



US00D860944S

(12) **United States Design Patent** (10) **Patent No.:** **US D860,944 S**  
**Beaven et al.** (45) **Date of Patent:** **\*\* Sep. 24, 2019**

(54) **CHARGING HATCH**

(71) Applicant: **Jaguar Land Rover Limited**, Whitley, Coventry (GB)

(72) Inventors: **Matthew Beaven**, Coventry (GB); **Simon Tovey**, Coventry (GB)

(73) Assignee: **Jaguar Land Rover Limited**, Whitley, Coventry (GB)

(\*\*) Term: **15 Years**

(21) Appl. No.: **29/600,462**

(22) Filed: **Apr. 12, 2017**

(30) **Foreign Application Priority Data**

Oct. 17, 2016 (EM) ..... 003421965-0010

(51) **LOC (12) Cl.** ..... **13-02**

(52) **U.S. Cl.**  
USPC ..... **D13/120**

(58) **Field of Classification Search**  
USPC ..... D13/103, 108, 120, 151-155; D12/218, D12/126, 400, 415  
CPC ..... B60L 11/18; B60R 13/04  
See application file for complete search history.

(56) **References Cited**

U.S. PATENT DOCUMENTS

D392,020 S *	3/1998	Fairles	.....	D23/206
D629,348 S *	12/2010	Nishimoto	.....	D12/126
D638,757 S *	5/2011	May	.....	D12/114
D721,788 S *	1/2015	Pifer	.....	D23/233
D761,938 S *	7/2016	Pifer	.....	D23/233

D775,041 S *	12/2016	Matsumura	.....	D12/197
D786,197 S *	5/2017	Imai	.....	D13/154
D791,676 S *	7/2017	Ozawa	.....	D12/218
D813,133 S *	3/2018	Henstridge	.....	D12/196
2017/0253279 A1 *	9/2017	Hemphill	.....	B62D 29/005
2018/0105211 A1 *	4/2018	Jarvis	.....	B60R 13/04

\* cited by examiner

*Primary Examiner* — Jennifer Rivard  
*Assistant Examiner* — Alison M Ofstun

(74) *Attorney, Agent, or Firm* — Wood Herron & Evans LLP

(57) **CLAIM**

The ornamental design for a charging hatch, as shown and described.

**DESCRIPTION**

FIG. 1 is a right front perspective view of a charging hatch, showing our new design.  
 FIG. 2 is a left front perspective view of the charging hatch shown in FIG. 1.  
 FIG. 3 is a right rear perspective view thereof.  
 FIG. 4 is a left rear perspective view thereof.  
 FIG. 5 is a right side view thereof.  
 FIG. 6 is a left side view thereof.  
 FIG. 7 is a front view thereof.  
 FIG. 8 is a rear view thereof.  
 FIG. 9 is a top view thereof; and,  
 FIG. 10 is a right front perspective view thereof, shown in an environment of use.  
 The broken lines represent a boundary of the claimed design and form no part thereof. The vehicle shown in half-tone portions illustrates environmental subject matter and forms no part of the claimed design.

**1 Claim, 10 Drawing Sheets**

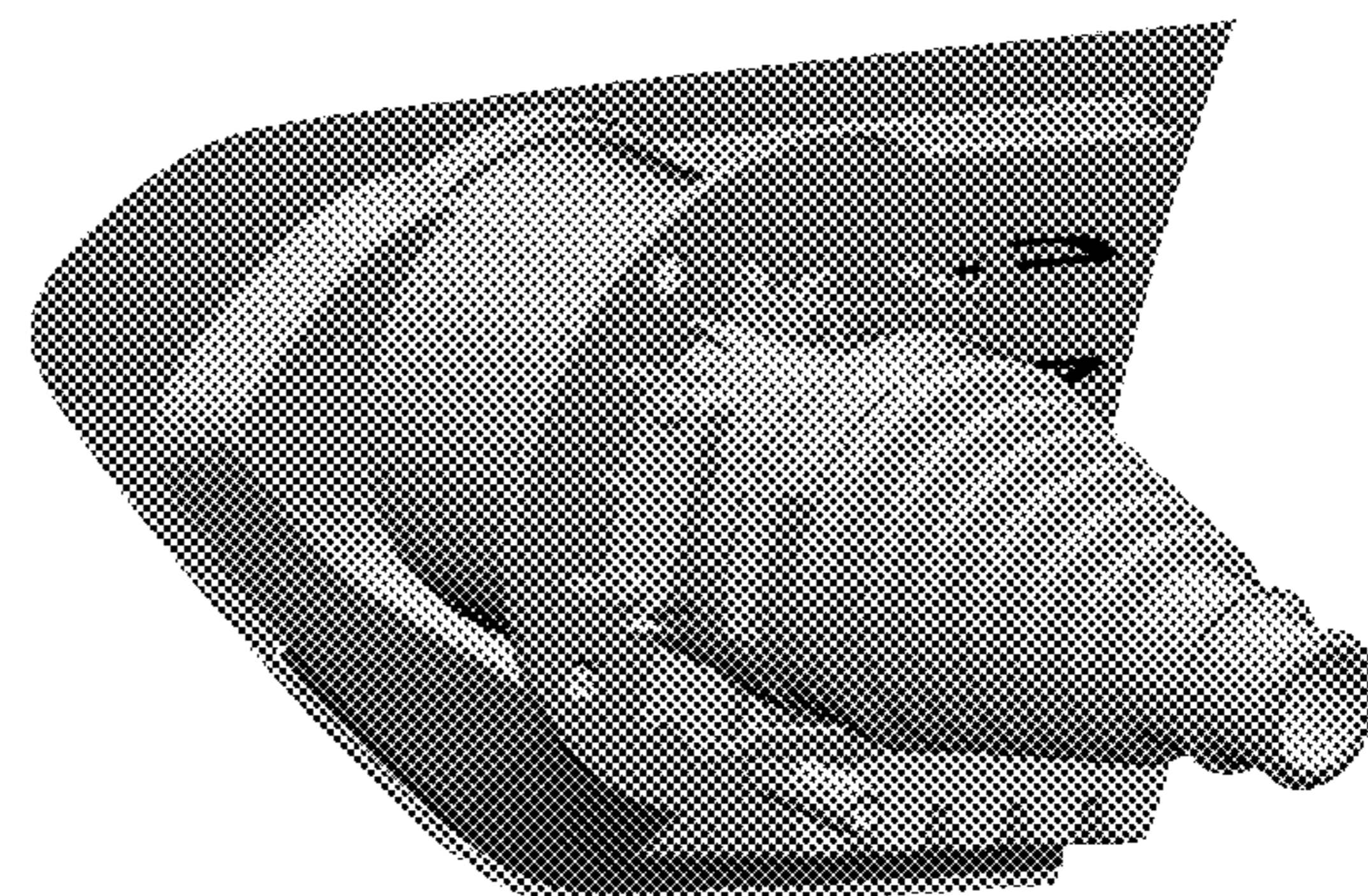
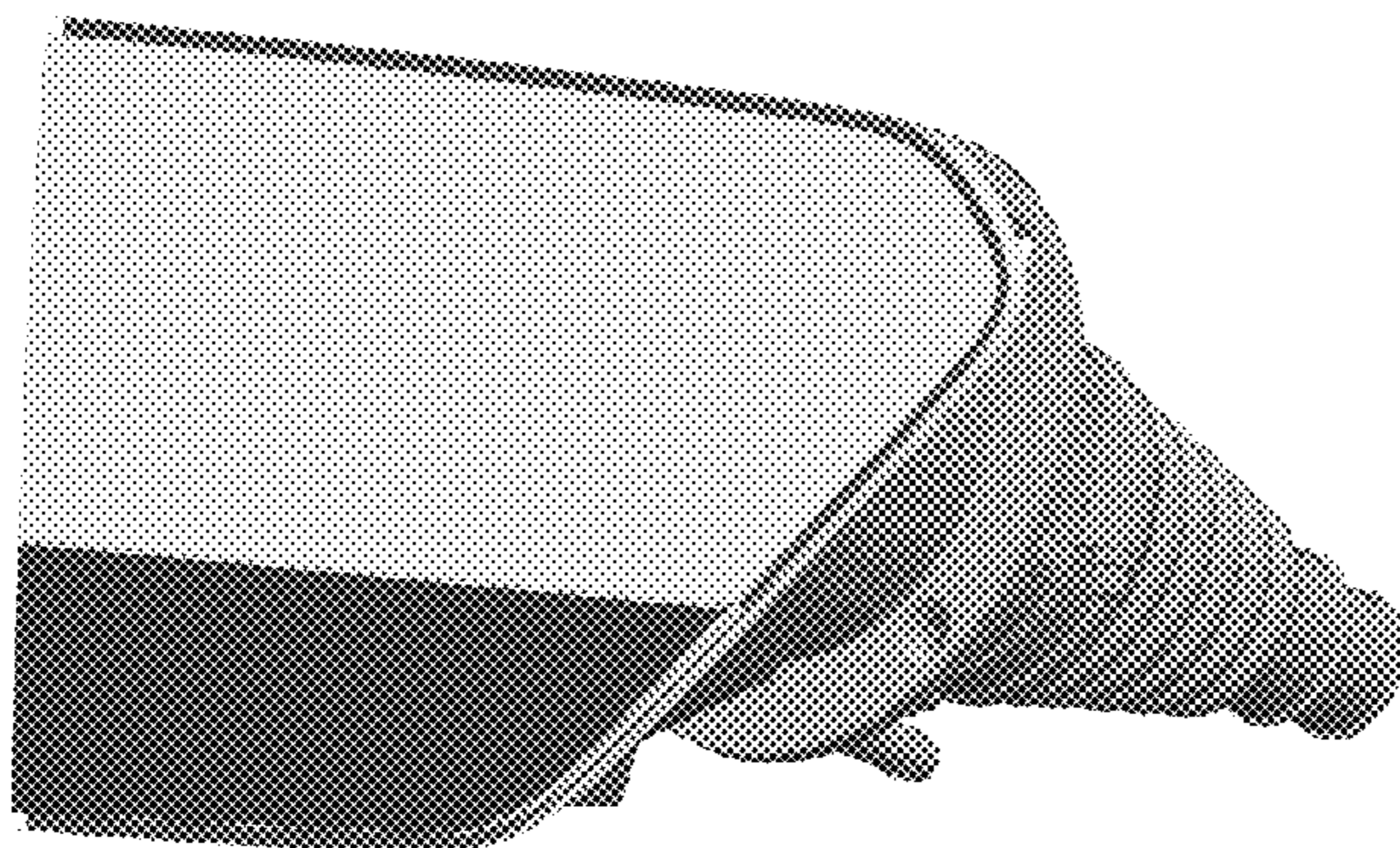

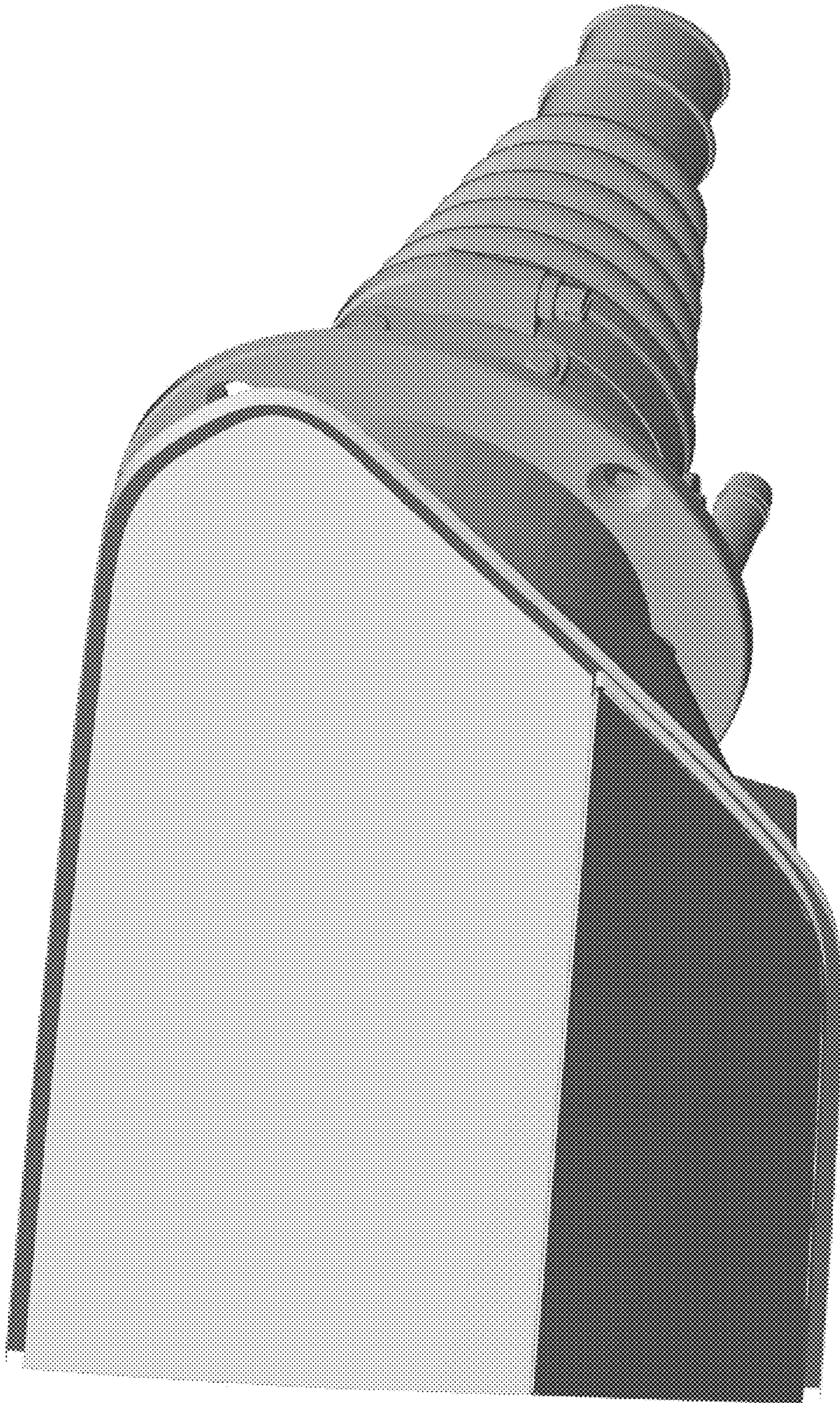

FIG. 1

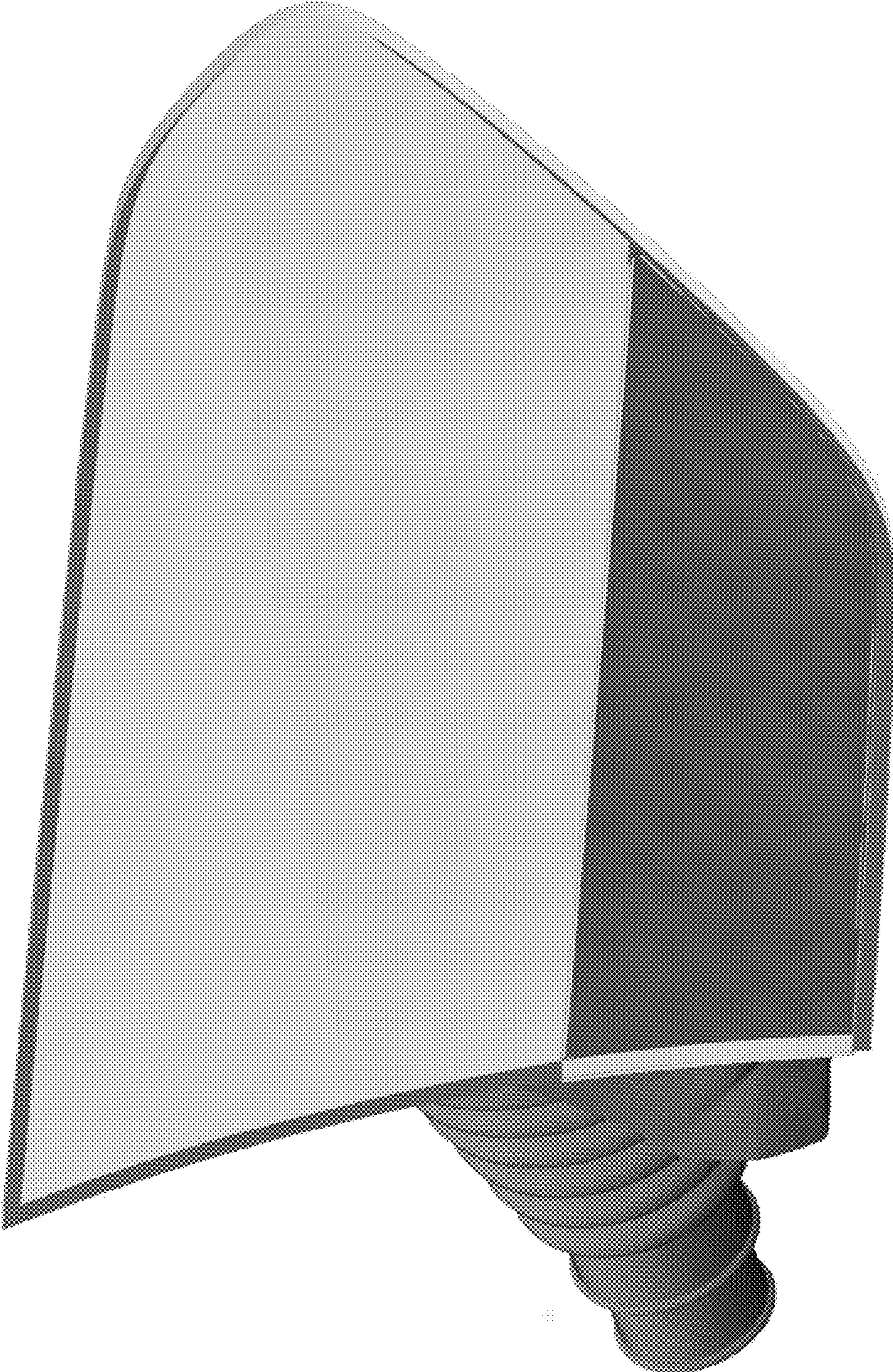

FIG. 2

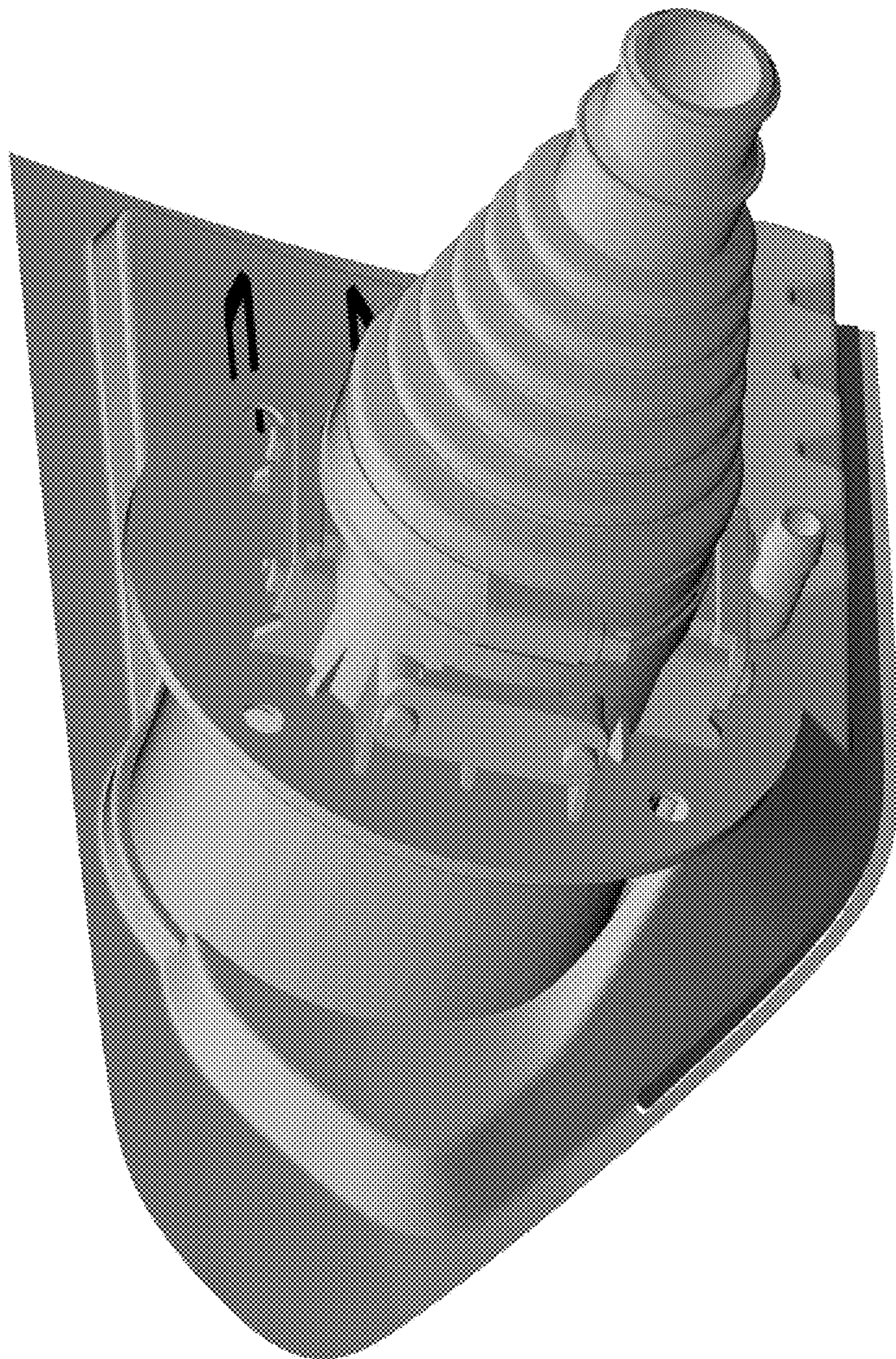

FIG. 3

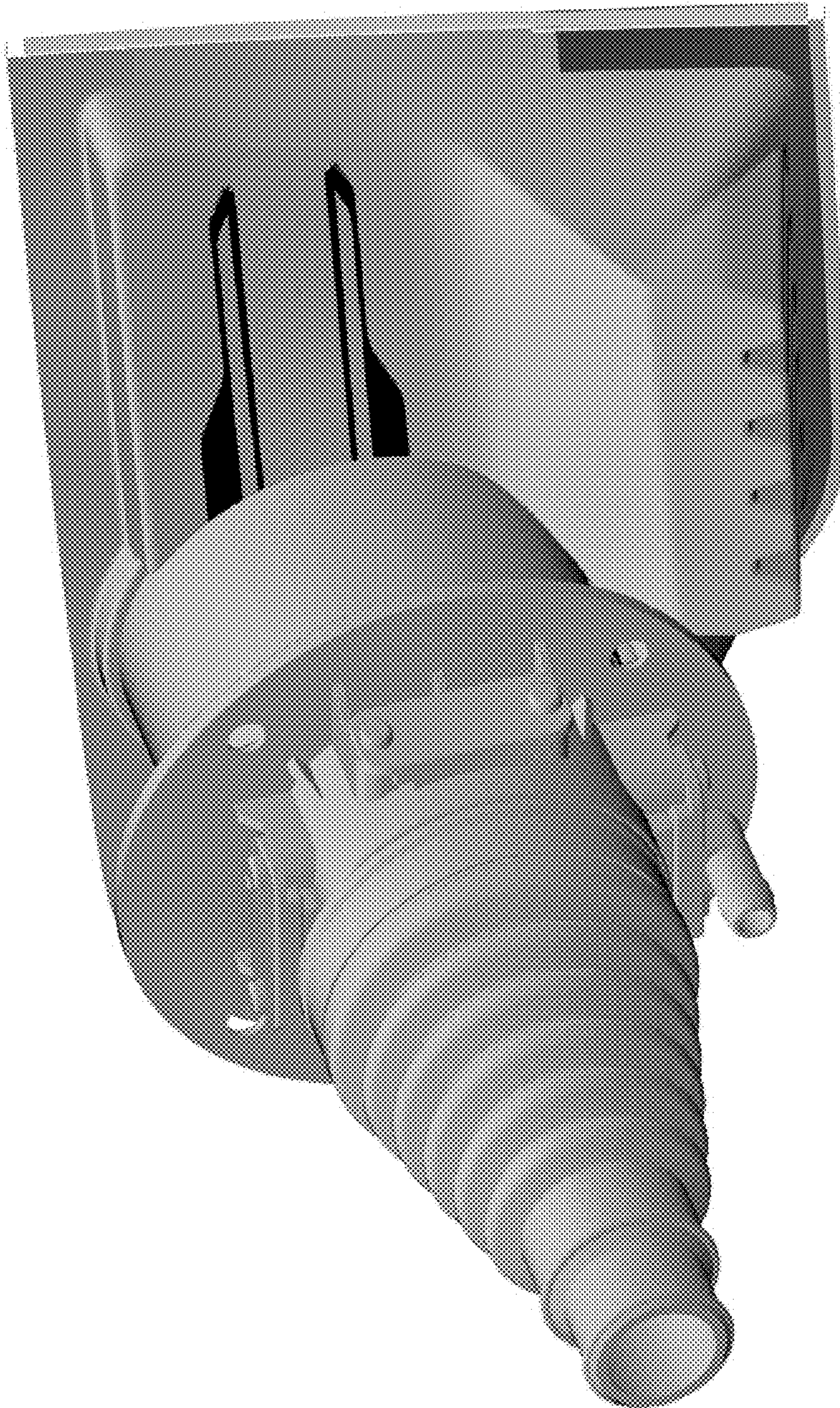

FIG. 4

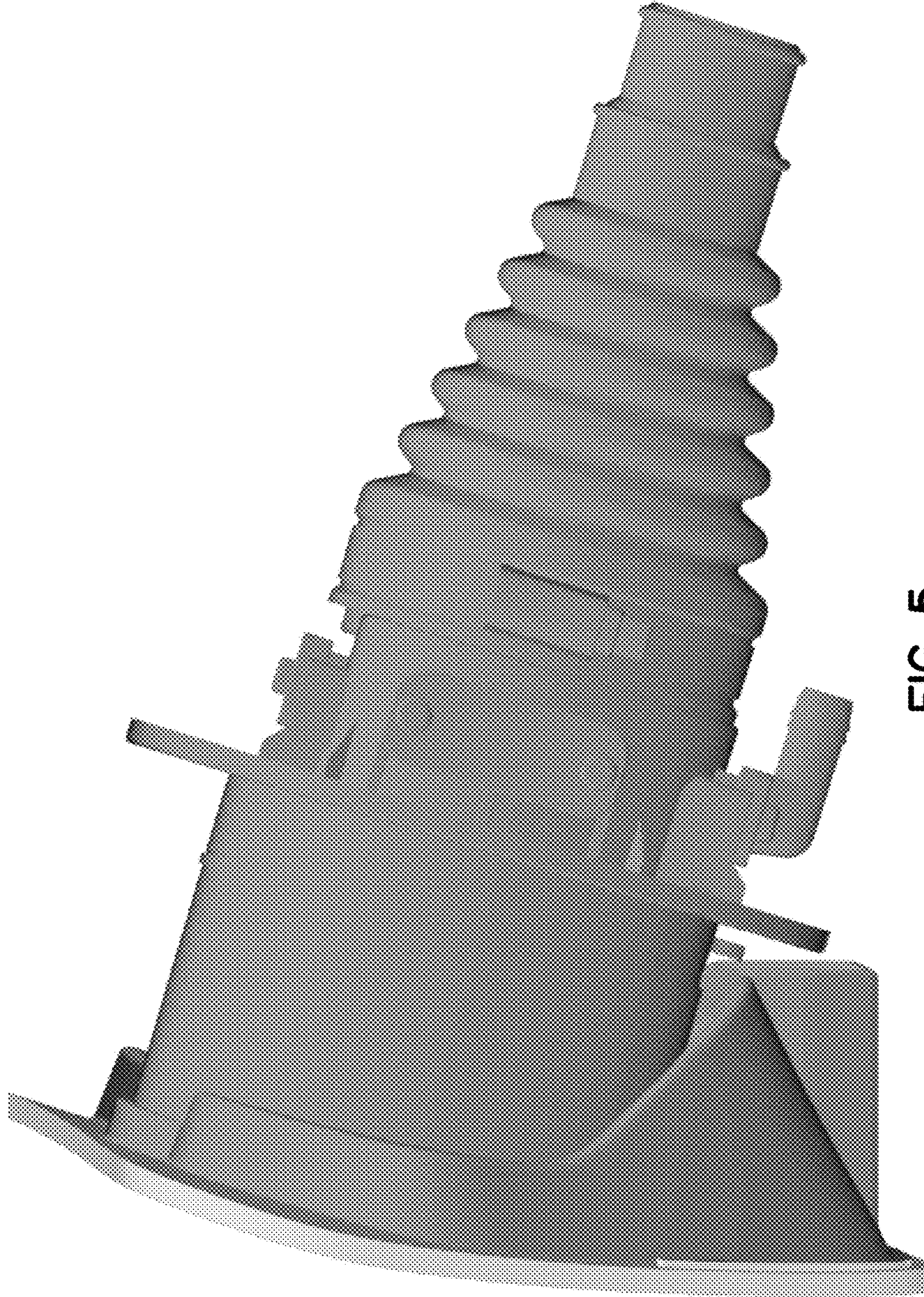

FIG. 5

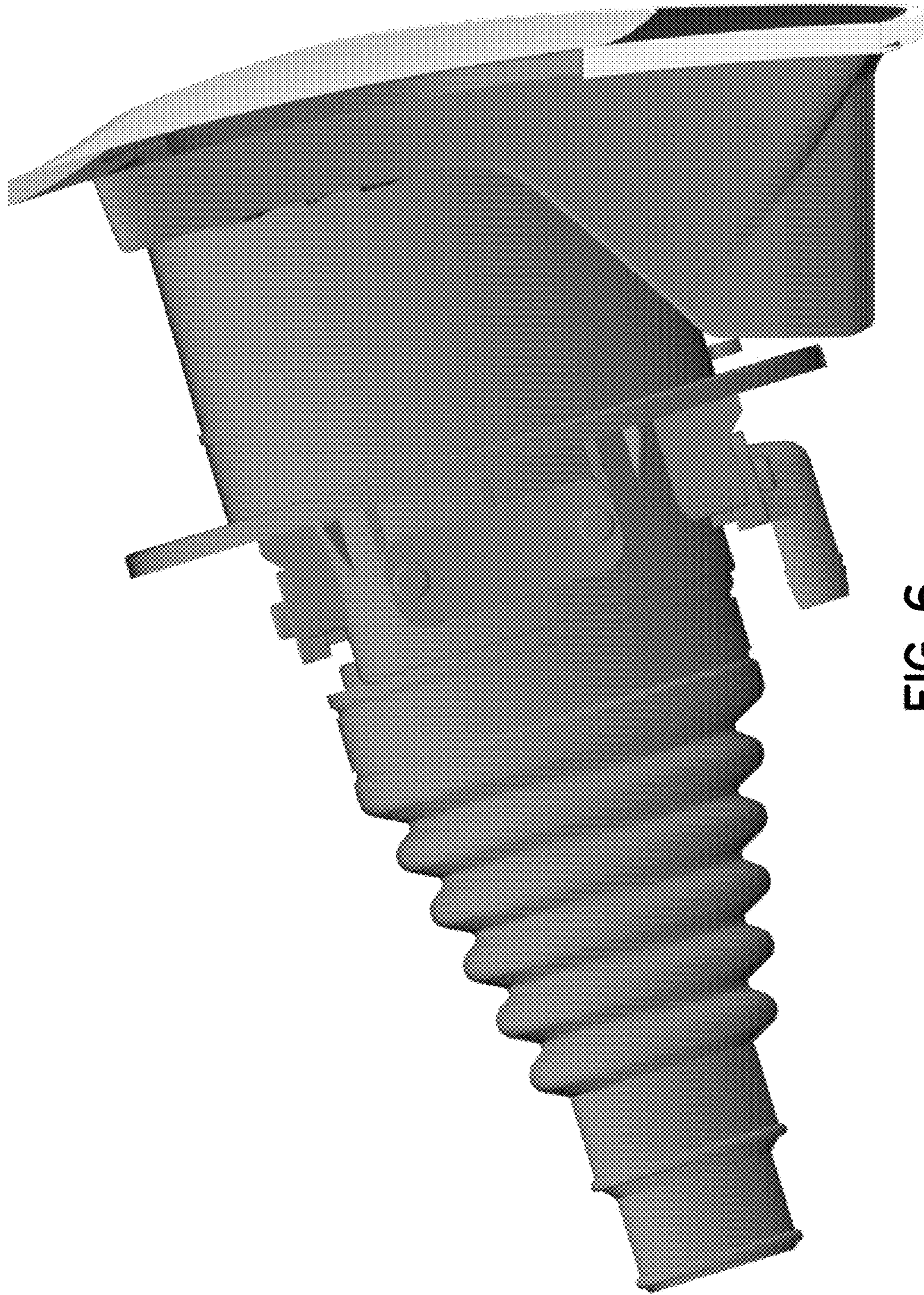

FIG. 6

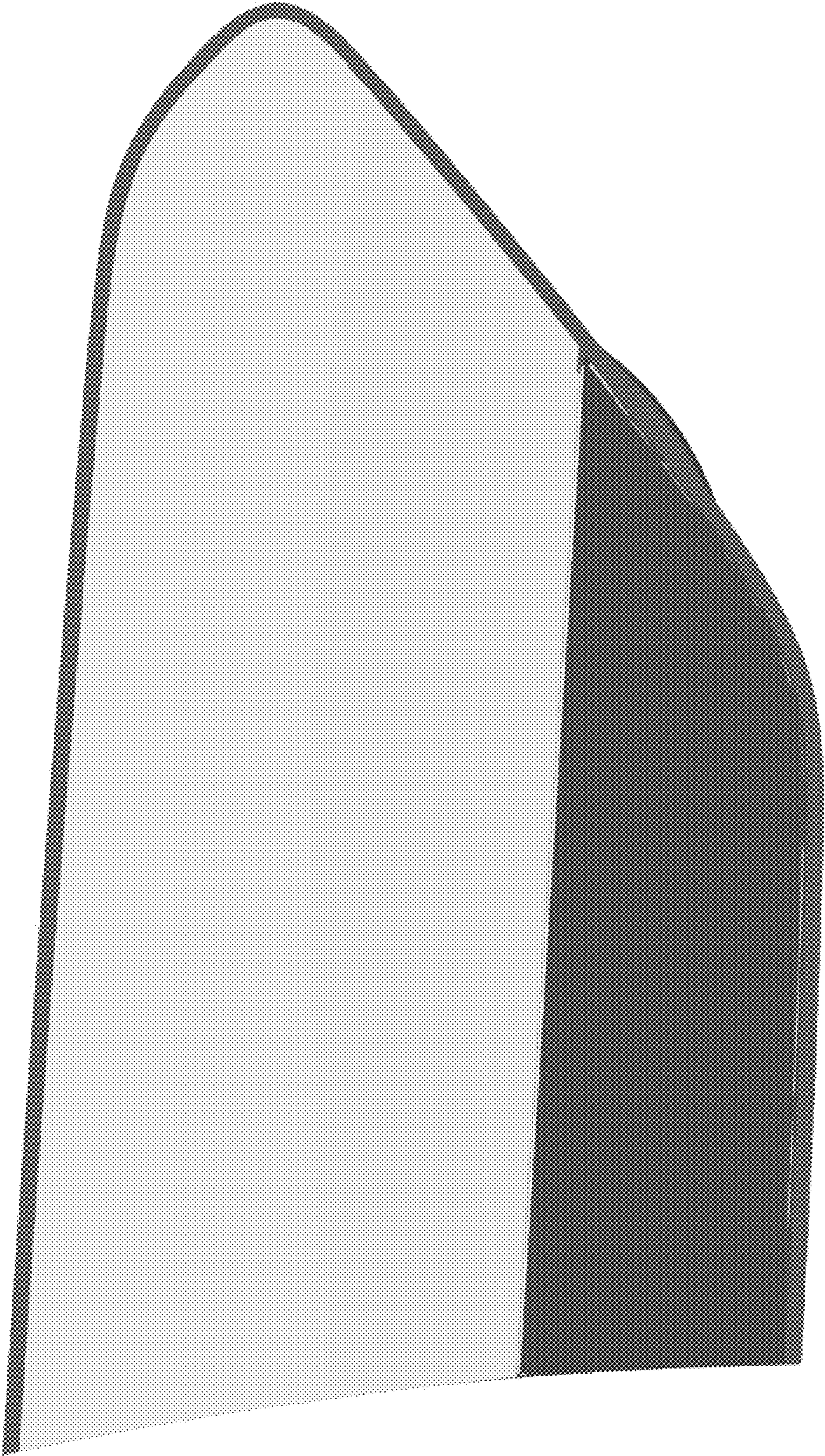

FIG. 7



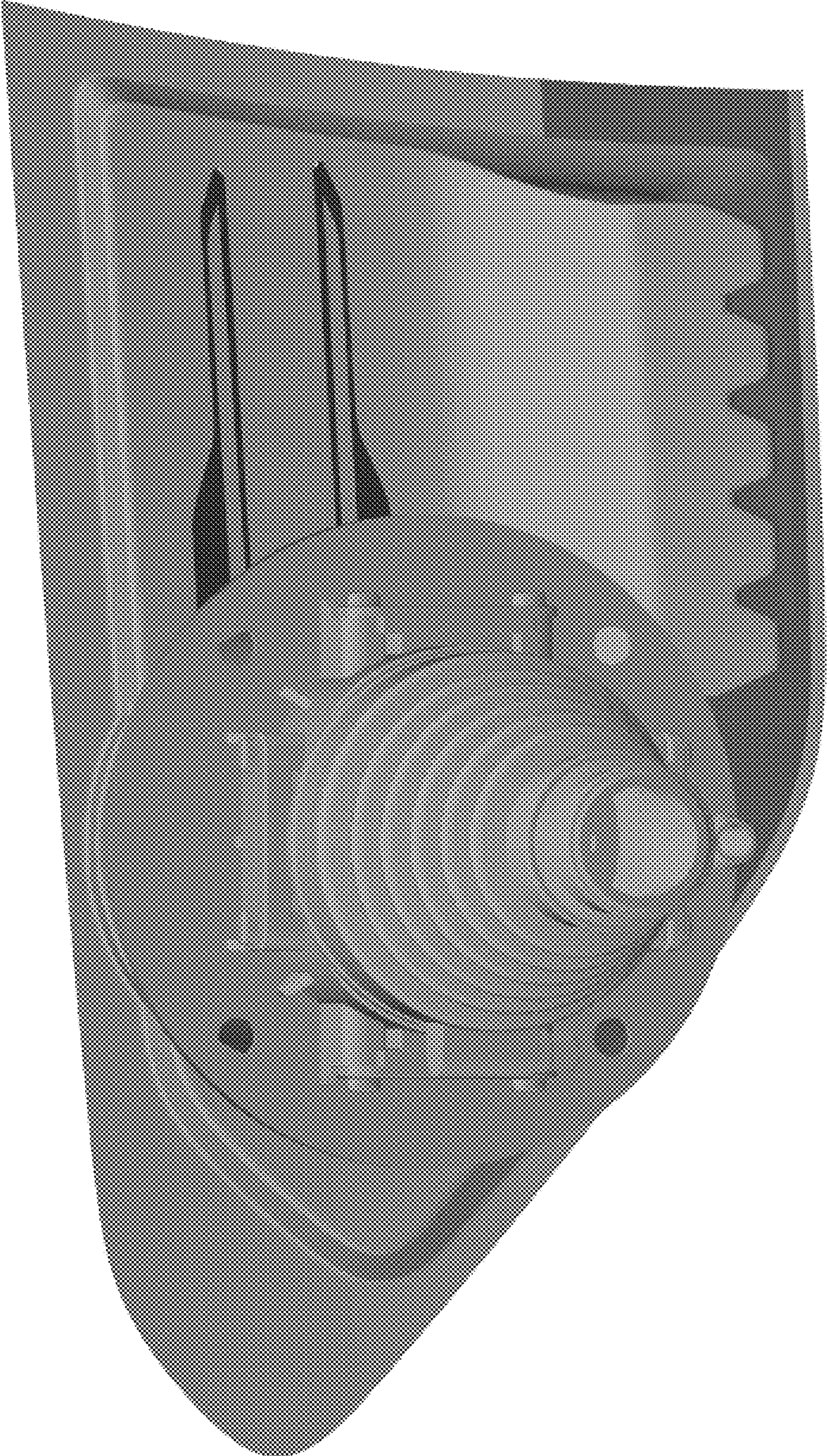

FIG. 8

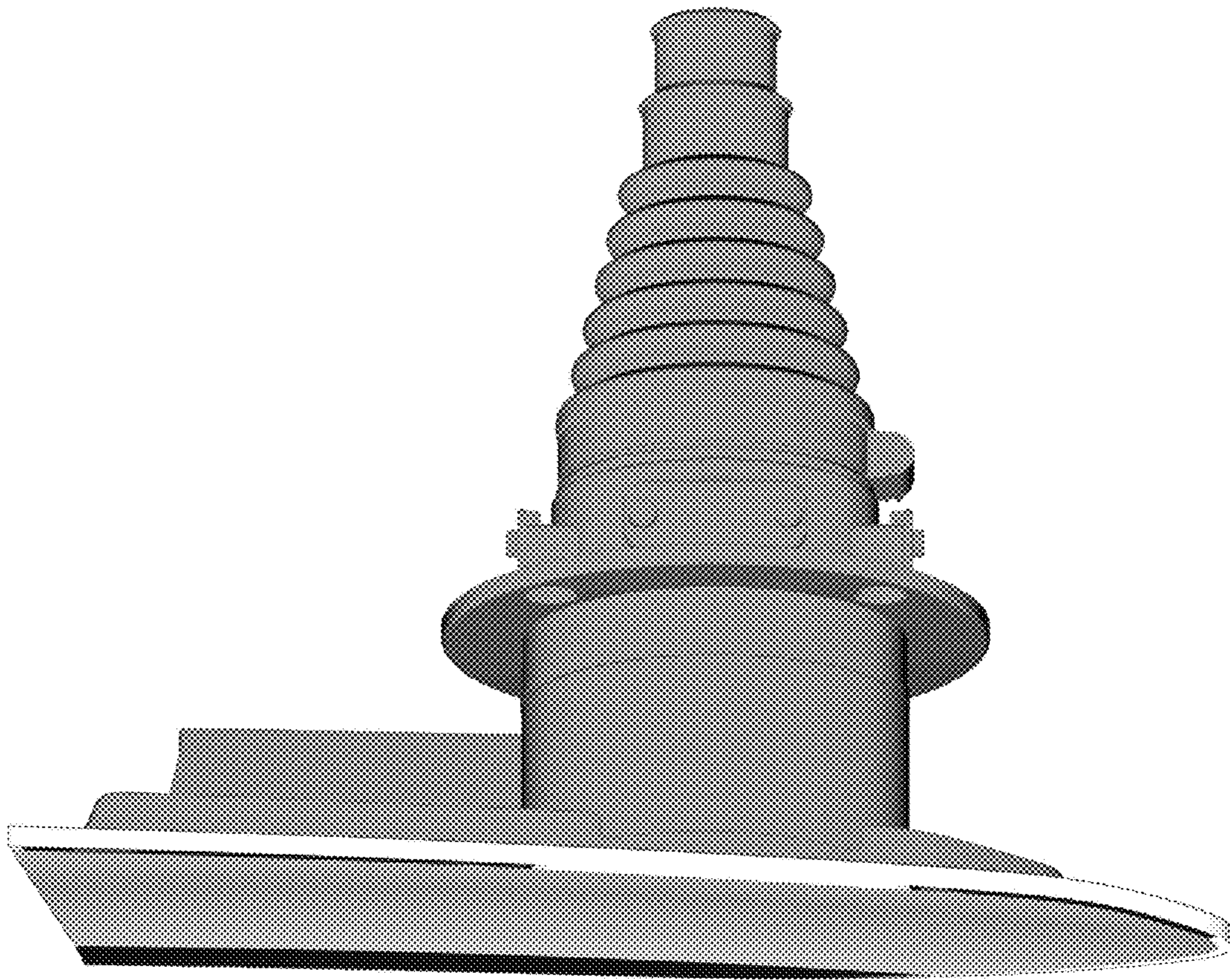

FIG. 9

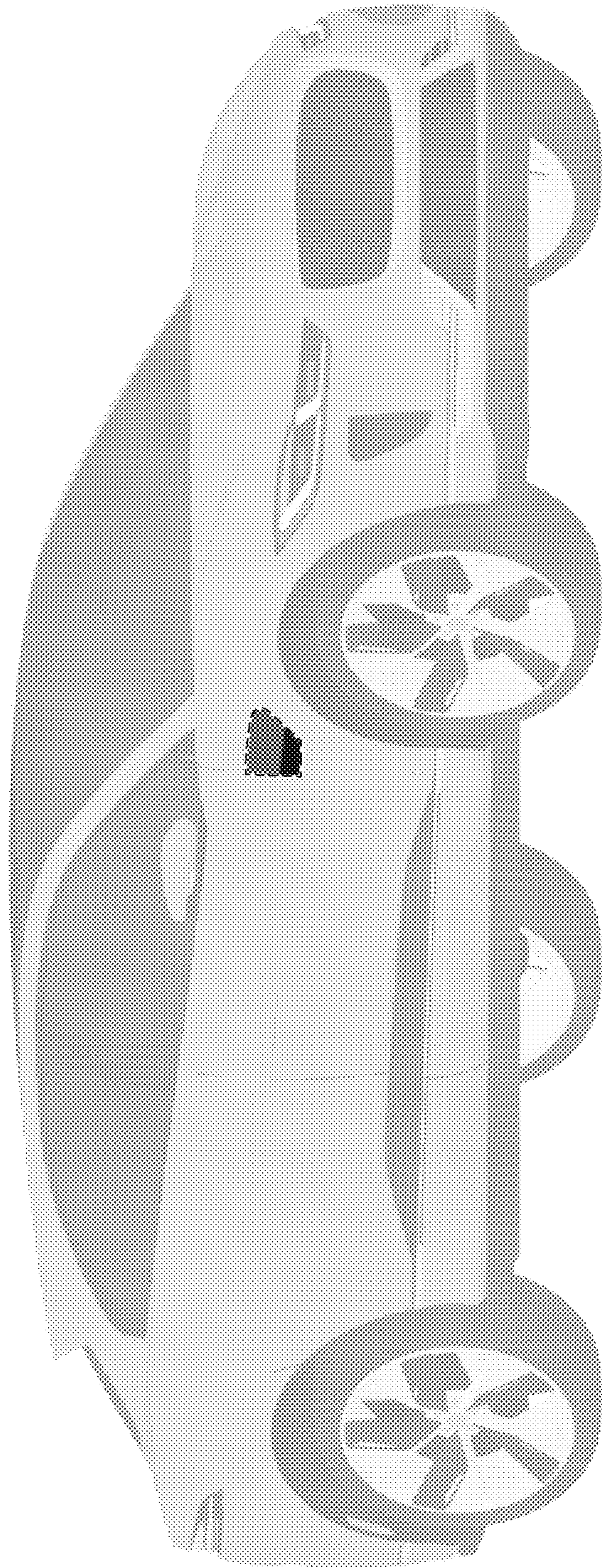

FIG. 10