

US00D860850S

(12) **United States Design Patent** (10) **Patent No.:** **US D860,850 S**
Solow (45) **Date of Patent:** **** Sep. 24, 2019**

(54) **SPLIT HORN**
(71) Applicant: **WOLO MFG. CORP.**, Deer Park, NY (US)
(72) Inventor: **Stanley Solow**, Plainview, NY (US)
(73) Assignee: **WOLO MFG. CORP.**, Deer Park, NY (US)
(**) Term: **15 Years**

(21) Appl. No.: **29/622,652**

(22) Filed: **Oct. 18, 2017**

(51) **LOC (12) Cl.** **10-06**

(52) **U.S. Cl.**
USPC **D10/120**

(58) **Field of Classification Search**
USPC D10/40-41, 104.2, 106.94, 114.1-114.9, D10/116.1, 120-121; D14/344; D24/167, 186
CPC . H04R 1/00; H04R 1/30; H04R 1/023; G10K 9/04; G10K 9/12; G10K 9/22
See application file for complete search history.

(56) **References Cited**

U.S. PATENT DOCUMENTS

2,871,972	A *	2/1959	Glassey	H04R 1/2865
					181/152
4,313,032	A *	1/1982	Thomas	H04R 1/30
					181/152
D415,055	S *	10/1999	Schmidt	D10/120
D439,185	S *	3/2001	Asahina	D10/116.1
D453,119	S *	1/2002	Tsuchikiri	D10/116.1
D464,284	S *	10/2002	Kuwabara	G10K 9/22
					D10/116.1
D513,599	S *	1/2006	Coward	D10/120
D593,888	S *	6/2009	Huftalen	D10/116.1

D593,889	S *	6/2009	Huftalen	D10/116.1
7,802,535	B2 *	9/2010	Solow	G10K 9/04
					116/142 FP
D704,587	S *	5/2014	Solow	D10/120
2004/0246110	A1 *	12/2004	Di Giovanni	G10K 9/04
					340/388.1
2009/0090292	A1 *	4/2009	Solow	G10K 9/04
					116/142 FP
2012/0158168	A1 *	6/2012	Khakhalev	B23K 20/10
					700/108
2013/0121521	A1 *	5/2013	Solow	G10K 9/04
					381/340
2014/0093112	A1 *	4/2014	Solow	H04R 1/00
					381/340

* cited by examiner

Primary Examiner — Sandra S Snapp
Assistant Examiner — Katherine Glennon
(74) *Attorney, Agent, or Firm* — Andrew F. Young, Esq.; Lackenbach Siegel, LLP

(57) **CLAIM**

The ornamental design for a split horn, as shown and described.

DESCRIPTION

FIG. 1 is a front top perspective view of a split horn showing my new design.
FIG. 2 is a bottom front perspective view thereof.
FIG. 3 is a front elevation view thereof.
FIG. 4 is a rear elevation view thereof.
FIG. 5 is a left side elevation view thereof.
FIG. 6 is a right side elevation view thereof.
FIG. 7 is a top plan view thereof; and,
FIG. 8 is a bottom plan view thereof.
The broken lines illustrate portions of the article that form no part of the claimed design.

1 Claim, 5 Drawing Sheets

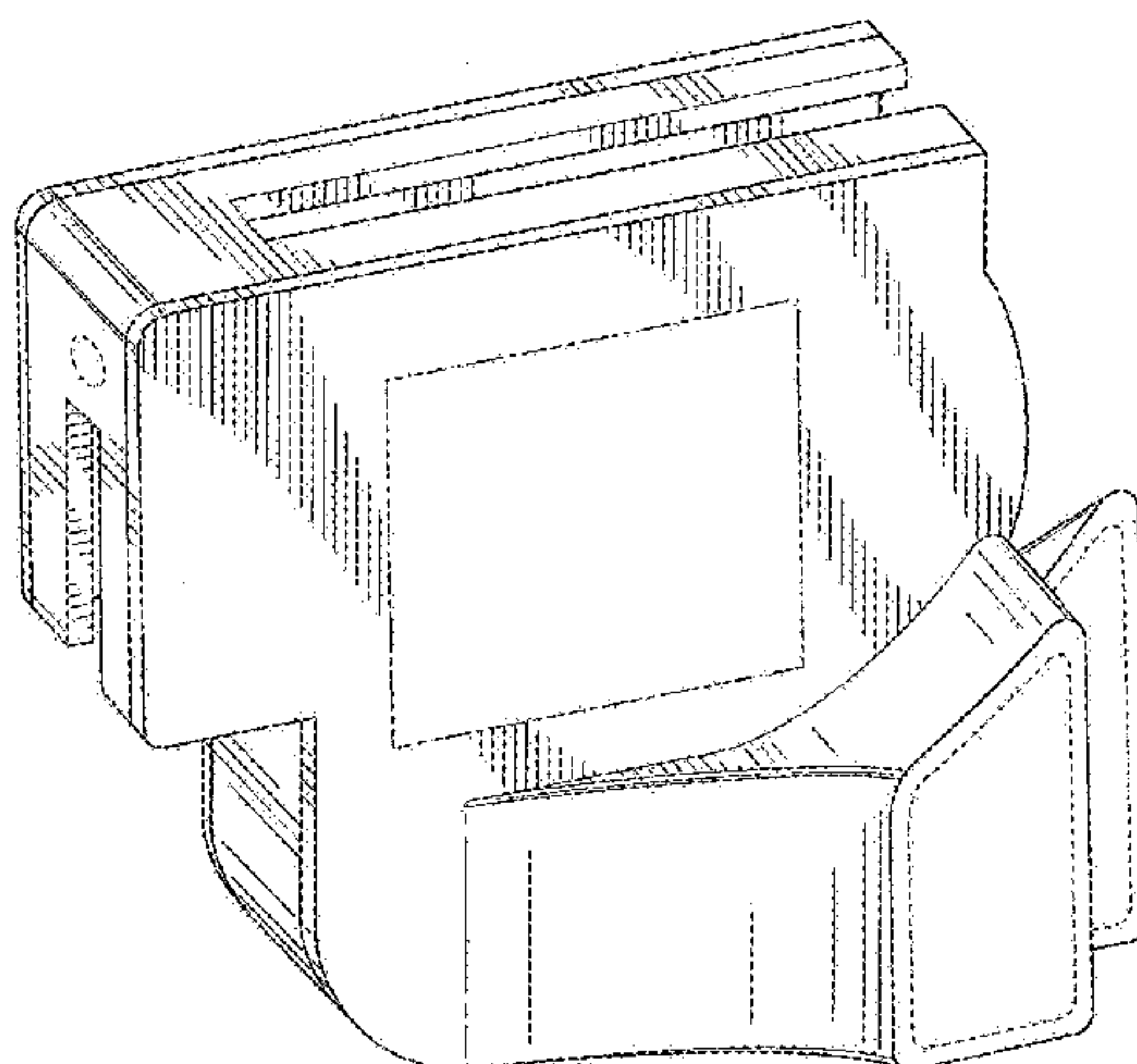

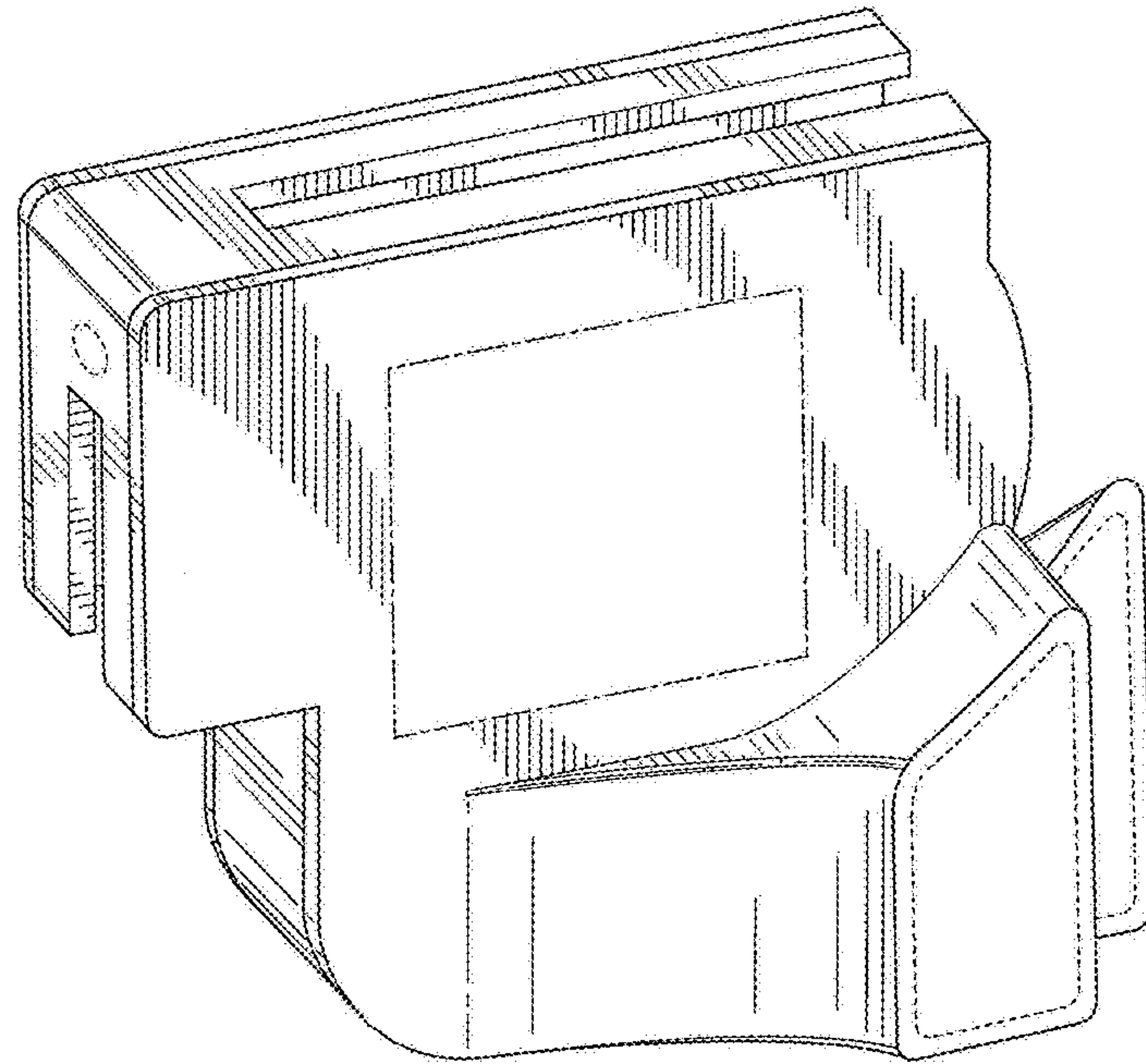

FIG. 1

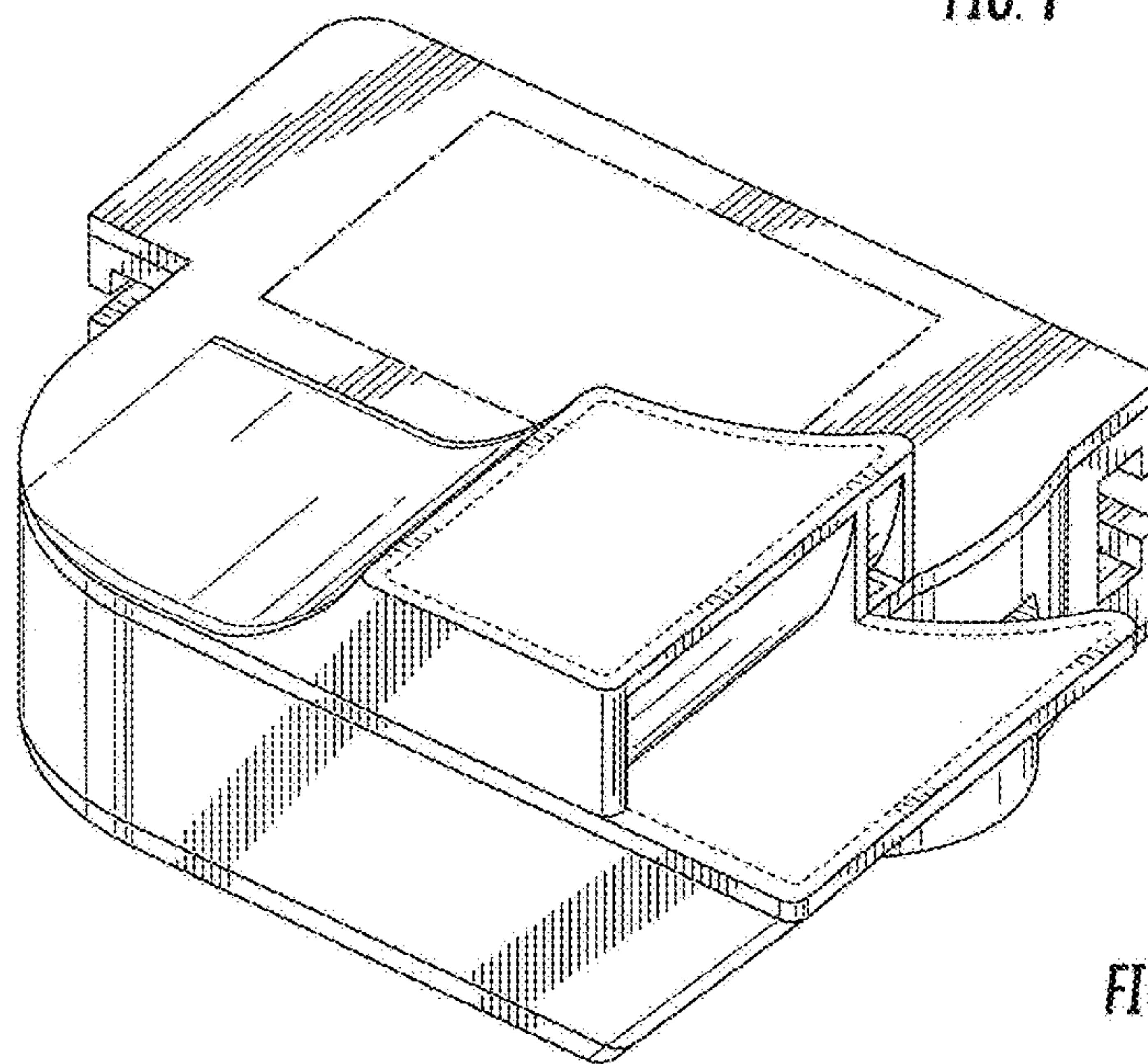

FIG. 2

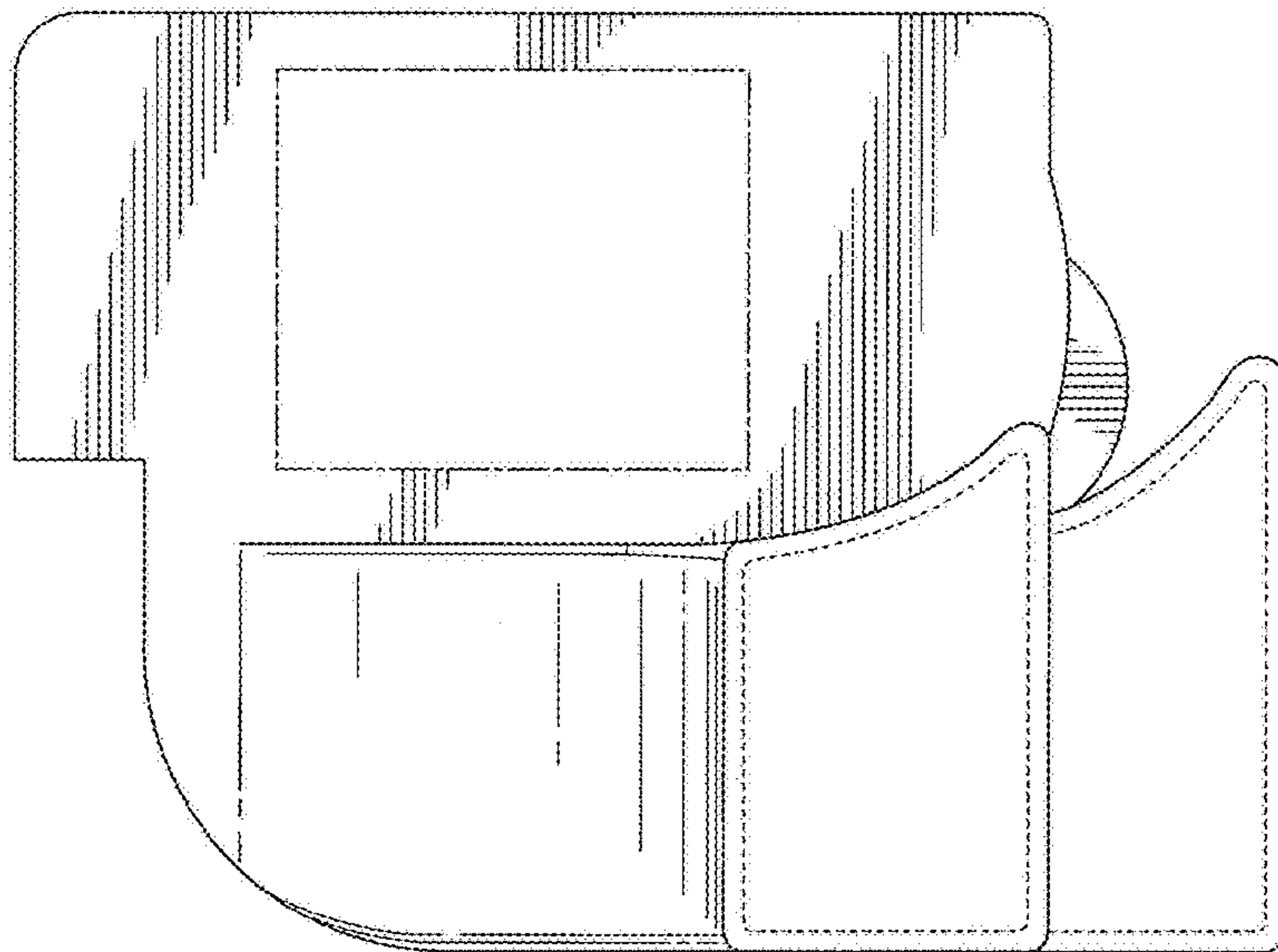

FIG. 3

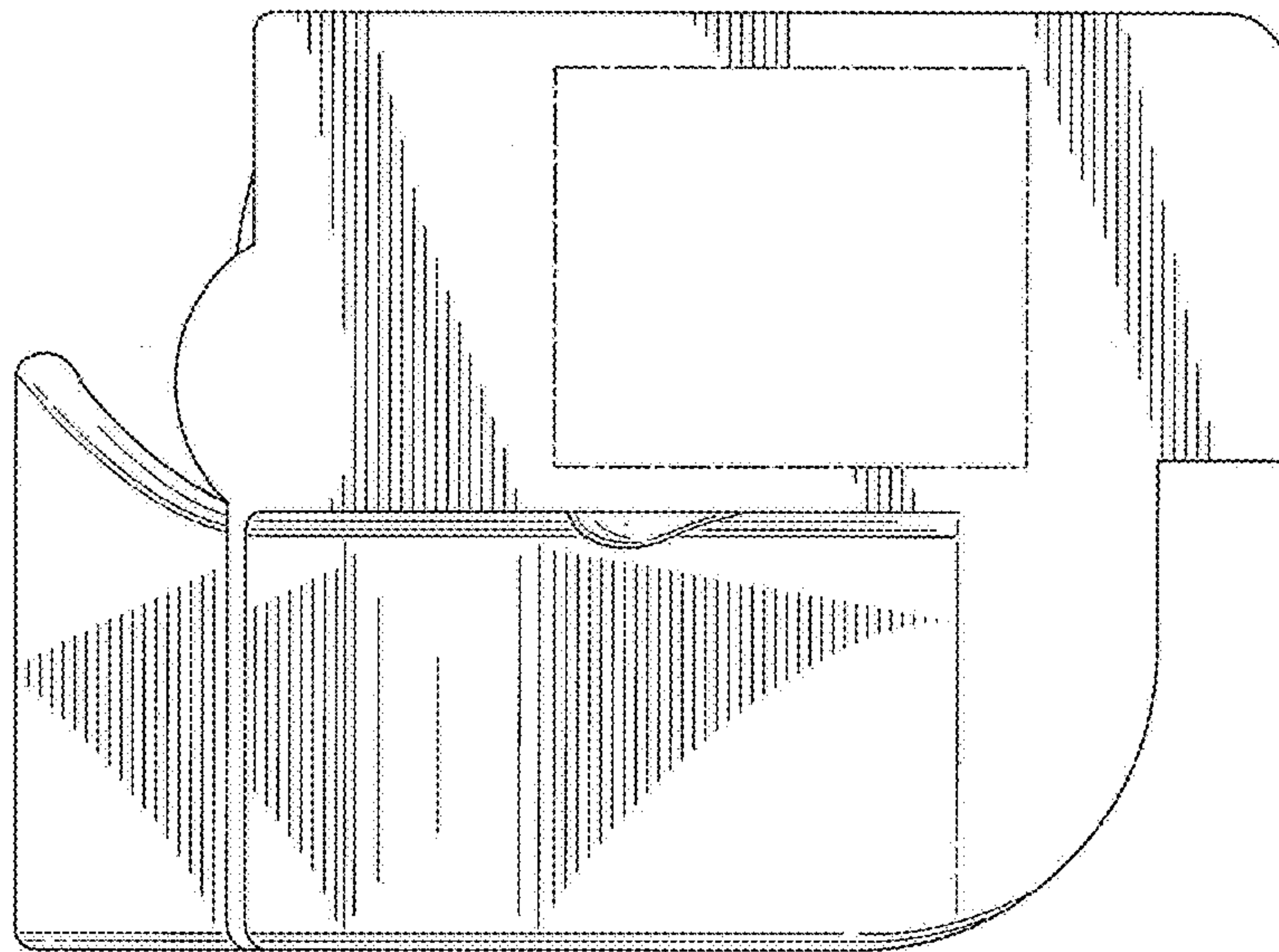

FIG. 4

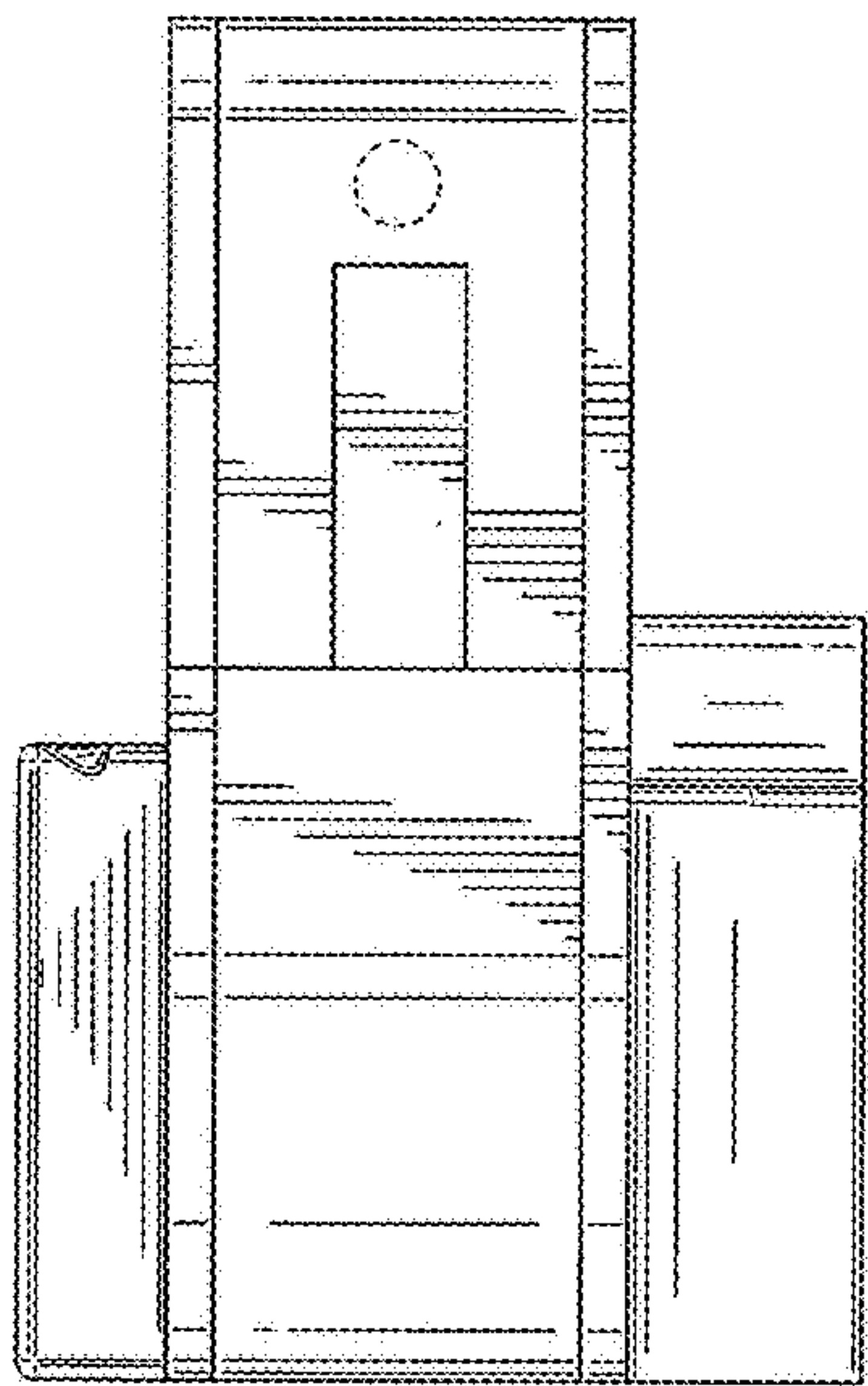

FIG. 5

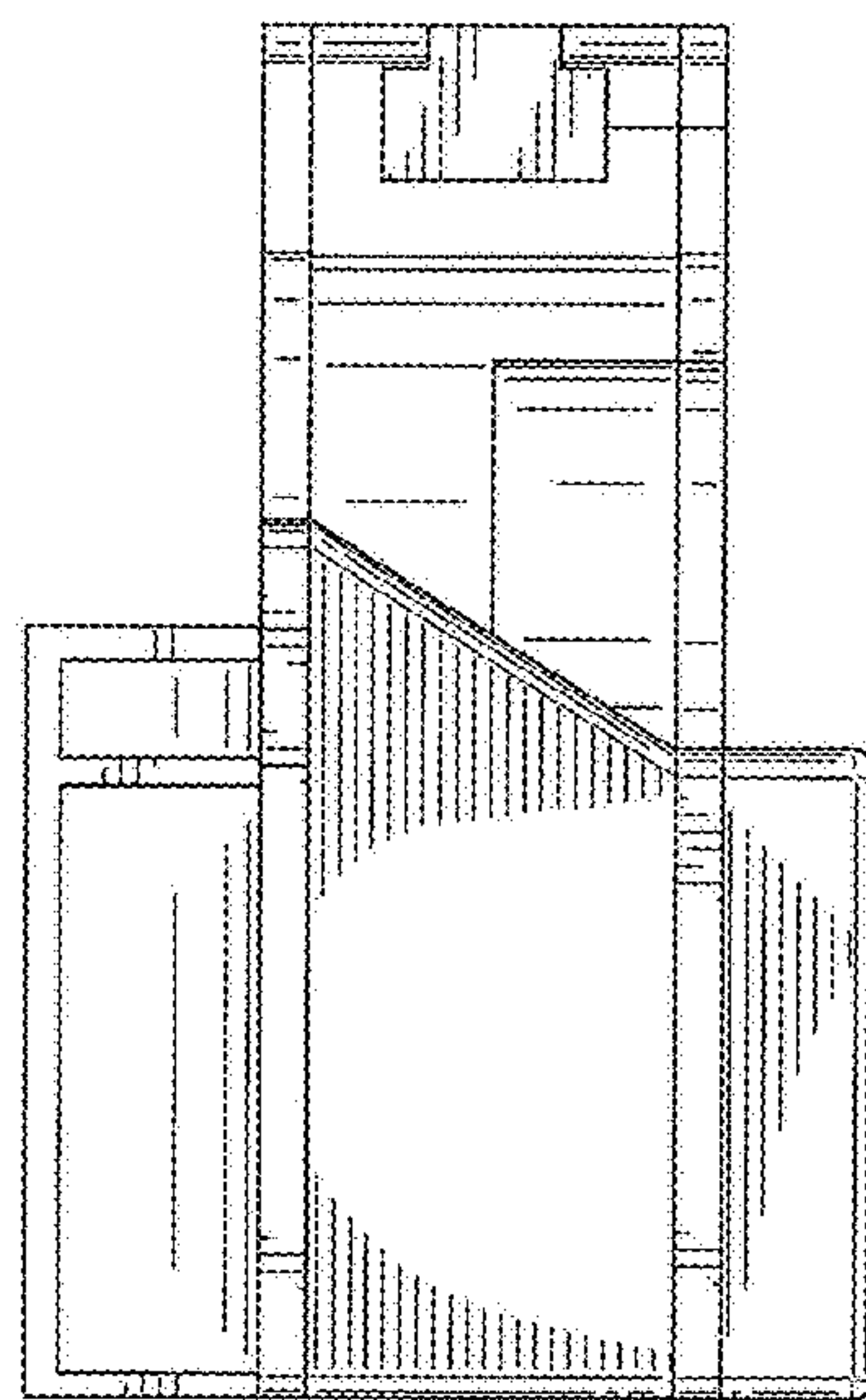

FIG. 6

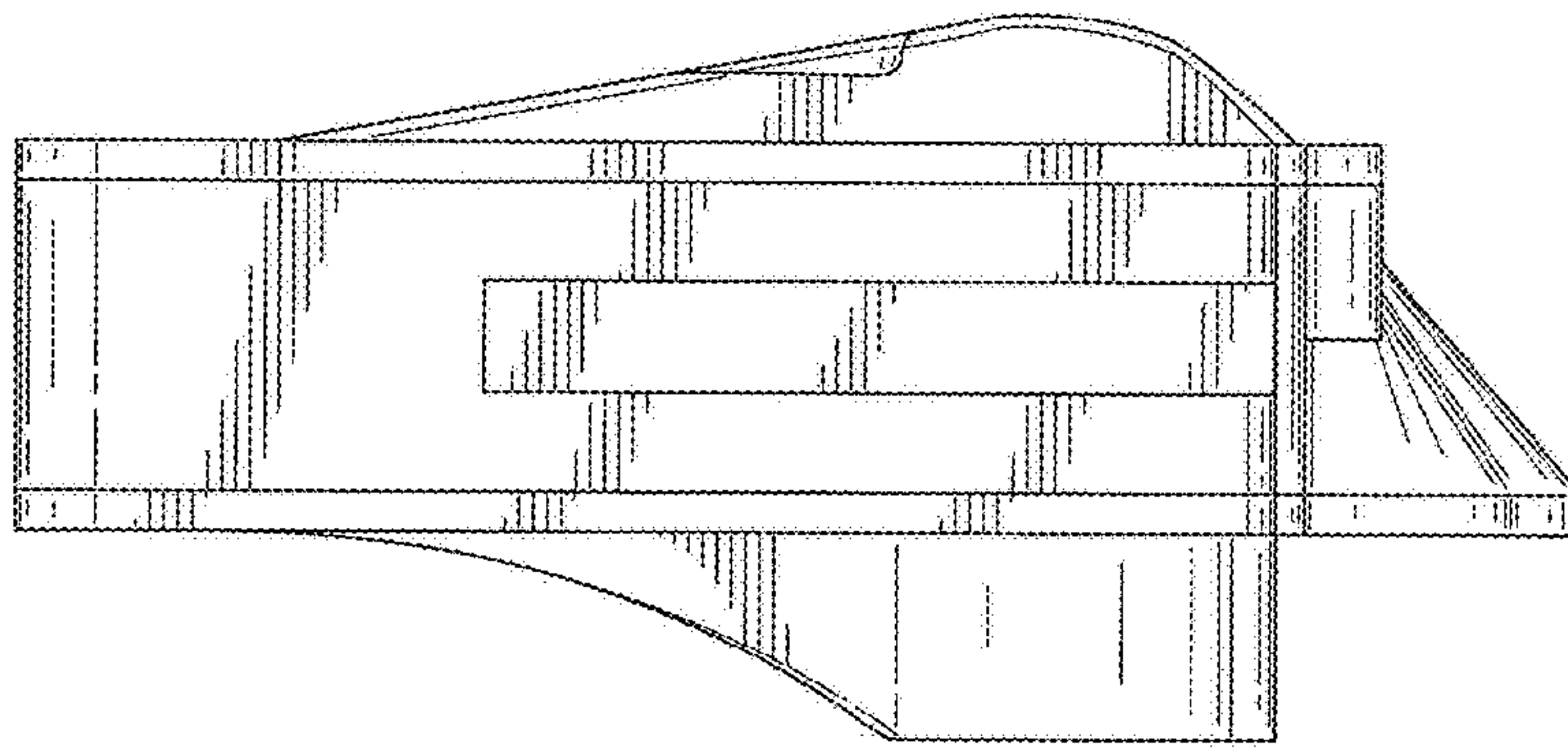

FIG. 7

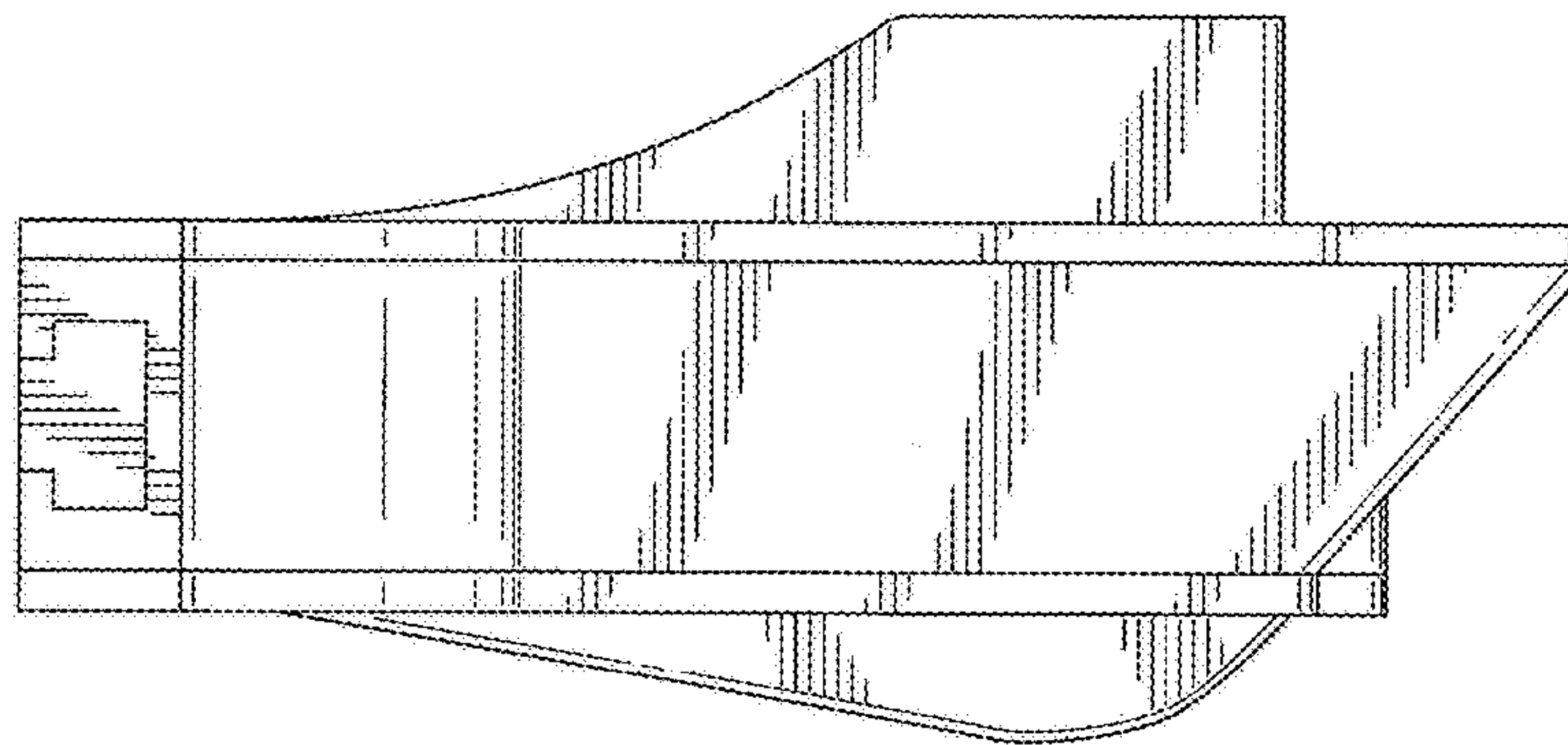

FIG. 8