

US00D860109S

(12) **United States Design Patent** (10) **Patent No.:** **US D860,109 S**
Miron et al. (45) **Date of Patent:** **** Sep. 17, 2019**

- (54) **GALLEY**
- (71) Applicant: **BOMBARDIER INC.**, Dorval (CA)
- (72) Inventors: **Bruno Miron**, Coteau-du-Lac (CA);
Alexandre Curthelet, Montreal (CA);
Adrian Goring, Saint Laurent (CA)
- (73) Assignee: **BOMBARDIER INC.**, Dorval, Québec (CA)
- (**) Term: **15 Years**
- (21) Appl. No.: **29/590,723**
- (22) Filed: **Jan. 12, 2017**

- D263,100 S * 2/1982 Thompson D18/59
- D263,777 S * 4/1982 Thompson D6/663
- D273,150 S 3/1984 Benson
- D314,090 S 1/1991 Stephens et al.
- D332,248 S * 1/1993 Harper D12/320
- D507,285 S * 7/2005 Cho D15/86
- D592,887 S 5/2009 Mischkulnig

(Continued)

OTHER PUBLICATIONS

Retro Rustic Reclaimed Wood 6 Drawer Dresser . by bestdressers. dated 2018. found online [Apr. 1, 2019]. <http://bestdressers.hubspace.org/black-standing-dresser/>.*

(Continued)

Primary Examiner — Marissa J Cash
(74) *Attorney, Agent, or Firm* — Karceski IP Law, PLLC

Related U.S. Application Data

- (62) Division of application No. 29/489,016, filed on Apr. 25, 2014, now abandoned.
- (51) **LOC (12) Cl.** **12-07**
- (52) **U.S. Cl.**
USPC **D12/345**
- (58) **Field of Classification Search**
USPC D12/319–345, 1–4, 16.1, 214;
D21/436–454, 455; D30/160; D6/663,
D6/668, 671, 675.3, 680.1, 696.5, 514,
D6/616
CPC B64C 29/0025; B64C 2201/108; B64C
2201/048; B64C 2201/088; B64C 29/00;
B64C 29/0058; B64C 39/001; B64C
39/024; B64C 39/062; B64C 2201/141;
B64C 27/12; A47B 51/00
See application file for complete search history.

(57) **CLAIM**
The ornamental design for a galley, as shown and described.

DESCRIPTION

FIG. 1 is a perspective view of a first embodiment of a galley according to the design;
FIG. 2 is a front view of the galley of FIG. 1;
FIG. 3 is a right side view of the galley of FIG. 1;
FIG. 4 is a left side view of the galley of FIG. 1;
FIG. 5 is a top view of the galley of FIG. 1;
FIG. 6 is a bottom view of the galley of FIG. 1;
FIG. 7 is a perspective view of a second embodiment of a galley according to the design;
FIG. 8 is a front view of the galley of FIG. 7;
FIG. 9 is a right side view of the galley of FIG. 7;
FIG. 10 is a left side view of the galley of FIG. 7;
FIG. 11 is a top view of the galley of FIG. 7; and,
FIG. 12 is a bottom side view of the galley of FIG. 7.
The broken lines that are included in the figures of the drawings denote aspects of the galley that form no part of the claimed design.

(56) **References Cited**
U.S. PATENT DOCUMENTS

- D90,873 S * 10/1933 Dunning D23/272
- D155,284 S * 9/1949 Gershun D26/58
- D249,427 S 9/1978 Neveux

1 Claim, 12 Drawing Sheets

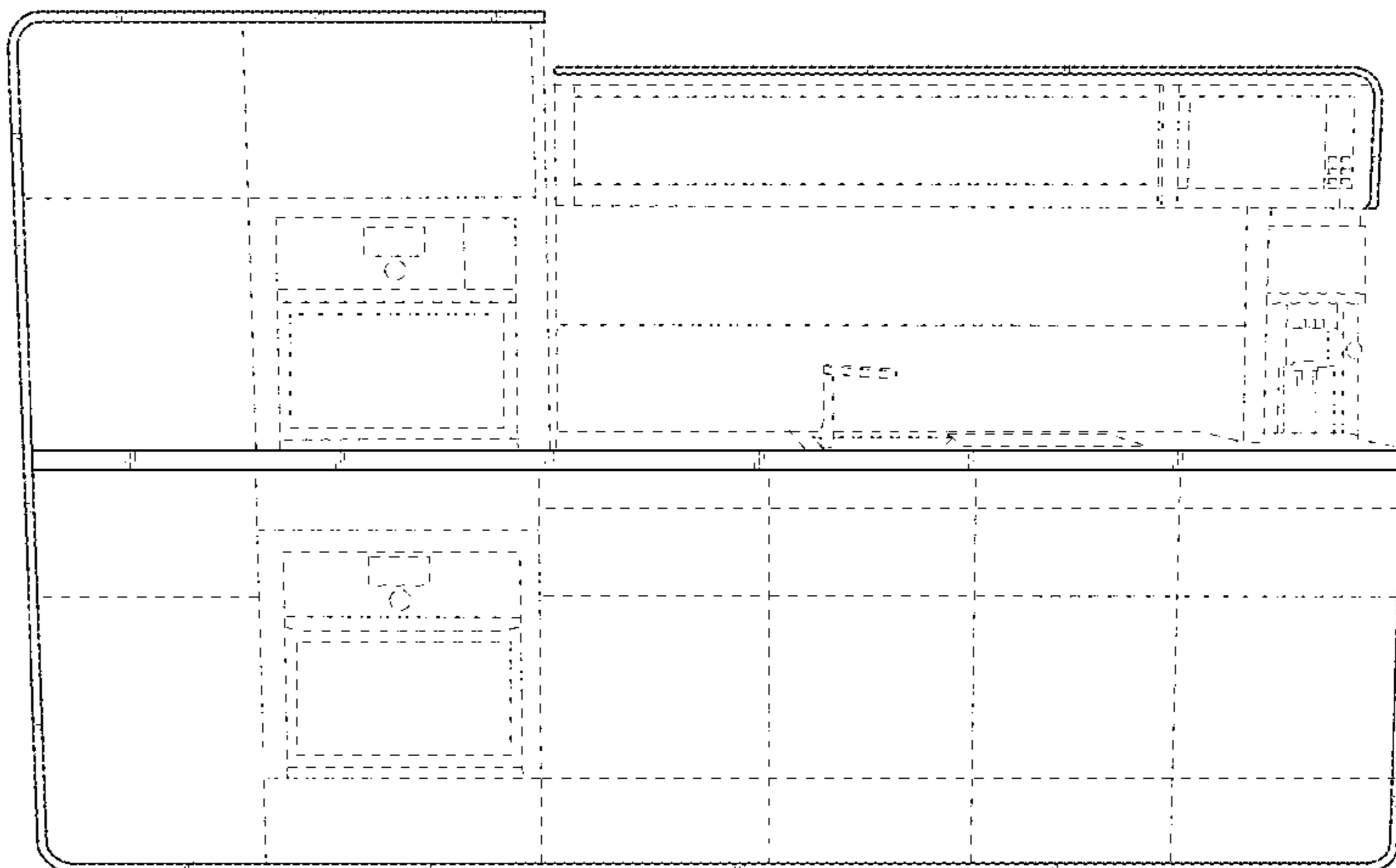

(56)

References Cited

U.S. PATENT DOCUMENTS

D617,725 S * 6/2010 Collins D12/345
 D628,138 S 11/2010 Collins et al.
 D647,024 S 10/2011 Tan
 D649,926 S 12/2011 Tan
 D669,013 S 10/2012 Sehreuder
 D706,064 S * 6/2014 Ota D6/675.3
 D711,305 S 8/2014 Pirie et al.
 D731,396 S 6/2015 Pirie et al.
 D731,950 S 6/2015 Fissette et al.
 D746,618 S * 1/2016 Clark D6/675.3
 D753,422 S * 4/2016 Snider D6/675.3
 D785,980 S * 5/2017 Brown D6/675.3
 2001/0050519 A1 * 12/2001 Kasuya B64D 11/04
 312/315
 2006/0145002 A1 * 7/2006 Van Loon A47B 51/00
 244/118.1
 2007/0236116 A1 * 10/2007 Sweet E05D 13/14
 312/312
 2007/0241650 A1 * 10/2007 Schmitt A47B 51/00
 312/312
 2014/0175962 A1 * 6/2014 Hollenstein A47B 51/00
 312/319.5

2014/0203693 A1 * 7/2014 Wisniewski A47B 46/005
 312/249.8
 2014/0238064 A1 8/2014 Hawkins et al.
 2015/0232183 A1 8/2015 Godecker et al.

OTHER PUBLICATIONS

Coaster Home Furnishings 2 Shelf End Table Glossy White. by Coaster Home Furnishings. earliest review dated Jun. 23, 2017. found online [Apr. 2, 2019] https://www.amazon.com/Coaster-Home-Furnishings-2-Shelf-Glossy/dp/B00R8JY8W2/ref=pd_day0_hl_0_2/133-8889599-4121147?_encoding=UTF8&pd_rd_i=B00R8JY8W2&pd_rd_r=fd0e596c-.
 Coffee Table with 2-shelf White and Clear. by Coaster Home Furnishings. earliest review dated Sep. 7, 2016. found online [Apr. 2, 2019] https://www.amazon.com/Coffee-Table-2-shelf-White-Clear/dp/B00R8JY9N0/ref=cm_cr_arp_d_product_top?ie=UTF8.
 Winsome Cube Display Shelves 126 Cube Display. by nobailout. dated Feb. 9, 2018. found online [Apr. 2, 2019] <http://www.nobailout.org/shelving-home-gallery>.
 Lounge Cube Shelves. Set of 4 Retro Design Lounge Cube Shelves in White in Different Sizes with Round Corners by ts-ideen on Amazon UK. dated Oct. 23, 2013. found online. [Aug. 25, 2016] <https://www.amazon.co.uk/Design-Lounge-Shelves-Different-Corners/dp/B00BUPW3A4>.

* cited by examiner

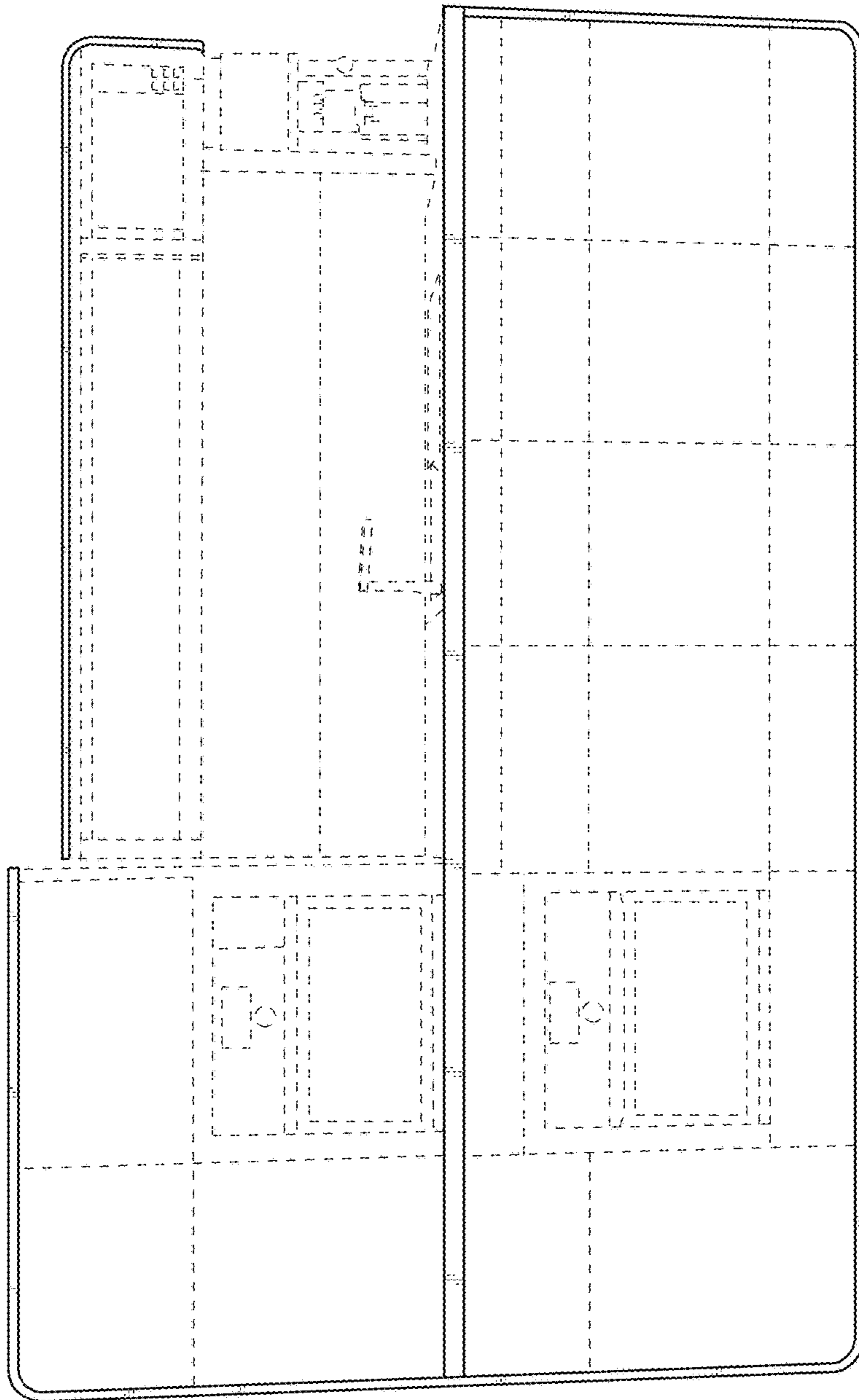

FIG. 1

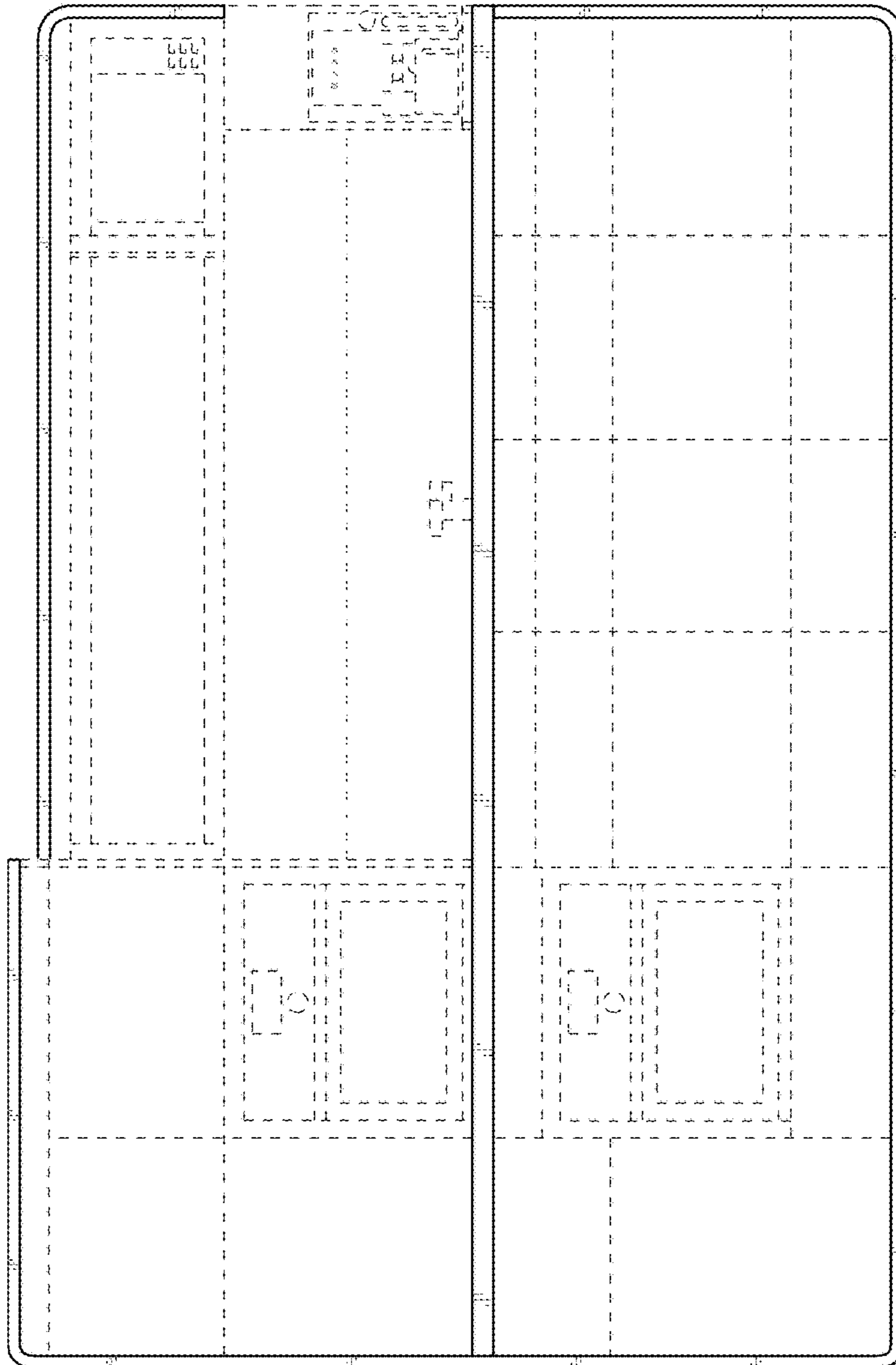

FIG. 2

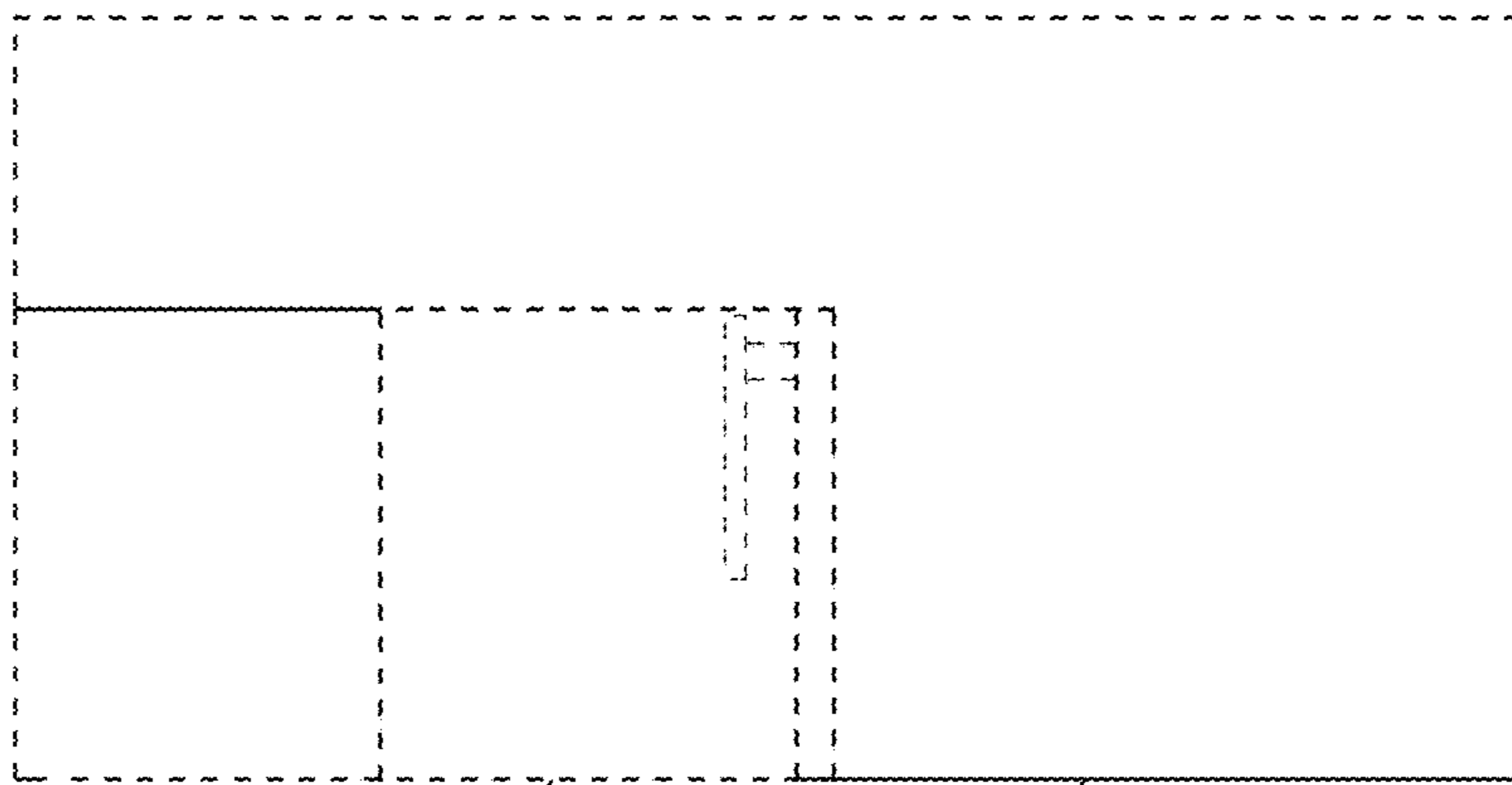

FIG. 3

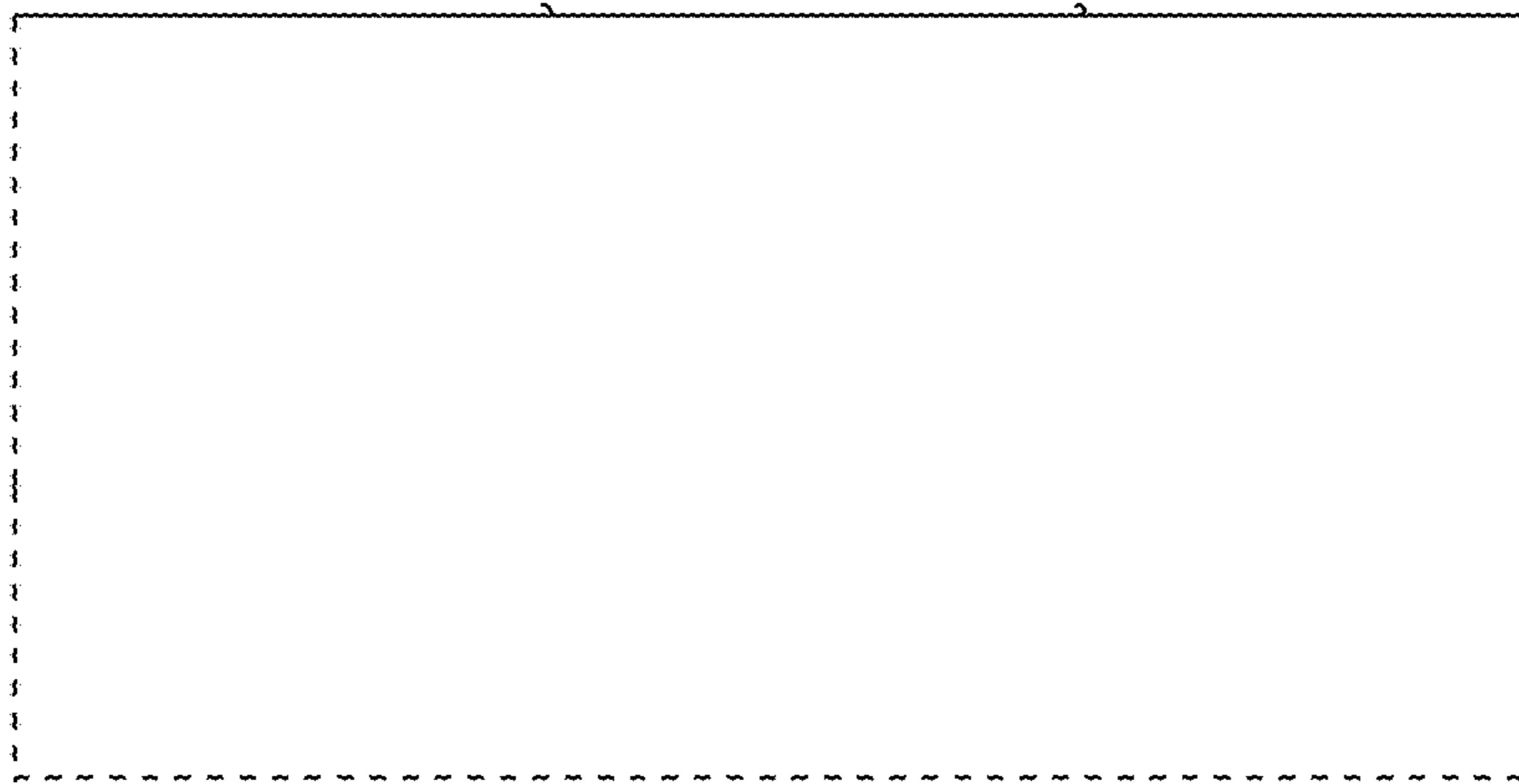

FIG. 4

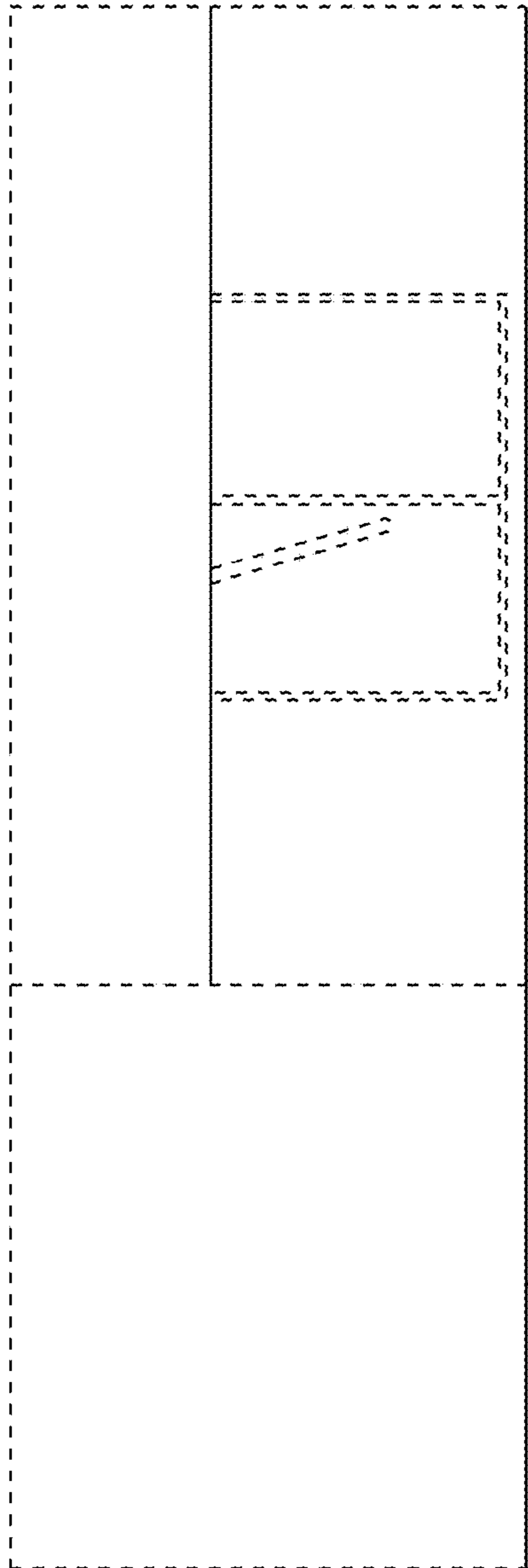

FIG. 5

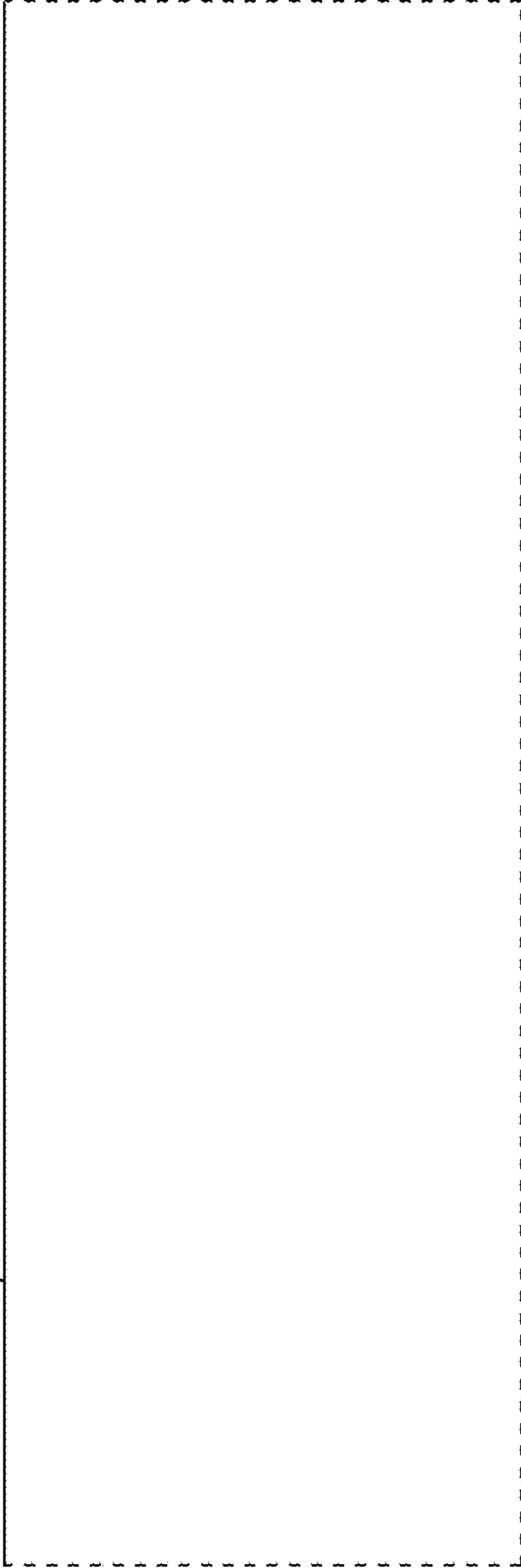

FIG. 6

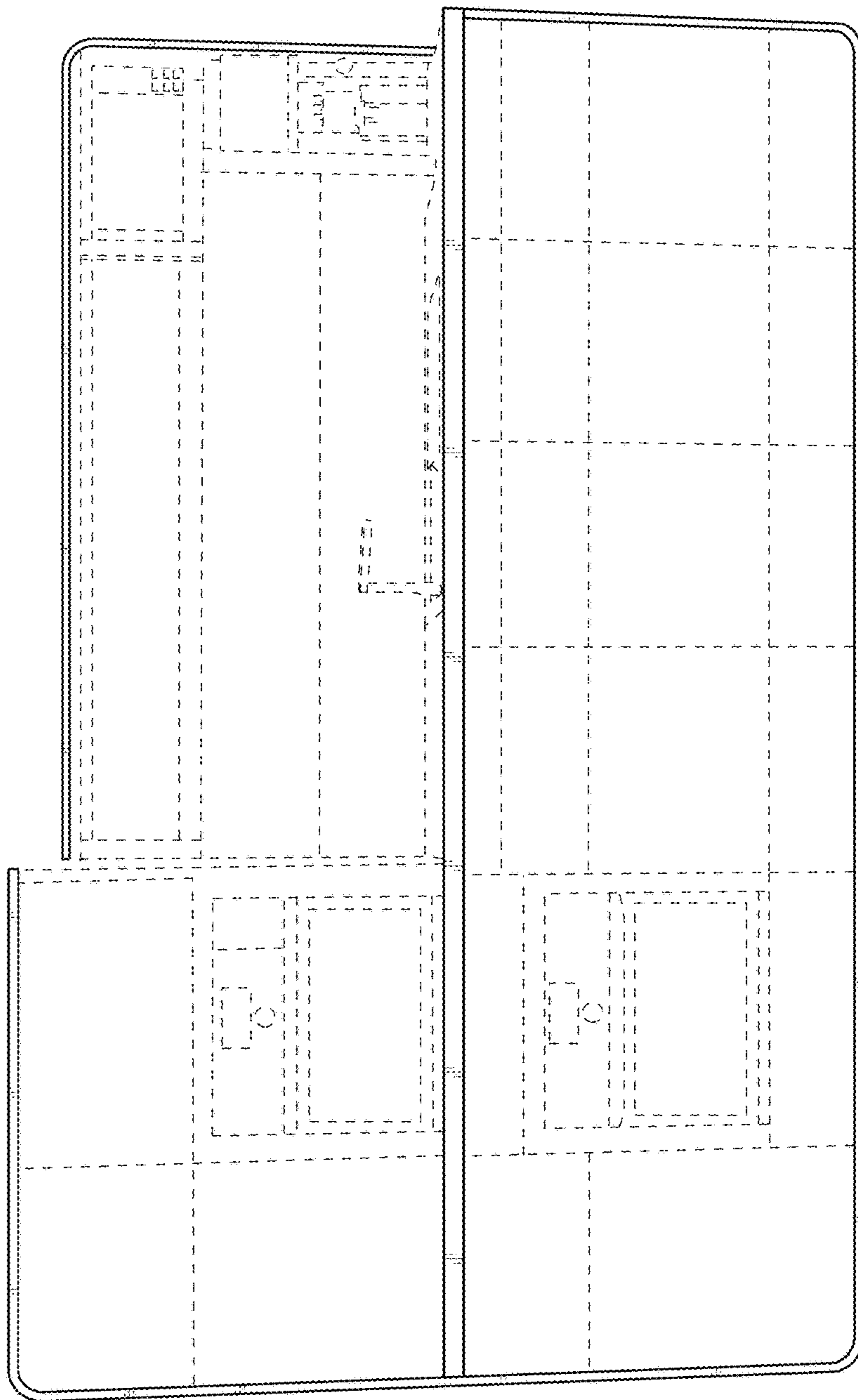

FIG. 7

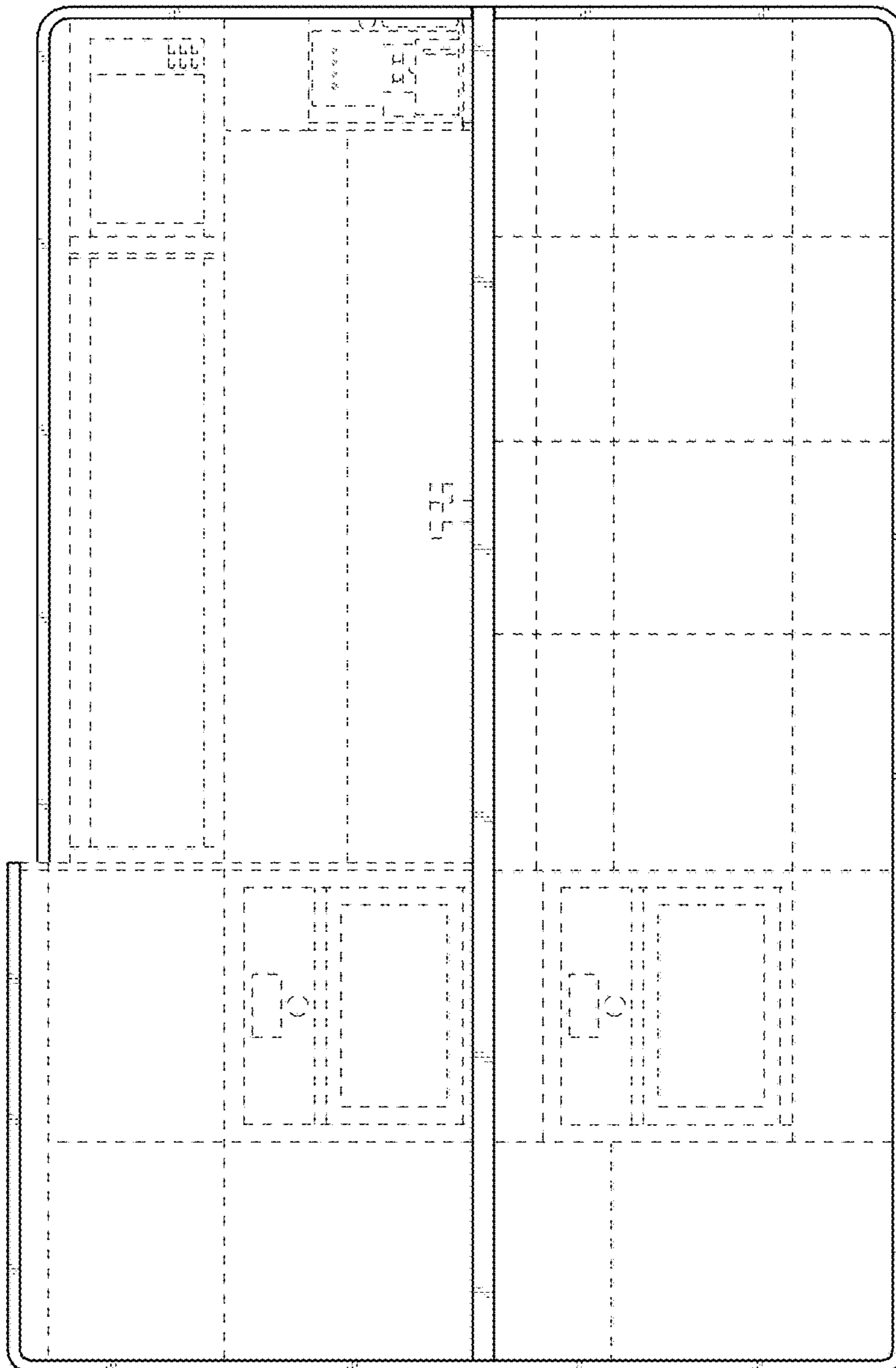

FIG. 8

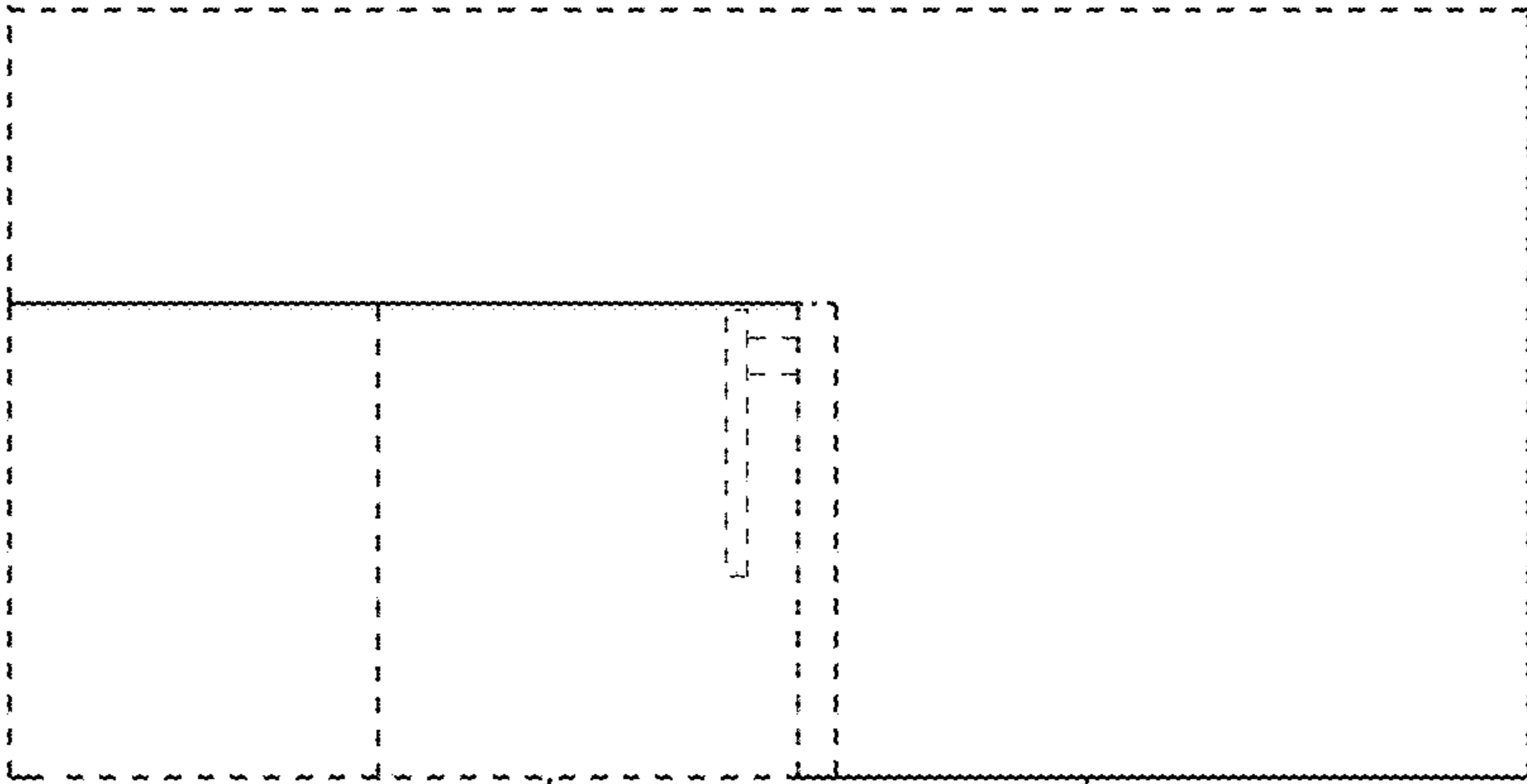

FIG. 9



FIG. 10

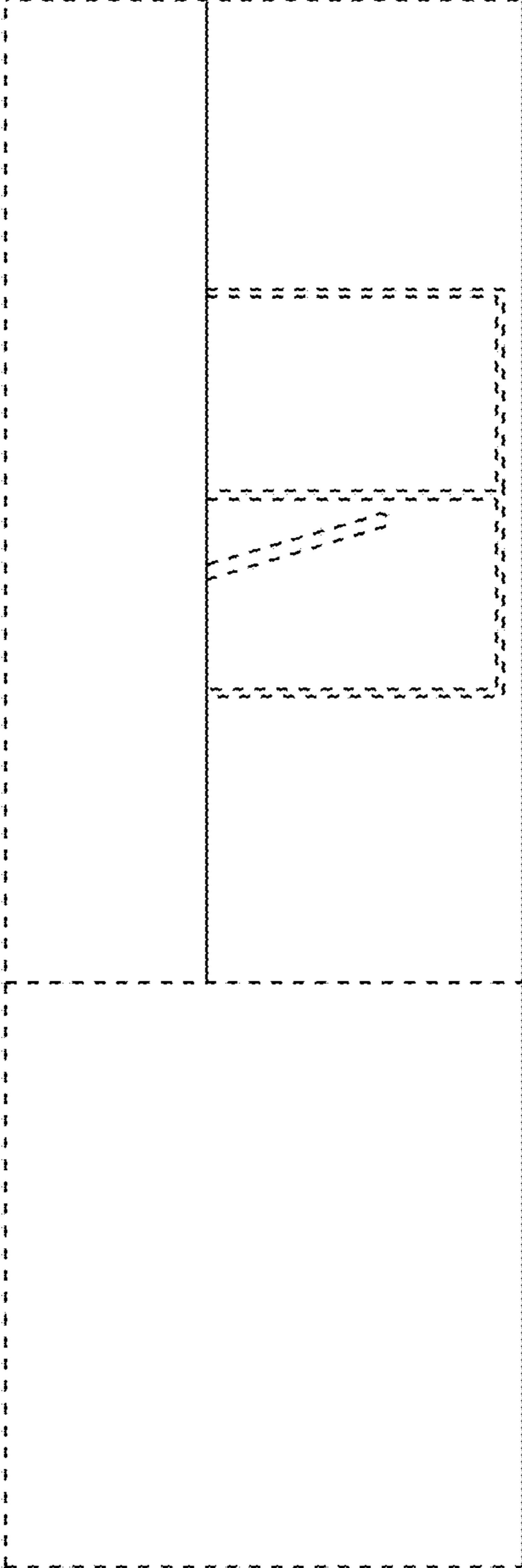

FIG. 11

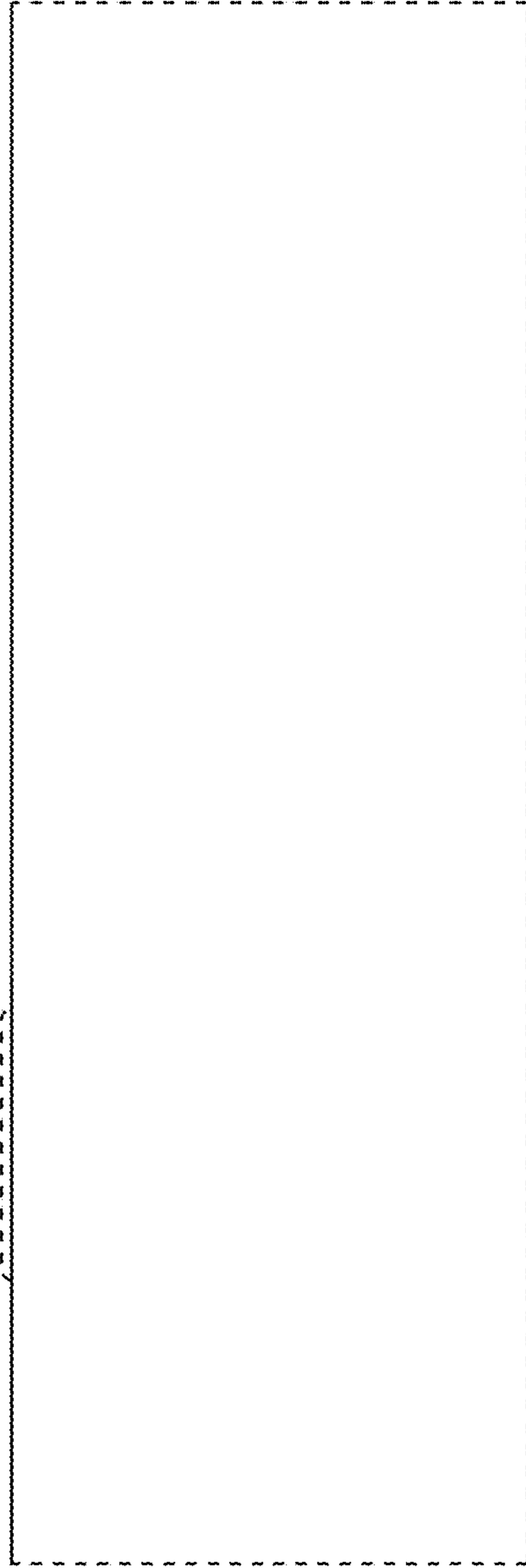

FIG. 12