



US00D859429S

(12) **United States Design Patent**  
**Kim et al.**

(10) **Patent No.:** **US D859,429 S**

(45) **Date of Patent:** **\*\* Sep. 10, 2019**

(54) **DISPLAY SCREEN OR PORTION THEREOF WITH TRANSITIONAL GRAPHICAL USER INTERFACE**

D701,503 S \* 3/2014 Akana ..... D14/341  
D715,831 S 10/2014 Kim  
D738,903 S \* 9/2015 Lee ..... D14/485  
D750,118 S \* 2/2016 Shoji ..... D14/486

(Continued)

(71) Applicant: **Samsung Electronics Co., Ltd.**,  
Suwon-si (KR)

**FOREIGN PATENT DOCUMENTS**

(72) Inventors: **Kyung-Jin Kim**, Seoul (KR); **Mi-Ra Yu**, Seoul (KR); **Jean-Christophe Naour**, Ahnyang-si (KR); **Woo-Seok Hwang**, Seoul (KR)

CN 2014301288939 2/2015  
CN 2014301289630 2/2015

(Continued)

(73) Assignee: **Samsung Electronics Co., Ltd.**,  
Suwon-si (KR)

*Primary Examiner* — Robin V Webster  
*Assistant Examiner* — Rachel A Voorhies  
(74) *Attorney, Agent, or Firm* — NSIP Law

(\*\*) Term: **15 Years**

(57) **CLAIM**

We claim the ornamental design for a display screen or portion thereof with transitional graphical user interface, as shown and described.

(21) Appl. No.: **29/637,698**

(22) Filed: **Feb. 21, 2018**

**DESCRIPTION**

(30) **Foreign Application Priority Data**

Aug. 30, 2017 (KR) ..... 30-2017-0040526

(51) **LOC (12) Cl.** ..... **14-04**

(52) **U.S. Cl.**  
USPC ..... **D14/485**

(58) **Field of Classification Search**  
USPC ..... D14/485-489  
CPC ..... H04L 12/581; H04L 12/1813; G06F 19/3406; G06F 17/30873; G06F 3/0481; A61B 5/02; H04N 21/478; G06Q 10/10; G06Q 10/107  
See application file for complete search history.

FIG. 1 is a first image of a display screen or portion thereof with transitional graphical user interface showing our new design;

FIG. 2 is a second image thereof;

FIG. 3 is a third image thereof;

FIG. 4 is a fourth image thereof;

FIG. 5 is a fifth image thereof;

FIG. 6 is a sixth image thereof; and,

FIG. 7 is a seventh image thereof.

The outer perimeter shown in a pair of dashed broken lines in the drawings represents a display screen or portion thereof and forms no part of the claimed design. The remaining dashed broken lines in the drawings illustrate portions of the transitional graphical user interface that form no part of the claimed design.

The appearance of the transitional image sequentially transitions between the images shown in FIGS. 1 through 7. The process or period in which one image transitions to another image forms no part of the claimed design.

(56) **References Cited**

**U.S. PATENT DOCUMENTS**

6,628,310 B1 \* 9/2003 Hiura ..... G06F 3/0481  
715/776  
D654,504 S \* 2/2012 Pearson ..... D14/486

**1 Claim, 7 Drawing Sheets**

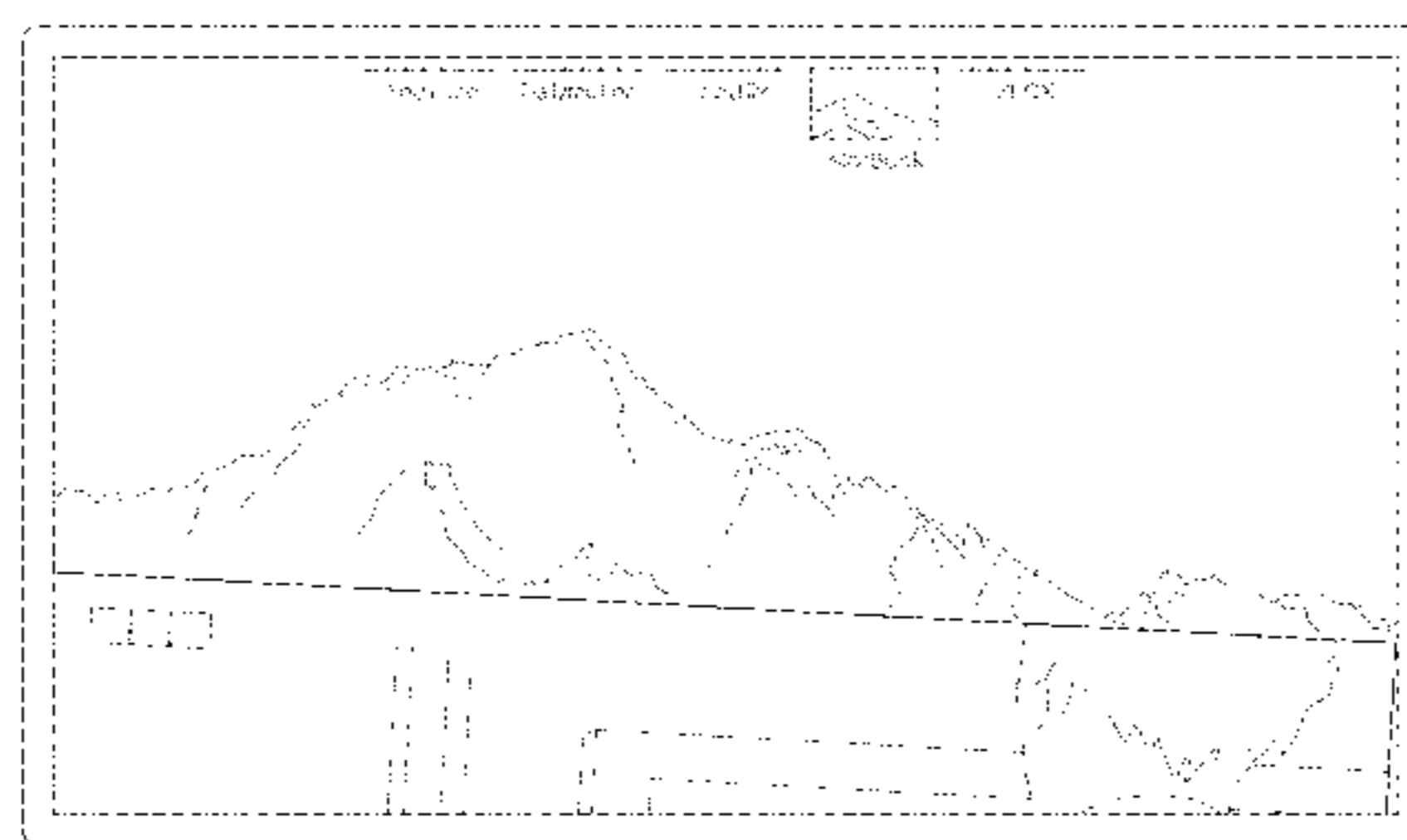
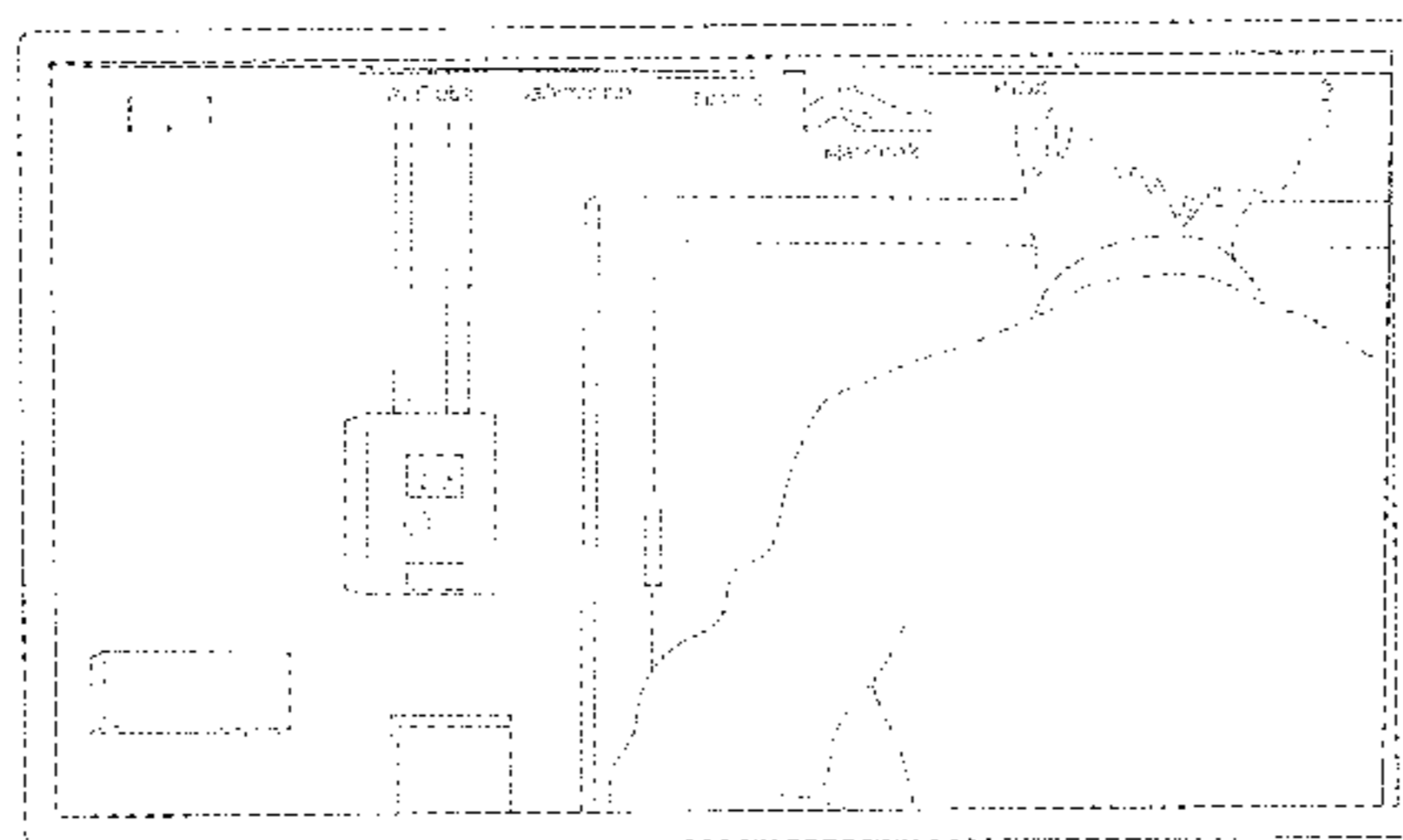

(56)

**References Cited**

U.S. PATENT DOCUMENTS

D755,814	S *	5/2016	Rad .....	D14/486
D781,334	S *	3/2017	Rad .....	D14/486
D797,767	S *	9/2017	Esselstrom .....	D14/485
D800,755	S *	10/2017	De Cock .....	D14/486
D802,615	S *	11/2017	Zhao .....	D14/486
D803,869	S *	11/2017	Kuhn .....	D14/488
D806,740	S *	1/2018	Sutherland .....	D14/488
D808,406	S *	1/2018	Lee .....	D14/486
D813,890	S *	3/2018	Pitman .....	D14/486
D815,129	S *	4/2018	Phillips .....	D14/486
D815,666	S *	4/2018	Burns .....	D14/488
D821,412	S *	6/2018	Diament .....	G03B 17/54
				D14/485
D828,850	S *	9/2018	Smith .....	D14/486
D830,395	S *	10/2018	Phillips .....	D14/486
2017/0031530	A1 *	2/2017	Ikeda .....	G03B 17/54
2018/0240213	A1 *	8/2018	Izumi .....	G06F 3/04845

FOREIGN PATENT DOCUMENTS

CN	2014305022559	11/2015
KR	30-2012-0001040	9/2014

\* cited by examiner

FIG. 1

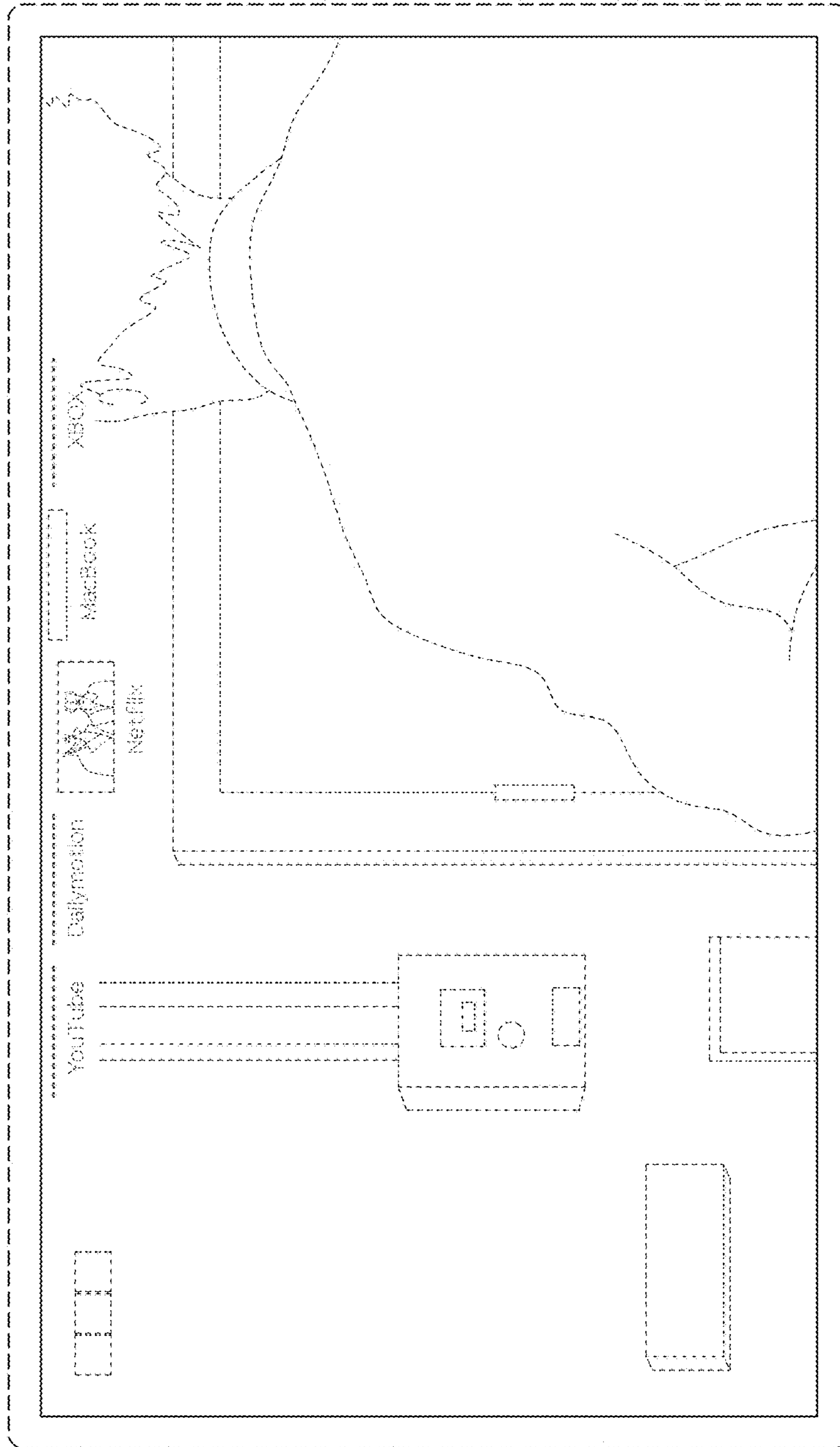

FIG. 2

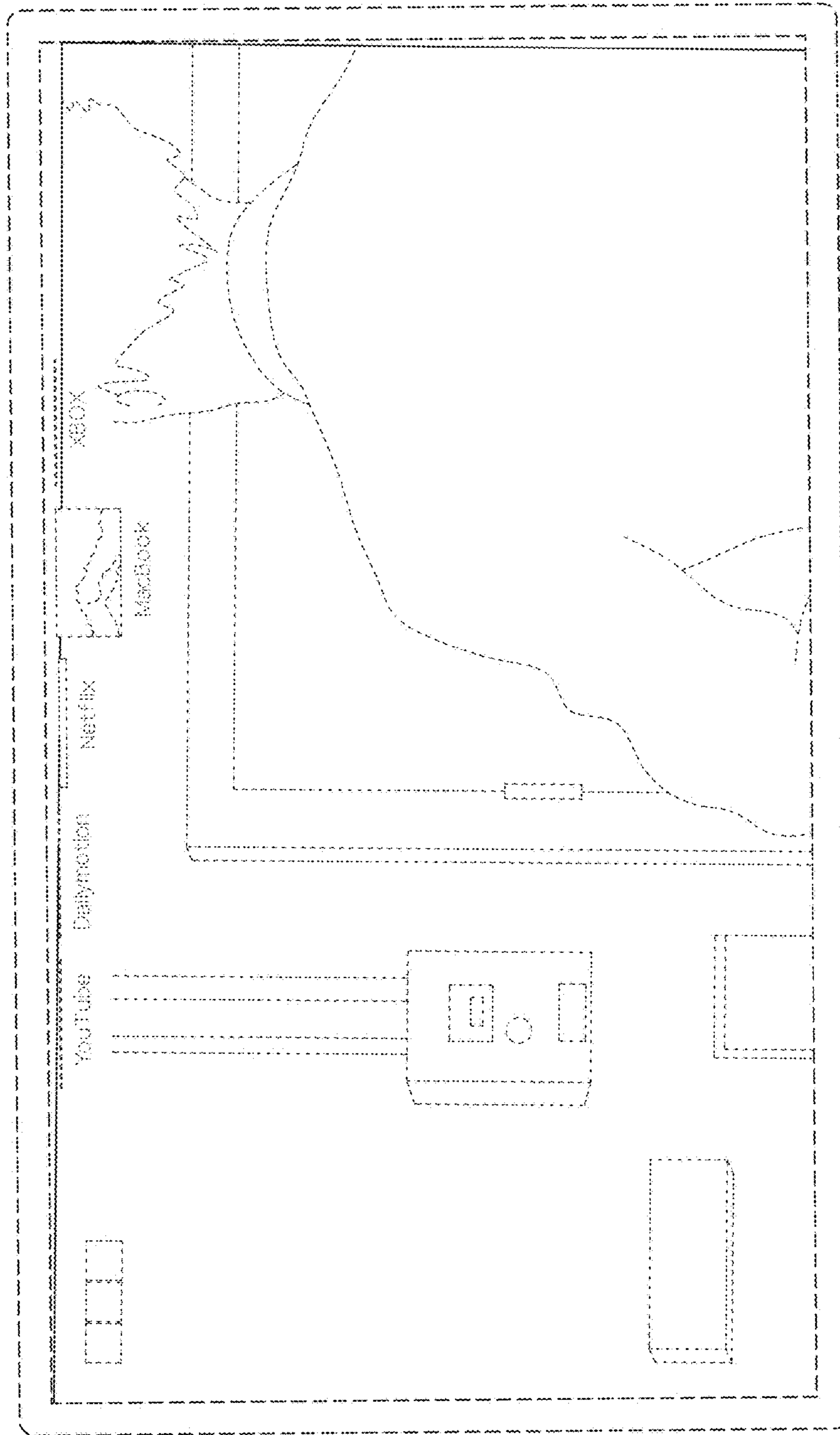

FIG. 3

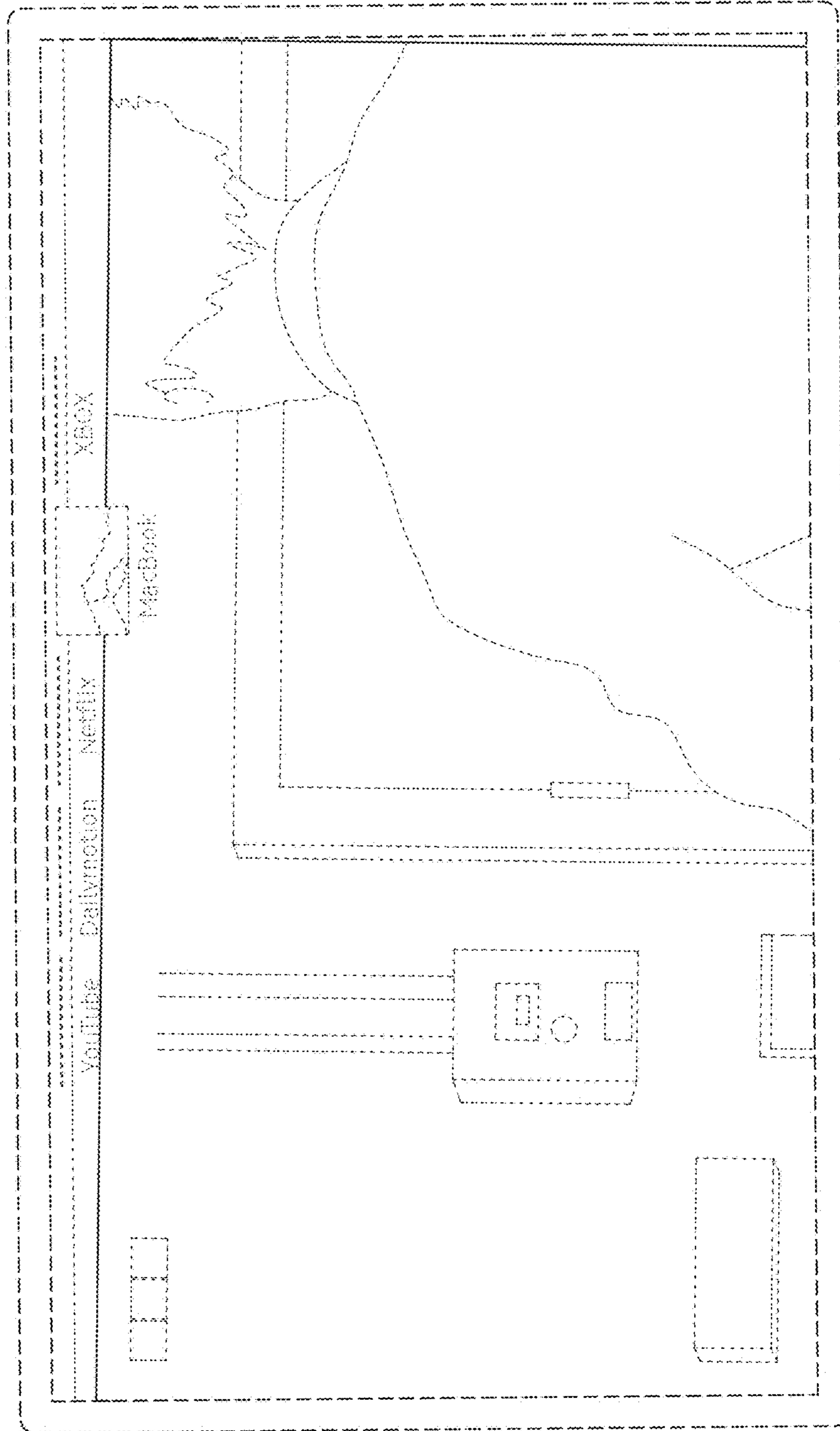

FIG. 4

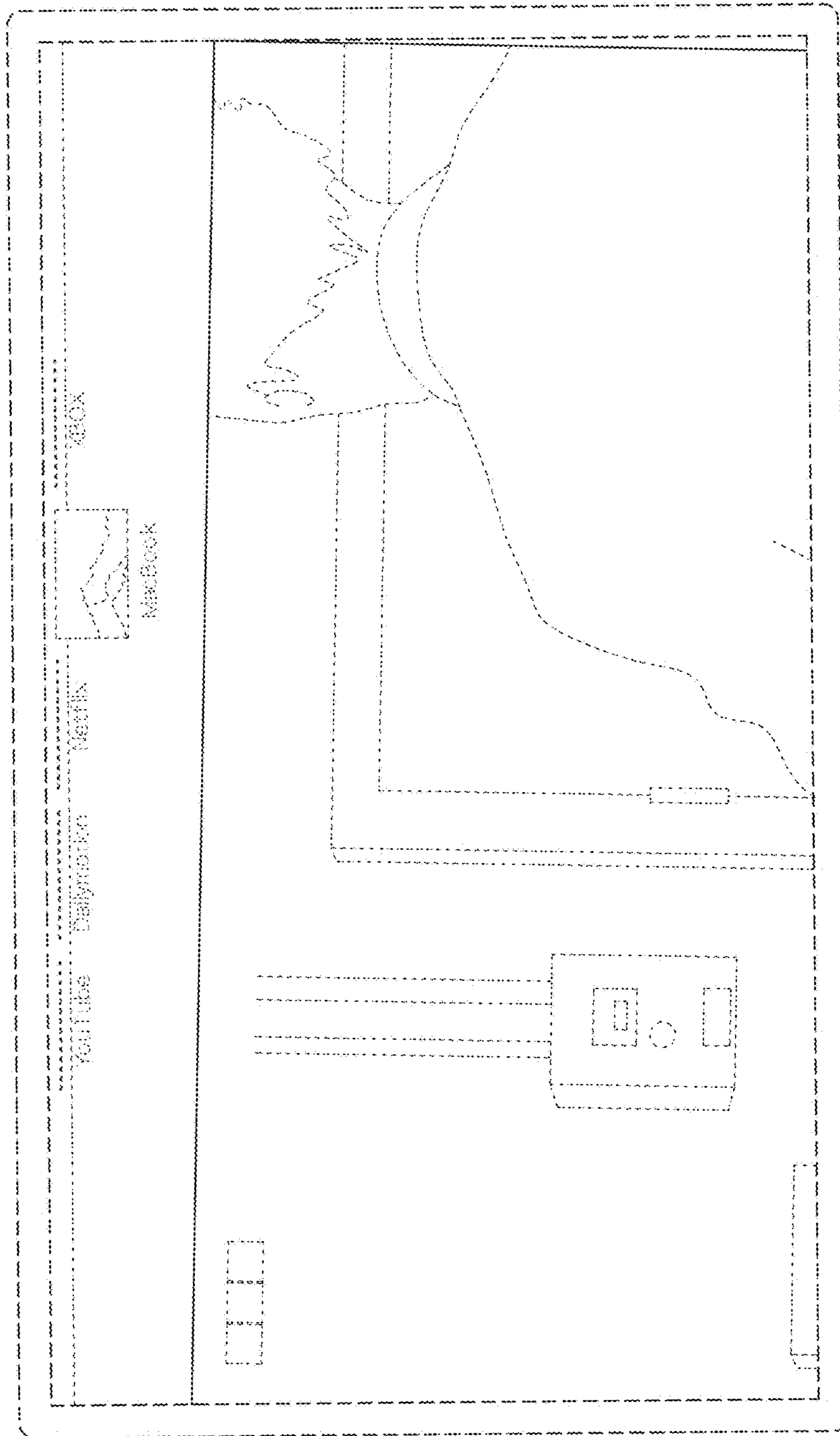

FIG. 5

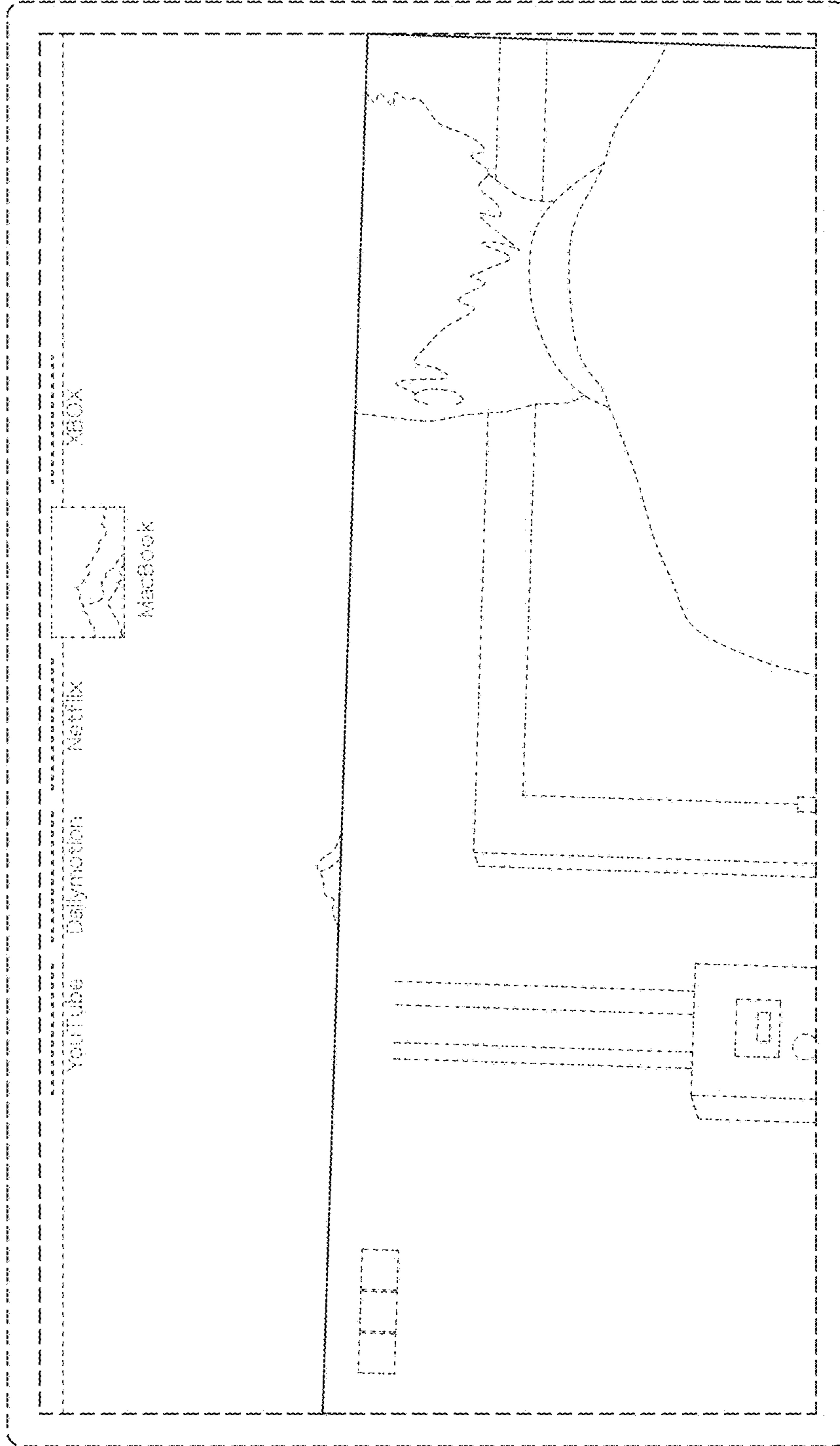

FIG. 6

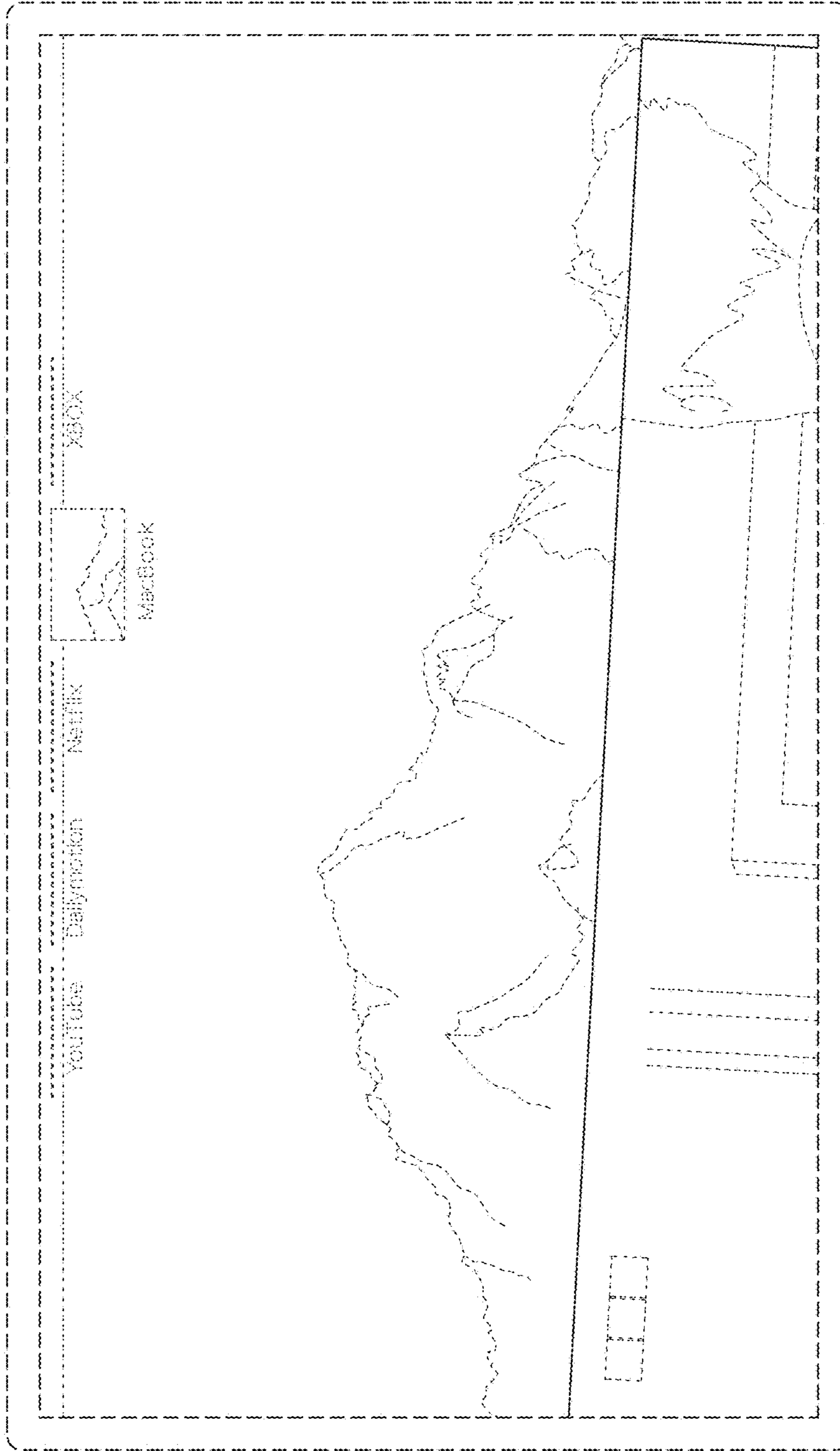



FIG. 7

