



US00D858796S

(12) **United States Design Patent** (10) **Patent No.:** **US D858,796 S**
Martin et al. (45) **Date of Patent:** **** Sep. 3, 2019**

(54) **MODULAR COMPOSITE SHELTER SYSTEM**

Primary Examiner — Brett Miller

(71) Applicant: **Strategic Solutions Unlimited, Inc.**,
Fayetteville, NC (US)

(74) *Attorney, Agent, or Firm* — Dority & Manning, P.A.

(72) Inventors: **Tony Michael Martin**, Myrtle Beach,
SC (US); **Erik David Ross**,
Fayetteville, NC (US)

(57) **CLAIM**

The ornamental design for a modular composite shelter system, as shown and described.

(73) Assignee: **Strategic Solutions Unlimited, Inc.**,
Fayetteville, NC (US)

DESCRIPTION

(**) Term: **15 Years**

(21) Appl. No.: **29/580,149**

(22) Filed: **Oct. 6, 2016**

(51) **LOC (12) Cl.** **25-03**

(52) **U.S. Cl.**
USPC **D25/33**

(58) **Field of Classification Search**
USPC D25/1, 3-35, 55-59, 61; 52/79.1-79.9
CPC E04H 1/00-1277; E04H 1/14; E04H
3/00-04; E04H 2001/1283-1294; E04B
1/34823; E04B 1/3483; E04B 1/3444;
E04B 1/3431; E04B 1/343; E04B
1/34869

See application file for complete search history.

FIG. 1 is a front perspective view of a first example modular composite shelter system embodiment;
 FIG. 2 is a rear perspective view of a first example modular composite shelter system embodiment;
 FIG. 3 is a front plan view of a first example modular composite shelter system embodiment;
 FIG. 4 is a left side plan view of a first example modular composite shelter system embodiment;
 FIG. 5 is a right side plan view of a first example modular composite shelter system embodiment;
 FIG. 6 is a top plan view of a first example modular composite shelter system embodiment;
 FIG. 7 is a bottom plan view of a first example modular composite shelter system embodiment;
 FIG. 8 is a front perspective view of a second example modular composite shelter system embodiment;
 FIG. 9 is a rear perspective view of a second example modular composite shelter system embodiment;
 FIG. 10 is a front plan view of a second example modular composite shelter system embodiment;
 FIG. 11 is a left side plan view of a second example modular composite shelter system embodiment;
 FIG. 12 is a right side plan view of a second example modular composite shelter system embodiment;
 FIG. 13 is a top plan view of a second example modular composite shelter system embodiment; and,
 FIG. 14 is a bottom plan view of a second example modular composite shelter system embodiment.

The broken lines depict portions of the system that form no part of the claim.

(56) **References Cited**

U.S. PATENT DOCUMENTS

2,120,861	A *	6/1938	Hastings	E04H 15/34
					D25/33
2,647,287	A *	8/1953	Jones	E04B 1/34321
					D25/33
3,236,014	A	2/1966	Edgar		
3,992,828	A	11/1976	Ohe		
4,223,500	A	9/1980	Clark et al.		

(Continued)

OTHER PUBLICATIONS

Department of The Army, Appendix D (463L Cargo System), "United Air Movement Planning", Field Manual No. 55-9, Apr. 5, 1993, Washington, DC.

1 Claim, 14 Drawing Sheets

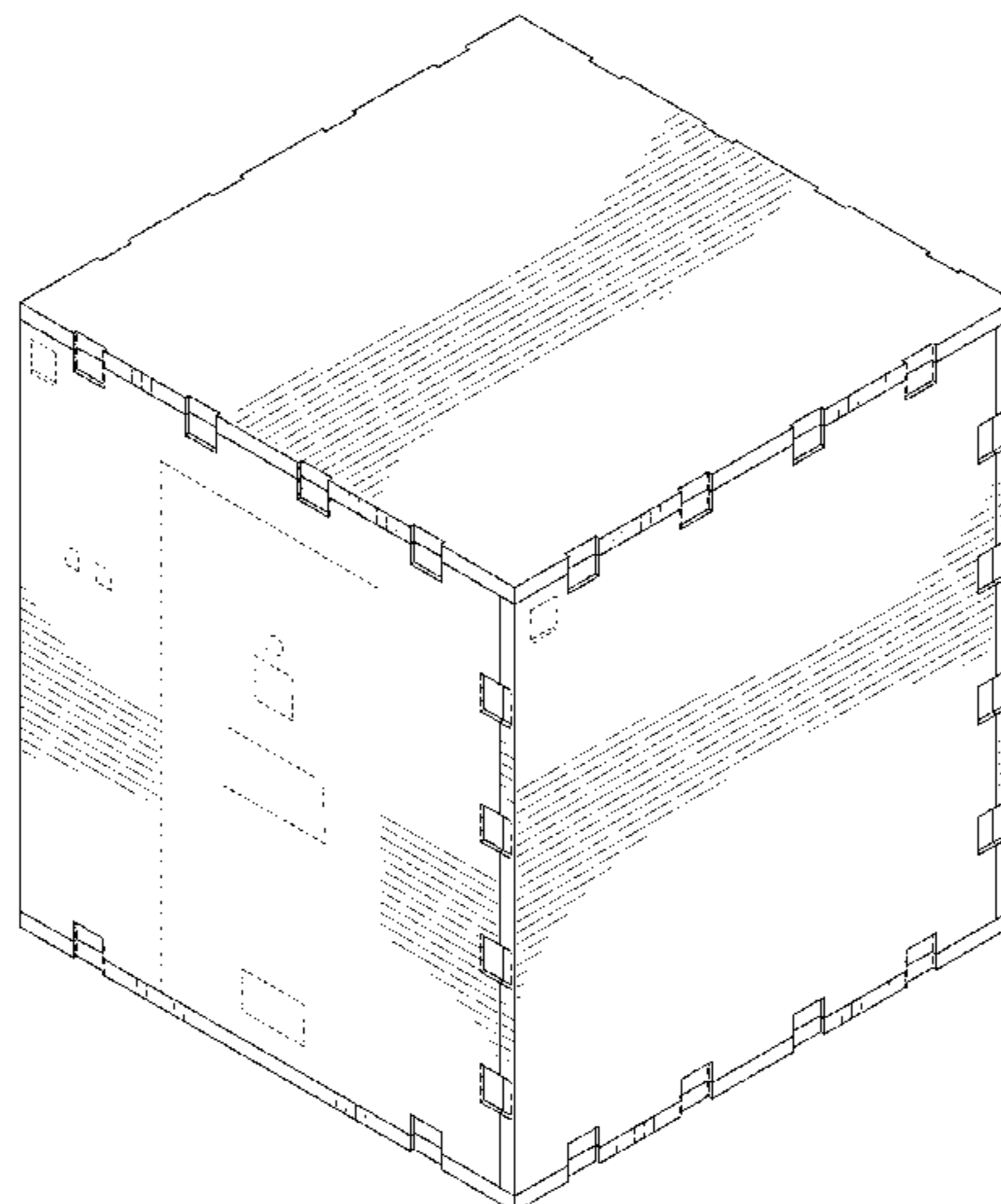

(56)

References Cited

U.S. PATENT DOCUMENTS

6,179,522 B1 1/2001 Sanford et al.
6,313,549 B1 11/2001 Moisan et al.
6,622,640 B2 9/2003 Taylor et al.
7,954,294 B2 6/2011 Appleford
D683,469 S * 5/2013 Yoder D25/32
D740,961 S * 10/2015 Hart D25/16
D742,030 S * 10/2015 Magiera D25/33
D771,272 S * 11/2016 Hart D25/1
2008/0263968 A1 10/2008 Day
2010/0043309 A1 2/2010 Martin et al.
2013/0067846 A1 * 3/2013 Kvols E04H 1/1205
52/586.1
2014/0123572 A1 * 5/2014 Segall E04H 1/1205
52/79.5
2017/0314255 A1 * 11/2017 Klein E04B 1/34357
2017/0356182 A1 * 12/2017 Caffaratti Giro E04H 1/12

* cited by examiner

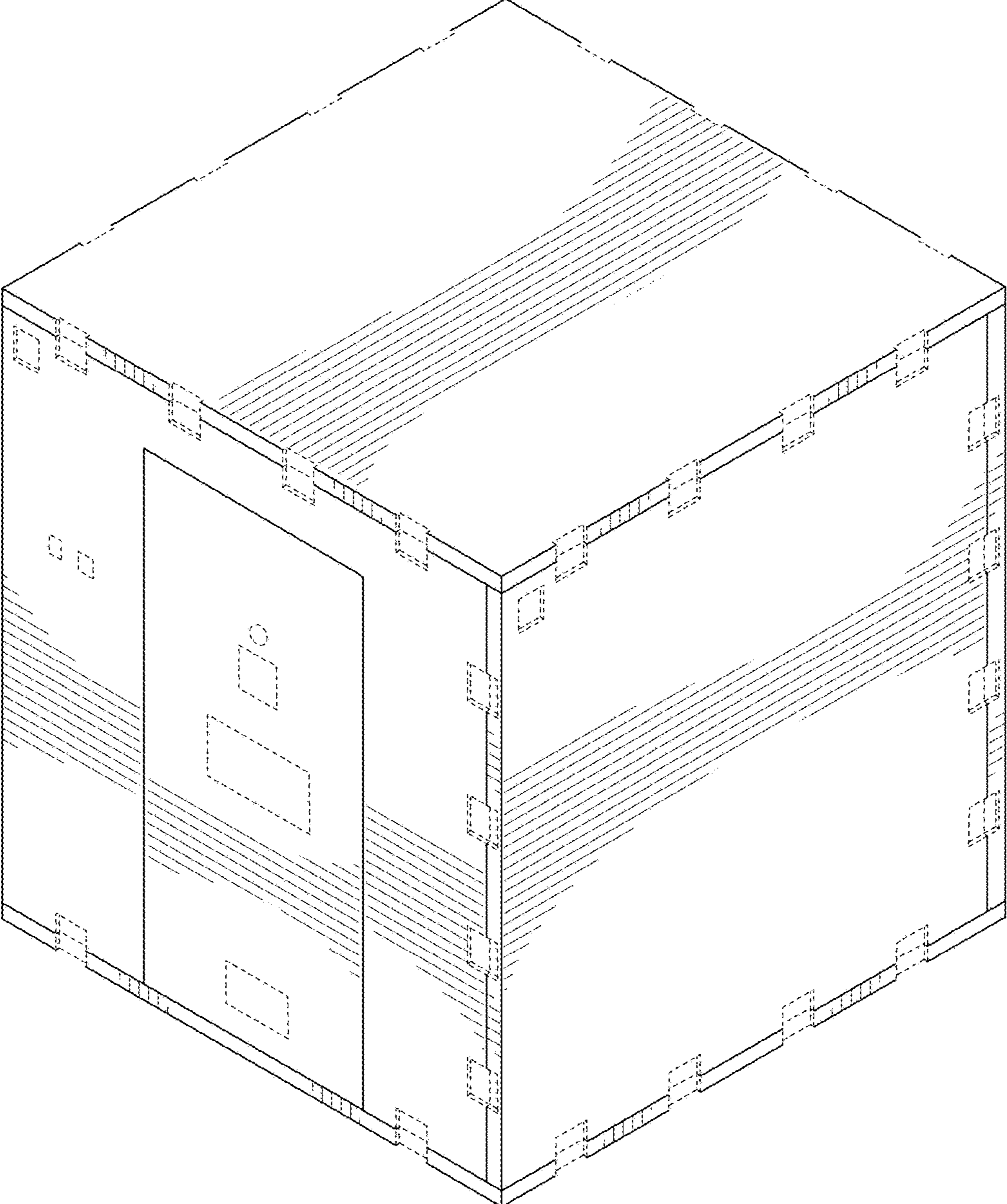

FIG. 1

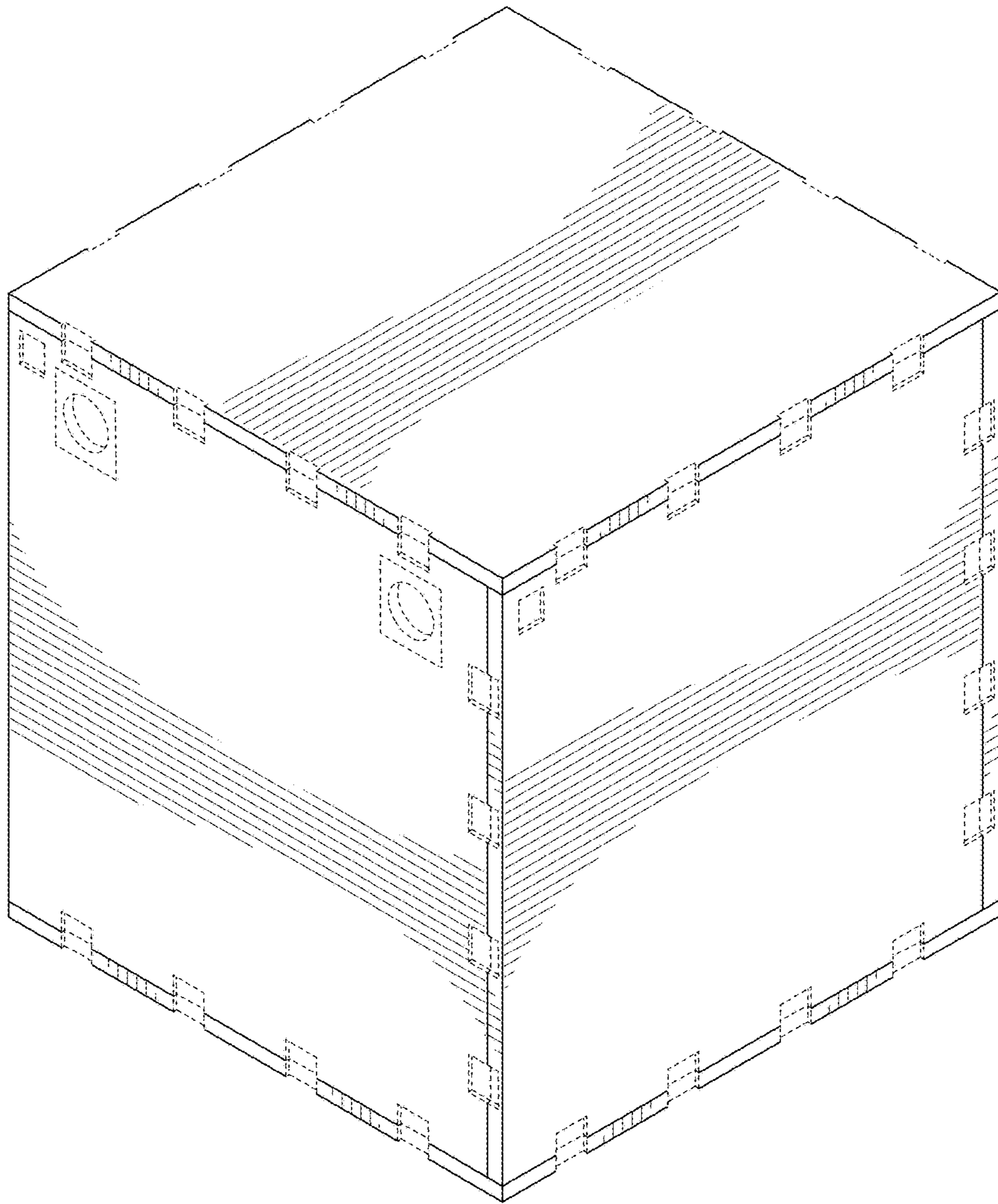

FIG. 2

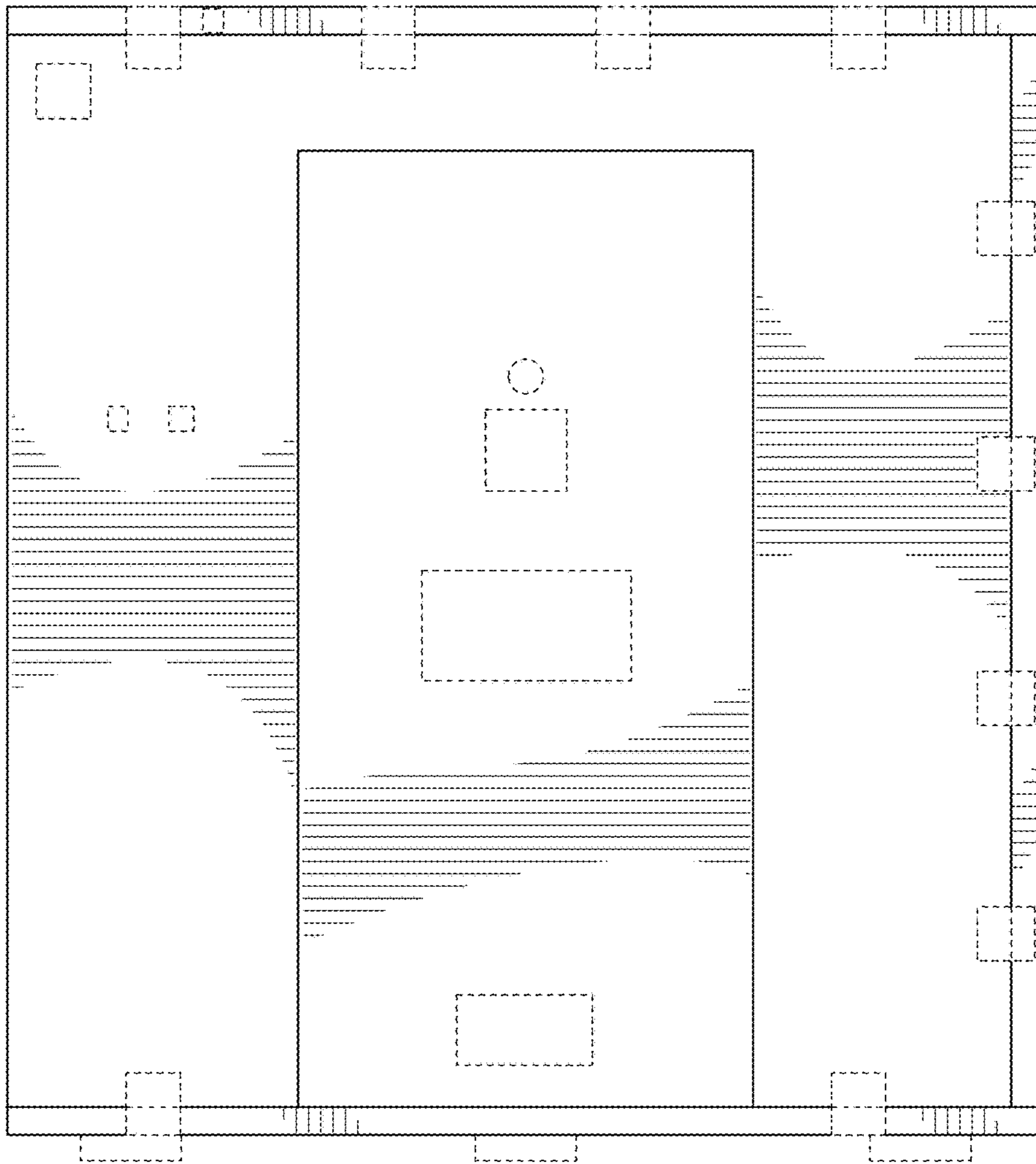

FIG. 3

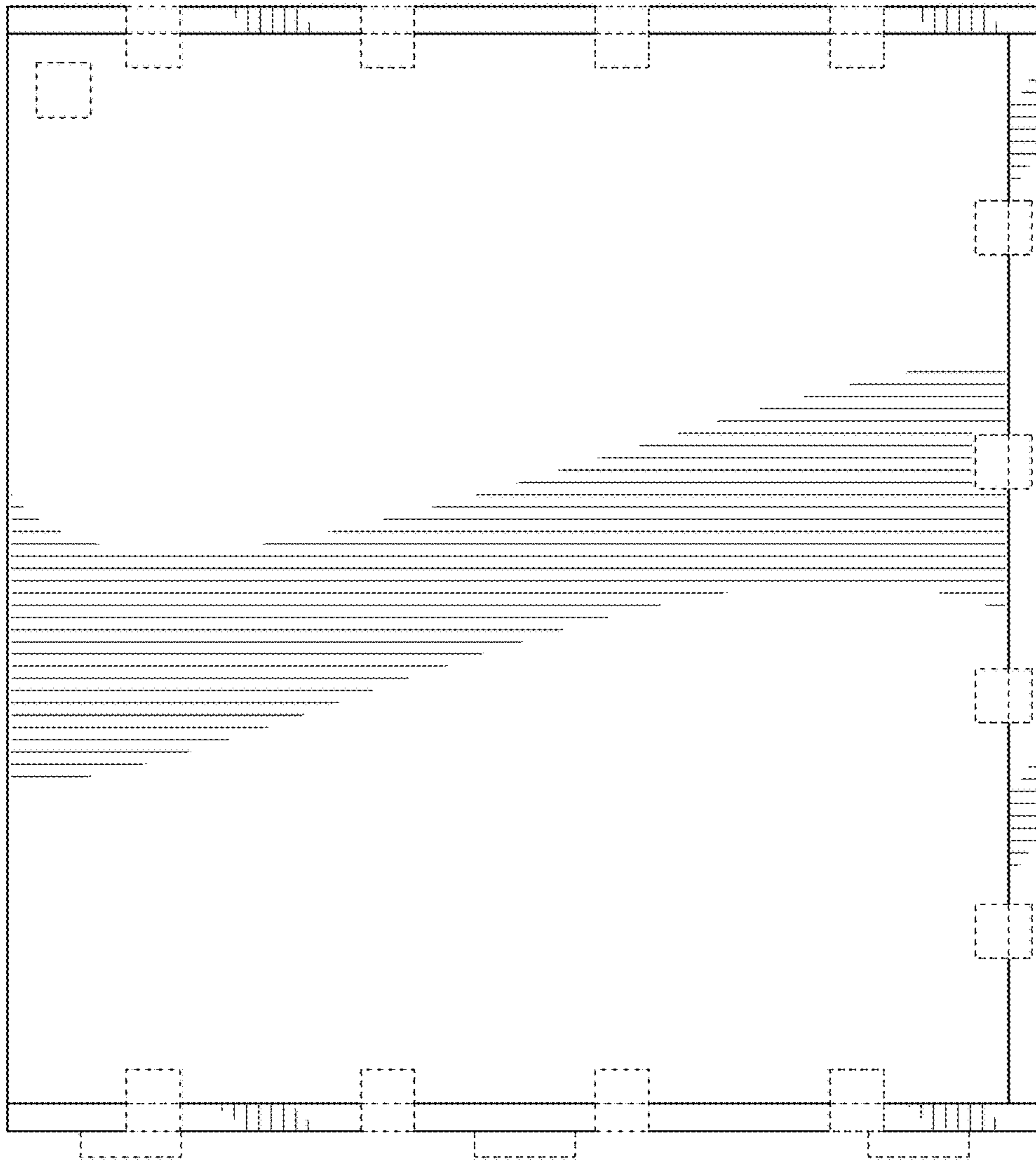

FIG. 4

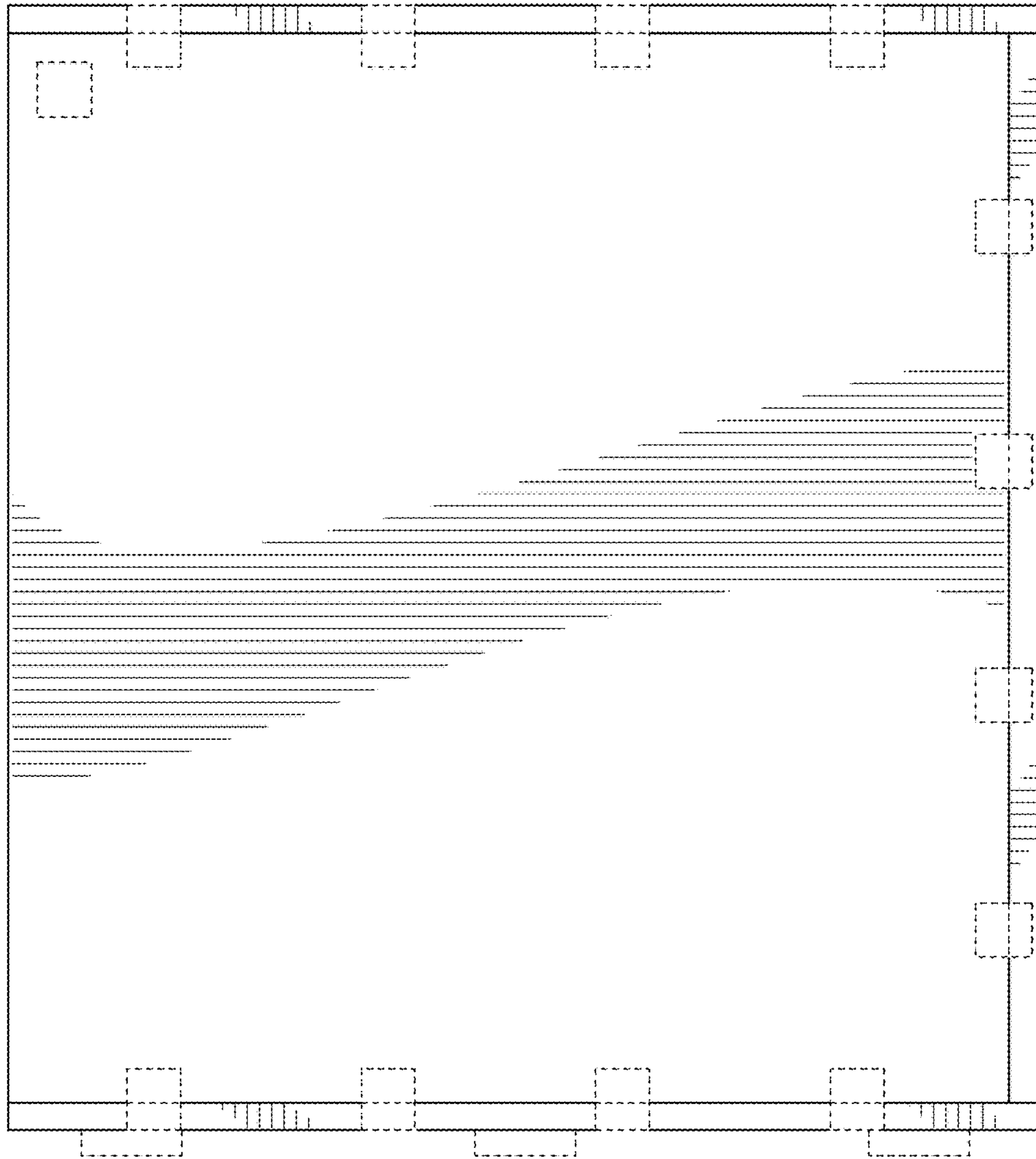

FIG. 5

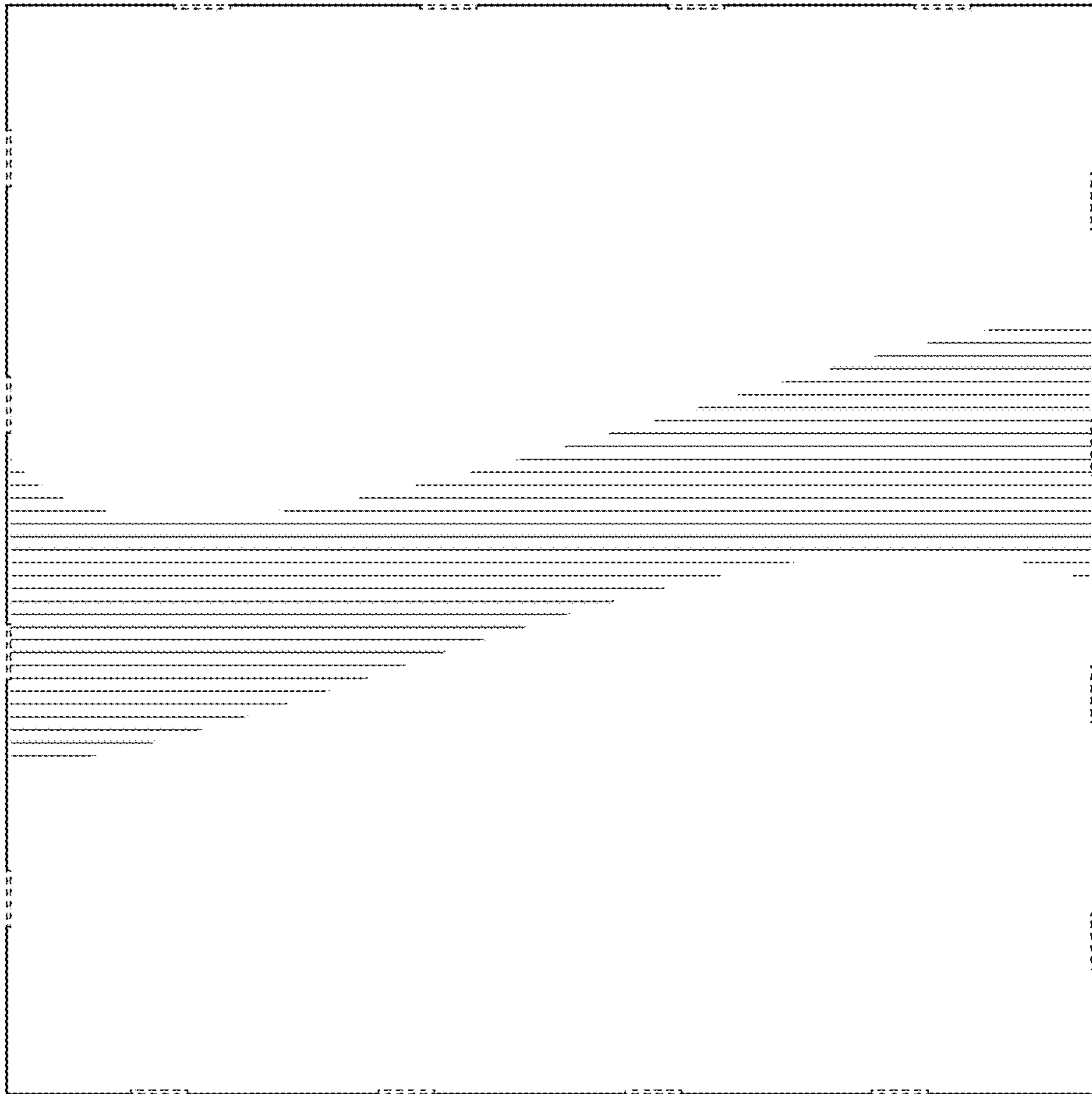

FIG. 6

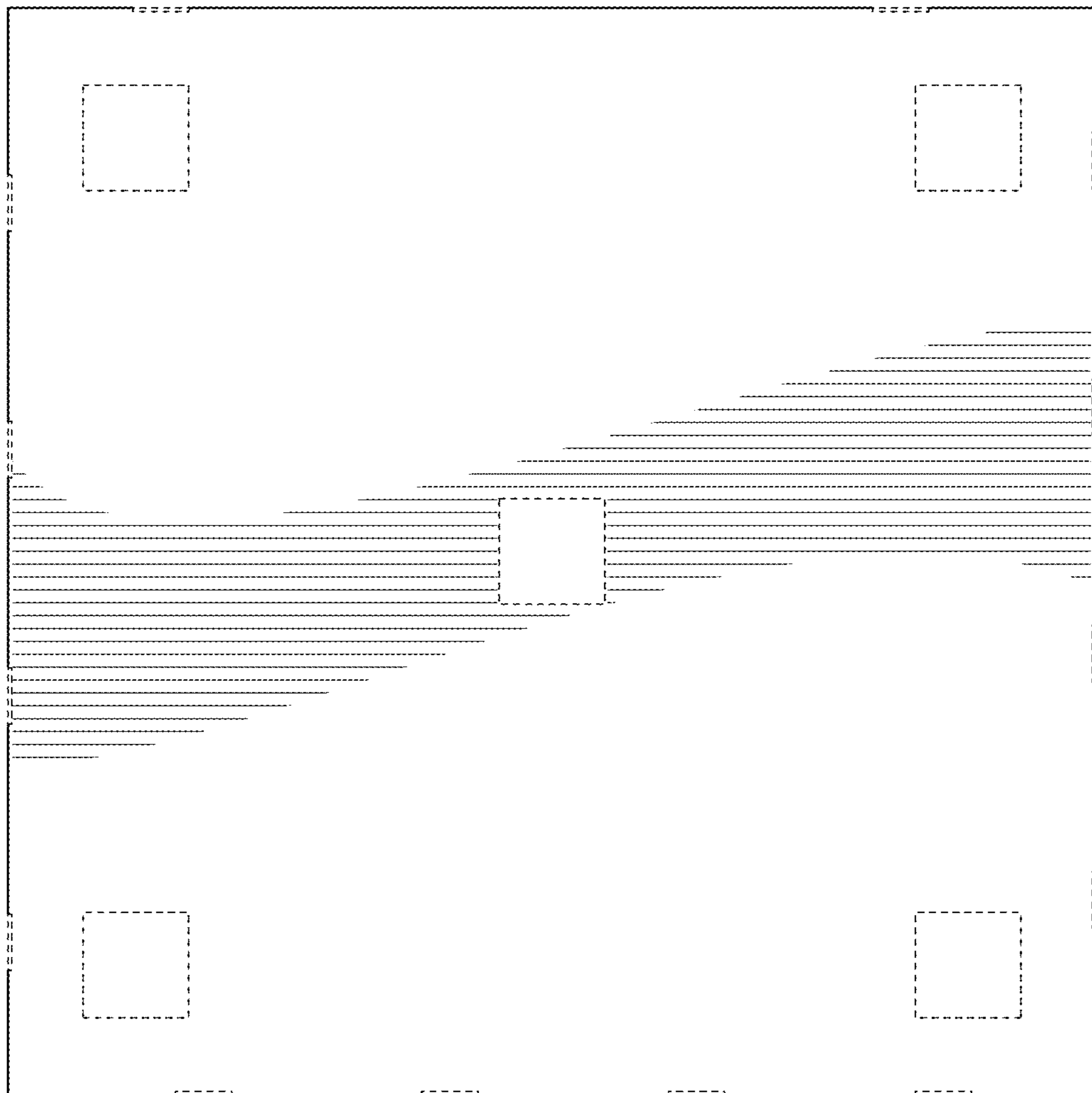

FIG. 7

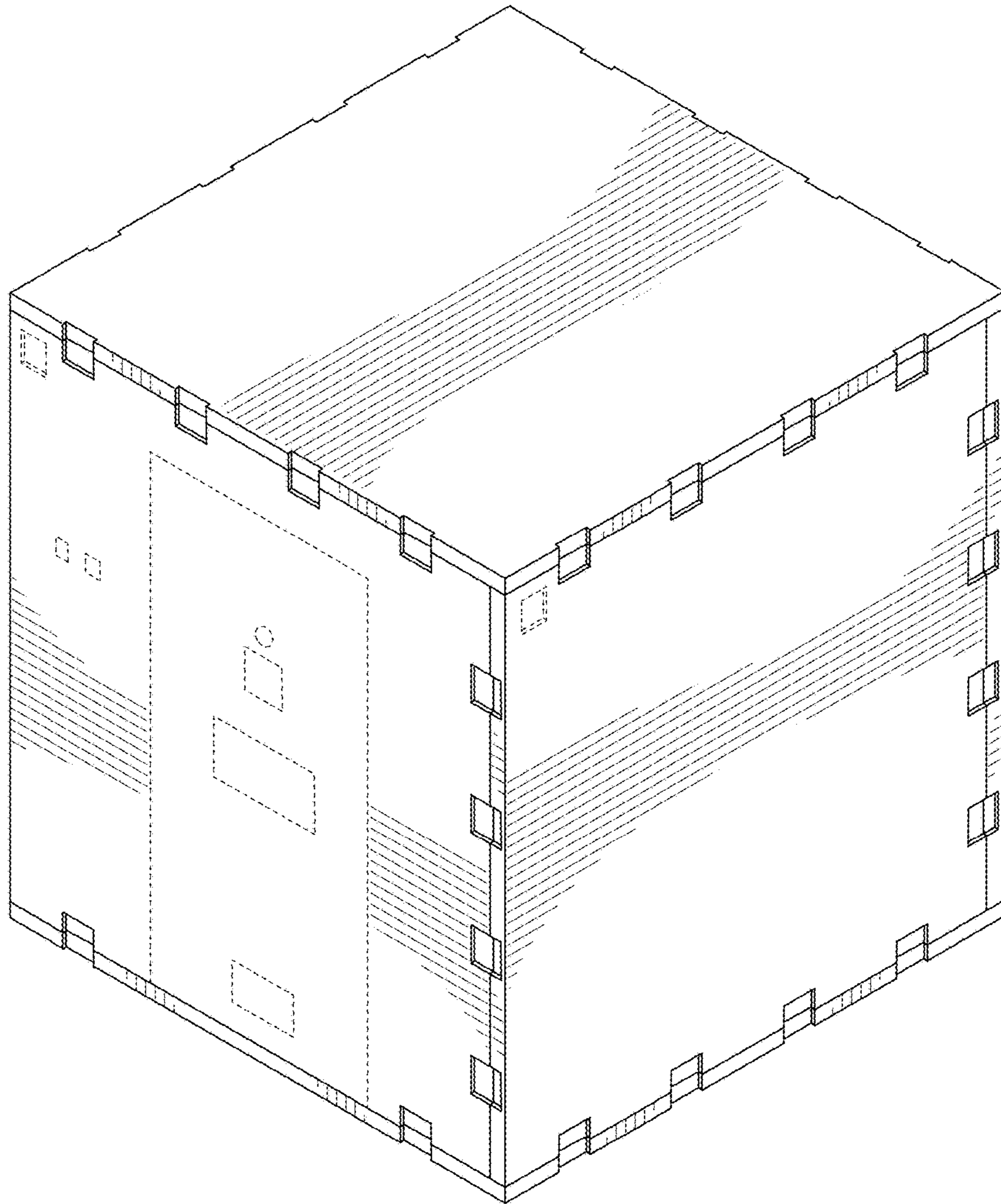

FIG. 8

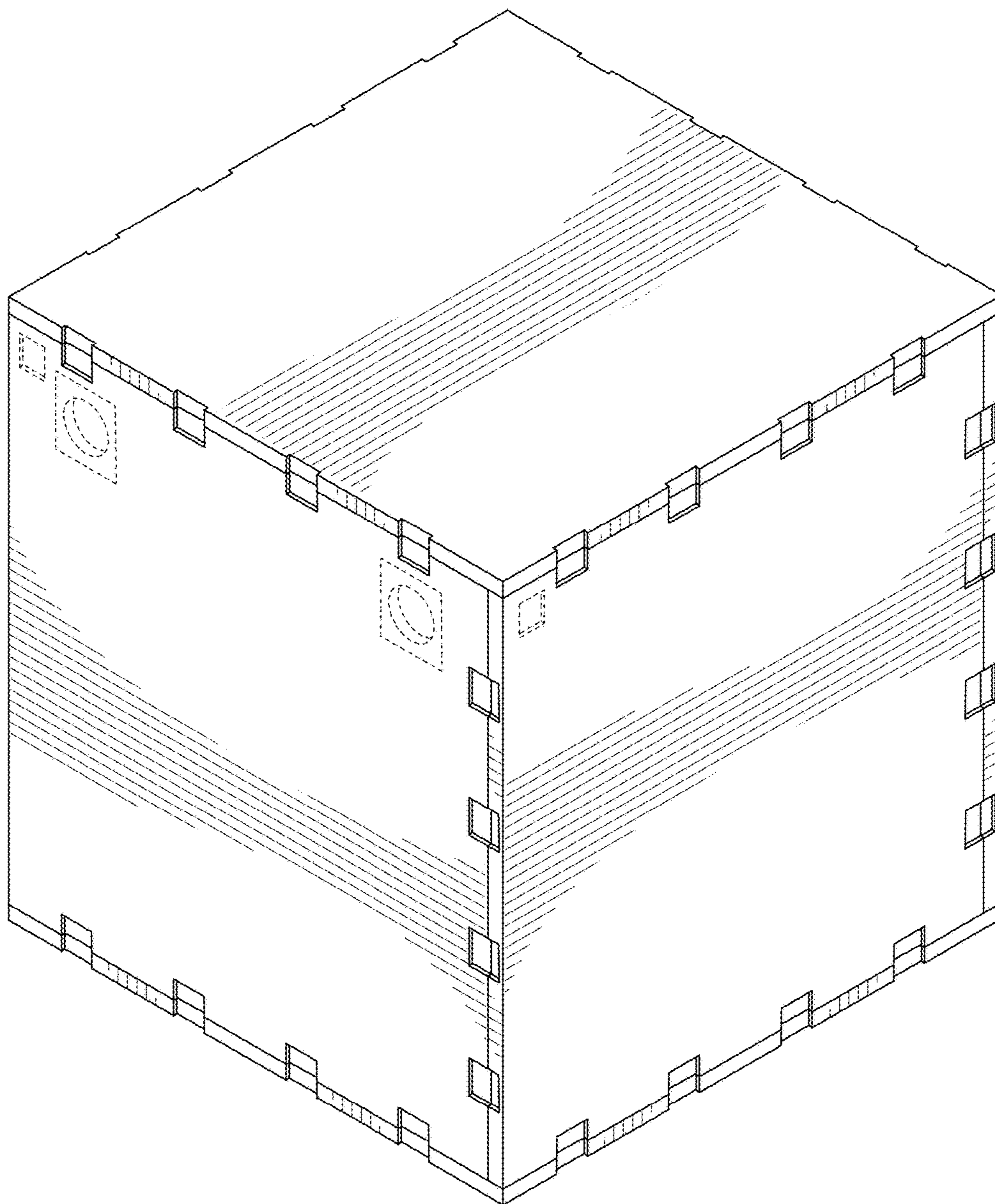

FIG. 9

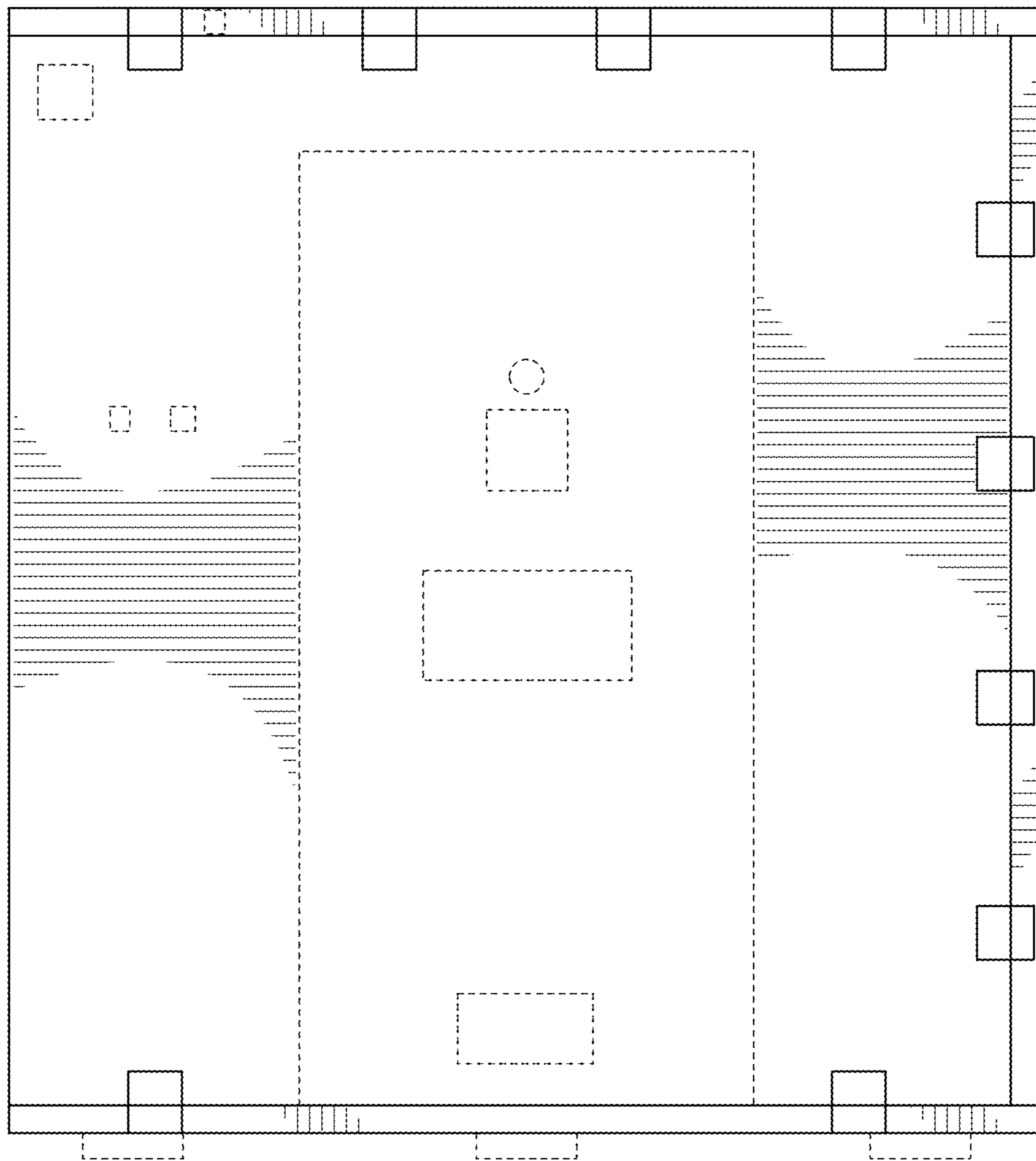

FIG. 10

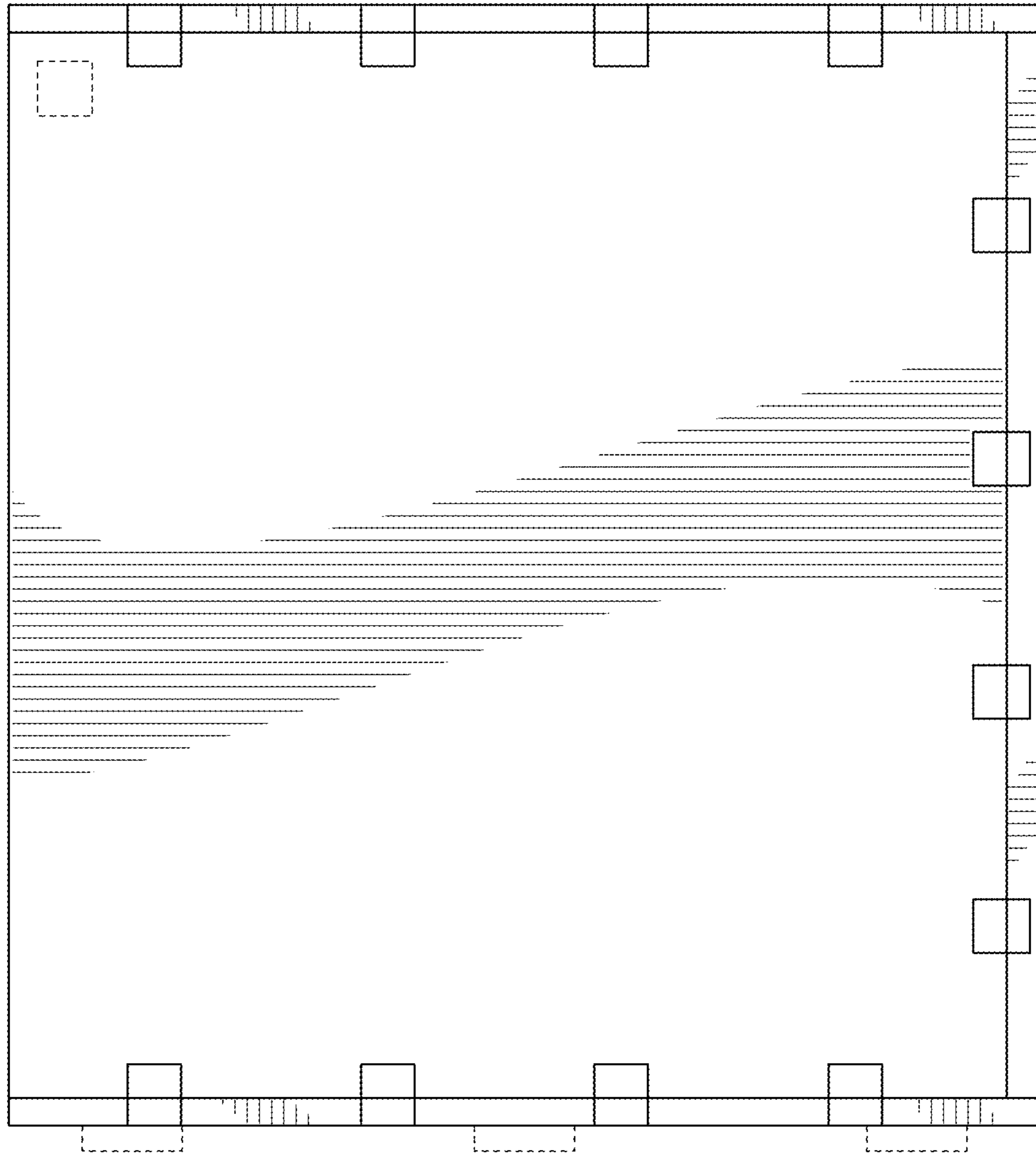

FIG. 11

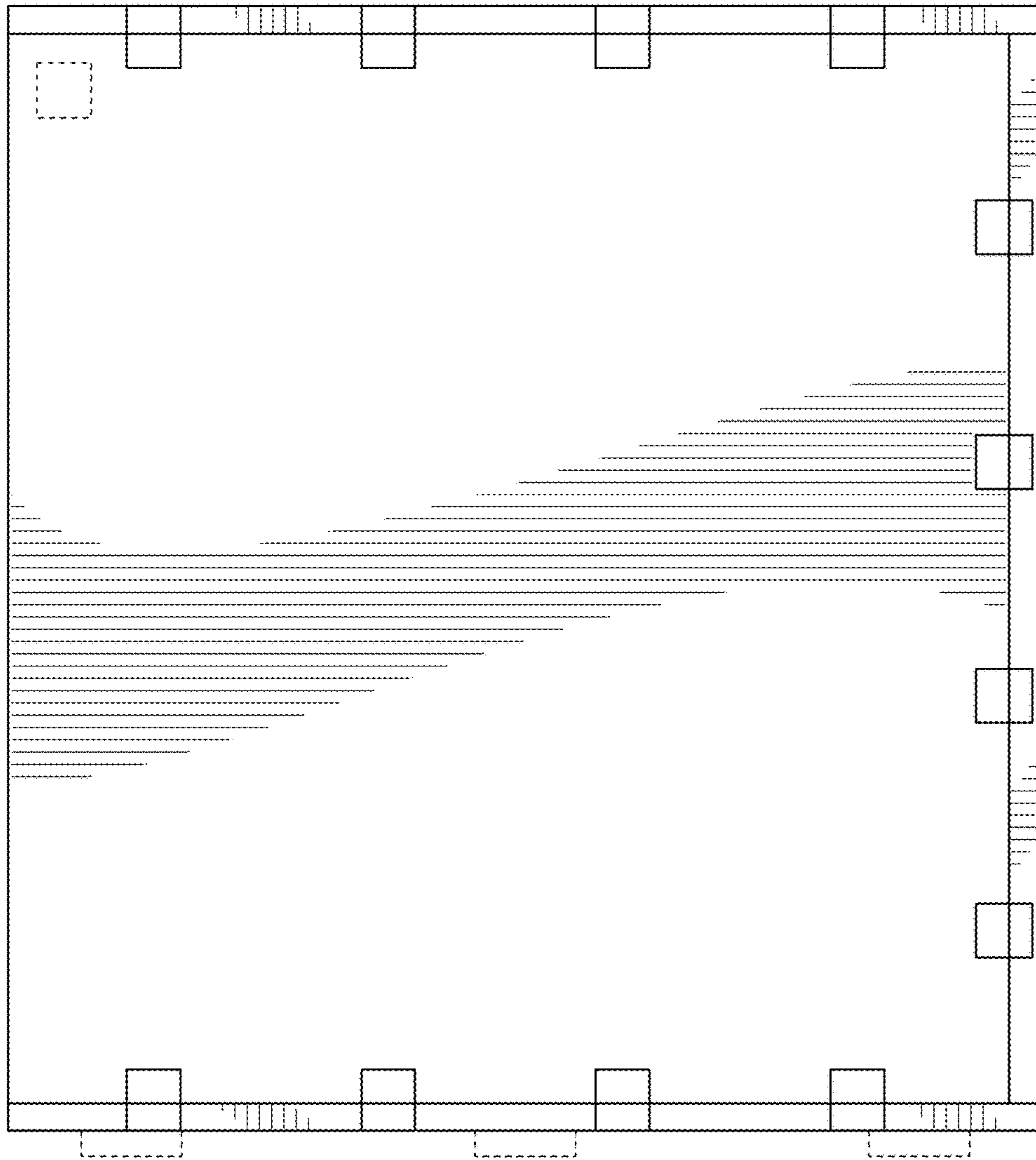

FIG. 12

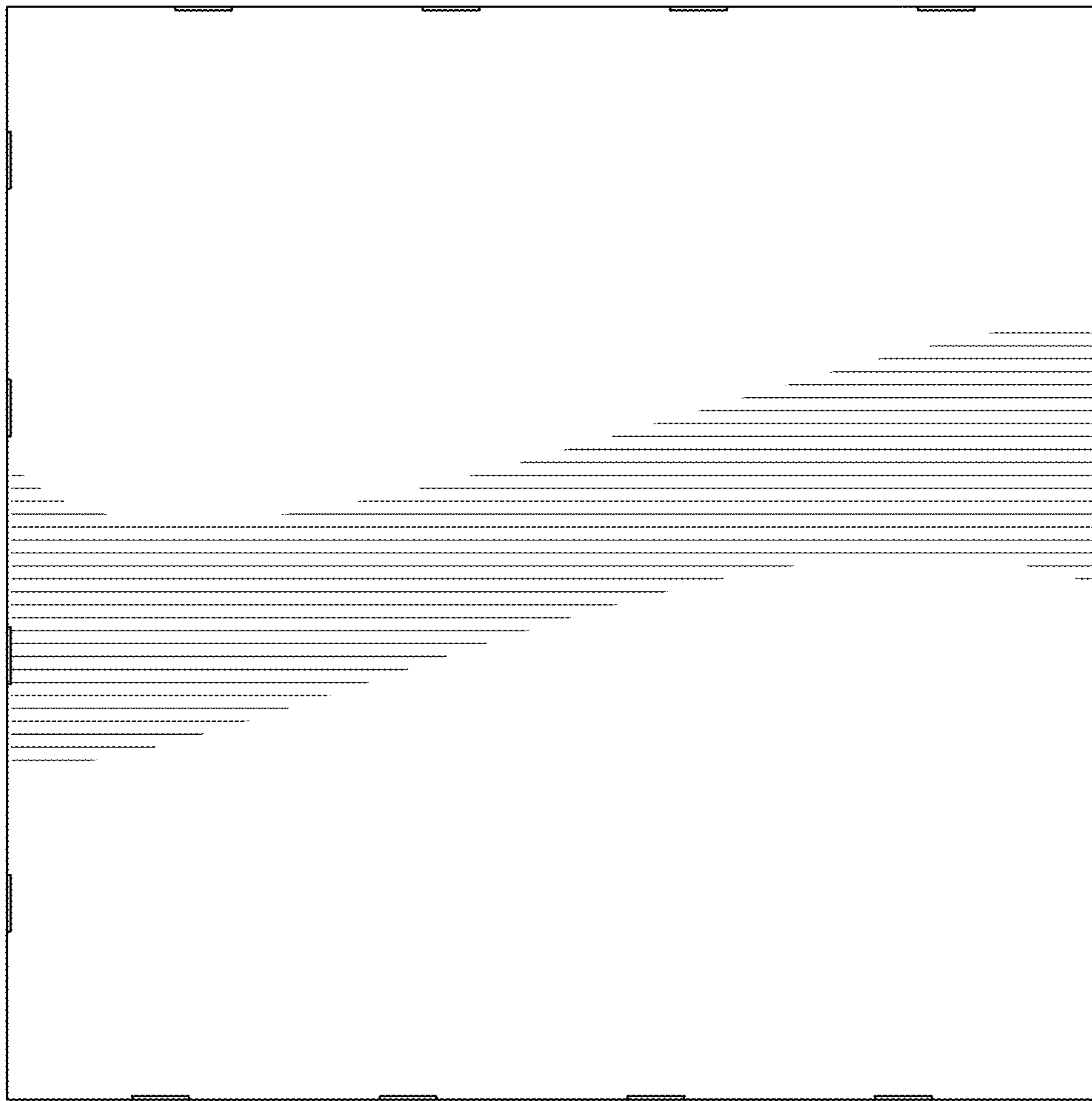

FIG. 13

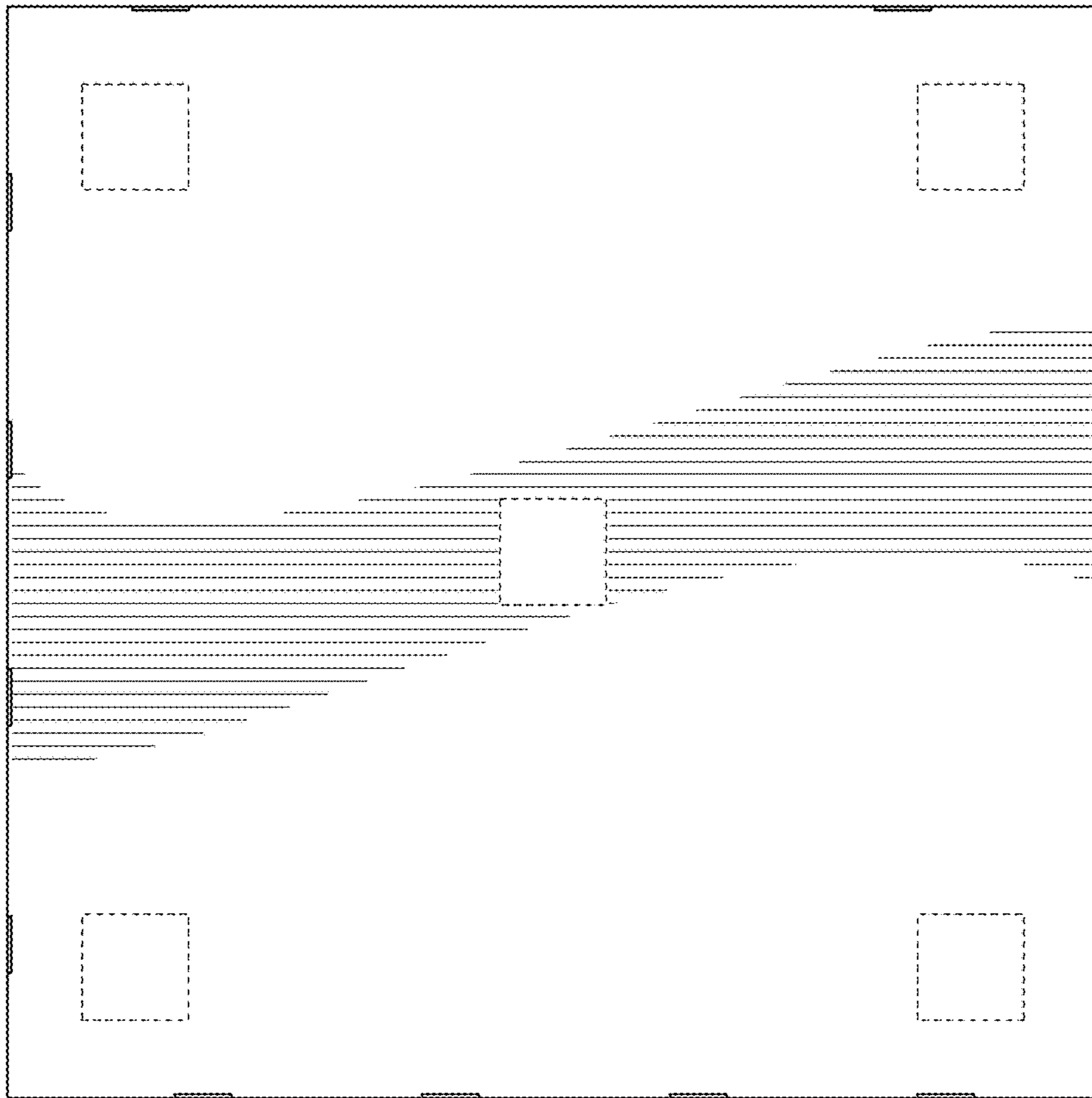

FIG. 14