



US00D856213S

(12) **United States Design Patent** (10) **Patent No.:** **US D856,213 S**
Kubo et al. (45) **Date of Patent:** **** Aug. 13, 2019**

(54) **FRONT BUMPER FOR AN AUTOMOBILE**

D813,735 S * 3/2018 Kanno D12/169
D813,736 S * 3/2018 Jevremovic D12/169
D814,989 S * 4/2018 Ino D12/169

(71) Applicant: **TOYOTA JIDOSHA KABUSHIKI KAISHA**, Toyota-shi (JP)

(72) Inventors: **Kosuke Kubo**, Okazaki (JP); **Tadao Hoshino**, Hiroshima (JP); **Yasunori Kawano**, Hiroshima (JP); **Atsushi Shudo**, Hiroshima (JP)

(73) Assignee: **TOYOTA JIDOSHA KABUSHIKI KAISHA** (JP)

(**) Term: **15 Years**

(21) Appl. No.: **29/638,653**

(22) Filed: **Feb. 28, 2018**

(51) **LOC (12) Cl.** **12-16**

(52) **U.S. Cl.**
USPC **D12/169**

(58) **Field of Classification Search**
USPC D12/169, 216, 90-92, 86, 171, 196, 163,
D12/164; 293/102, 113, 115, 117, 120;
296/180.1, 180.2

CPC B60R 19/02; B60R 19/04; B62D 25/08
See application file for complete search history.

(56) **References Cited**

U.S. PATENT DOCUMENTS

D733,621 S * 7/2015 Ikuma D12/169
D748,021 S * 1/2016 Iwanaga D12/169
D751,957 S * 3/2016 Tomatsu D12/169
D752,486 S * 3/2016 Sperling D12/169
D784,214 S * 4/2017 Kanasugi D12/169
D793,923 S * 8/2017 Katou D12/169
D800,032 S * 10/2017 Yokoi D12/169
D800,035 S * 10/2017 Takamatsu D12/169

OTHER PUBLICATIONS

Toyota, The Scion Spirit Lives on, <<http://www.toyota.com/scion/>>, published on Sep. 11, 2017.

Toyota, 2018 Yaris iA, <<https://www.toyota.com/yarisia/>>, published on Sep. 11, 2017.

Mazda, Mazda Official Web Site, <<http://www.mazda.co.jp/>>, published on Sep. 11, 2017.

Mazda, Exterior Design, <http://www.mazda.co.jp/cars/demio/feature/design/?link_id=sbnv>, published on Sep. 11, 2017.

* cited by examiner

Primary Examiner — Melody N Brown

(74) *Attorney, Agent, or Firm* — Saidman DesignLaw Group, LLC

(57) **CLAIM**

The ornamental design for a front bumper for an automobile, as shown and described.

DESCRIPTION

FIG. 1 is a perspective view of a front bumper for an automobile showing our new design;

FIG. 2 is a front view thereof;

FIG. 3 is a rear view thereof;

FIG. 4 is a top plan view thereof;

FIG. 5 is a bottom plan view thereof;

FIG. 6 is a right side view thereof; and,

FIG. 7 is a left side view thereof.

The various shades of gray as well as the shadows and reflections represent contour and not surface ornamentation or any particular color.

1 Claim, 7 Drawing Sheets

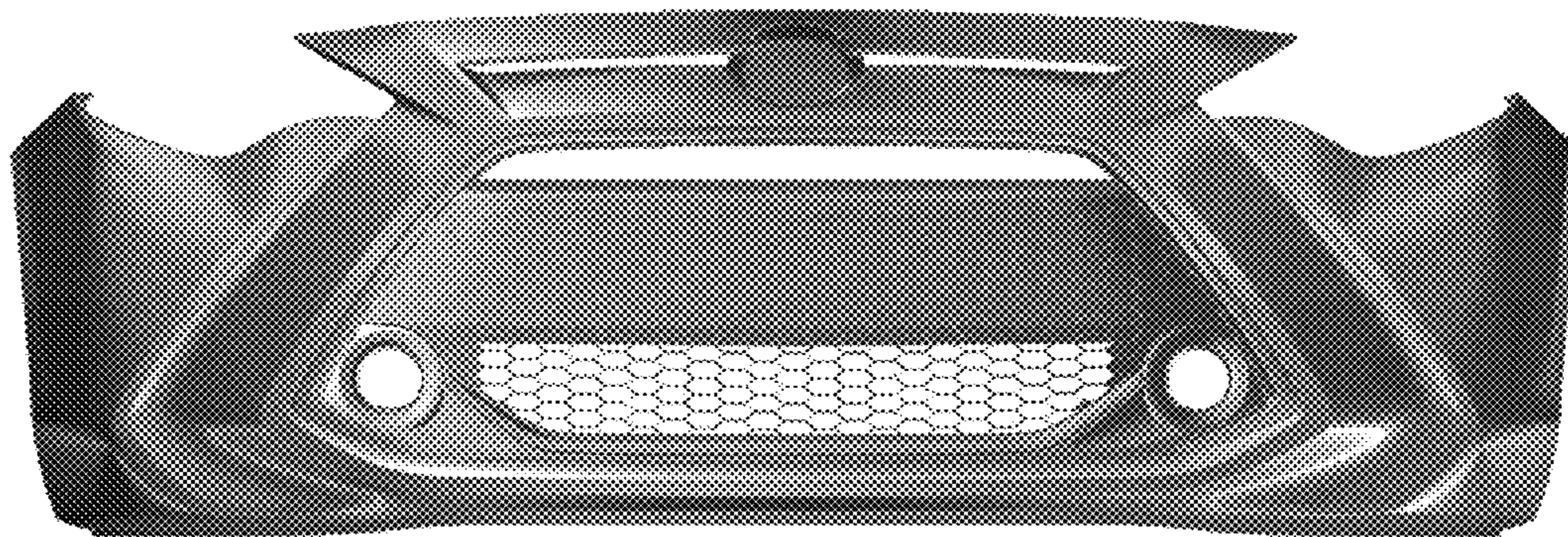

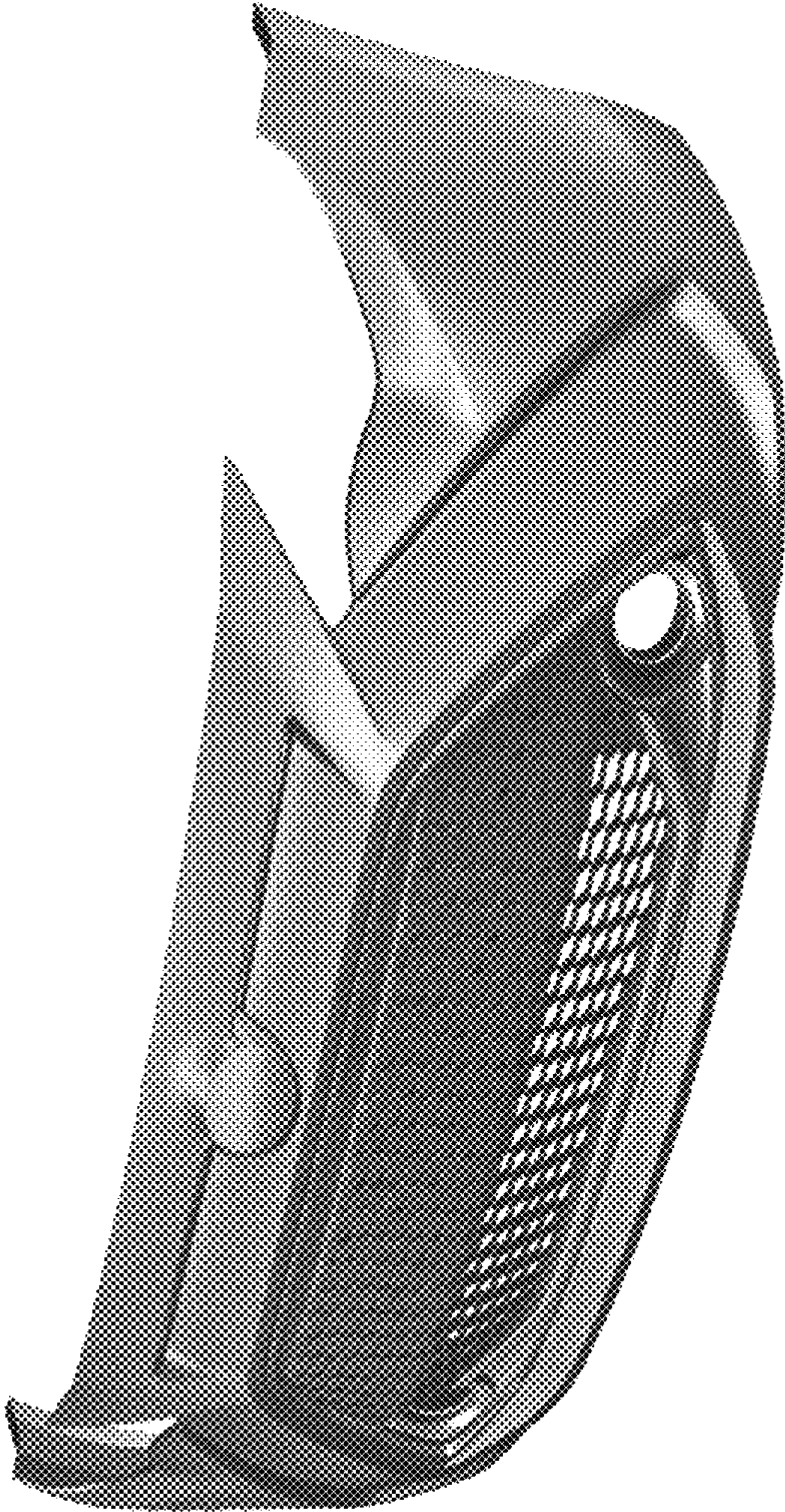

FIG. 1

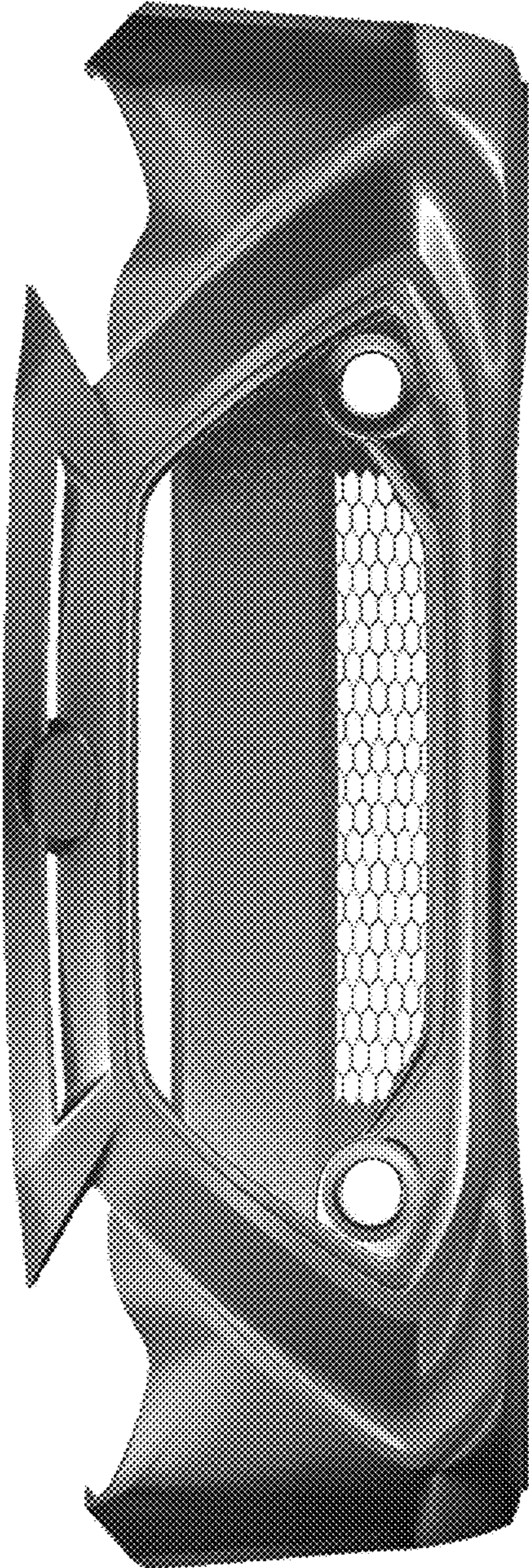

FIG. 2



FIG. 3



FIG. 4

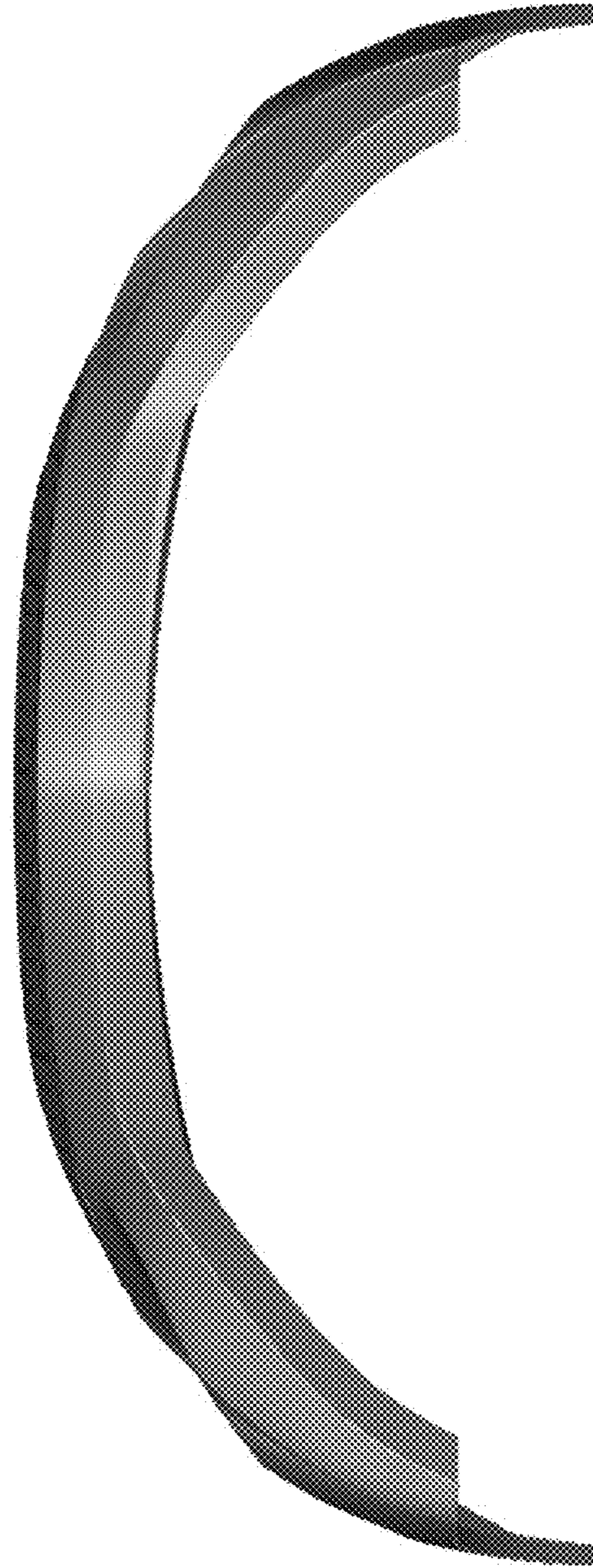

FIG. 5

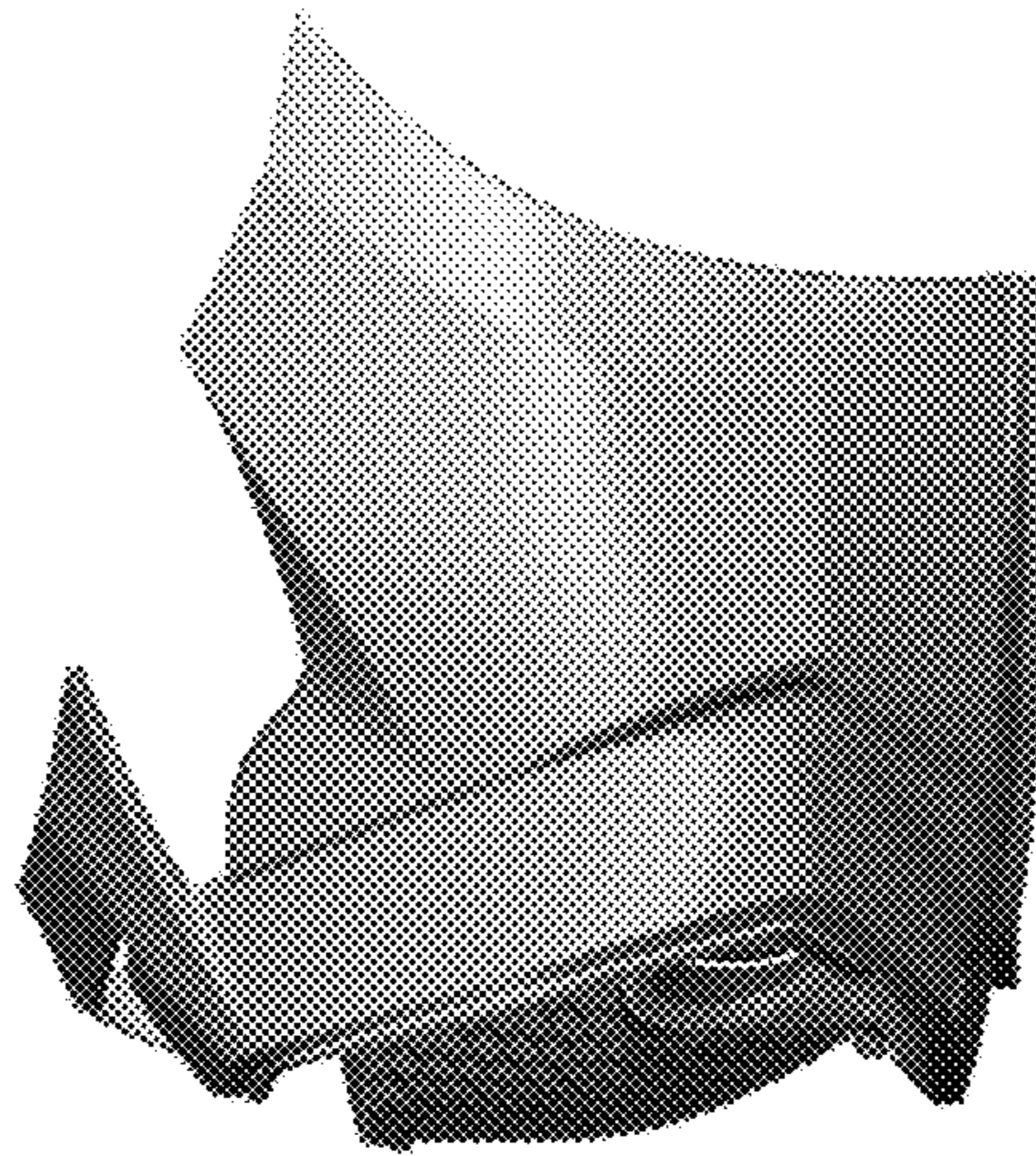

FIG. 6

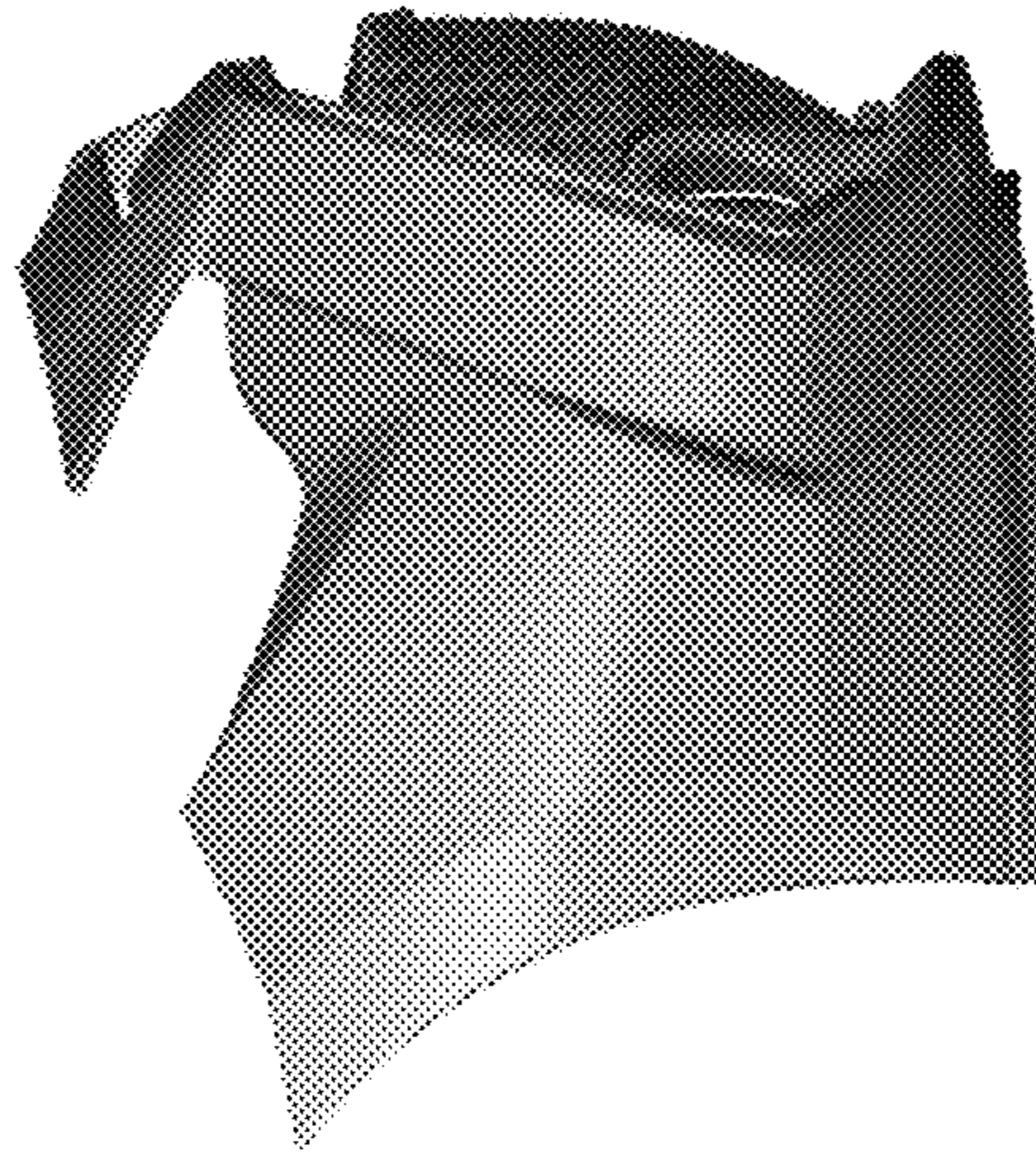

FIG. 7