



US00D855707S

(12) **United States Design Patent** (10) **Patent No.:** **US D855,707 S**
Ross (45) **Date of Patent:** **** Aug. 6, 2019**

(54) **CONNECTOR**

(71) Applicant: **JAKOBI INTERNATIONAL LIMITED**, Auckland (NZ)

(72) Inventor: **Janine Ross**, Auckland (NZ)

(73) Assignee: **Jakobi International Limited**, Auckland (NZ)

(**) Term: **15 Years**

(21) Appl. No.: **29/608,064**

(22) Filed: **Jun. 19, 2017**

(30) **Foreign Application Priority Data**

Dec. 19, 2016 (NZ) 422500

(51) **LOC (12) Cl.** **21-01**

(52) **U.S. Cl.**
USPC **D21/487; D9/434**

(58) **Field of Classification Search**

USPC D7/323, 254, 391, 392, 392.1, 503, D7/552.1, 553.1, 553.2, 554, 589, 600.1, D7/602, 614, 704; D9/434, 435, 436, D9/437, 438, 439, 440, 442, 443, 445, D9/446, 447, 449, 450, 452, 453, 454, D9/499, 686, 688, 690, 708, 709, 723, D9/724, 763, 772; D23/206, 249, 259, D23/260, 209; D8/352, 354, 382; D21/484, 487, 503, 561; D24/129; D13/120, 133, 146, 147, 149, 150, 151; D32/31

CPC B65D 47/065; B65D 43/02; B65D 43/16; B65D 43/22; B65D 43/26; B65D 47/0885; B65D 47/08; B65D 51/212; B65D 51/18; B65D 51/04; B65D 51/24; B65D 51/222; B65D 51/002; B65D 47/265; B65D 2543/0046; B65D 2543/00092; B65D 2543/00231; B65D 2543/00842; B65D 21/0217; B65D 1/165; B65D 1/027; B65D 1/0246; B65D 85/72;

B65D 17/165; B65D 41/04; B65D 2251/0093; B65D 2101/0015; A45F 3/18; A47G 19/00; A47G 19/2272; A47G 19/2205; A47G 19/2222; A47G 19/2266; A47G 19/2294; A47J 36/10; A47J 36/14; A47J 36/06; F24F 13/0209; F16L 37/252; A63H 33/06; A63H 33/08; A63H 33/084; A63H 33/086; A63H 33/088; A63H 33/10; A63H 33/105

See application file for complete search history.

(56) **References Cited**

U.S. PATENT DOCUMENTS

2,001,248	A *	5/1935	Greene	B65D 51/18
					220/255
D233,138	S *	10/1974	Vogel	215/200
D315,181	S *	3/1991	Meyer	D21/487
D328,033	S *	7/1992	DiGuseppi	D9/435
D353,684	S *	12/1994	Moussa	D26/113
D363,665	S *	10/1995	Goto	D7/511
D397,168	S *	8/1998	Poissant	D21/484
D519,030	S *	4/2006	Matsuda	D9/453
D553,498	S *	10/2007	Cooney	D9/454
D581,809	S *	12/2008	Wichowski	D9/504
D583,880	S *	12/2008	Slater	D21/487
D635,222	S *	3/2011	Stein	D23/249

(Continued)

Primary Examiner — Jennifer Rivard

Assistant Examiner — Catherine S Posthauer

(74) *Attorney, Agent, or Firm* — Studebaker & Brackett PC

(57) **CLAIM**

The ornamental design for a connector, as shown and described.

DESCRIPTION

FIG. 1 is a bottom view showing my new design for a connector; and, FIG. 2 is a perspective view thereof.

1 Claim, 2 Drawing Sheets

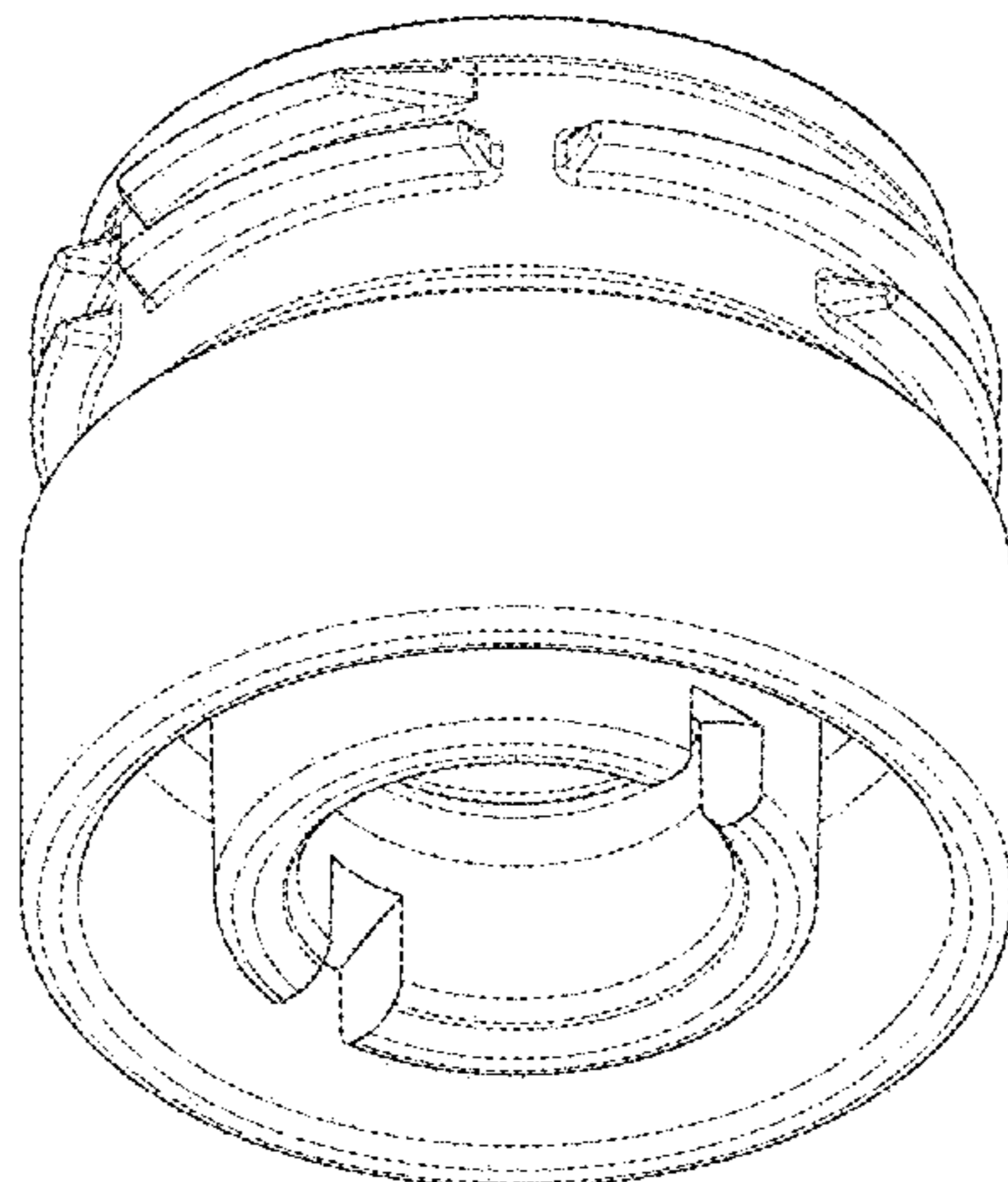

(56)

References Cited

U.S. PATENT DOCUMENTS

D682,994 S * 5/2013 Schulz D23/259
D734,668 S * 7/2015 Epstein D9/440
D788,886 S * 6/2017 Salzer D23/259
D815,277 S * 4/2018 Eury D24/129
D827,364 S * 9/2018 Rummel D7/392.1
D832,431 S * 10/2018 Turturro D24/129
D837,901 S * 1/2019 Peng D21/487
D838,319 S * 1/2019 Peng D21/487
2014/0069917 A1 * 3/2014 Meyers B65D 21/022
220/23.88
2015/0266631 A1 * 9/2015 Wohlgenannt B65D 1/0246
215/44
2017/0174398 A1 * 6/2017 Cox B65D 41/0471
2017/0231604 A1 * 8/2017 Jakobsen A61B 10/0096
422/536
2018/0057221 A1 * 3/2018 Wheaton B65D 41/0407

* cited by examiner

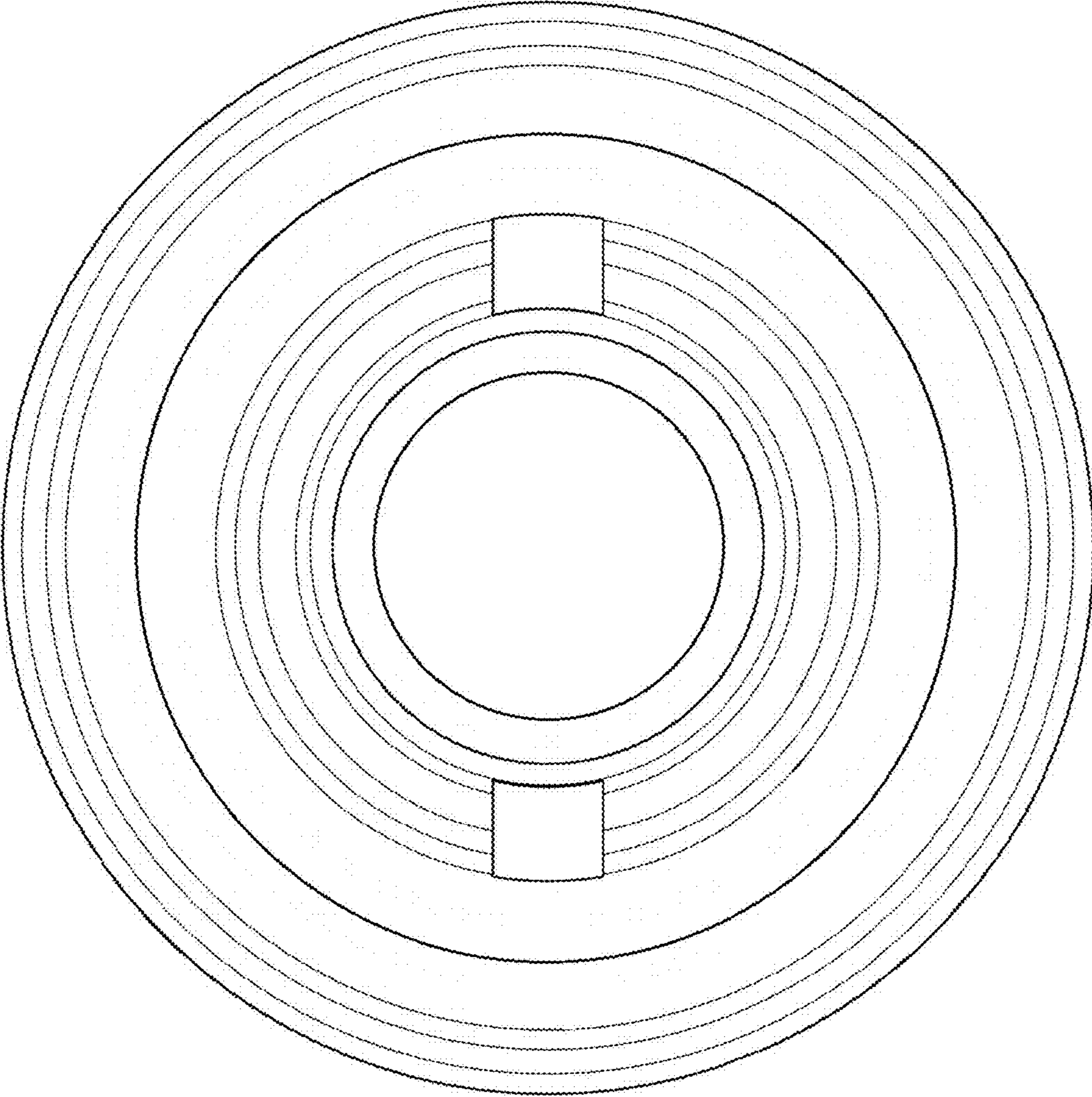

Fig. 1

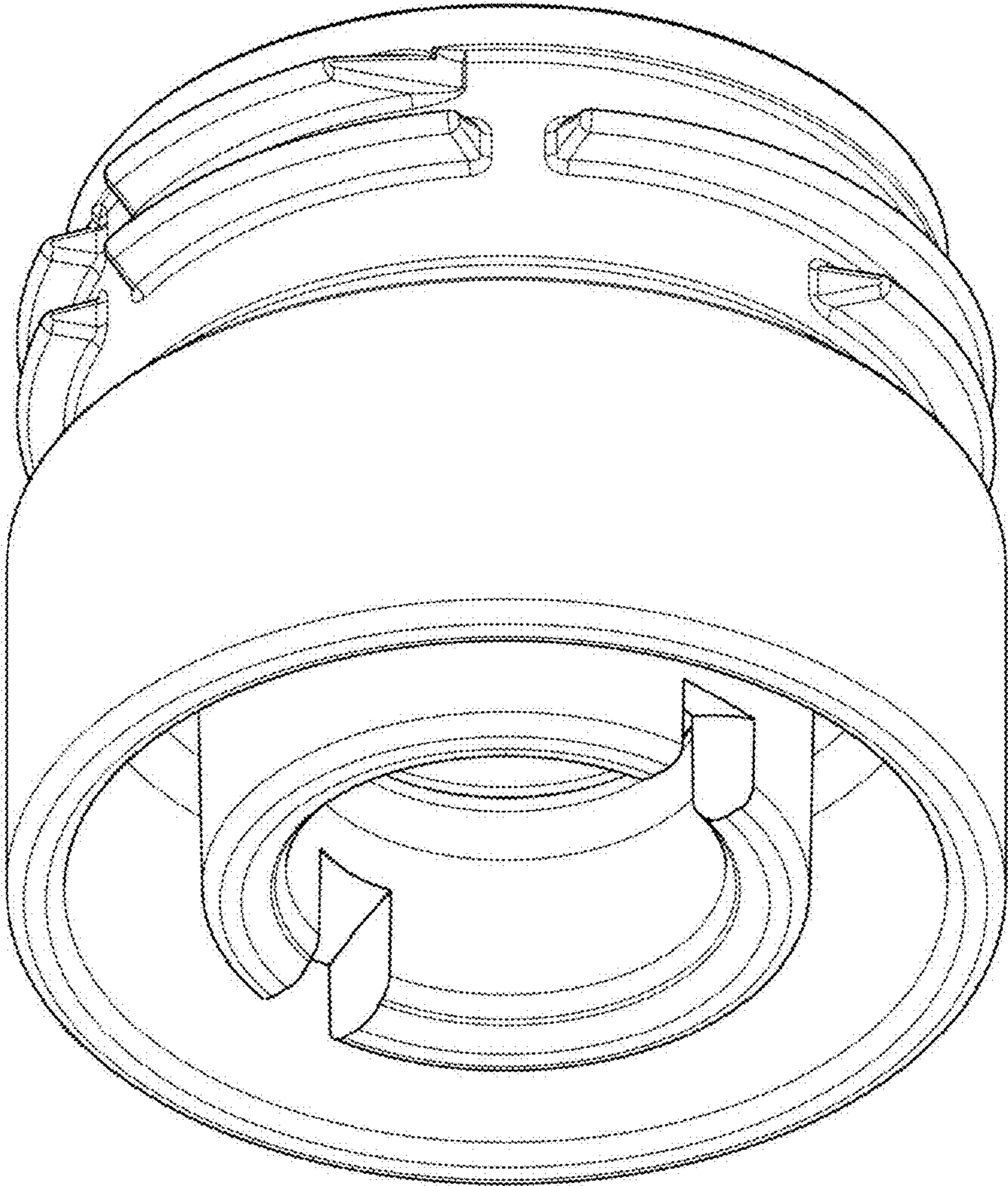

Fig. 2