



US00D855350S

(12) **United States Design Patent** (10) **Patent No.:** **US D855,350 S**  
**Holt** (45) **Date of Patent:** **\*\* Aug. 6, 2019**

(54) **DEVICE MOUNTING APPARATUS**

2012/0127379 A1\* 5/2012 Wengreen ..... H05K 5/0204  
348/836

(71) Applicant: **Gerald Dwayne Holt**, Klamath Falls,  
OR (US)

2016/0080681 A1\* 3/2016 Bynum ..... H04N 5/655  
348/836

(72) Inventor: **Gerald Dwayne Holt**, Klamath Falls,  
OR (US)

2018/0008044 A1\* 1/2018 Holt ..... A47B 97/00

\* cited by examiner

(\*\*) Term: **15 Years**

*Primary Examiner* — Wan Laymon

*Assistant Examiner* — Mark Booker

(21) Appl. No.: **29/610,073**

(74) *Attorney, Agent, or Firm* — Graham Casanova Alig;  
Alig Patent Law

(22) Filed: **Jul. 10, 2017**

(57) **CLAIM**

**Related U.S. Application Data**

I claim the ornamental design for the device mounting  
apparatus, as shown and described.

(63) Continuation-in-part of application No. 15/644,836,  
filed on Jul. 10, 2017, and a continuation-in-part of  
application No. PCT/US2017/041287, filed on Jul.  
10, 2017.

**DESCRIPTION**

(51) **LOC (12) Cl.** ..... **06-04**

FIG. 1 is an isometric view of a device mounting apparatus  
of the present invention;

(52) **U.S. Cl.**

FIG. 2 is a direct front view thereof;

USPC ..... **D6/553**

FIG. 3 is a direct top-down view thereof;

(58) **Field of Classification Search**

USPC ..... D6/553, 574; D7/698; 52/287.1;

FIG. 4 is a right side view, the left side view is a mirror  
image thereof; and,

108/28–29, 152; 211/13.1, 42, 86.01,

FIG. 5 is an isometric view of thereof, attached to a flat  
screen monitor and holding a device.

211/88.01, 90.01, 90.03, 126.1, 134, 153;

248/205.3, 235, 243, 247, 249, 250;

It is noted both the monitor and device are depicted as  
dashed lines to clearly disavow any claim to the ornamental  
design of the dashed elements.

312/108, 140.2, 229; 348/836; D14/129

CPC .. H04N 5/655; A47B 83/001; A47B 21/0314;

F16M 13/02

The bottom of the device mounting apparatus is flat and  
devoid of ornamental features as such the bottom view  
forms no part of the claimed design. The device mounting  
apparatus is shown in its environment in FIG. 5, broken lines  
are used to indicate that elements of the environment form  
no part of the claimed design.

See application file for complete search history.

The broken line shown in FIG. 5 forms no part of the  
claimed design.

(56) **References Cited**

**U.S. PATENT DOCUMENTS**

D308,784 S \* 6/1990 Liptak ..... D6/553

D769,644 S \* 10/2016 Jacobson ..... D6/553

2002/0135975 A1\* 9/2002 Schmidt ..... A47B 81/06

361/679.6

**1 Claim, 5 Drawing Sheets**

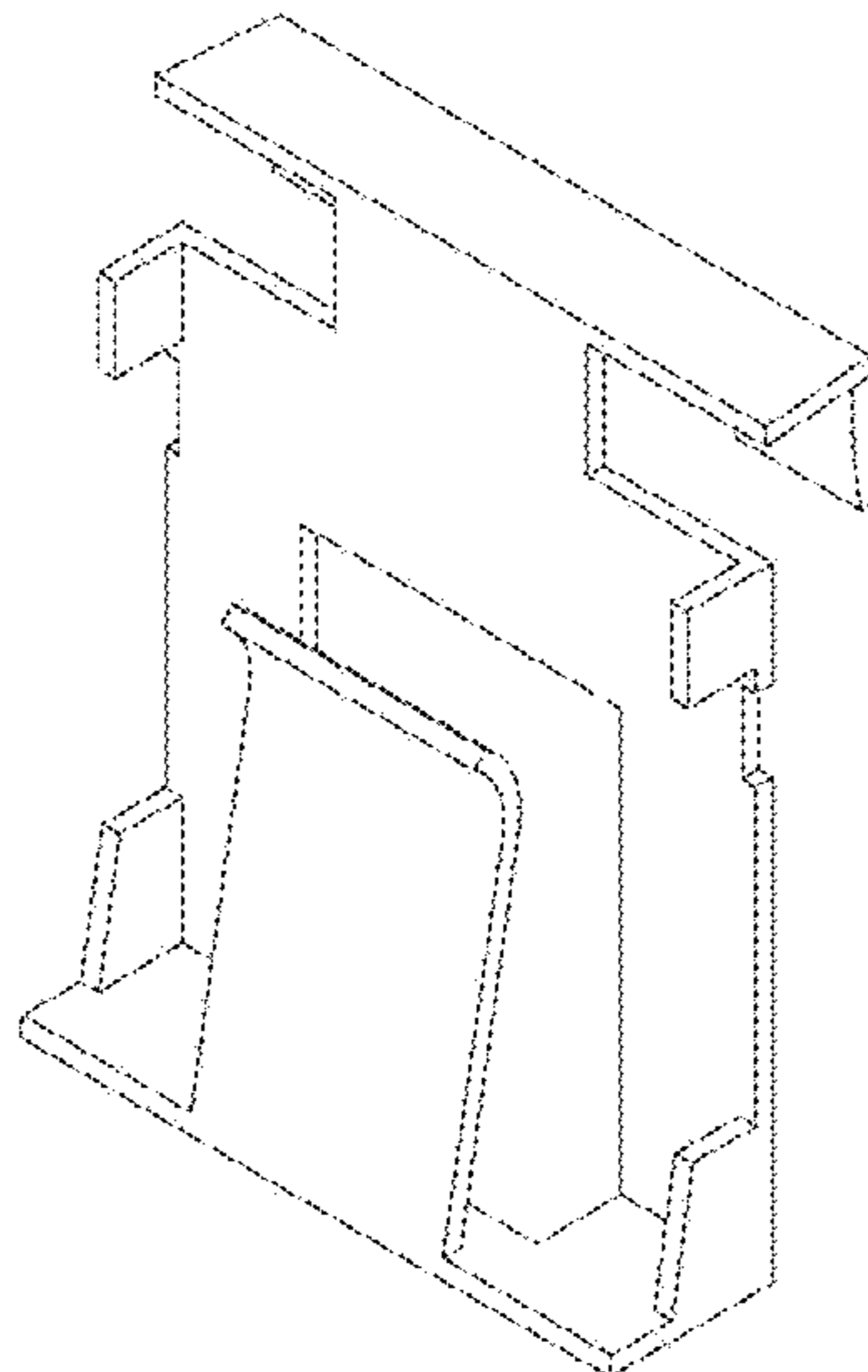

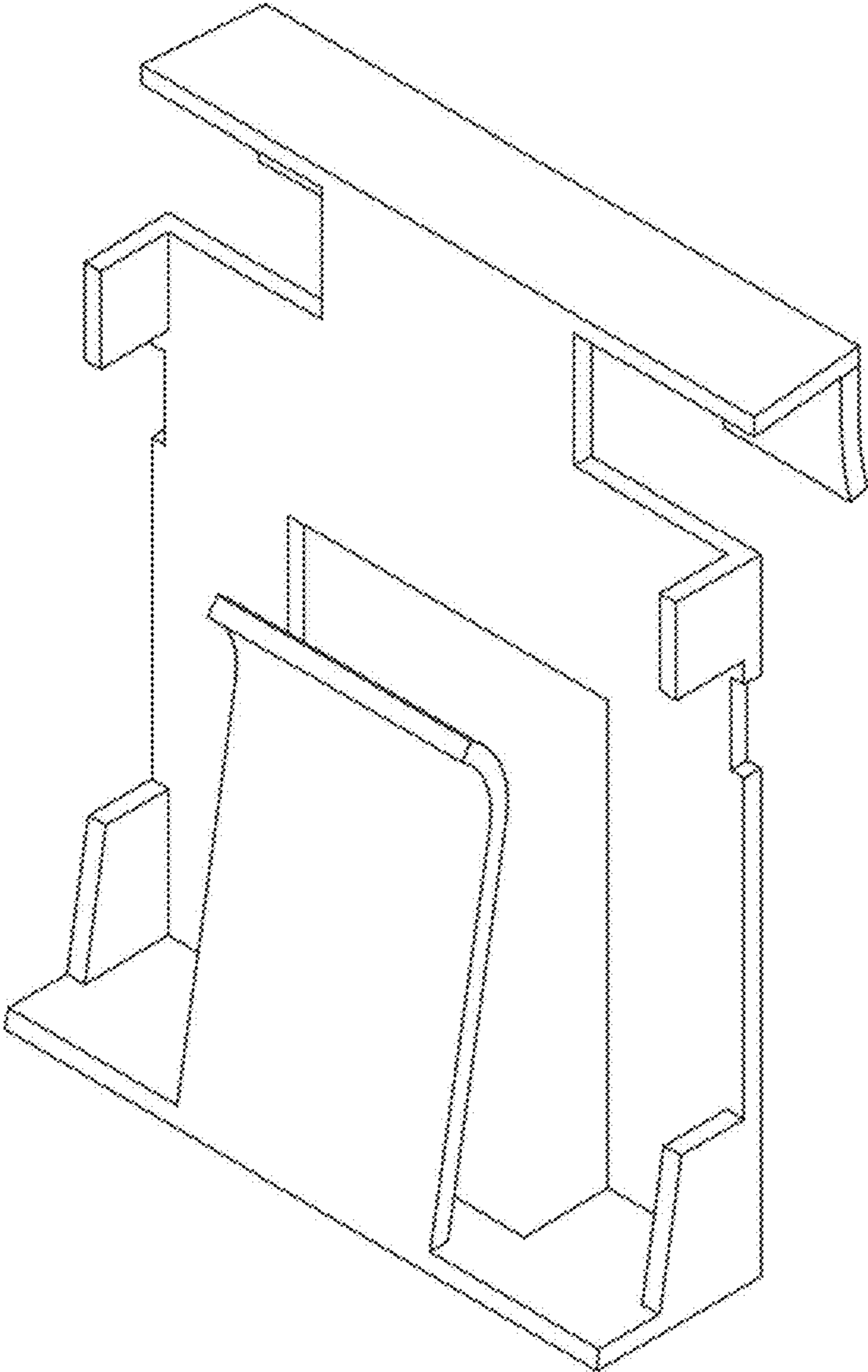

FIG. 1

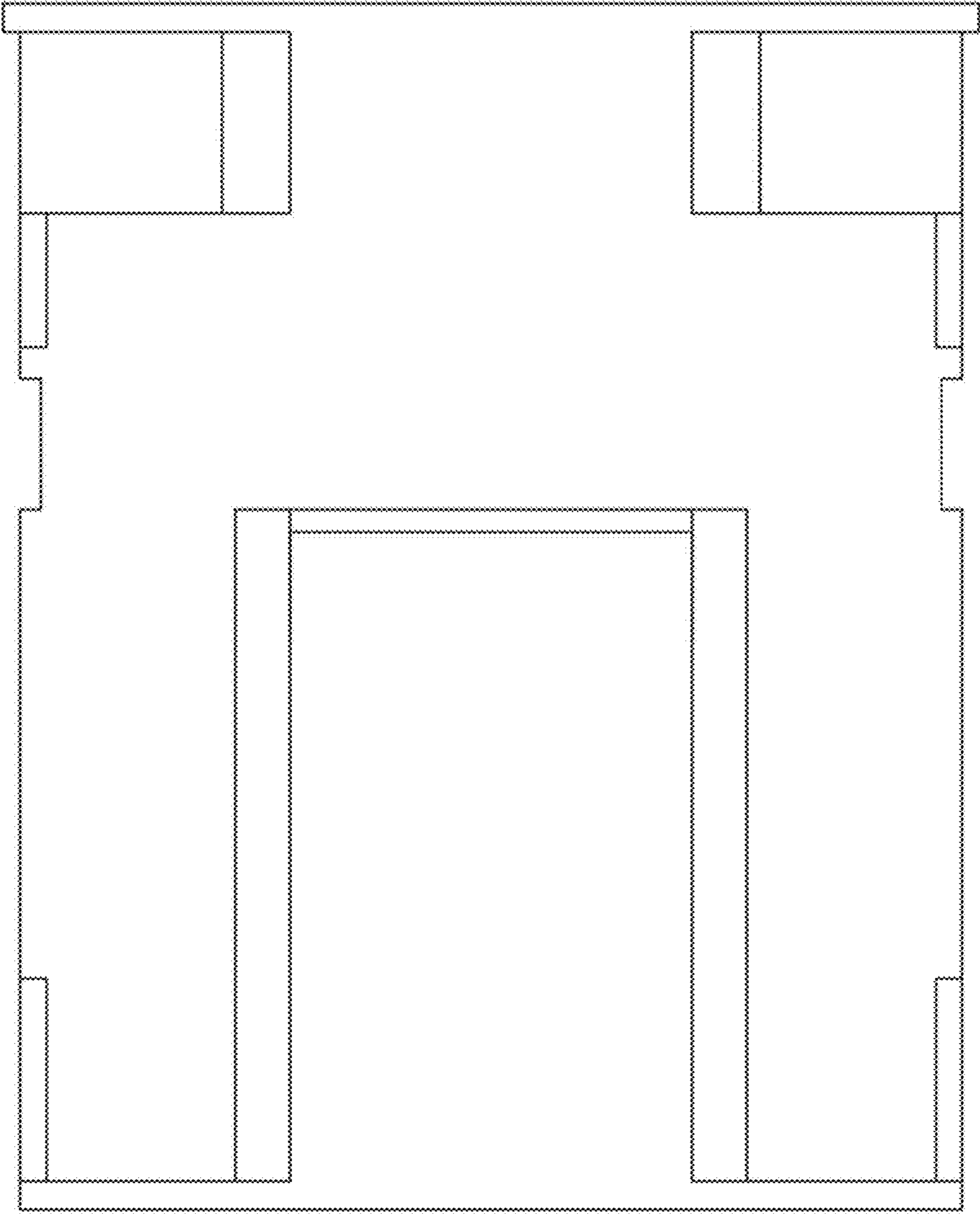

FIG. 2

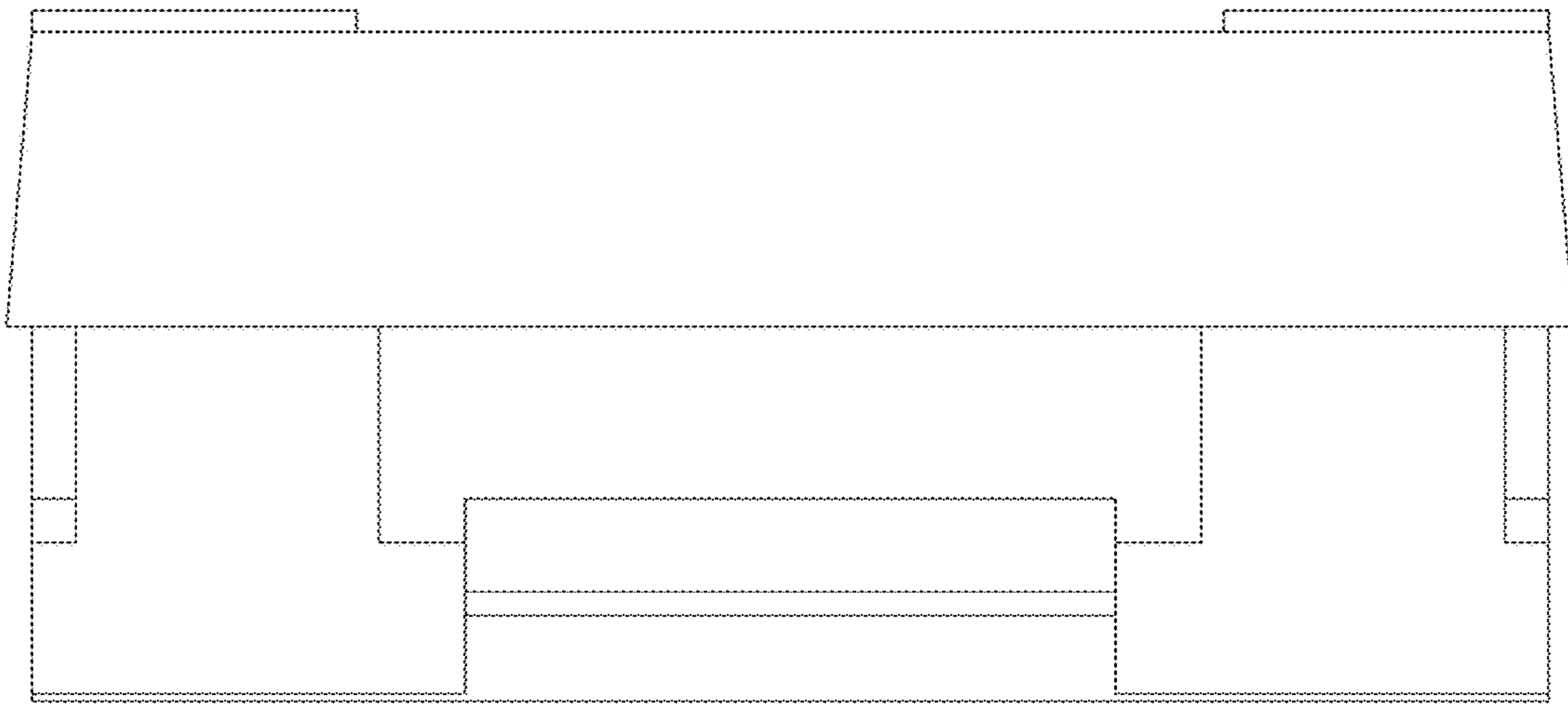

FIG. 3

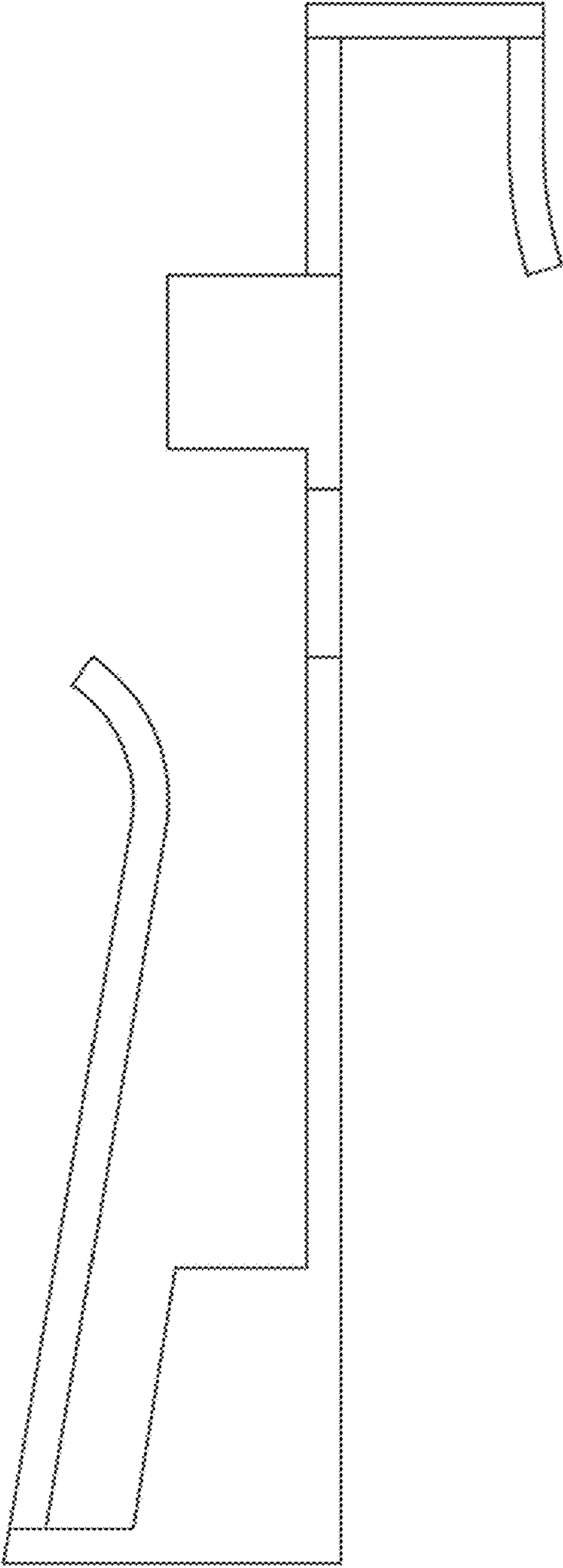

FIG. 4

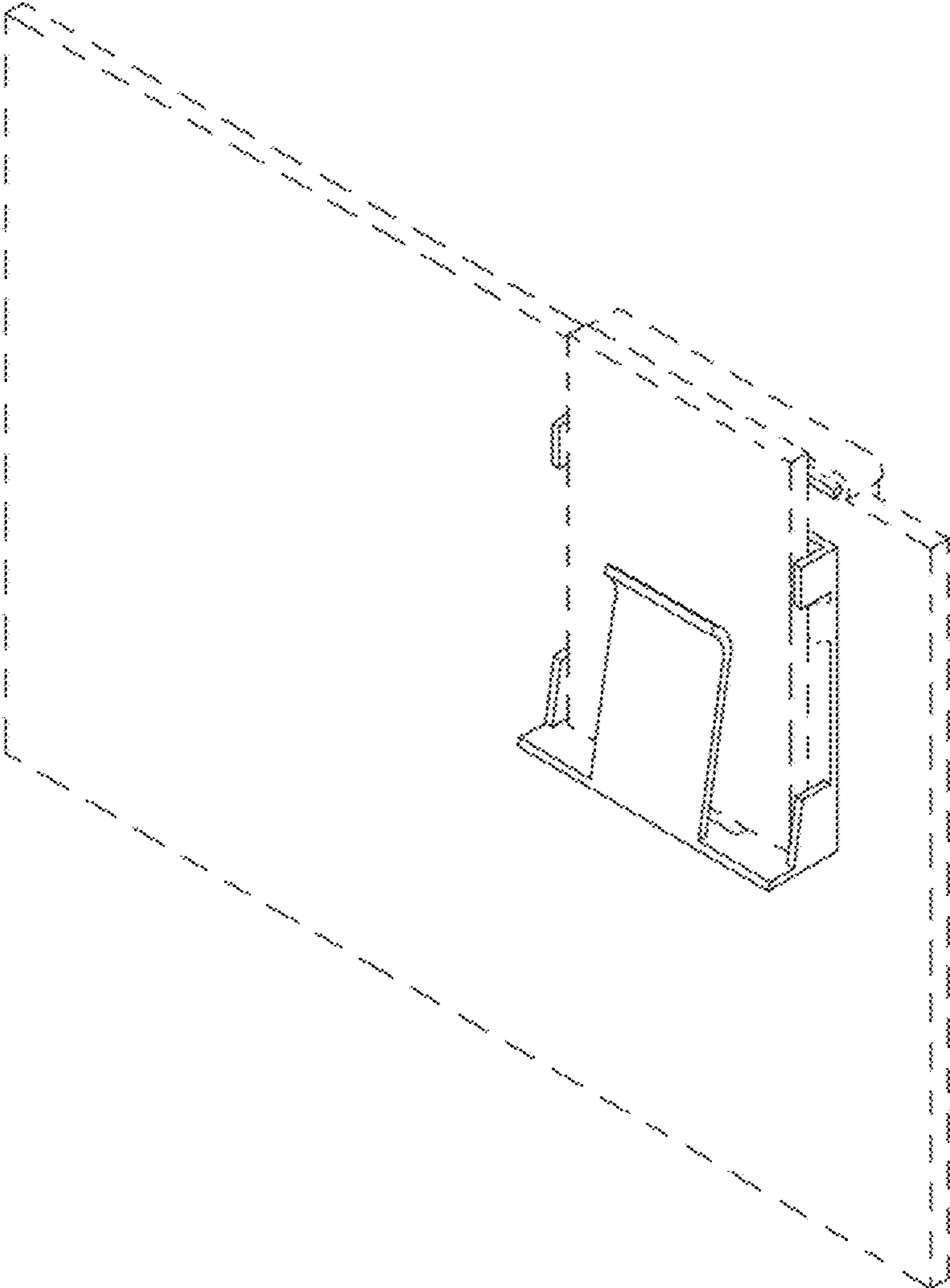

FIG. 5