



US00D854948S

(12) **United States Design Patent**
Lundgren-Goodman et al.

(10) **Patent No.:** **US D854,948 S**
(45) **Date of Patent:** **** Jul. 30, 2019**

(54) **MEASURING SPOON**
(71) Applicant: **Å&R Carton Lund Aktiebolag**, Lund (SE)
(72) Inventors: **Maximilian Lundgren-Goodman**, Lomma (SE); **Henrik Herlin**, Kristianstad (SE)
(73) Assignee: **Å&R Carton Lund Aktiebolag**, Lund (SE)

(**) Term: **15 Years**

(21) Appl. No.: **29/618,240**

(22) Filed: **Sep. 20, 2017**

(30) **Foreign Application Priority Data**

Mar. 21, 2017 (EM) 003813948-0001
Mar. 21, 2017 (EM) 003813948-0002
Mar. 21, 2017 (EM) 003813948-0003
Mar. 21, 2017 (EM) 003813948-0004

(51) **LOC (11) Cl.** **10-04**

(52) **U.S. Cl.**
USPC **D10/46.2**

(58) **Field of Classification Search**
USPC D7/653, 692, 691; D10/46.2, 46.3; D24/116
CPC G01F 19/00-007; B65D 21/0233
See application file for complete search history.

(56) **References Cited**

U.S. PATENT DOCUMENTS

D255,973 S * 7/1980 Morin D7/653
7,077,054 B1 * 7/2006 Hurlock A47G 19/16
210/465

D546,634 S * 7/2007 Hauser D7/653
D582,297 S * 12/2008 Vendl D10/46.3
D582,298 S * 12/2008 Vendl D10/46.3
D615,886 S * 5/2010 Pallotto D10/46.2
D660,730 S * 5/2012 Lee D10/46.2
D666,505 S * 9/2012 De Leo D10/46.2
D666,506 S * 9/2012 De Leo D10/46.2
D730,752 S * 6/2015 Clark D10/46.3
2008/0295343 A1 * 12/2008 Mattingly A47G 21/02
30/324

* cited by examiner

Primary Examiner — Brett Miller

(74) *Attorney, Agent, or Firm* — Tucker Ellis LLP

(57) **CLAIM**

The ornamental design for a measuring spoon, as shown and described.

DESCRIPTION

FIG. 1 is a top-front-right perspective view of a measuring spoon showing our new design;
FIG. 2 is a top-rear-right perspective view thereof;
FIG. 3 is a bottom-rear-left perspective view thereof;
FIG. 4 is a front view thereof;
FIG. 5 is a rear view thereof;
FIG. 6 is a right side view thereof; and,
FIG. 7 is a bottom view thereof.

The de-emphasized portions shown in the drawings illustrate portions of the measuring spoon that form no part of the claimed design.

The broken lines are for the purpose of illustrating portions of the measuring spoon of indeterminate dimension that form no part of the claimed design.

1 Claim, 7 Drawing Sheets

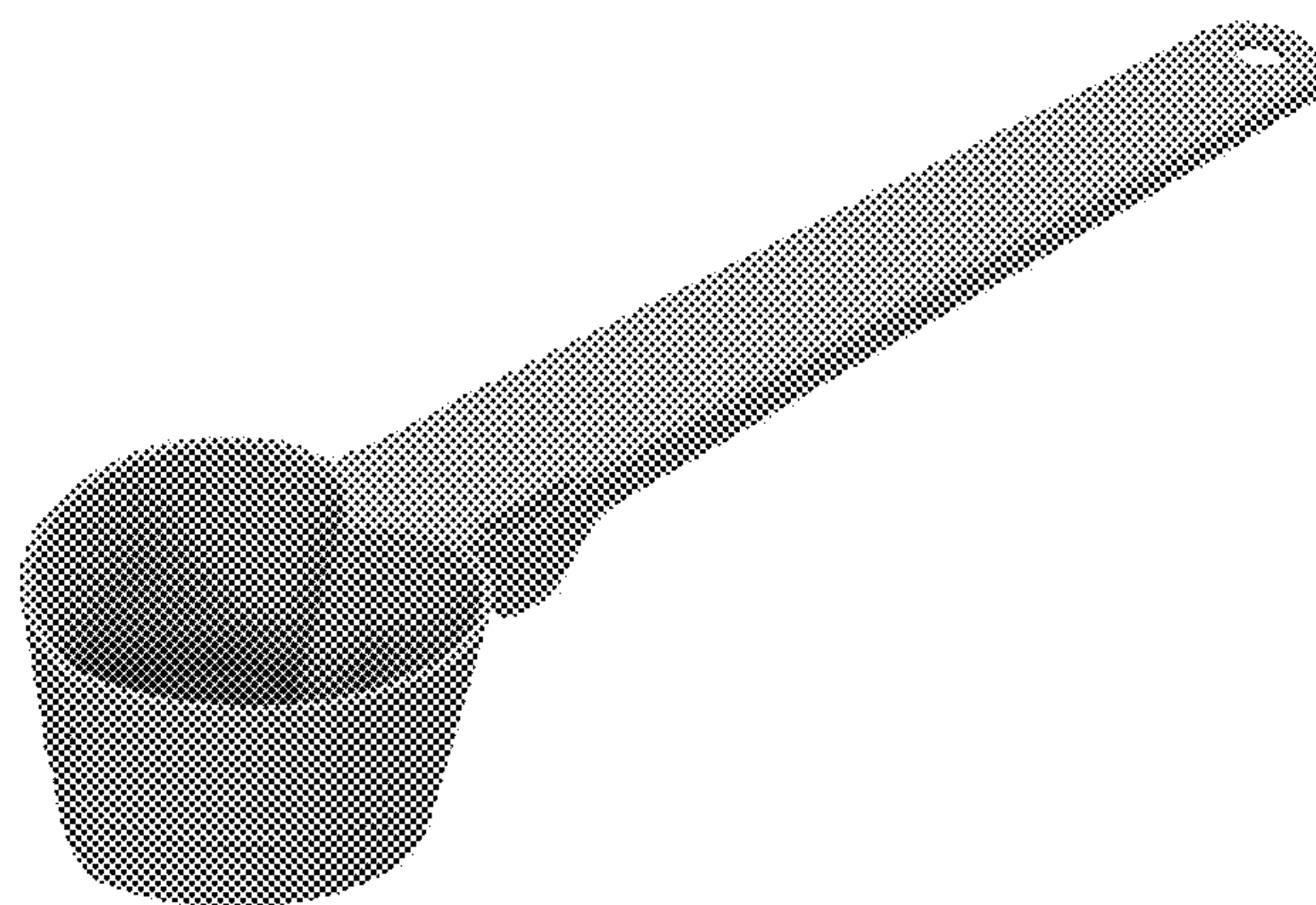

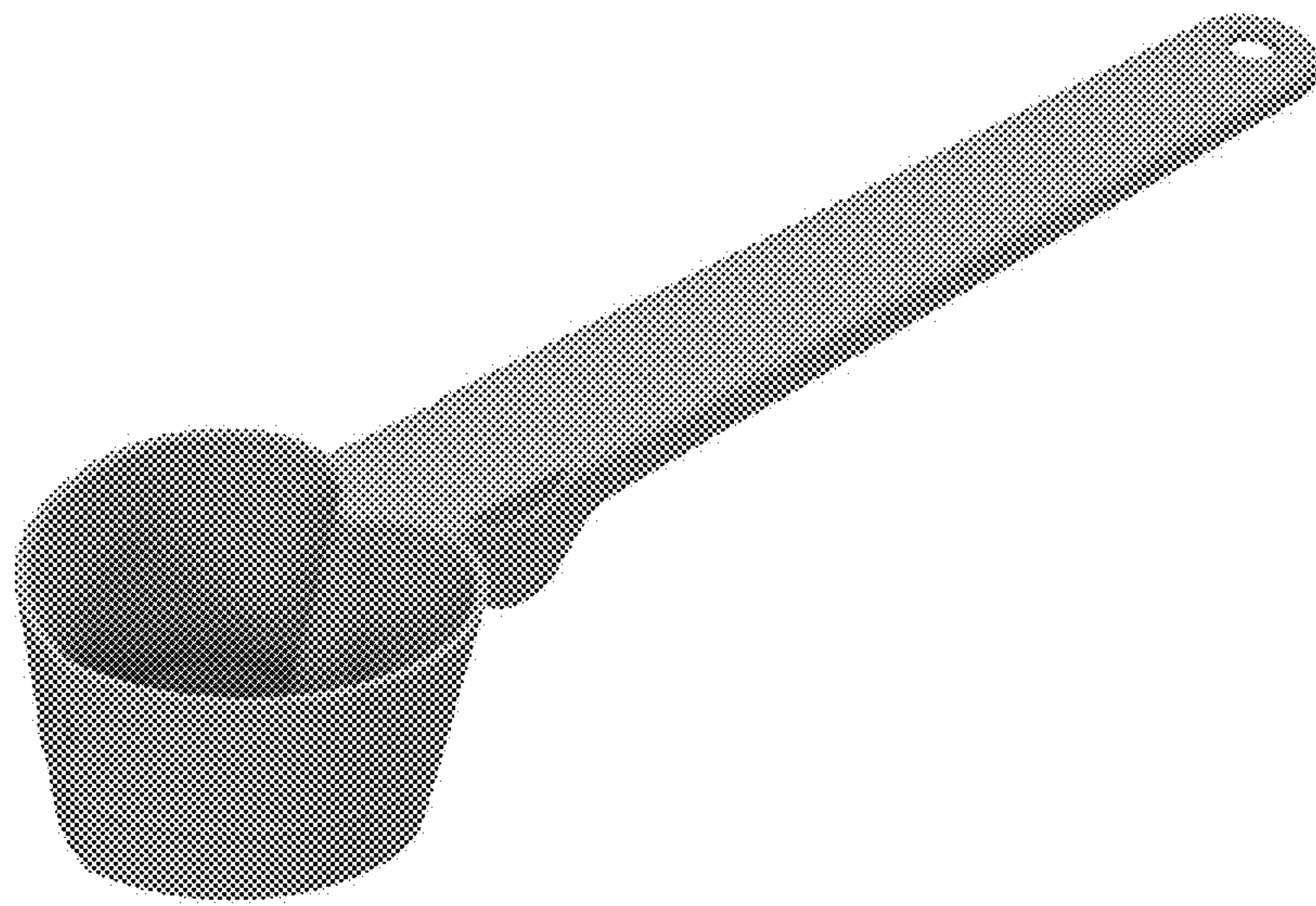

FIG. 1

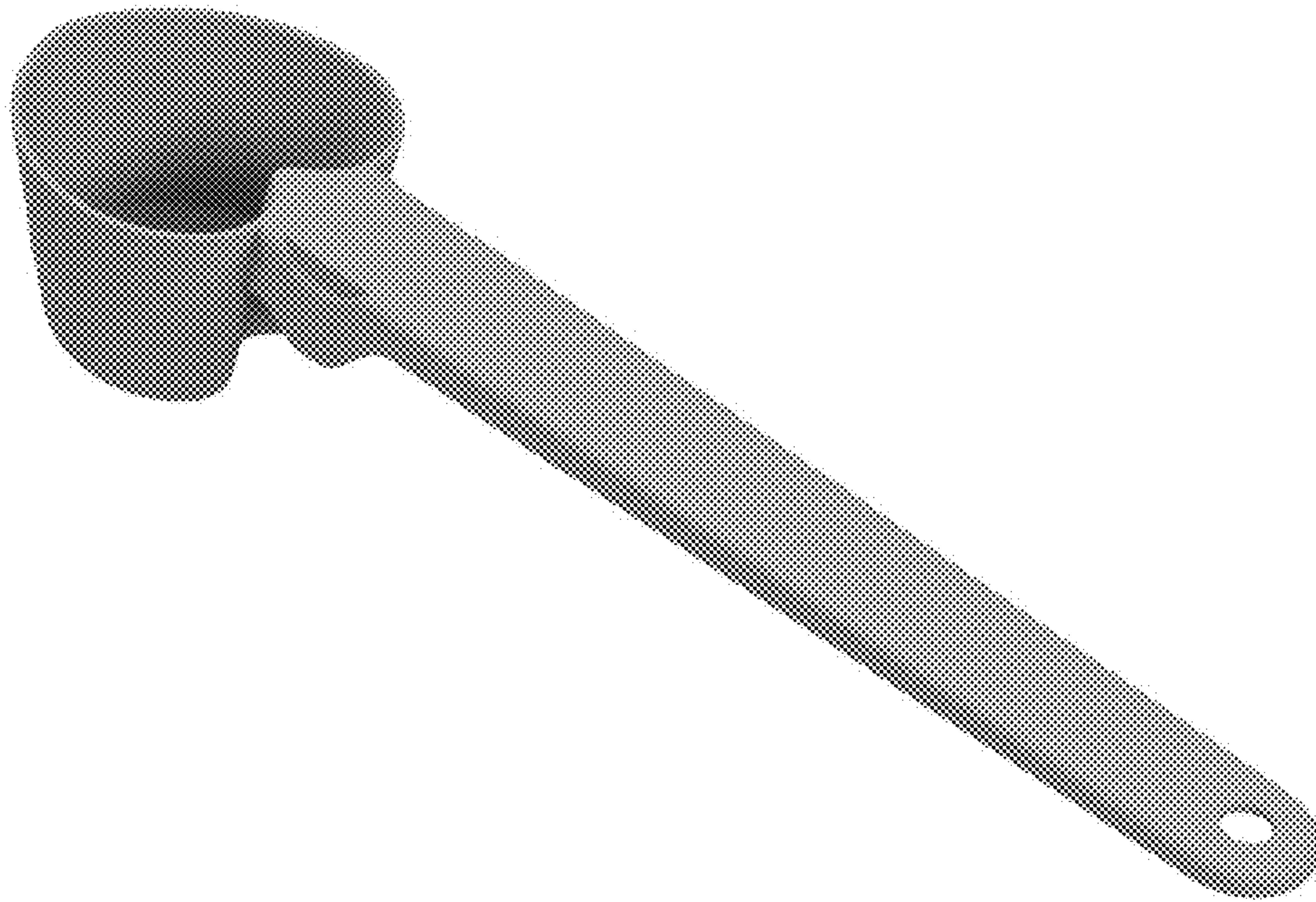

FIG. 2

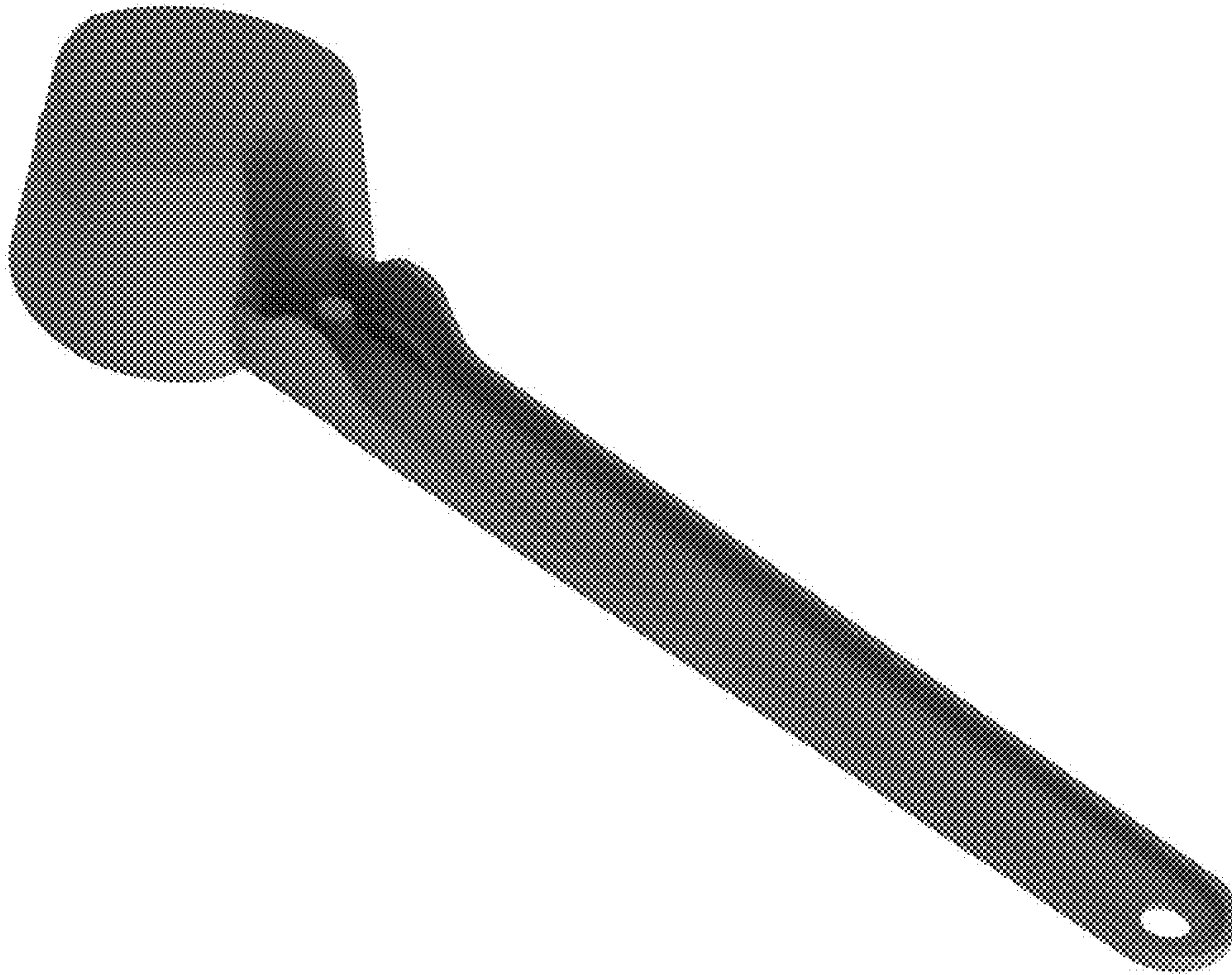

FIG. 3

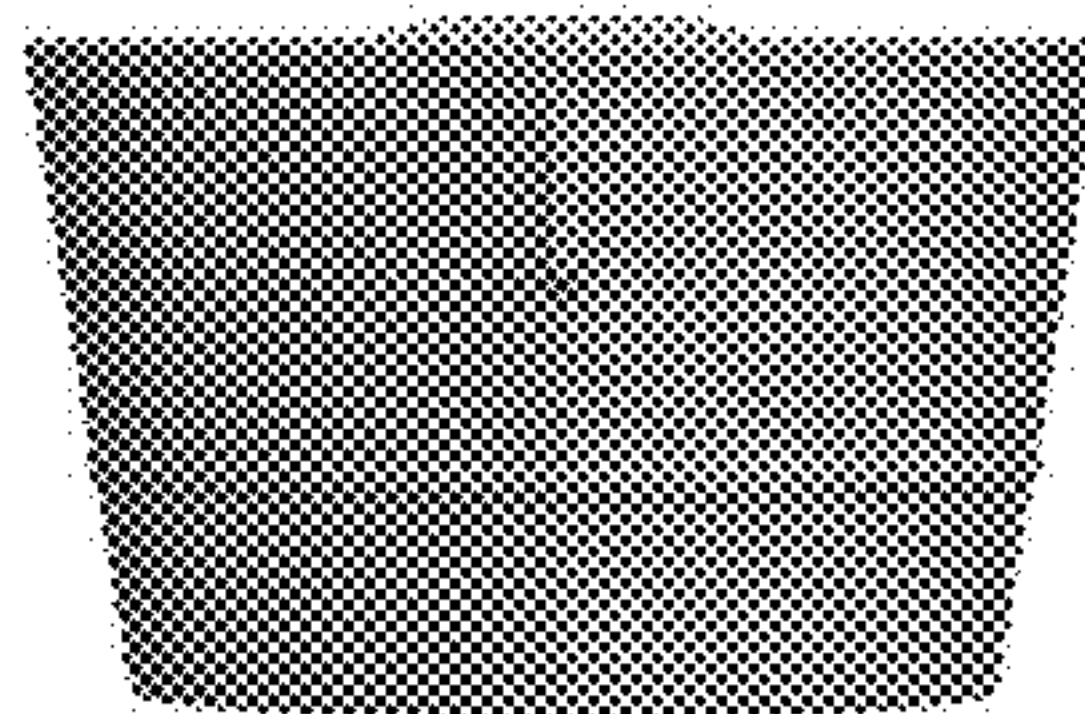

FIG. 4

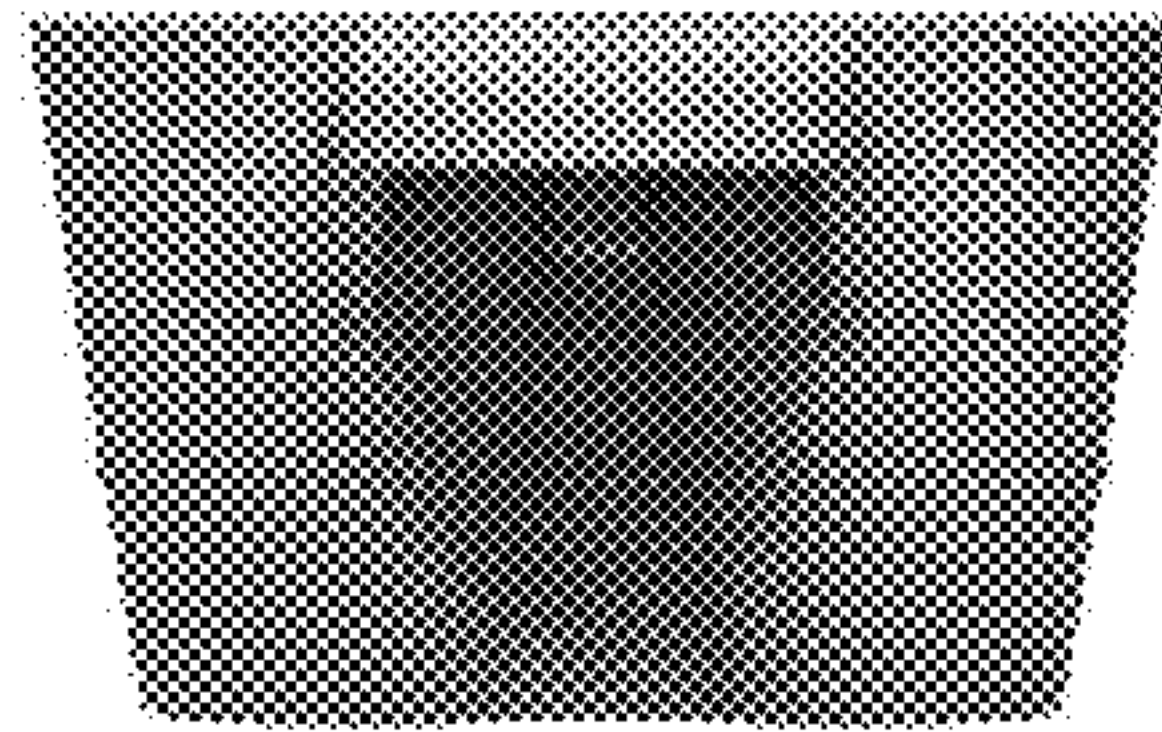

FIG. 5



FIG. 6



FIG. 7