



US00D854602S

(12) **United States Design Patent** (10) **Patent No.:** **US D854,602 S**
Shiono (45) **Date of Patent:** **** Jul. 23, 2019**

(54) **PROJECTOR**

(71) Applicant: **Sony Corporation**, Tokyo (JP)
(72) Inventor: **Daisuke Shiono**, Tokyo (JP)
(73) Assignee: **SONY CORPORATION**, Tokyo (JP)

(**) Term: **15 Years**

(21) Appl. No.: **29/589,616**

(22) Filed: **Jan. 3, 2017**

(30) **Foreign Application Priority Data**

Aug. 30, 2016 (CN) 2016 3 0444703

(51) **LOC (11) Cl.** **16-02**

(52) **U.S. Cl.**
USPC **D16/235**

(58) **Field of Classification Search**
USPC D16/235, 237, 239, 250; D3/271.7;
D6/691, 678.1, 656.16, 686, 693.3, 687,
D6/688, 691.8, 702, 709, 709.21, 708.16,
D6/708.17, 712; D8/373; D18/59
CPC G03B 21/54; G03B 21/145; F16M 11/00;
F16M 11/04; F16M 11/18
See application file for complete search history.

(56) **References Cited**

U.S. PATENT DOCUMENTS

2,860,024 A * 11/1958 Kappel G03B 21/54
217/62
D218,575 S * 9/1970 Wally, Jr. D16/235
4,148,453 A * 4/1979 Brantly F16M 11/14
211/26
D259,454 S * 6/1981 Gudgel D16/235
D568,292 S 5/2008 Tsuge

(Continued)

FOREIGN PATENT DOCUMENTS

JP D1115365 S 7/2001
JP D1452905 S 10/2012
KR 30-0627847 S 1/2012

OTHER PUBLICATIONS

Sony Ultra Short Throw Projector LSPX-A1. Published Jan. 8, 2018. Retrieved on Oct. 17, 2018. Retrieved from the Internet: <URL: https://www.cnet.com/pictures/sony-ultra-short-throw-projector-lspx-a1/2/>.*

Primary Examiner — Wan Laymon

(74) *Attorney, Agent, or Firm* — Michael Best and Friedrich LLP

(57) **CLAIM**

The ornamental design for a projector, as shown and described.

DESCRIPTION

FIG. 1 is a perspective view of a first embodiment of a projector showing my new design; FIG. 2 is a front elevational view thereof; FIG. 3 is a rear elevational view thereof; FIG. 4 is a left side elevational view thereof; and FIG. 5 is a top plan view thereof. FIG. 6 is a perspective view of a second embodiment of a projector showing my new design; FIG. 7 is a front elevational view thereof; FIG. 8 is a rear elevational view thereof; FIG. 9 is a left side elevational view thereof; and FIG. 10 is a top plan view thereof. FIG. 11 is a perspective view of a third embodiment of a projector showing my new design; FIG. 12 is a front elevational view thereof; FIG. 13 is a rear elevational view thereof; FIG. 14 is a left side elevational view thereof; and, FIG. 15 is a top plan view thereof. The even-dash broken lines illustrate unclaimed portions of the projector and form no part of the claimed design. The dot-dash broken lines define the boundaries of the claimed design and form no part of the claimed design.

1 Claim, 15 Drawing Sheets

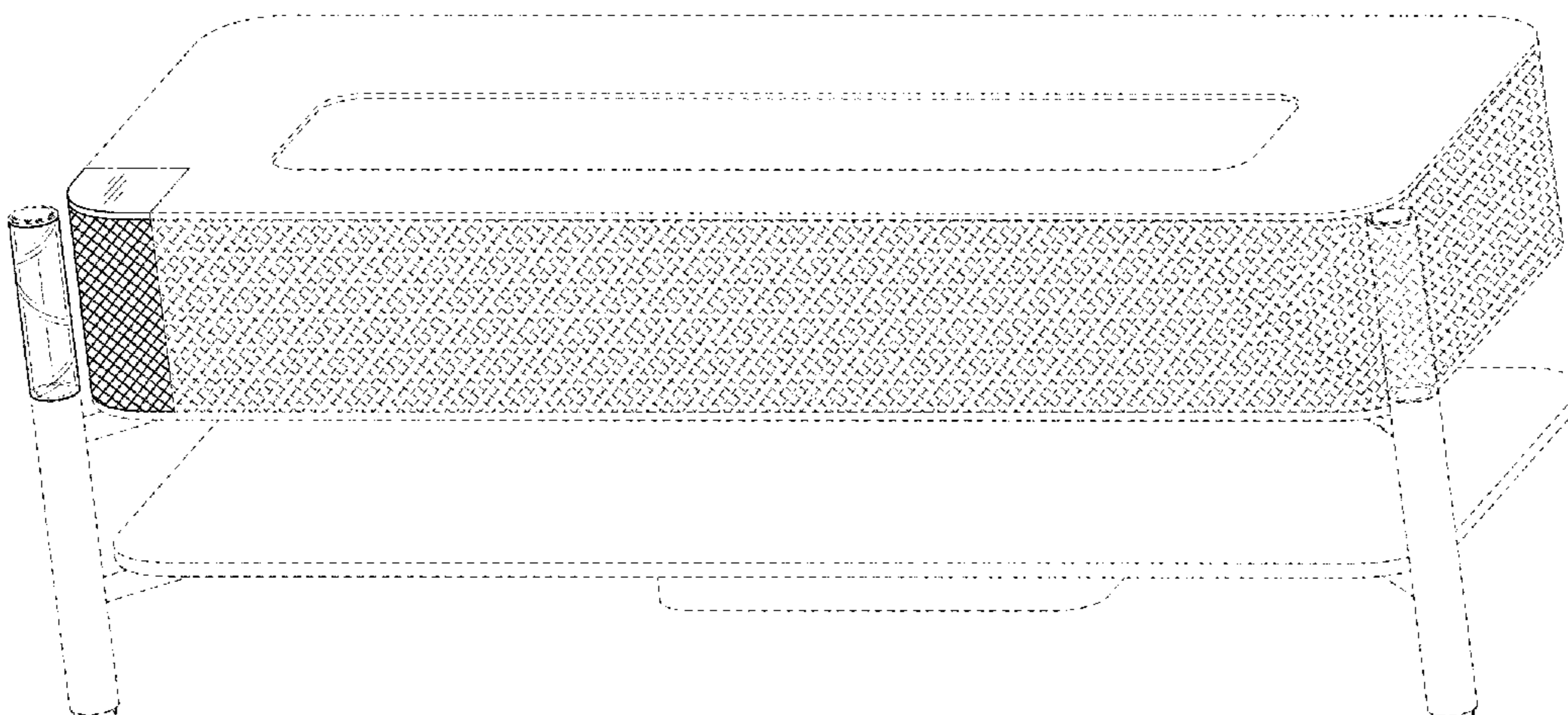

(56)

References Cited

U.S. PATENT DOCUMENTS

8,820,702 B2 *	9/2014	Lin	G03B 21/145
			211/26
D767,663 S	9/2016	Tsujita	
2016/0198842 A1 *	7/2016	Kang	F16M 11/18
			108/1

* cited by examiner

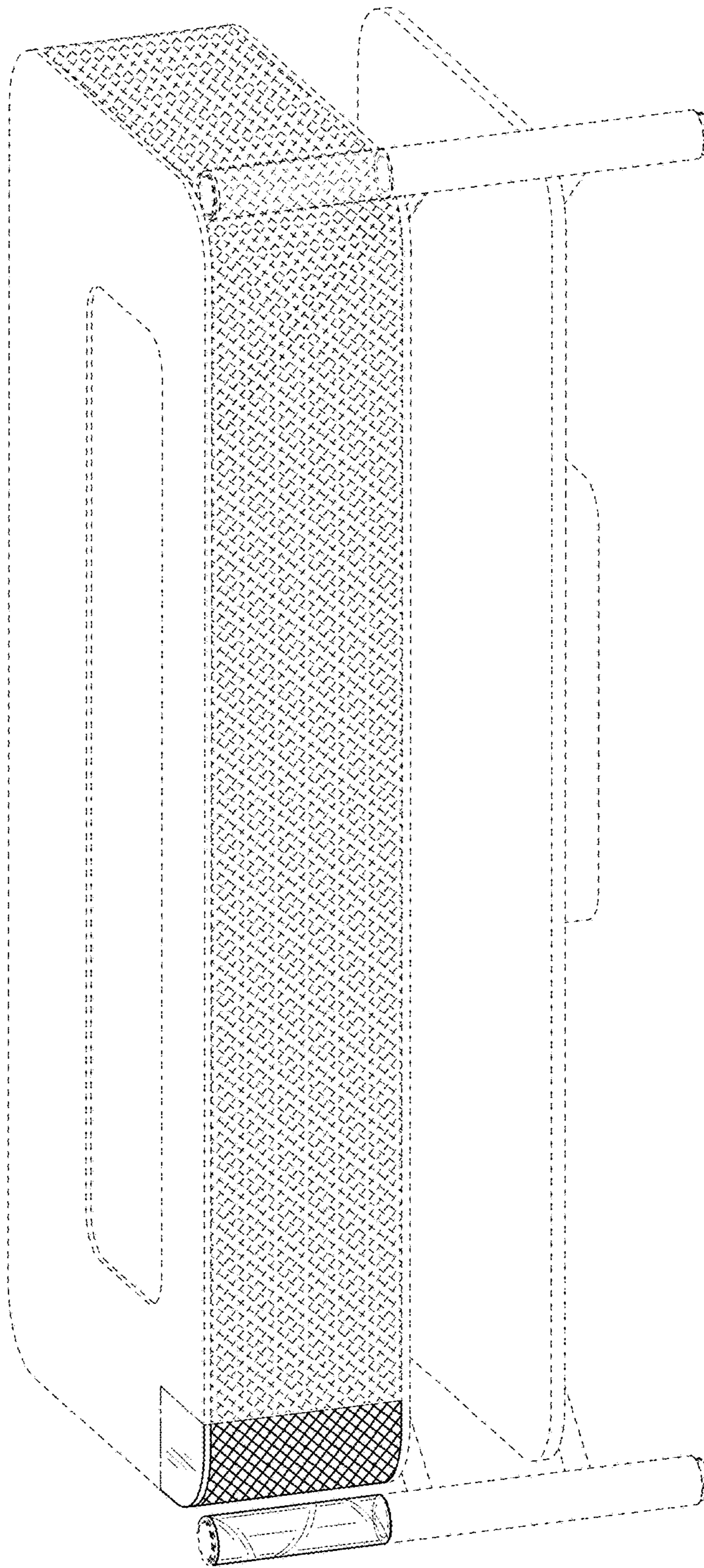

FIG. 1

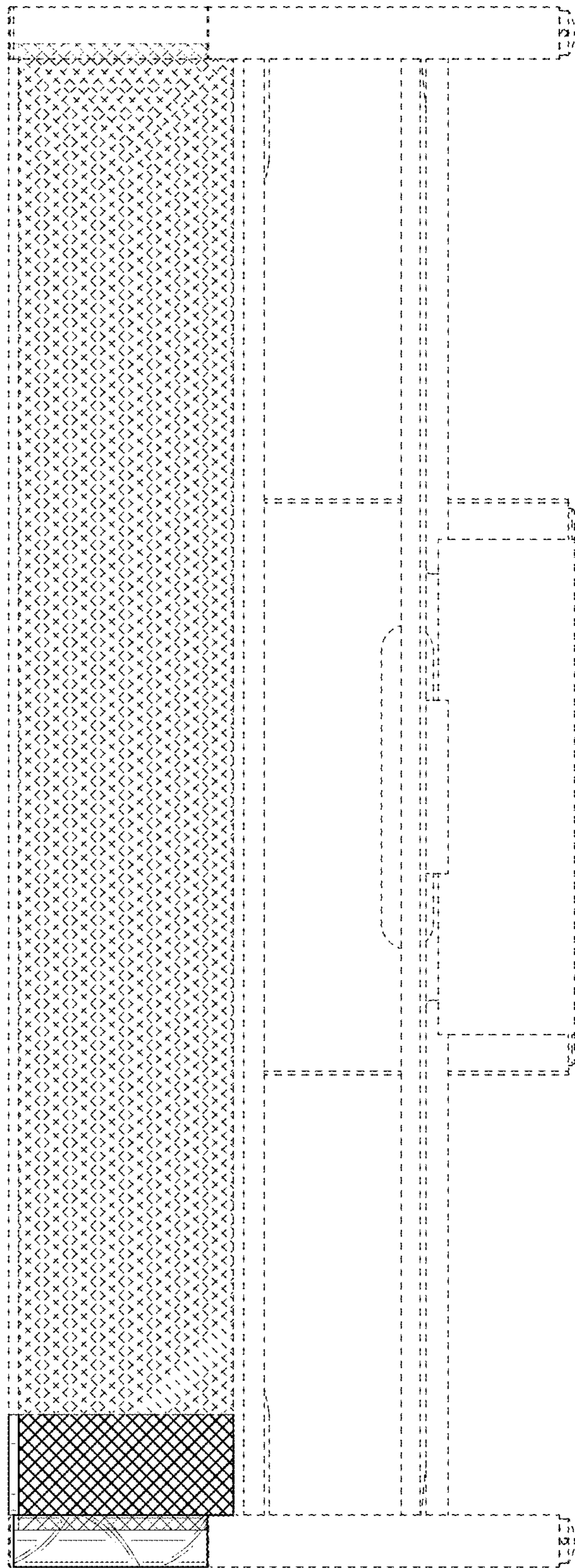

FIG. 2

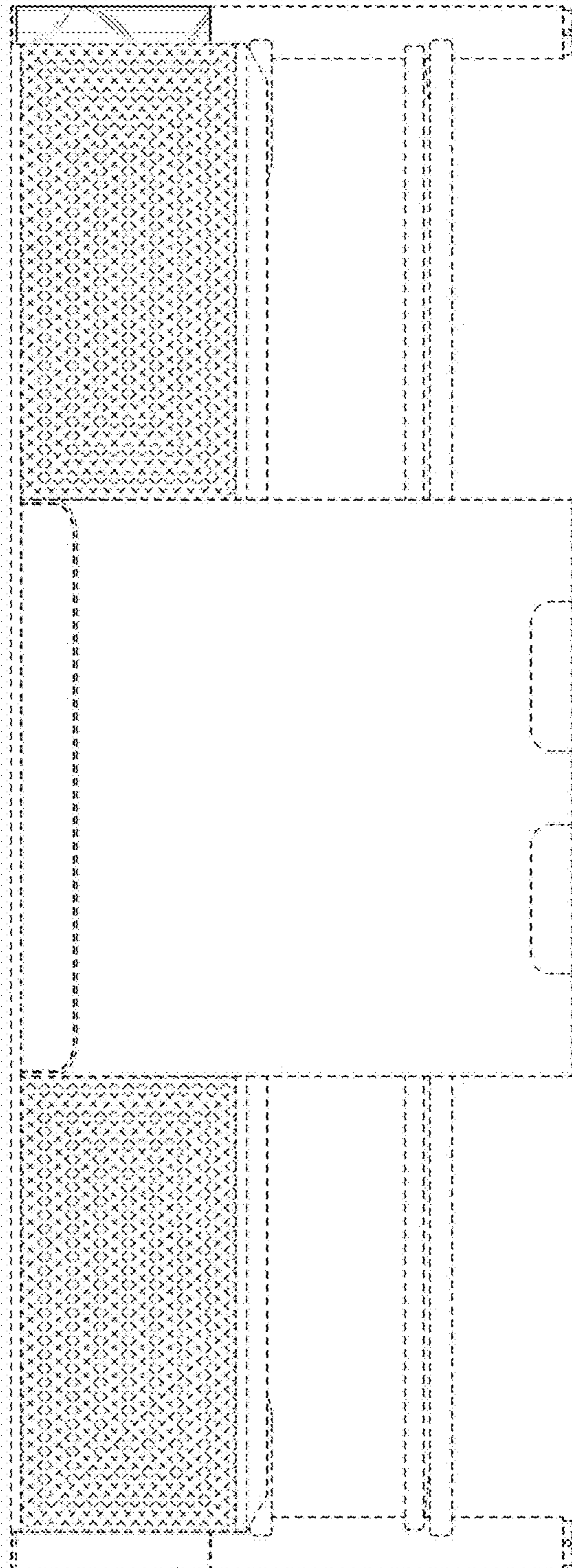

FIG. 3

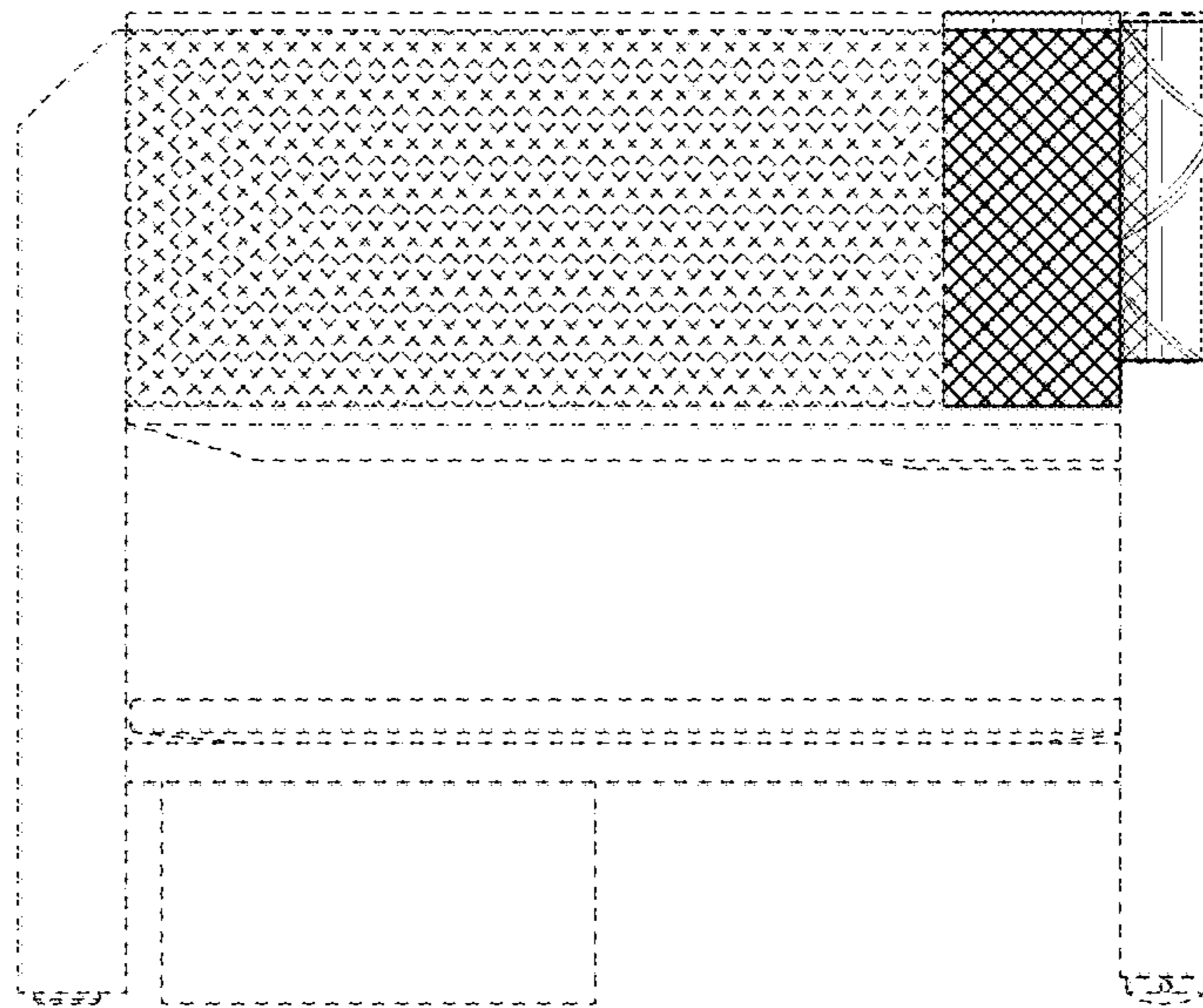

FIG. 4

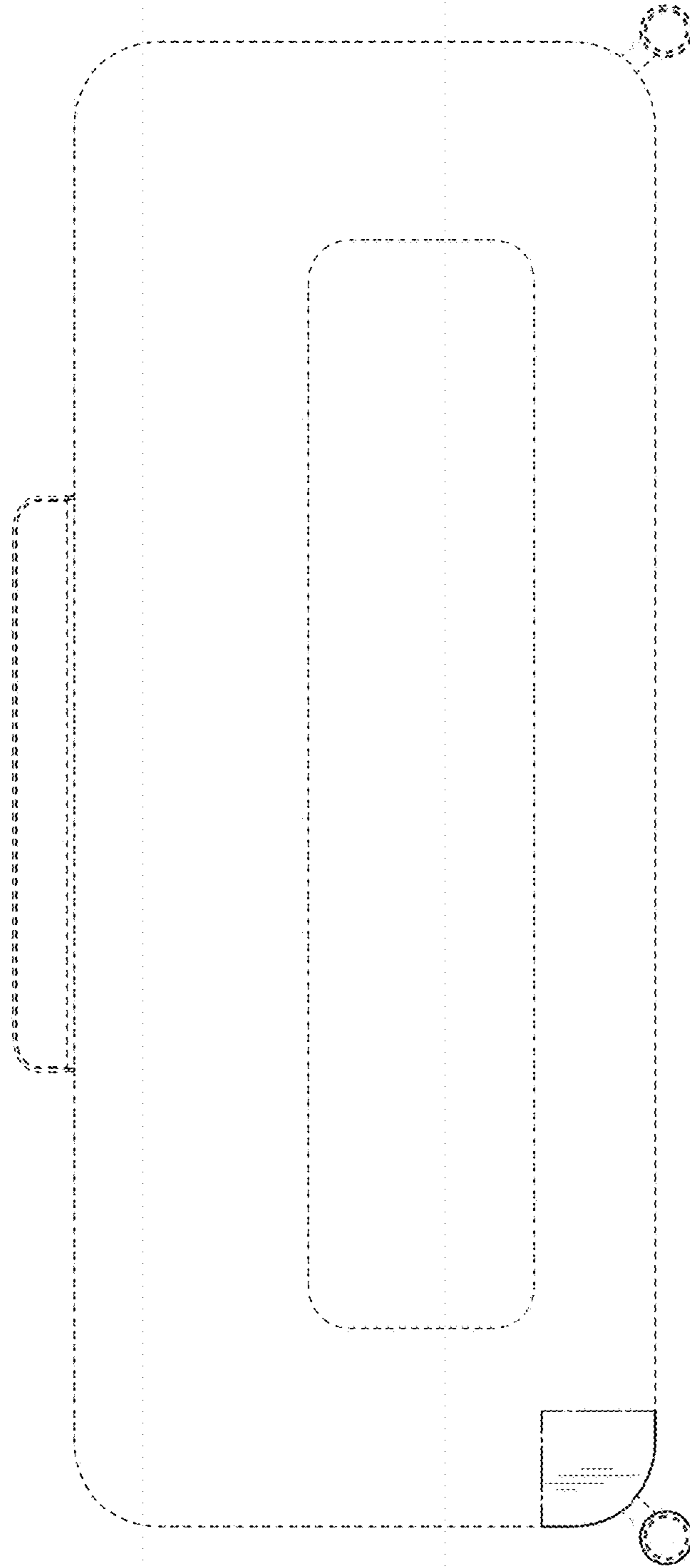

FIG. 5

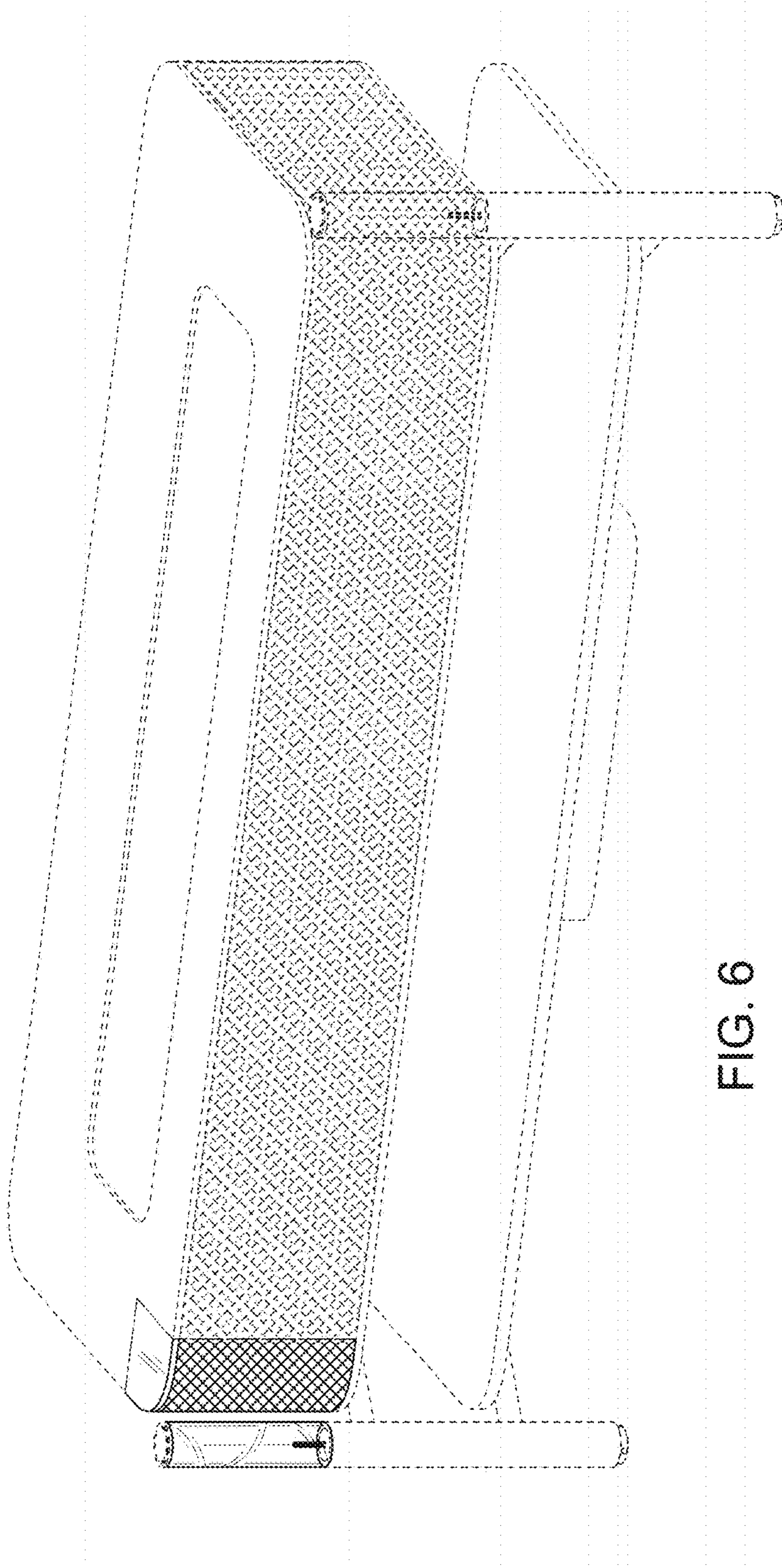

FIG. 6

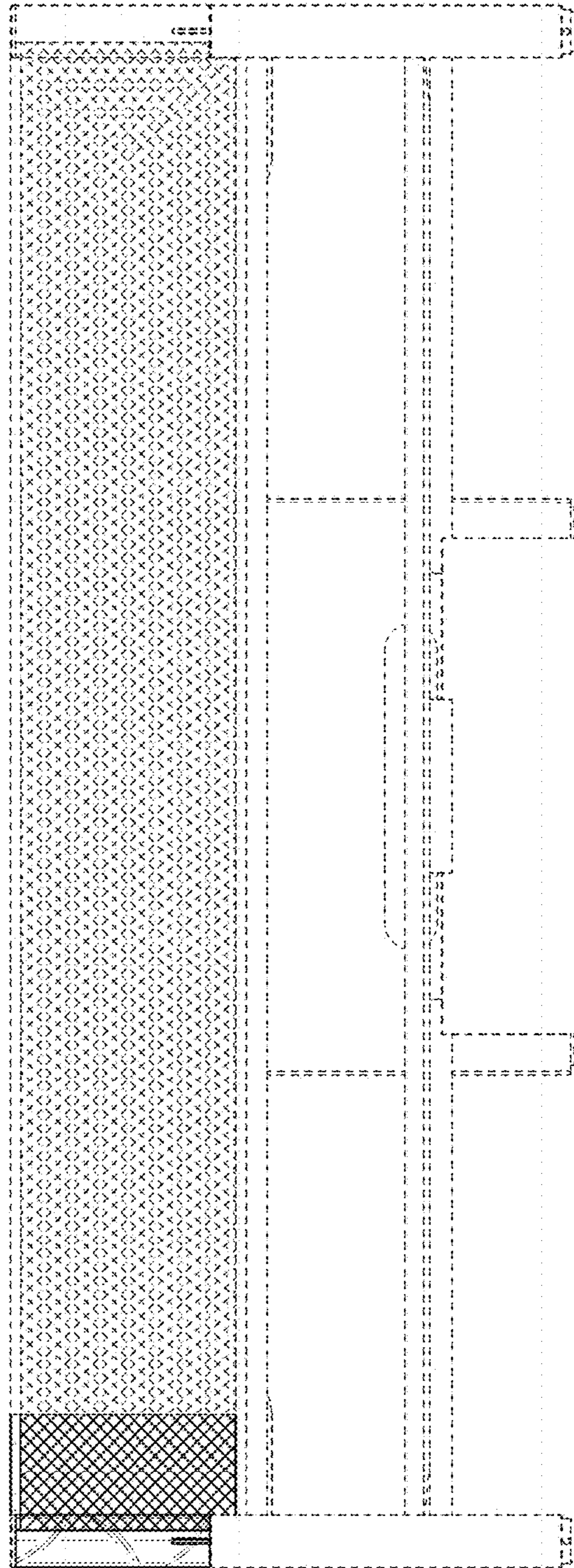

FIG. 7

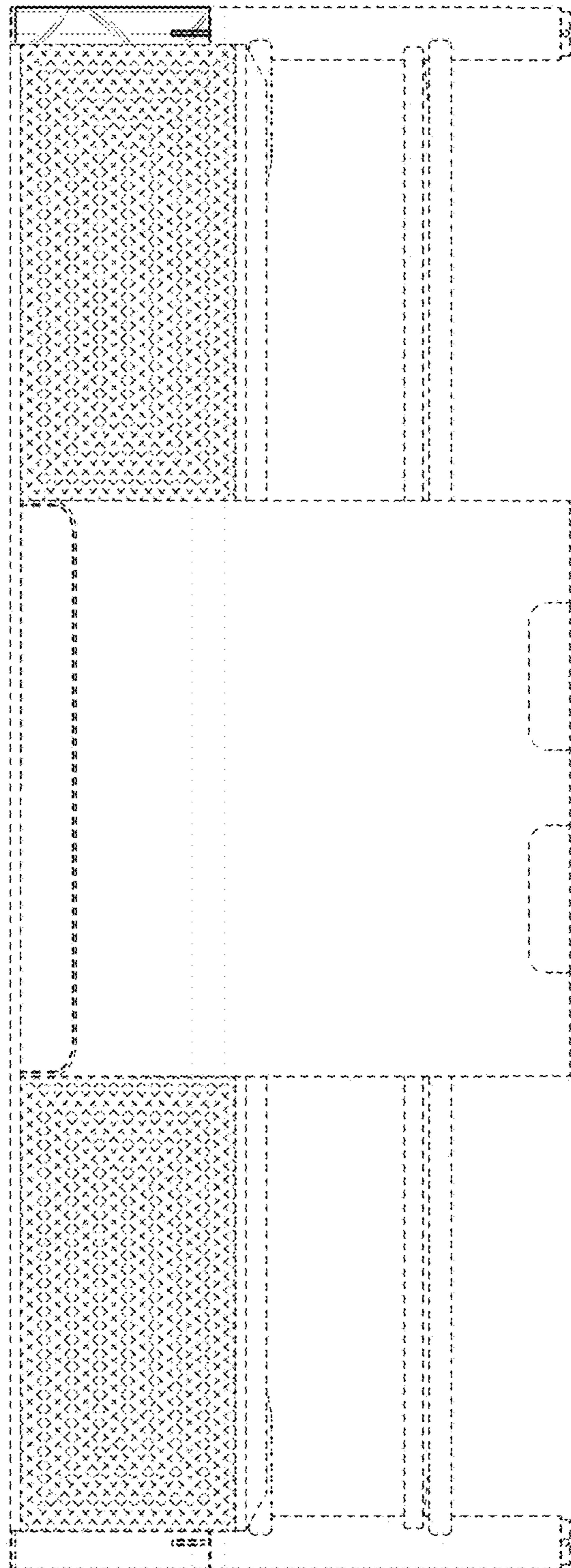

FIG. 8

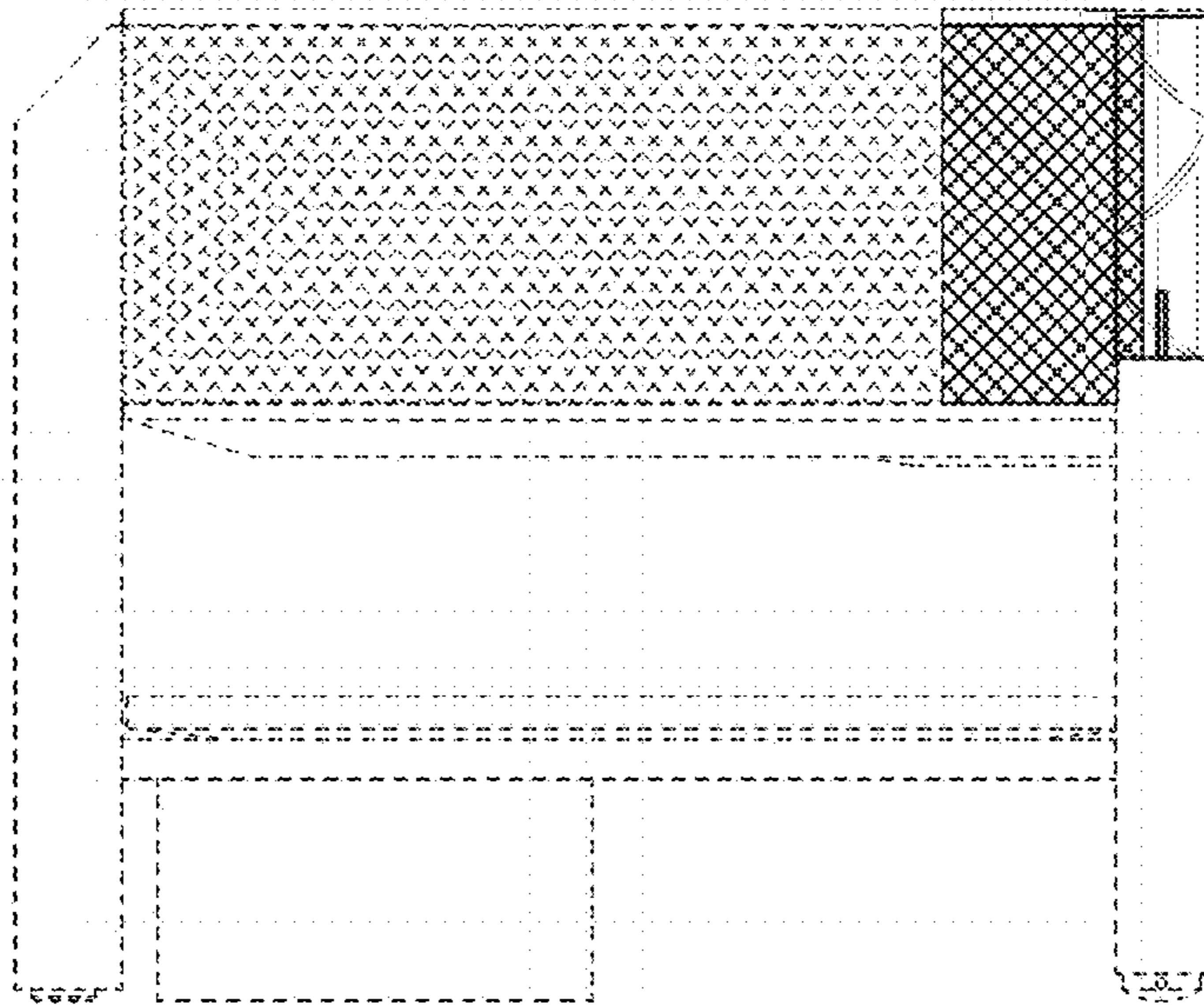

FIG. 9

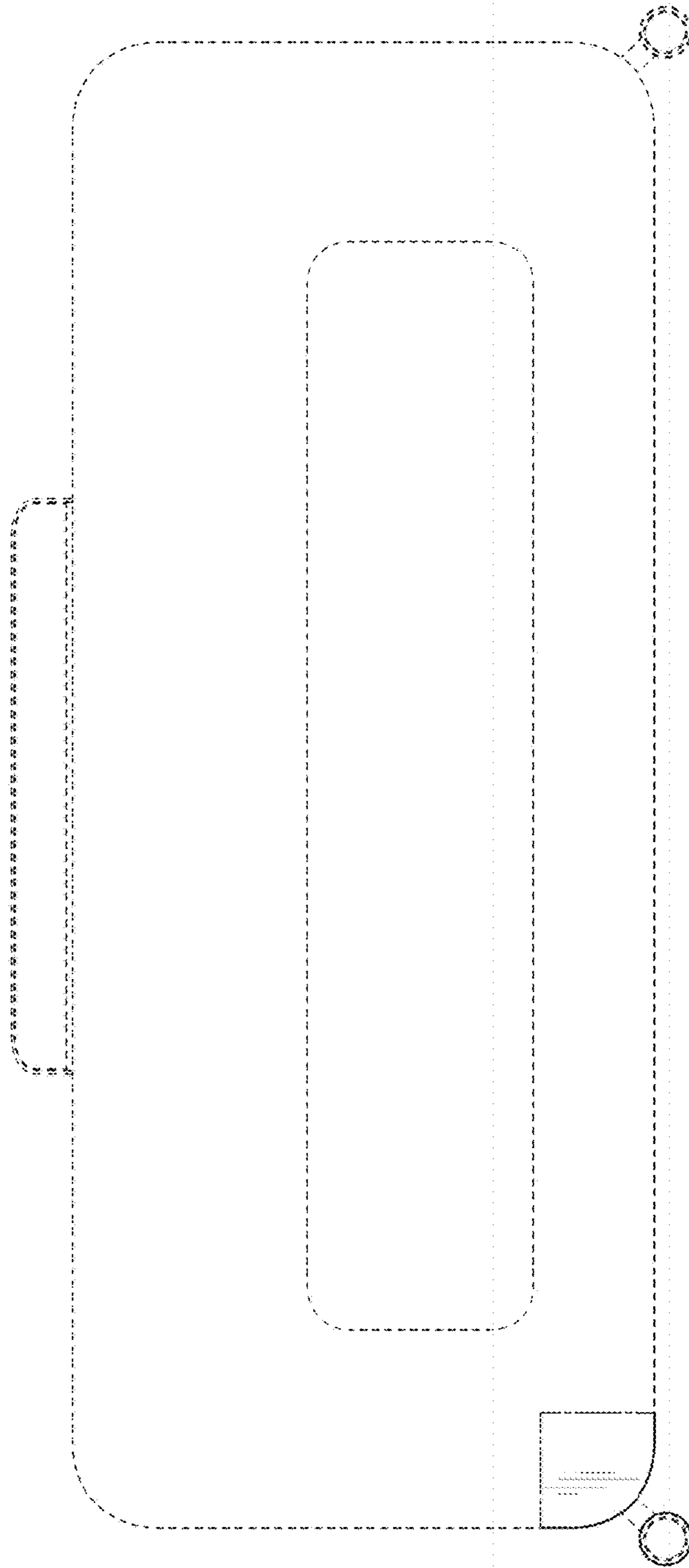

FIG. 10

FIG.11

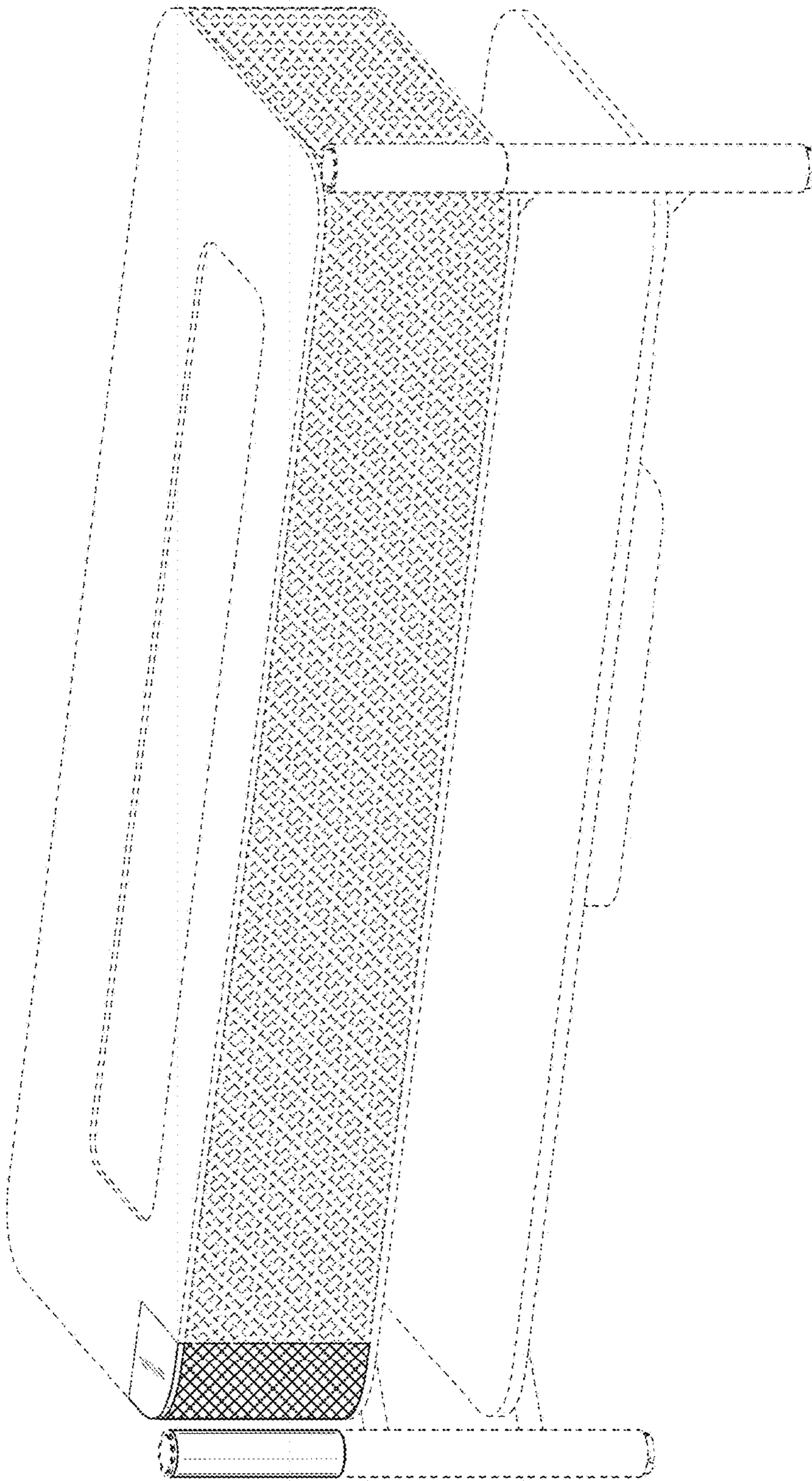

FIG.12

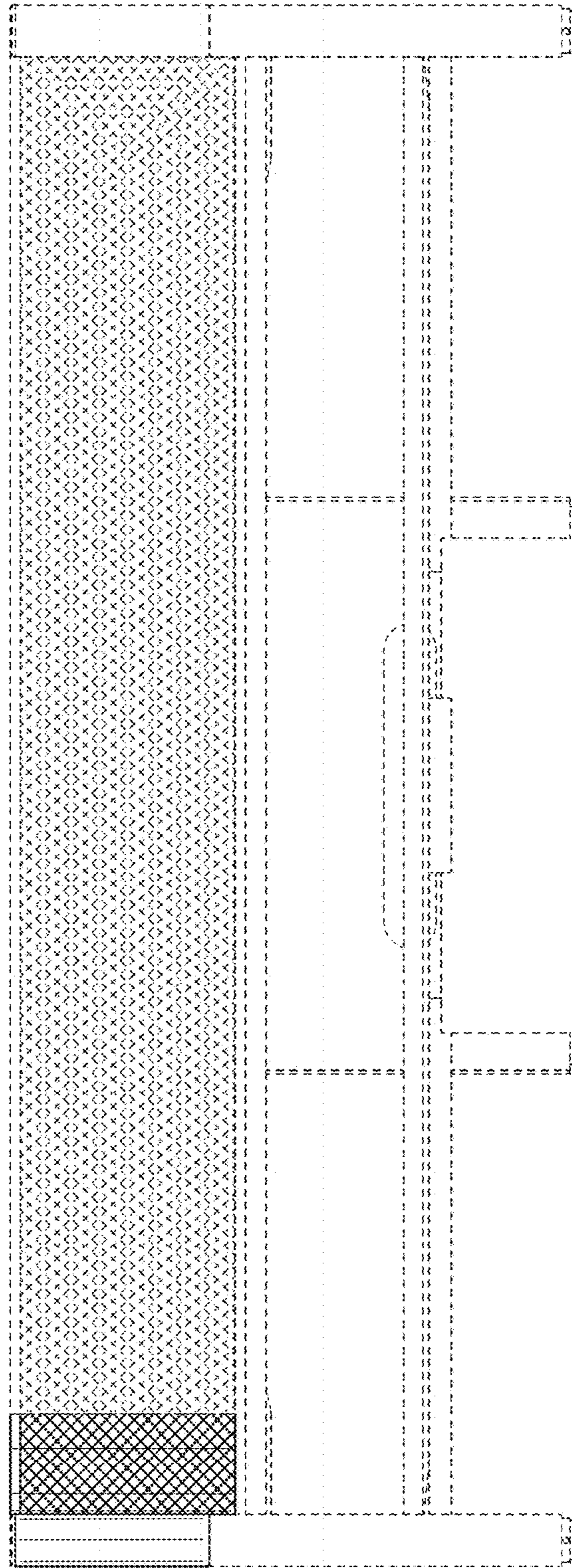

FIG. 13

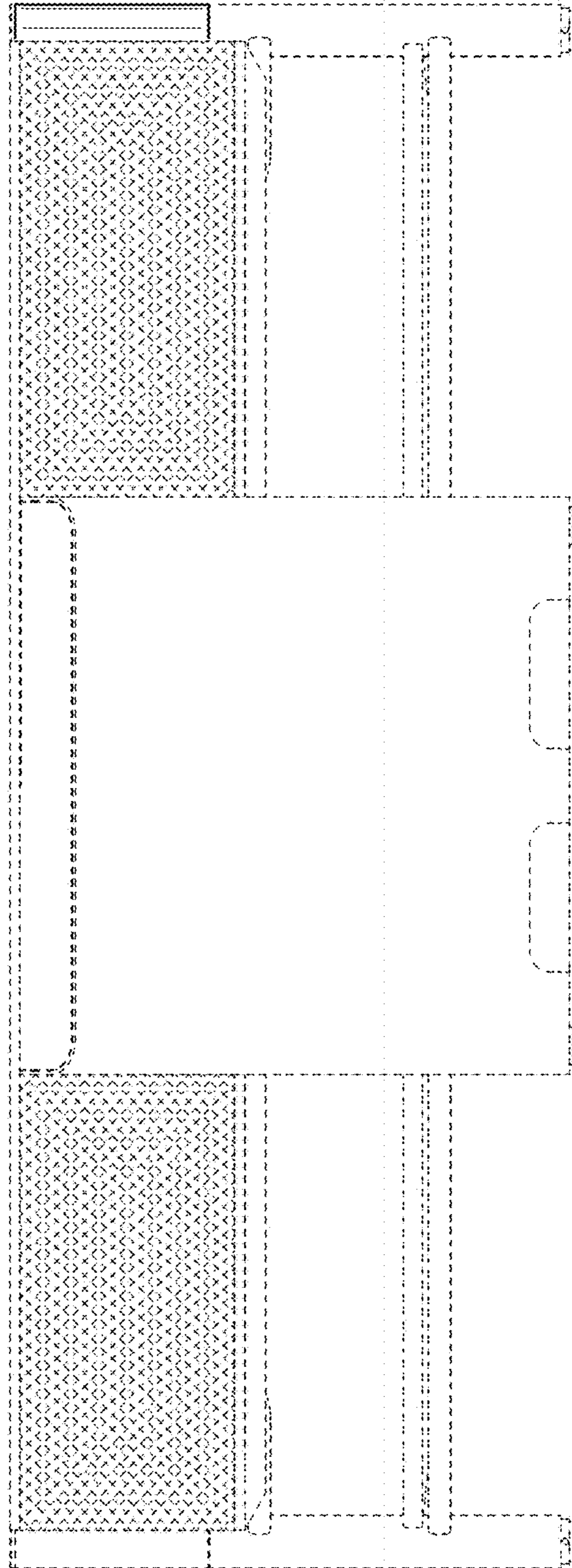

FIG.14

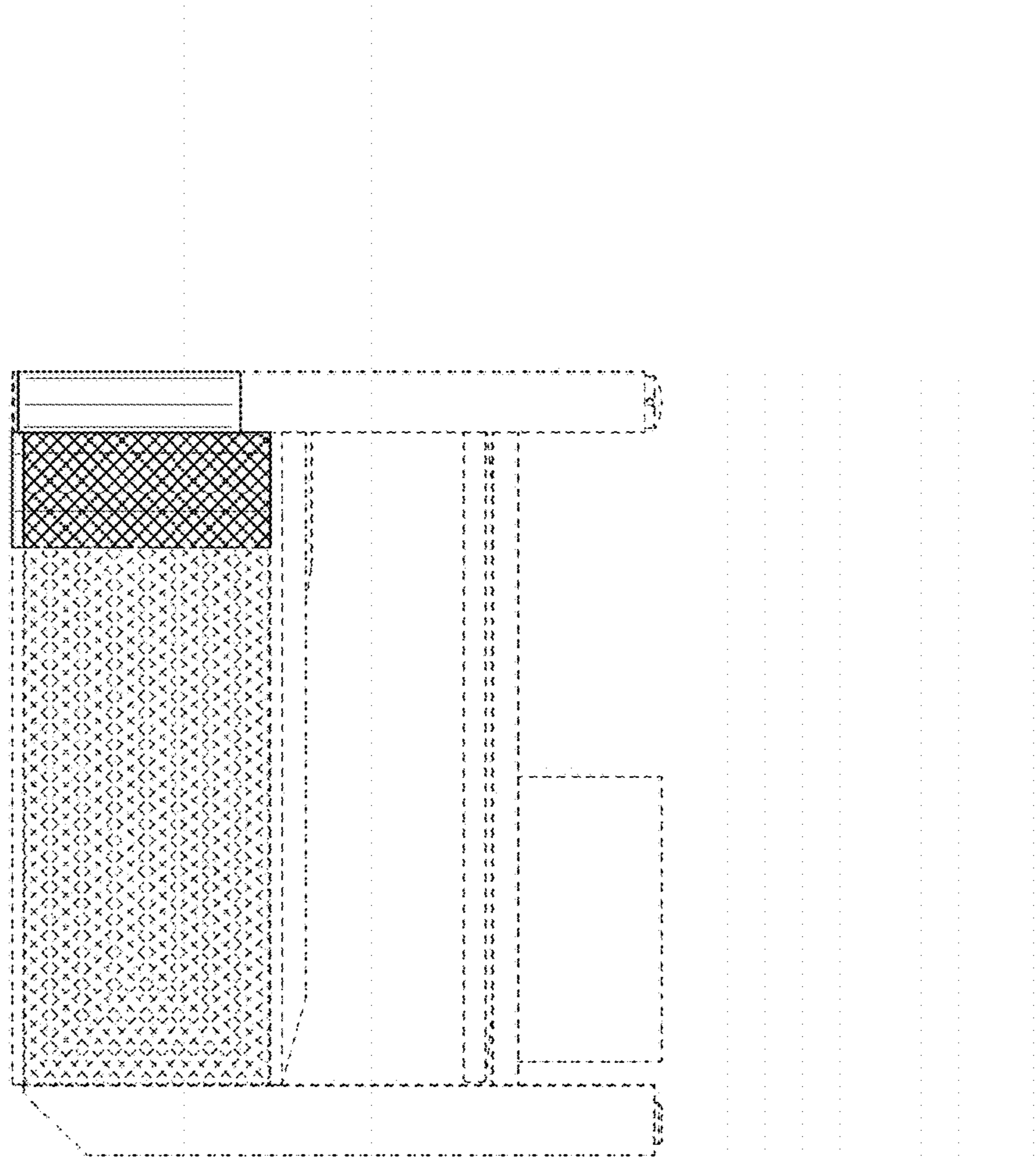

FIG.15

