



US00D854080S

(12) **United States Design Patent** (10) **Patent No.:** **US D854,080 S**
Senshiki et al. (45) **Date of Patent:** **** Jul. 16, 2019**

(54) **PRINTING MACHINE**

(56) **References Cited**

(71) Applicant: **CANON KABUSHIKI KAISHA**,
Tokyo (JP)
(72) Inventors: **Yasunori Senshiki**, Tokyo (JP); **Hiroki Nakanishi**, Tokyo (JP); **Fumi Nihei**, Tokyo (JP)

U.S. PATENT DOCUMENTS

D236,547 S *	8/1975	Clayton et al.	D18/53
D277,766 S *	2/1985	Schott	D14/305
D322,452 S *	12/1991	Peters	D18/59
D343,857 S *	2/1994	Clary	D18/50
D347,837 S *	6/1994	Gerlach	D14/299
D354,764 S *	1/1995	Tokuda	347/108
D412,525 S *	8/1999	Tachibana	D18/53
D453,785 S *	2/2002	Grossmann	D18/48
D523,070 S *	6/2006	Schneider	D18/50
D531,206 S *	10/2006	Hegge	D18/53
D621,442 S *	8/2010	Kachi	D18/39
D663,768 S *	7/2012	Yanagisawa	D18/53
D673,212 S *	12/2012	Okamoto	D18/53
D823,385 S *	7/2018	Senshiki	D18/53

(**) Term: **15 Years**

(21) Appl. No.: **35/504,488**

(22) Filed: **Aug. 22, 2017**

(80) **Hague Agreement Data**

Int. Filing Date: **Aug. 22, 2017**
Int. Reg. No.: **DM/097459**
Int. Reg. Date: **Aug. 22, 2017**
Int. Reg. Pub. Date: **Feb. 23, 2018**

* cited by examiner

Primary Examiner — Richard E Chilcot

(57) **CLAIM**

The ornamental design for a printing machine, as shown and described.

(30) **Foreign Application Priority Data**

Feb. 28, 2017 (JP) 2017-003958

(51) **LOC (11) Cl.** **18-02**

(52) **U.S. Cl.**
USPC **D18/53**
CPC **G06K 15/12 (2013.01)**

(58) **Field of Classification Search**
USPC D18/50-59, 36-45, 34.4-34.6; D14/301, D14/307
CPC G06K 15/12; G06K 15/14; H04N 1/00204; H04N 1/00249; H04N 1/00278; B41J 3/00; B41J 3/28; B41J 3/445; B41J 3/46
See application file for complete search history.

DESCRIPTION

- 1. Printing machine
- 1.1 : Front
- 1.2 : Back
- 1.3 : Top
- 1.4 : Bottom
- 1.5 : Left
- 1.6 : Right
- 1.7 : Perspective
- 1.8 : Sectional view

Reproduction no. **1.8** is a vertical sectional view cut along the line between the doors at the upper part of the product in reproduction no. **1.2**.

1 Claim, 8 Drawing Sheets

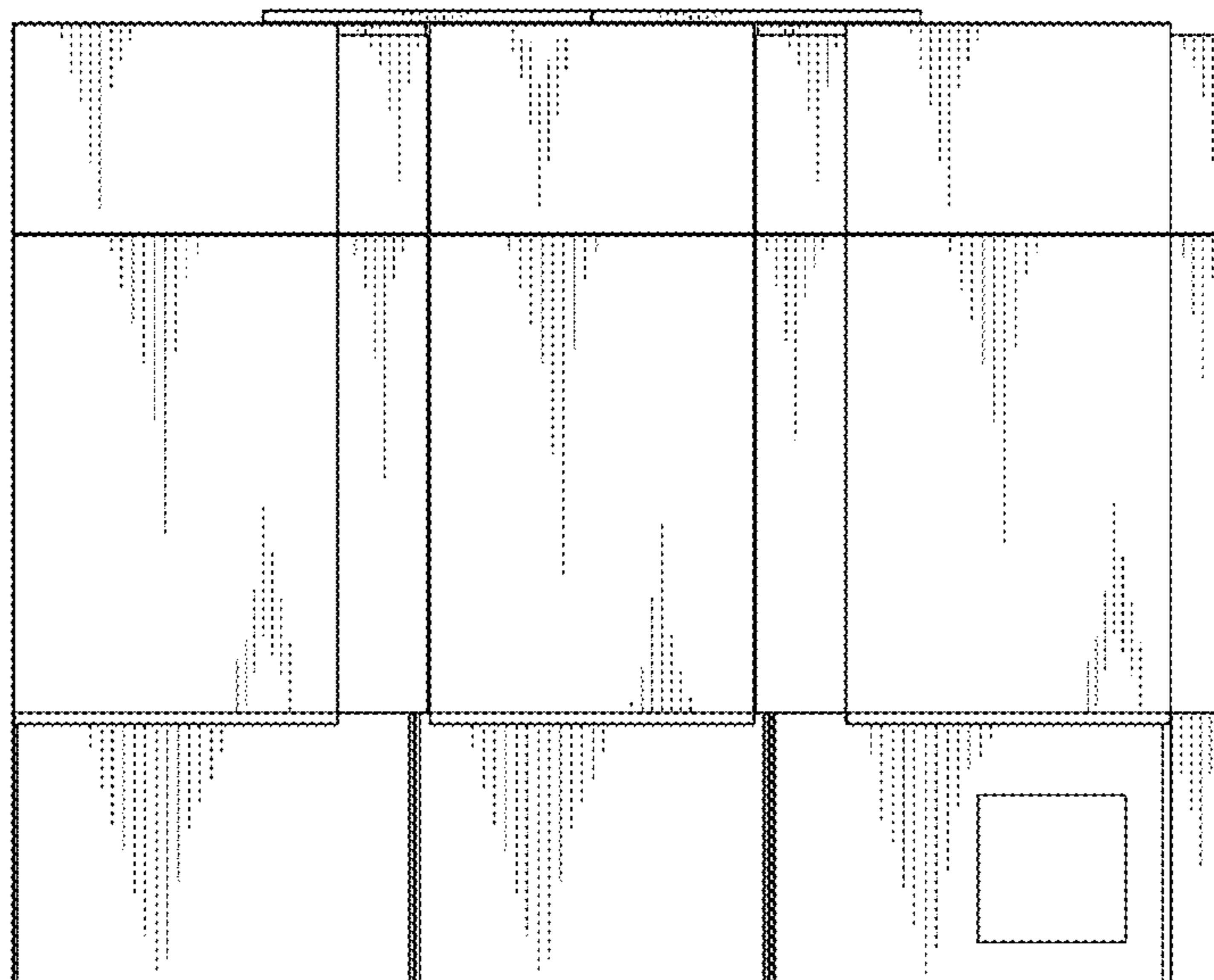

1.1

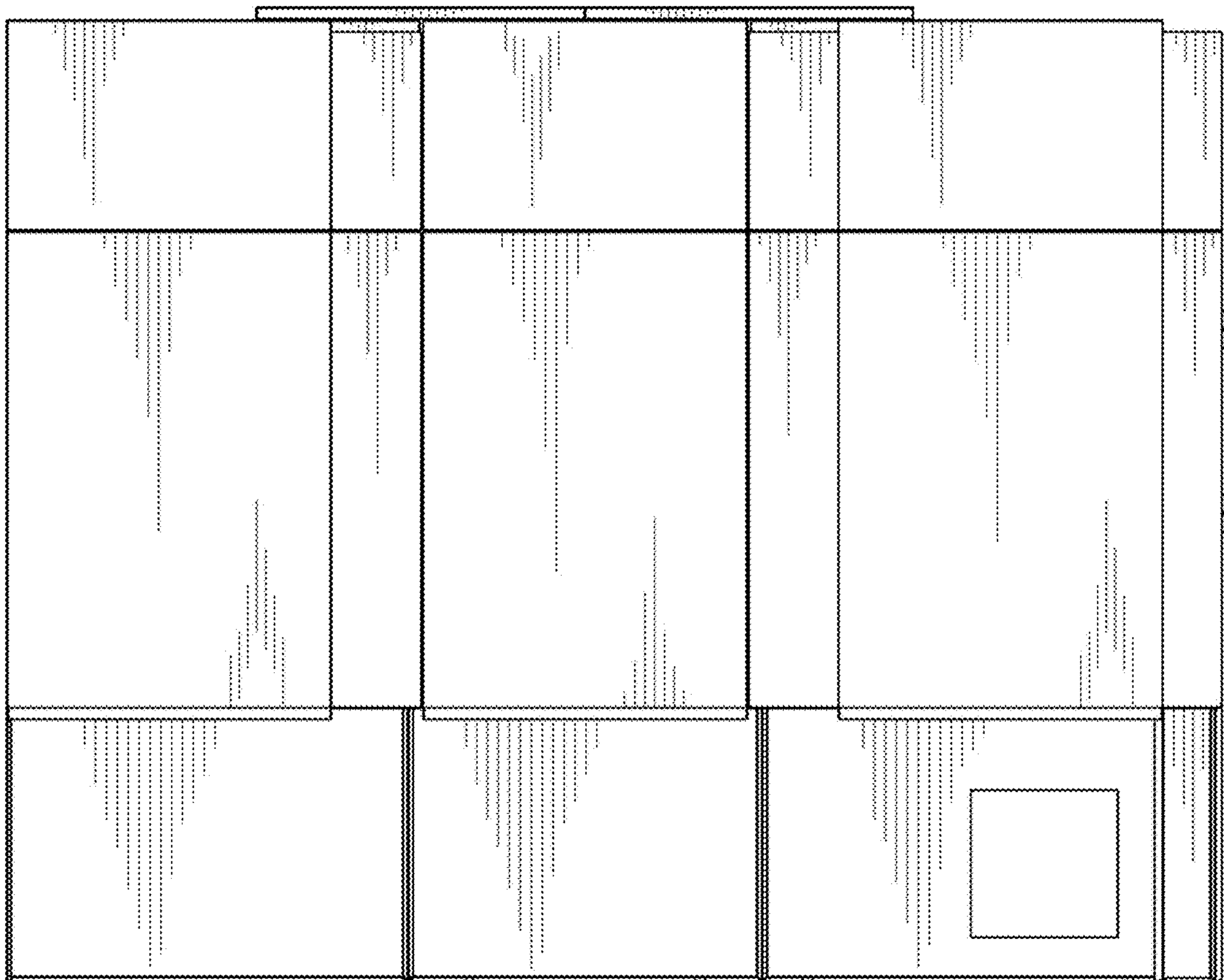

1.2

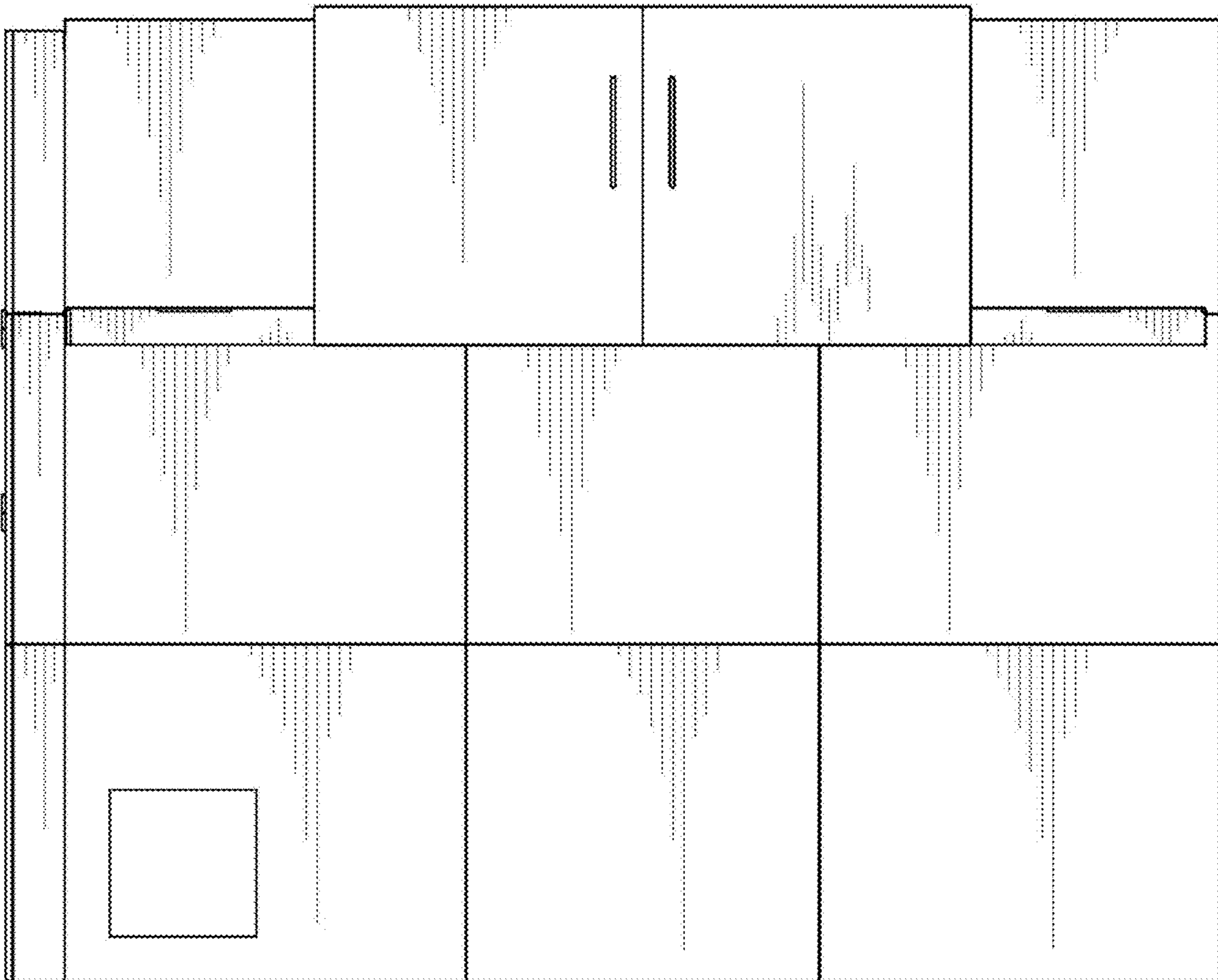

1.3

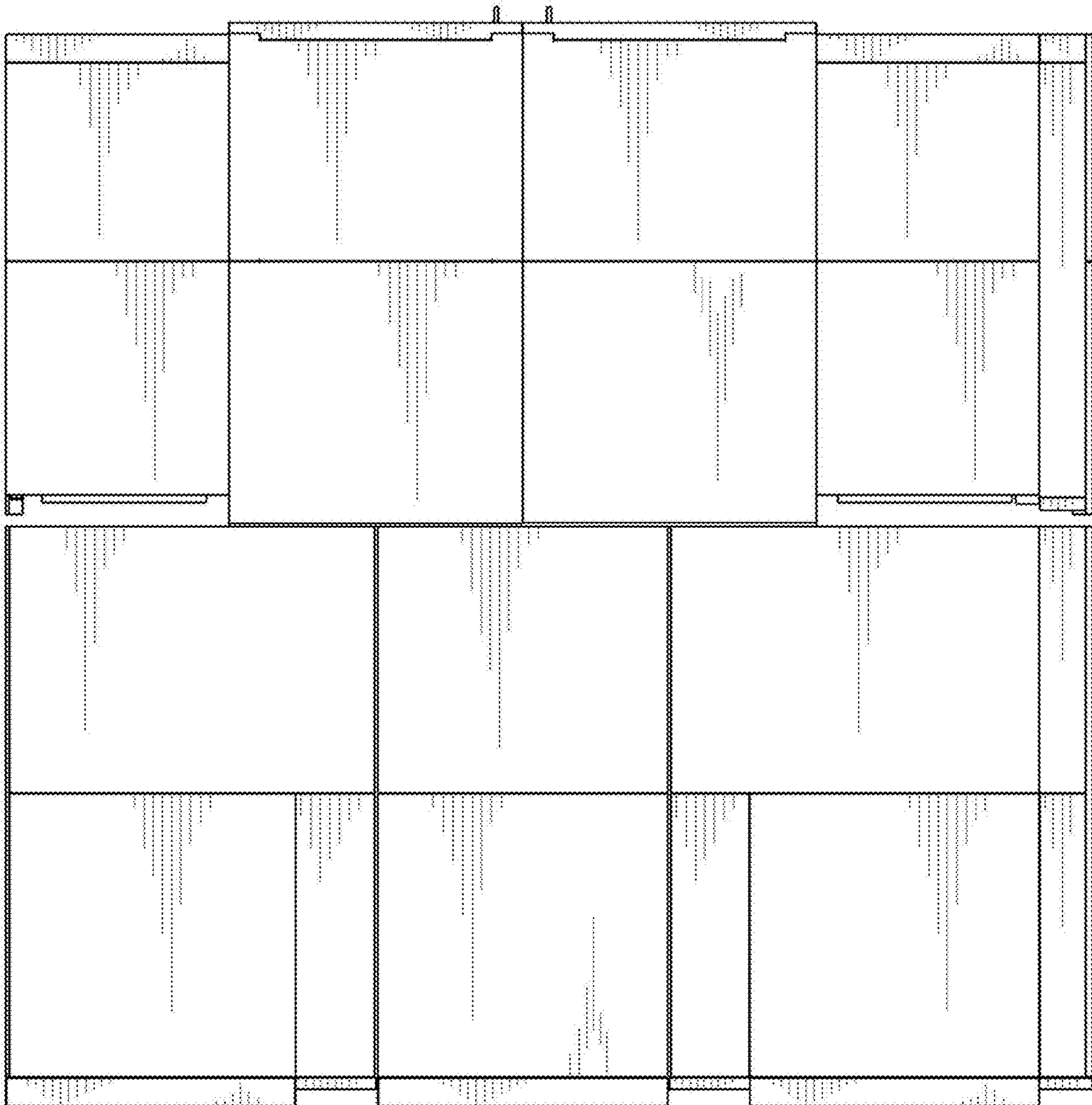

1.4

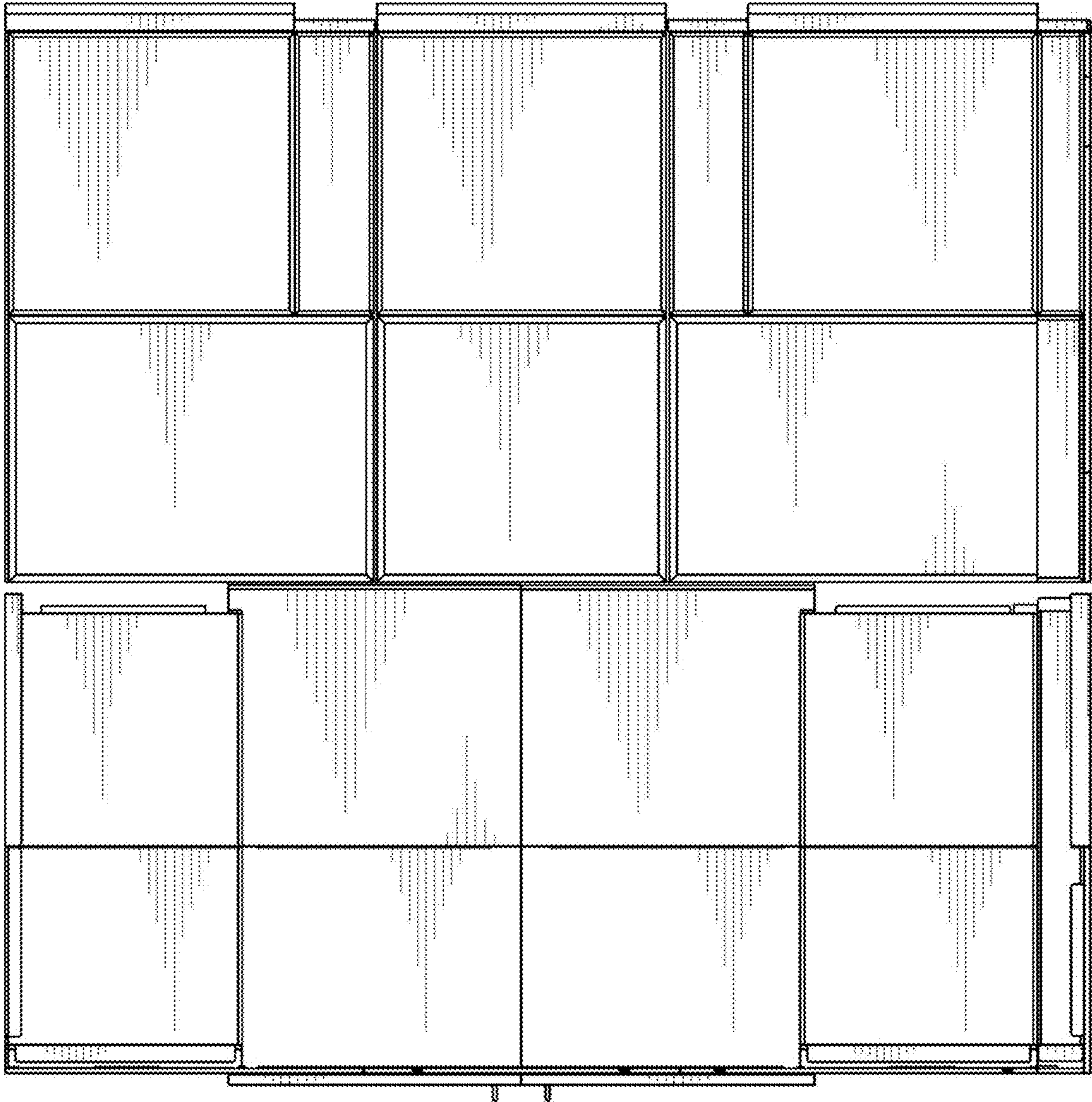

1.5

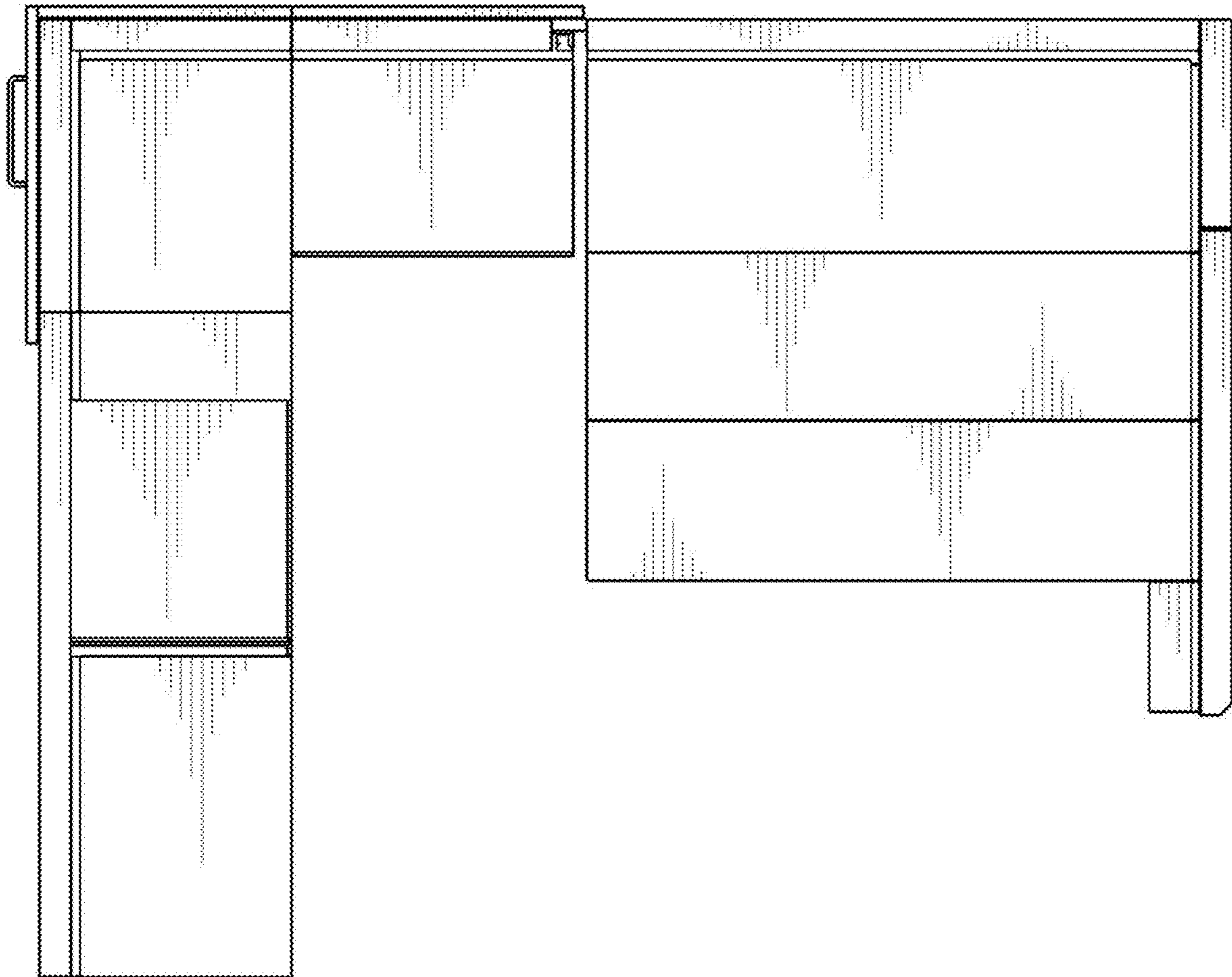

1.6

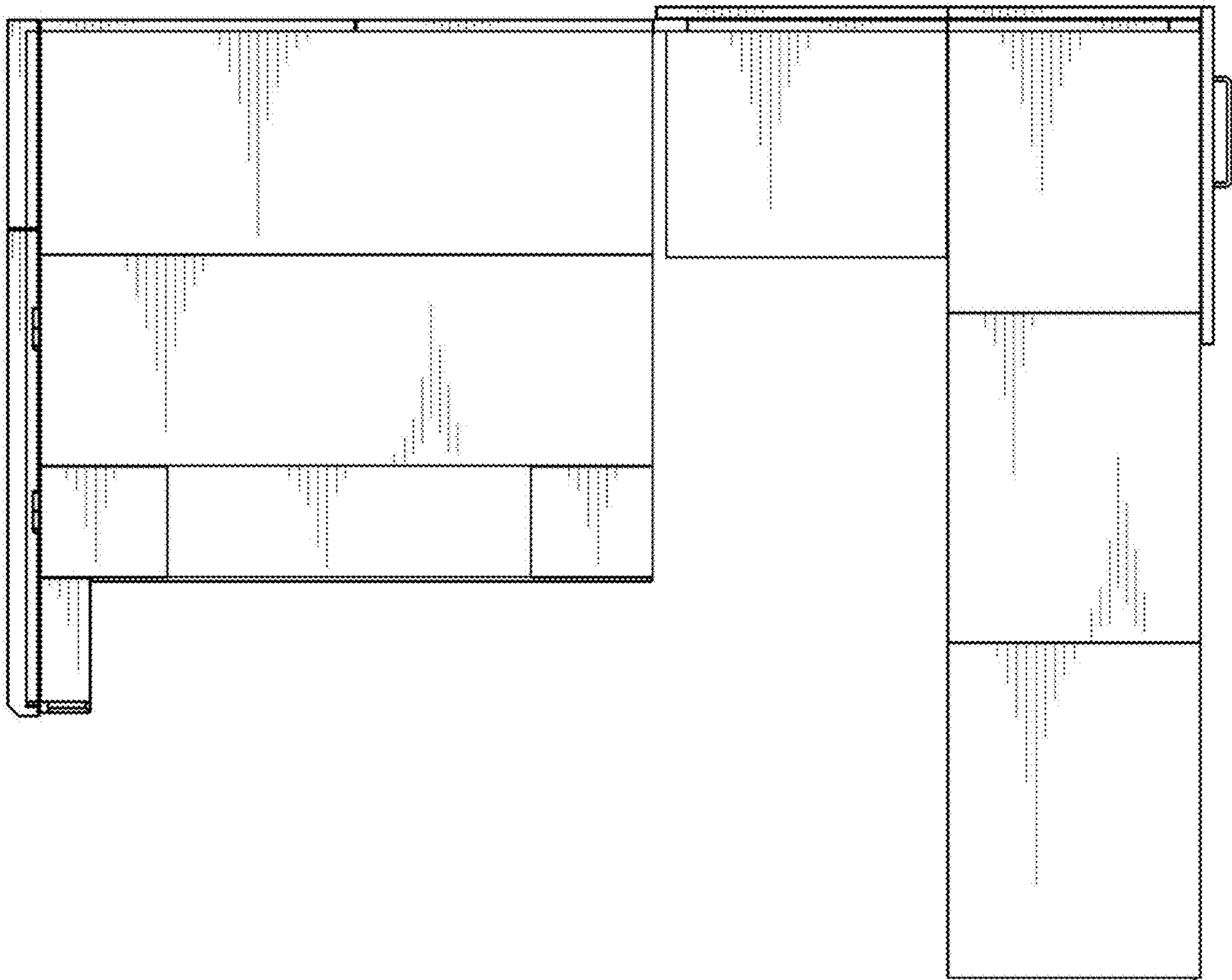

1.7

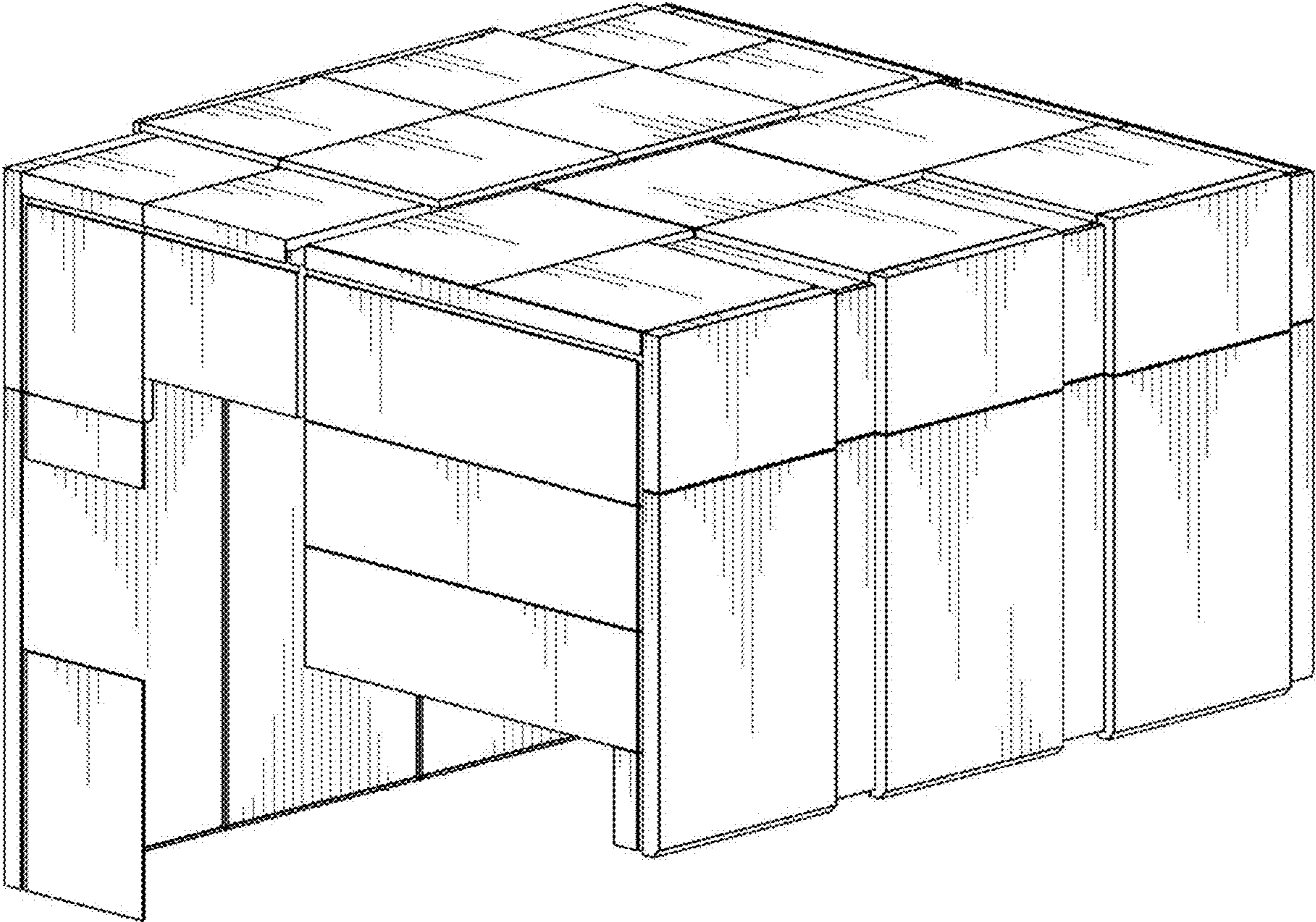

1.8

