



US00D852221S

(12) **United States Design Patent**
Levin et al.

(10) **Patent No.:** **US D852,221 S**
(45) **Date of Patent:** **** Jun. 25, 2019**

(54) **DISPLAY SCREEN WITH ANIMATED GRAPHICAL USER INTERFACE**

(71) Applicant: **Microsoft Corporation**, Redmond, WA (US)

(72) Inventors: **Kim Levin**, Tel Aviv (IL); **Shahar Prish**, Tel Aviv (IL); **Ella Ben-Tov**, Tel Aviv (IL)

(73) Assignee: **Microsoft Corporation**, Redmond, WA (US)

(**) Term: **15 Years**

(21) Appl. No.: **29/625,142**

(22) Filed: **Nov. 7, 2017**

(51) **LOC (11) Cl.** **14-04**

(52) **U.S. Cl.**
USPC **D14/488**

(58) **Field of Classification Search**
USPC D14/485, 486, 487, 488
CPC G06F 3/048; G06F 3/0481; G06F 3/04812; G06F 3/04817; G06F 3/0482; G06F 3/0484; G06F 3/0485; G06F 3/0487; G06F 3/0488; G06F 3/04883; G06F 3/04886; G06F 3/0489

See application file for complete search history.

(56) **References Cited**

U.S. PATENT DOCUMENTS

D544,874 S	6/2007	Evans et al.	
D551,676 S	9/2007	Cummins et al.	
D554,660 S	11/2007	Hoover et al.	
D573,605 S	7/2008	Amacker	
D580,448 S	11/2008	Jasinski	
D593,107 S *	5/2009	Shimoda	D14/485
D606,080 S *	12/2009	Murchie	D14/485
D634,750 S	3/2011	Loretan et al.	

D638,432 S	5/2011	Flik et al.	
D691,627 S	10/2013	Newton-Dunn et al.	
D693,832 S *	11/2013	Edwards	D14/485
D694,770 S *	12/2013	Edwards	D14/485
D694,772 S	12/2013	Edwards et al.	
D698,813 S	2/2014	Brown	
D710,873 S	8/2014	Nakada	
D719,183 S	12/2014	Kuwahara	
D719,188 S	12/2014	Anderson et al.	
D734,772 S	7/2015	Kitamorn et al.	
D734,776 S	7/2015	Kitamorn et al.	
D737,300 S	8/2015	Hisada et al.	
D746,834 S	1/2016	Gray et al.	
D748,656 S	2/2016	Moon et al.	

(Continued)

Primary Examiner — Melanie H Tung

(74) *Attorney, Agent, or Firm* — Banner & Witcoff, Ltd.

(57) **CLAIM**

The ornamental design for a display screen with animated graphical user interface, as shown and described.

DESCRIPTION

FIG. 1 is the first image in a sequence for display screen with animated graphical user interface showing our new design; FIG. 2 is the second image thereof; FIG. 3 is the third image thereof; FIG. 4 is the fourth image thereof; FIG. 5 is the fifth image thereof; FIG. 6 is the sixth image thereof; and, FIG. 7 is the seventh image thereof.

The appearance of the animated graphical user interface sequentially transitions between the images shown in FIGS. 1-7. The process or period in which one image transitions to another forms no part of the claimed design.

The outermost broken line showing of the display screen forms no part of the claimed design. The remaining broken lines show portions of the animated graphical user interface that form no part of the claimed design.

1 Claim, 7 Drawing Sheets

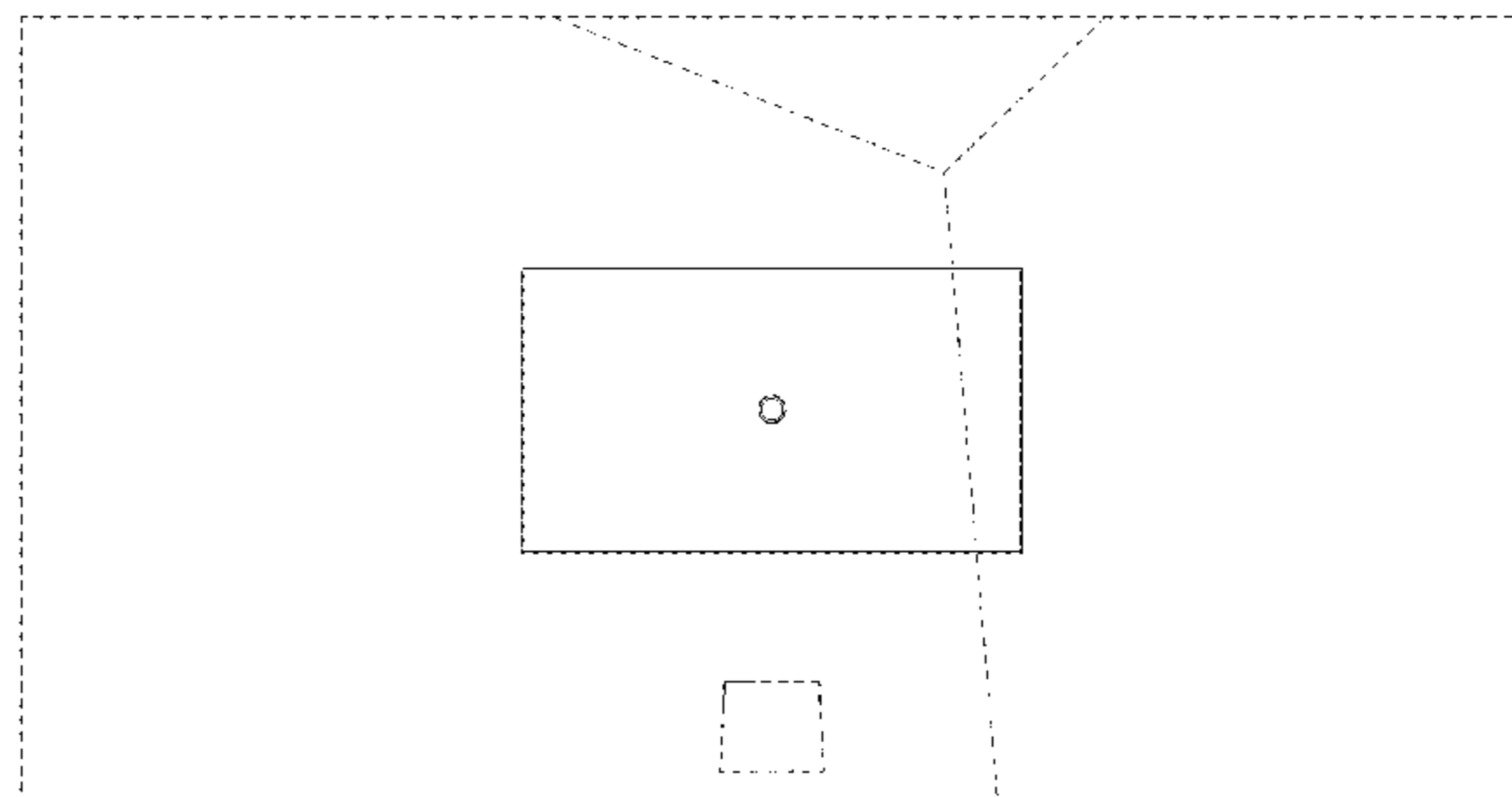
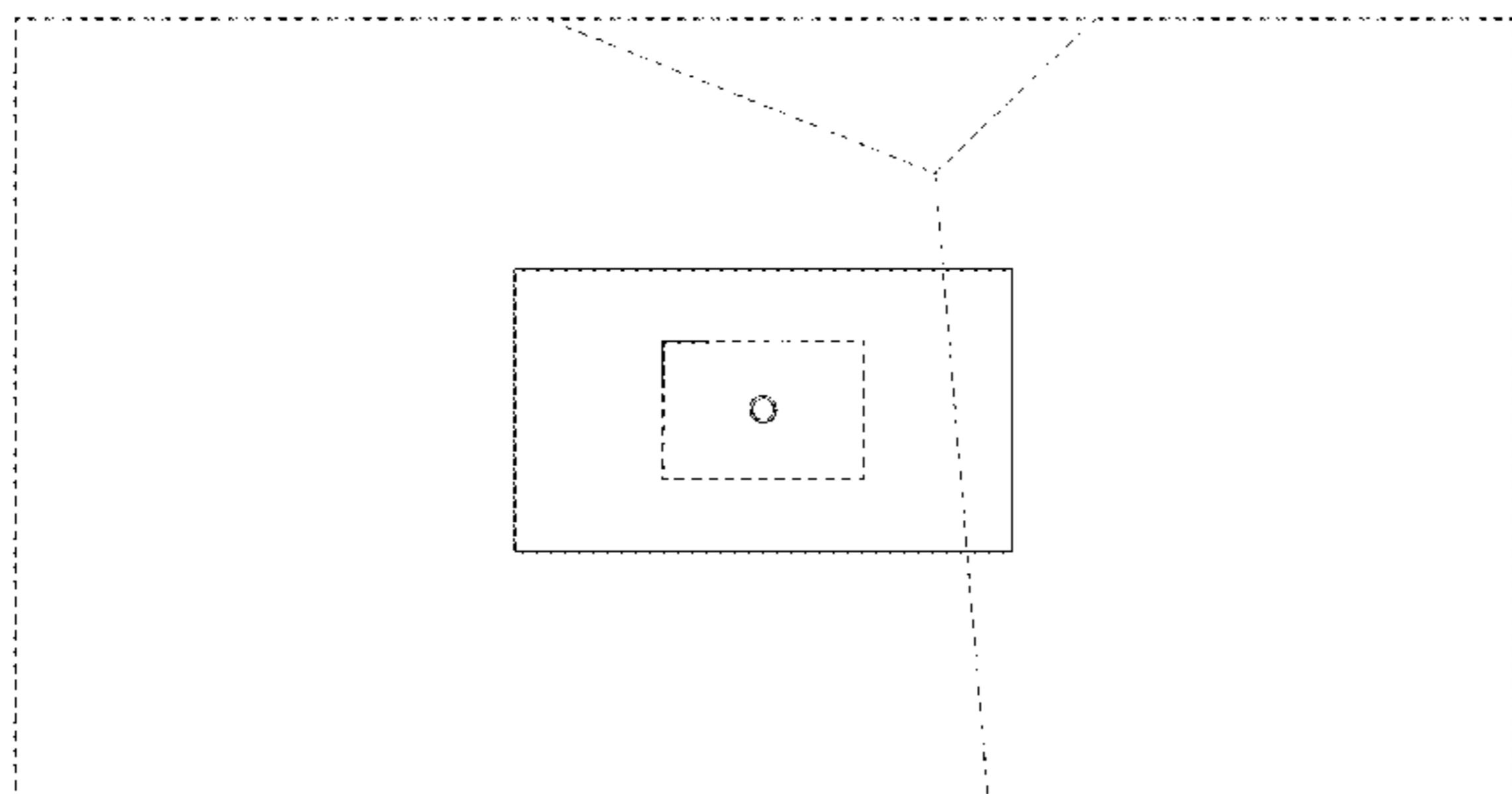

(56)

References Cited

U.S. PATENT DOCUMENTS

D749,099 S 2/2016 Moon et al.
 D751,092 S 3/2016 Moon et al.
 D751,093 S 3/2016 Moon et al.
 D754,158 S 4/2016 Moon et al.
 D755,224 S 5/2016 Abbas
 D764,497 S * 8/2016 Seo D14/485
 D772,243 S * 11/2016 Everette D14/485
 D772,244 S 11/2016 Jon
 D774,515 S 12/2016 Kim et al.
 D775,147 S 12/2016 Chaudhri et al.
 9,535,562 B2 * 1/2017 Mehninger G06F 3/048
 D782,504 S * 3/2017 Lee D14/485
 D782,517 S 3/2017 Zarick et al.
 D786,274 S * 5/2017 Lee D14/485
 D789,969 S 6/2017 Chaudhri et al.
 D791,158 S 7/2017 Shiino
 D802,004 S * 11/2017 Zhao D14/486
 D802,005 S * 11/2017 Tseou D14/486
 D802,615 S * 11/2017 Zhao D14/486
 D808,977 S * 1/2018 Zhao D14/485
 D812,632 S * 3/2018 Saneii D14/486
 D817,994 S * 5/2018 Jou D14/487

D820,872 S * 6/2018 Inman D14/486
 D832,290 S * 10/2018 Tran G06Q 50/22
 D14/486
 D836,648 S * 12/2018 Butcher D14/485
 D837,804 S * 1/2019 Jou D14/485
 2010/0153872 A1 * 6/2010 Ahn G06F 3/0481
 715/768
 2012/0030636 A1 * 2/2012 Miyazaki G06F 3/0488
 715/863
 2013/0154925 A1 * 6/2013 Chen H04N 21/4222
 345/157
 2013/0212522 A1 * 8/2013 Fleizach G06F 3/0488
 715/784
 2015/0324085 A1 * 11/2015 Kadomatsu G06F 3/0488
 345/173
 2016/0188156 A1 * 6/2016 Lee H04N 5/4403
 715/768
 2016/0309090 A1 * 10/2016 Park G06F 3/013
 2016/0313891 A1 * 10/2016 Tsuda G06F 3/013
 2017/0083229 A1 * 3/2017 Luo G06F 3/04883
 2017/0139477 A1 * 5/2017 Nakayama G06F 3/013
 2017/0139568 A1 * 5/2017 Itani G06F 3/04812
 2017/0220205 A1 * 8/2017 Takimoto G06F 3/048

* cited by examiner

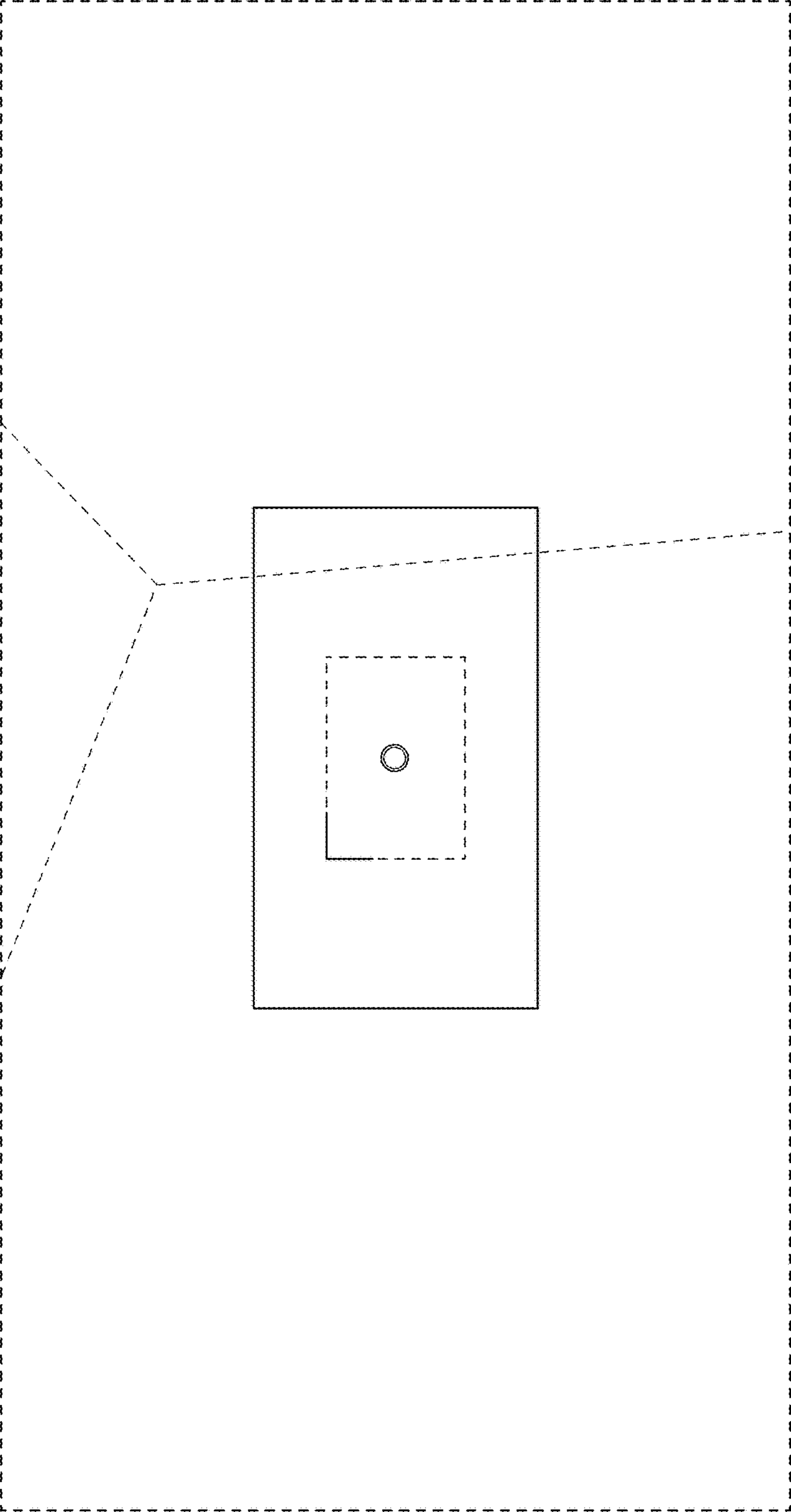

FIG. 1

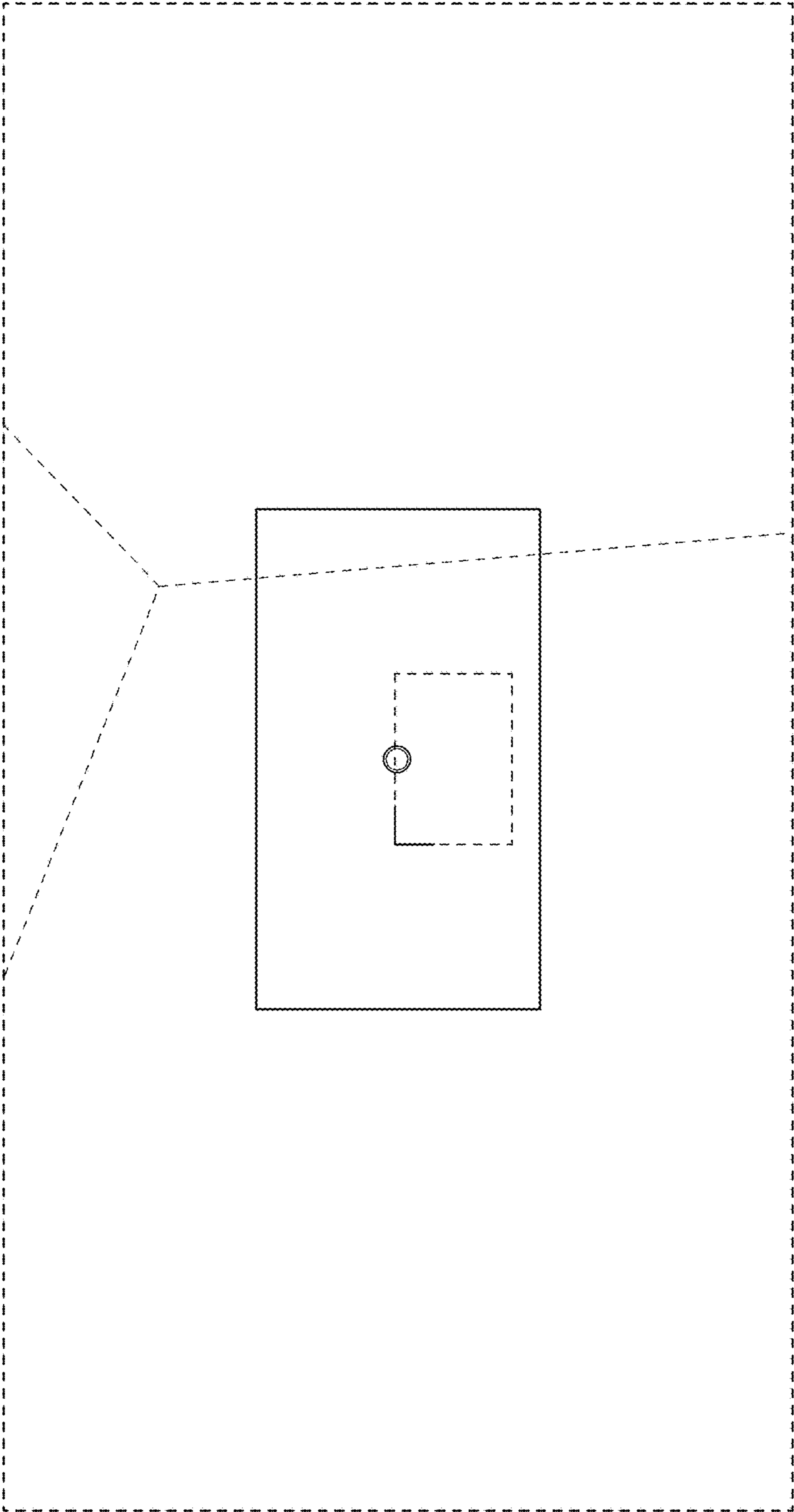

FIG. 2

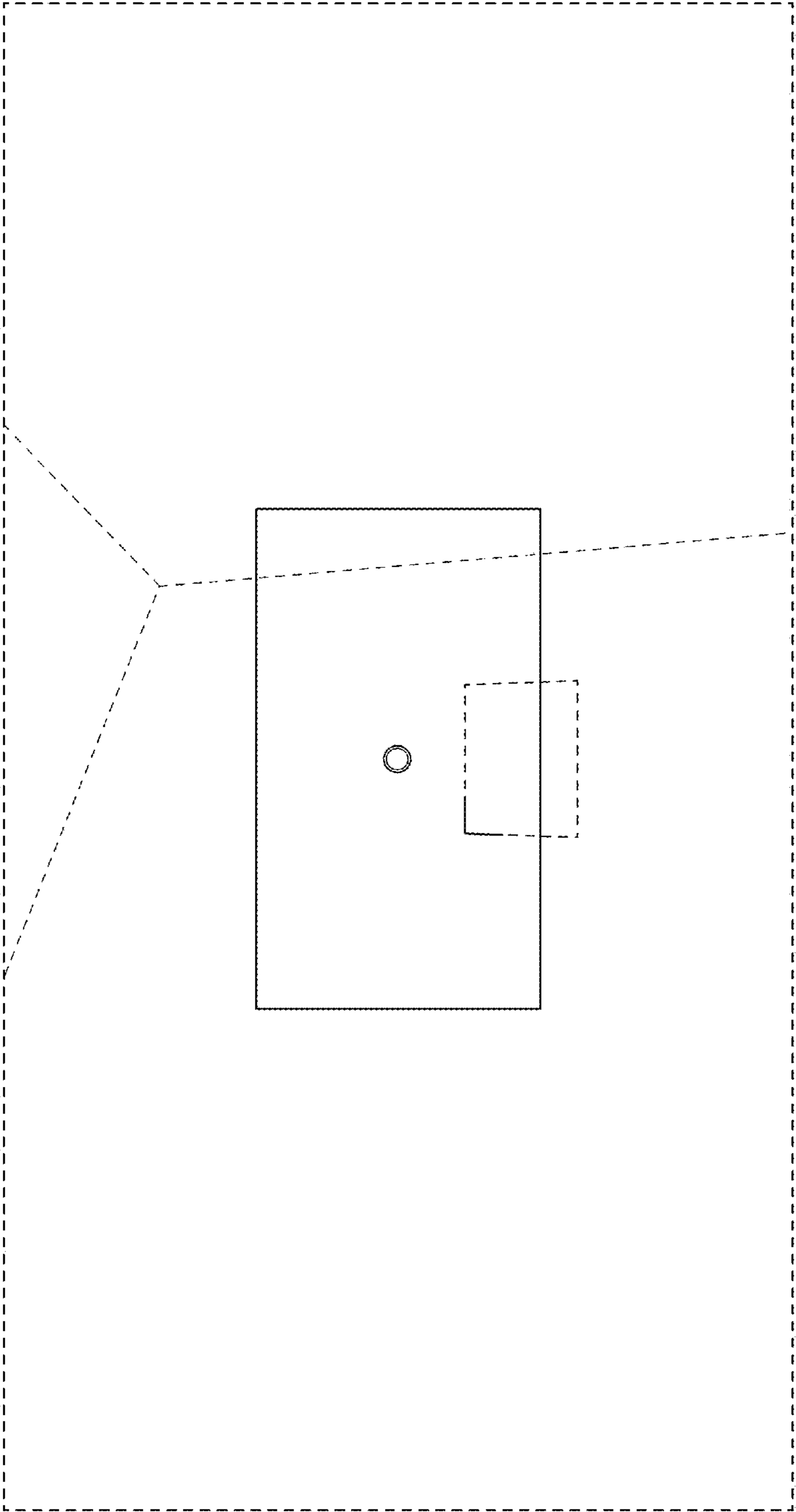

FIG. 3

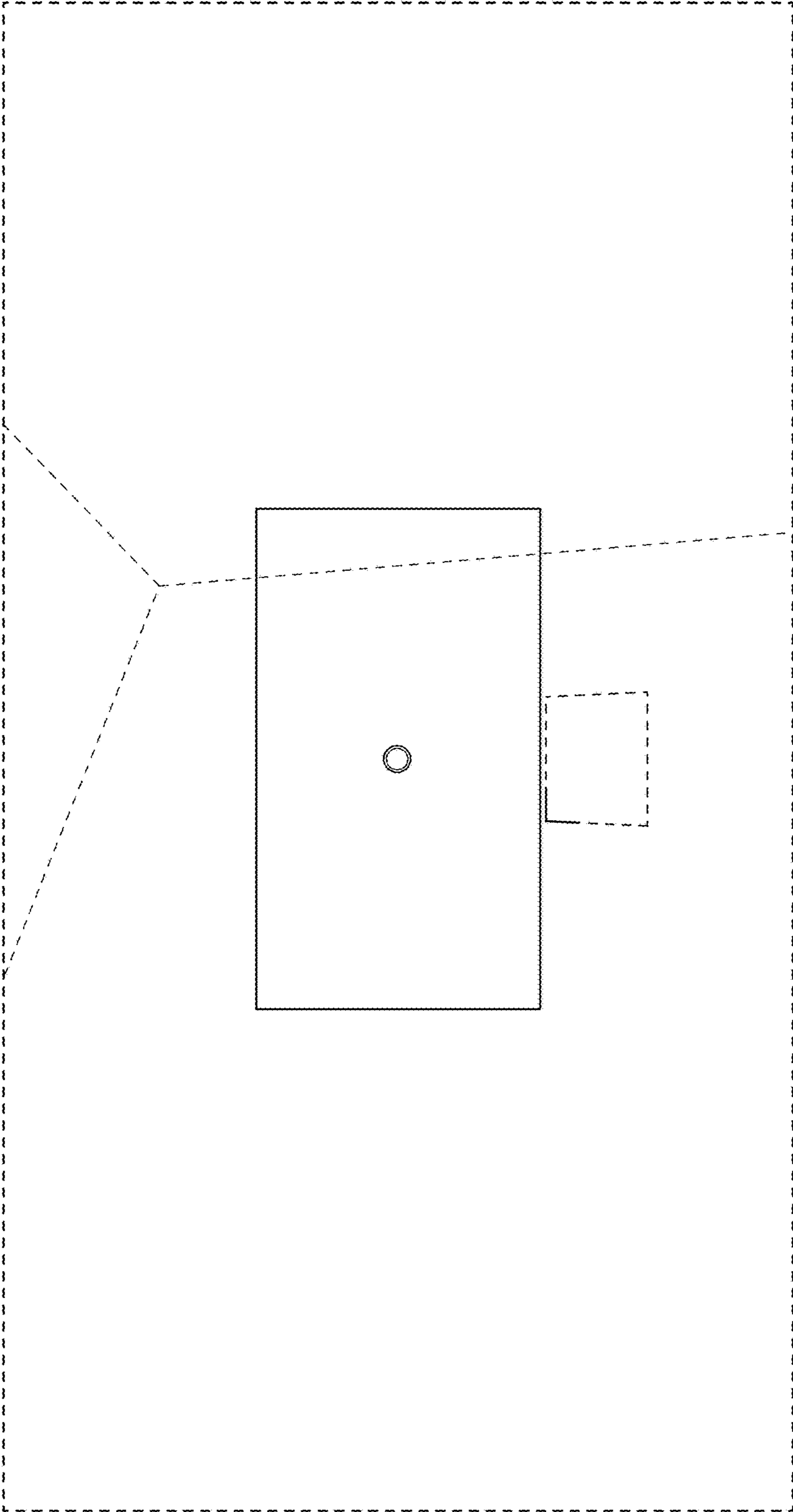

FIG. 4

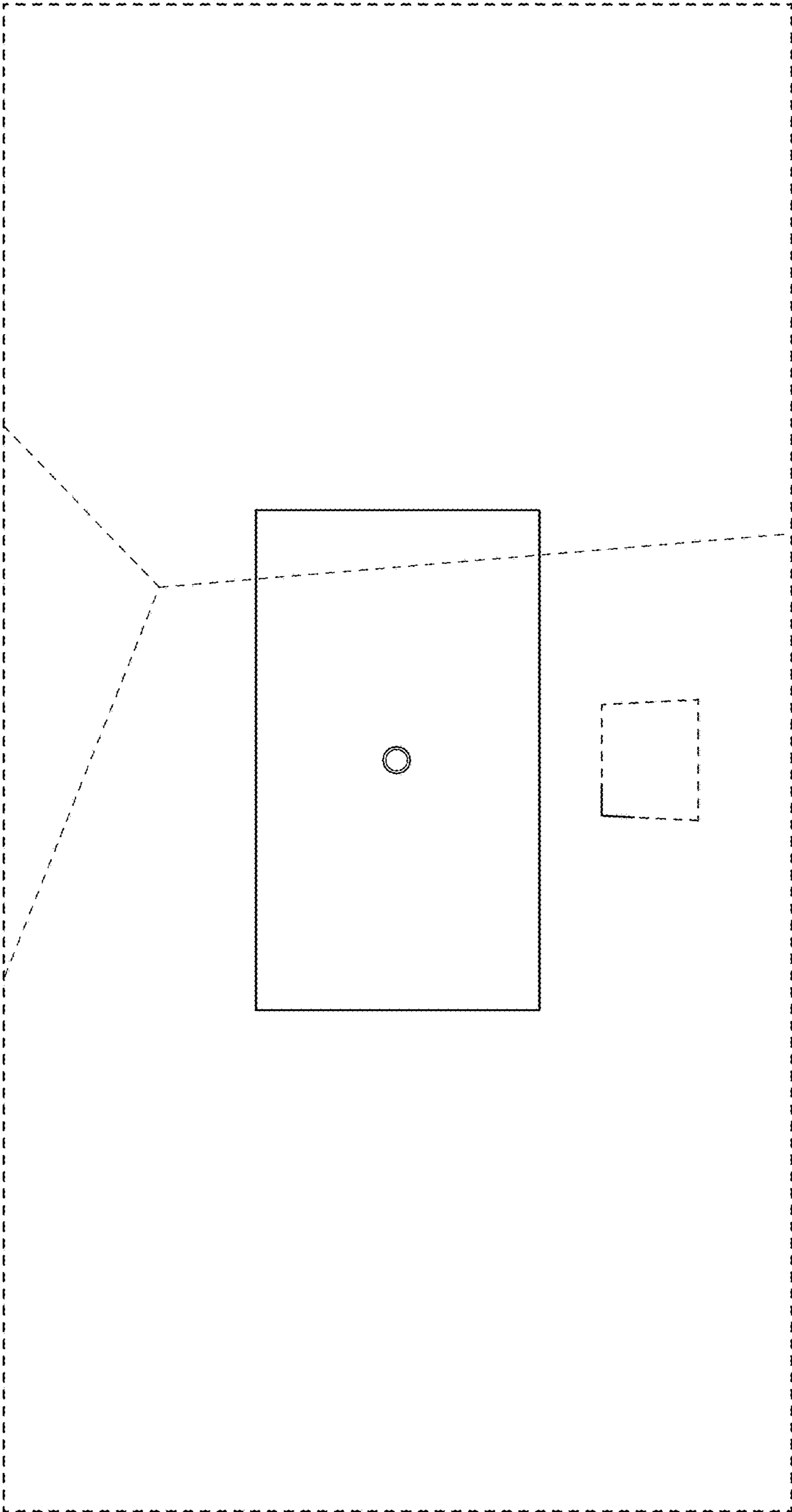

FIG. 5

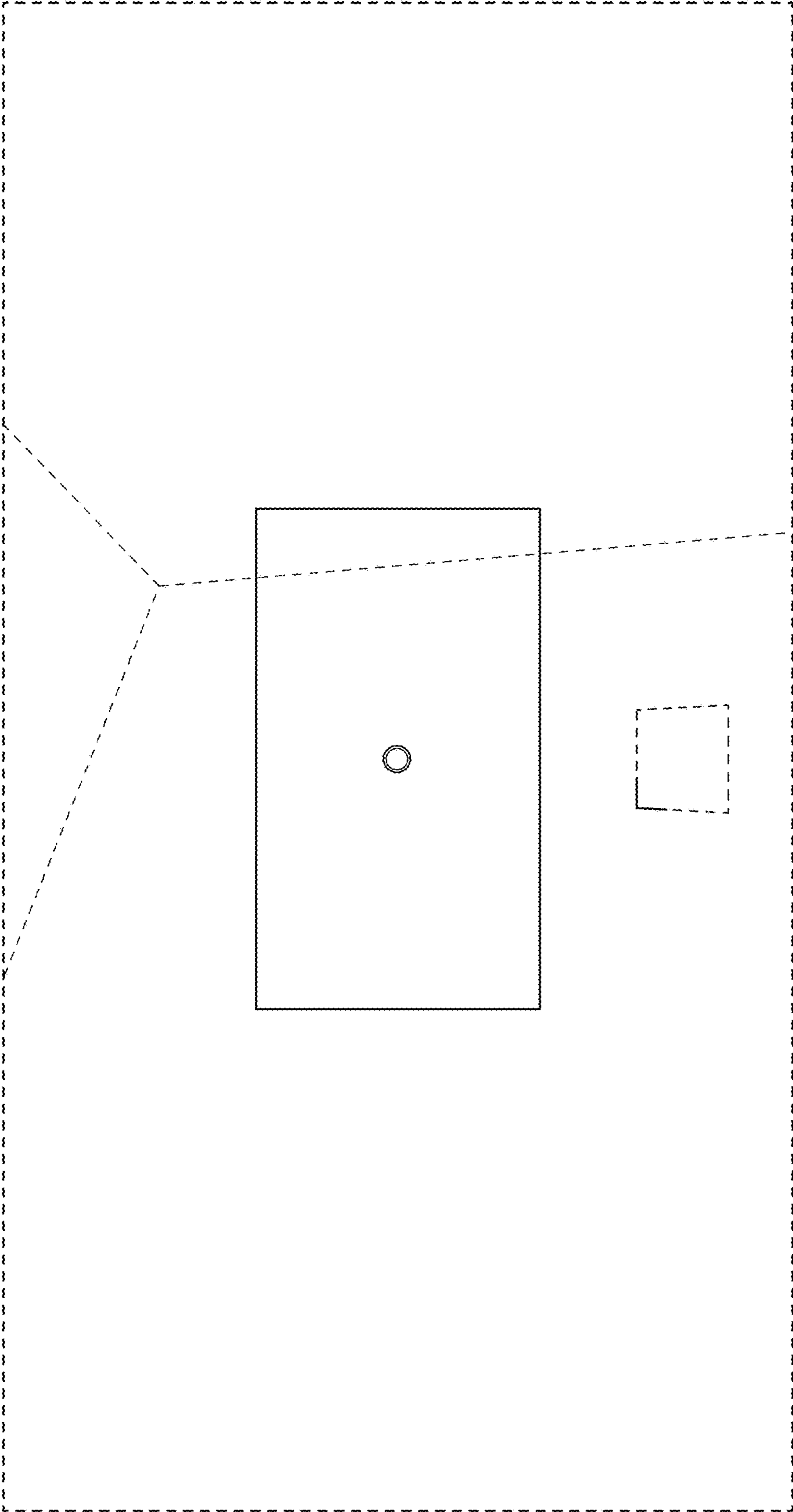

FIG. 6

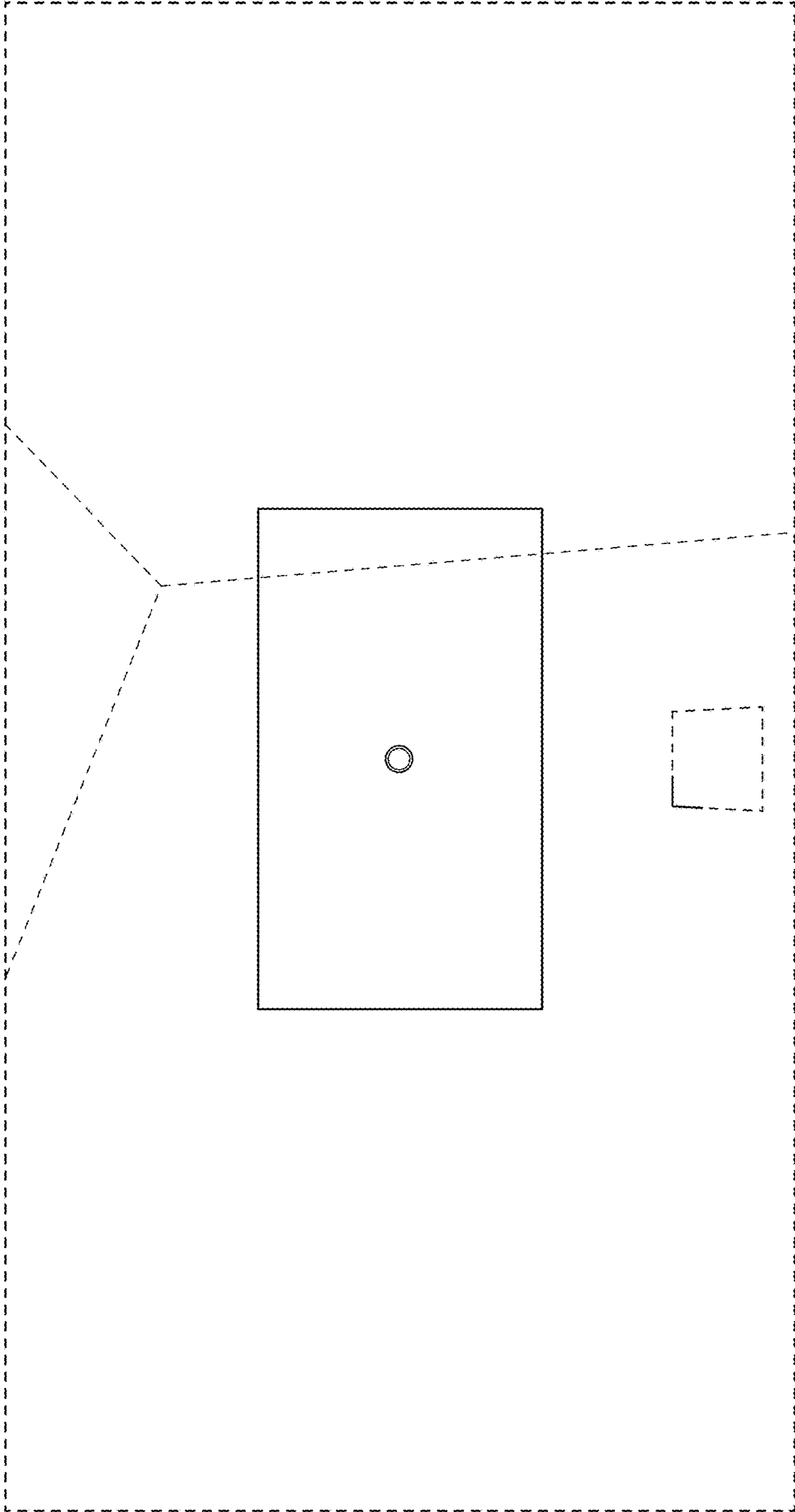

FIG. 7