



US00D852206S

(12) **United States Design Patent**
Nakamura et al.

(10) **Patent No.:** **US D852,206 S**
(45) **Date of Patent:** **** Jun. 25, 2019**

(54) **DISPLAY SCREEN WITH ANIMATED GRAPHICAL USER INTERFACE**

FOREIGN PATENT DOCUMENTS

(71) Applicant: **EBARA CORPORATION**, Tokyo (JP)

JP 1569708 S 2/2017

(72) Inventors: **Takamasa Nakamura**, Tokyo (JP);
Tsuneo Torikoshi, Tokyo (JP)

OTHER PUBLICATIONS

(73) Assignee: **EBARA CORPORATION**, Tokyo (JP)

“How to create Dropdown Menu/Navigation Bar in Html and CSS (Hindi/Urdu)” May 23, 2016, posted at youtube.com, [site visited Jan. 22, 2019]. <https://www.youtube.com/watch?v=ZK1I2f1QkrY>.*

(**) Term: **15 Years**

(Continued)

(21) Appl. No.: **29/631,436**

Primary Examiner — Jack Reickel

Assistant Examiner — John M Otte

(22) Filed: **Dec. 29, 2017**

(74) *Attorney, Agent, or Firm* — Pearne & Gordon LLP

(30) **Foreign Application Priority Data**

(57) **CLAIM**

Jun. 29, 2017 (JP) 2017-014044

The ornamental design for a display screen with animated graphical user interface, as shown and described.

(51) **LOC (11) Cl.** **14-04**

(52) **U.S. Cl.**
USPC **D14/485**

(58) **Field of Classification Search**
USPC D14/485–495; D20/11; D21/324, 325
CPC G06F 3/048; G06F 3/0481; G06F 3/04817;
G06F 3/0482; G06F 3/0483; G06F
3/04842; G06F 3/0485; G06F 3/04855;
G06F 3/0486; G06F 3/0488; G06F
3/04886; G06F 9/4443; G06F 8/38; G06F
17/211; G06F 17/212

DESCRIPTION

See application file for complete search history.

FIG. 1. is a front view of a display screen with animated graphical user interface showing the first image of our new design;
FIG. 2. is a second image thereof;
FIG. 3. is a third image thereof;
FIG. 4. is a reference perspective view in usage; and,
FIG. 5. is a reference front view in usage.

(56) **References Cited**

The appearance of the animated images sequentially transitions between images shown in FIGS. 1 through 3. The process or period in which an image transitions to another forms no part of the claimed design.

U.S. PATENT DOCUMENTS

The broken lines shown in FIGS. 1-3 represent unclaimed subject matter of the display screen with animated graphical user interface and form no part of the claimed design. The dot-dash lines shown in FIGS. 2-3 illustrate the boundary of the claim and form no part of the claimed design. The broken lines shown in FIGS. 4-5 represent unclaimed environments and form no part of the claimed design.

D549,714 S * 8/2007 Sharma D14/485
D593,578 S * 6/2009 Ball D14/488
D670,726 S * 11/2012 Bitran D14/487
D697,930 S * 1/2014 Crabtree D14/486
D702,700 S * 4/2014 Thompson D14/485
D750,113 S * 2/2016 Kettner D14/486
D774,066 S * 12/2016 Kas D14/486

(Continued)

1 Claim, 5 Drawing Sheets

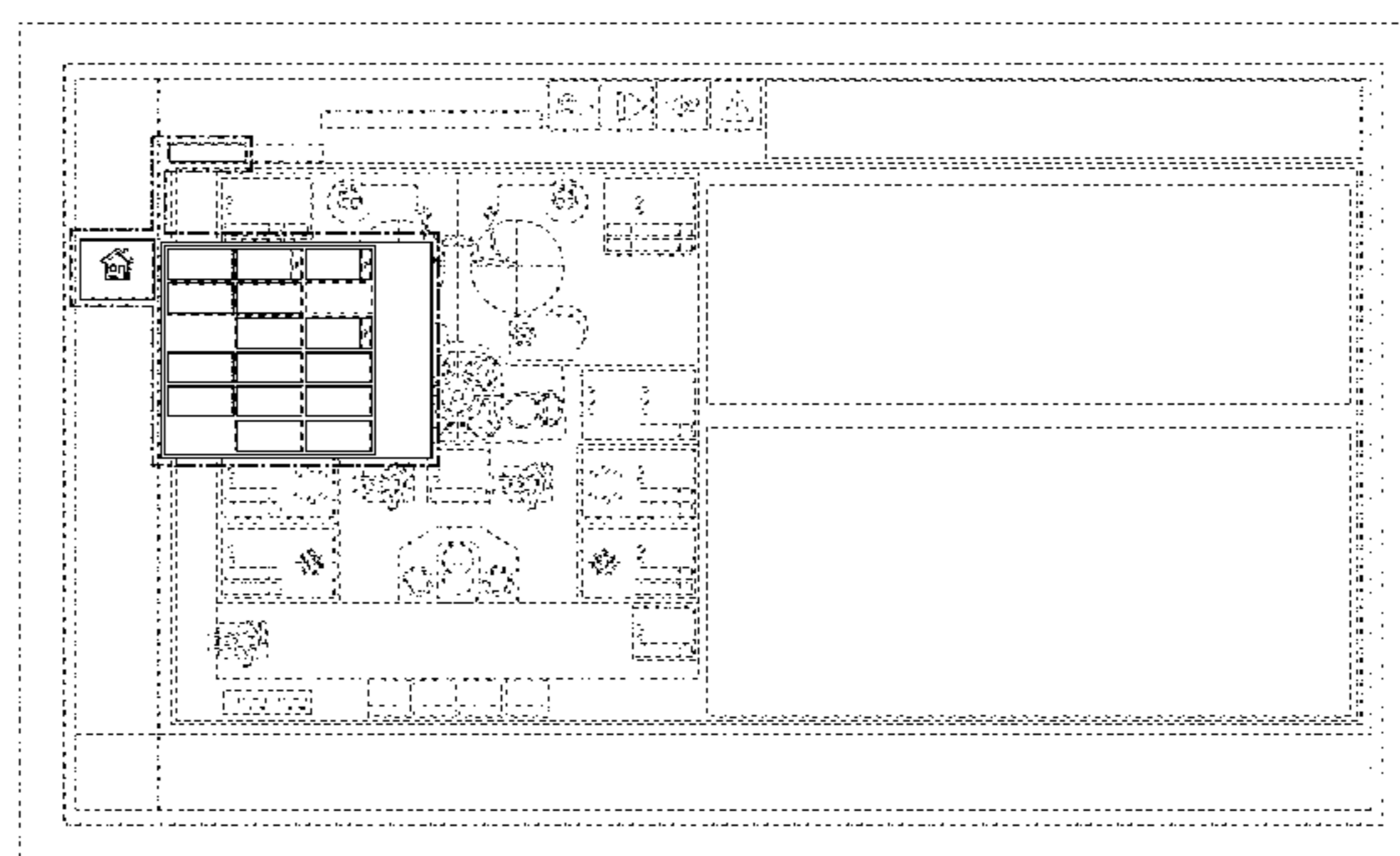
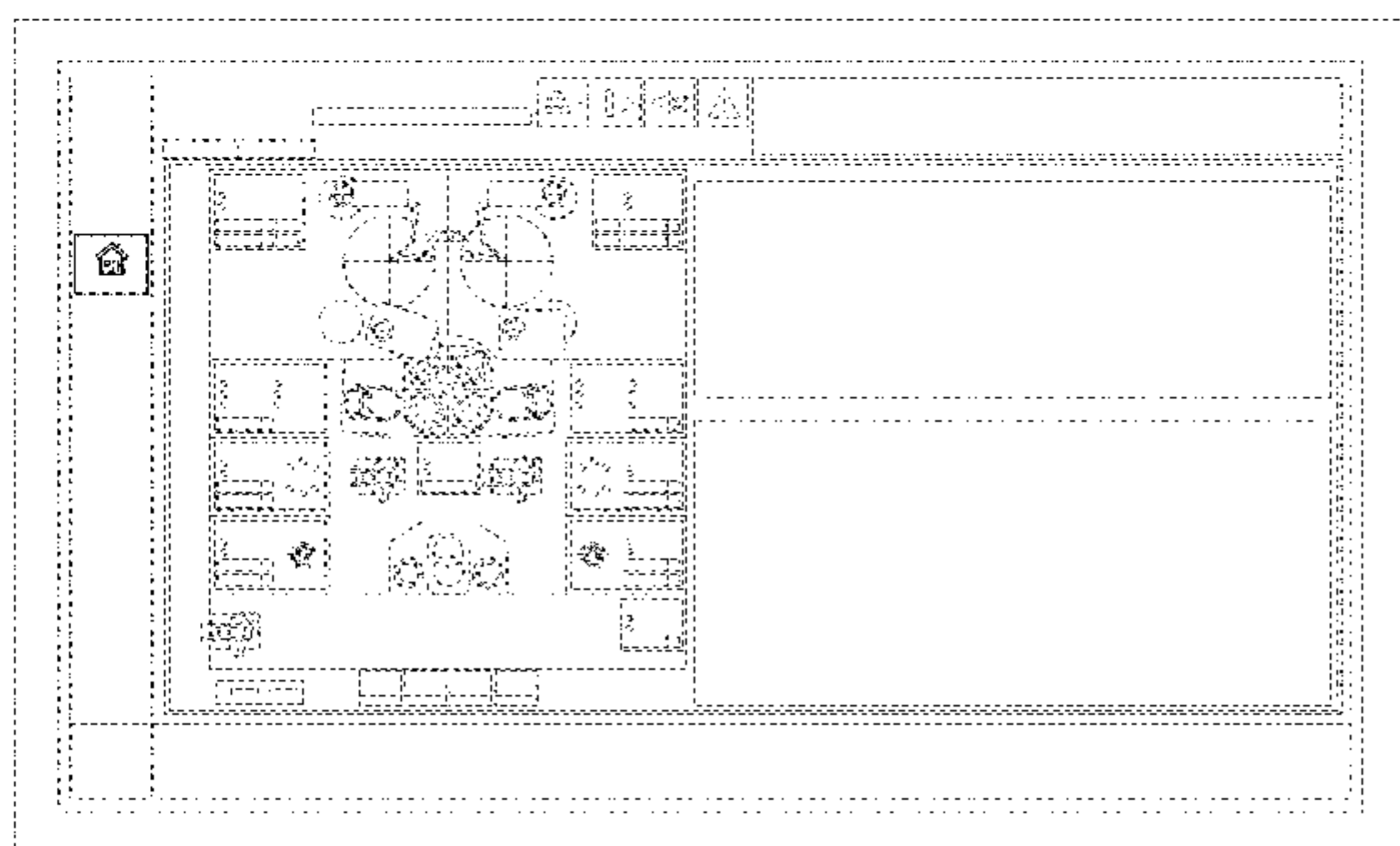

(56)

References Cited

U.S. PATENT DOCUMENTS

D780,797 S * 3/2017 Kisielius D14/486
D796,540 S * 9/2017 McLean D14/487
D812,085 S * 3/2018 Kas D14/486
9,934,222 B2 * 4/2018 Leong G06F 3/04817
9,972,121 B2 * 5/2018 Li G06T 15/10
2010/0205567 A1 * 8/2010 Haire G06F 8/38
715/840

OTHER PUBLICATIONS

Ghafoor, Inam, "How to Organize the Gallery on Android" Feb. 20, 2013, posted at youtube.com, [site visited Jan. 22, 2019]. https://www.youtube.com/watch?v=Qw2dtv_Q7ZM.*

* cited by examiner

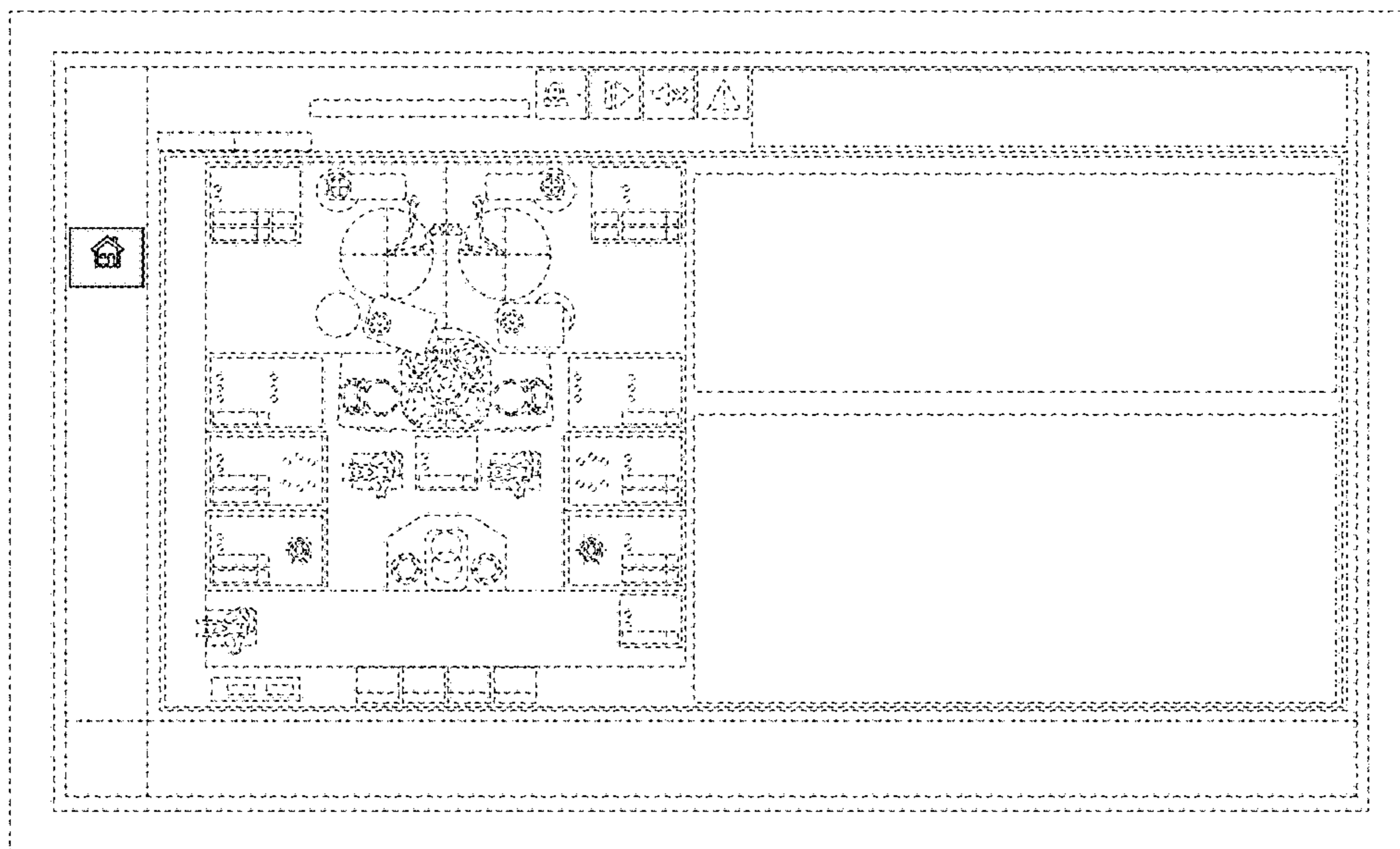

FIG. 1

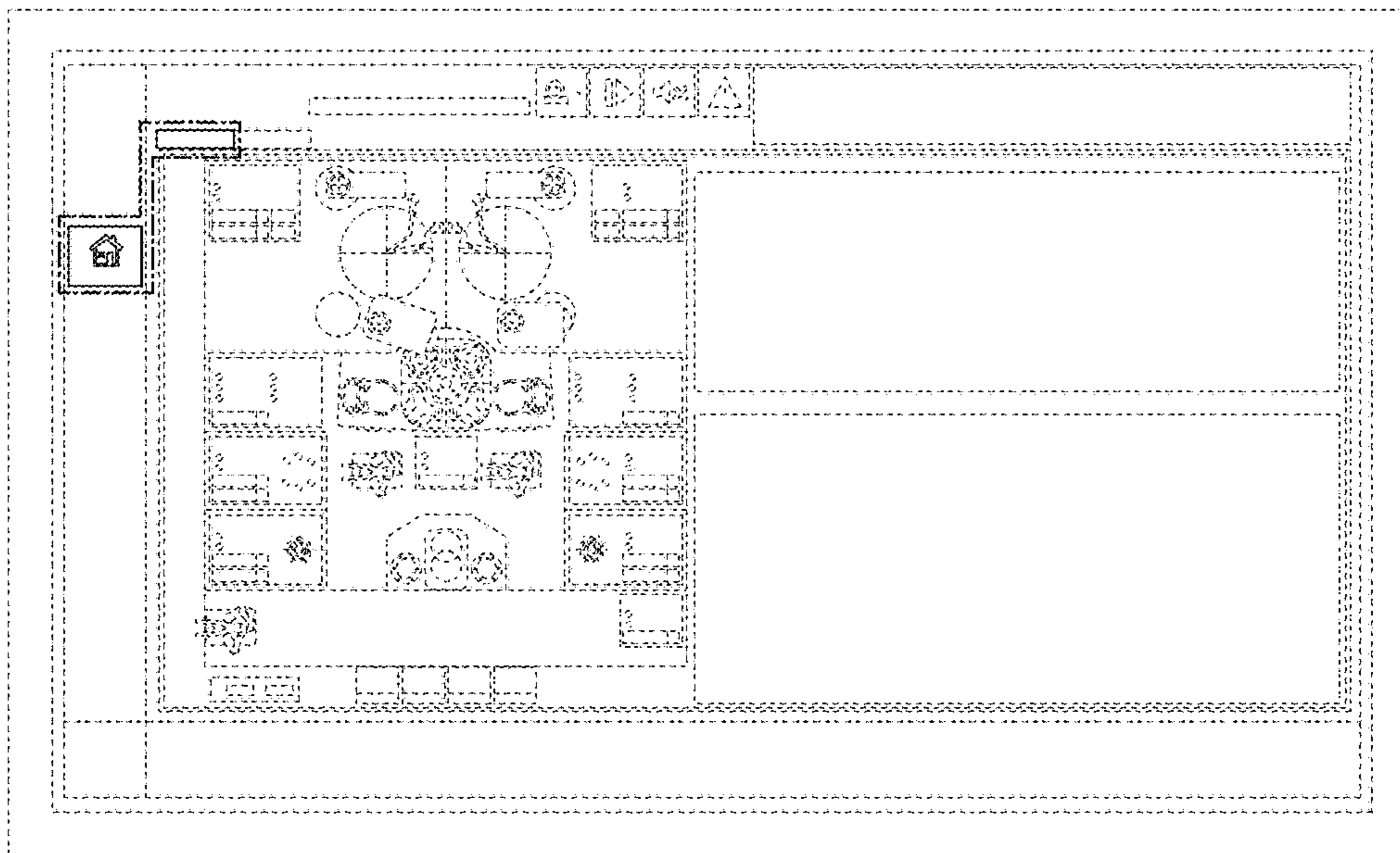

FIG. 2

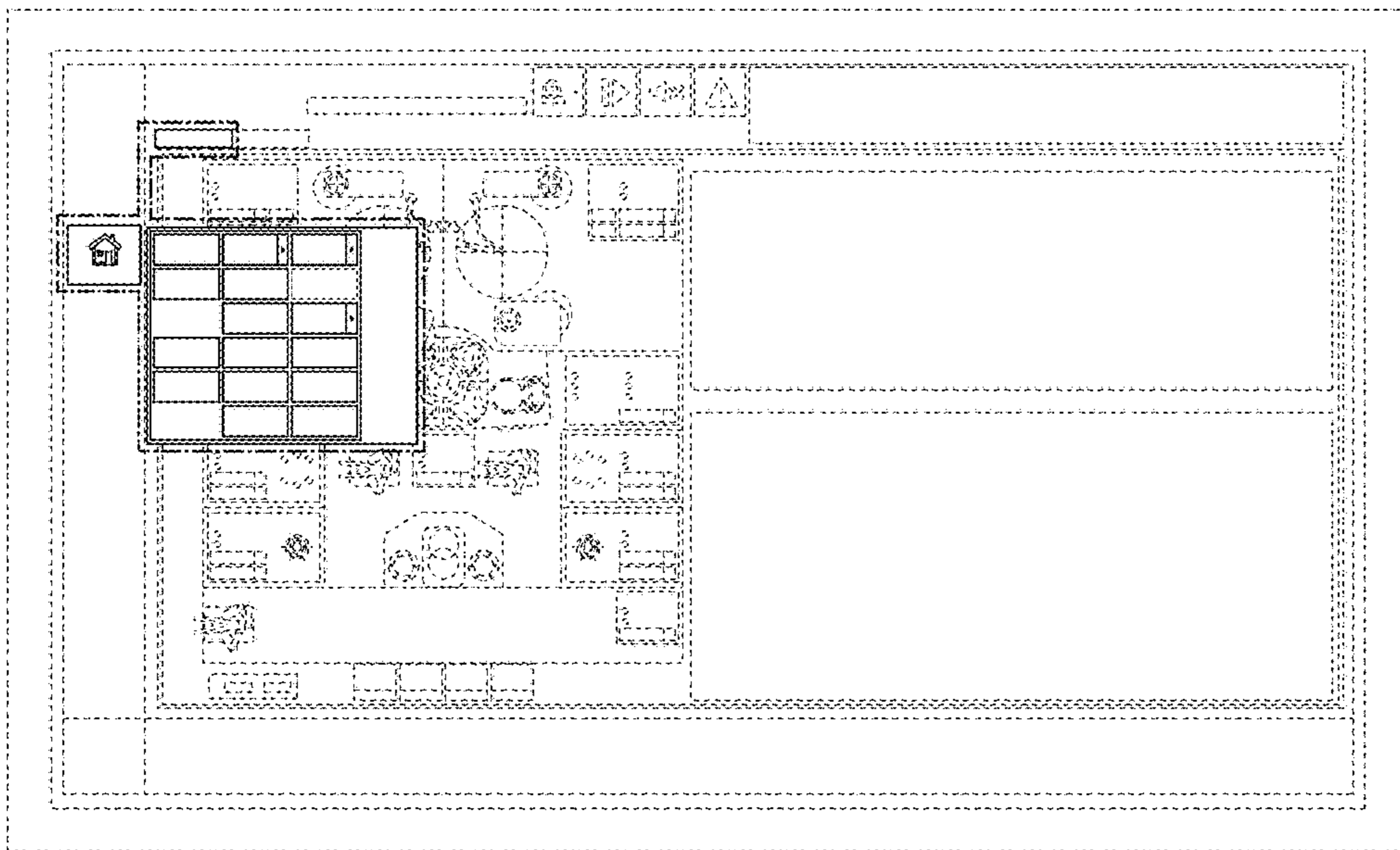

FIG. 3

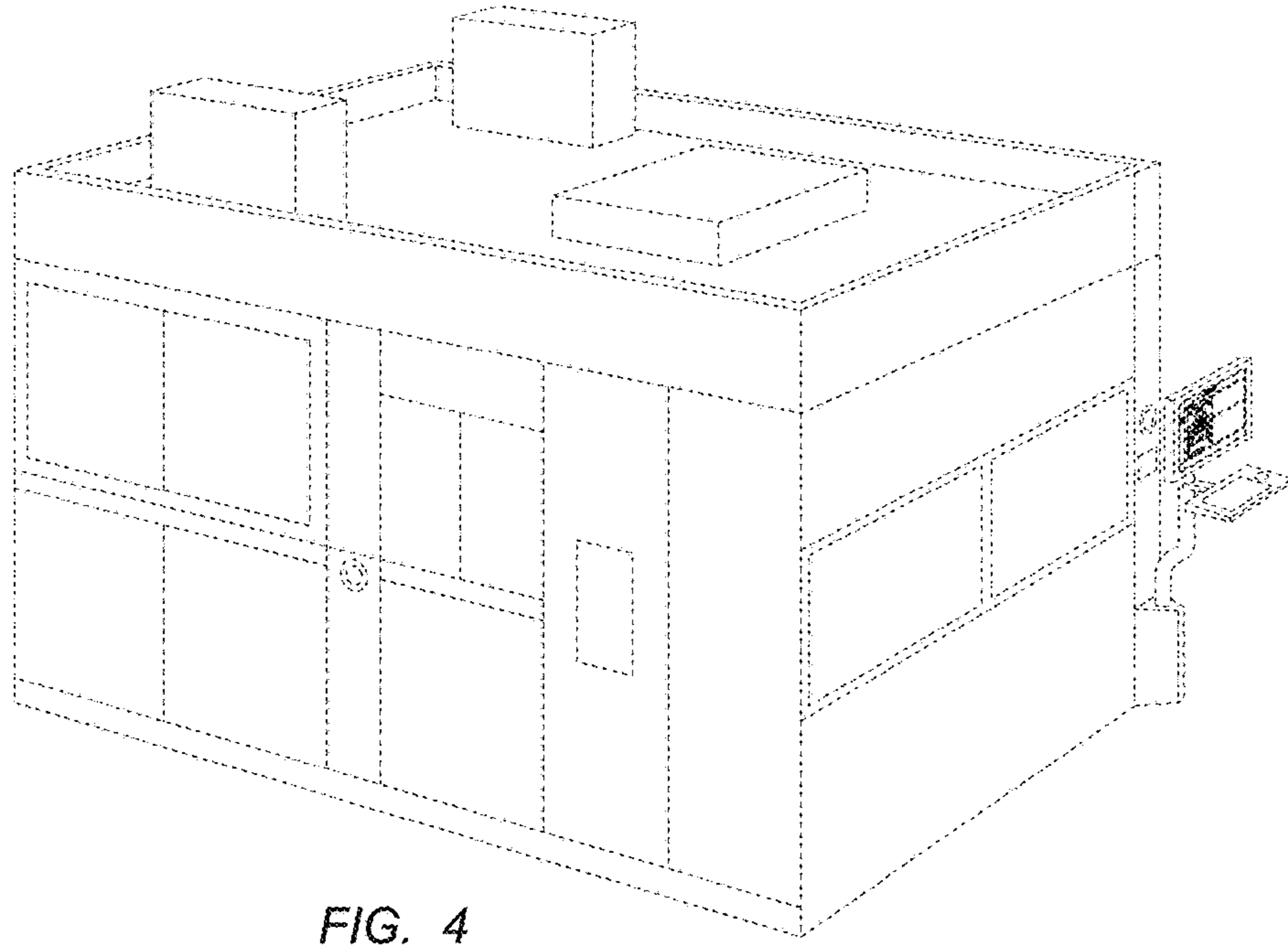

FIG. 4

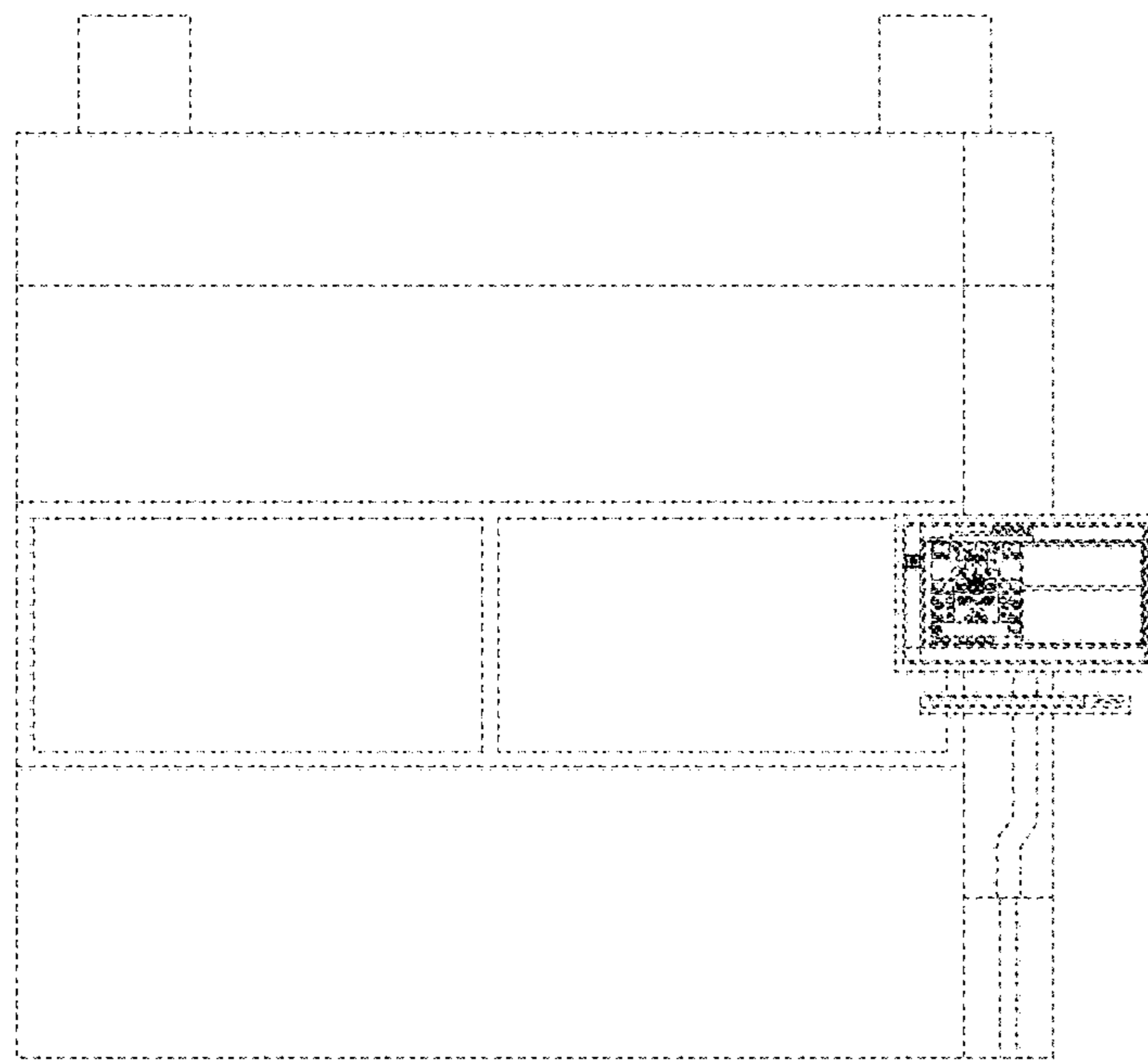

FIG. 5