



US00D851855S

(12) **United States Design Patent** (10) **Patent No.:** **US D851,855 S**
Farmer et al. (45) **Date of Patent:** **** Jun. 25, 2019**

(54) **CONFECTION**

(71) Applicant: **The Hershey Company**, Hershey, PA (US)

(72) Inventors: **Theresa Lynn Farmer**, Annville, PA (US); **Todd David Wickenheisser**, Harrisburg, PA (US); **Eric Zampedri**, Palmyra, PA (US); **Mary Beth Marette**, Hummelstown, PA (US); **Sutasinee Chanwangsa Seitz**, St. Louis Park, MN (US); **James Edward Pierce**, Mount Wolf, PA (US); **Daniel Alvie Delzer**, Lakewood Ranch, FL (US); **Rachel Lewis**, Harrisburg, PA (US)

(73) Assignee: **The Hershey Company**, Hershey, PA (US)

(**) Term: **15 Years**

(21) Appl. No.: **29/646,066**

(22) Filed: **May 1, 2018**

(51) **LOC (11) Cl.** **01-01**

(52) **U.S. Cl.**
USPC **D1/107; D1/127**

(58) **Field of Classification Search**
 USPC D1/100–130, 199; 426/5, 76, 87, 92, 94, 426/95, 99, 101, 103, 108, 138–139, 143, 426/144, 279, 282, 283, 391, 514, 549, 426/660; D24/102; D30/160; D6/598; D11/125, 128; D28/8.1, 8.2
 CPC . A23G 3/54; A23G 4/20; A23G 3/343; A23G 3/36; A23G 3/28; A61K 9/2072; A61K 9/2095

See application file for complete search history.

(56) **References Cited**

U.S. PATENT DOCUMENTS

D172,083 S *	5/1954	Brenner	D1/108
D234,941 S *	4/1975	Gottsegen	D1/108
D249,027 S *	8/1978	Dibble	D11/125
D379,500 S *	5/1997	King	D11/121
D411,069 S *	6/1999	Bear	D11/128
D430,100 S *	8/2000	Shurling	D12/199
D448,515 S *	9/2001	Sehl	D26/99
D461,428 S *	8/2002	Danon	D11/128
D473,485 S *	4/2003	Danon	D11/128
D528,351 S *	9/2006	Morgan	D7/354
D550,587 S *	9/2007	Limber	D11/117
D614,829 S *	5/2010	Lowry	D1/106
D668,017 S *	10/2012	Coble	D1/107

* cited by examiner

Primary Examiner — Katie Jane Stoffko

(74) *Attorney, Agent, or Firm* — Design IP

(57) **CLAIM**

The ornamental design for a confection, as shown and described.

DESCRIPTION

FIG. 1 is a front isometric view of a confection showing our new design;

FIG. 2 is a front view thereof;

FIG. 3 is a rear view thereof;

FIG. 4 is a left side view thereof;

FIG. 5 is a right side view thereof;

FIG. 6 is a top view thereof; and,

FIG. 7 is a bottom view thereof.

The greyscale shading shown in FIGS. 1-7 is provided solely for the purpose of showing surface contours. The dash-dot lines in the figures and the ghosted areas within the dash-dot lines show portions of the confection that form no part of the claimed design.

1 Claim, 7 Drawing Sheets

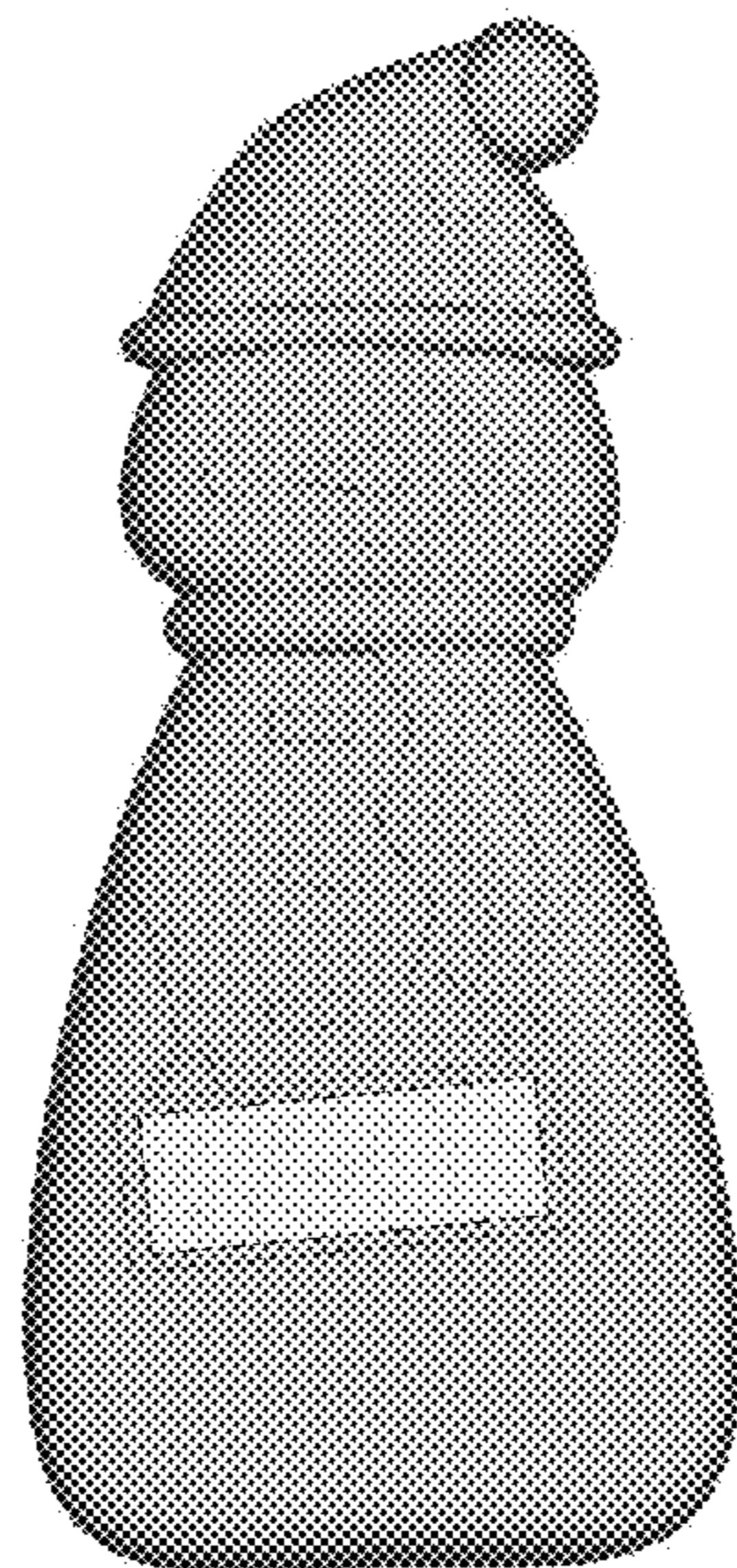

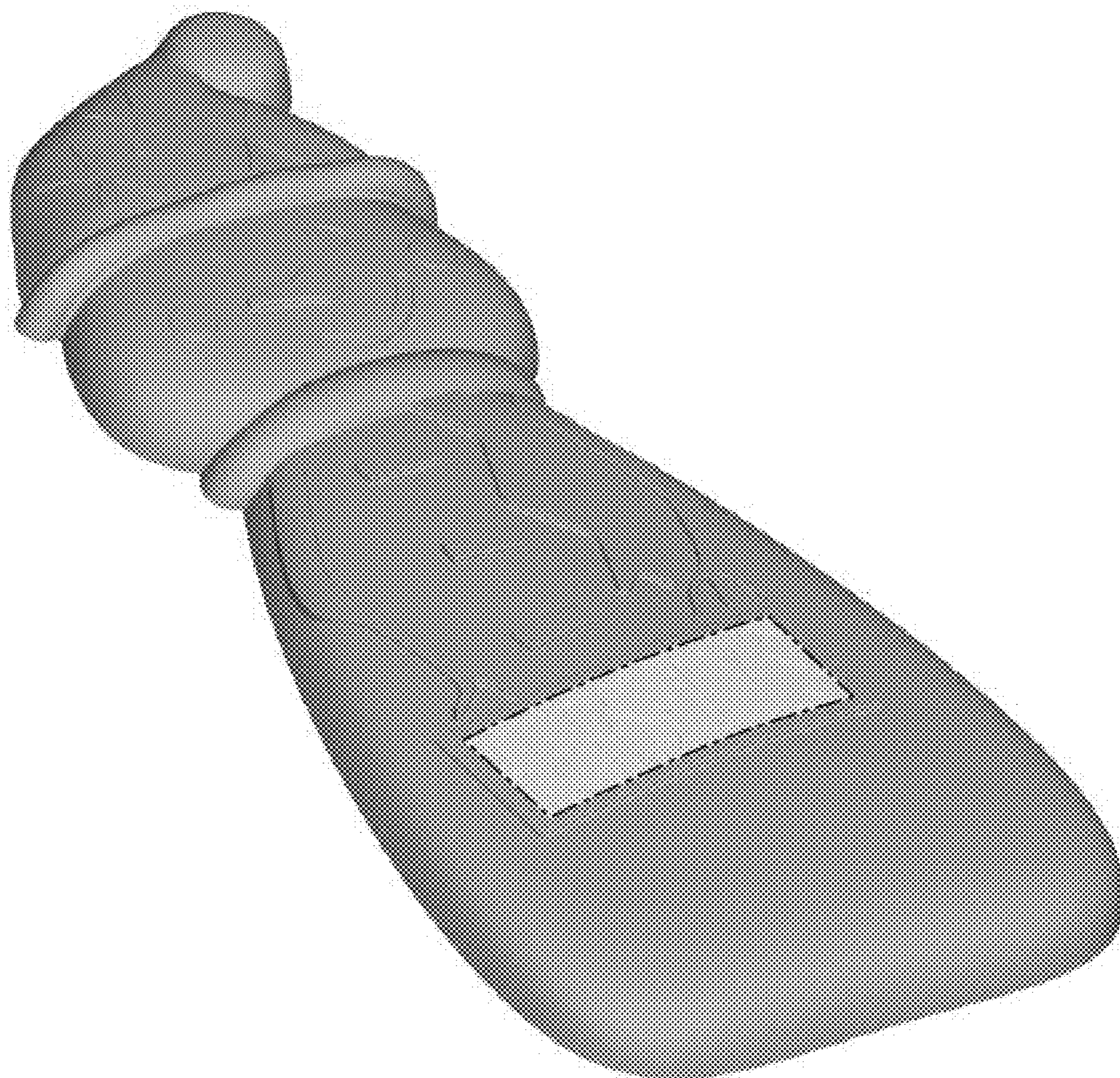

FIG. 1

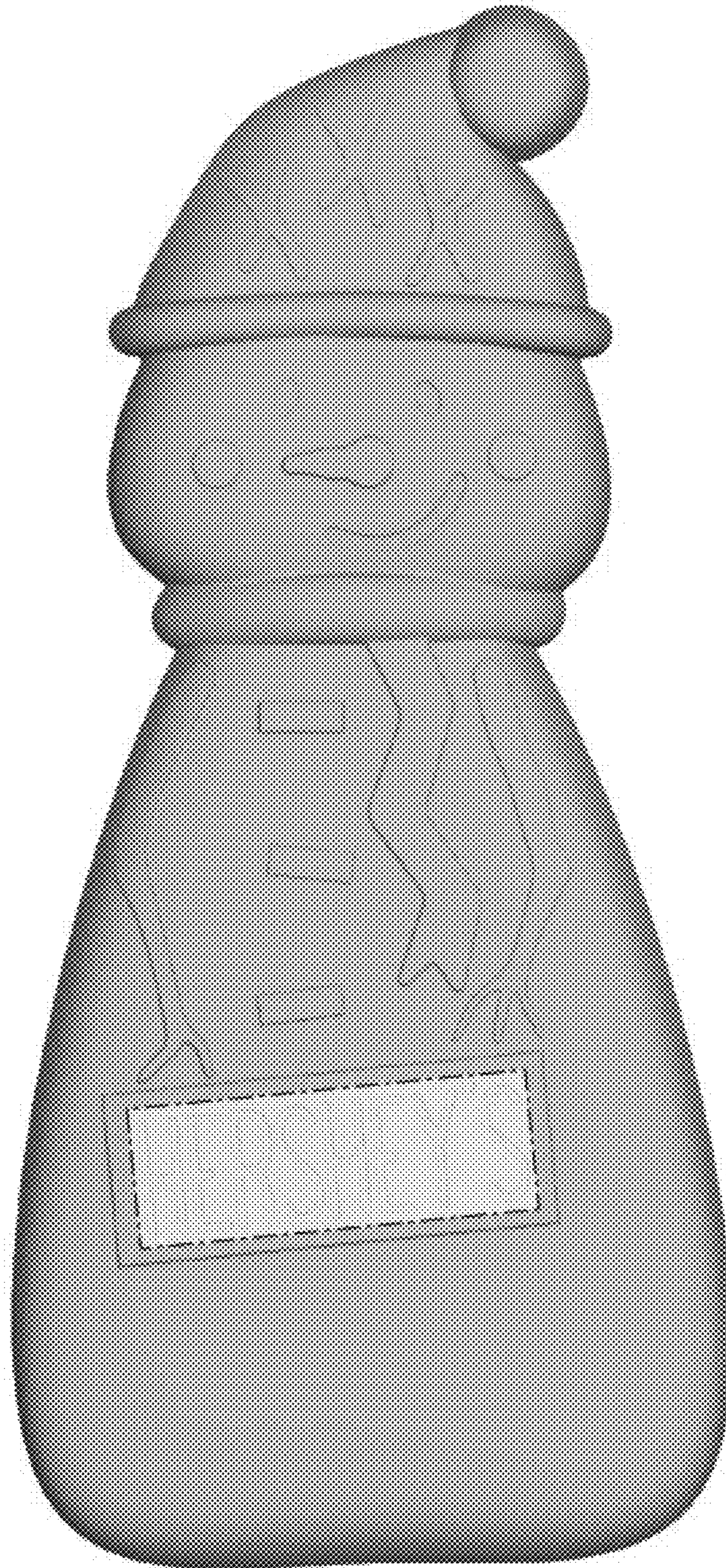

FIG. 2

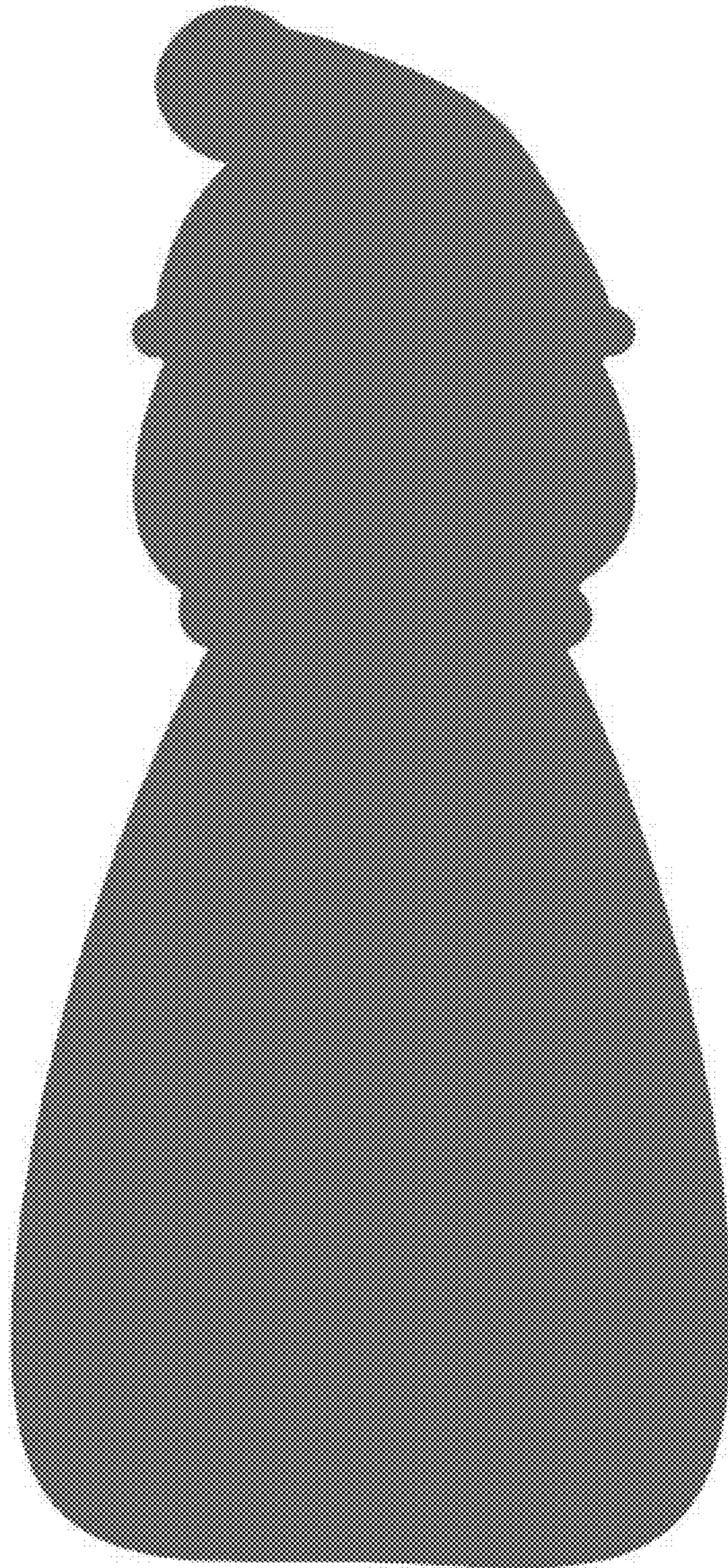

FIG. 3

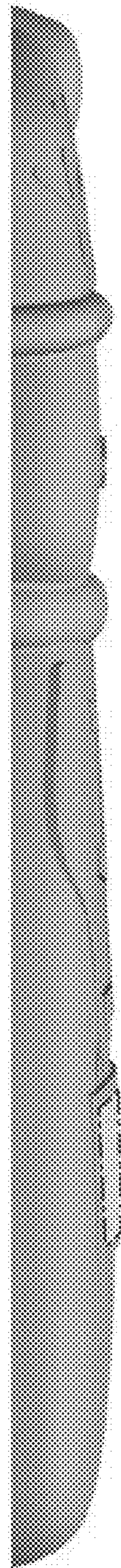

FIG. 4

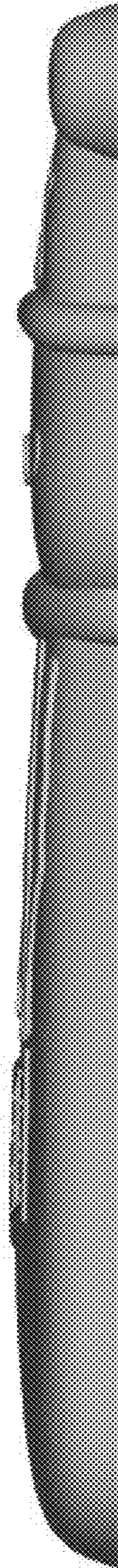

FIG. 5



FIG. 6

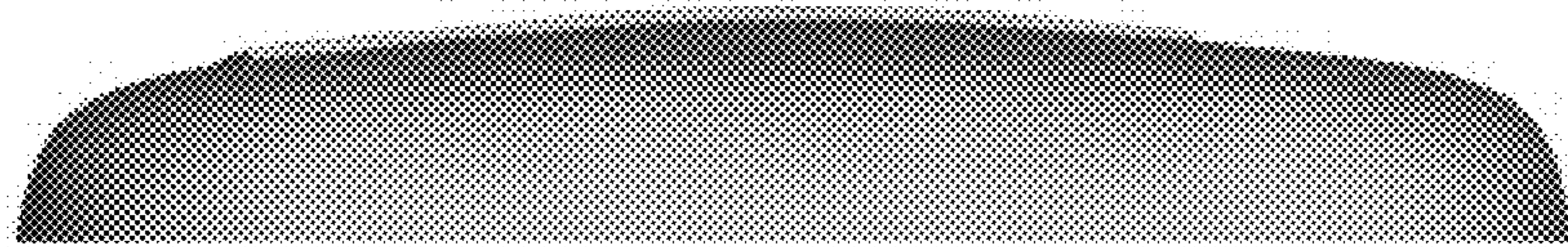

FIG. 7