



US00D851100S

(12) **United States Design Patent**  
**Belanger**

(10) **Patent No.:** **US D851,100 S**

(45) **Date of Patent:** **\*\* Jun. 11, 2019**

(54) **DISPLAY SCREEN WITH GRAPHICAL USER INTERFACE**

(71) Applicant: **Peak Innovations Inc.**, Richmond (CA)

(72) Inventor: **Nicole Eleanor Belanger**, Langley (CA)

(73) Assignee: **Peak Innovations Inc.**, Richmond (CA)

(\*\*) Term: **15 Years**

(21) Appl. No.: **29/621,762**

(22) Filed: **Oct. 11, 2017**

(30) **Foreign Application Priority Data**

Apr. 11, 2017 (CA) ..... 174062

(51) **LOC (11) Cl.** ..... **14-04**

(52) **U.S. Cl.**  
USPC ..... **D14/485**

(58) **Field of Classification Search**  
USPC ..... D14/485, 486; D20/11; D25/48.3  
CPC .... G06F 3/048; G06F 3/0481; G06F 3/04812;  
G06F 3/04817; G06F 3/0482; G06F  
3/0489; G06F 3/0484  
See application file for complete search history.

(56) **References Cited**

**U.S. PATENT DOCUMENTS**

D621,065 S \* 8/2010 Mullet ..... D25/48.3  
D748,816 S \* 2/2016 Gouge ..... D25/48.3

D757,039 S \* 5/2016 Yang ..... D14/485  
D765,684 S \* 9/2016 Zheng ..... D14/486  
D768,685 S \* 10/2016 Lee ..... D14/486  
D802,793 S \* 11/2017 Gouge ..... D25/48.3  
D808,541 S \* 1/2018 Gouge ..... D25/48.3  
10,025,887 B1 \* 7/2018 Santarone ..... G06F 17/5004  
10,026,218 B1 \* 7/2018 Mertens ..... H04N 13/332  
10,075,828 B2 \* 9/2018 Horton ..... G05B 15/02  
2018/0067593 A1 \* 3/2018 Tiwari ..... G08B 29/18

**OTHER PUBLICATIONS**

<https://www.themurphydoor.com/support/flush-mount-door/measuring-guide/> (Year: 2018).\*

<https://doordesignlab.com/faq> (Year: 2017).\*

<https://www.distinctivedoors.co.uk/measuring-guide-for-doors>.\*

\* cited by examiner

*Primary Examiner* — Melanie H Tung

(74) *Attorney, Agent, or Firm* — Smiths IP; Lawrence Chan

(57) **CLAIM**

The ornamental design for a display screen with graphical user interface, as shown and described.

**DESCRIPTION**

FIG. 1 is a front view of a display screen with graphical user interface showing my new design; and, FIG. 2 is a front view thereof, the broken line showing of a device forms no part of the claimed design. The broken line showing of the display screen and text in both views forms no part of the claimed design.

**1 Claim, 2 Drawing Sheets**

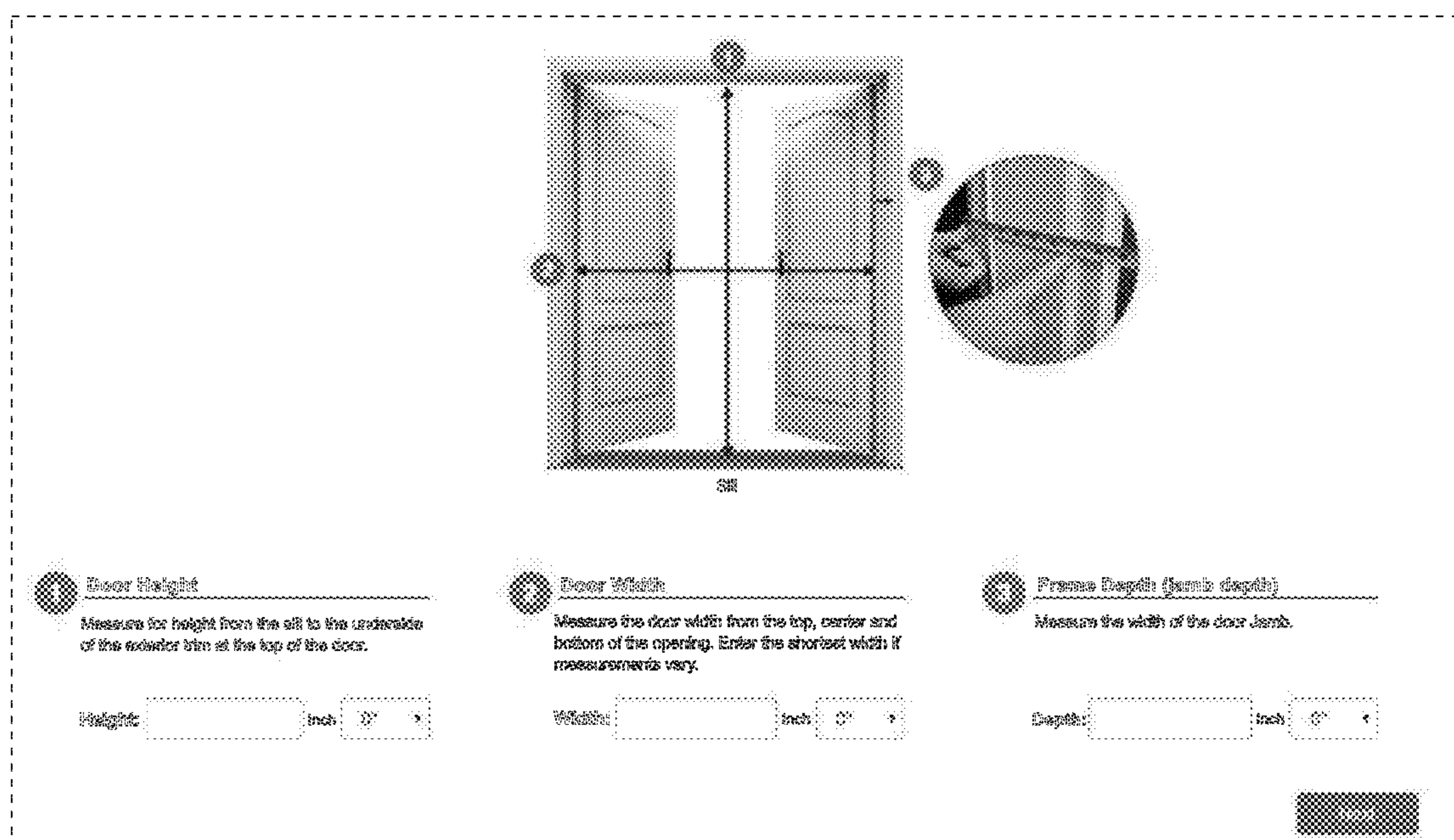



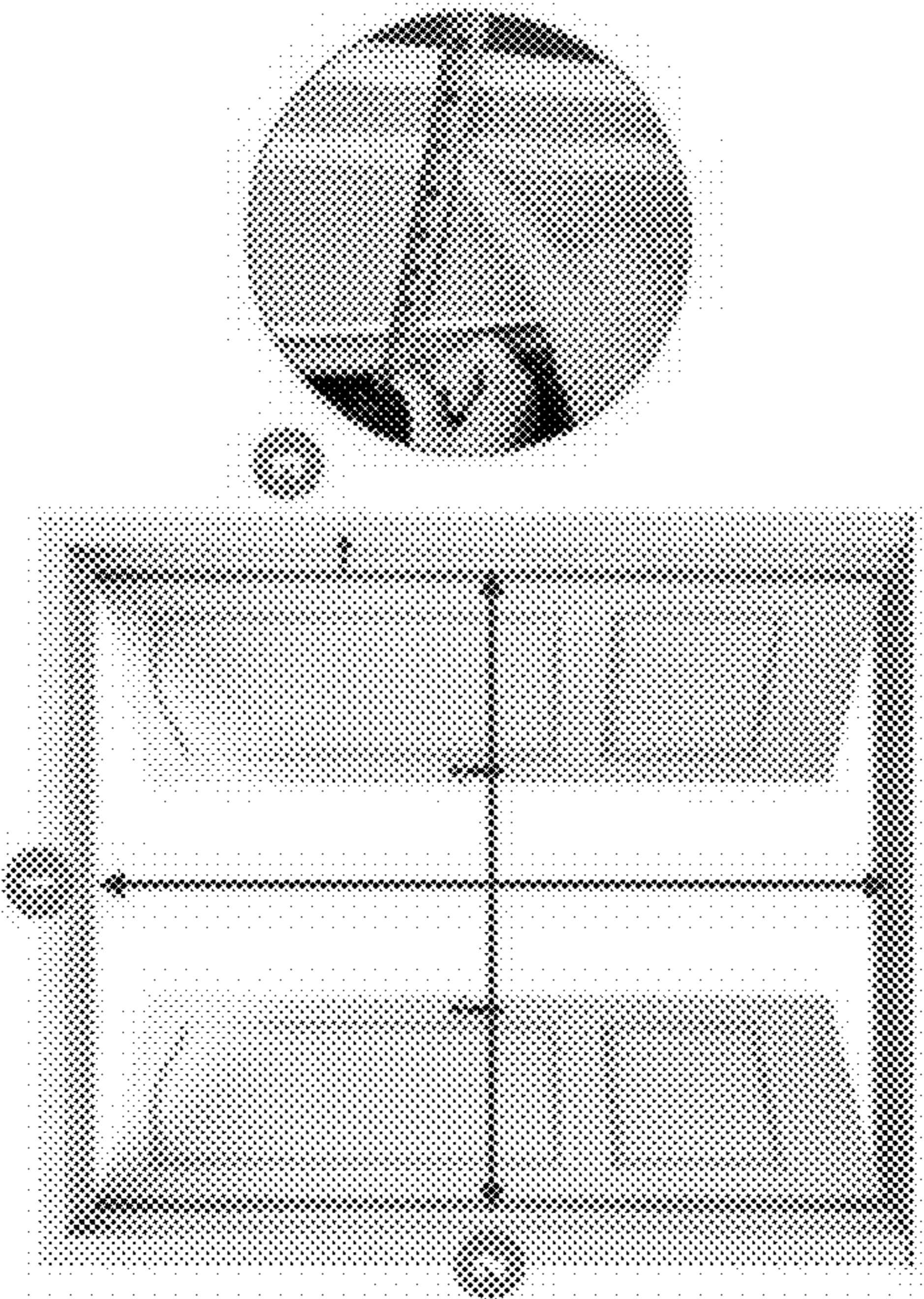

**Door Height**  
Measure for height from the sill to the underside of the exterior trim at the top of the door.

**Door Width**  
Measure the door width from the top, center and bottom of the opening. Enter the narrowest width if measurements vary.

**Frame Depth (Jamb depth)**  
Measure the width of the door jamb.

Height:  inch  x

Width:  inch  x

Depth:  inch  x

Fig. 2