



US00D850498S

(12) **United States Design Patent** (10) **Patent No.:** **US D850,498 S**
Kim et al. (45) **Date of Patent:** **** Jun. 4, 2019**

(54) **REFRIGERATOR**

(71) Applicant: **SAMSUNG ELECTRONICS CO., LTD.**, Suwon-si, Gyeonggi-do (KR)
(72) Inventors: **Ki-Soo Kim**, Gunpo-si (KR); **Seok-Woo Kim**, Seoul (KR); **Young-Min Park**, Seoul (KR); **Cheol-Woong Seo**, Seongnam-si (KR); **Ki-Sang Yoon**, Daejeong-si (KR); **Se-Lim Yoon**, Seongnam-si (KR); **Sang-Hyun Lee**, Seoul (KR); **Sun-Min Lee**, Seoul (KR); **Seon-Ju Lee**, Seoul (KR); **Jun-Kyo Lee**, Seongnam-si (KR)

(73) Assignee: **SAMSUNG ELECTRONICS CO., LTD.**, Gyeonggi-Do (KR)

(**) Term: **15 Years**

(21) Appl. No.: **29/633,239**

(22) Filed: **Jan. 12, 2018**

Related U.S. Application Data

(62) Division of application No. 29/593,210, filed on Feb. 7, 2017, now Pat. No. Des. 832,312.

(30) **Foreign Application Priority Data**

Aug. 18, 2016 (KR) 30-2016-0040308

(51) **LOC (11) Cl.** **15-07**

(52) **U.S. Cl.**
USPC **D15/86**

(58) **Field of Classification Search**
USPC D15/79-91
CPC F02M 37/18; F02M 3/045; F02M 43/00; F02M 51/04; F02M 51/0614; F02M 53/043; F02M 55/004; F02M 55/008; F02M 57/021; F02M 57/027; F02M 59/025; F02M 59/10; F02M 5/00; F02M 5/12; F02M 5/14;

(Continued)

(56) **References Cited**

U.S. PATENT DOCUMENTS

D210,560 S 3/1968 Kennedy et al.
D495,719 S 9/2004 Kirchner et al.

(Continued)

FOREIGN PATENT DOCUMENTS

CN 303655608 S 4/2016
JP D1415850 S 6/2011

OTHER PUBLICATIONS

42-Inch Built-In French Door Refrigerator, Jenn-Air [online]. pp. 1-2 [retrieved on Feb. 7, 2017]. Retrieved from the Internet: <URL: <https://jennair.com/appliances/details/JF42NXFXDE>.

(Continued)

Primary Examiner — Khawaja Anwar

(74) *Attorney, Agent, or Firm* — Cantor Colburn LLP

(57) **CLAIM**

The ornamental design for a refrigerator, as shown and described.

DESCRIPTION

FIG. 1 is a perspective view of a refrigerator showing our new design;
FIG. 2 is a front view thereof;
FIG. 3 is a rear view thereof;
FIG. 4 is a left-side view thereof;
FIG. 5 is a right-side view thereof;
FIG. 6 is a top view thereof; and,
FIG. 7 is a bottom view thereof.
The broken lines illustrating portions of the refrigerator form no part of the claimed design.
The dot-dash broken lines represent an unclaimed boundary and form no part of the claimed design.

1 Claim, 7 Drawing Sheets

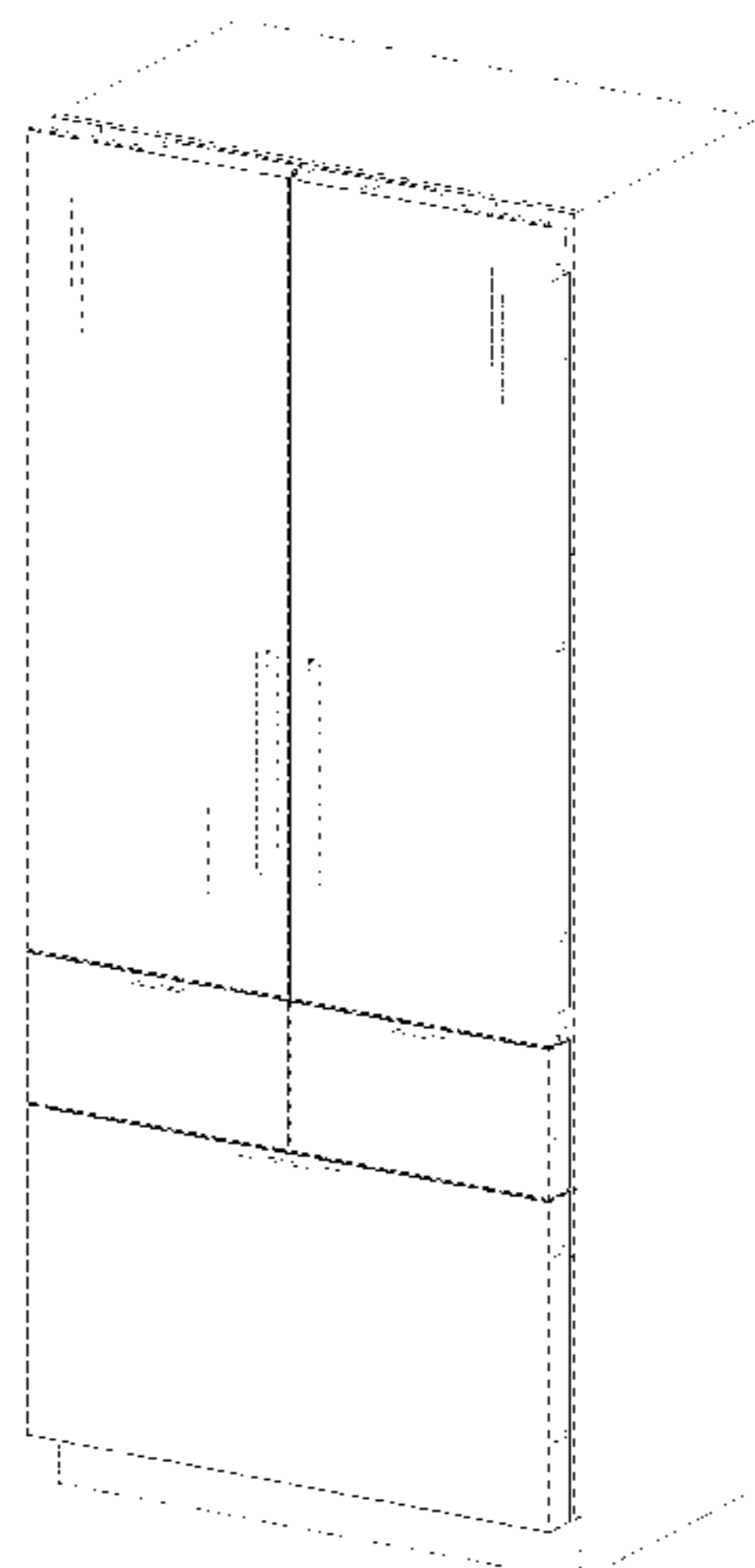

(58) **Field of Classification Search**
 CPC F02M 61/02; F02M 61/045; F02M 61/14;
 F02M 61/145; F02M 61/18; F02M
 61/184; F02M 61/1853; F02M 61/20;
 F02M 65/003; F02M 69/00; F02M
 69/041; F02M 69/043; F02M 69/32;
 F02M 69/50; F02M 7/10; F02M 7/12;
 F02M 7/133; F02M 7/17; F02M 9/12;
 F02M 9/127; F02M 9/14

See application file for complete search history.

D724,113 S	3/2015	Seo et al.	
D726,233 S	4/2015	Cho et al.	
D742,941 S	11/2015	Choi et al.	
D767,648 S	9/2016	Shoemaker et al.	
D774,569 S	12/2016	Seo et al.	
D775,674 S	1/2017	Seo et al.	
D786,317 S *	5/2017	Kim	D15/85
D786,947 S *	5/2017	Kim	D15/86
D794,685 S	8/2017	Wang et al.	
D798,343 S	9/2017	Kwon et al.	
D810,794 S *	2/2018	Kim	D15/85

(56) **References Cited**

U.S. PATENT DOCUMENTS

D570,884 S	6/2008	Yang et al.	
D632,314 S	2/2011	Kristiansen et al.	
D666,635 S	9/2012	Jidam et al.	
D674,823 S	1/2013	Jidam et al.	
D676,467 S *	2/2013	Kim	D15/86
D680,138 S	4/2013	Seo et al.	
D681,695 S	5/2013	Lee et al.	
D702,739 S *	4/2014	Kim	D15/86

OTHER PUBLICATIONS

Coupon PX. Whirlpool 26-Cu.ft. French Door [online]. pp. 1-2 [retrieved on Feb. 7, 2017]. Retrieved from the Internet: <URL: <https://www.couponpx.com/coupons/13052>.>
 Sale Stores. LG LMX25984SB 4 Door French Door Refrigerator with Ice and Water-Dispenser . . . [online]. pp. 1-2 [retrieved on Feb. 7, 2017]. Retrieved from the Internet: <URL: <http://salestores.com/IgImx25984sb.html#WJokJFUrKM9>.>

* cited by examiner

FIG. 1

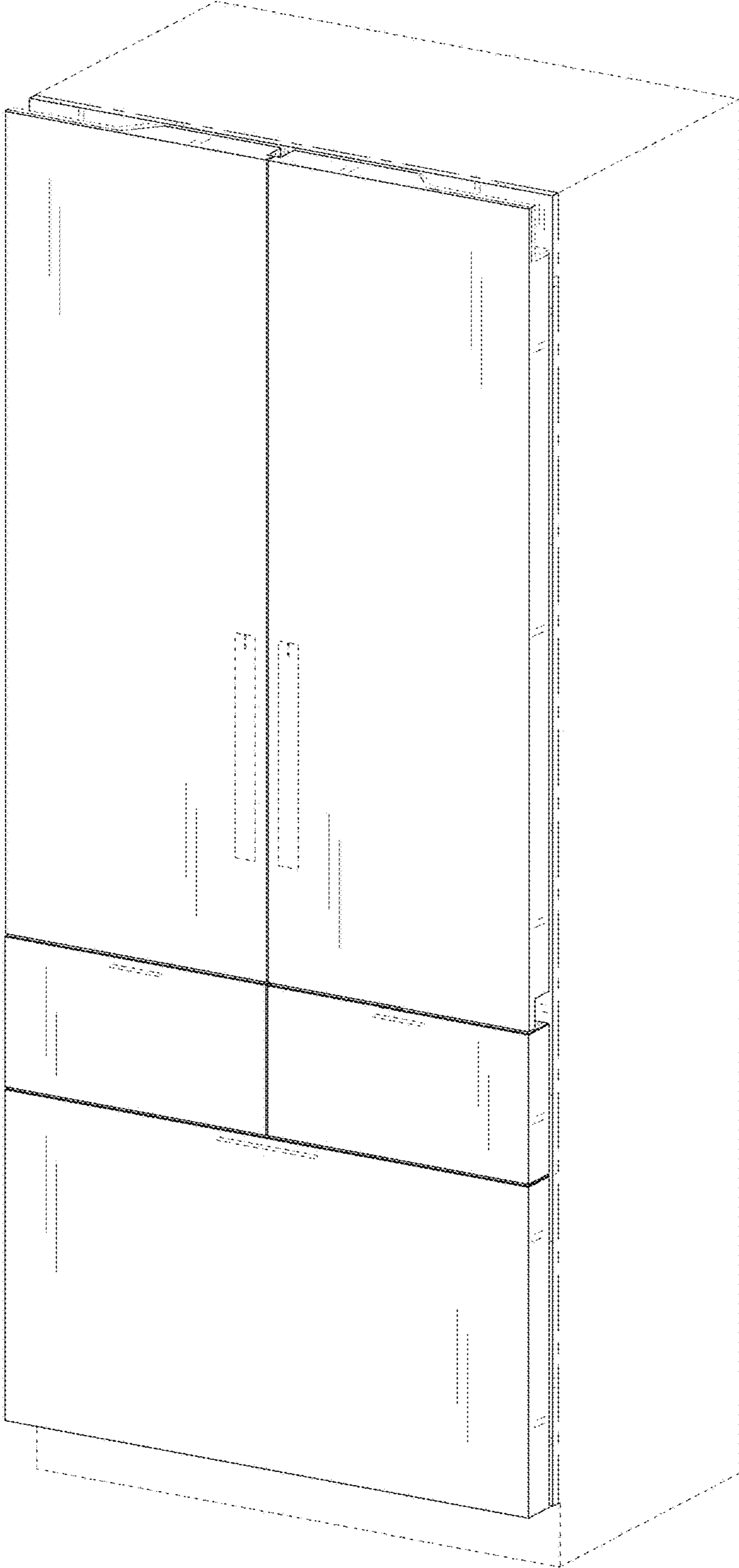

FIG. 2

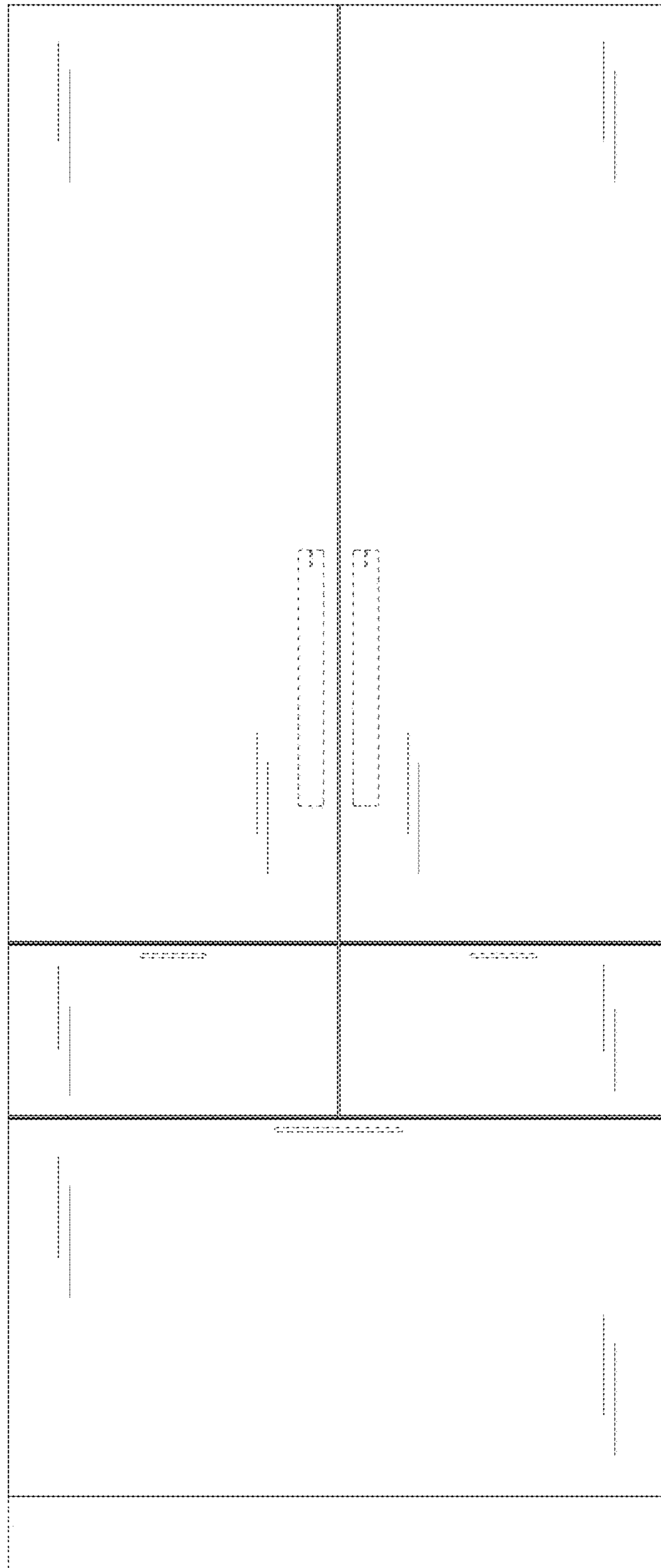

FIG. 3



FIG. 4

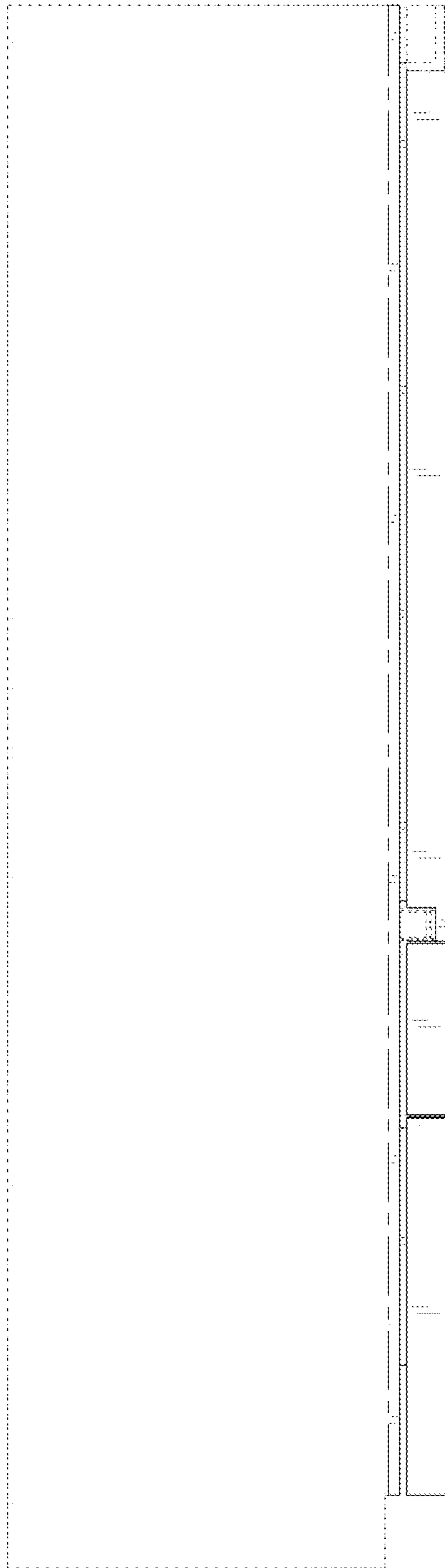

FIG. 5

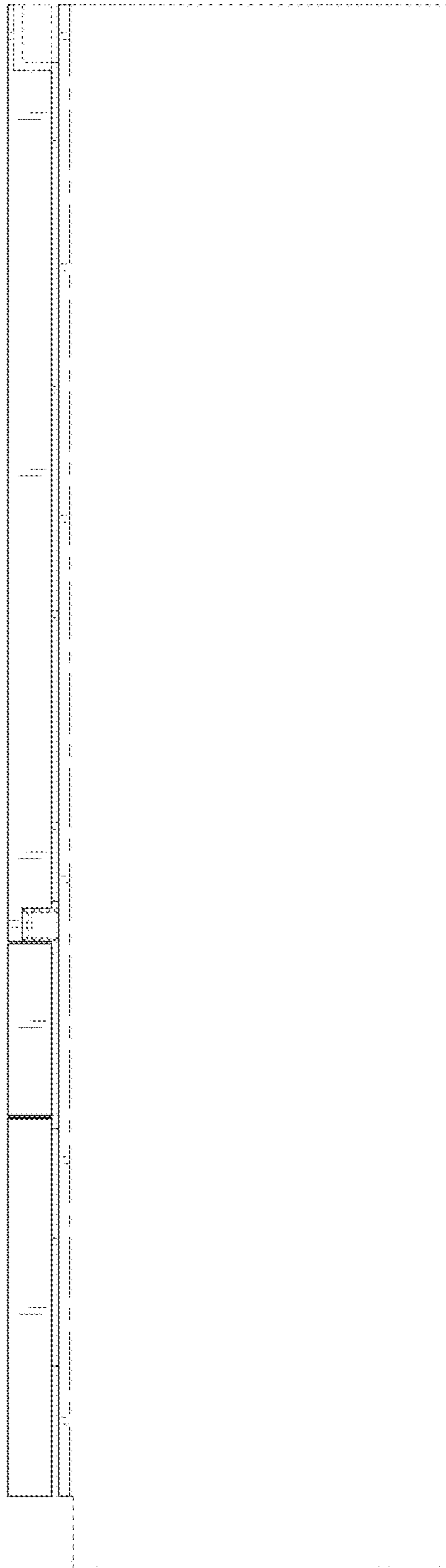

FIG. 6

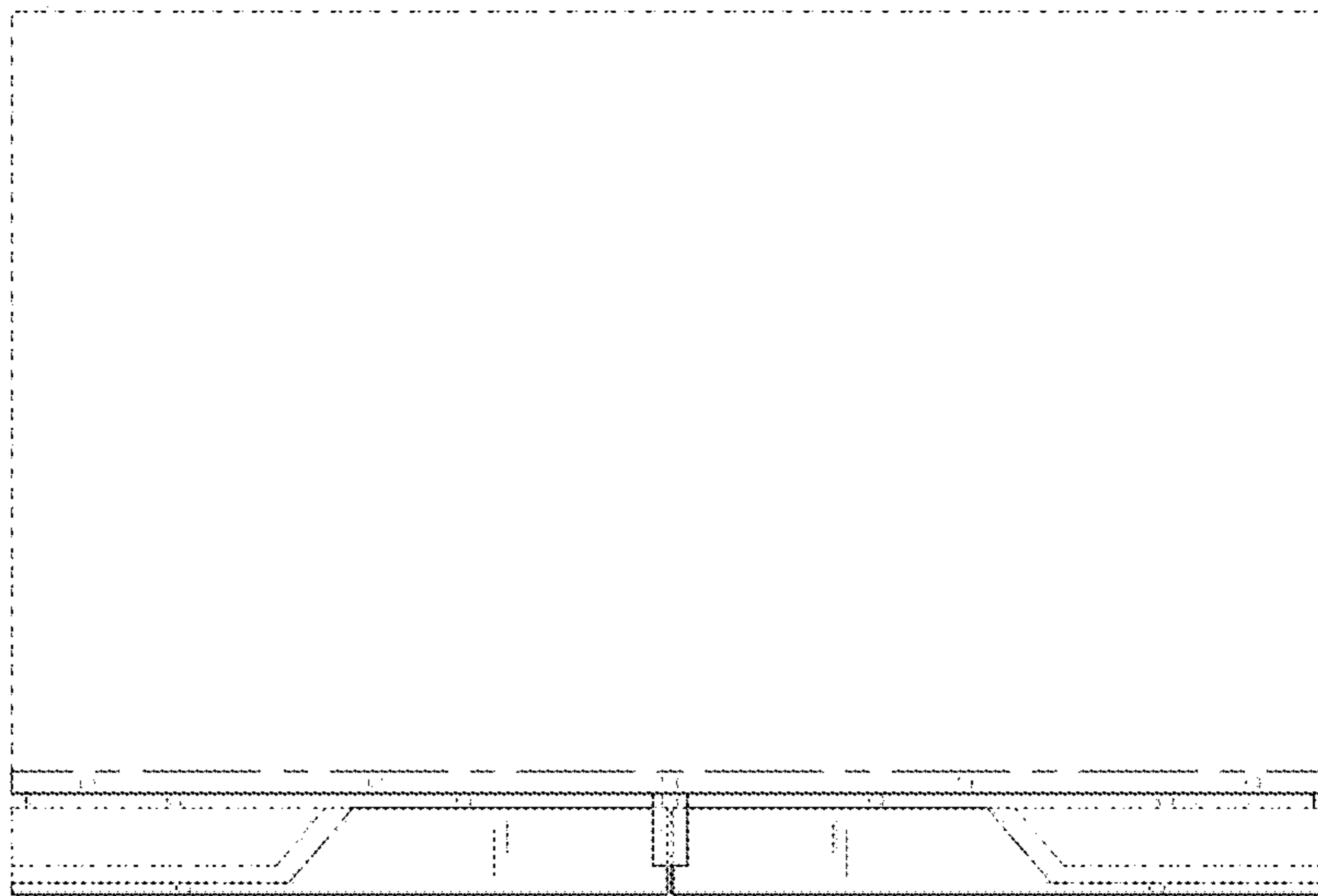

FIG. 7

