



US00D849771S

(12) **United States Design Patent** (10) **Patent No.:** **US D849,771 S**
Foley et al. (45) **Date of Patent:** **** May 28, 2019**

(54) **DISPLAY SCREEN WITH A GRAPHICAL USER INTERFACE**
(71) Applicant: **Gamblit Gaming, LLC**, Glendale, CA (US)
(72) Inventors: **Zachary Foley**, Los Angeles, CA (US); **Mark Paulik**, Wyoming, MI (US); **Edvard Toth**, Santa Monica, CA (US)
(73) Assignee: **Gamblit Gaming, LLC**, Glendale, CA (US)

D604,742 S * 11/2009 Nagata D14/486
D616,463 S * 5/2010 Barcheck D14/493
D667,430 S * 9/2012 Ouilhet D14/489
D677,326 S * 3/2013 Gleasman D18/27
D707,246 S * 6/2014 Inose D14/486
D714,342 S * 9/2014 Barling D14/492
D750,100 S * 2/2016 Lee D14/485
D751,112 S * 3/2016 Laird D14/489
D752,078 S * 3/2016 Guesnon, Jr. D14/486
D763,860 S * 8/2016 Sunshine D14/485
D765,119 S * 8/2016 Kim D14/486

(Continued)

(**) Term: **15 Years**
(21) Appl. No.: **29/619,021**
(22) Filed: **Sep. 26, 2017**
(51) **LOC (11) Cl.** **14-04**
(52) **U.S. Cl.**
USPC **D14/486; D14/488**
(58) **Field of Classification Search**
USPC D14/485–495
CPC A63F 2001/001; G06F 3/04847; G06F 3/0485; G06F 3/048; G06F 3/0488; H04N 1/00477
See application file for complete search history.

OTHER PUBLICATIONS

USPTO Patent Application No. 29/668,245, Restriction Requirement Office Action dated Dec. 19, 2018.

Primary Examiner — Darlington Ly
Assistant Examiner — Katherine A Holbrow
(74) *Attorney, Agent, or Firm* — Caitlyn Ross

(57) **CLAIM**

The ornamental design for a display screen with a graphical user interface, as shown and described.

DESCRIPTION

FIG. 1 is a front view of a first embodiment of a display screen with a graphical user interface, showing our new design; and,

FIG. 2 is a front view of a second embodiment of a display screen with a graphical user interface, showing our new design;

The outermost dual set of broken lines, outer circular features, and rounded rectangle illustrate an electronic device. The outermost broken line rectangle with square corners illustrates a display screen. The broken lines within the display screen illustrate portions of the graphical user interface. None of the broken lines form part of the claimed design.

(56) **References Cited**

U.S. PATENT DOCUMENTS

D311,023 S * 10/1990 Klein D18/27
D394,278 S * 5/1998 Nowicki D18/27
D416,550 S * 11/1999 Richter D14/489
D474,196 S * 5/2003 Tyburski D14/486
D481,041 S * 10/2003 Segal D14/486
D505,135 S * 5/2005 Sapp D14/489
D551,243 S * 9/2007 Young D14/487
D563,423 S * 3/2008 Suzuki D14/486
D585,904 S * 2/2009 Hosokawa D14/485
D585,905 S * 2/2009 Hosokawa D14/485
D589,976 S * 4/2009 Hosokawa D14/489
D591,305 S * 4/2009 Shimoda D14/485

1 Claim, 2 Drawing Sheets

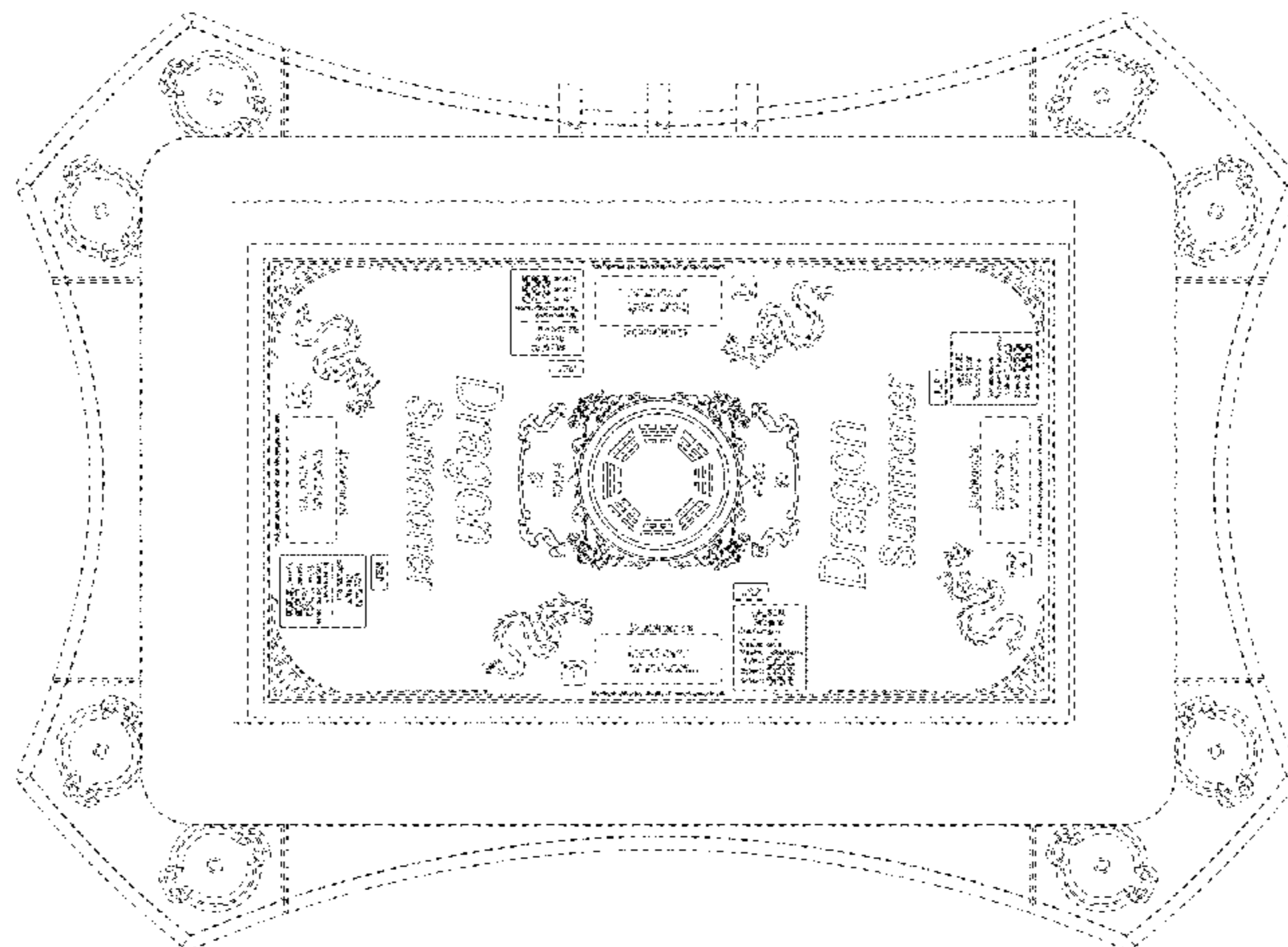

(56)

References Cited

U.S. PATENT DOCUMENTS

D766,297	S	*	9/2016	Kim	D14/486
D773,531	S	*	12/2016	Toth	D14/491
D777,194	S	*	1/2017	Sellers	D14/486
D780,773	S	*	3/2017	Sharp	D14/485
D781,340	S	*	3/2017	Toth	D14/488
D785,037	S	*	4/2017	Bi	D14/488
D803,878	S	*	11/2017	Lin	D14/489
9,818,260	B2	*	11/2017	Arnone	G07F 17/3227
D819,663	S	*	6/2018	Sharp	D14/485
D820,851	S	*	6/2018	Sharp	D14/485
D823,888	S	*	7/2018	Toth	D14/488
D825,585	S	*	8/2018	Sharp	D14/485
D830,383	S	*	10/2018	Sellers	D14/486
D832,861	S	*	11/2018	Toth	D14/485
2013/0244784	A1	*	9/2013	Assa	G06F 3/0488 463/40
2016/0104344	A1	*	4/2016	Meyer	G07F 17/34 463/20

* cited by examiner

