



US00D848840S

(12) **United States Design Patent**
Fukumoto et al.

(10) **Patent No.:** **US D848,840 S**

(45) **Date of Patent:** **** May 21, 2019**

(54) **CONTAINER LID**

(71) Applicants: **Kikkoman Corporation**, Chiba (JP);
Yoshino Kogyosho Co., Ltd., Tokyo
(JP)

(72) Inventors: **Masashi Fukumoto**, Noda (JP); **Denmi
Kuwagaki**, Noda (JP); **Keisuke
Miyairi**, Tokyo (JP); **Satoshi
Sakamoto**, Tokyo (JP)

(73) Assignees: **Kikkoman Corporation**, Chiba (JP);
Yoshino Kogyosho Co., Ltd., Tokyo
(JP)

(**) Term: **15 Years**

(21) Appl. No.: **29/614,170**

(22) Filed: **Aug. 16, 2017**

Related U.S. Application Data

(62) Division of application No. 35/500,773, filed on Sep.
30, 2015 (U.S. filing date under 35 U.S.C. 384), and
(Continued)

(30) **Foreign Application Priority Data**

Apr. 1, 2015 (JP) 2015-007390
Apr. 1, 2015 (JP) 2015-007391
(Continued)

(51) **LOC (11) Cl.** **09-07**

(52) **U.S. Cl.**
USPC **D9/447**

(58) **Field of Classification Search**
USPC D9/447, 552, 697, 560, 708, 529, 565,
D9/449, 436, 563, 559, 500, 503, 575,
(Continued)

(56) **References Cited**

U.S. PATENT DOCUMENTS

3,820,692 A * 6/1974 Swett et al. B65D 47/0895
222/547
D298,014 S * 10/1988 McGlyn D9/446
(Continued)

Primary Examiner — Rhea Shields

(74) *Attorney, Agent, or Firm* — Sterne, Kessler,
Goldstein & Fox P.L.L.C.

(57) **CLAIM**

The ornamental design for a container lid, as shown and
described.

DESCRIPTION

FIG. 1 is a front view of a container lid showing the claimed
design;
FIG. 2 is a rear view thereof;
FIG. 3 is a top view thereof;
FIG. 4 is a bottom side view thereof;
FIG. 5 is a right side view thereof;
FIG. 6 is a top front perspective view thereof;
FIG. 7 is an enlarged front view of the thereof;
FIG. 8 is an enlarged rear view thereof;
FIG. 9 is an enlarged top view thereof;
FIG. 10 is an enlarged right side view thereof;
FIG. 11 is an enlarged top front perspective view thereof;
and,
FIG. 12 is a cross-sectional view thereof, taken along the
line 12-12' of FIG. 10.
The left side view is omitted in each design since the left side
view is symmetrical to a right side view.
The broken lines in the figures show portions of the con-
tainer lid and environment that form no part of the claimed
design.

1 Claim, 12 Drawing Sheets

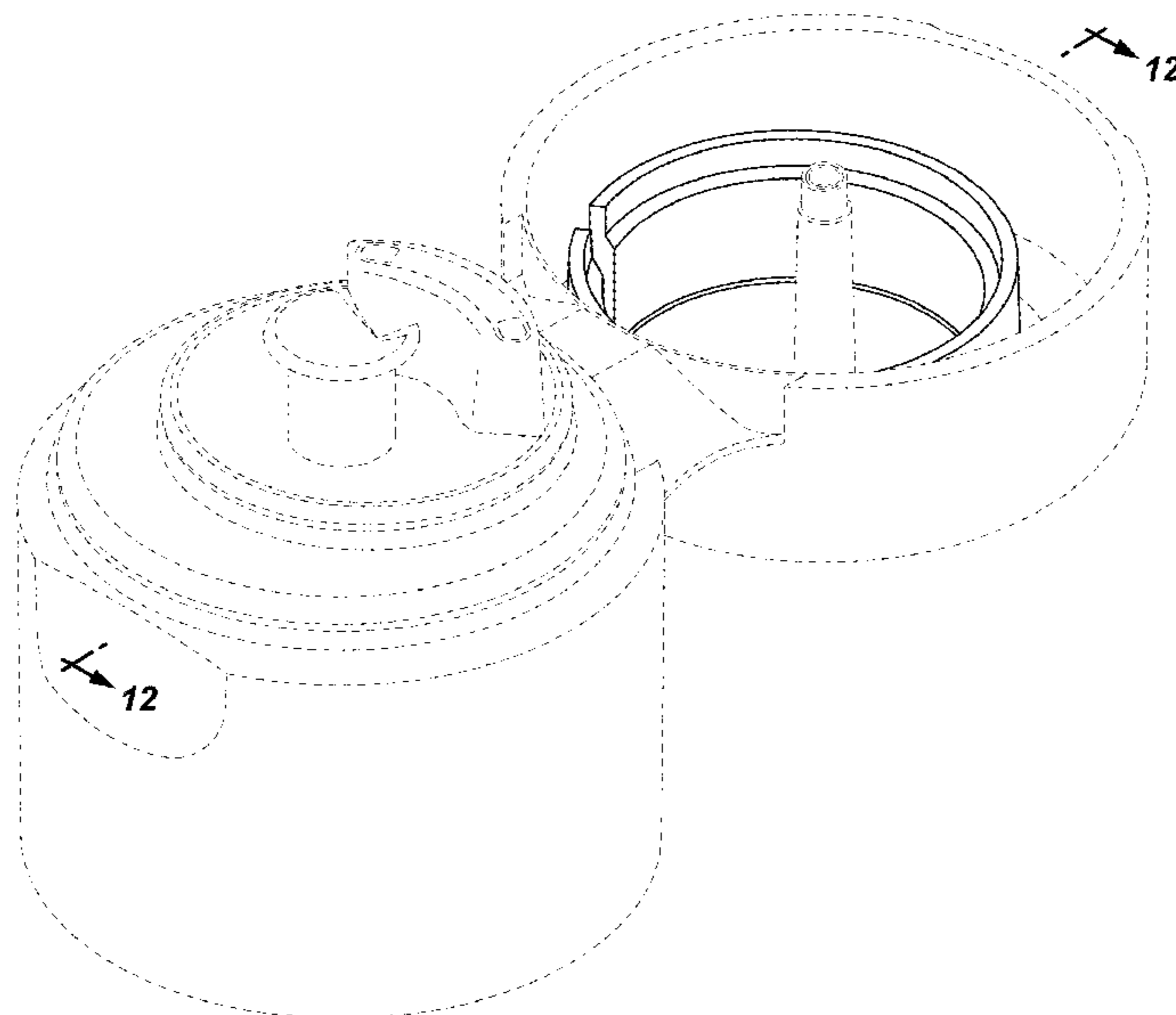

Related U.S. Application Data

having an international filing date of Sep. 30, 2015,
now Pat. No. Des. 798,712.

(30) **Foreign Application Priority Data**

Apr. 1, 2015 (JP) 2015-007392
Apr. 1, 2015 (JP) 2015-007393

(58) **Field of Classification Search**

USPC D9/558, 452, 439, 435, 504, 434, 446;
D7/392.1, 377, 510, 700; 222/547, 95,
222/105; D23/366; 220/256.1
CPC B65D 77/06; B65D 83/0061;
B65D 47/0895; B65D 1/02; B65D
47/0838; B65D 41/04; B65D 35/14; A61J
1/1418

See application file for complete search history.

(56) **References Cited**

U.S. PATENT DOCUMENTS

D402,202 S * 12/1998 Sherman D9/446
D585,278 S * 1/2009 Wilson D9/449
D614,488 S * 4/2010 Kallenbach D9/449
D629,685 S * 12/2010 Brannon D9/446
D672,241 S * 12/2012 Sawicki D9/449
D676,333 S * 2/2013 Fracasso D9/697
D680,434 S * 4/2013 Fracasso D9/447

D688,554 S * 8/2013 Fracasso D9/447
D701,765 S * 4/2014 Fukumoto D9/447
D711,230 S * 8/2014 den Boer D9/449
D713,723 S * 9/2014 den Boer D9/449
D713,724 S * 9/2014 den Boer D9/449
D722,267 S * 2/2015 Miranda De Araujo D9/449
D740,678 S * 10/2015 Fukumoto D9/559
9,315,313 B2 * 4/2016 Kuwagaki B65D 83/0061
D761,058 S * 7/2016 Ou D7/510
D775,952 S * 1/2017 Kim D9/452
D779,940 S * 2/2017 Kim D9/449
D780,579 S * 3/2017 Kim D9/449
D782,310 S * 3/2017 Li D9/434
D798,712 S * 10/2017 Fukumoto D9/447
D807,171 S * 1/2018 Miller D9/435
D808,721 S * 1/2018 Soni D7/510
D814,931 S * 4/2018 Alima D9/504
D817,169 S * 5/2018 Dzikowicz D9/449
D818,309 S * 5/2018 Jasso Gomez D7/392.1
D820,677 S * 6/2018 D'Anglade D9/435
D823,115 S * 7/2018 Walker D9/447
D828,158 S * 9/2018 Manis D9/436
D828,718 S * 9/2018 Ksiazek D7/392.1
D829,065 S * 9/2018 Marantis D7/700
2010/0219186 A1 * 9/2010 Kuwagaki B65D 47/0838
220/256.1
2014/0144938 A1 * 5/2014 Kakuta B65D 35/14
222/105
2018/0016085 A1 * 1/2018 Kitora B65D 1/02
2018/0251274 A1 * 9/2018 Hashimoto B65D 41/04

* cited by examiner

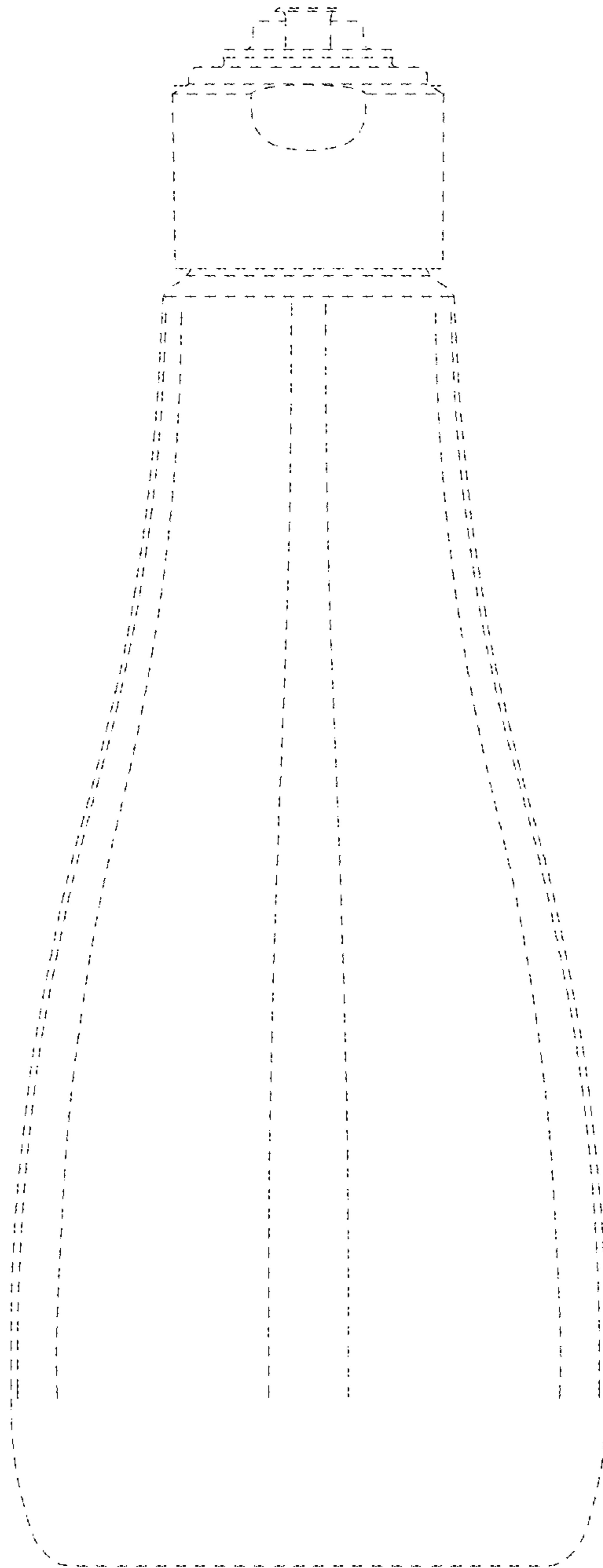

FIG. 1

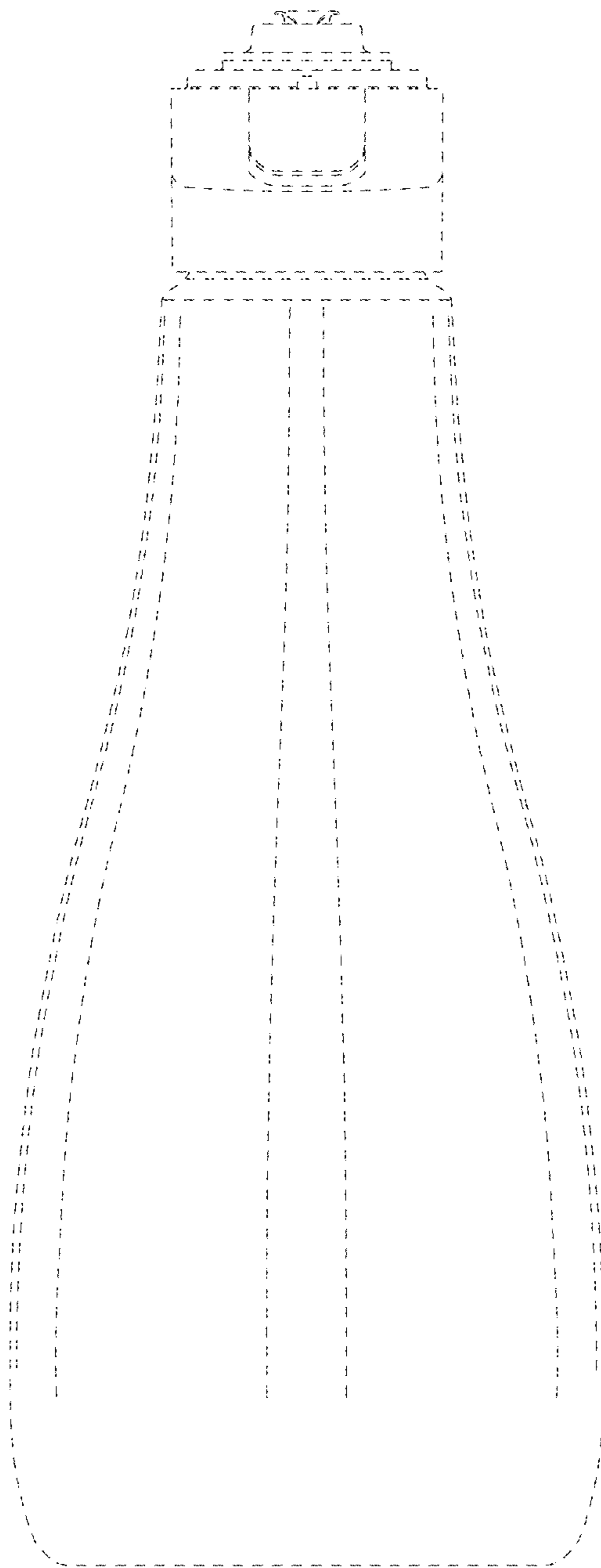

FIG. 2

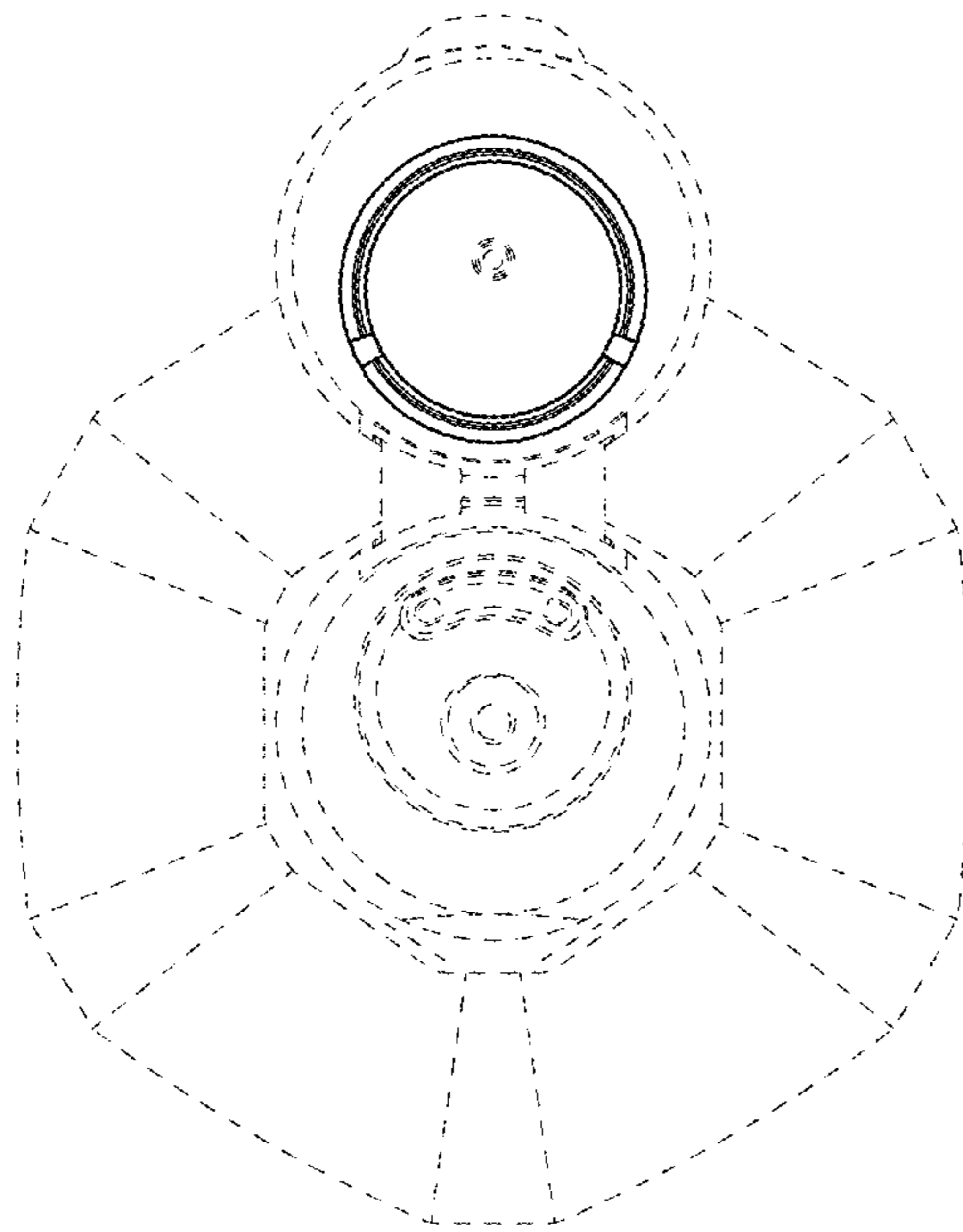

FIG. 3

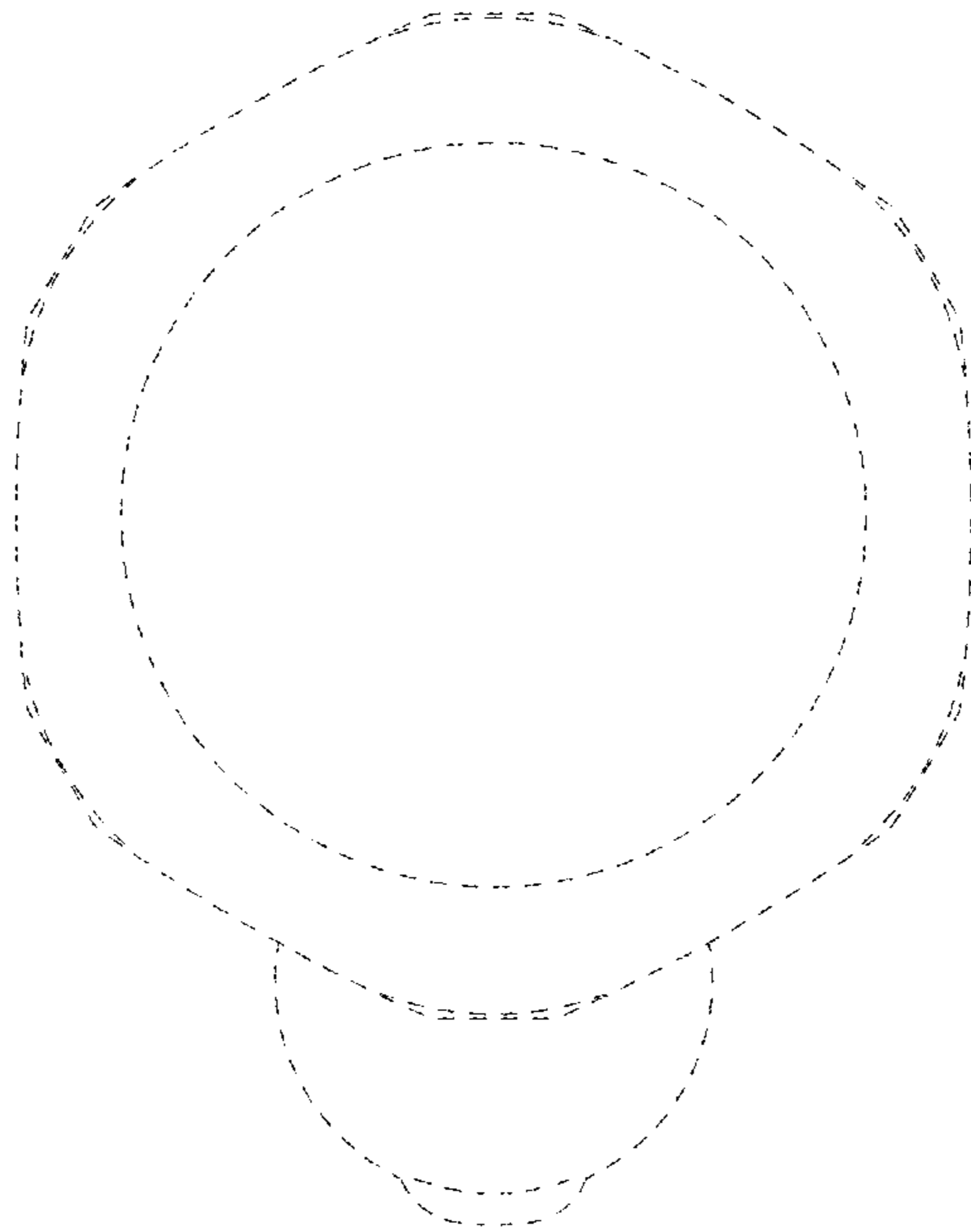

FIG. 4

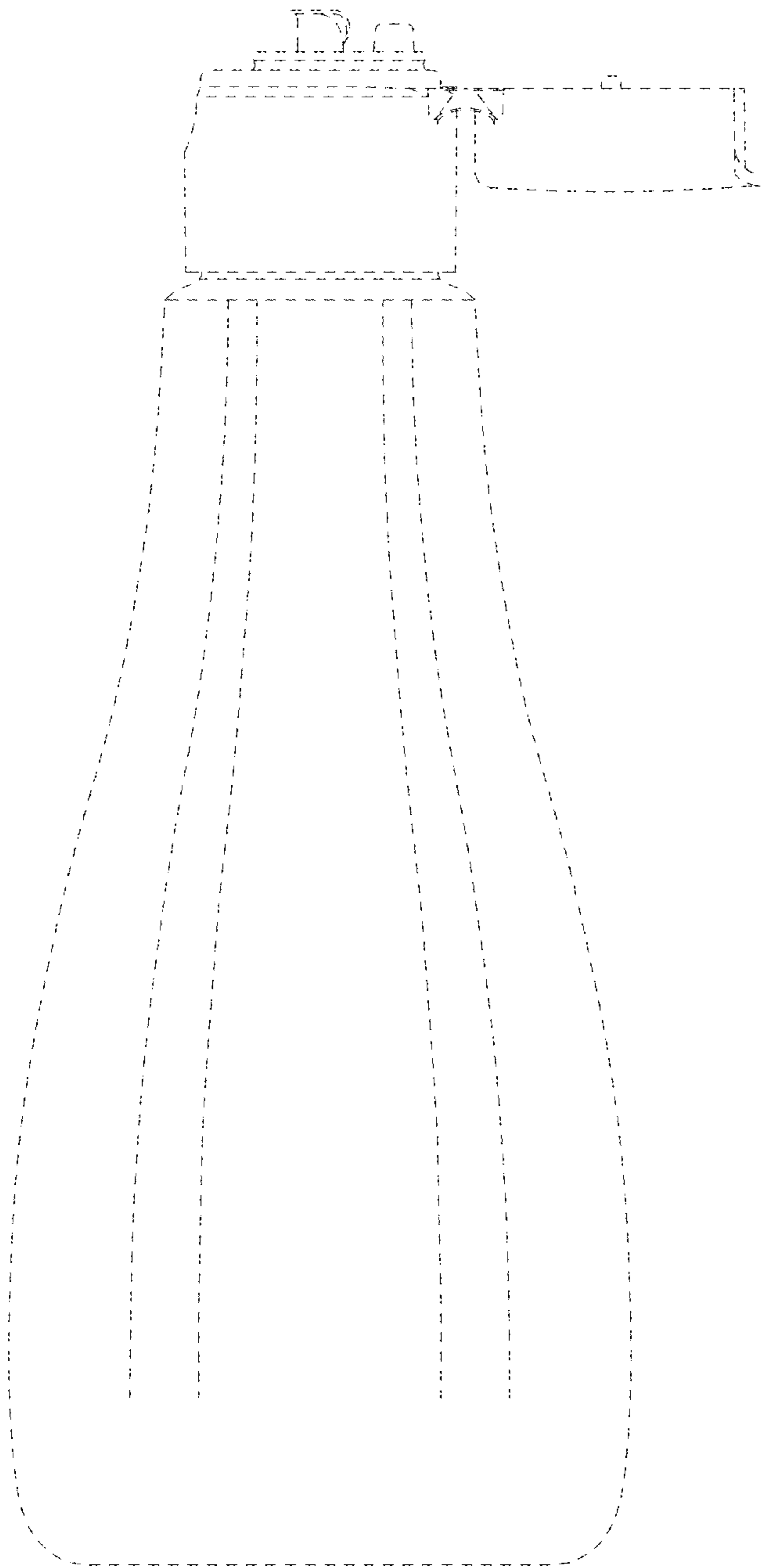

FIG. 5

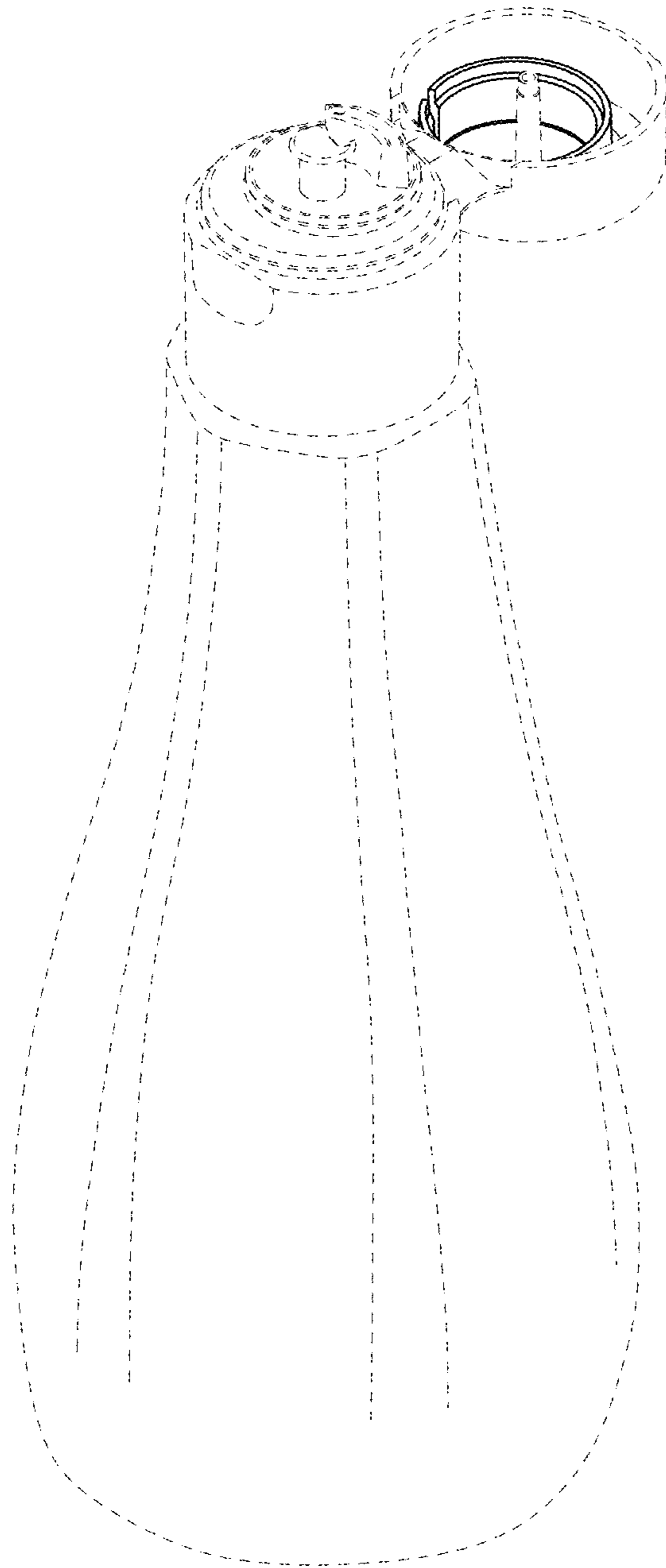

FIG. 6

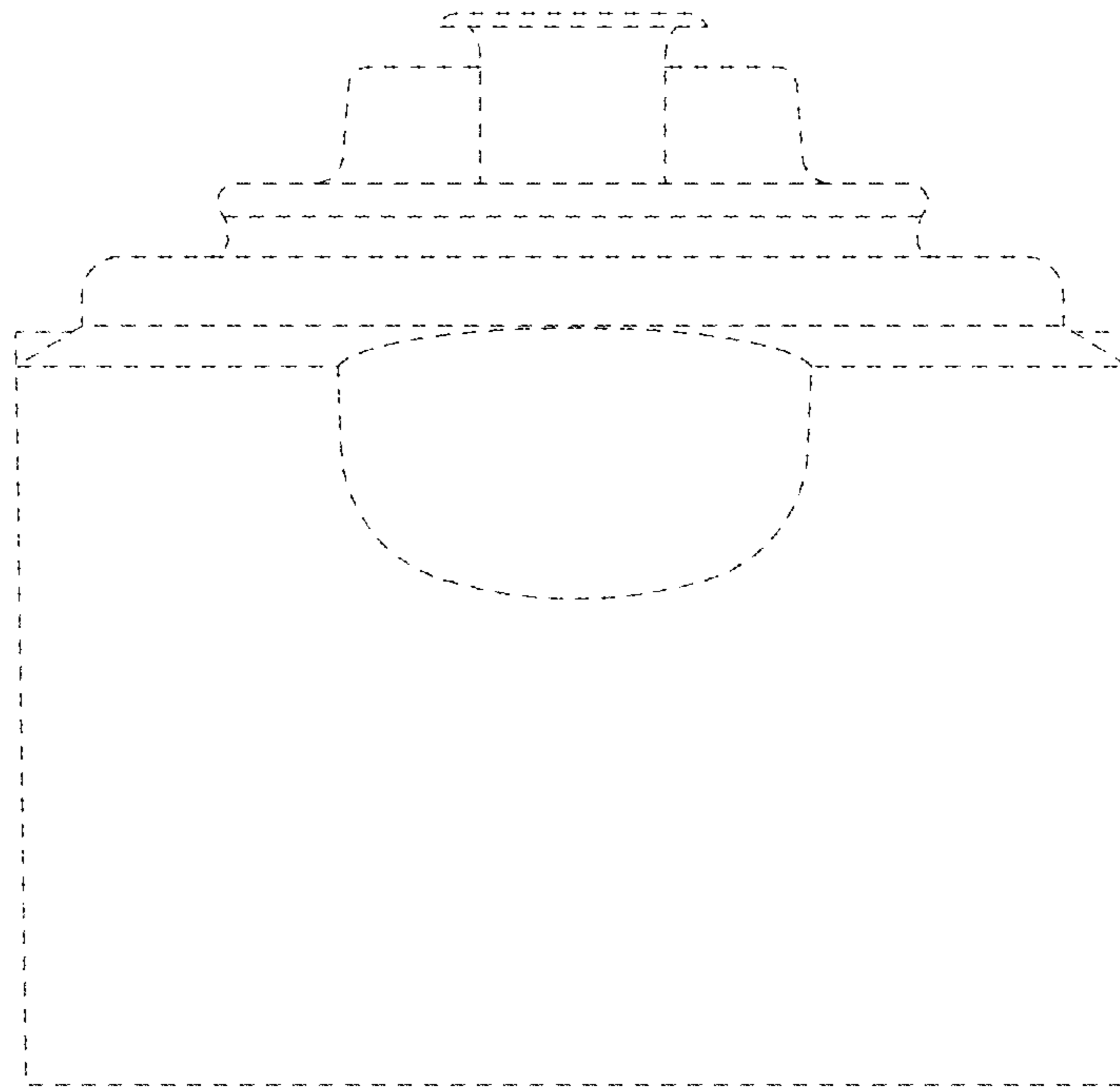

FIG. 7

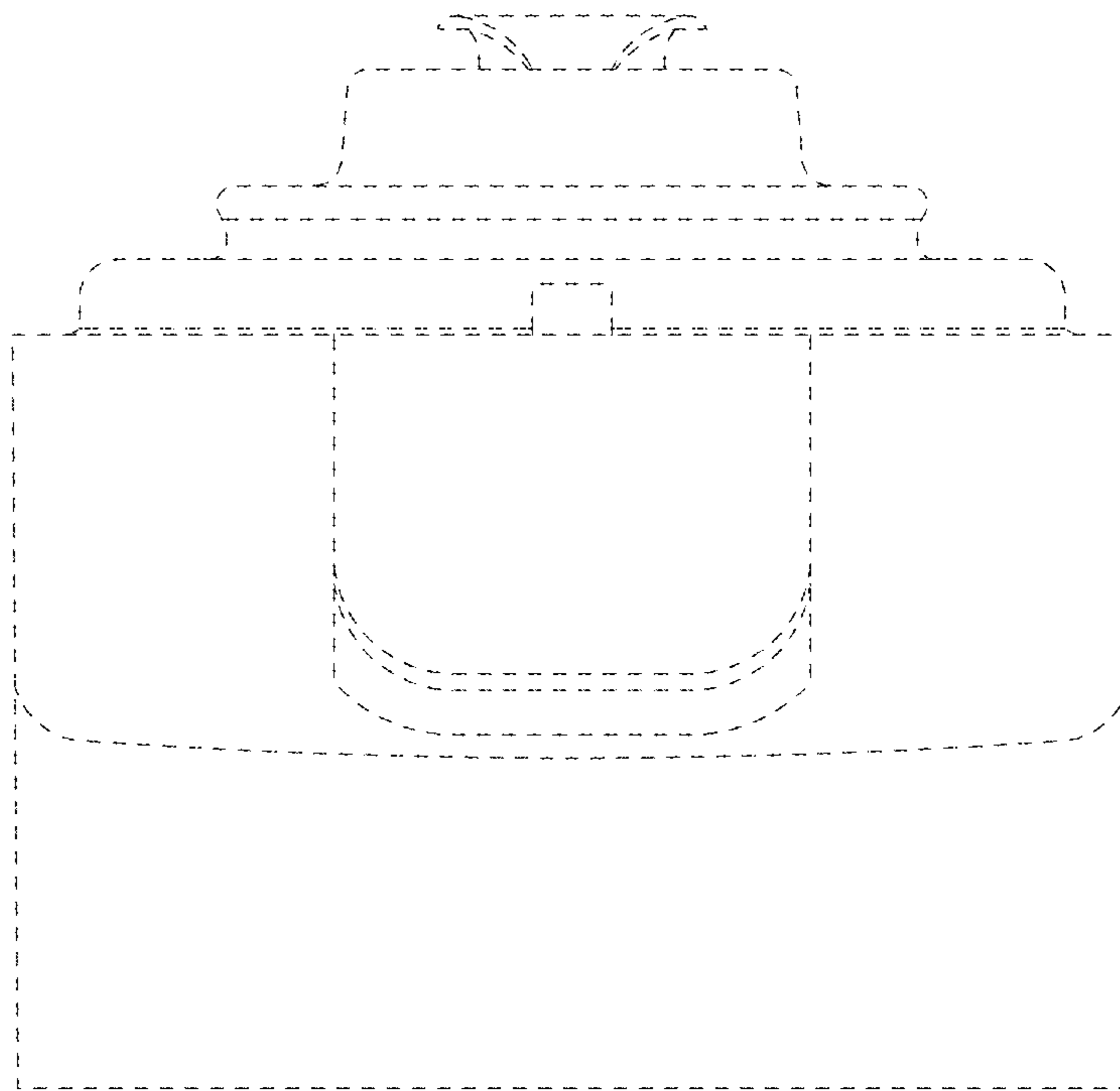

FIG. 8

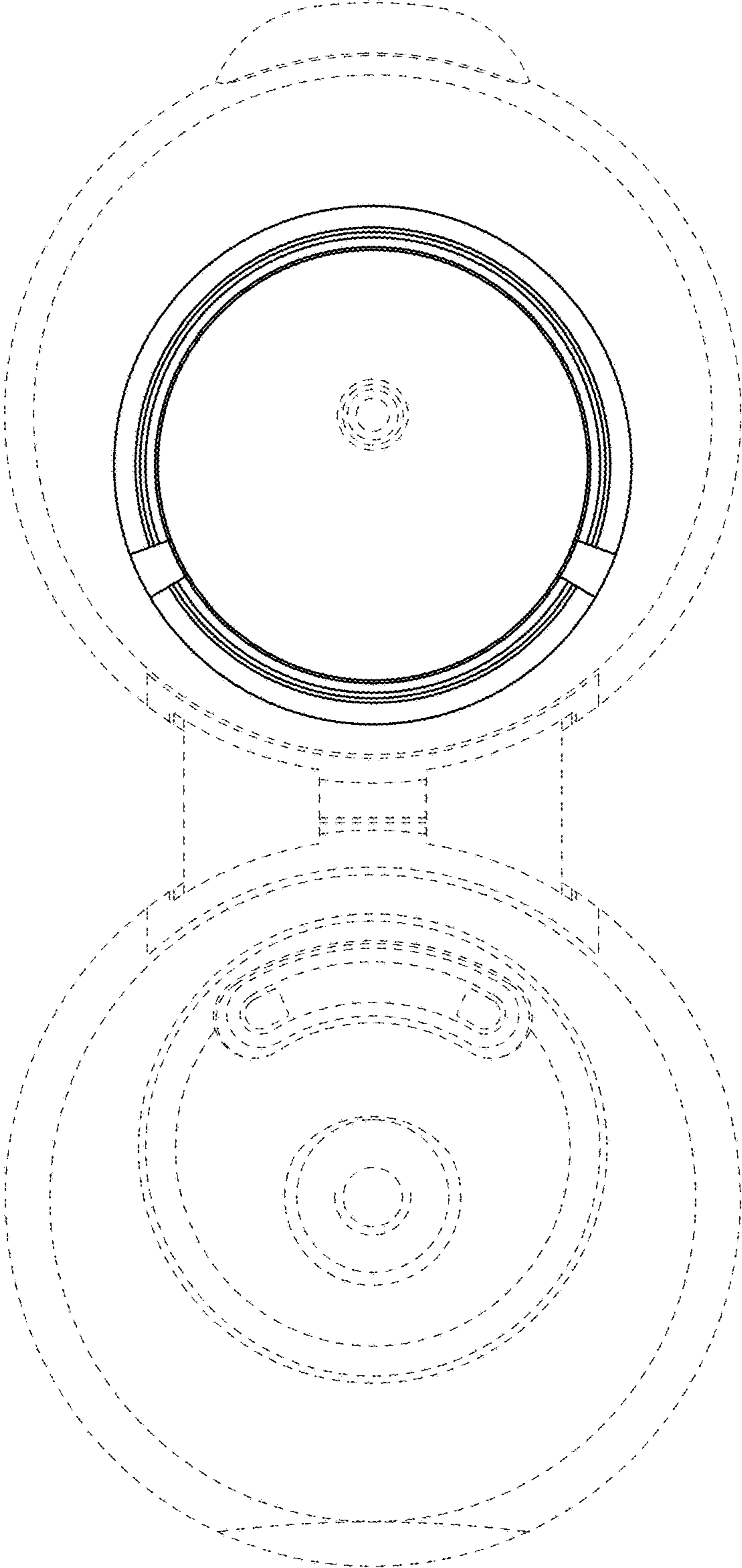

FIG. 9

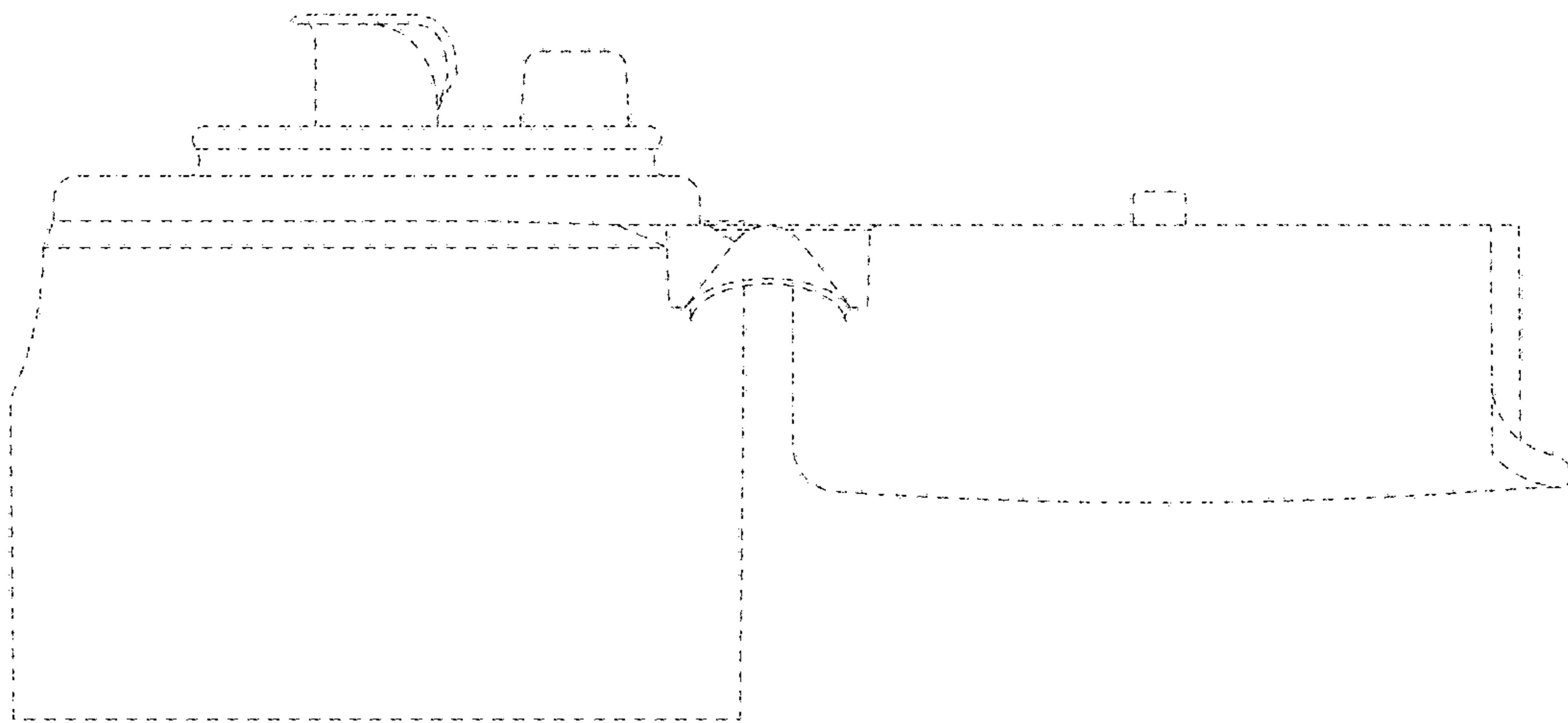

FIG. 10

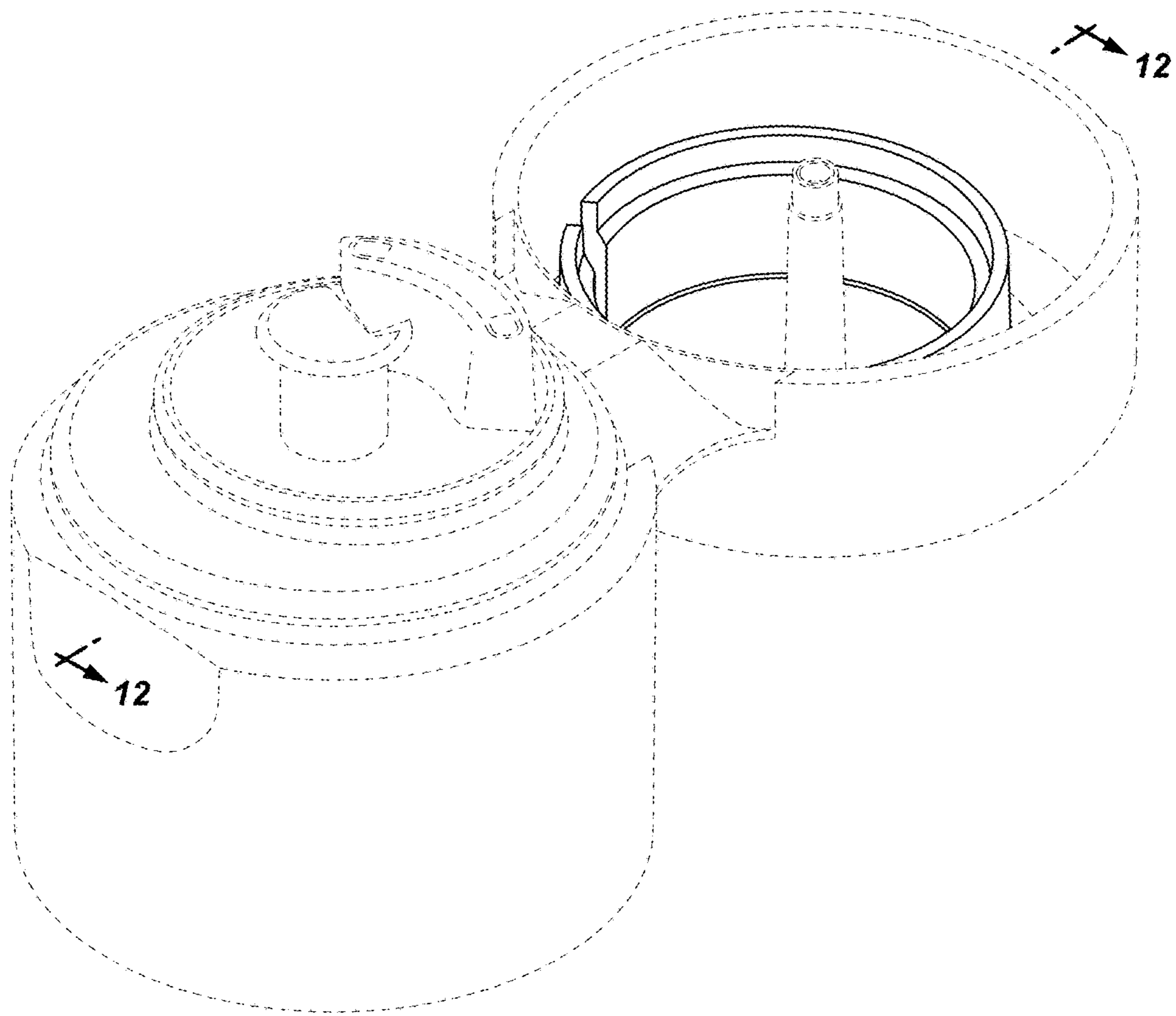

FIG. 11

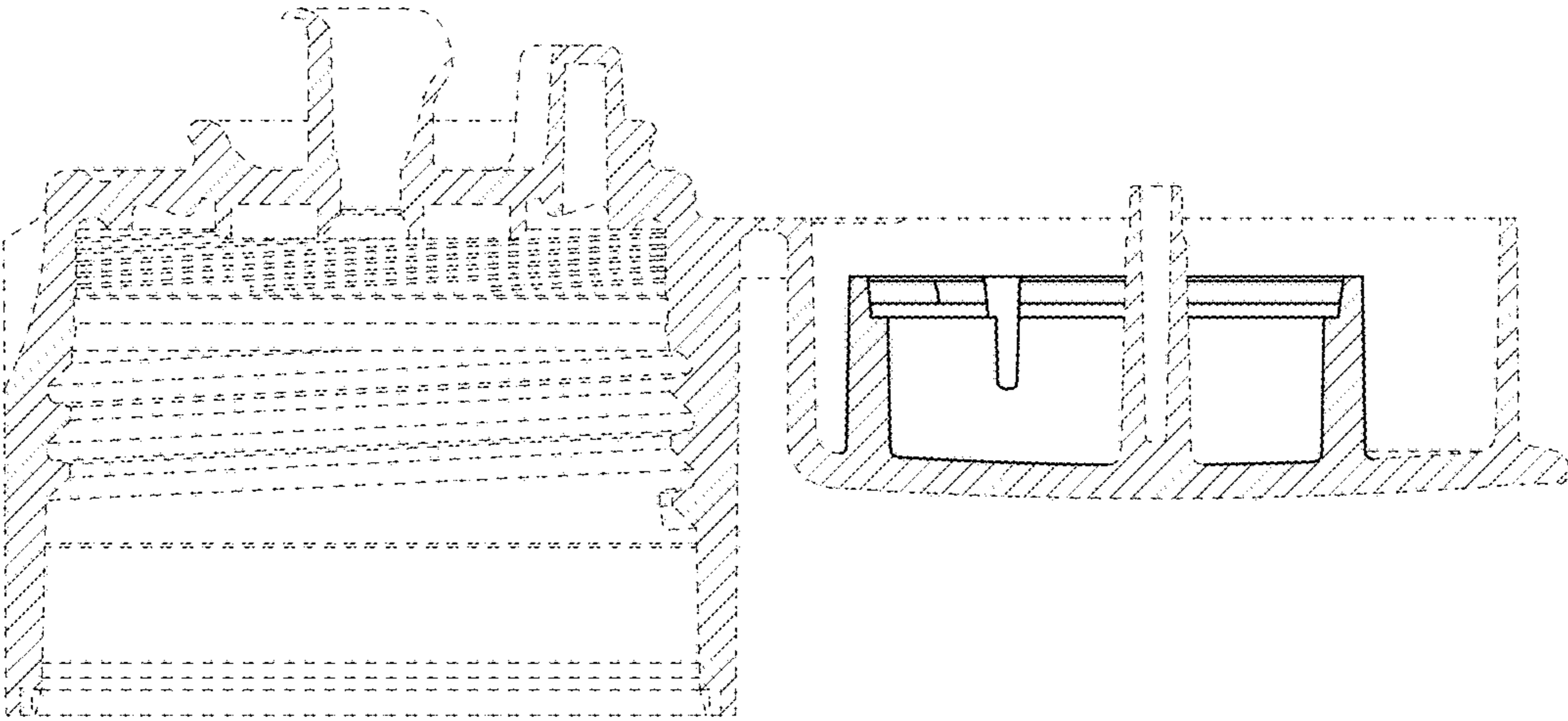

FIG. 12