



US00D847912S

(12) **United States Design Patent** (10) **Patent No.:** **US D847,912 S**
Wood (45) **Date of Patent:** **** May 7, 2019**

(54) **REAR AXLE FOR A MODEL VEHICLE**
(71) Applicant: **TRAXXAS LP**, McKinney, TX (US)
(72) Inventor: **Jonathan Scott Wood**, Lewisville, TX (US)
(73) Assignee: **TRAXXAS LP**, McKinney, TX (US)
(**) Term: **15 Years**

D304,473 S 11/1989 Poulsen
D311,942 S 11/1990 Dideriksen
D332,978 S 2/1993 Tsuchiya
D341,560 S * 11/1993 Fabris D12/160
5,338,247 A 8/1994 Miles
5,498,208 A 3/1996 Braun
D403,023 S 12/1998 Araki
5,954,586 A 9/1999 Kirson
6,394,878 B1 5/2002 Wang
6,416,136 B1 7/2002 Smith
(Continued)

(21) Appl. No.: **29/592,276**
(22) Filed: **Jan. 27, 2017**
(51) **LOC (11) Cl.** **21-01**
(52) **U.S. Cl.**
USPC **D21/495**
(58) **Field of Classification Search**
USPC D12/114, 160; 280/124.116, 124.11;
301/124.1, 125; 475/230; D21/495, 561,
D21/562
CPC B60B 27/06; B60B 2900/313; B60B
2360/108; B60B 2360/102; B60B
2900/212; B60Y 2200/114
See application file for complete search history.

OTHER PUBLICATIONS

Axial; Axial SCX10 II; Aug. 2016.
(Continued)

Primary Examiner — Robin V Webster
Assistant Examiner — Keith J Wilson
(74) *Attorney, Agent, or Firm* — Daryl R. Wright; Greg Carr

(57) **CLAIM**

I claim the ornamental design for a rear axle for a model vehicle, as shown and described.

DESCRIPTION

FIG. 1 is an upper, left, front perspective view of a rear axle for a model vehicle;
FIG. 2 is an upper, right, rear perspective view thereof;
FIG. 3 is a front elevation view thereof;
FIG. 4 is a rear elevation view thereof;
FIG. 5 is a left side elevation view thereof;
FIG. 6 is a right, side elevation view thereof;
FIG. 7 is a top plan view thereof; and,
FIG. 8 is a bottom plan view thereof.
In the drawings, the broken line showing of features of the rear axle for a model vehicle illustrate portions of the rear axle for a model vehicle that form no part of the claimed design.

1 Claim, 4 Drawing Sheets

(56) **References Cited**
U.S. PATENT DOCUMENTS
1,377,905 A 5/1921 Martz
1,455,706 A 5/1923 Bower et al.
2,041,992 A 5/1936 Noel
2,083,085 A 6/1937 Palmer
2,132,545 A 10/1938 Smith
2,547,435 A 4/1951 Bouchard
3,306,077 A 2/1967 Piatti
3,333,654 A 8/1967 Price-Stephens
3,767,221 A 10/1973 Asberg
D242,442 S * 11/1976 Garrison D12/114
4,509,932 A 4/1985 Weible
4,632,203 A 12/1986 Krude
4,690,656 A 9/1987 Friendman et al.
D304,472 S 11/1989 Poulsen

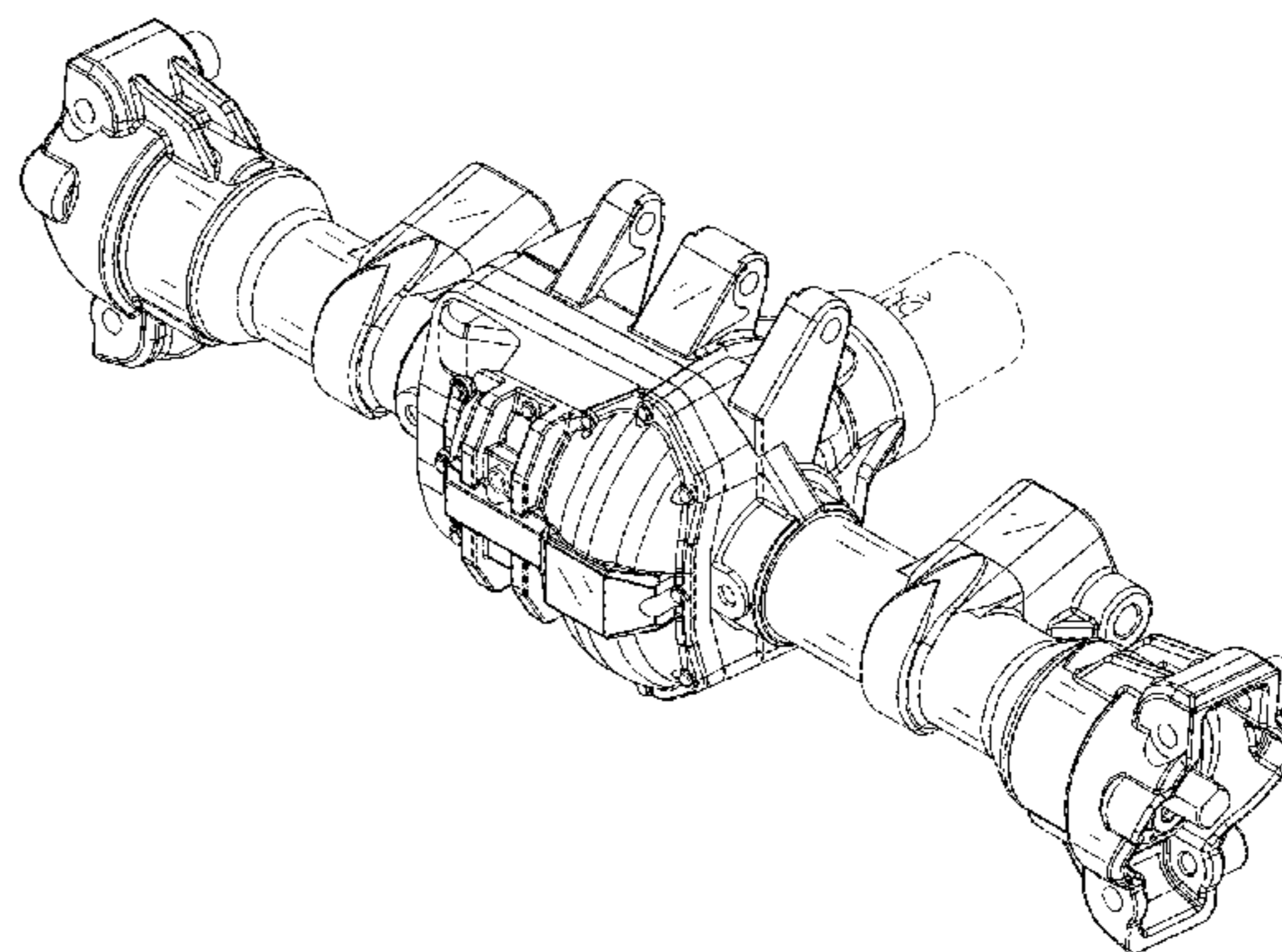
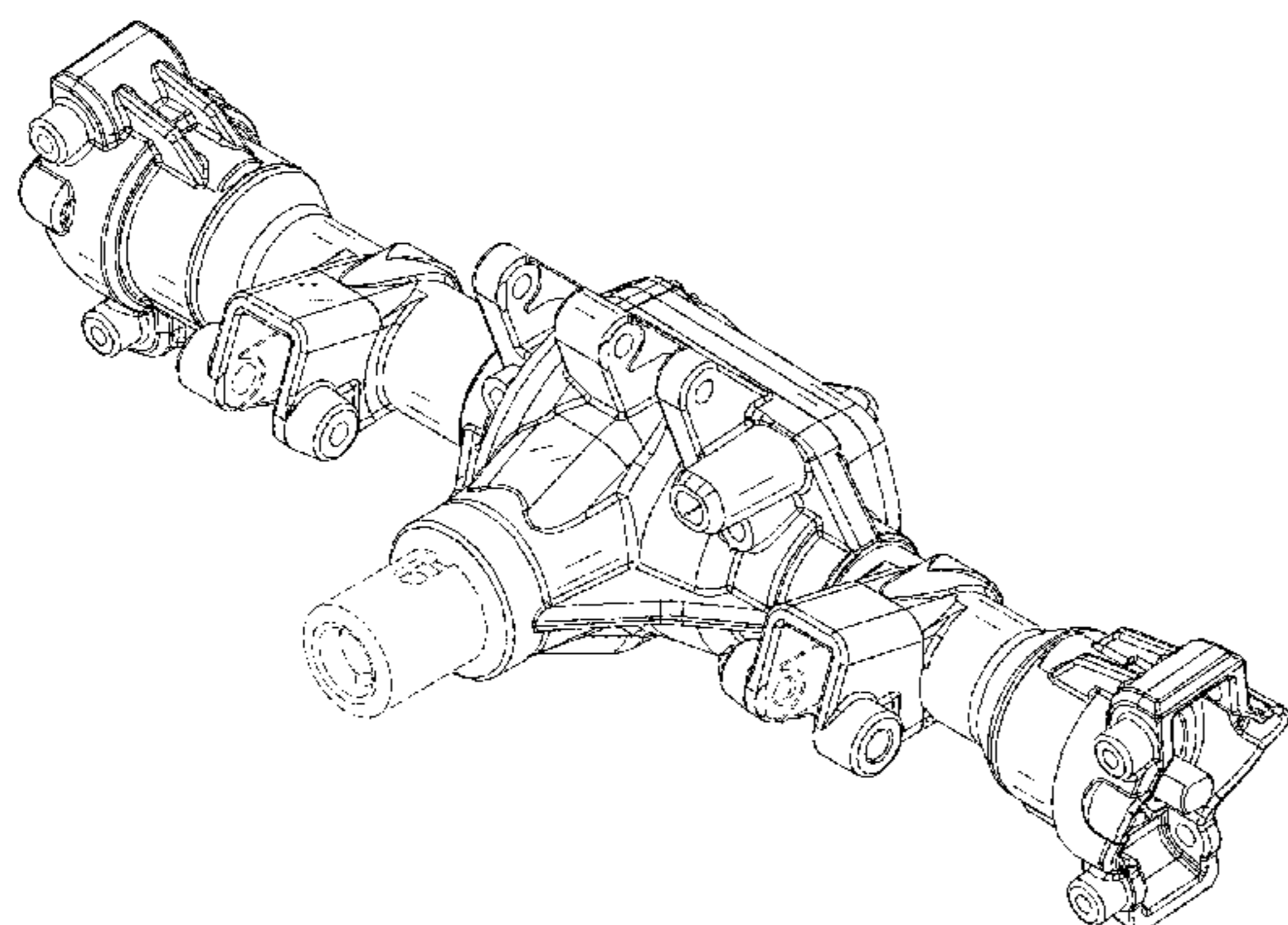

(56)

References Cited

U.S. PATENT DOCUMENTS

6,478,709 B1 * 11/2002 Irwin F16H 48/08
475/230

6,513,614 B2 2/2003 Knutson et al.

6,773,353 B2 8/2004 Cornay et al.

6,820,707 B1 11/2004 Cantemir

7,144,326 B2 12/2006 Thompson

7,810,604 B2 10/2010 Byers et al.

7,841,923 B2 11/2010 Marzetta et al.

D686,677 S * 7/2013 Simonds D12/160

8,574,022 B2 11/2013 Grisolia et al.

2002/0065021 A1 5/2002 Wang

2002/0160688 A1 10/2002 Rehkemper et al.

2002/0165031 A1 11/2002 Riefe

2004/0005931 A1 1/2004 Wang et al.

2004/0231910 A1 11/2004 Mercier et al.

2005/0206222 A1 * 9/2005 Swanson B60B 35/121
301/124.1

2006/0240897 A1 10/2006 Carlini et al.

2007/0293328 A1 12/2007 Mazziotti

2008/0238015 A1 * 10/2008 Duddling B60B 35/08
280/124.116

2009/0039700 A1 * 2/2009 Gradu B60B 35/121
301/111.02

2011/0001350 A1 * 1/2011 Schmitz B60G 9/003
301/124.1

2011/0057408 A1 * 3/2011 Koschinat B60B 35/08
280/124.11

2013/0278047 A1 * 10/2013 Gottschalk B60B 35/003
301/125

2017/0028517 A1 * 2/2017 Ferrari B23K 37/0538

2017/0370465 A1 * 12/2017 Fast F16H 57/0412

OTHER PUBLICATIONS

Bomber; Bomber Fabrication Gusset Kit; Aug. 2016.

Wikipedia; Dana 44 Axle; Aug. 2016.

Reid Racing; Reid Racing Axle Products; Aug. 2016.

Currie; Currie RockJock 79 Axle; Aug. 2016.

Xray Model Racing Cars; "T1R Raycer-Instruction Manual;" Xray Model Racing Cars, Trencin, Slovak Republic, Europe (admitted prior art).

Traxxas; "T-MAXX Assemblies-Front Assembly;" Traxxas LP, Plano, Texas (admitted prior art).

* cited by examiner

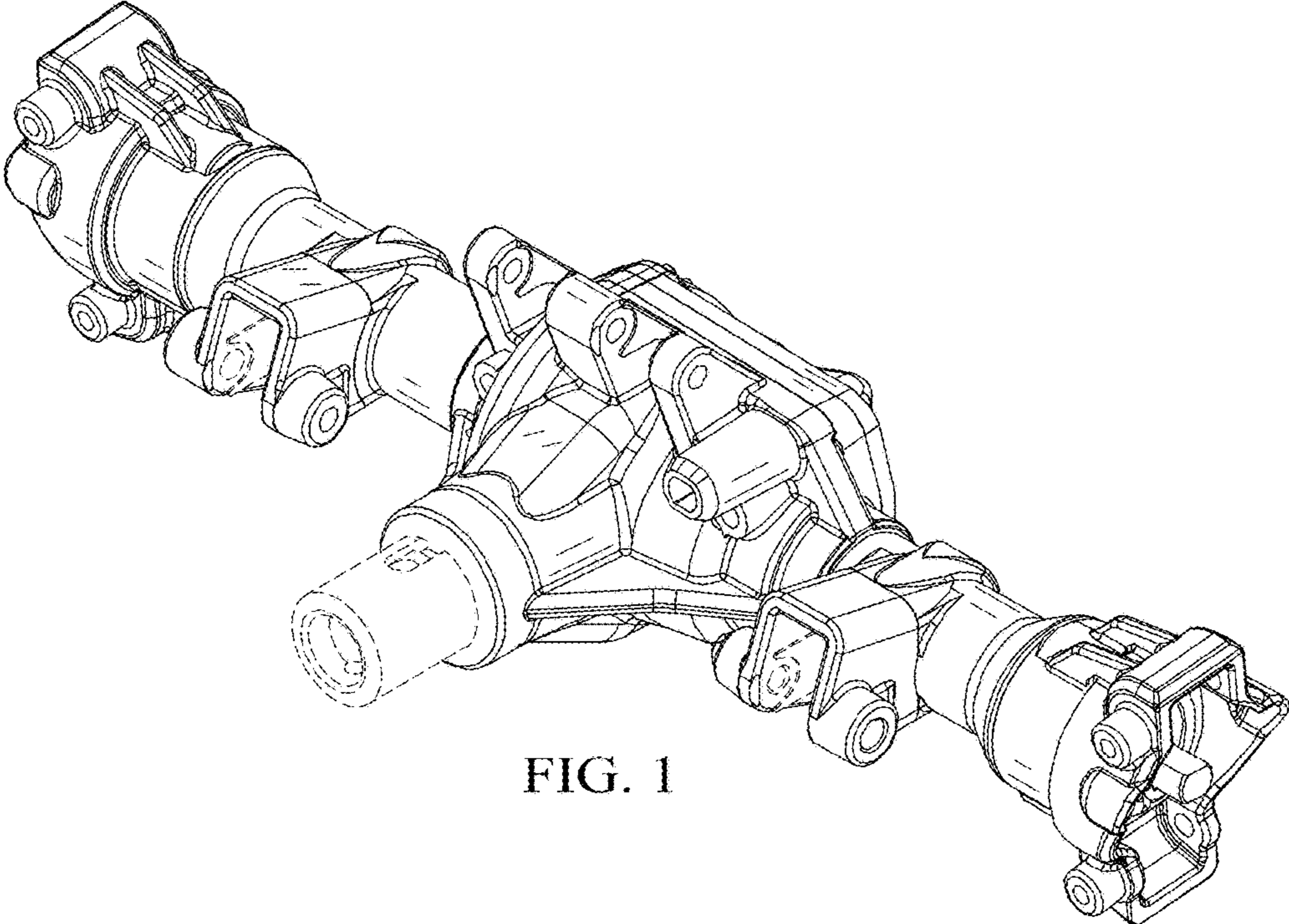

FIG. 1

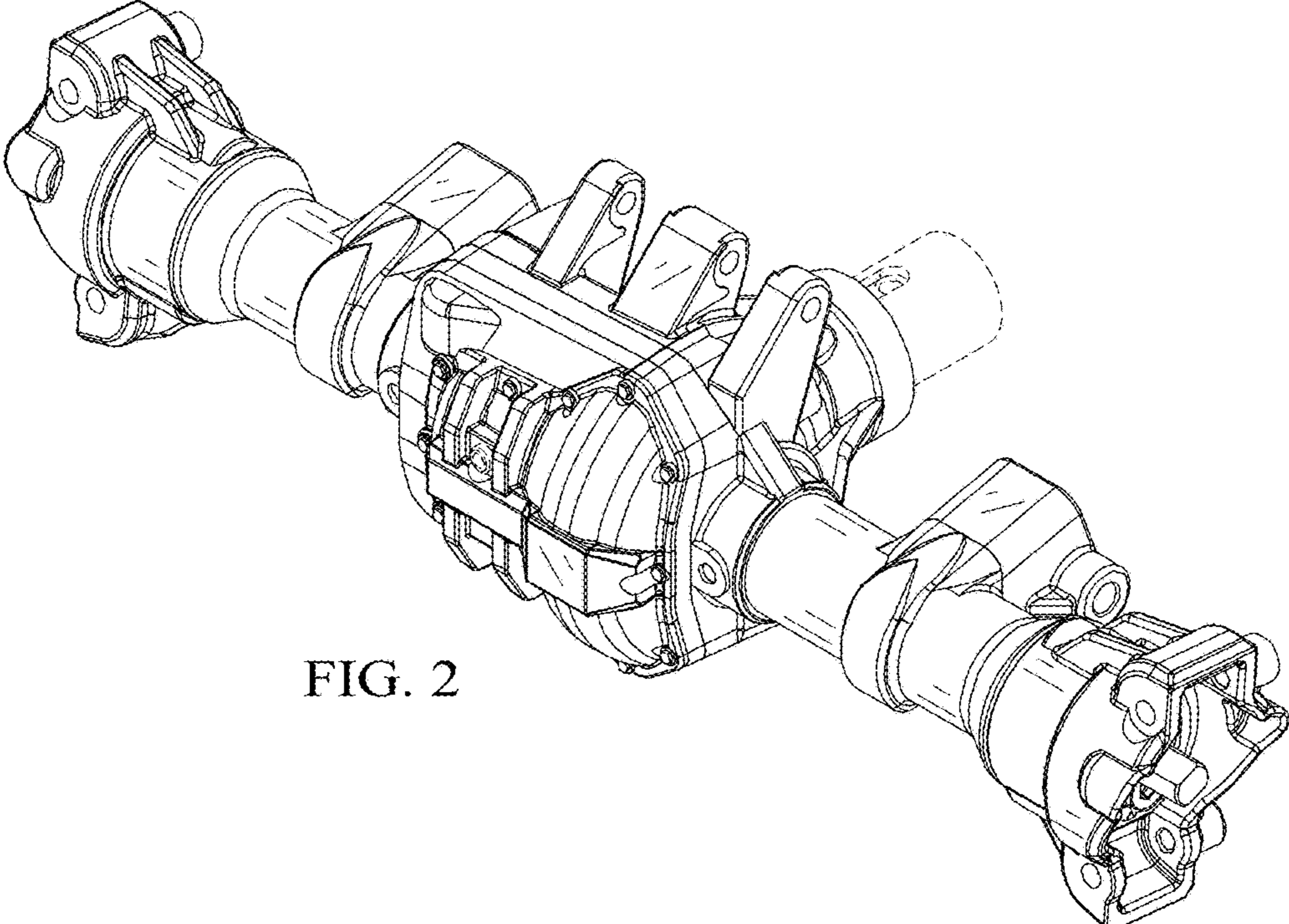

FIG. 2

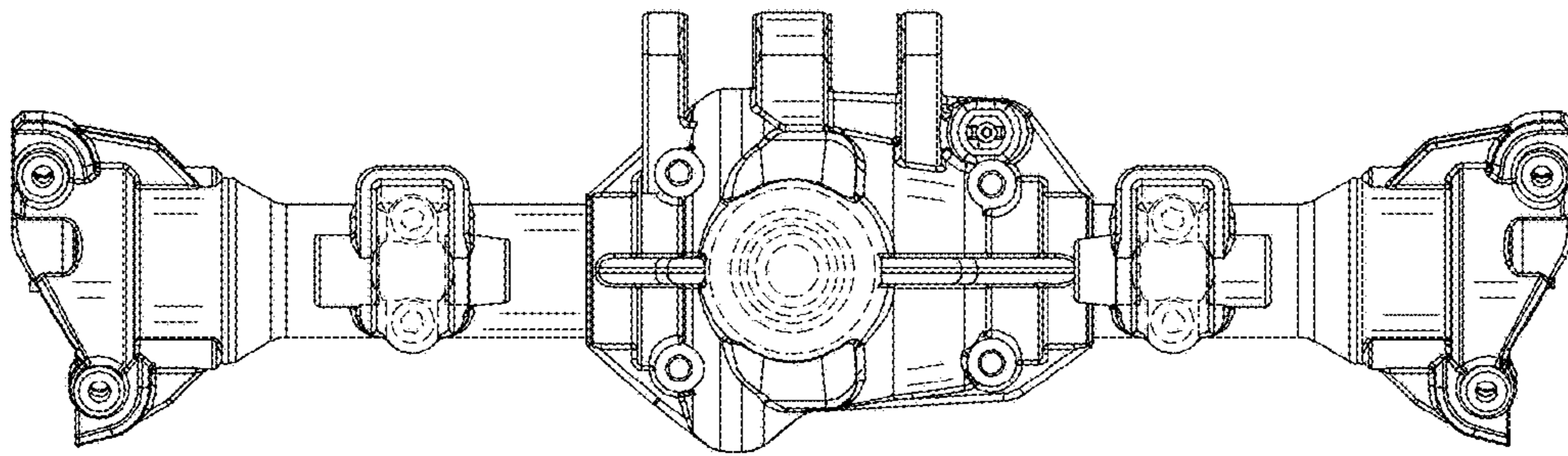

FIG. 3

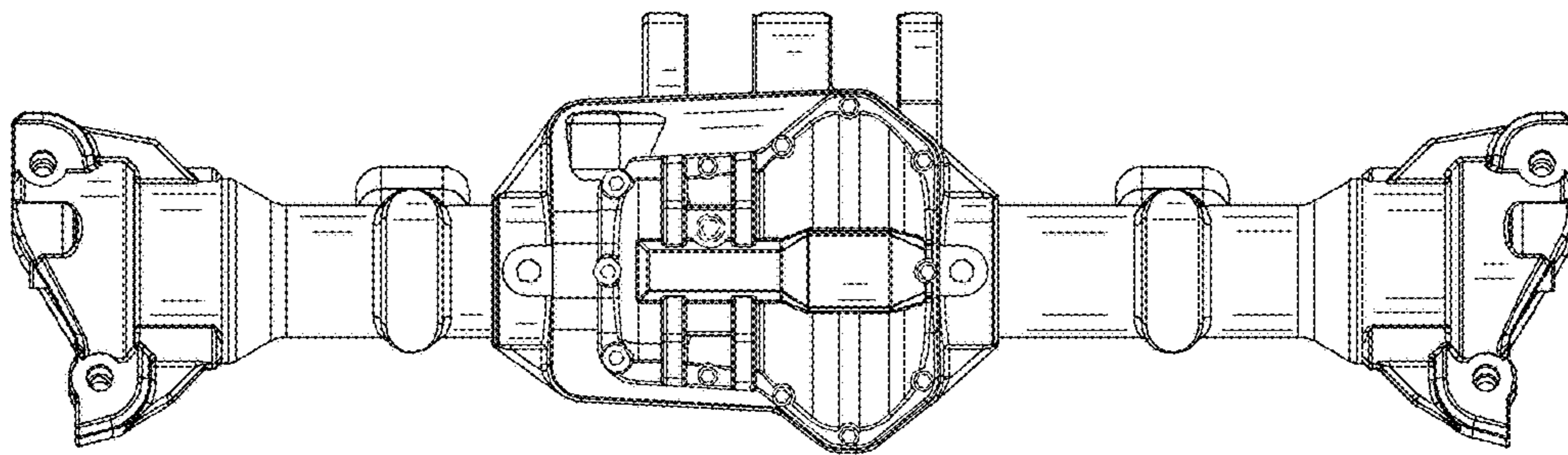

FIG. 4

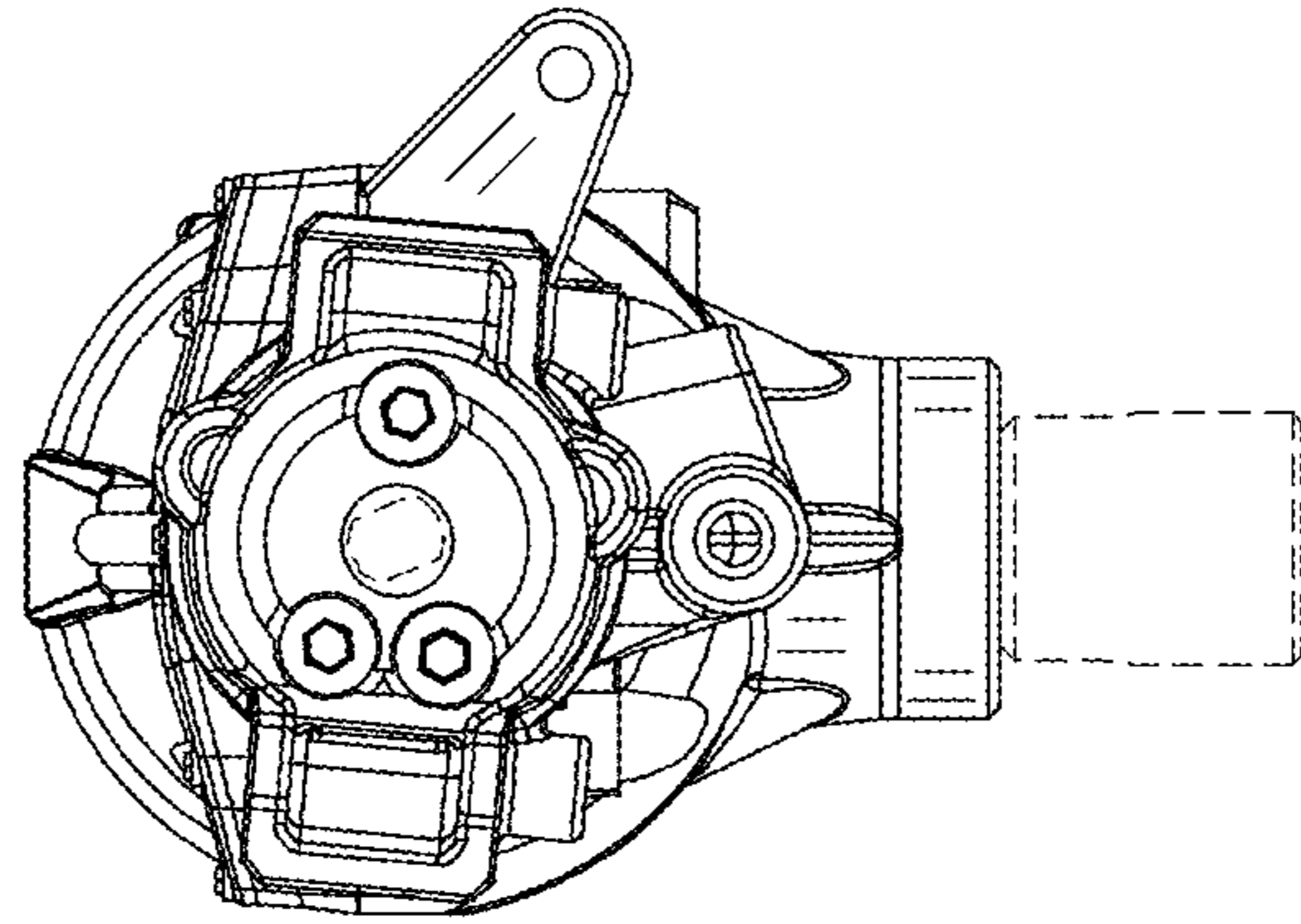

FIG. 5

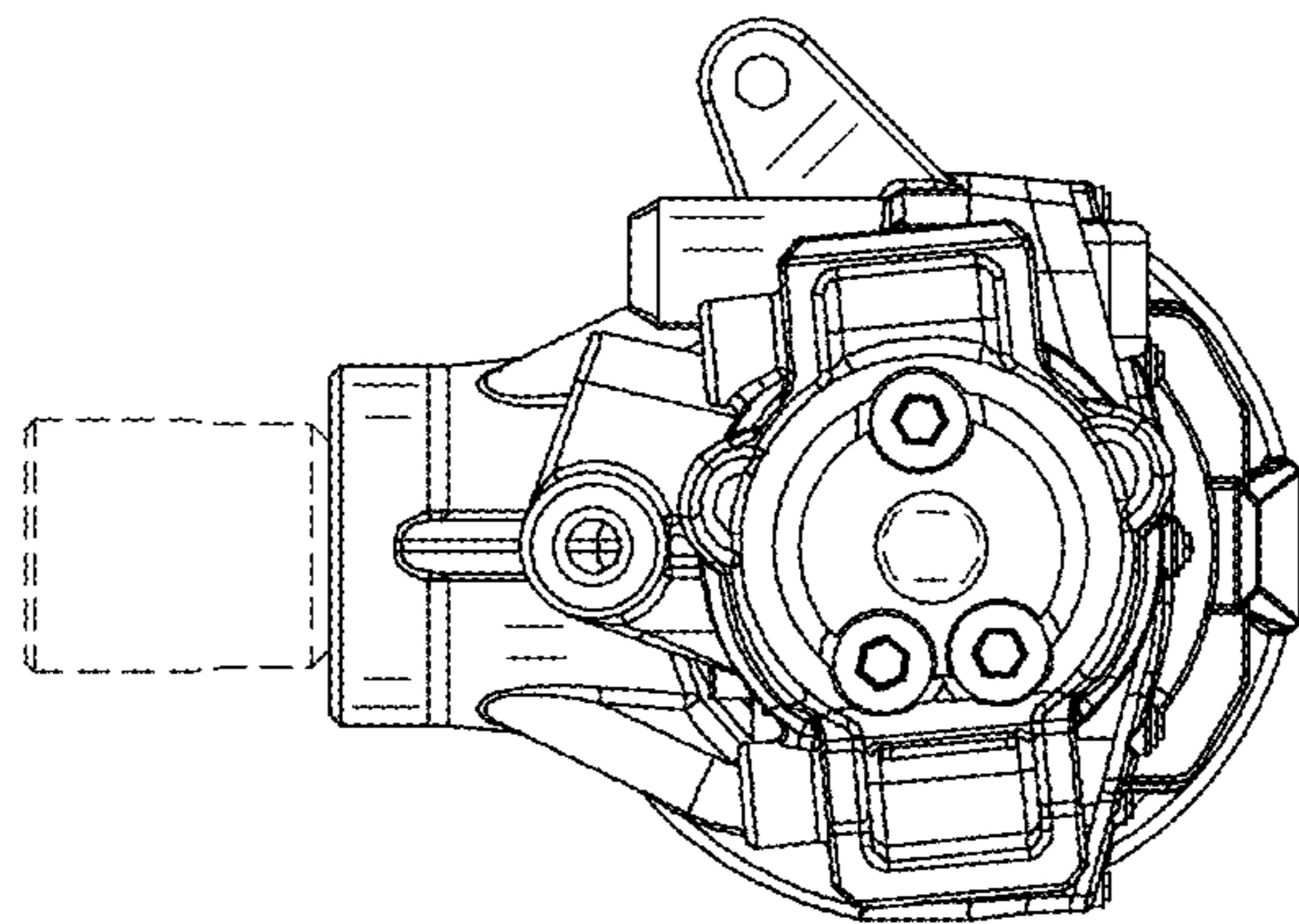

FIG. 6

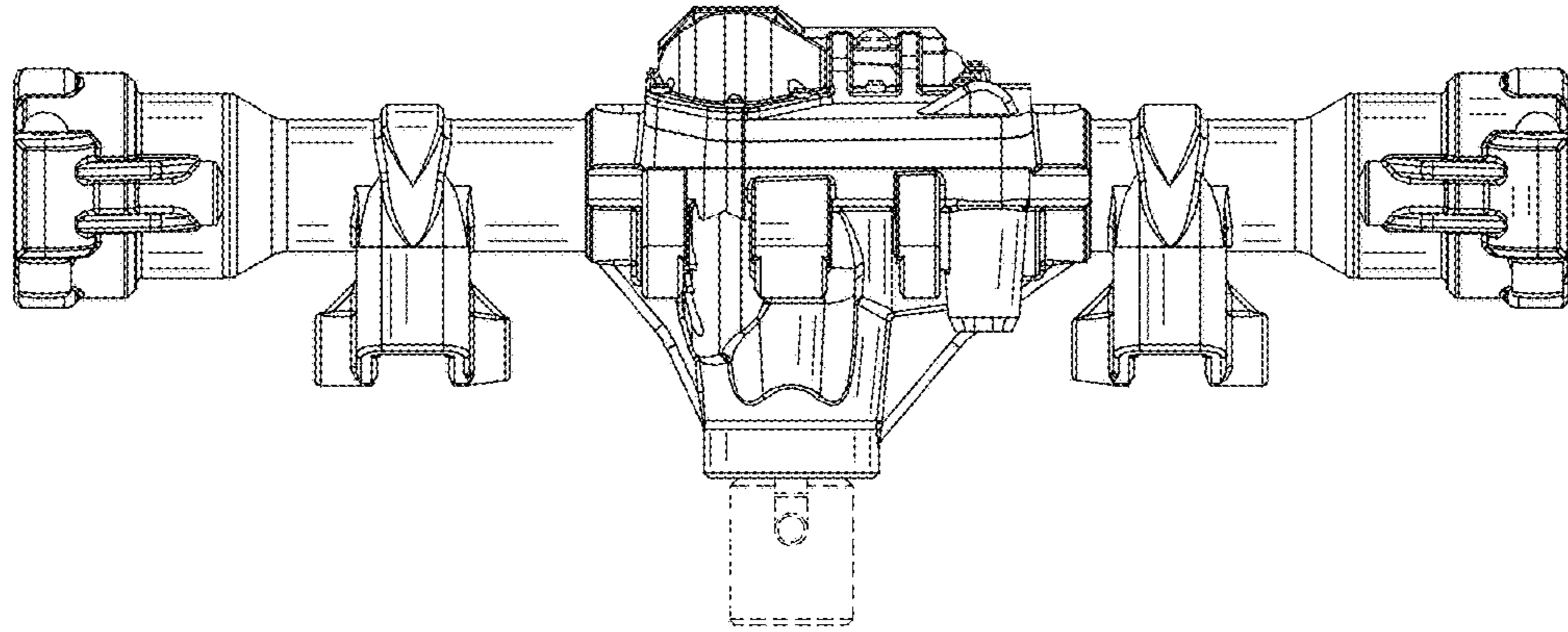

FIG. 7

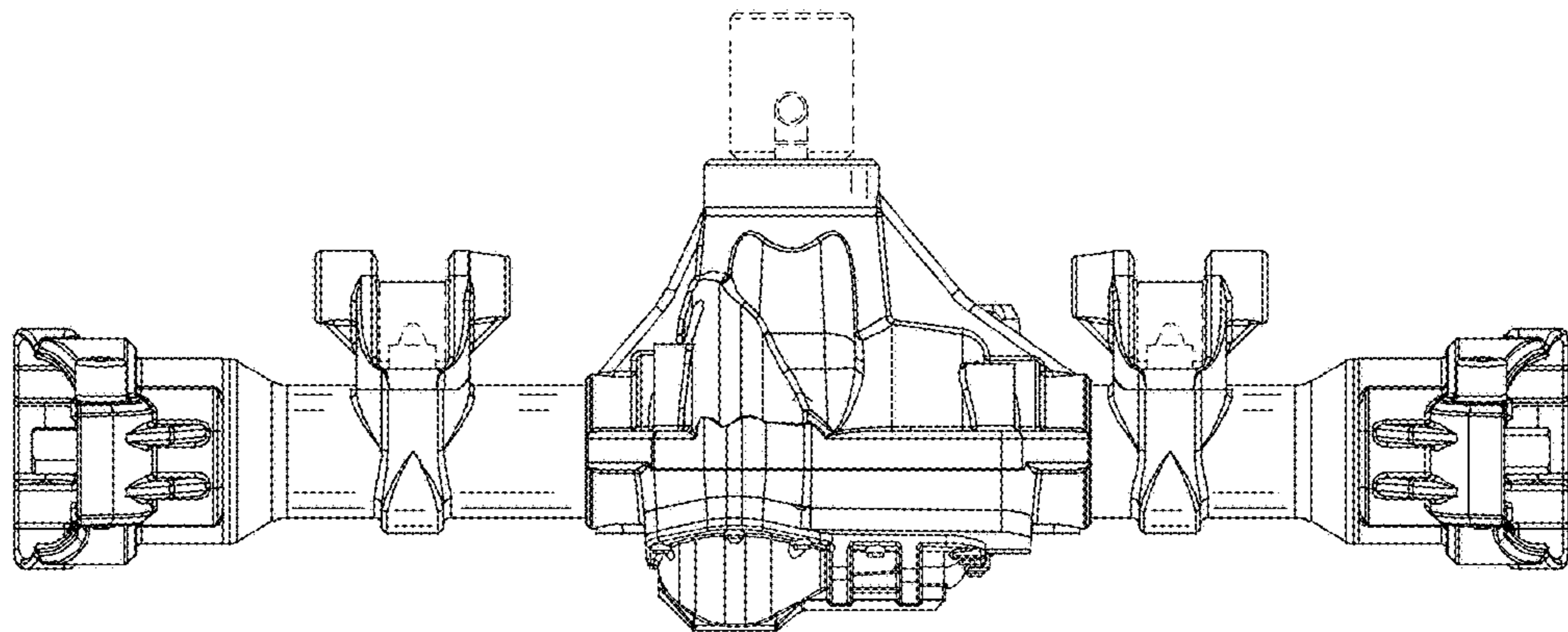

FIG. 8