



US00D845786S

(12) **United States Design Patent**
Campbell et al.

(10) **Patent No.:** **US D845,786 S**

(45) **Date of Patent:** **** Apr. 16, 2019**

(54) **DISPENSER**

(71) Applicant: **RPM Wood Finishes Group, Inc.**,
Hickory, NC (US)

(72) Inventors: **Colin Campbell**, Charlotte, NC (US);
Robert Soreo, Cleveland Heights, OH
(US)

(73) Assignee: **RPM WOOD FINISHES GROUP,**
INC., Hickory, NC (US)

(**) Term: **15 Years**

(21) Appl. No.: **29/584,147**

(22) Filed: **Nov. 11, 2016**

(51) **LOC (11) Cl.** **09-01**

(52) **U.S. Cl.**
USPC **D9/727**

(58) **Field of Classification Search**
USPC D9/442, 695-699, 702-714, 723-729,
D9/504; D24/199; D28/7; 132/317,
132/318, 320; 222/95, 207, 212, 335
CPC A45D 34/00; A45D 40/00; B65D 81/3272
See application file for complete search history.

(56) **References Cited**

U.S. PATENT DOCUMENTS

D292,884 S * 11/1987 Pataki D9/526
4,708,507 A * 11/1987 von Schuckmann ... A47L 23/05
401/171

D385,779 S * 11/1997 Sokol D9/529
D455,233 S * 4/2002 Look D19/66
D515,938 S * 2/2006 Shurtleff D9/529
D527,652 S * 9/2006 Davis D28/20
D530,623 S * 10/2006 Shurtleff D9/728
D541,670 S * 5/2007 McConville D9/529
D551,570 S * 9/2007 Shurtleff D9/727
2008/0060665 A1 * 3/2008 Umeno A45D 19/02
132/112

* cited by examiner

Primary Examiner — Derrick E Holland

Assistant Examiner — Janice Patyk

(74) *Attorney, Agent, or Firm* — Rankin, Hill & Clark
LLP

(57) **CLAIM**

The ornamental design for a dispenser, as shown and described.

DESCRIPTION

FIG. 1 is a perspective view of a dispenser, showing our new design;
FIG. 2 is a front elevation view thereof;
FIG. 3 is a rear elevation view thereof;
FIG. 4 is a right side elevation view thereof;
FIG. 5 is a left side elevation view thereof;
FIG. 6 is a top plan view thereof; and,
FIG. 7 is a bottom plan view thereof.
The broken lines in the figures illustrate the portions of the design that form no part of the claimed design.

1 Claim, 6 Drawing Sheets

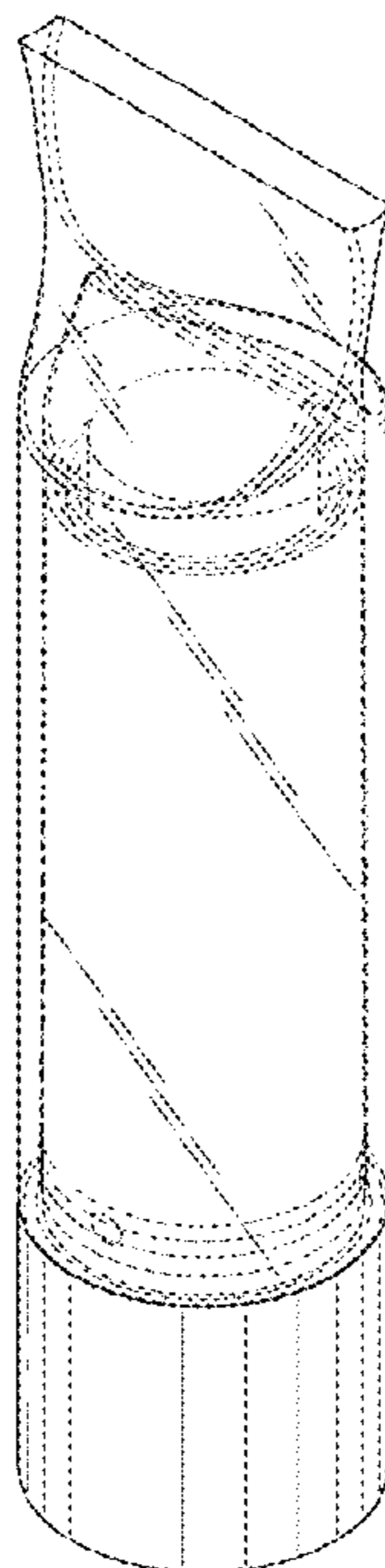

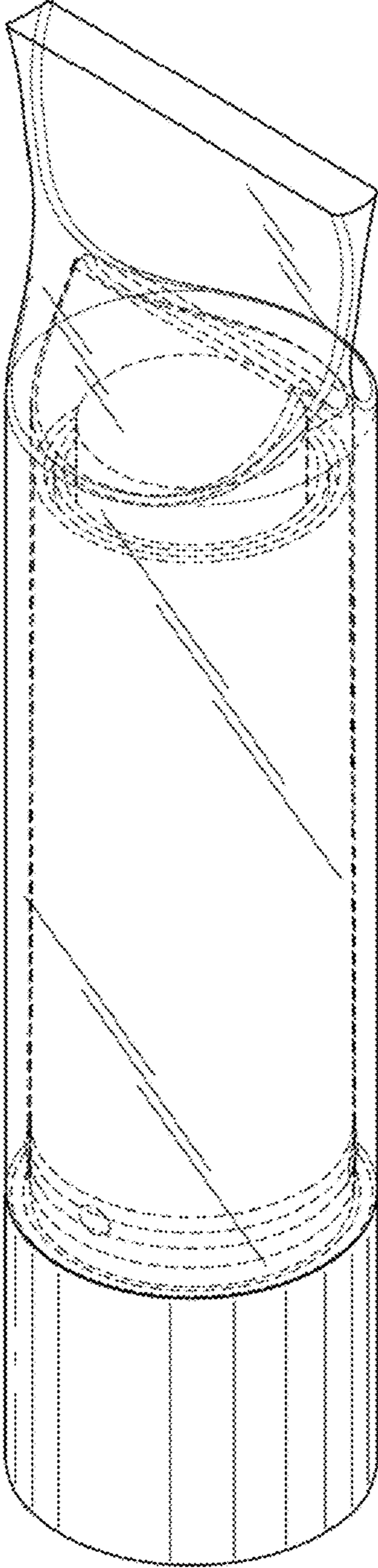

FIG. 1

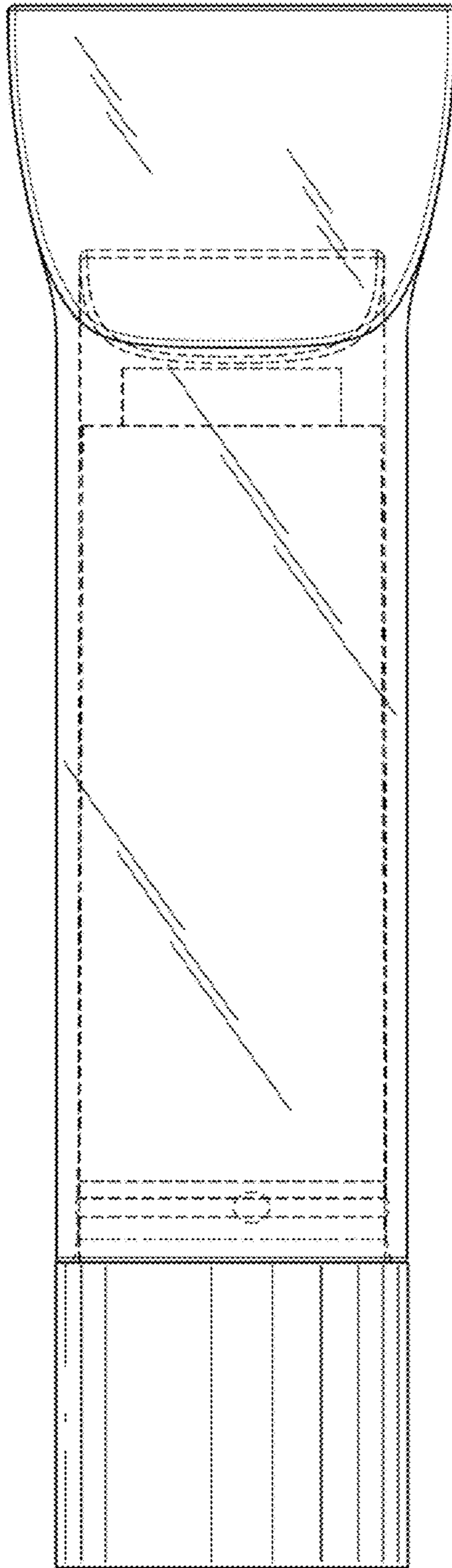

FIG. 2

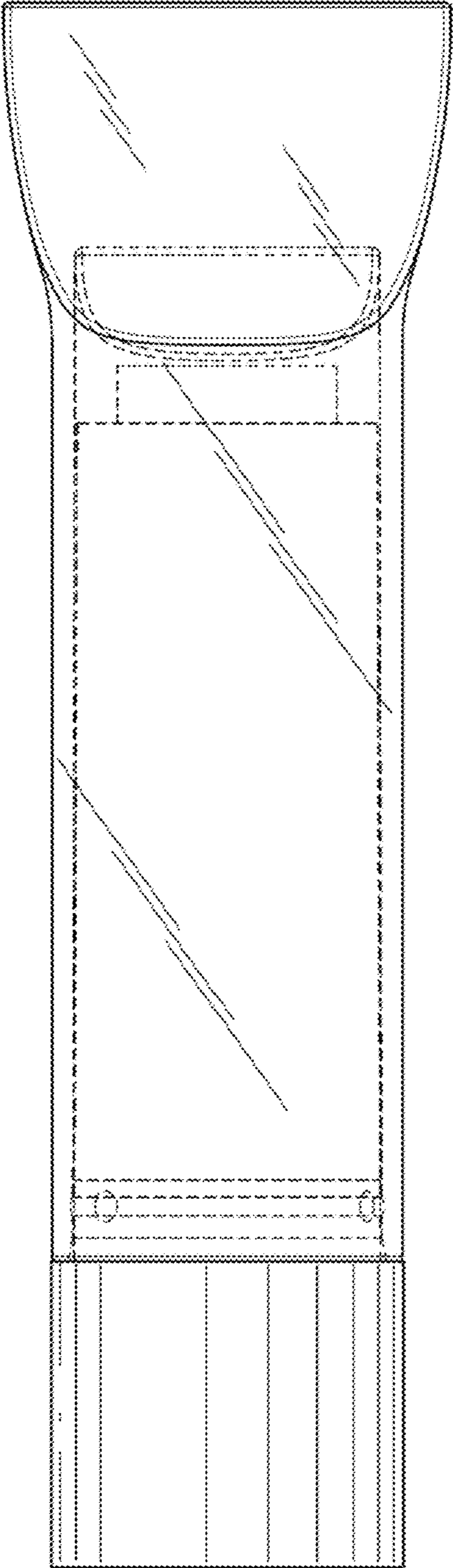

FIG. 3

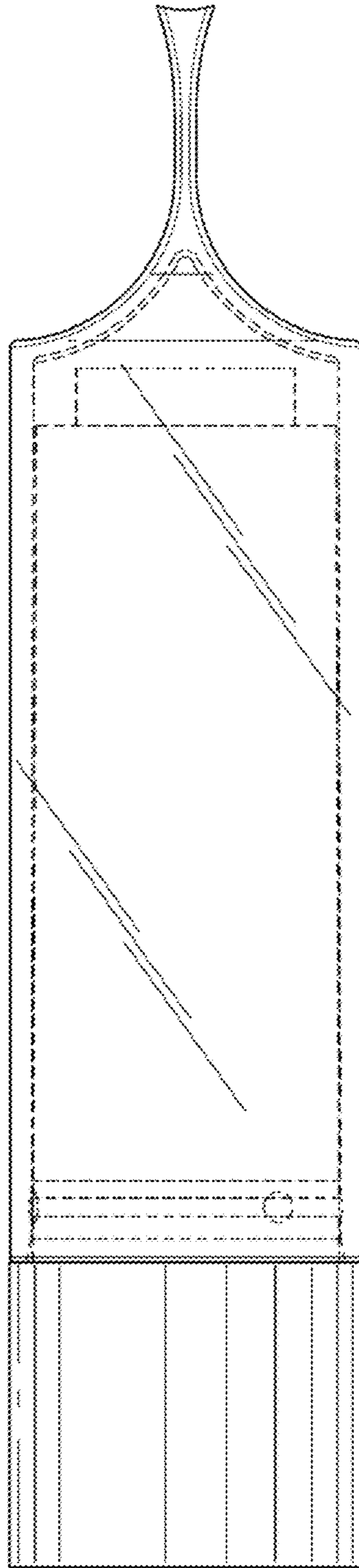

FIG.4

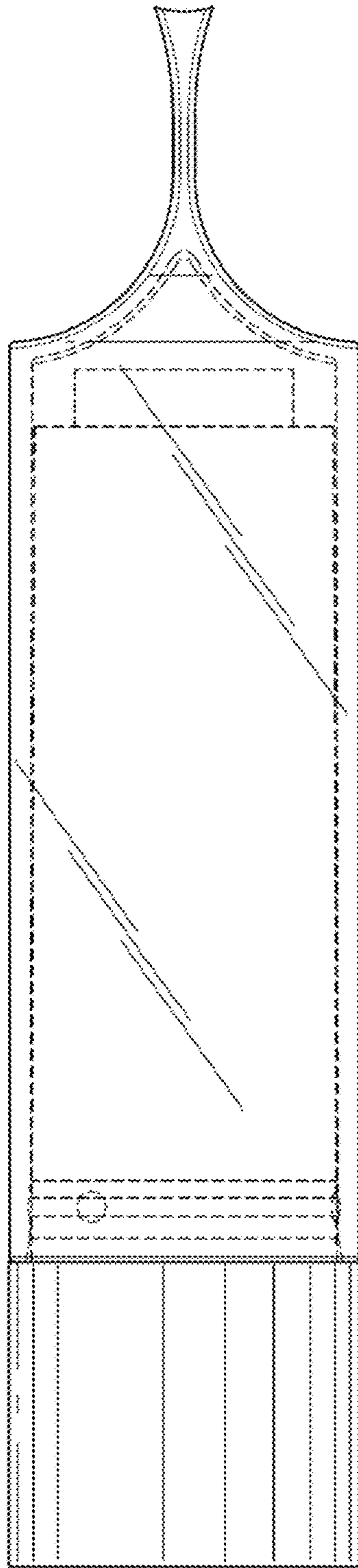

FIG. 5

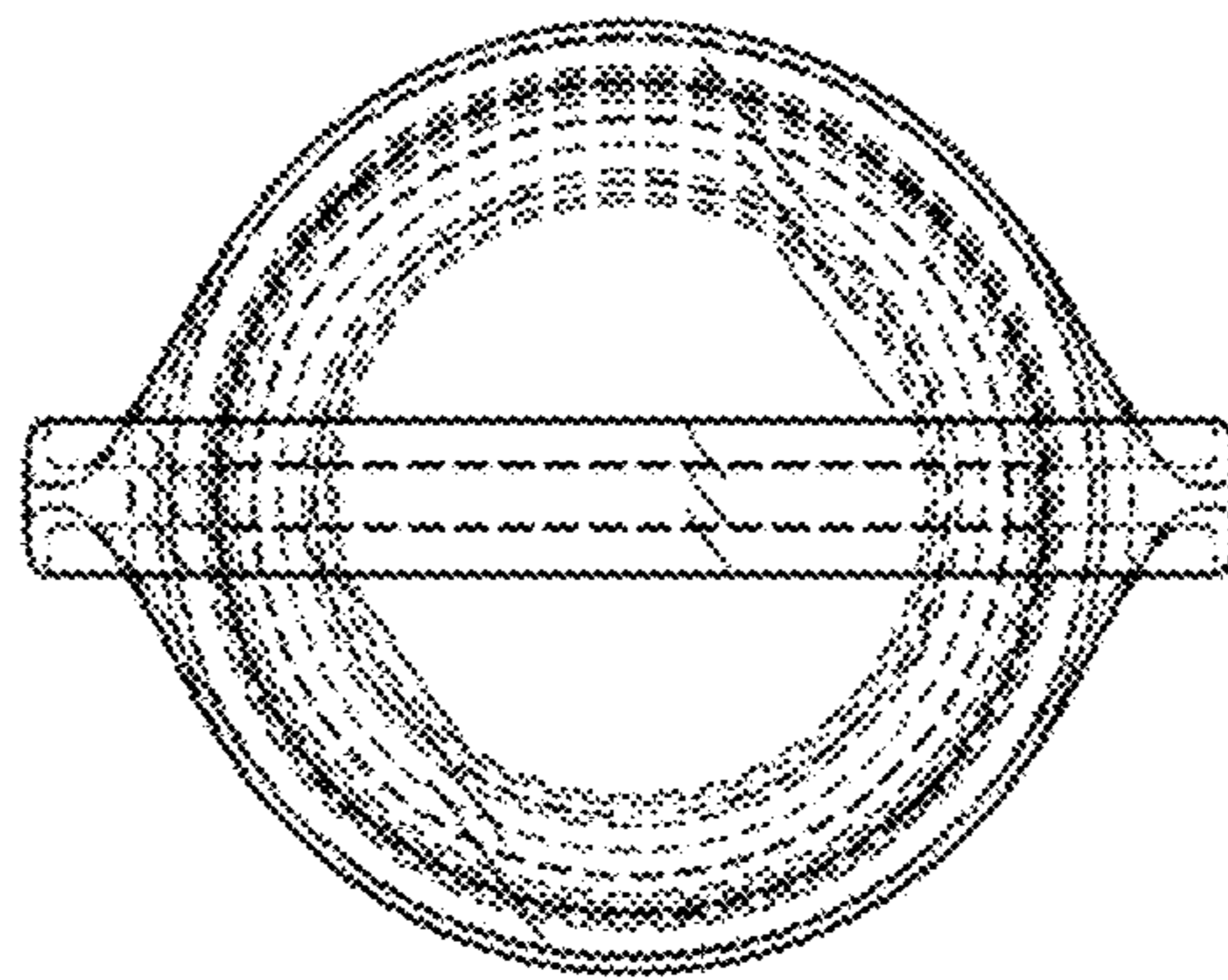

FIG. 6

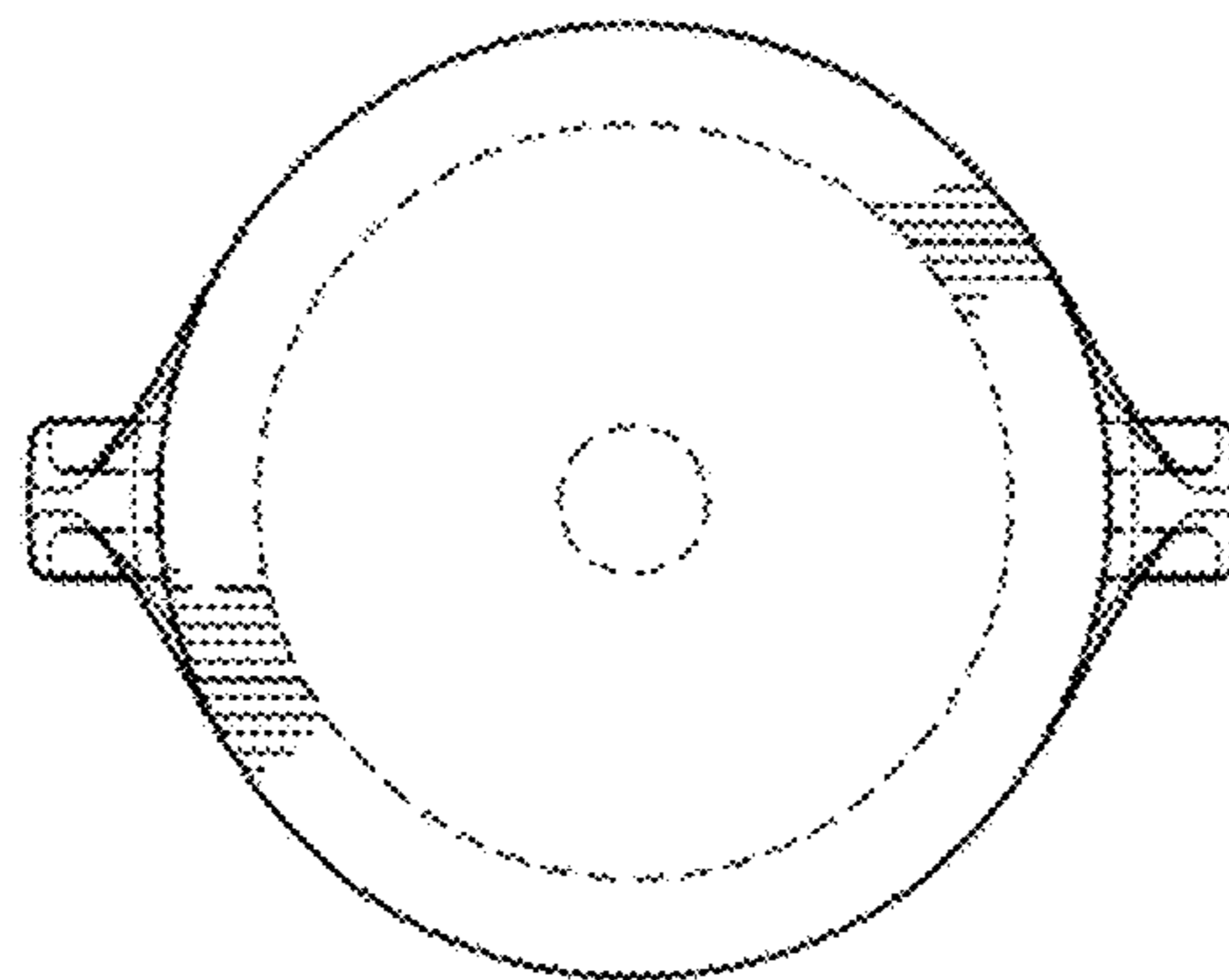

FIG. 7