



US00D845238S

(12) **United States Design Patent**
Kato et al.

(10) **Patent No.:** **US D845,238 S**

(45) **Date of Patent:** **** Apr. 9, 2019**

(54) **CONTROLLER FOR SERVOMOTORS**

(71) Applicant: **Mitsubishi Electric Corporation,**
Tokyo (JP)

(72) Inventors: **Shinichi Kato,** Tokyo (JP); **Tsutomu Tanaka,** Tokyo (JP); **Masaaki Kadoyanagi,** Tokyo (JP); **Shotaro Hirako,** Tokyo (JP)

(73) Assignee: **Mitsubishi Electric Corporation,**
Tokyo (JP)

(**) Term: **15 Years**

(21) Appl. No.: **29/599,943**

(22) Filed: **Apr. 7, 2017**

(30) **Foreign Application Priority Data**

Nov. 15, 2016 (JP) 2016-024807
Nov. 15, 2016 (JP) 2016-024808
Nov. 15, 2016 (JP) 2016-024809

(51) **LOC (11) Cl.** **13-03**

(52) **U.S. Cl.**
USPC **D13/123**

(58) **Field of Classification Search**
USPC D13/110, 123, 158, 160, 162, 162.1;
D14/188; 318/486, 560, 567, 625, 677,
318/680, 681; 361/725
CPC .. G05D 3/1409; G05D 3/1418; G05D 3/1427;
H02H 3/253
See application file for complete search history.

(56) **References Cited**

U.S. PATENT DOCUMENTS

D366,243 S * 1/1996 Kurokawa D13/162
D366,244 S * 1/1996 Kurokawa D13/162
D366,245 S * 1/1996 Kurokawa D13/162
D366,867 S * 2/1996 Kurokawa D13/162
D456,782 S * 5/2002 Nagai D13/162
D478,061 S * 8/2003 Abe D14/188

D479,219 S * 9/2003 Abe D14/188
D608,300 S * 1/2010 Boyland D13/162
D609,195 S * 2/2010 Yamashita D13/162
D621,350 S * 8/2010 Huang D13/110
D621,351 S * 8/2010 Huang D13/110
D623,592 S * 9/2010 Huang D13/110
D631,436 S * 1/2011 Huang D13/110

(Continued)

FOREIGN PATENT DOCUMENTS

JP 1477024 S 8/2013

OTHER PUBLICATIONS

An Office Action; "Notification of Reasons for Refusal" issued by the Japanese Patent Office on Apr. 4, 2017, which corresponds to Japanese Patent Application No. 2016-024809 and is related to U.S. Appl. No. 29/599,943; with English language translation.

Primary Examiner — Selina Sikder

(74) *Attorney, Agent, or Firm* — Studebaker & Brackett PC

(57) **CLAIM**

The ornamental design for the controller for servomotors, as shown and described.

DESCRIPTION

FIG. 1 is a front, top, and right side perspective view of the controller for servomotors showing our new design;
FIG. 2 is a rear, bottom and left side perspective view thereof;
FIG. 3 is a front view thereof;
FIG. 4 is a rear view thereof;
FIG. 5 is a top side view thereof;
FIG. 6 is a bottom side view thereof;
FIG. 7 is a left side view thereof; and,
FIG. 8 is a right side view thereof.
The parts shown in the broken lines is for the purpose of illustrating portions of the article and do not form part of the claimed designs.

1 Claim, 8 Drawing Sheets

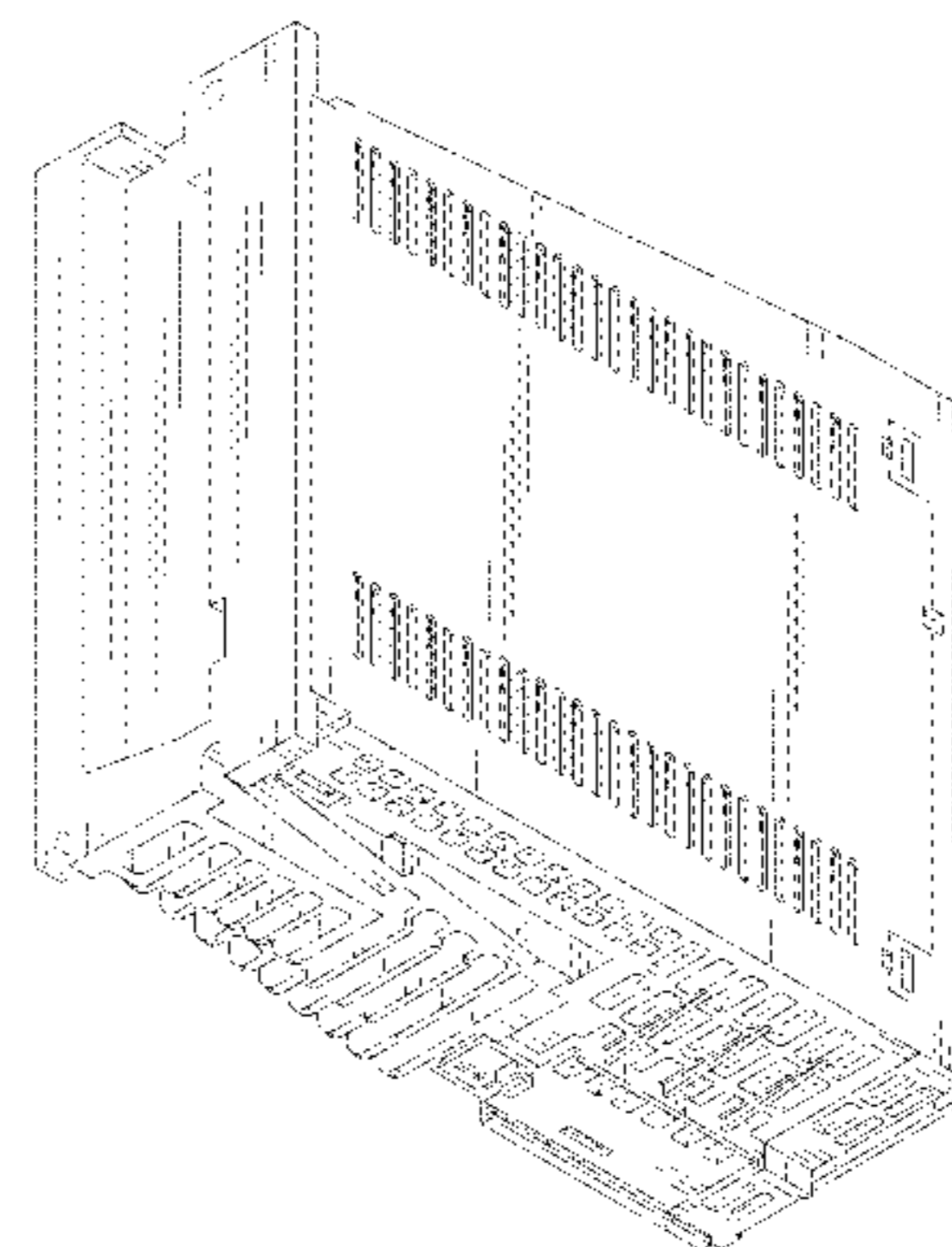
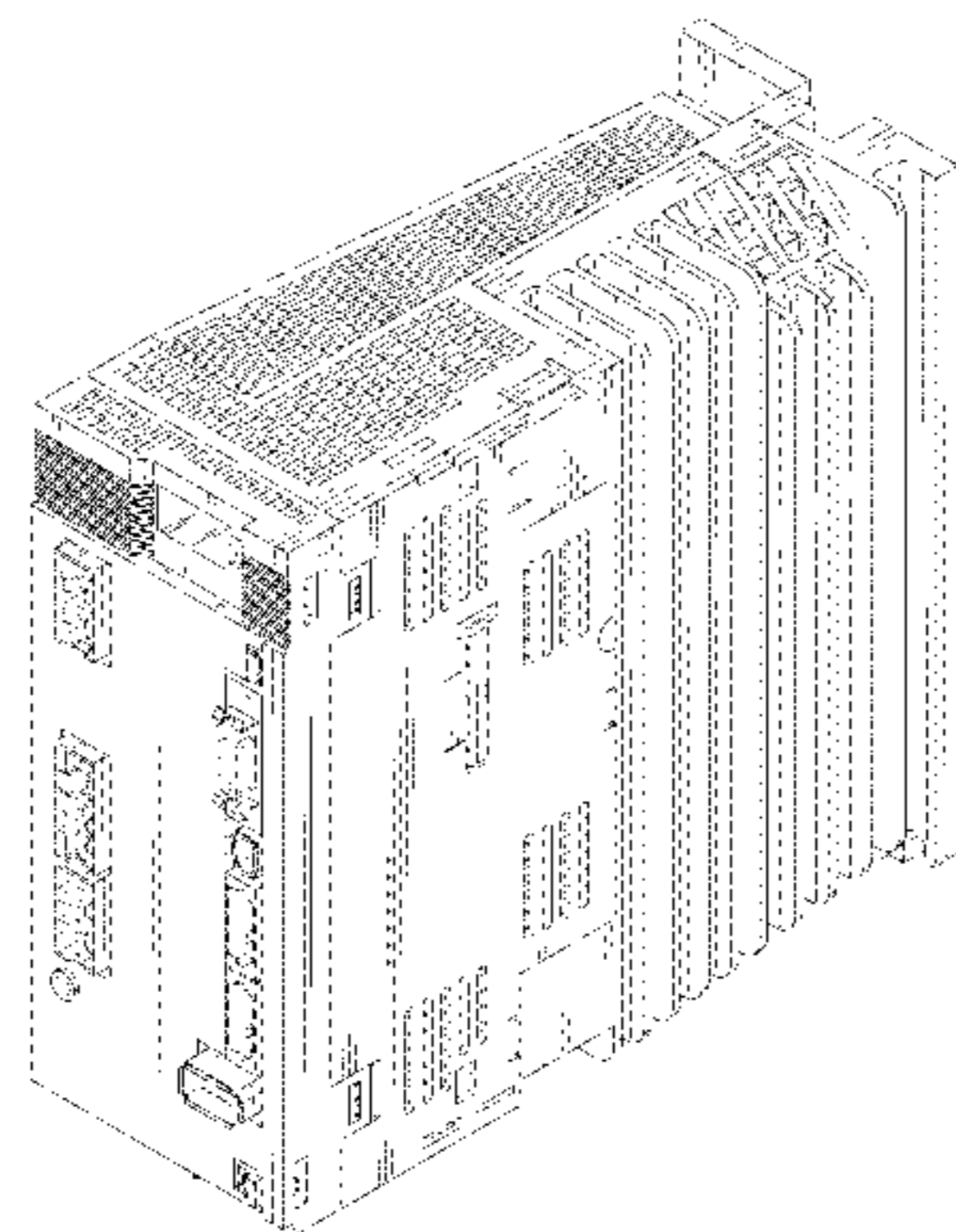

(56)

References Cited

U.S. PATENT DOCUMENTS

| | | | | |
|------------|---|---------|----------------|---------|
| D724,051 S | * | 3/2015 | Nakahira | D13/110 |
| D724,052 S | * | 3/2015 | Nakahira | D14/188 |
| D737,242 S | * | 8/2015 | Nakahira | D13/110 |
| D758,969 S | * | 6/2016 | Kato | D13/123 |
| D812,019 S | * | 3/2018 | Kato | D13/162 |
| D829,181 S | * | 9/2018 | Kato | D13/162 |
| D829,672 S | * | 10/2018 | Kato | D13/162 |

* cited by examiner

Fig. 1

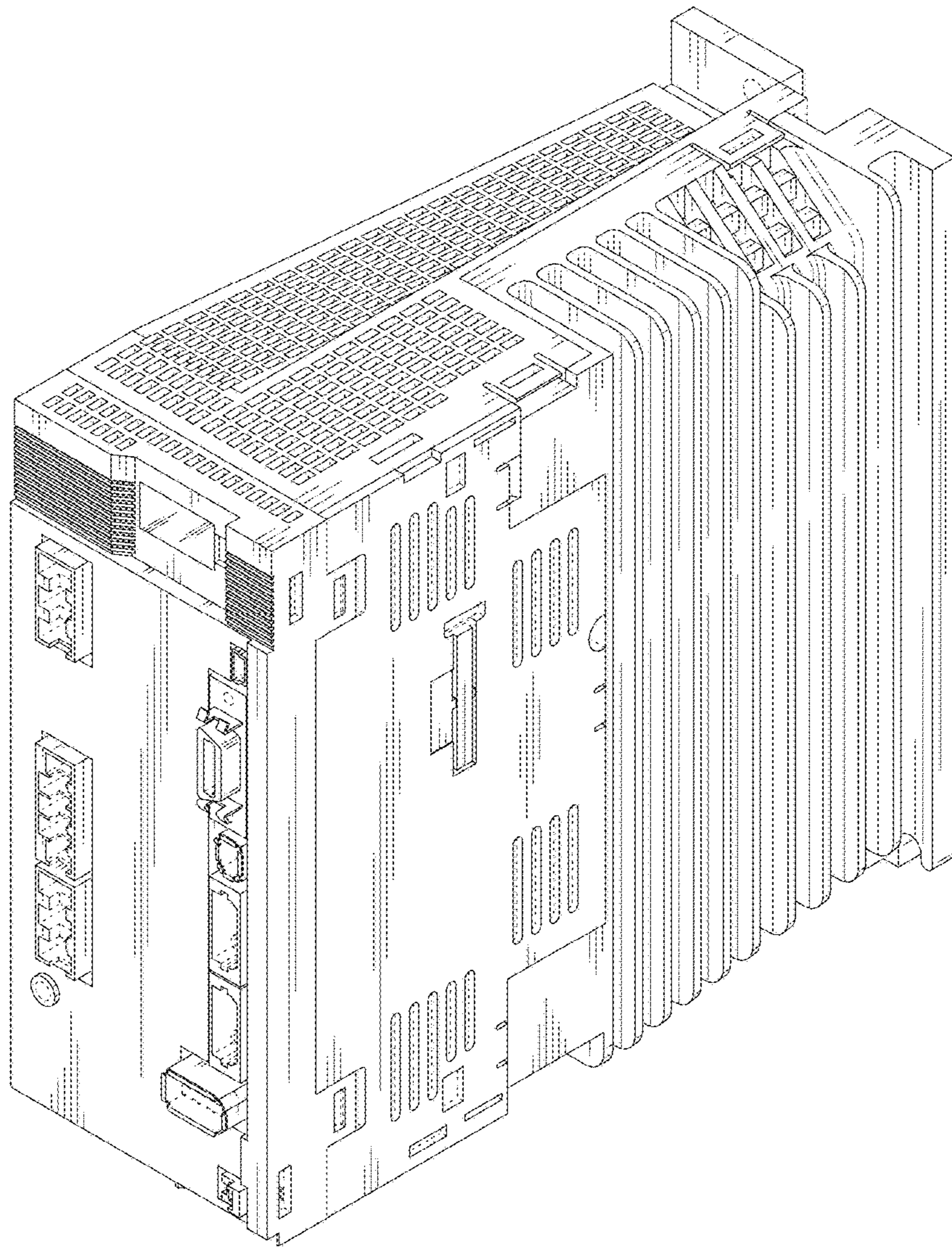

Fig. 2

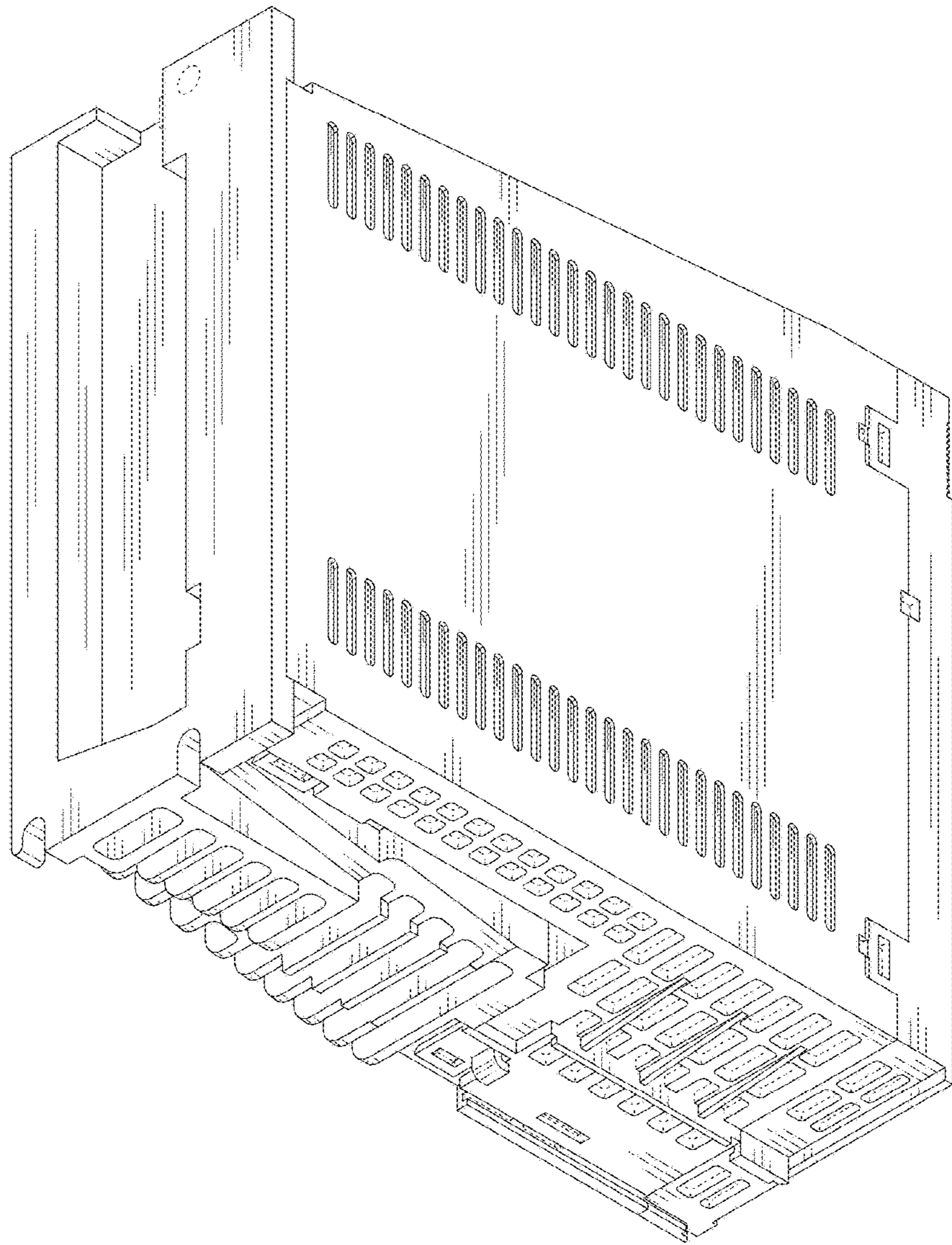

Fig. 3

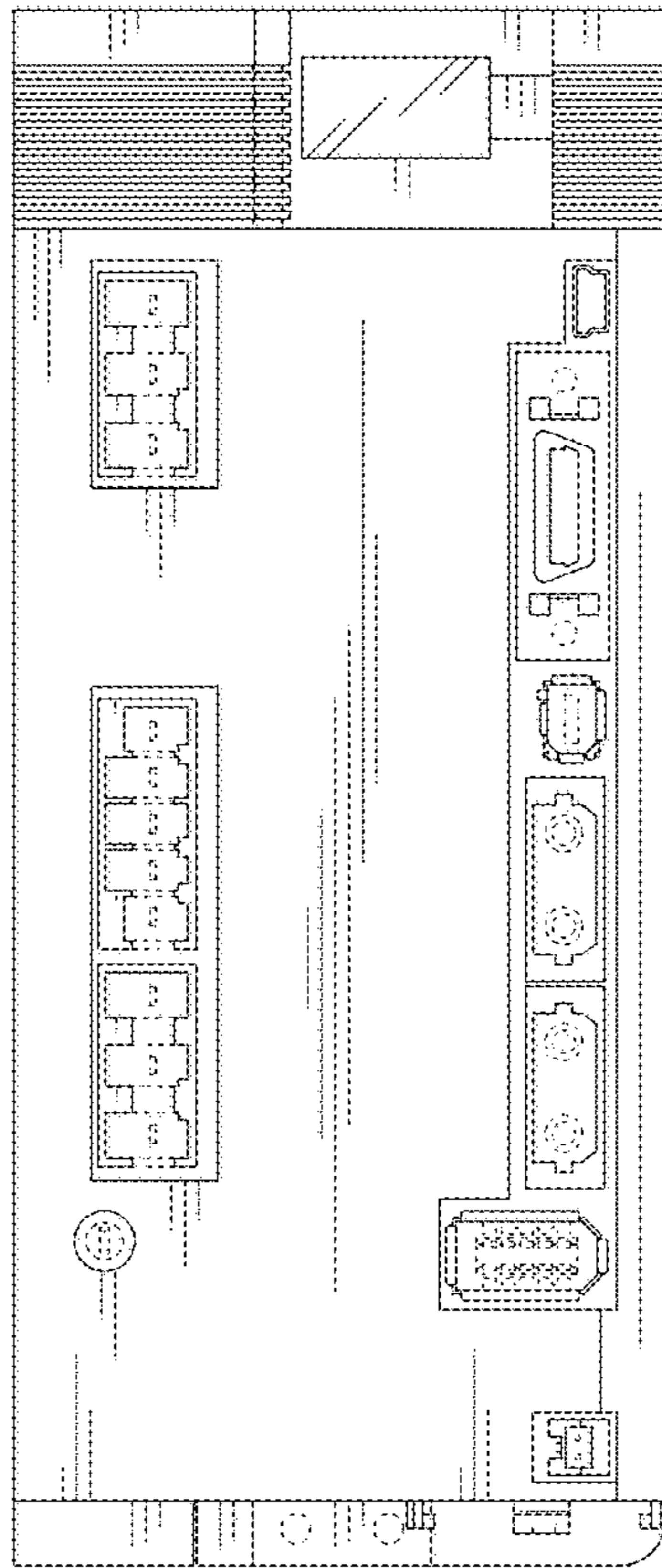

Fig. 4

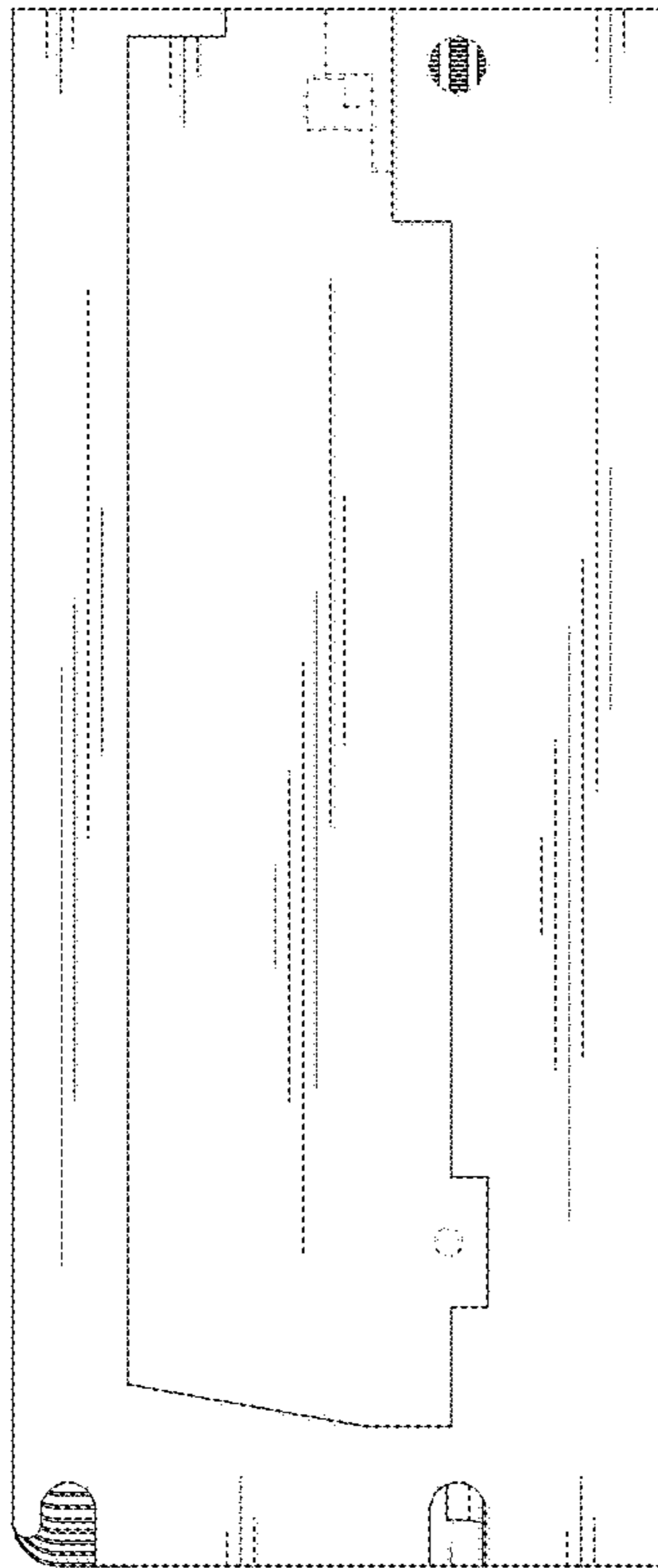

Fig. 5

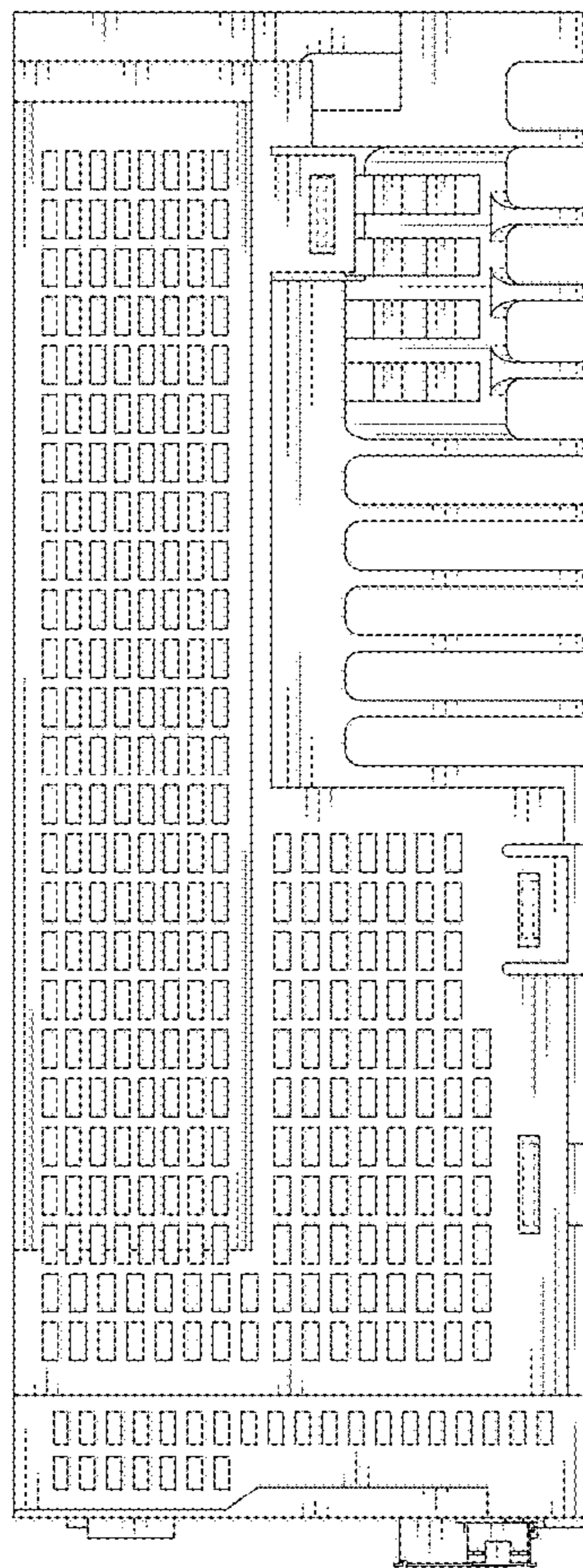

Fig. 6

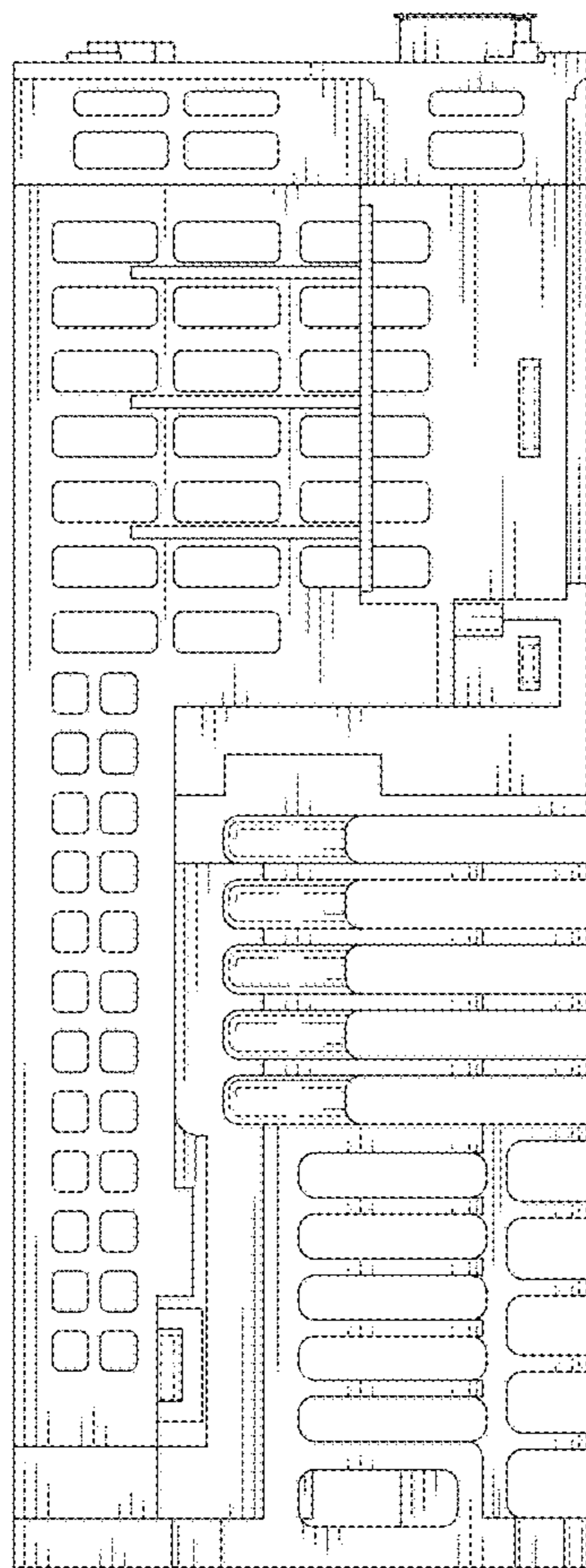

Fig. 7

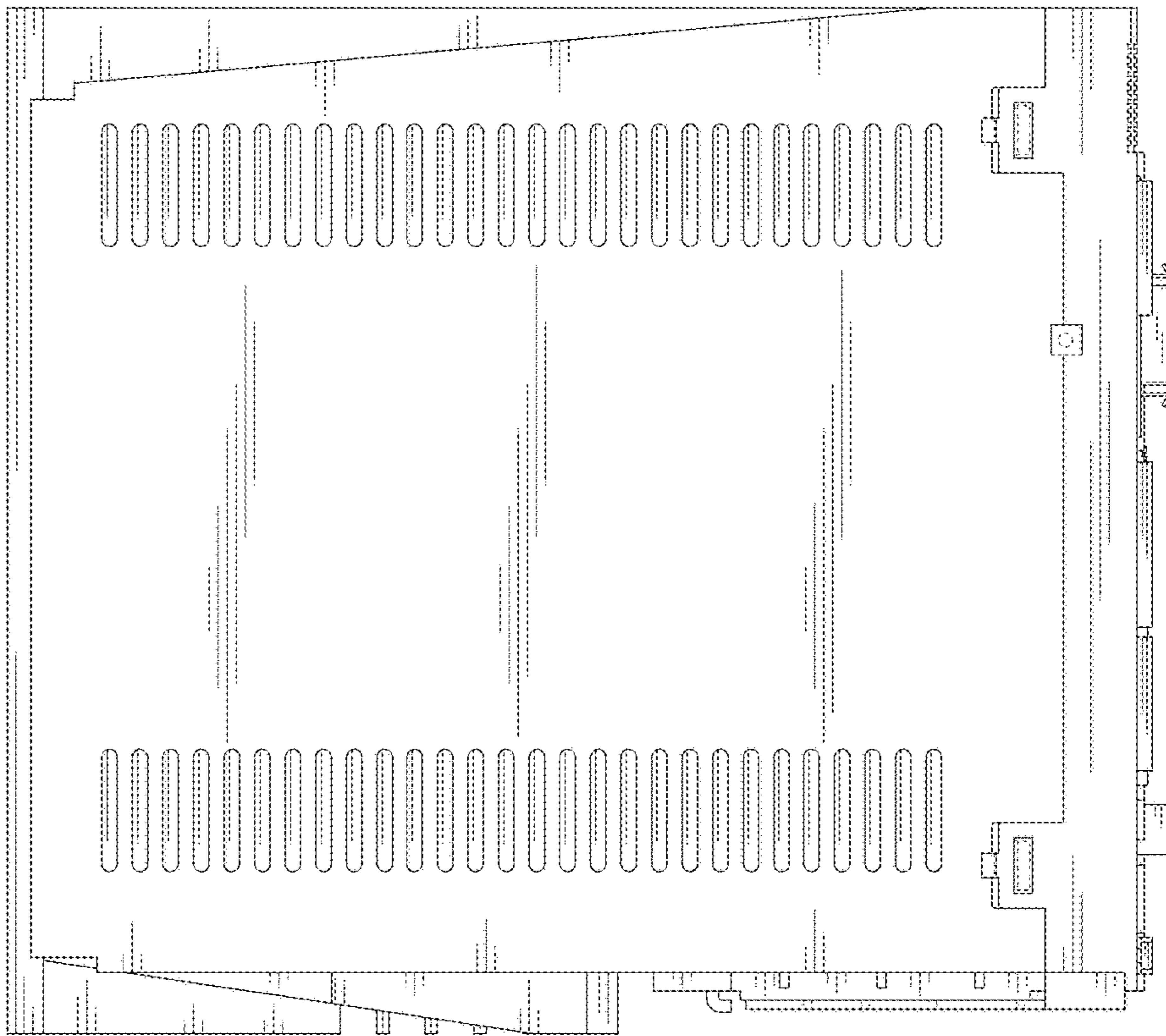

Fig. 8

