



US00D844673S

(12) **United States Design Patent**
Stolarski

(10) **Patent No.:** **US D844,673 S**

(45) **Date of Patent:** **** Apr. 2, 2019**

- (54) **SNOWPLOW**
- (71) Applicant: **SAMASZ SP. Z.O.O.**, Zabłudow (PL)
- (72) Inventor: **Antoni Stolarski**, Bialystok (PL)
- (73) Assignee: **SAMASZ SP. Z O.O.**, Bialystok (PL)
- (**) Term: **15 Years**
- (21) Appl. No.: **29/628,980**
- (22) Filed: **Dec. 9, 2017**
- (51) **LOC (11) Cl.** **15-03**
- (52) **U.S. Cl.**
USPC **D15/11**
- (58) **Field of Classification Search**
USPC D15/10, 11, 22-28, 32; 37/196, 266
CPC E01H 5/06-5/062; E02F 3/76-3/848
See application file for complete search history.

- 6,526,677 B1 * 3/2003 Bloxdorf E01H 5/06
37/231
- 6,594,923 B1 7/2003 Kost et al.
- 6,615,513 B2 9/2003 Quenzi et al.
- 6,711,837 B2 3/2004 Bloxdorf et al.
- 6,860,039 B2 3/2005 Schultz et al.
- 6,874,582 B2 4/2005 Hollinrake et al.
- 6,928,757 B2 8/2005 Bloxdorf et al.
- 6,941,685 B2 * 9/2005 Goy E01H 5/06
172/816
- 6,944,978 B2 9/2005 LeBlond et al.
- 6,964,121 B2 11/2005 Harris
- 7,134,227 B2 11/2006 Quenzi et al.
- 7,171,769 B2 2/2007 Schultz et al.
- 7,171,770 B2 2/2007 Schultz et al.
- 7,191,846 B2 * 3/2007 Matsumoto E02F 3/815
172/811
- 7,401,658 B2 * 7/2008 Matsumoto E02F 3/7613
172/811
- 7,430,821 B2 10/2008 LeBlond et al.
(Continued)

(56) **References Cited**

U.S. PATENT DOCUMENTS

- 3,987,562 A * 10/1976 Deen E01H 5/06
37/231
- 5,121,562 A * 6/1992 Feller E02F 3/80
37/232
- 5,515,623 A * 5/1996 Weeks E01H 5/066
239/159
- 5,638,618 A * 6/1997 Niemela E01H 5/06
172/782
- 5,706,591 A * 1/1998 Wissmiller E01H 5/06
172/272
- D395,436 S * 6/1998 Hagenbuch D15/32
- 5,909,960 A 6/1999 Ager et al.
- 6,151,808 A 11/2000 Curtis
- 6,178,669 B1 1/2001 Quenzi et al.
- 6,209,231 B1 3/2001 Curtis
- 6,219,943 B1 * 4/2001 Kitchell E01H 5/063
172/811
- 6,393,737 B2 5/2002 Quenzi et al.
- 6,408,549 B1 6/2002 Quenzi et al.

FOREIGN PATENT DOCUMENTS

CA 2552633 1/2010

Primary Examiner — Mark A Goodwin

(74) *Attorney, Agent, or Firm* — Andrzej Malarz, Esq.

(57) **CLAIM**

The ornamental design for snowplow, as shown and described.

DESCRIPTION

FIG. 1 is a front top left side perspective view of snowplow showing my new design;
FIG. 2 is a front top right side perspective view thereof;
FIG. 3 is a rear top left side perspective view thereof;
FIG. 4 is a left side elevational view thereof;
FIG. 5 is a rear elevational view thereof; and,
FIG. 6 is a top plan view thereof.

1 Claim, 6 Drawing Sheets

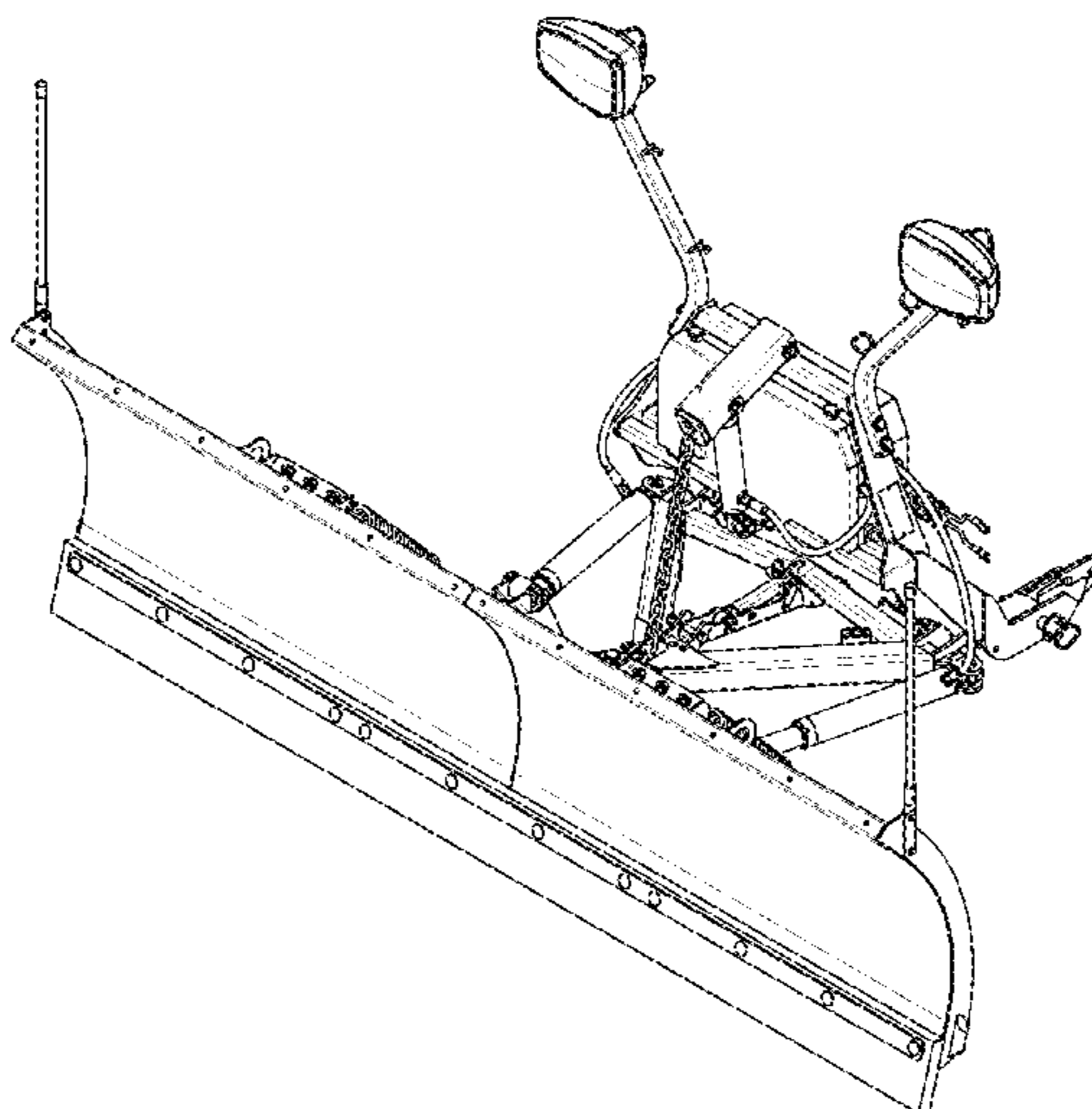

(56)

References Cited

U.S. PATENT DOCUMENTS

7,658,022 B2 *	2/2010	Strait	E01H 5/063 37/232	2004/0006895 A1	1/2004	Schultz et al.	
7,681,334 B2	3/2010	LeBlond et al.			2004/0079002 A1 *	4/2004	Goy E01H 5/06 37/231
7,797,859 B2	9/2010	LeBlond et al.			2004/0144001 A1 *	7/2004	Potak B60R 9/06 37/231
7,841,110 B2	11/2010	Koch et al.			2009/0223091 A1 *	9/2009	Livingston E01H 5/06 37/283
7,963,052 B2	6/2011	Koch et al.			2009/0282706 A1 *	11/2009	Barker E01H 5/061 37/196
8,191,288 B2 *	6/2012	Weagley	E01H 5/06 172/702	2010/0175281 A1	7/2010	LeBlond et al.	
D672,370 S *	12/2012	Becker	D15/28	2013/0232827 A1 *	9/2013	Summers E01H 5/062 37/232
8,522,458 B2	9/2013	Gendreau			2014/0237865 A1	8/2014	Jones et al.	
D692,927 S *	11/2013	Jones	D15/32	2015/0152613 A1 *	6/2015	Ockunzzi E01H 5/061 37/266
8,739,437 B2	6/2014	Ropog et al.			2016/0076285 A1	3/2016	Jones et al.	
8,850,724 B2	10/2014	Bloxdorf			2016/0138233 A1 *	5/2016	Barker E01H 5/061 37/231
9,096,979 B2	8/2015	Larsen			2017/0284045 A1 *	10/2017	Holman E01H 5/062
9,200,418 B2	12/2015	Jones et al.			2017/0328021 A1 *	11/2017	Miller E01H 5/066
D749,151 S *	2/2016	McAdam	D15/32				
D792,913 S *	7/2017	Guggino	D15/32				
9,751,452 B2	9/2017	Orazem						

* cited by examiner

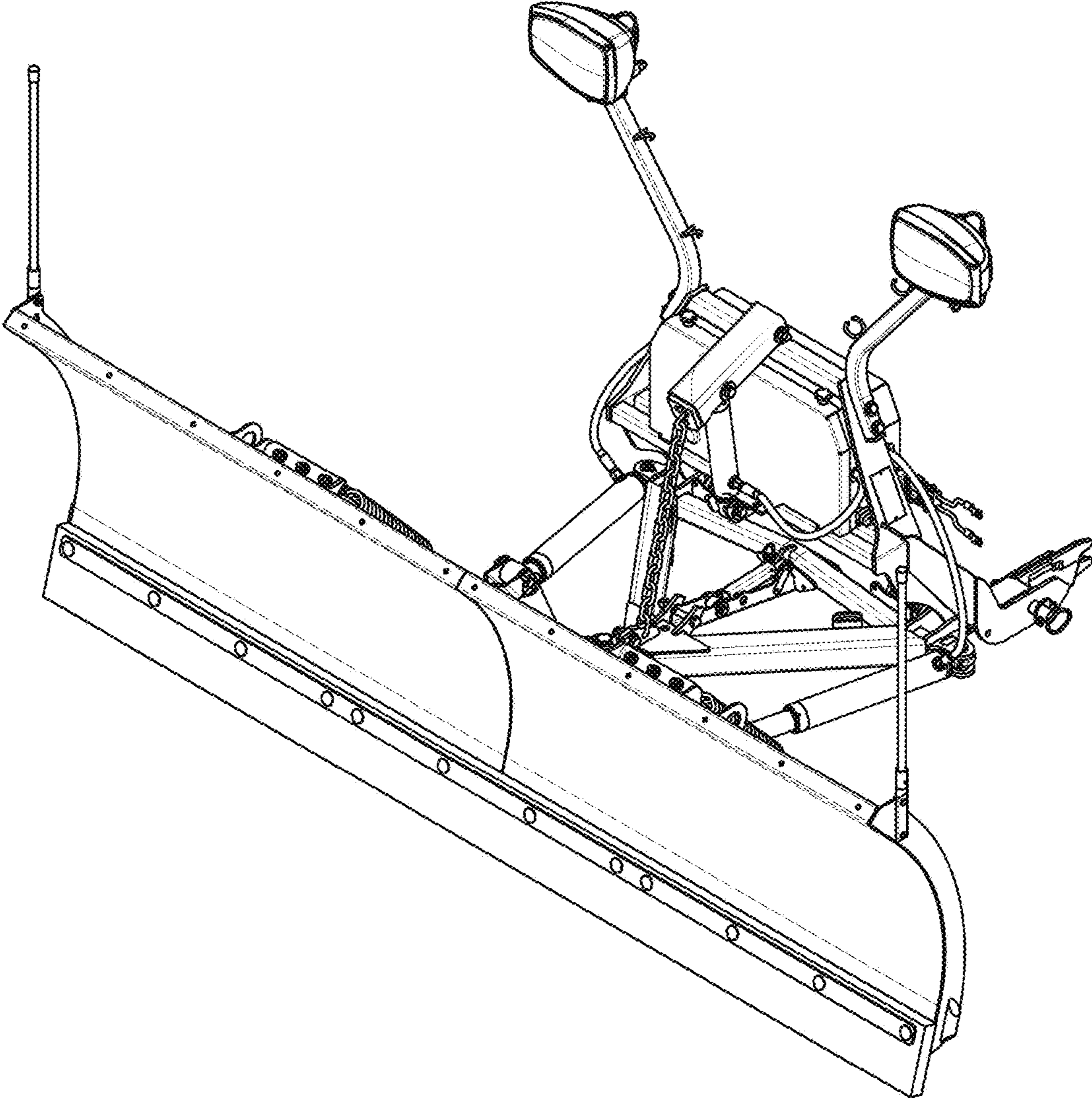

FIG. 1

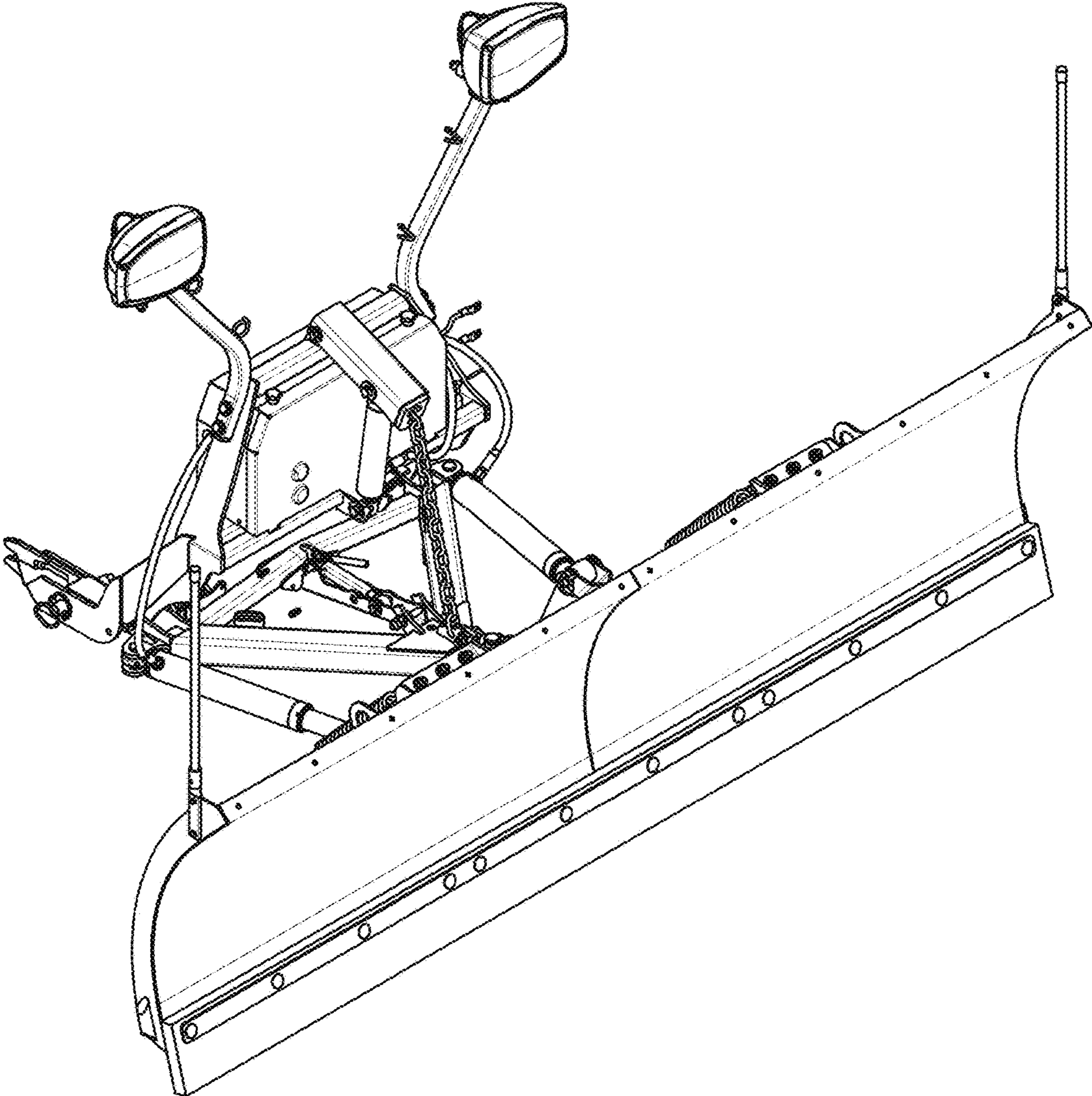

FIG. 2

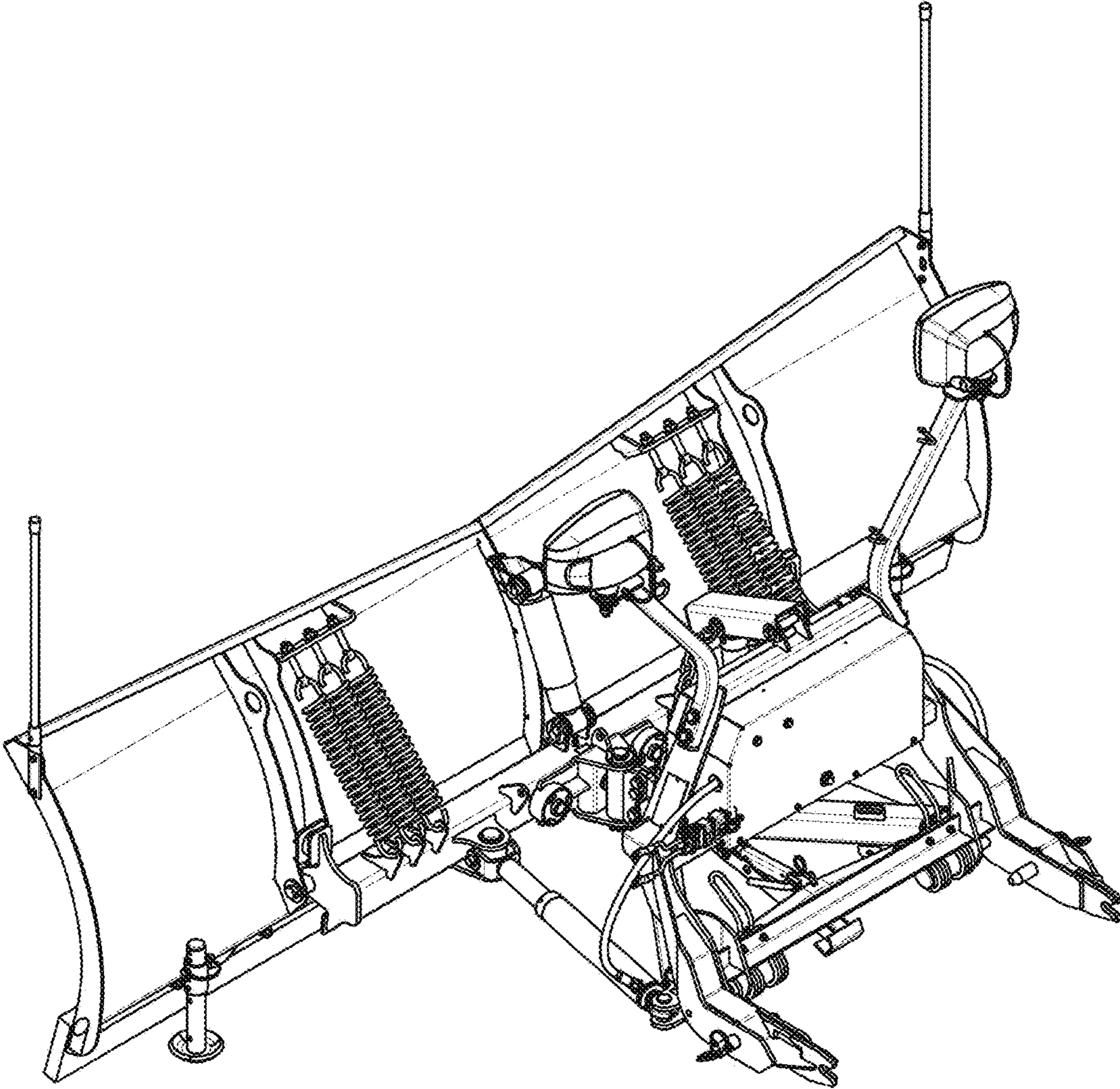

FIG. 3

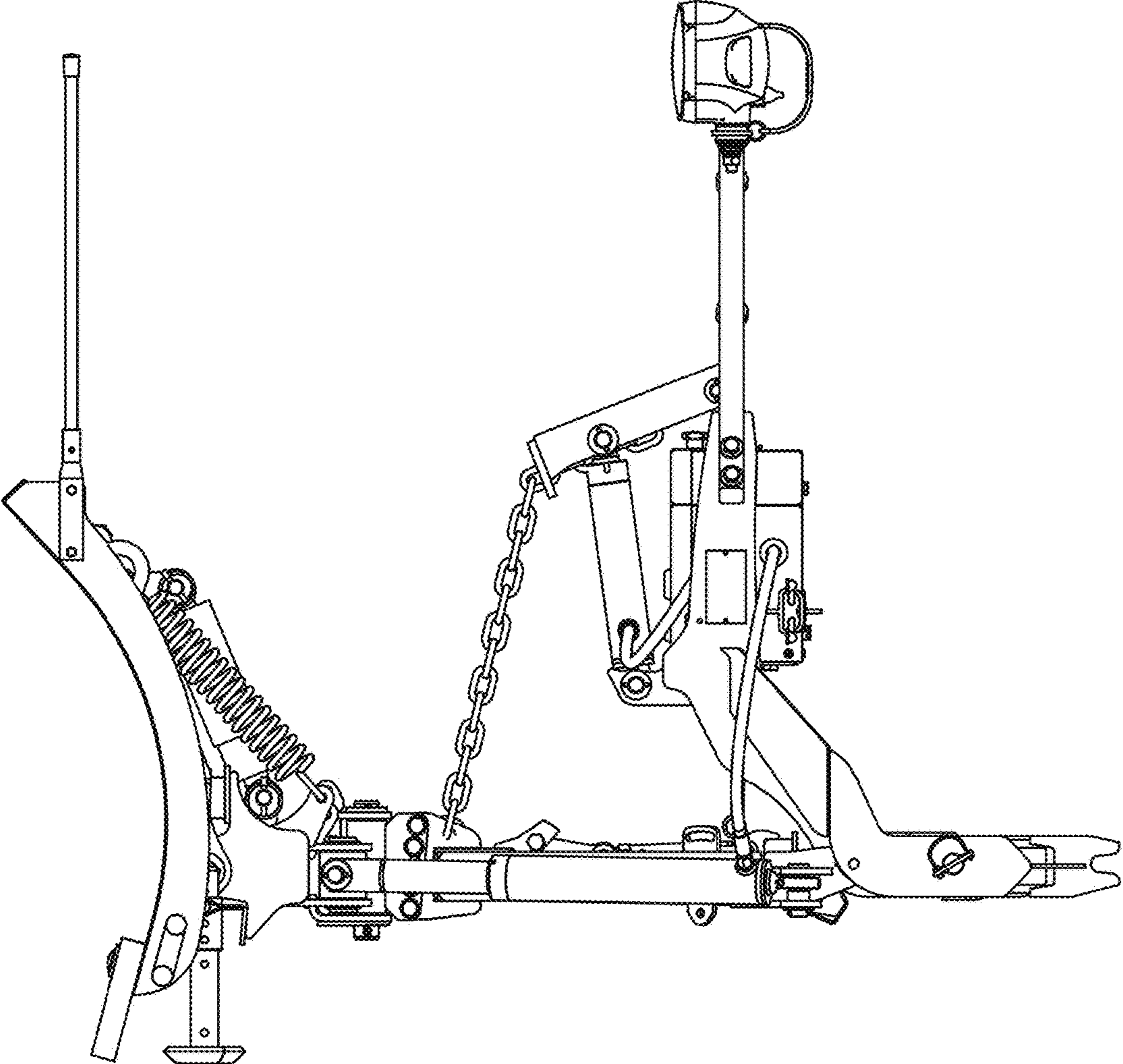

FIG. 4

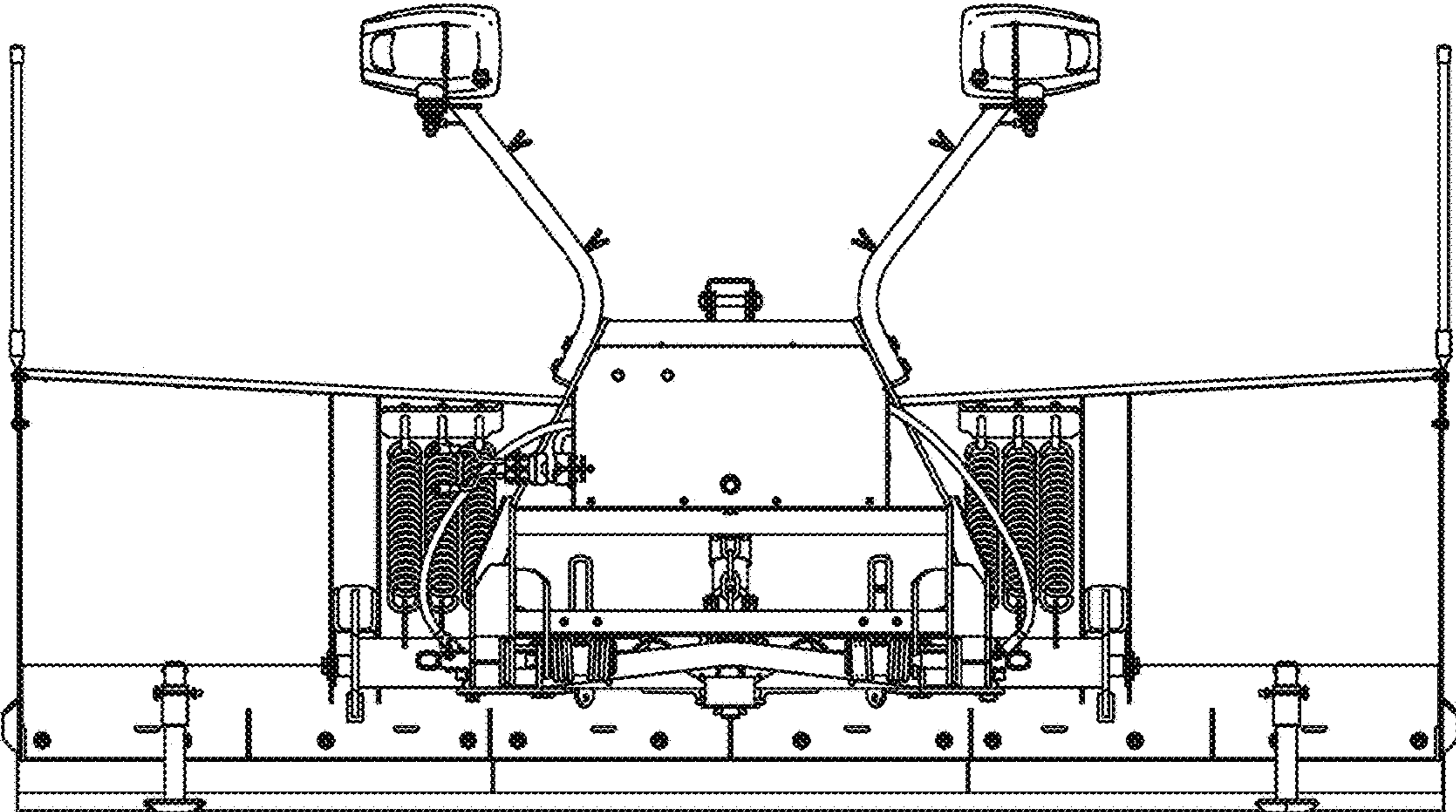

FIG. 5

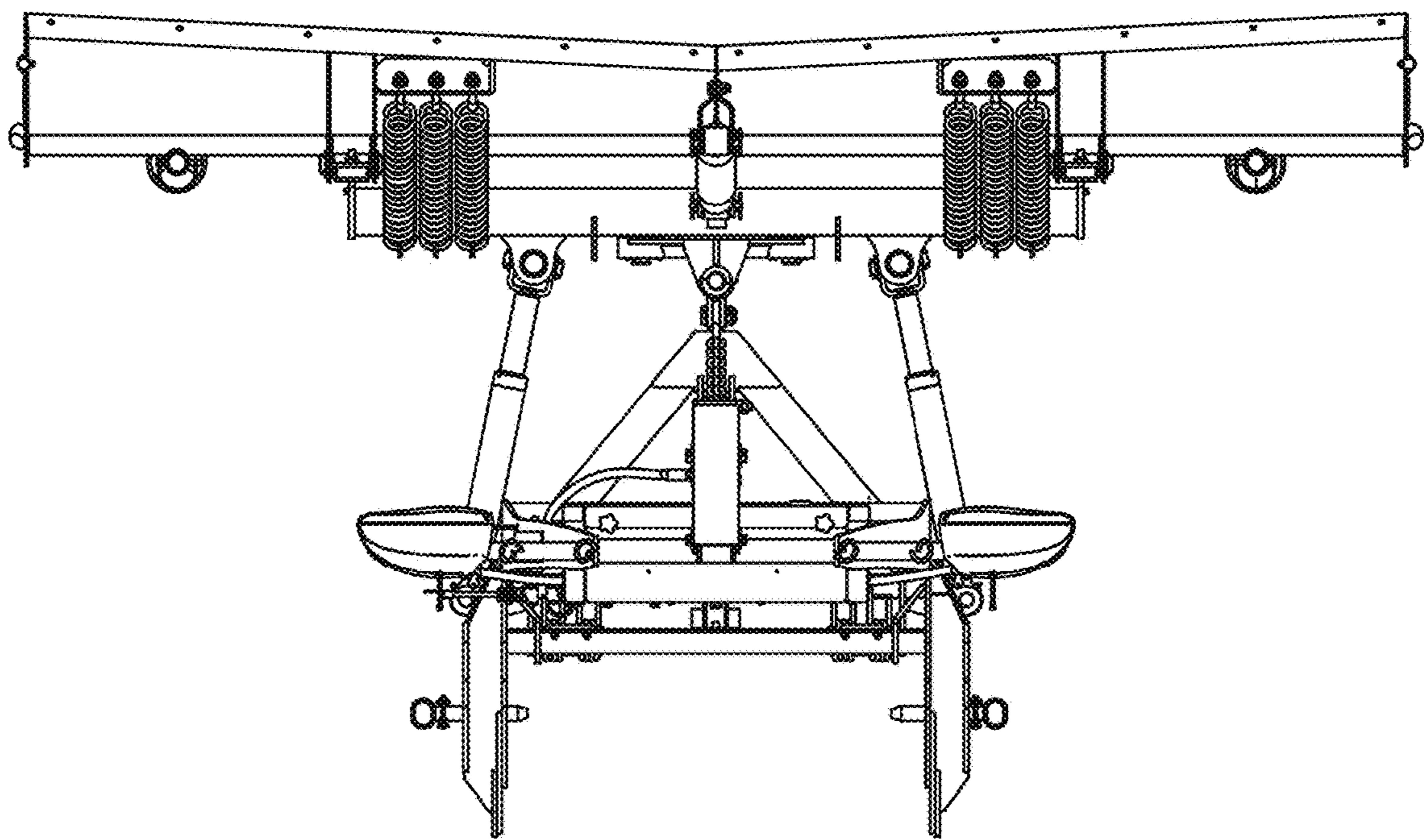

FIG. 6