



US00D844669S

(12) **United States Design Patent**  
**Sinico**

(10) **Patent No.:** **US D844,669 S**

(45) **Date of Patent:** **\*\* Apr. 2, 2019**

- (54) **PUMP**
- (71) Applicant: **DWT HOLDING S.P.A.**, Mestrino (IT)
- (72) Inventor: **Francesco Sinico**, Montecchio Maggiore (IT)
- (73) Assignee: **DWT HOLDING S.P.A.**, Mestrino (IT)
- (\*\*) Term: **15 Years**
- (21) Appl. No.: **29/625,797**
- (22) Filed: **Nov. 13, 2017**

**Related U.S. Application Data**

- (62) Division of application No. 29/505,299, filed on Sep. 8, 2015, now Pat. No. Des. 810,145.

**Foreign Application Priority Data**

- (30) Mar. 10, 2015 (EM) ..... 002650085

- (51) **LOC (11) Cl.** ..... **15-02**
- (52) **U.S. Cl.**  
USPC ..... **D15/7**

- (58) **Field of Classification Search**  
USPC ..... D15/7-9; D23/231, 232, 225; 417/60, 417/235, 265, 321, 355, 358, 363, 359, 417/410.1, 415-416, 405, 900, 269, 539, 417/234; 60/408, 412; 184/26-37; 415/140-147; 123/495, 509; 137/565.34  
CPC ..... F02M 37/04; F02M 37/14; F04B 53/92; F04B 1/005  
See application file for complete search history.

(56) **References Cited**

**U.S. PATENT DOCUMENTS**

- D289,402 S 4/1987 Carlson et al.
- D295,181 S \* 4/1988 Vitaloni ..... D15/9

- D351,602 S 10/1994 Rosebraugh et al.
- D374,237 S 10/1996 Wang
- D404,040 S 1/1999 Suthmann
- D425,911 S 5/2000 Fleischer et al.
- D464,362 S 10/2002 Tsai
- D466,522 S 12/2002 Huang
- D491,957 S 6/2004 Fang
- D492,324 S 6/2004 Stevens
- D498,242 S 11/2004 Song et al.
- D500,770 S 1/2005 Pohler
- D501,486 S \* 2/2005 Leone ..... D15/7
- D510,363 S 10/2005 Leone et al.
- D517,570 S 3/2006 Stiles, Jr. et al.
- D536,705 S 2/2007 Griffin et al.
- D541,818 S 5/2007 Rhea et al.
- D548,751 S \* 8/2007 Snider ..... D15/7
- D556,780 S 12/2007 Tazioli
- D558,233 S 12/2007 Itani
- D565,600 S 4/2008 Tazioli
- D572,273 S \* 7/2008 Carpenter ..... D15/7
- D588,160 S 3/2009 Beale

(Continued)

*Primary Examiner* — Ralf Seifert

(74) *Attorney, Agent, or Firm* — Cantor Colburn LLP

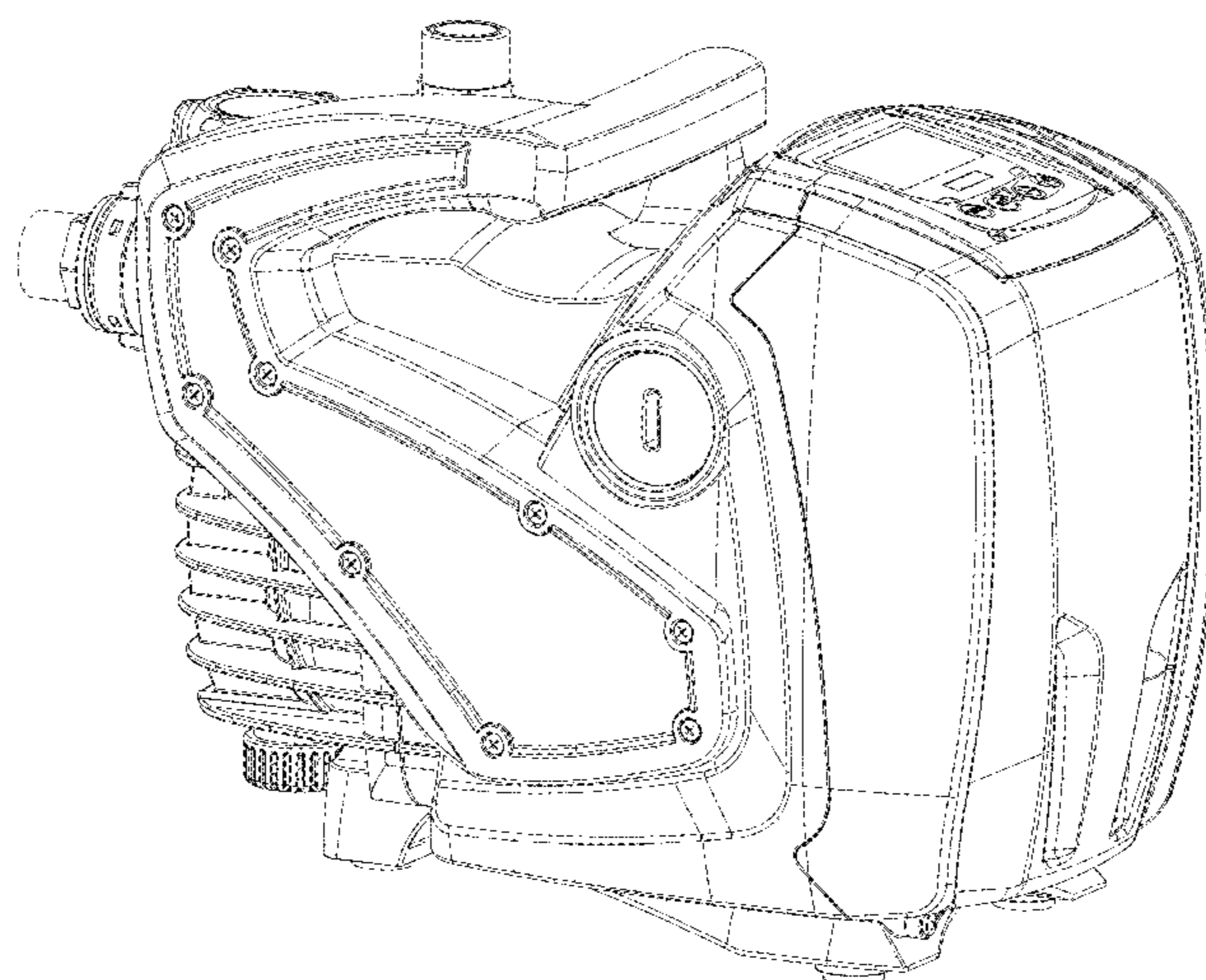
(57) **CLAIM**

I claim, the ornamental design for a pump, as shown and described.

**DESCRIPTION**

FIG. 1 is a perspective view of a pump, showing my new design;  
 FIG. 2 is a front elevation view thereof;  
 FIG. 3 is a rear elevation view thereof;  
 FIG. 4 is a left side elevation view thereof;  
 FIG. 5 is a right side elevation view thereof;  
 FIG. 6 is a top view thereof; and,  
 FIG. 7 is a bottom view thereof.  
 The broken lines are included for the purpose of illustrating portions of the pump that form no part of the claimed design.

**1 Claim, 7 Drawing Sheets**



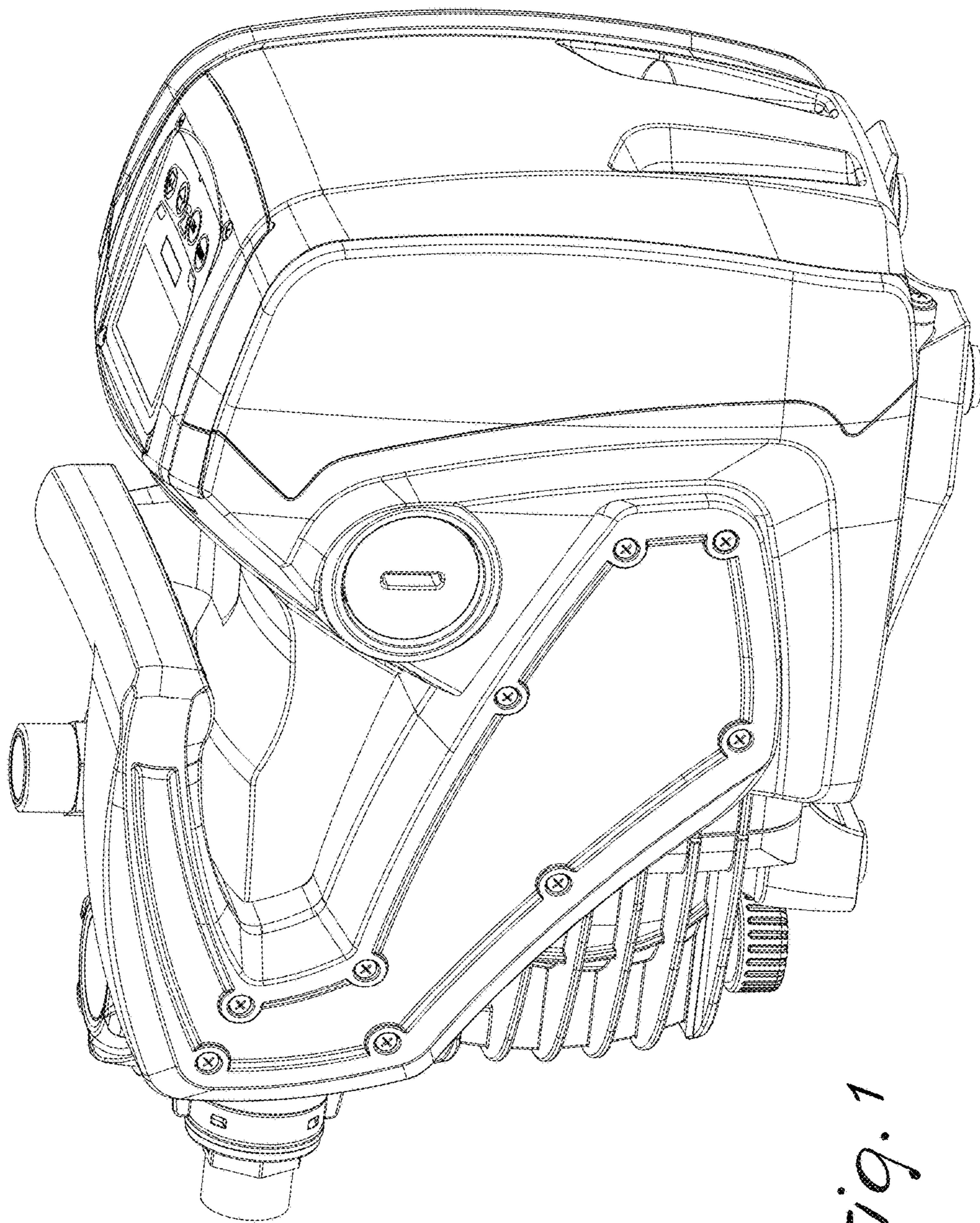
(56)

**References Cited**

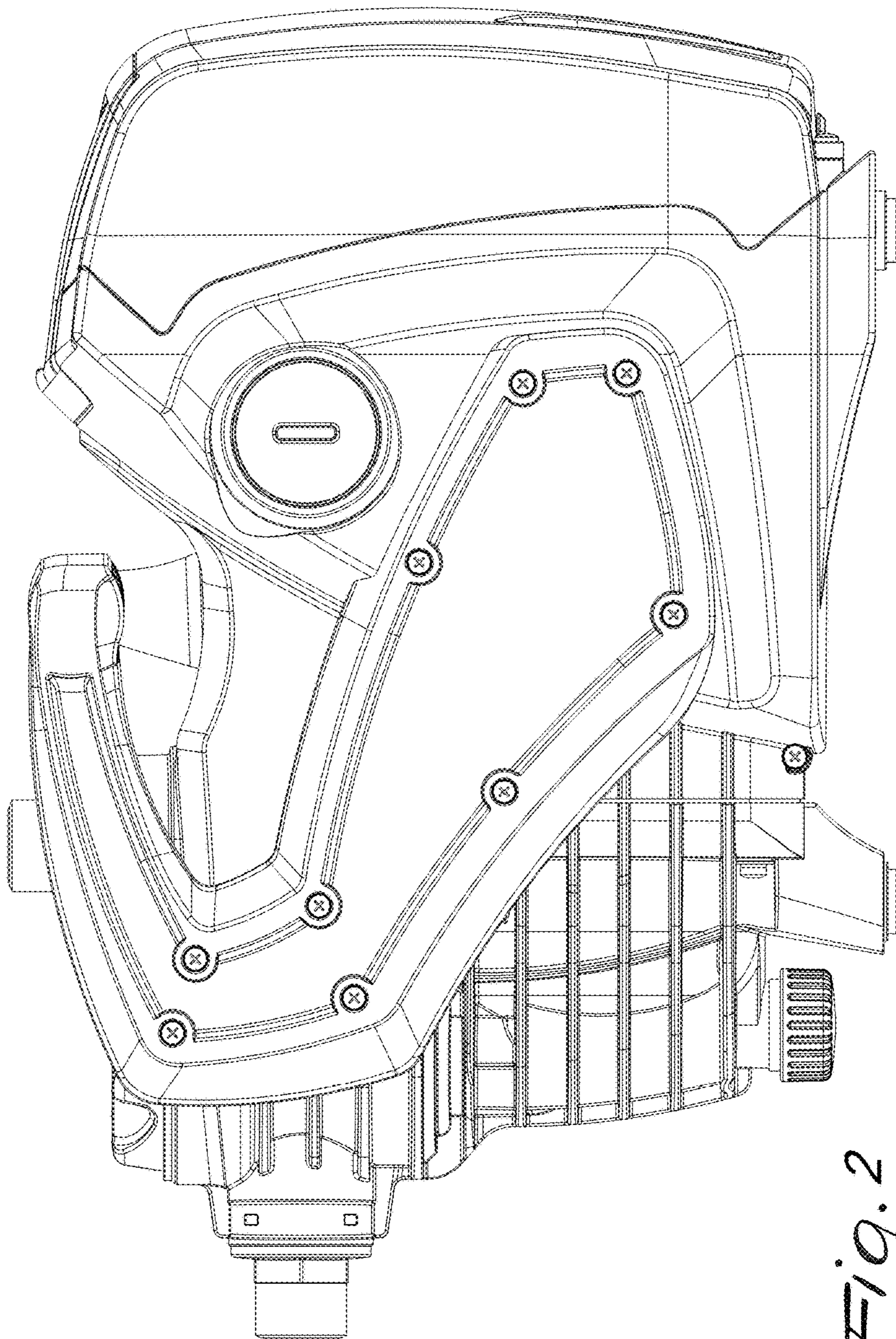
## U.S. PATENT DOCUMENTS

D590,420	S	4/2009	Casalini	
D590,842	S	4/2009	Clark et al.	
D601,590	S	* 10/2009	Burnham .....	D15/7
D604,745	S	11/2009	Sinico	
D621,853	S	8/2010	Sundheim et al.	
D630,229	S	1/2011	Dreifert	
D641,765	S	* 7/2011	Vieira .....	D15/9
D649,163	S	* 11/2011	Moormann .....	D15/7
D656,518	S	3/2012	Varini	
D669,501	S	* 10/2012	Meza .....	D15/7
D675,650	S	2/2013	Champ	
D677,702	S	3/2013	O'Shea	
D678,338	S	3/2013	O'Shea	
D690,323	S	9/2013	Burman et al.	
D700,213	S	2/2014	Taniguchi et al.	
D700,214	S	2/2014	Taniguchi et al.	
D700,624	S	3/2014	Taniguchi et al.	
D700,916	S	3/2014	Kieffer et al.	
D708,648	S	7/2014	Orsini	
D712,933	S	* 9/2014	DeOreo .....	D15/7
D738,402	S	9/2015	Nelson et al.	
D740,329	S	10/2015	Gilbert et al.	
D744,004	S	11/2015	Sacchetti et al.	
D757,825	S	5/2016	Chevallier et al.	
D800,790	S	* 10/2017	Mazur .....	D15/7
D806,133	S	* 12/2017	Costle .....	D15/9
D812,645	S	* 3/2018	Sinico .....	D15/7
D814,525	S	* 4/2018	Yang .....	D15/9

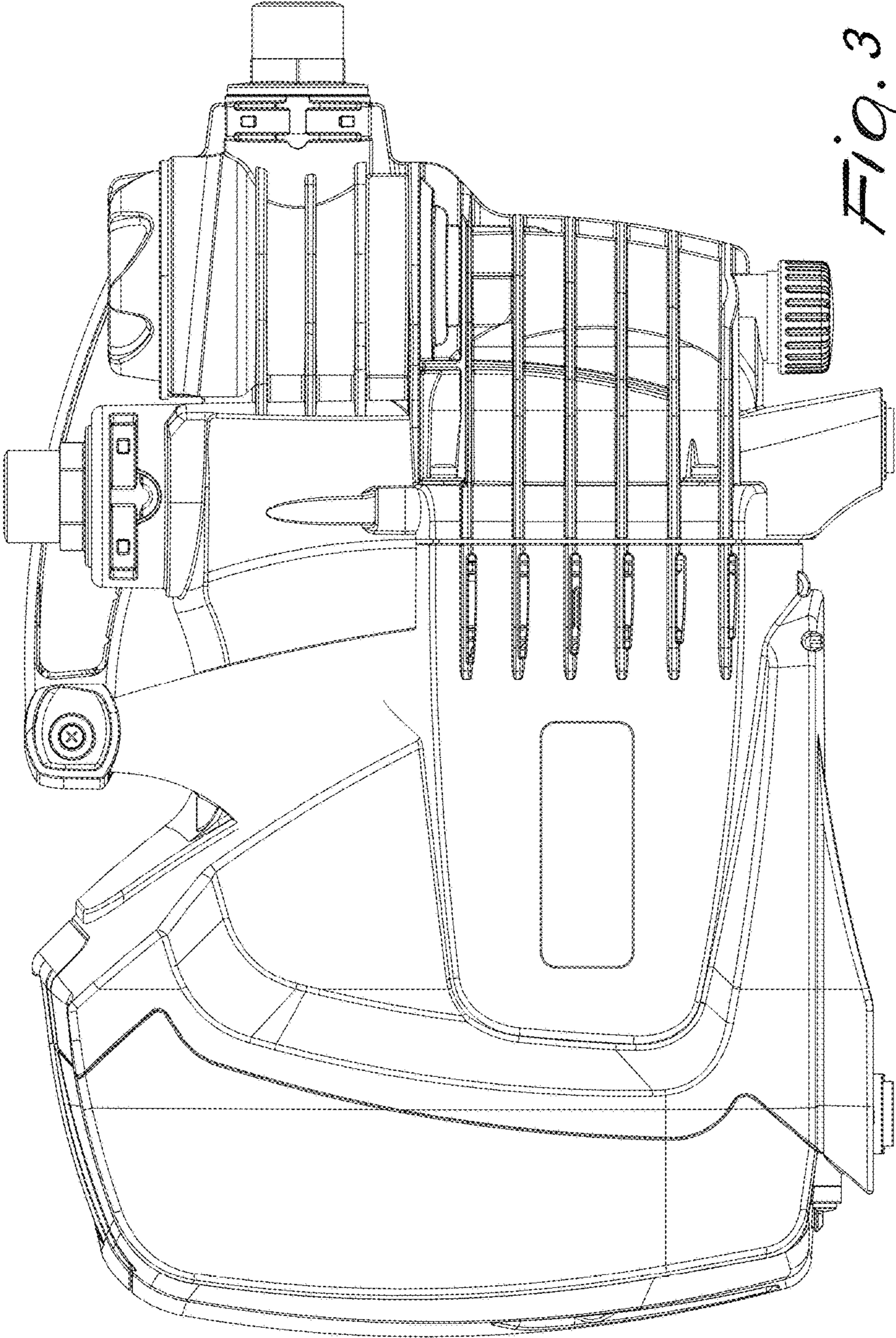
\* cited by examiner



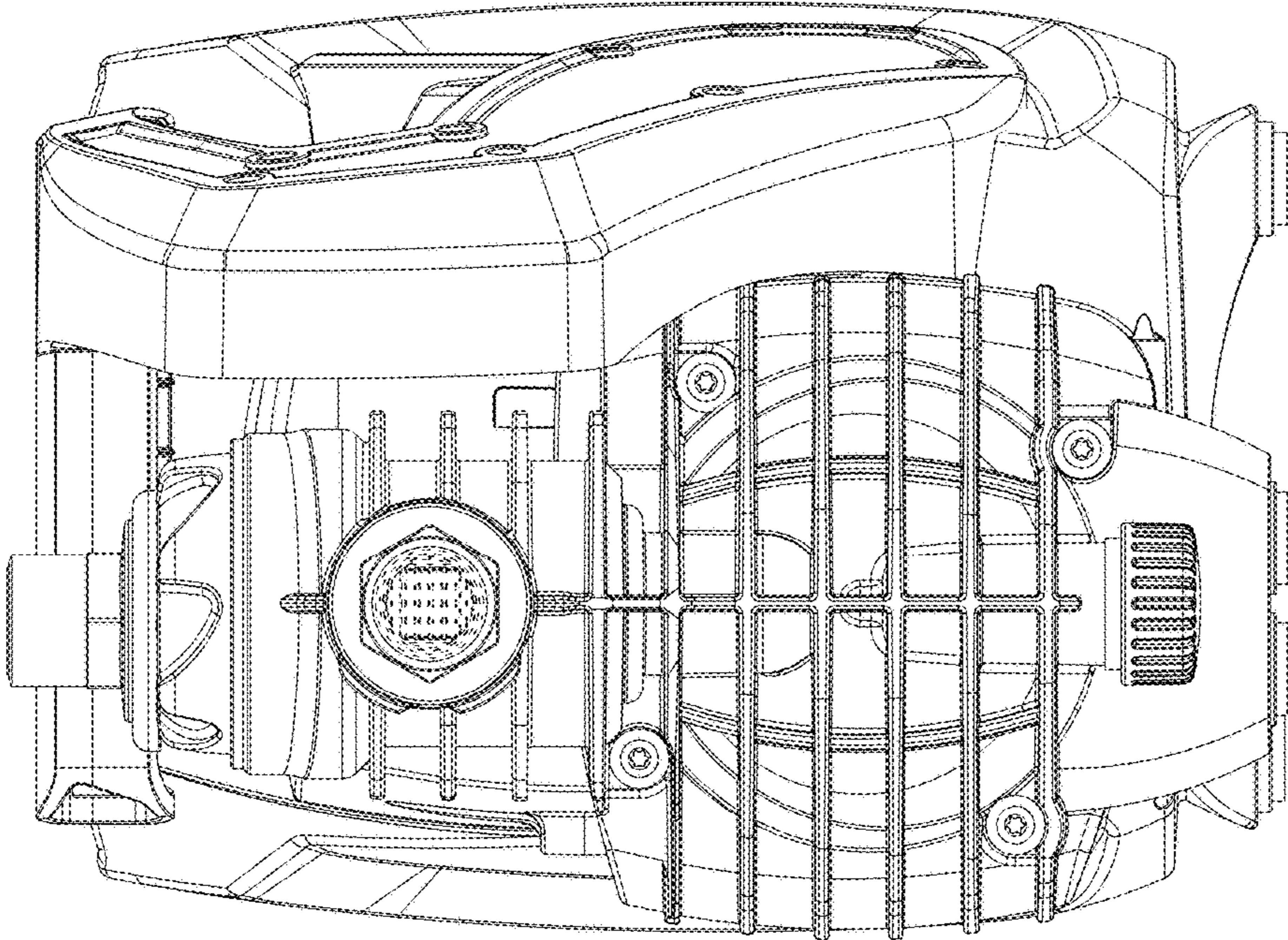
*Fig. 1*



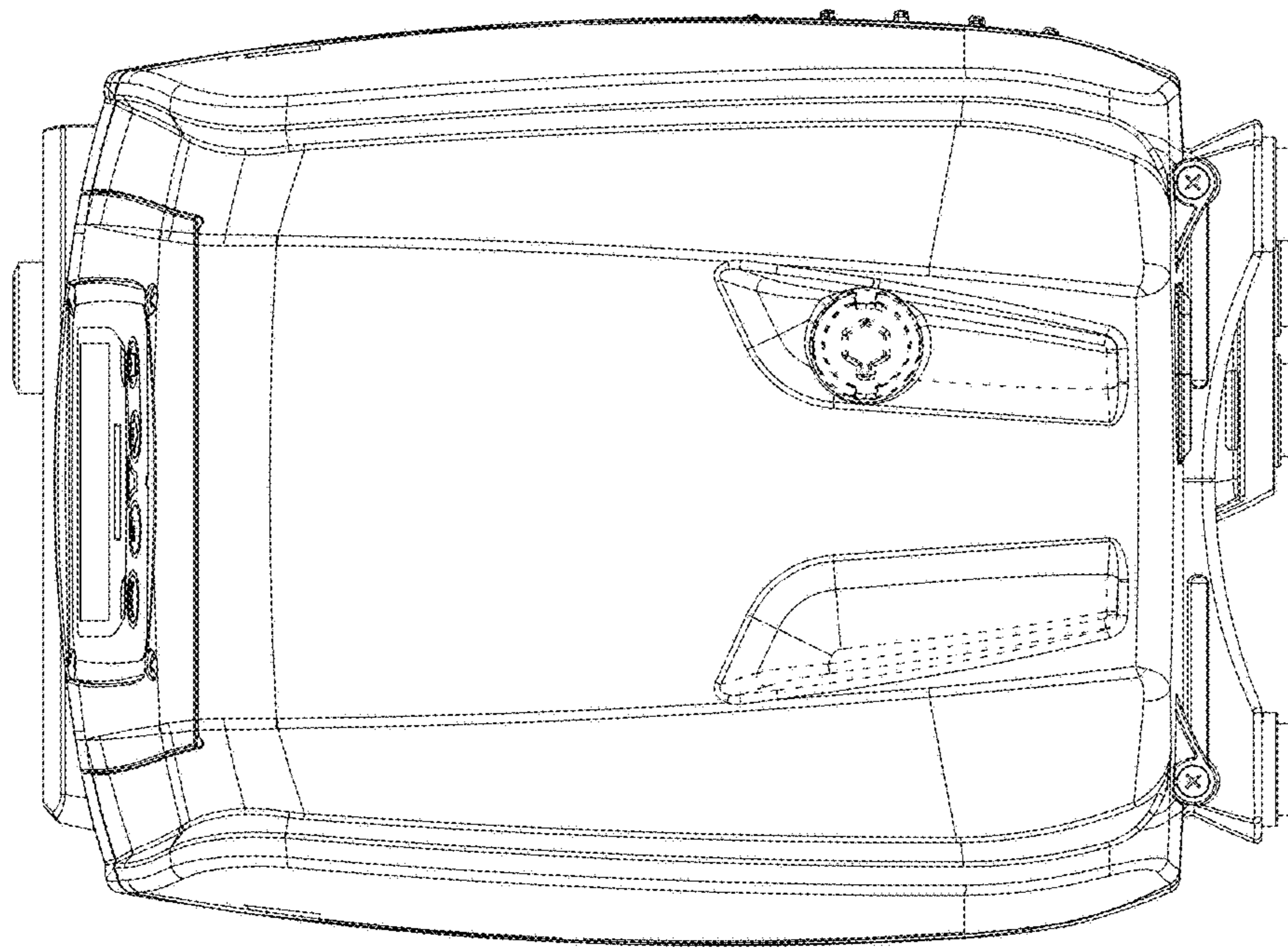
*Fig. 2*



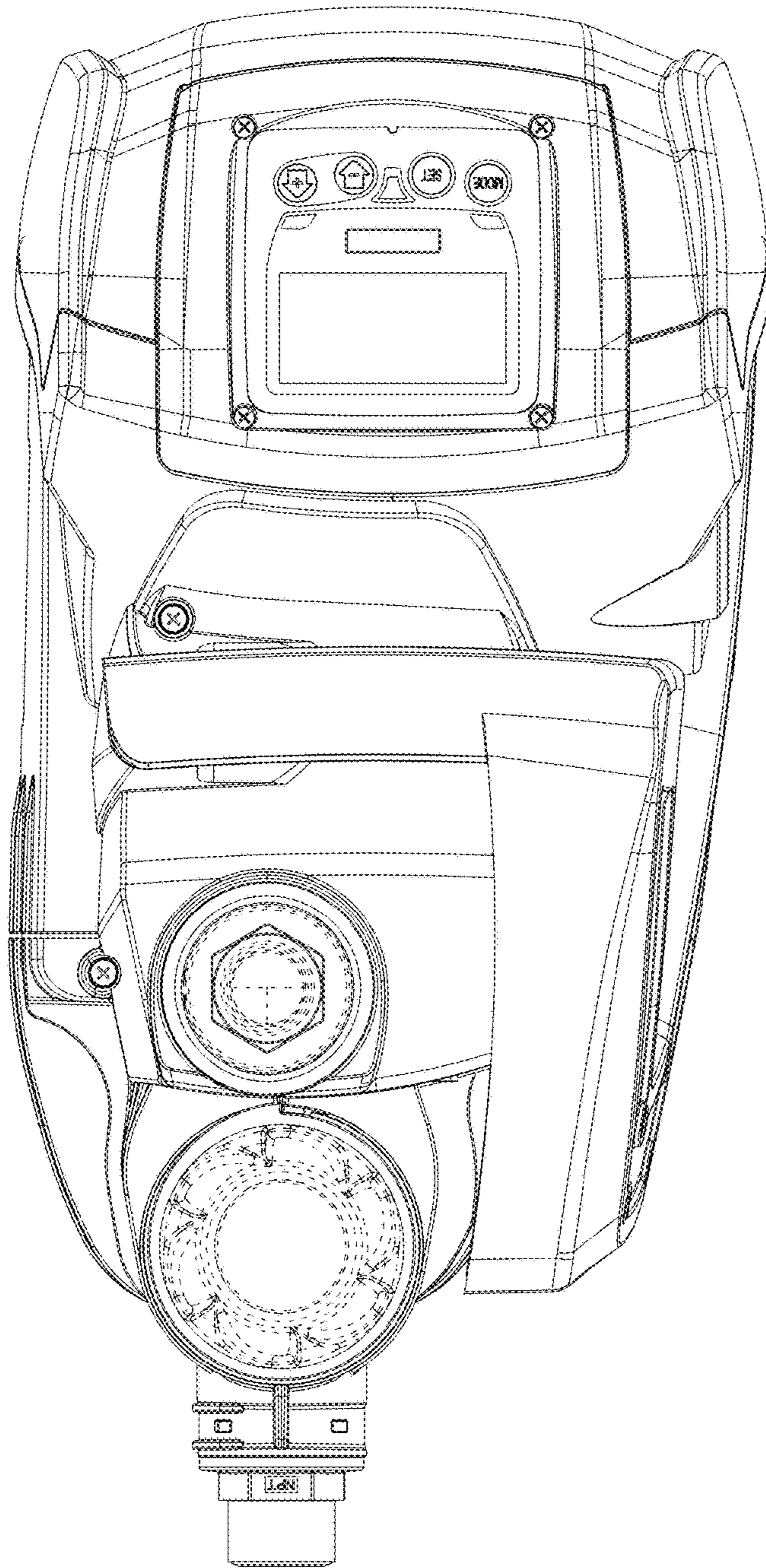
*Fig. 3*



*Fig. 4*

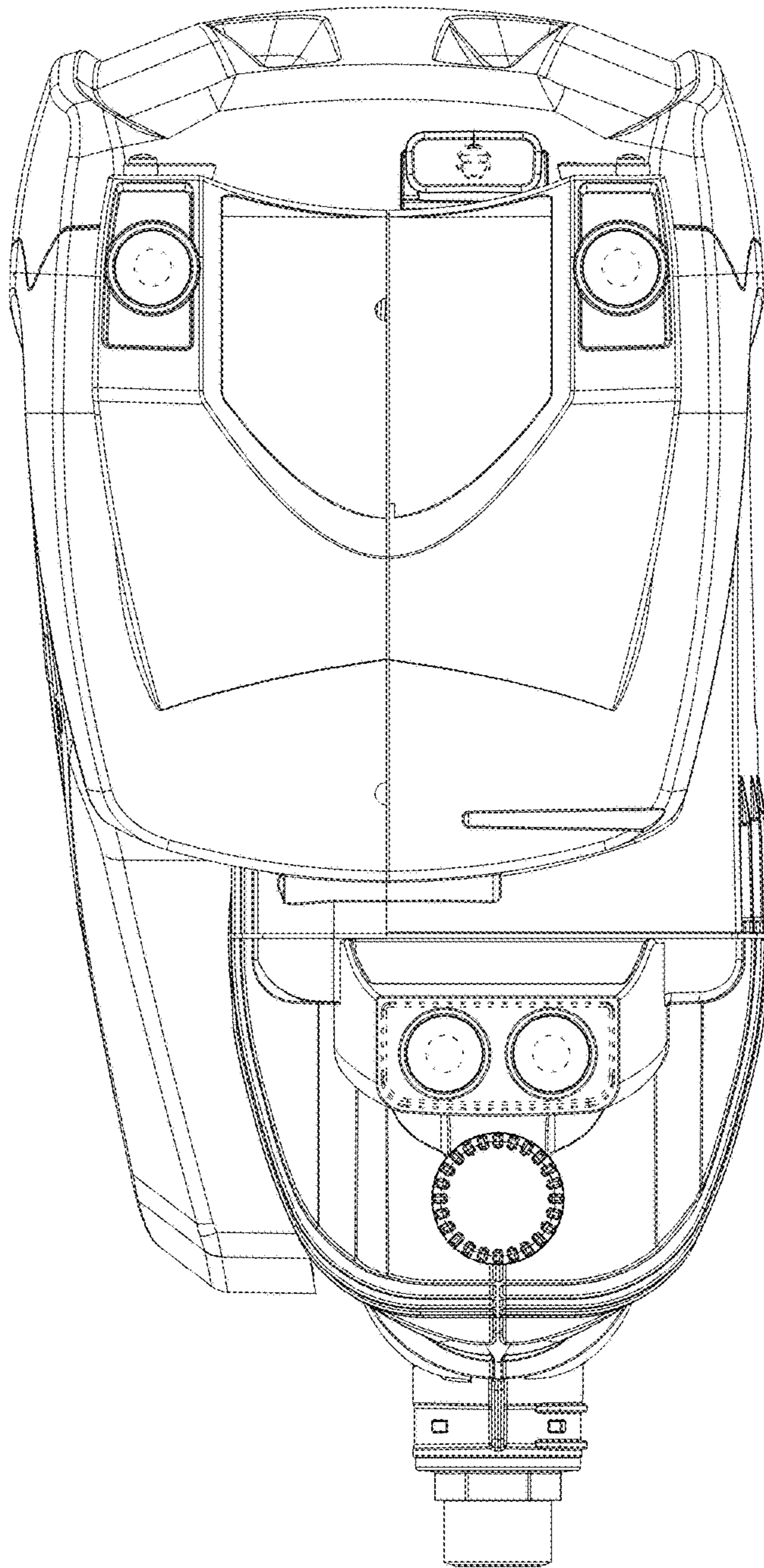


*Fig. 5*



*Fig. 6*





*Fig. 7*