



US00D843084S

(12) **United States Design Patent**
Dominick et al.

(10) **Patent No.:** **US D843,084 S**
(45) **Date of Patent:** **** Mar. 19, 2019**

(54) **POST OPERATIVE SURGICAL DRESSING GARMENT**

(71) Applicants: **Thomas Dominick**, Lewisburg, PA (US); **Troy Kerstetter**, Rebuck, PA (US)

(72) Inventors: **Thomas Dominick**, Lewisburg, PA (US); **Troy Kerstetter**, Rebuck, PA (US)

(**) Term: **15 Years**

(21) Appl. No.: **29/573,824**

(22) Filed: **Aug. 10, 2016**

(51) **LOC (11) Cl.** **02-02**

(52) **U.S. Cl.**
USPC **D2/742**

(58) **Field of Classification Search**
USPC D2/742, 731; D24/189
CPC . A41D 1/06; A41D 1/08; A41D 1/067; A41D 1/062; A41D 1/082; A41D 1/086; A41D 1/084; A41D 1/088; A41D 7/00; A41D 7/001; A41D 7/005; A41D 7/006
See application file for complete search history.

(56) **References Cited**

U.S. PATENT DOCUMENTS

D365,672 S *	1/1996	Childress	D2/742
6,665,882 B1 *	12/2003	Pedrick	A41D 7/005
				2/228
D750,348 S *	3/2016	Hammer	D2/742
D778,031 S *	2/2017	Maier	D2/742
D783,232 S *	4/2017	Zimmermann	D2/731

D794,903 S *	8/2017	Johnston	D2/700
D797,403 S *	9/2017	Moore	D2/731
D802,257 S *	11/2017	Van Sisseren	D2/742
D802,258 S *	11/2017	Lomax	D2/742
D804,781 S *	12/2017	Kositchiranant	D2/731
2014/0208484 A1 *	7/2014	Huff	A41F 9/025
				2/243.1

* cited by examiner

Primary Examiner — Robin V Webster

Assistant Examiner — James C Thorn, Sr.

(74) *Attorney, Agent, or Firm* — Sonya C. Harris; Invention Services

(57) **CLAIM**

The ornamental design for the post operative surgical dressing garment, as shown and described.

DESCRIPTION

FIG. 1 is a top left side perspective view of a postoperative surgical dressing garment showing our new design; FIG. 2 is a left side elevational view of our design; FIG. 3 is a front elevational view of our design; FIG. 4 is a right side view of our design; FIG. 5 is a front left side perspective view of our design illustrating the resealable pants leg in a partially opened position; FIG. 6 is a top elevational view of our design; FIG. 7 is a bottom elevational view of our design; FIG. 8 is a rear elevational view of our design illustrating the ice pockets; FIG. 9 is a top front right side perspective view of our design; and, FIG. 10 is a right side elevational view of our design.

1 Claim, 4 Drawing Sheets

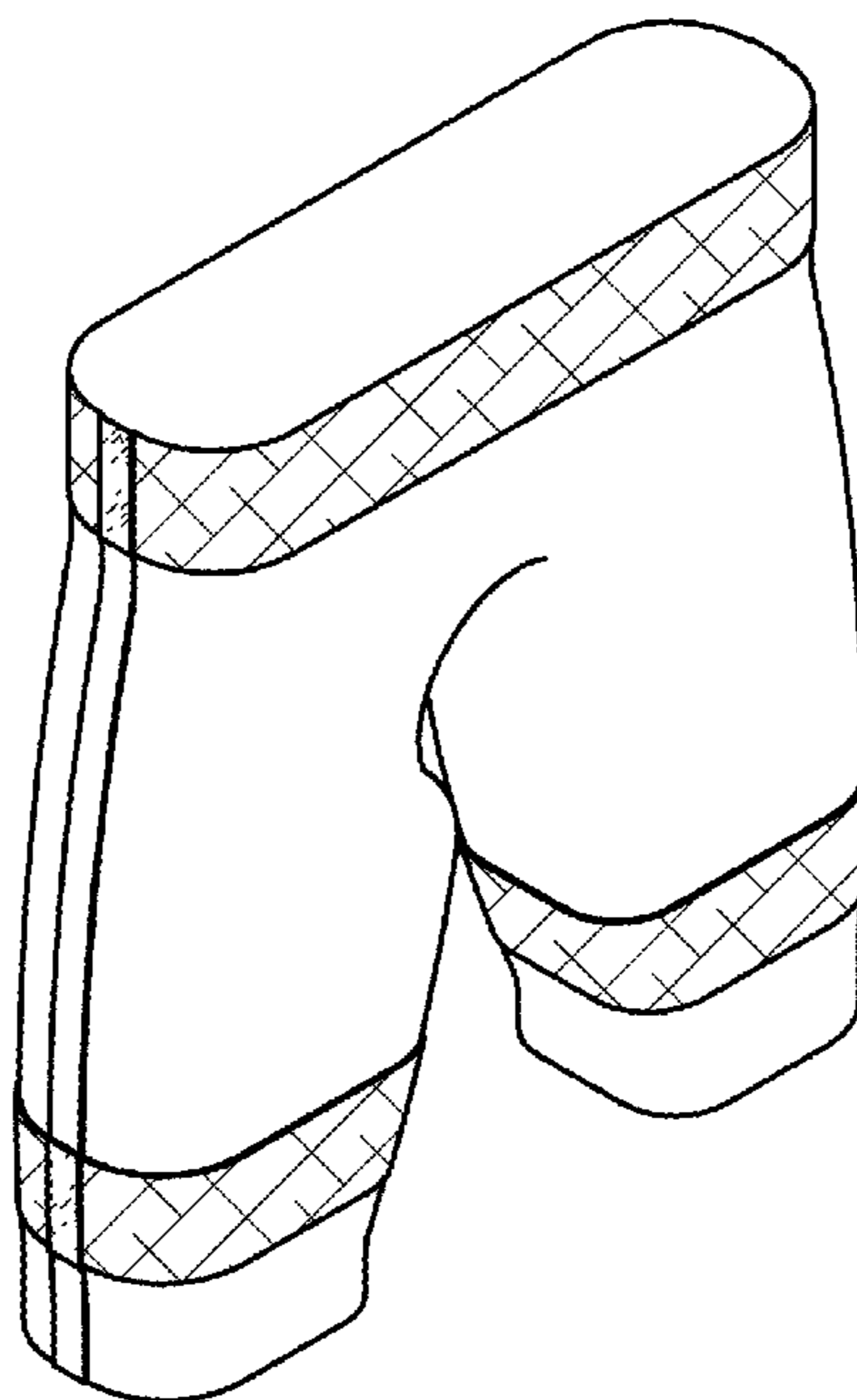

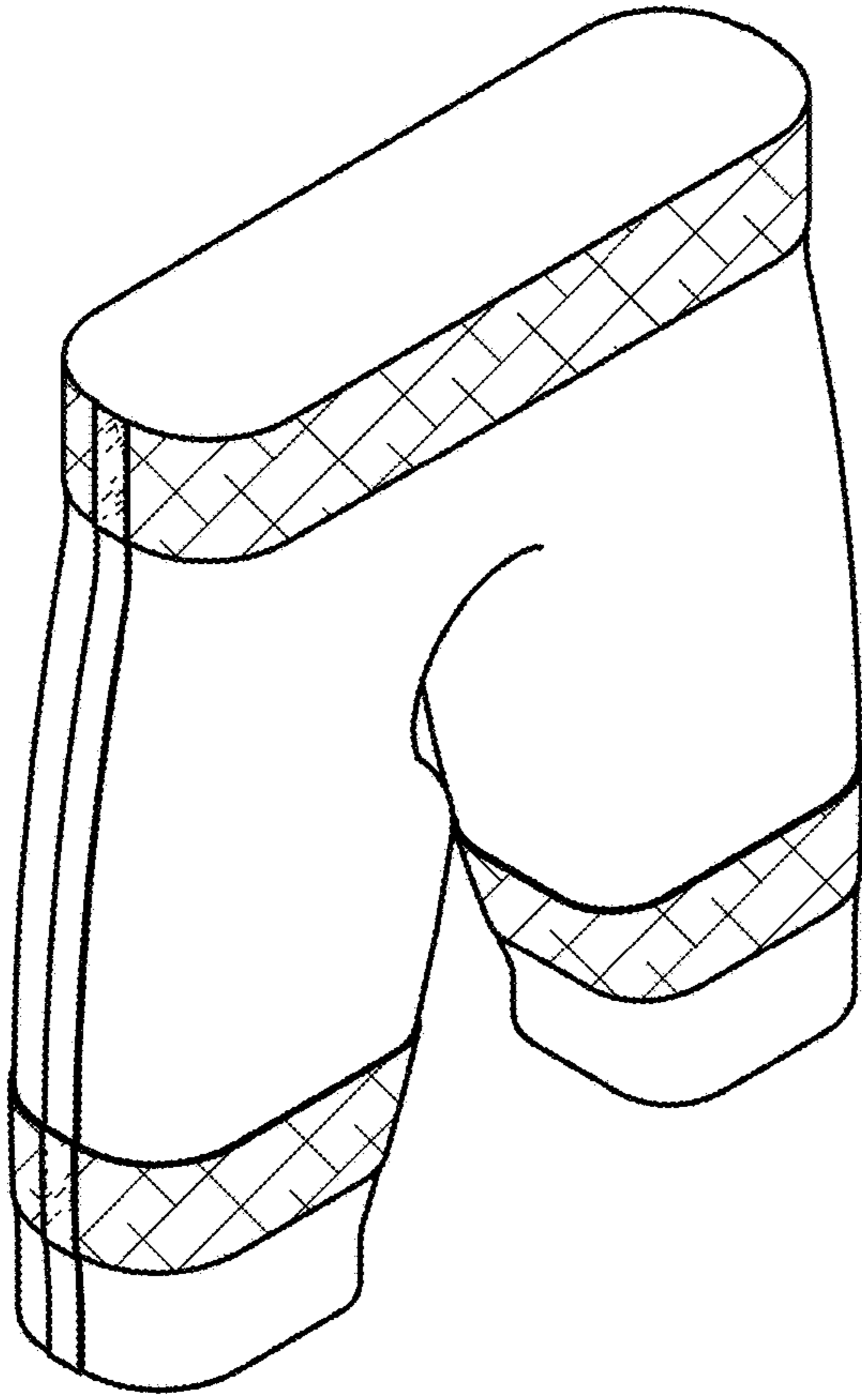

Fig. 1

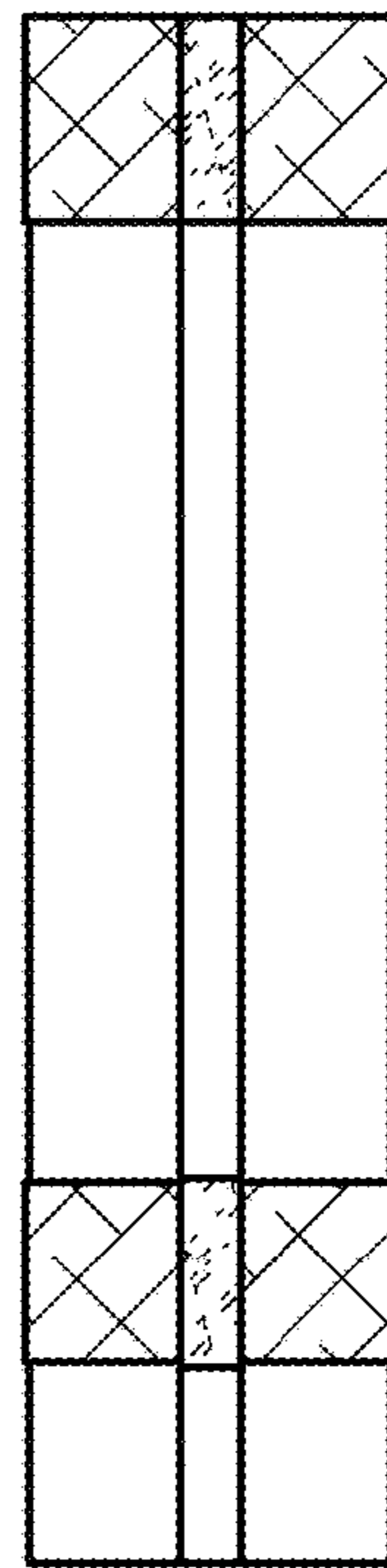

Fig. 2

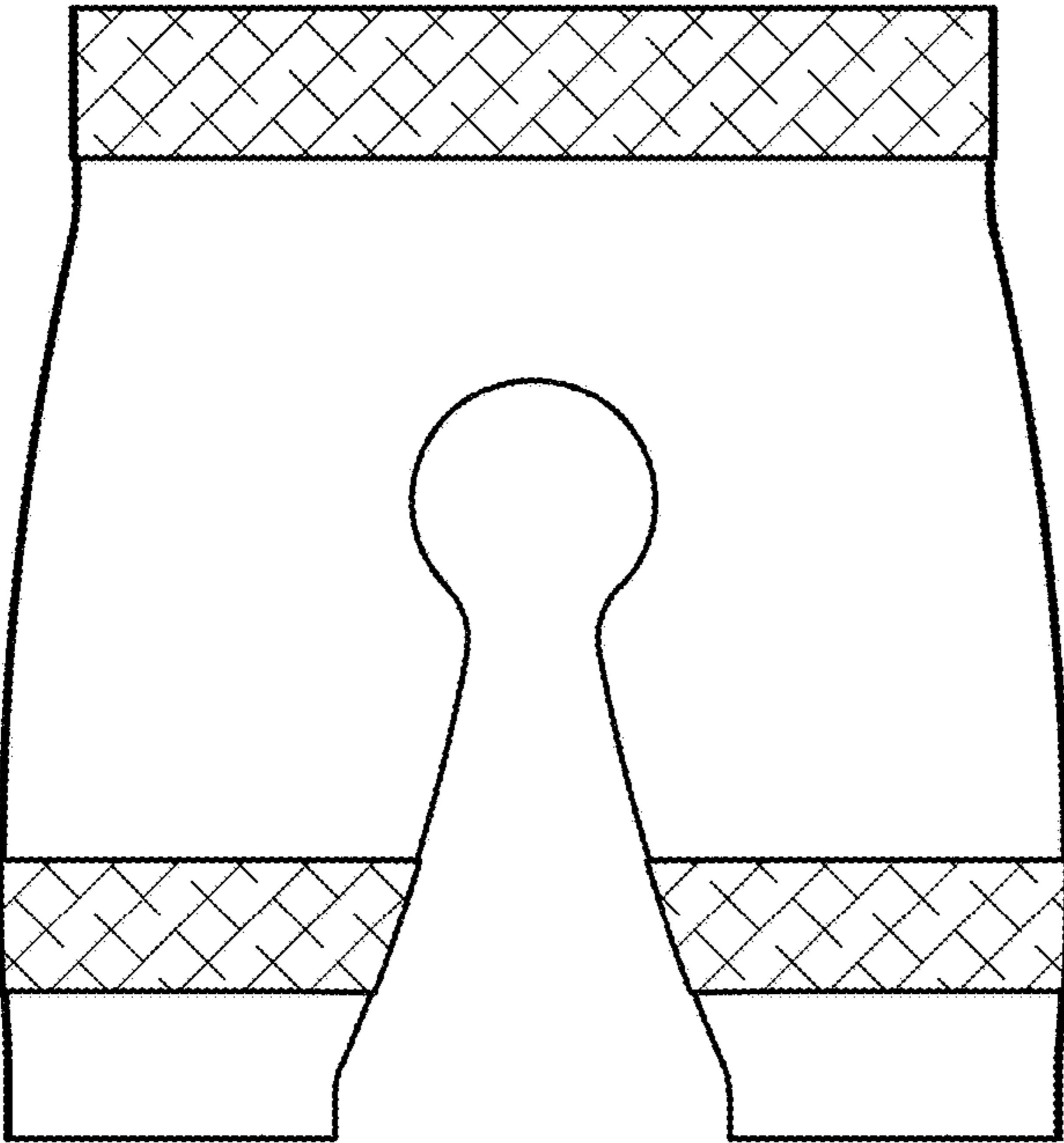

Fig. 3

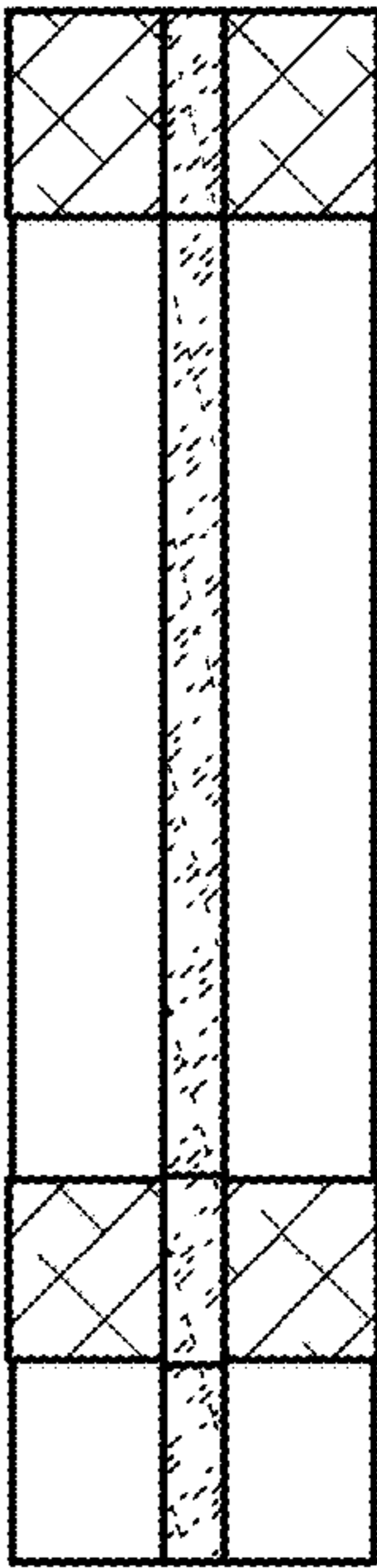

Fig. 4

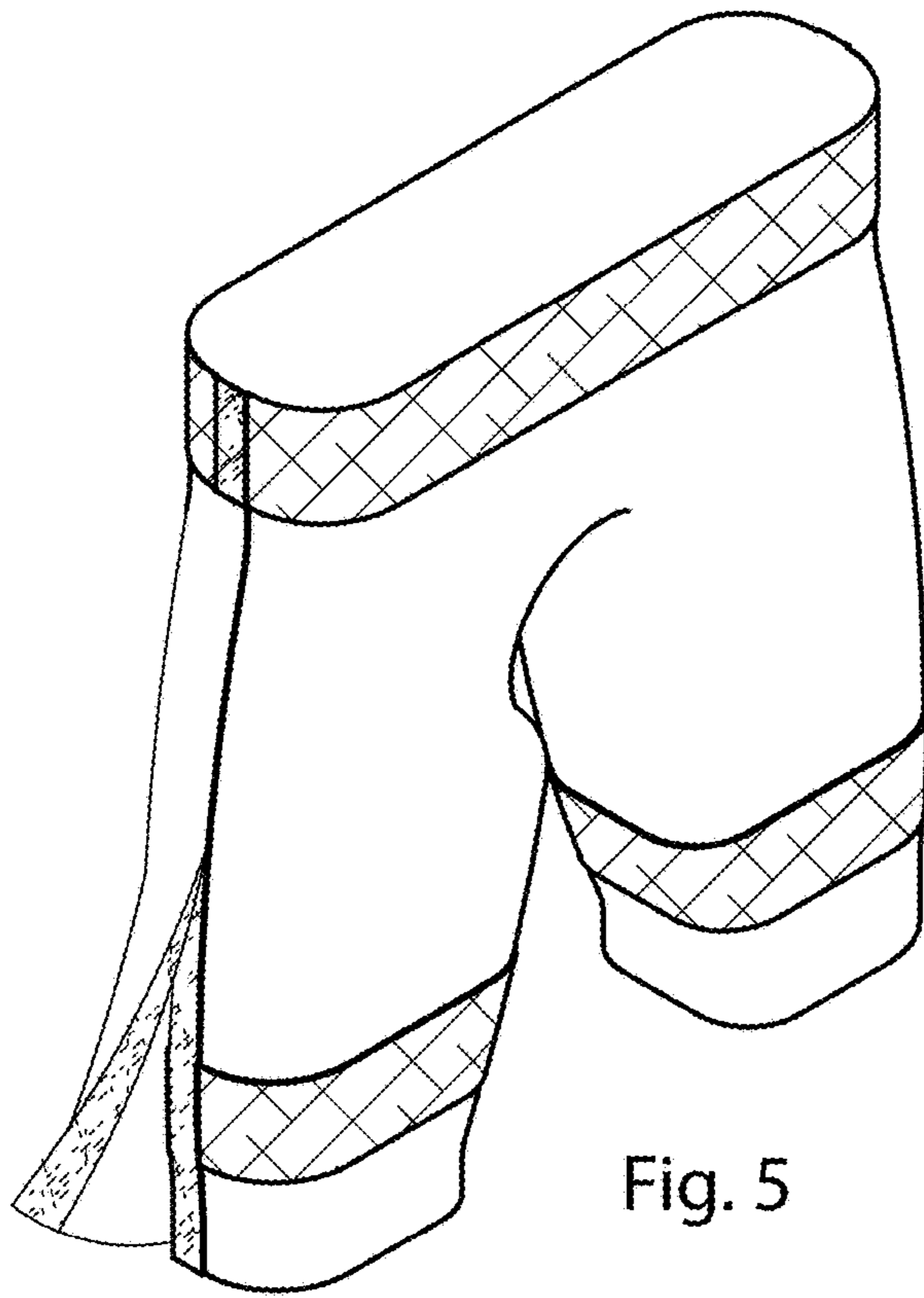

Fig. 5



Fig. 6

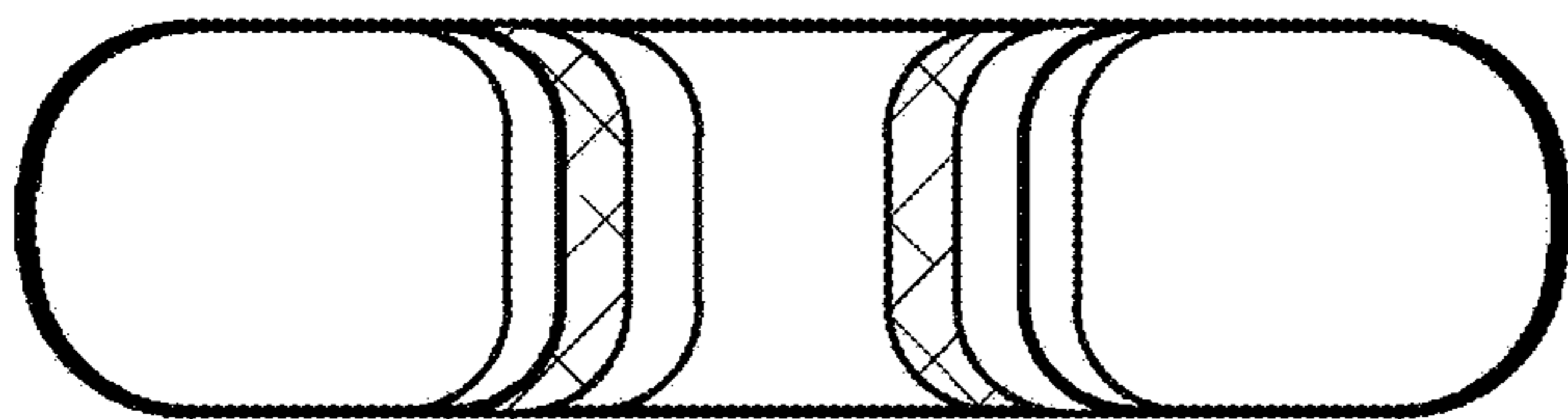

Fig. 7

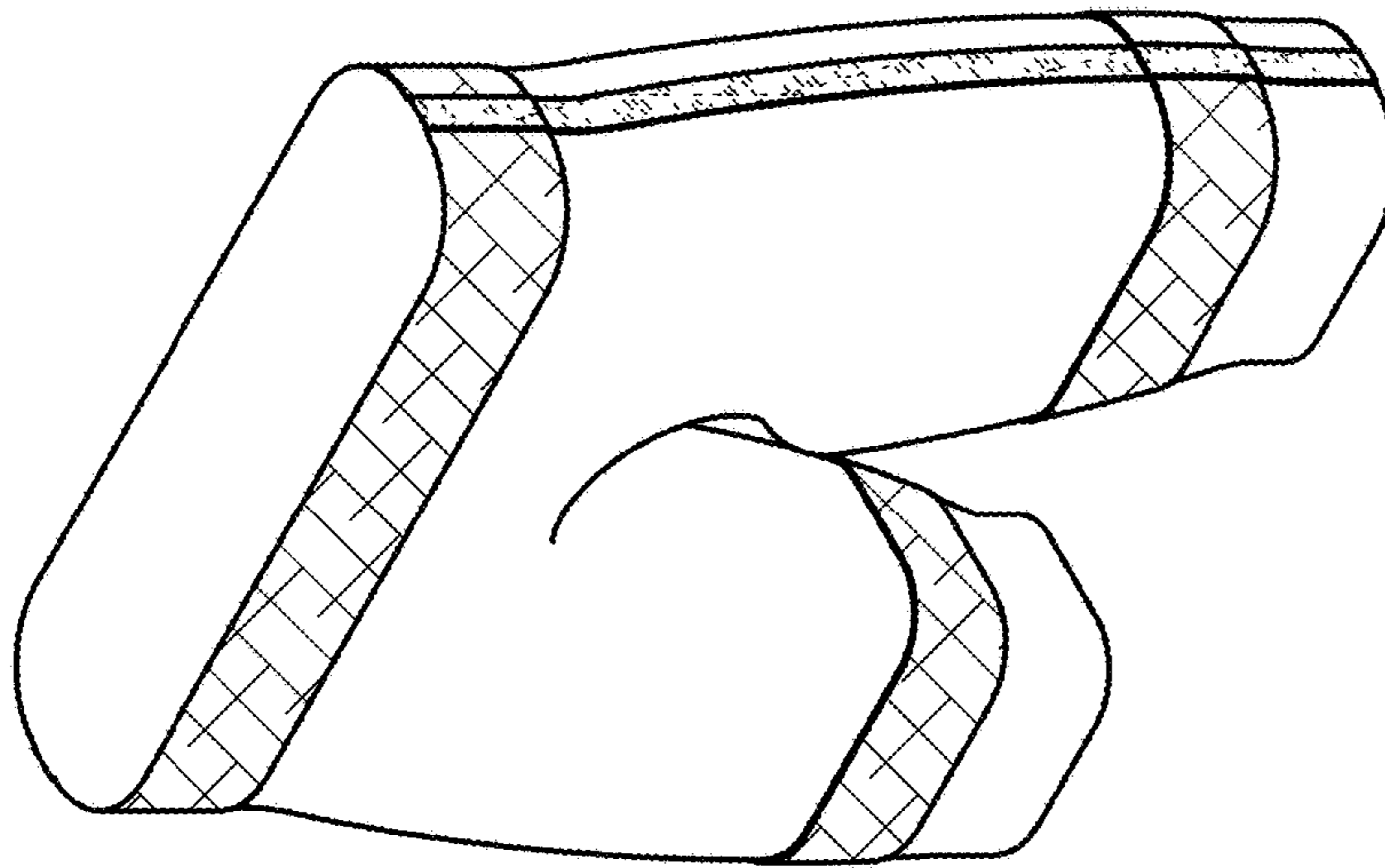

Fig. 9

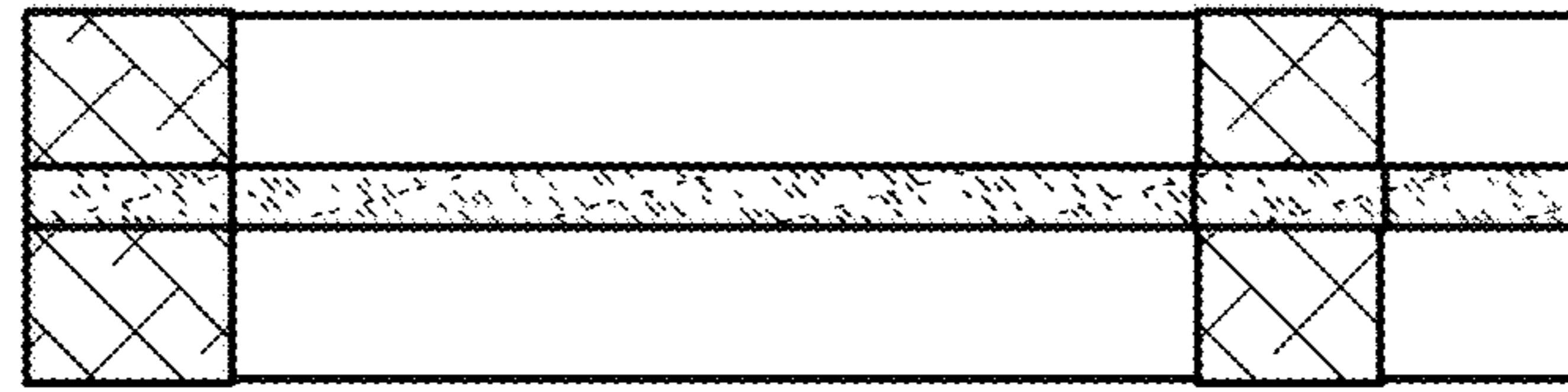

Fig. 10

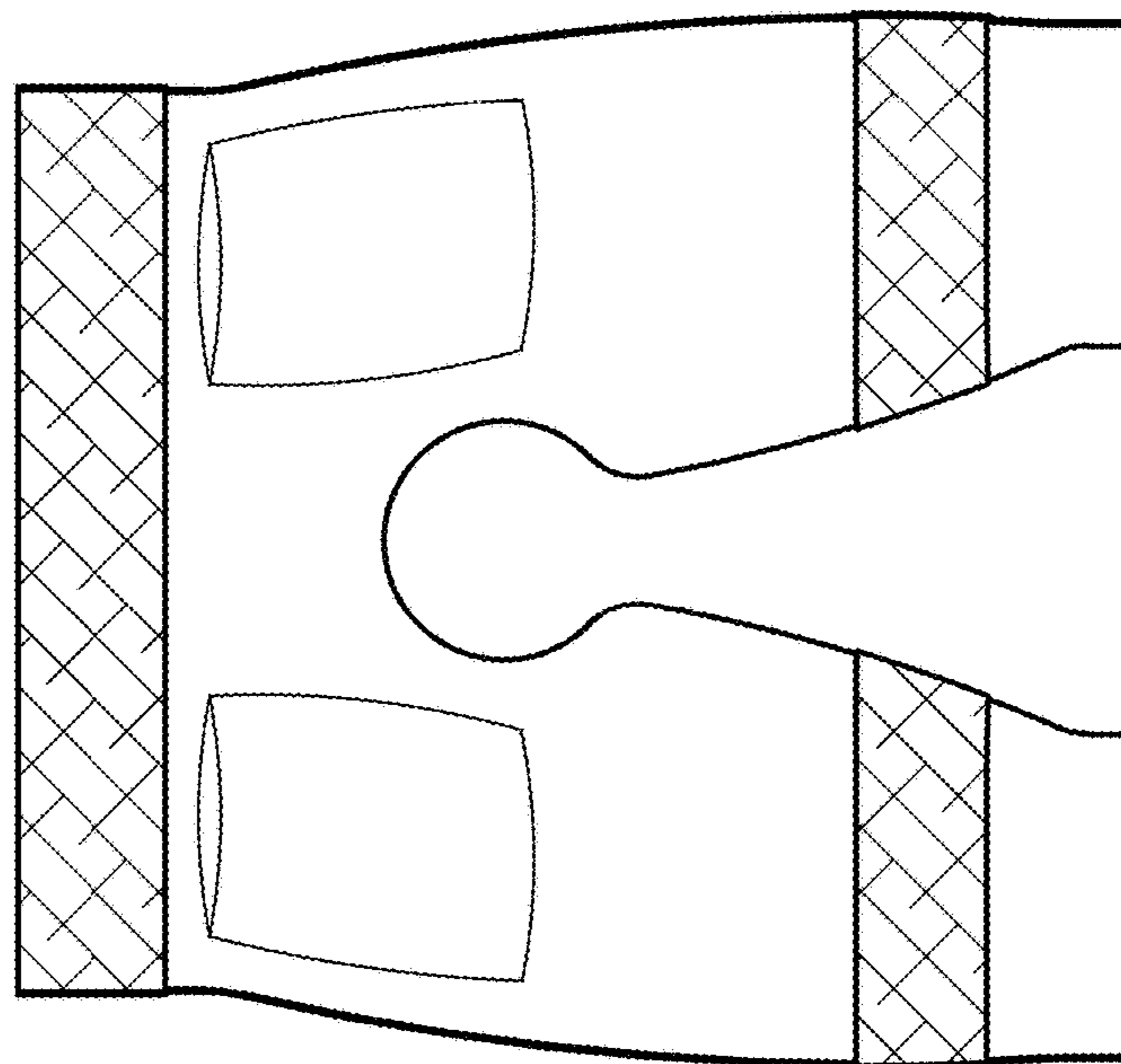

Fig. 8