



US00D840613S

(12) **United States Design Patent** (10) **Patent No.:** **US D840,613 S**  
**Chaviano** (45) **Date of Patent:** **\*\* Feb. 12, 2019**

(54) **DOG CAR TRANSPORT GRIPPER**  
(71) Applicant: **Zeida M. Chaviano**, Leonia, NJ (US)  
(72) Inventor: **Zeida M. Chaviano**, Leonia, NJ (US)  
(\*\*) Term: **15 Years**  
(21) Appl. No.: **29/620,674**  
(22) Filed: **Apr. 18, 2017**  
(51) **LOC (11) Cl.** ..... **30-99**  
(52) **U.S. Cl.**  
USPC ..... **D30/199**; D12/421; D12/400  
(58) **Field of Classification Search**  
USPC ..... D30/199; D12/183, 421, 422, 191, 190,  
D12/221, 400, 415; 119/706; 296/153,  
296/39.1, 152, 1.07, 1.08, 1.09;  
297/411.21, 411.22, 228.12, 228.1,  
297/228.13, 227, 219.1; 160/123, 105;  
49/57, 50; 52/716.5, 716.7, 716.8, 718.04  
CPC ..... A01K 1/035; B60J 11/025; B60J 11/06;  
B60R 13/00; B60R 13/0243; B60R 99/00;  
B60R 2011/0021; B60N 2/78; B60N  
2/783; B60N 2/787  
See application file for complete search history.

(56) **References Cited**  
U.S. PATENT DOCUMENTS  
2,869,146 A 1/1959 Allison  
D263,646 S \* 4/1982 Railton ..... D2/952  
4,758,043 A \* 7/1988 Reynaldos ..... B60J 9/00  
296/153  
4,781,231 A \* 11/1988 Garcia ..... B60J 11/06  
224/42.11  
D329,836 S \* 9/1992 Meyers ..... D12/421  
D341,711 S \* 11/1993 Askew ..... D2/980  
D342,858 S \* 1/1994 Carty ..... D6/606  
D367,033 S \* 2/1996 Phirippidis ..... D12/400  
D381,795 S \* 8/1997 Coats ..... D2/951  
D394,414 S \* 5/1998 Catalano ..... D1/199  
D415,604 S \* 10/1999 Schleh ..... D2/869

D426,074 S \* 6/2000 Fairweather ..... D6/303  
D440,384 S \* 4/2001 Shifflett ..... D2/947  
D445,518 S \* 7/2001 Warden ..... D26/38  
D457,705 S \* 5/2002 Haslet ..... D28/63  
D467,835 S \* 12/2002 Guillory ..... D11/126  
D476,767 S \* 7/2003 Warden ..... D26/38  
D494,500 S \* 8/2004 Brown ..... D11/133  
6,926,341 B1 \* 8/2005 Adesso ..... B60R 11/00  
119/712  
7,404,589 B2 7/2008 Carter  
D725,317 S \* 3/2015 Avalos Sartorio ..... D30/121  
D727,576 S \* 4/2015 Avalos Sartorio ..... D30/121  
2007/0108797 A1 5/2007 Burleson  
2011/0080015 A1 4/2011 Spiegel et al.  
2012/0240860 A1 \* 9/2012 Suplina ..... A01K 1/0353  
119/28.5

\* cited by examiner

*Primary Examiner* — Susan Moon Lee  
(74) *Attorney, Agent, or Firm* — Suzanne Kikel, Patent Agent

(57) **CLAIM**

The ornamental design for a dog car transport gripper, as shown and described.

**DESCRIPTION**

FIG. 1 is a front perspective view of a dog car transport gripper, showing my new design and its attachment to a car door arm rest.  
FIG. 2 is an enlarged front perspective view of the dog car transport gripper of FIG. 1.  
FIG. 3 is a rear elevational view thereof.  
FIG. 4 is a left side elevational thereof.  
FIG. 5 is a right side elevational view thereof.  
FIG. 6 is a bottom view thereof; and,  
FIG. 7 is a top view thereof.  
The broken lines showing of a car door arm rest in FIG. 1 depicts environmental subject matter and forms no part of the claimed design.

**1 Claim, 5 Drawing Sheets**

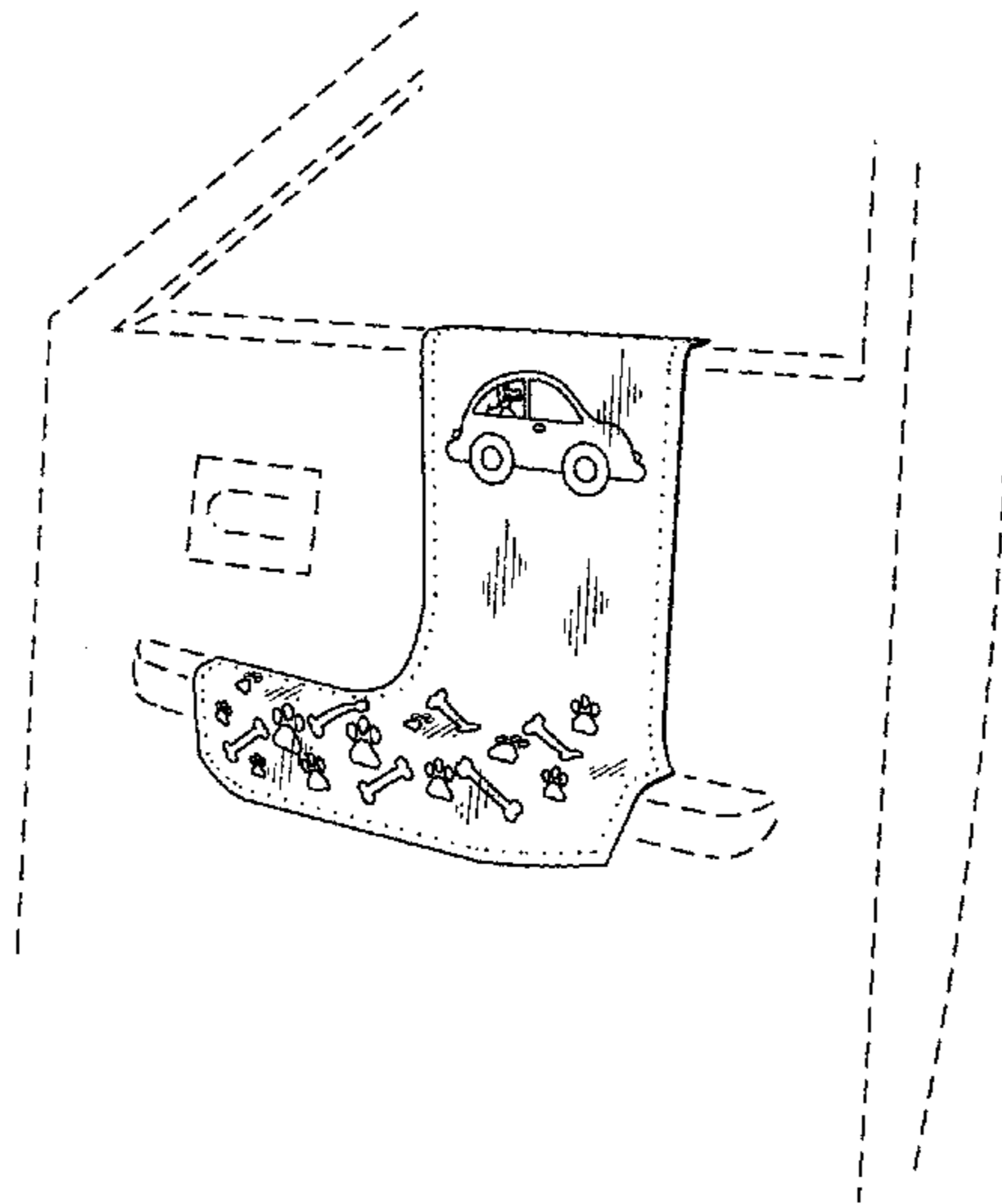

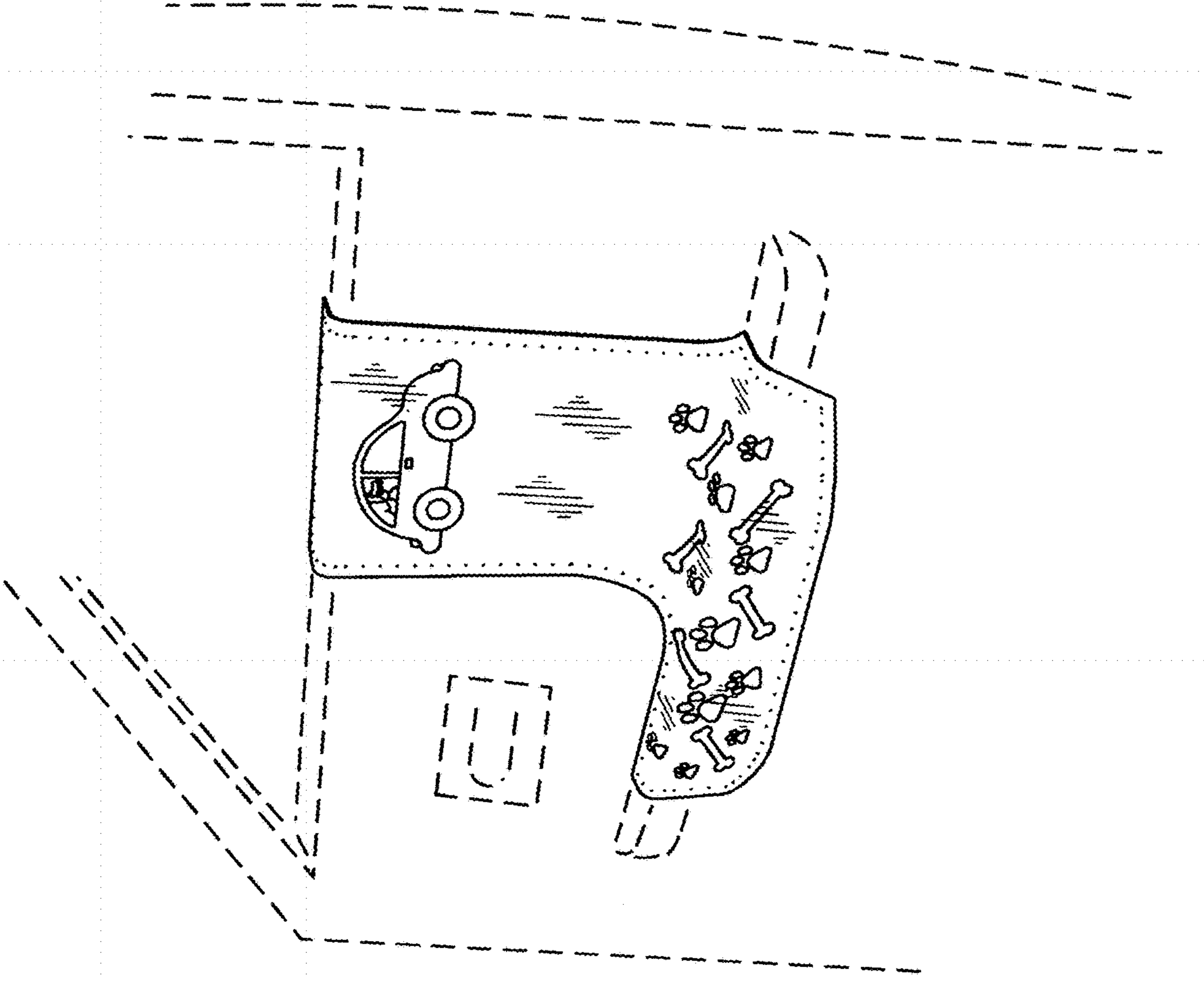

FIG. 1

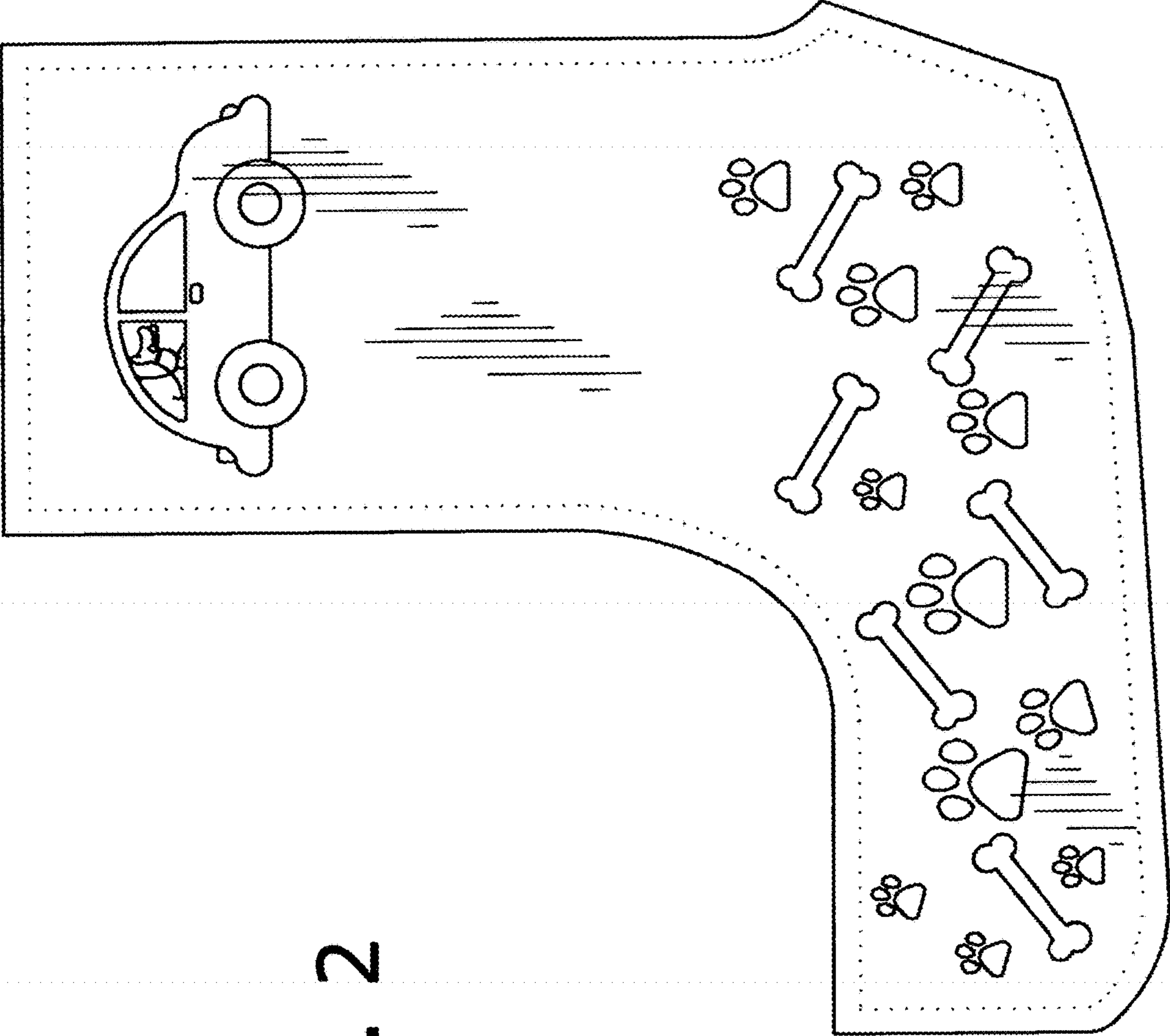

FIG. 2

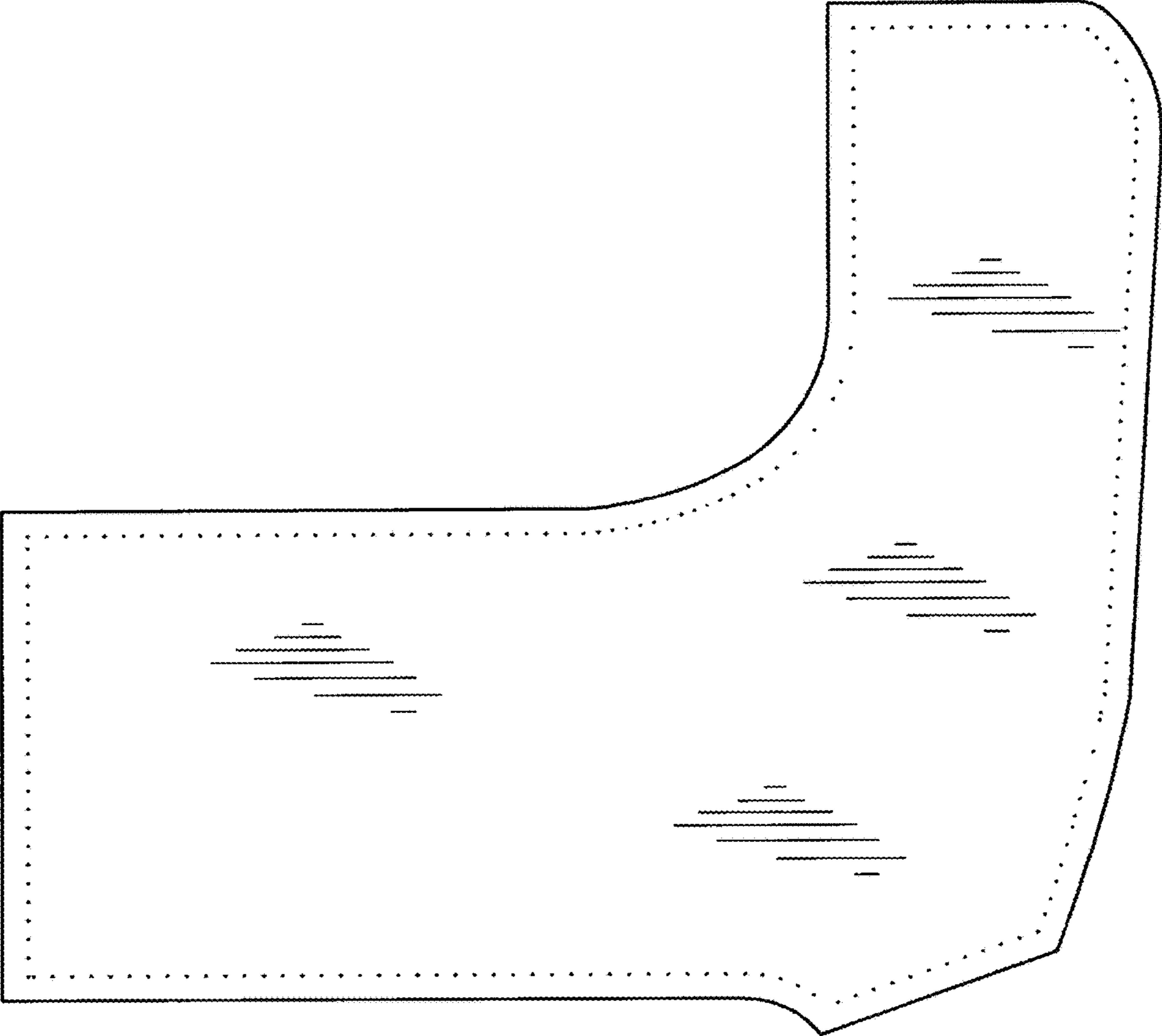

FIG. 3

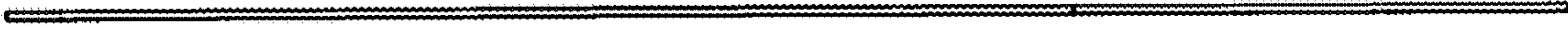

FIG. 5

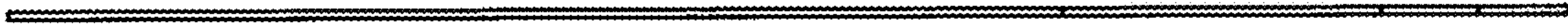

FIG. 4



**FIG. 6**



**FIG. 7**