



US00D839393S

(12) **United States Design Patent**
Schaubach

(10) **Patent No.:** **US D839,393 S**
(45) **Date of Patent:** **** Jan. 29, 2019**

- (54) **SPOUT**
- (71) Applicant: **Spectrum Brands, Inc.**, Middleton, WI (US)
- (72) Inventor: **Lauren Schaubach**, Costa Mesa, CA (US)
- (73) Assignee: **Spectrum Brands, Inc.**, Middleton, WI (US)
- (**) Term: **15 Years**
- (21) Appl. No.: **29/625,820**
- (22) Filed: **Nov. 13, 2017**
- (51) **LOC (11) Cl.** **23-01**
- (52) **U.S. Cl.**
USPC **D23/255**
- (58) **Field of Classification Search**
USPC D23/238-242, 249, 255, 257
CPC Y10T 137/9464
See application file for complete search history.

- D790,667 S 6/2017 Schaubach et al.
- D790,670 S 6/2017 Downey
- D791,285 S 7/2017 Schaubach
- D791,286 S * 7/2017 Downey D23/257
- D800,275 S * 10/2017 Andrew D23/257

* cited by examiner

Primary Examiner — Robert A Delehanty
(74) *Attorney, Agent, or Firm* — Banner & Witcoff, Ltd.

(57) **CLAIM**

The ornamental design for a spout, as shown and described.

DESCRIPTION

FIG. 1 is a front perspective view of a spout showing my new design;
FIG. 2 is a front view thereof;
FIG. 3 is a rear view thereof;
FIG. 4 is a left side view thereof;
FIG. 5 is a right side view thereof;
FIG. 6 is a top view thereof; and,
FIG. 7 is a bottom view thereof.

The broken lines immediately adjacent to the photographic area define the bounds of the claimed design and form no part thereof. The broken line showing of the unshaded elements of the tub filler represents unclaimed subject matter and forms no part of the claimed design.

(56) **References Cited**

U.S. PATENT DOCUMENTS

- D720,433 S 12/2014 Fritz
- D750,756 S * 3/2016 Flowers D23/255

1 Claim, 7 Drawing Sheets

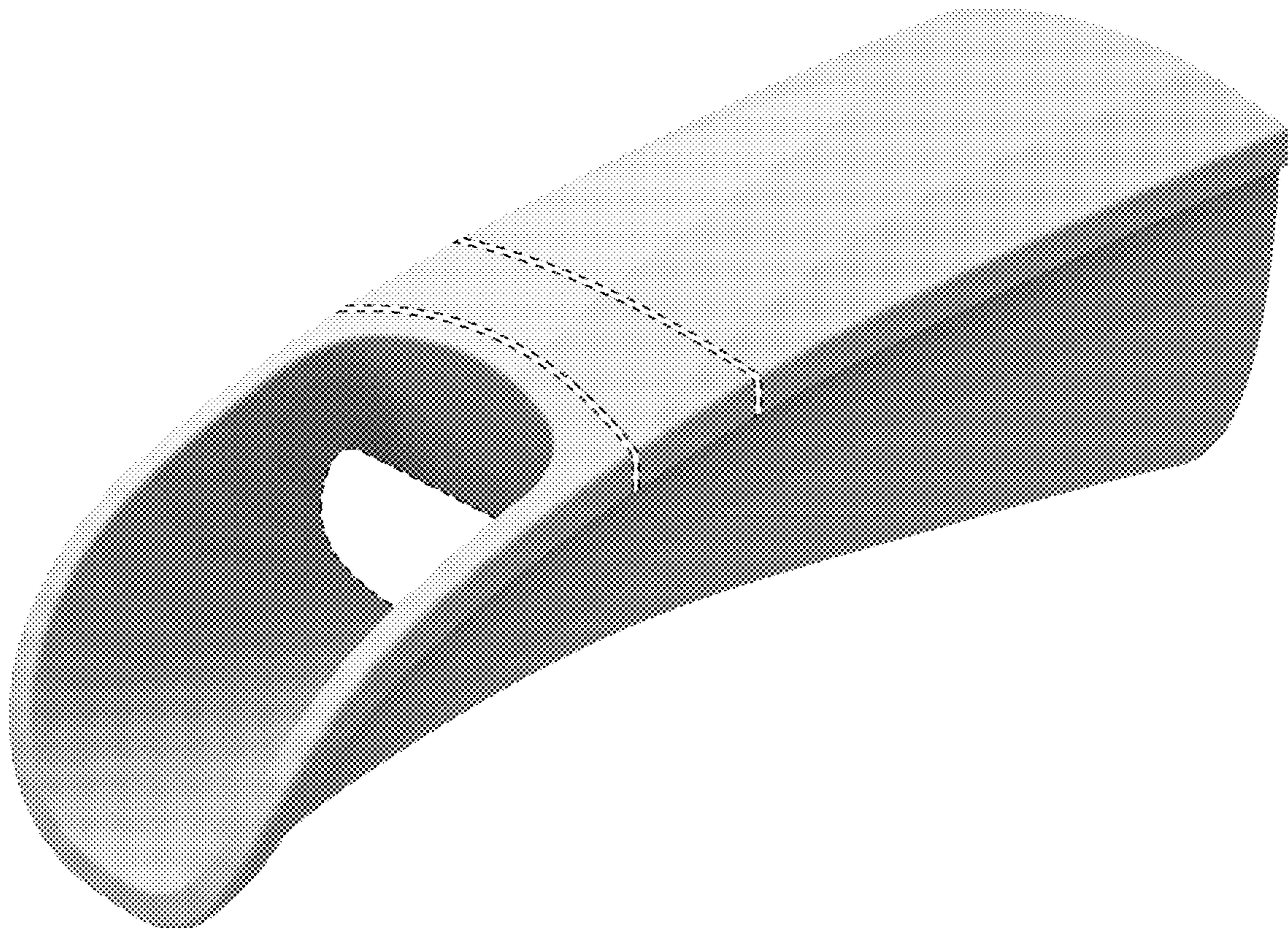

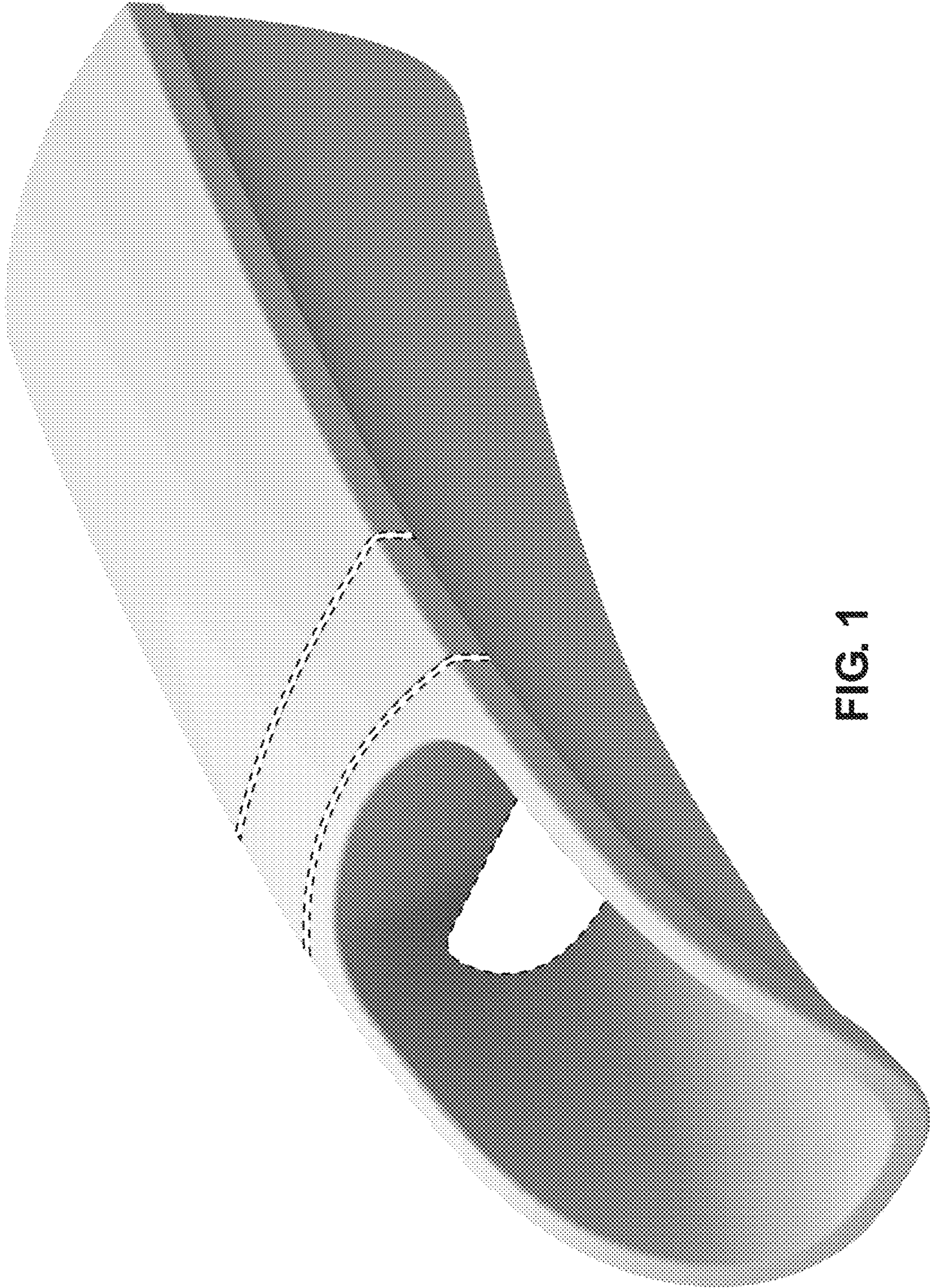

FIG. 1

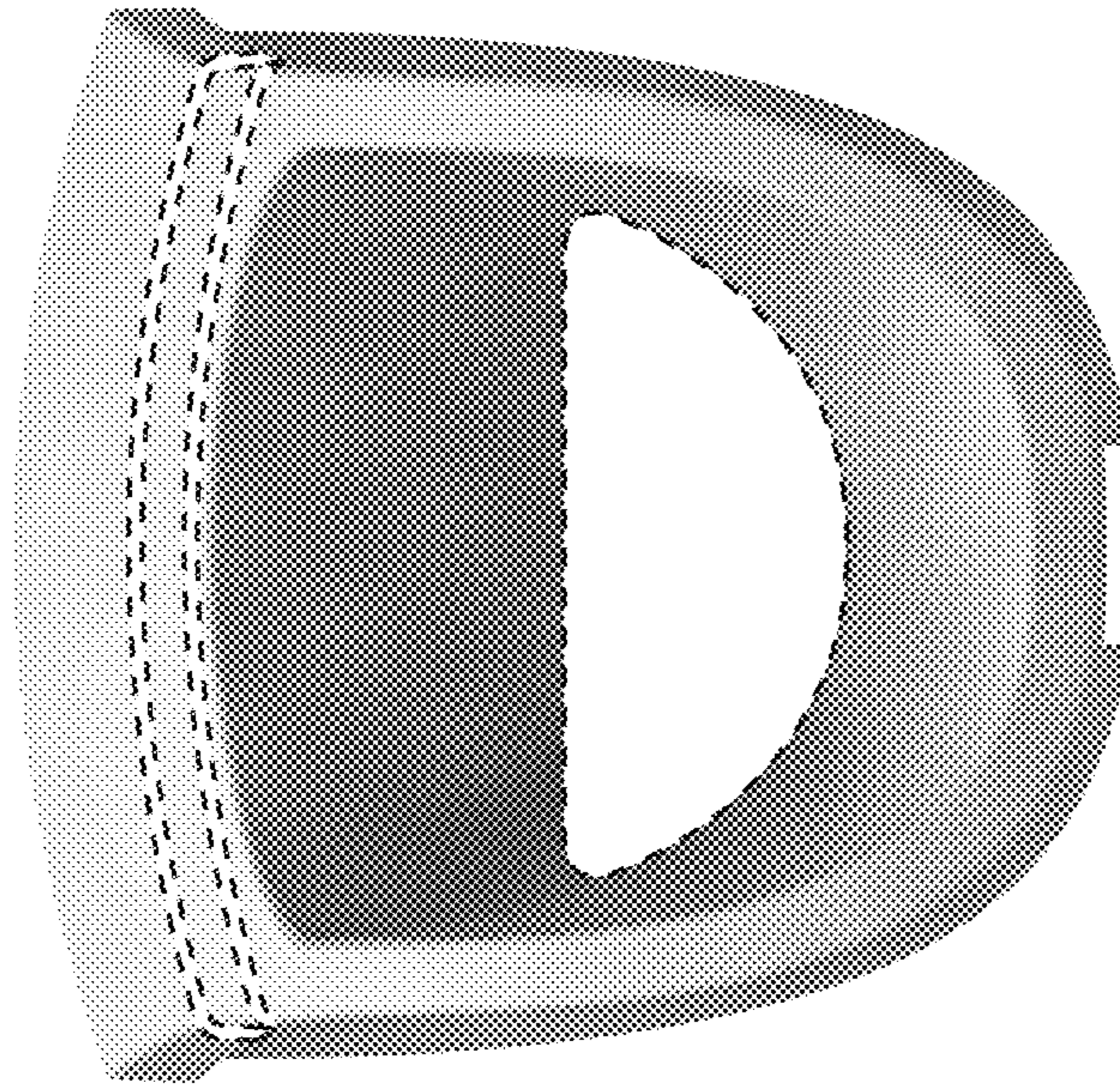

FIG. 2

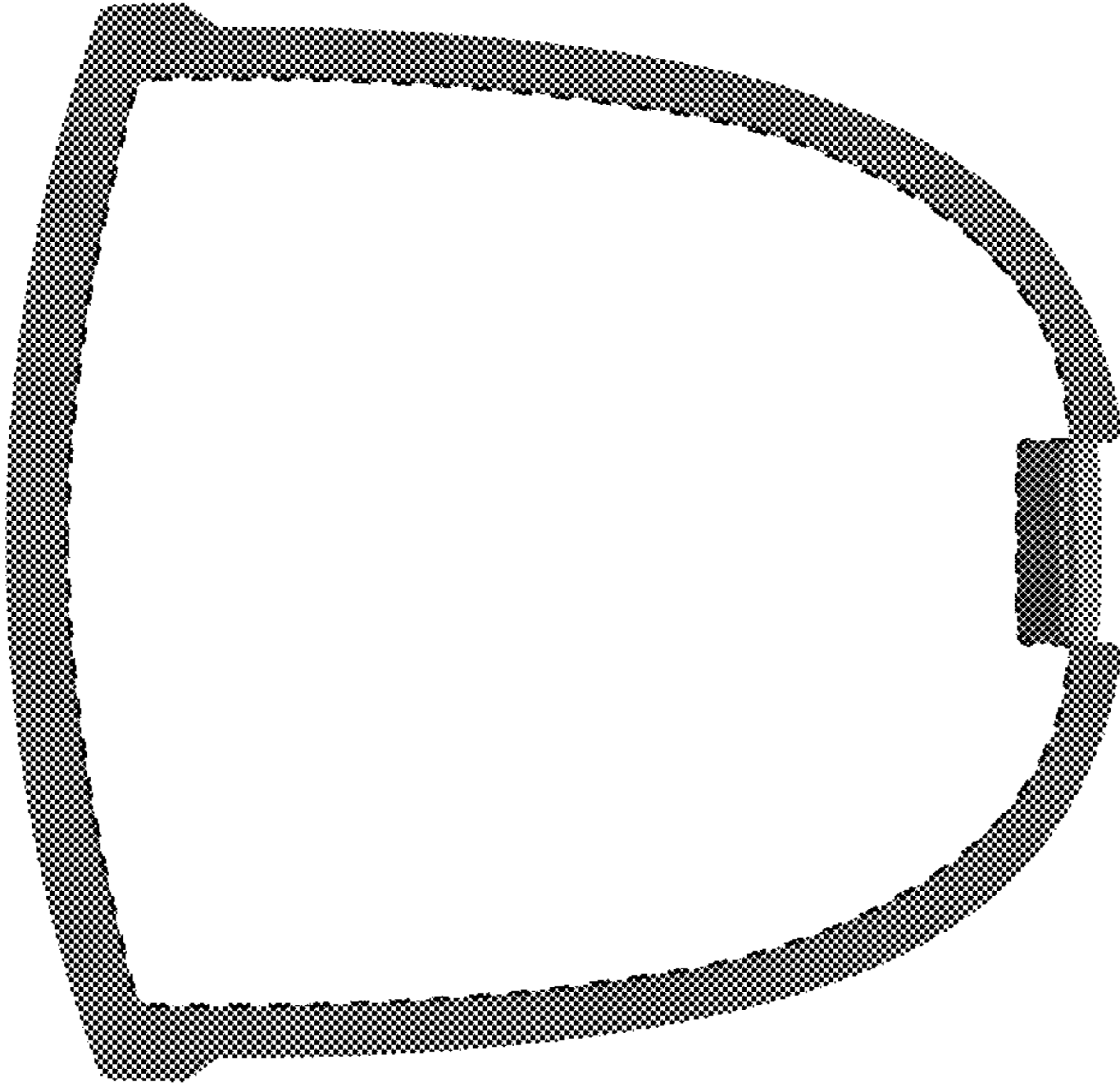

FIG. 3

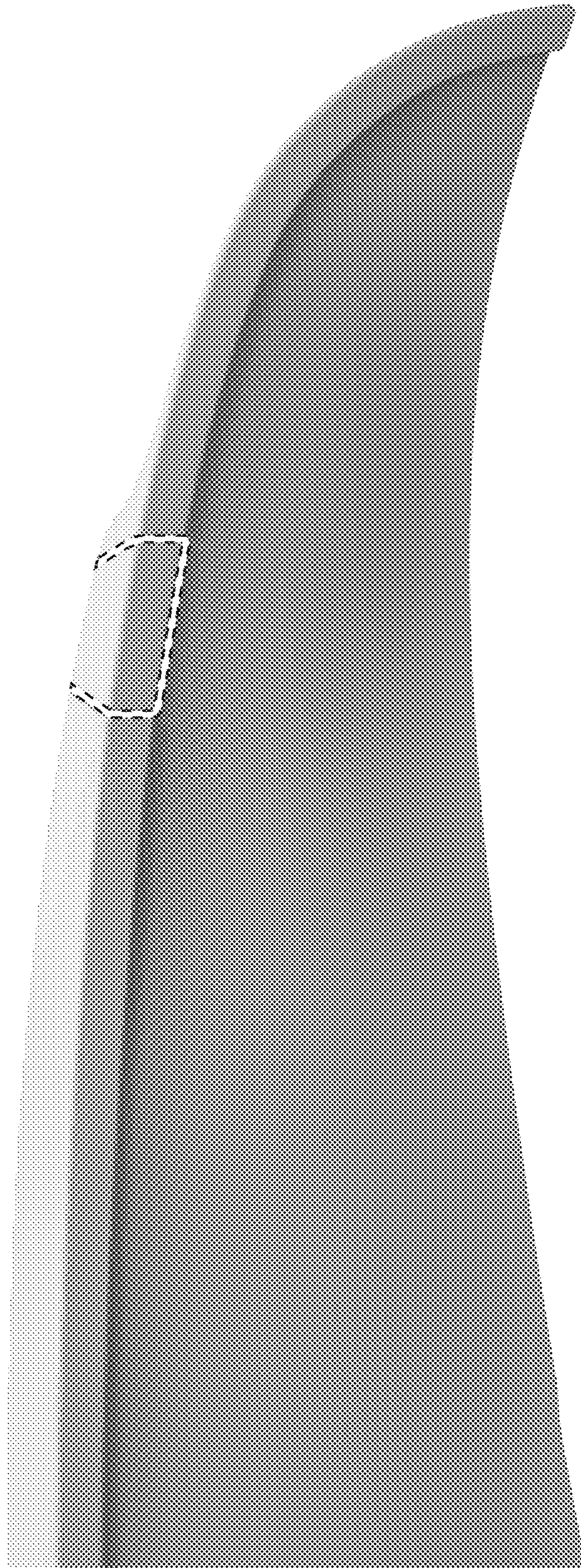

FIG. 4

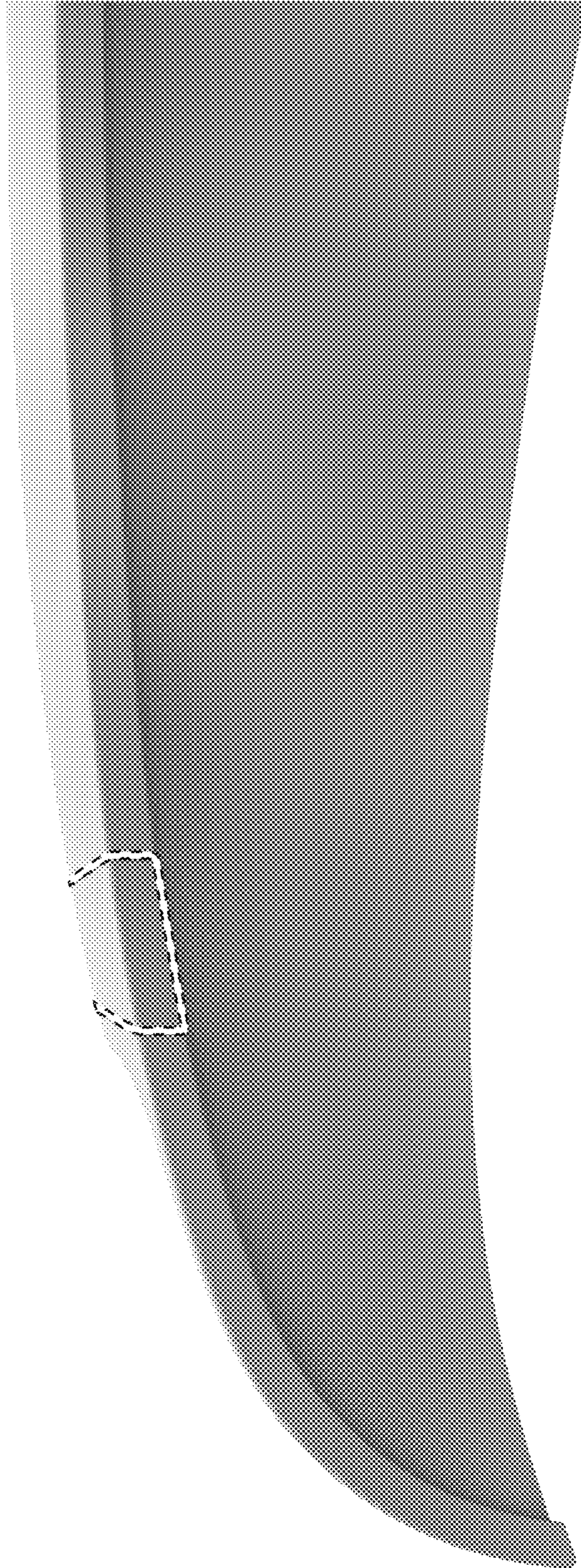

FIG. 5

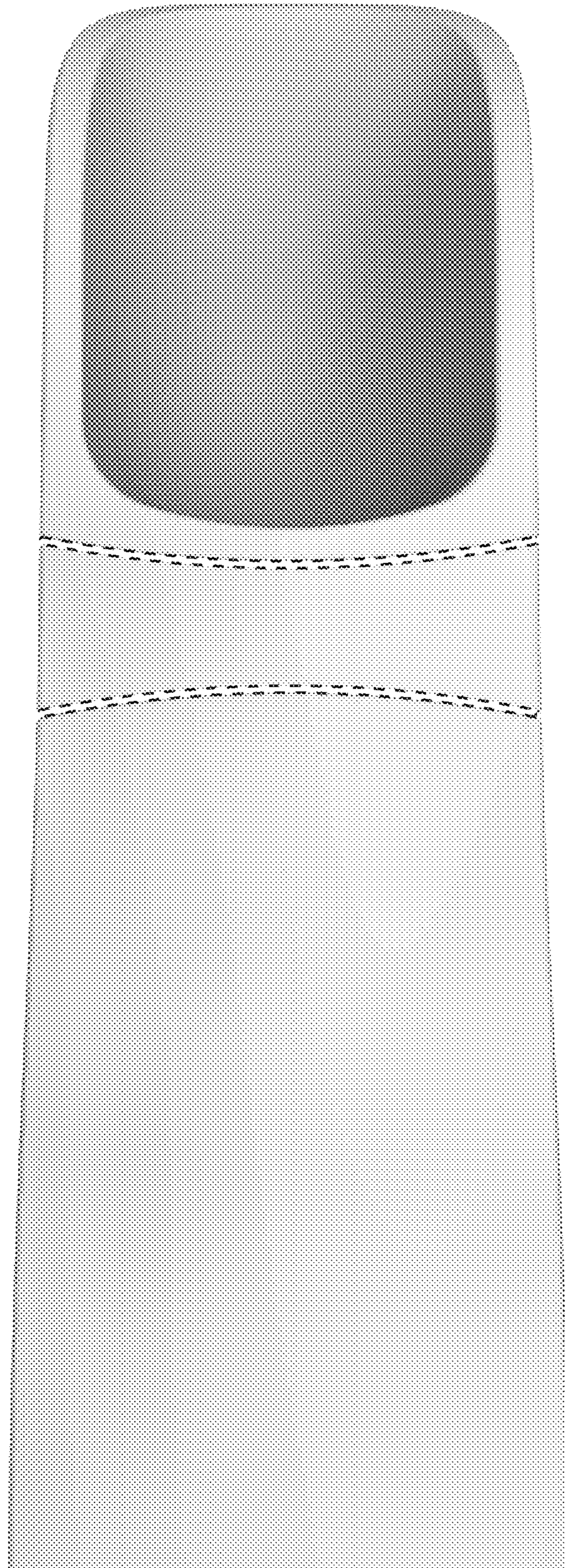

FIG. 6

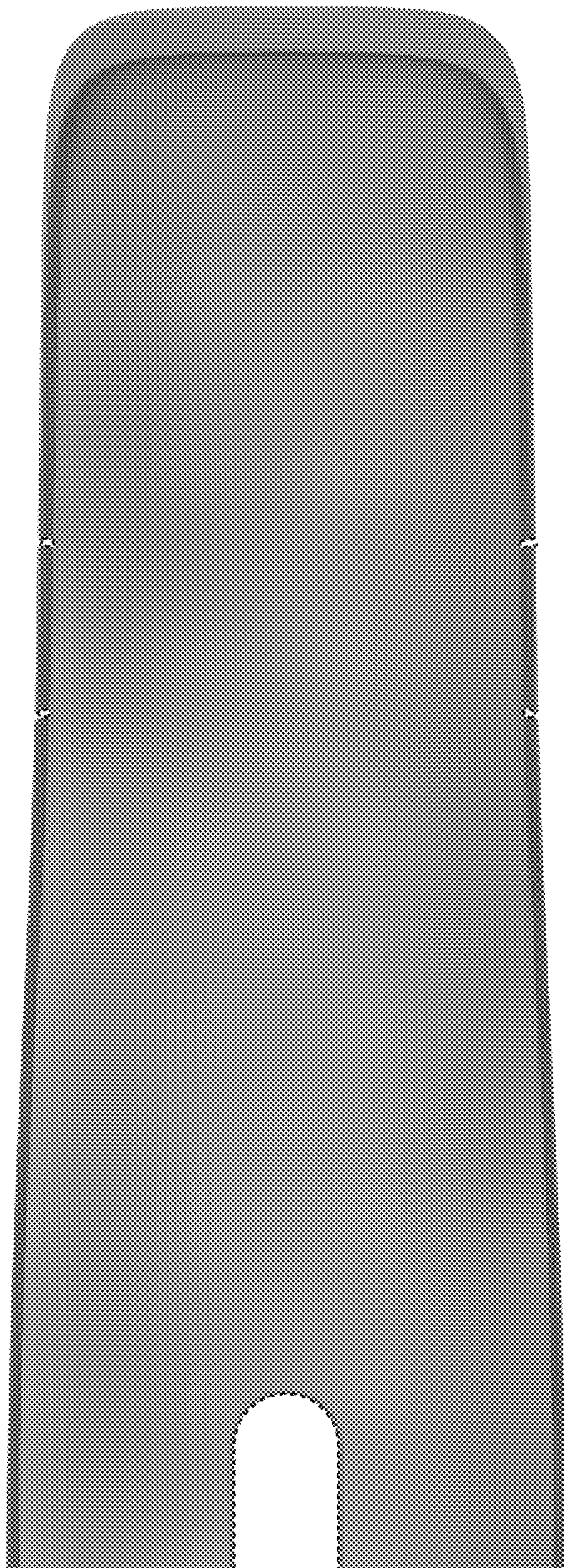

FIG. 7