



US00D837947S

(12) **United States Design Patent**
Schaubach et al.

(10) **Patent No.:** **US D837,947 S**
(45) **Date of Patent:** **** Jan. 8, 2019**

- (54) **SPOUT**
- (71) Applicant: **Spectrum Brands, Inc.**, Middleton, WI (US)
- (72) Inventors: **Lauren Schaubach**, Costa Mesa, CA (US); **Selia Ke**, Fujian (CN)
- (73) Assignee: **Spectrum Brands, Inc.**, Middleton, WI (US)
- (**) Term: **15 Years**
- (21) Appl. No.: **29/630,880**
- (22) Filed: **Dec. 22, 2017**
- (51) **LOC (11) Cl.** **23-01**
- (52) **U.S. Cl.**
USPC **D23/255**
- (58) **Field of Classification Search**
USPC D23/238-242, 249, 255, 257
CPC Y10T 137/9464
See application file for complete search history.

- D679,367 S 4/2013 Kwok
- D712,519 S 9/2014 Lu
- D720,433 S * 12/2014 Fritz D23/255
- D790,667 S 6/2017 Schaubach et al.
- D791,281 S 7/2017 Schaubach et al.
- D791,283 S 7/2017 Schaubach
- D798,421 S * 9/2017 Eads D23/257

* cited by examiner

Primary Examiner — Robert A Delehanty
(74) *Attorney, Agent, or Firm* — Banner & Witcoff, Ltd.

(57) **CLAIM**

The ornamental design for a spout, as shown and described.

DESCRIPTION

FIG. 1 is a front perspective view of a spout showing our new design;
 FIG. 2 is a front view thereof;
 FIG. 3 is a rear view thereof;
 FIG. 4 is a left side view thereof;
 FIG. 5 is a right side view thereof;
 FIG. 6 is a top view thereof; and,
 FIG. 7 is a bottom view thereof.
 The broken lines immediately adjacent to the photographic area define the bounds of the claimed design and form no part thereof.

(56) **References Cited**

U.S. PATENT DOCUMENTS

- D529,992 S 10/2006 Lammel
- D678,985 S * 3/2013 Berger D23/255

1 Claim, 7 Drawing Sheets

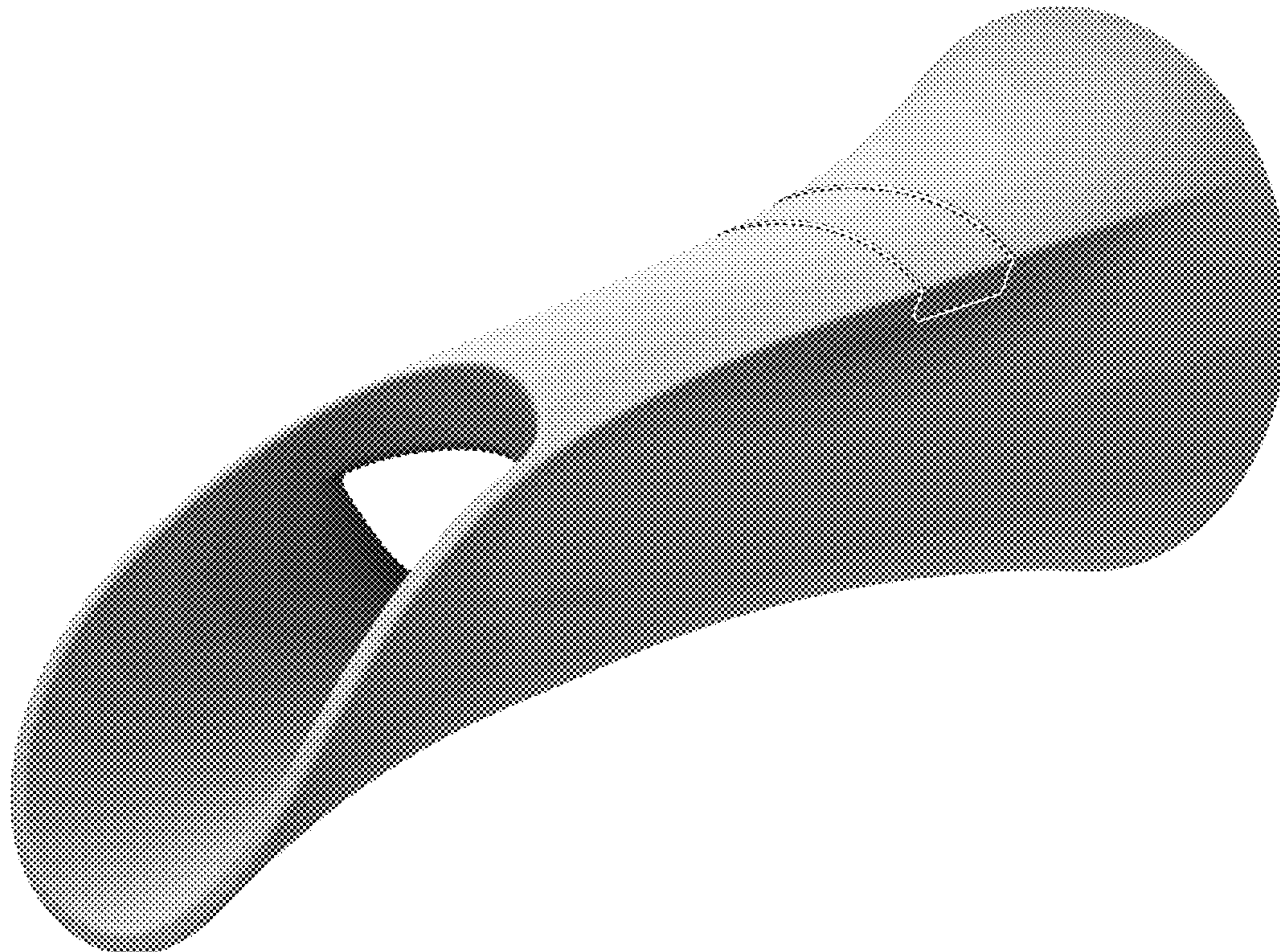

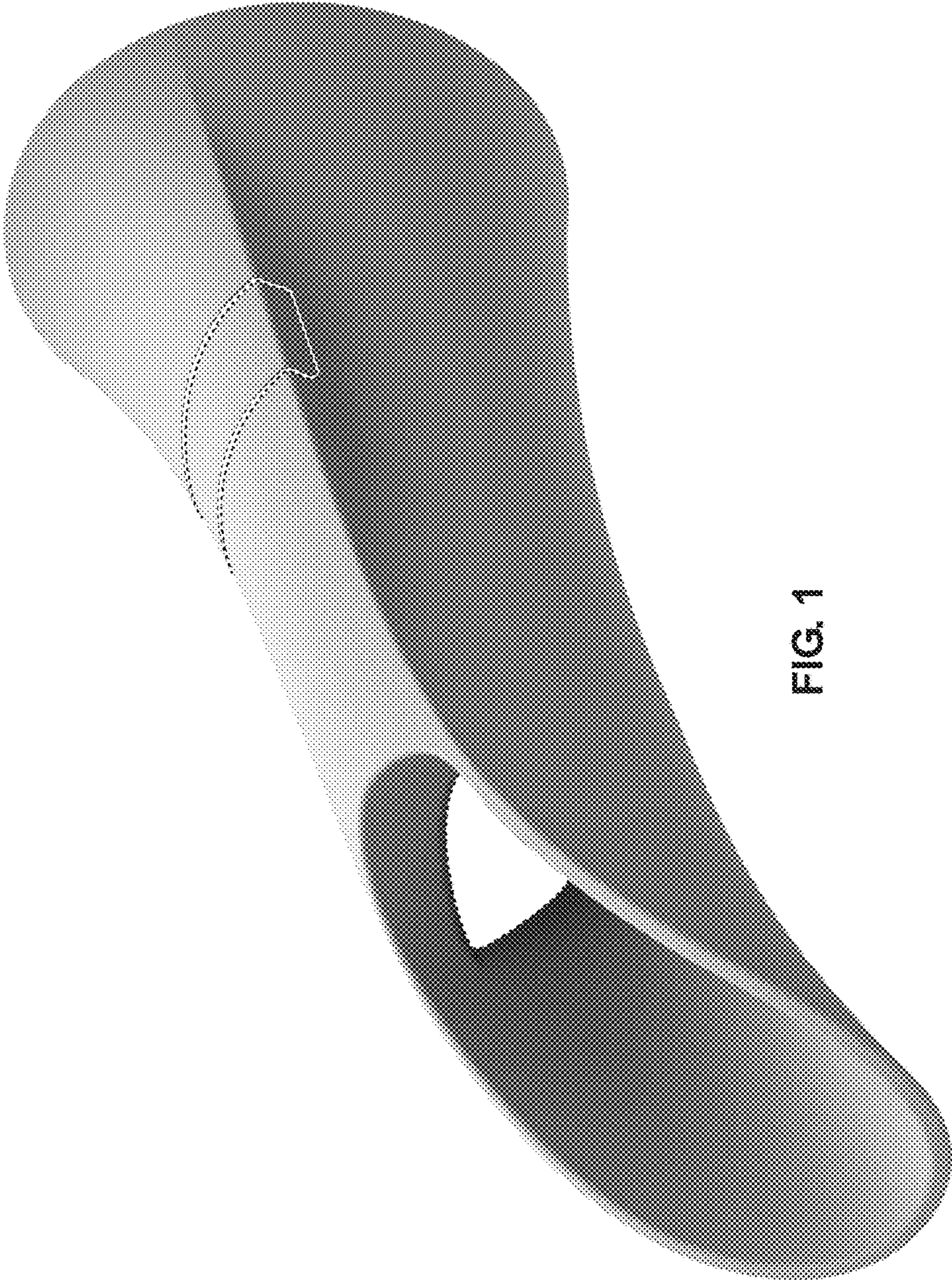

FIG. 1

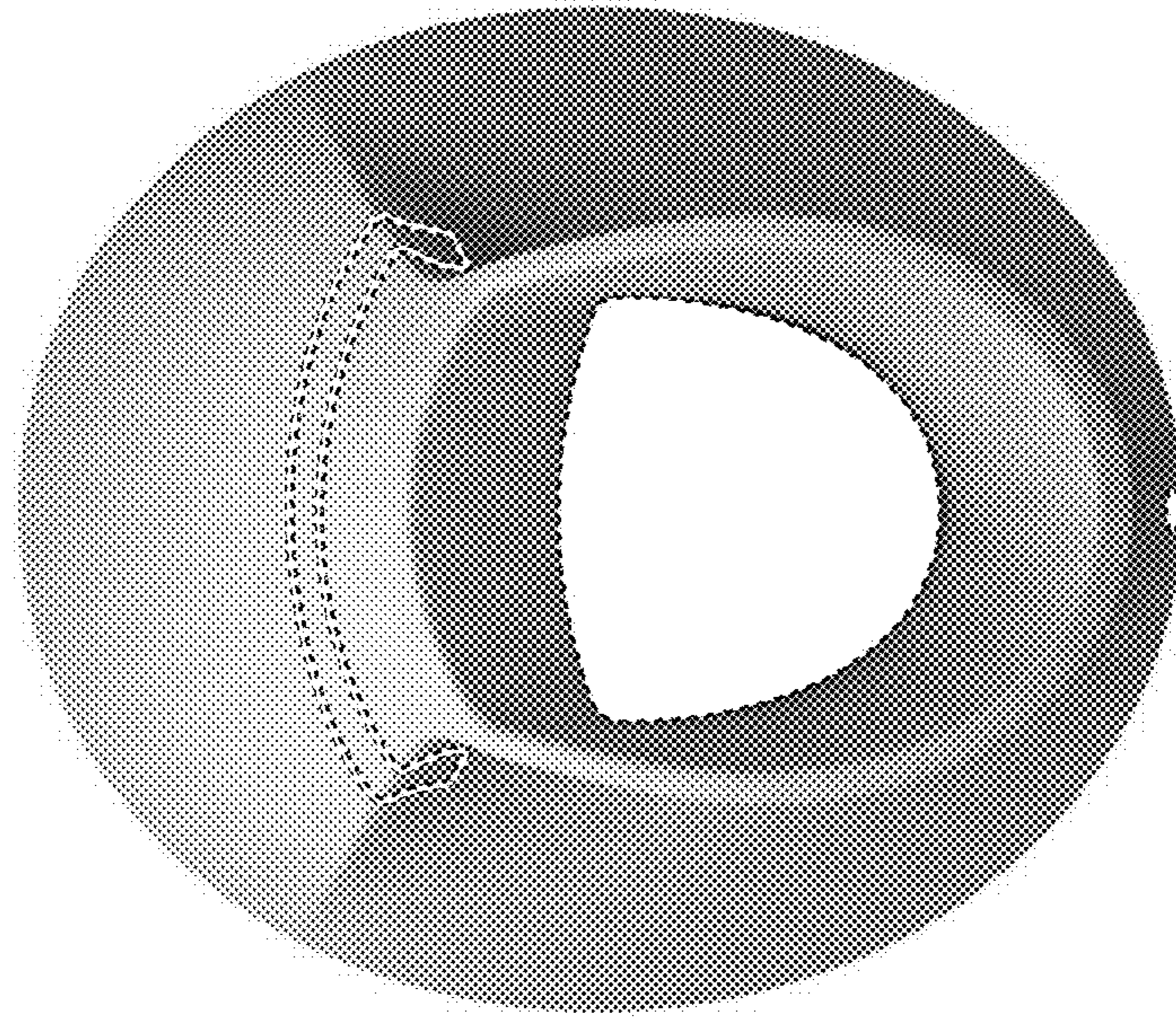

FIG. 2

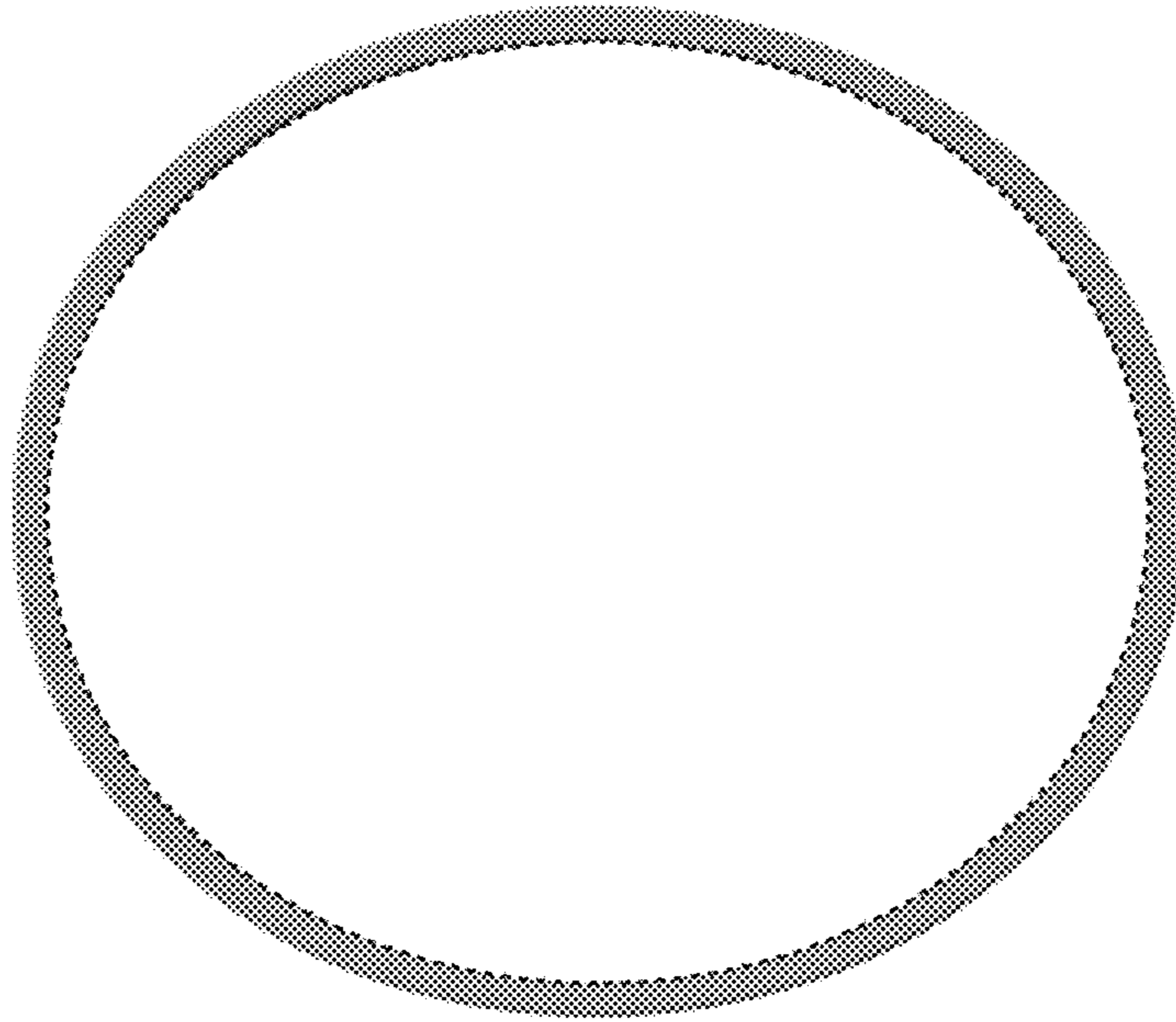

FIG. 3

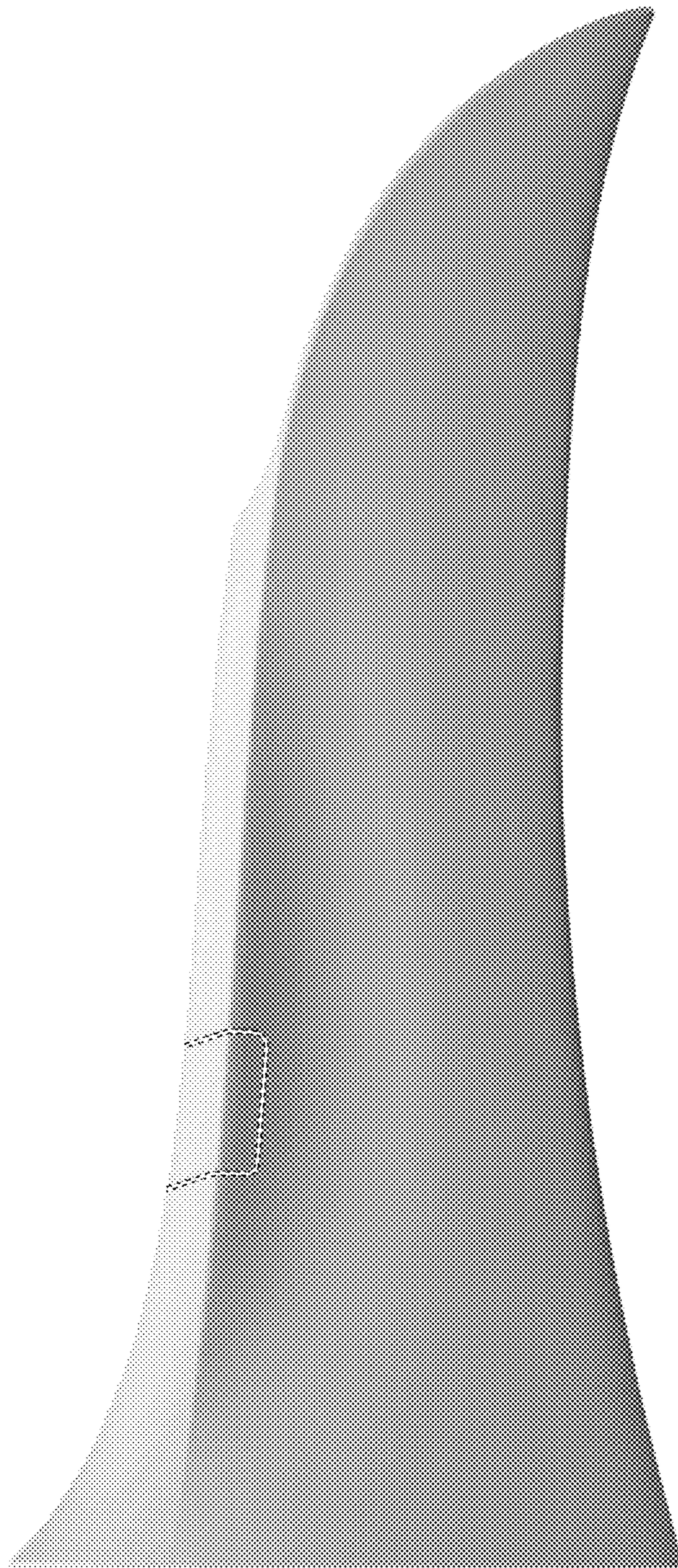

FIG. 4

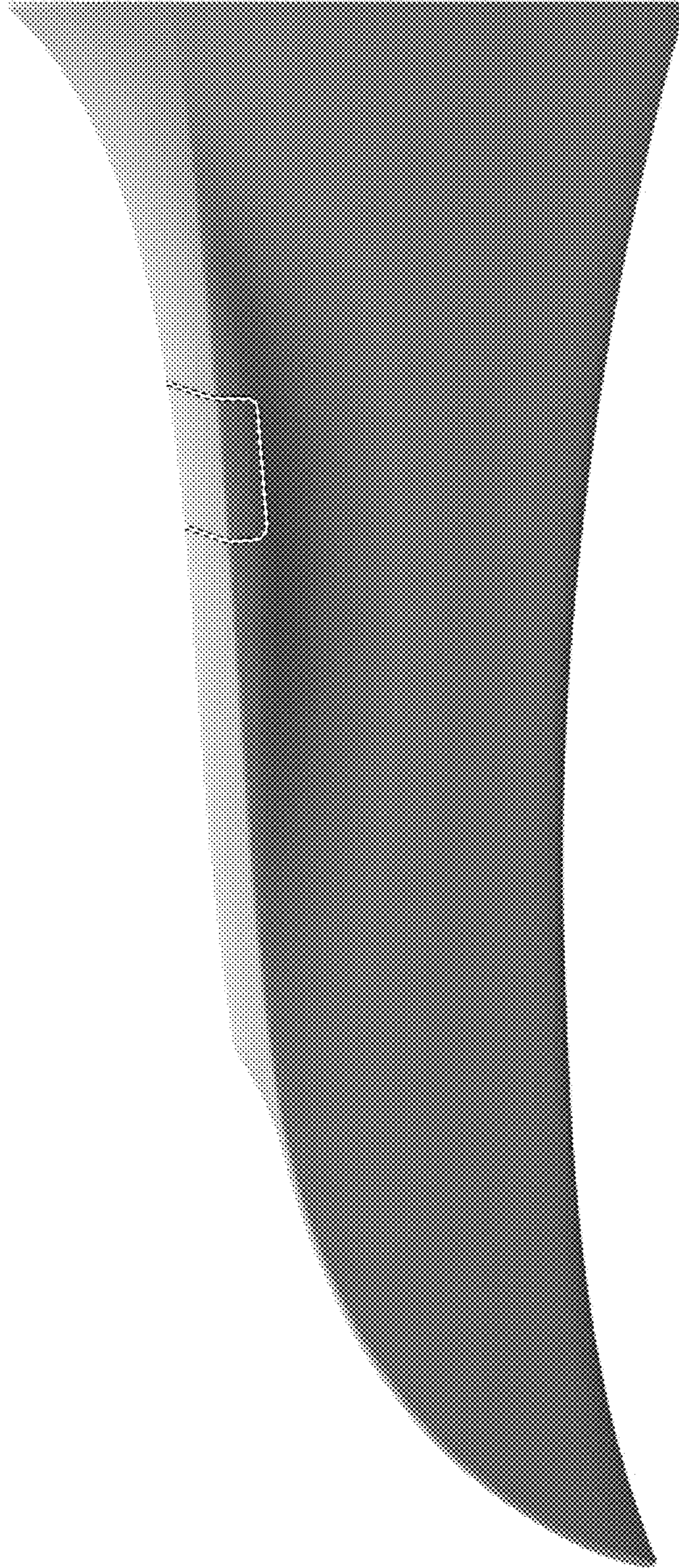

FIG. 5

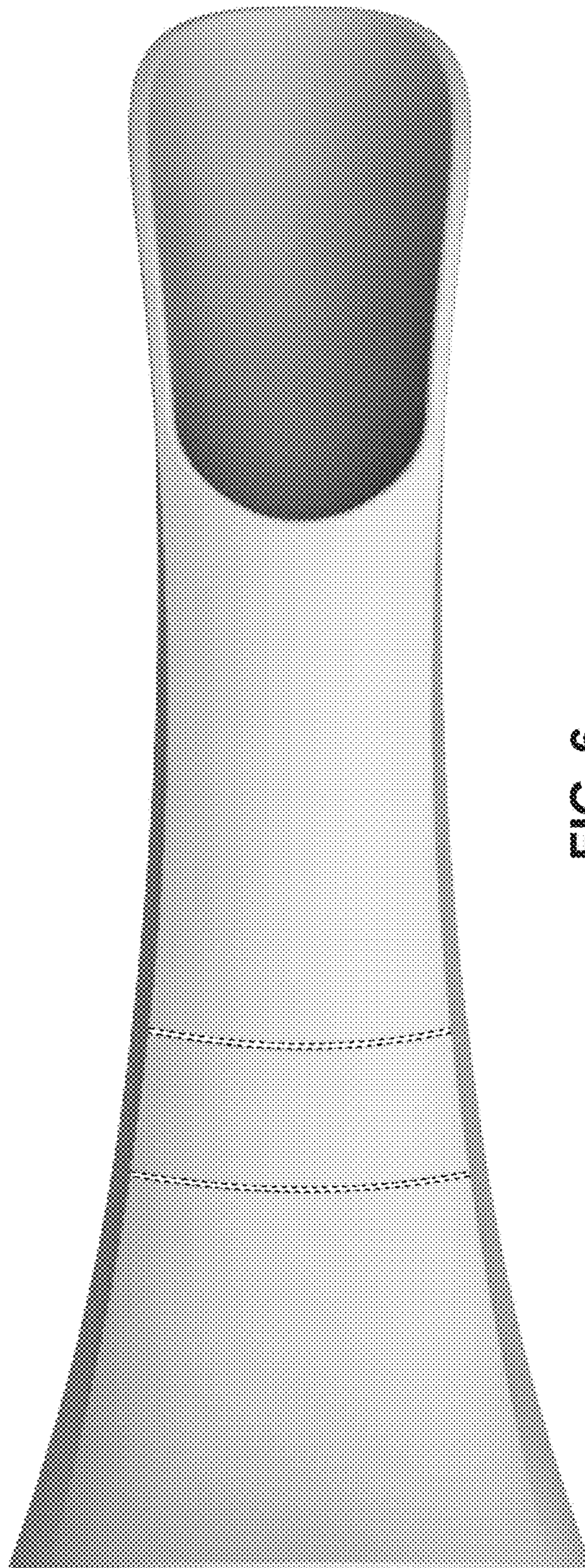

FIG. 6

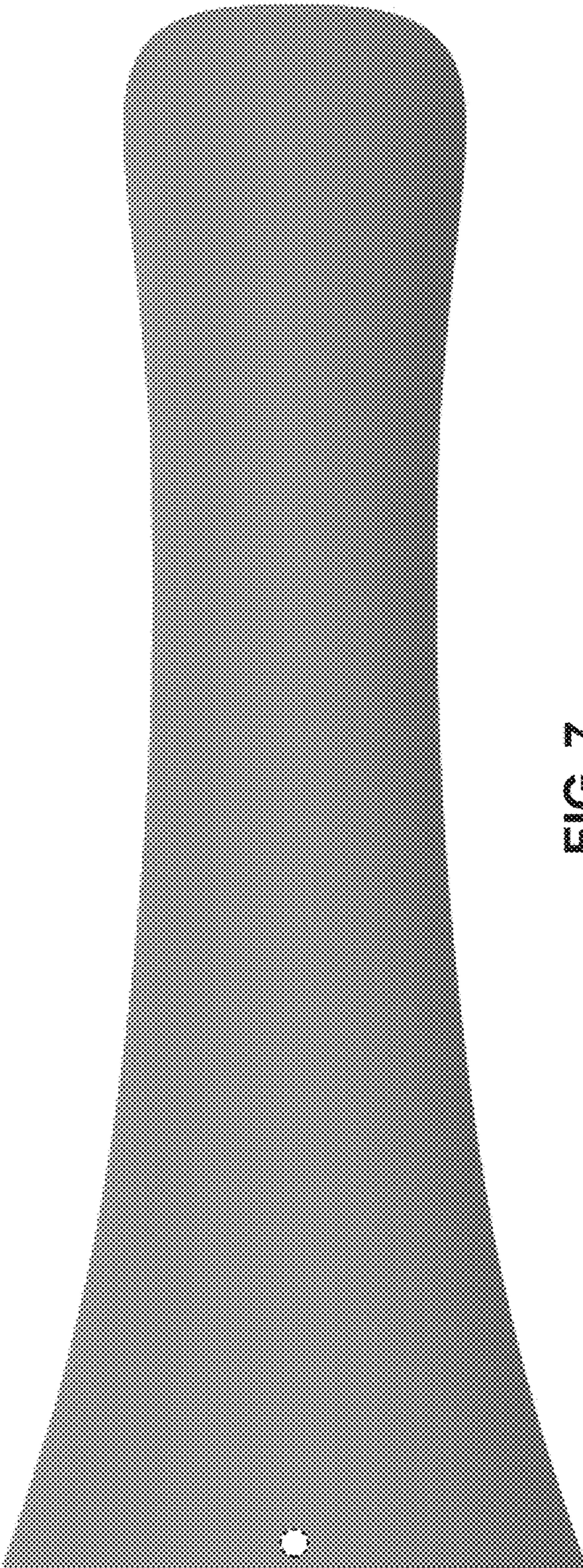

FIG. 7