



US00D836691S

(12) **United States Design Patent** (10) **Patent No.:** **US D836,691 S**
Jeong et al. (45) **Date of Patent:** **** Dec. 25, 2018**

(54) **VISION MODULE FOR INDUSTRIAL ROBOT**

(71) Applicant: **Hanwha Techwin Co., Ltd.**,
Changwon-si (KR)

(72) Inventors: **Kwang Seok Jeong**, Changwon-si
(KR); **Mun Jun Park**, Changwon-si
(KR)

(73) Assignee: **Hanwha Techwin Co., Ltd.**,
Changwon-si (KR)

(**) Term: **15 Years**

(21) Appl. No.: **29/628,879**

(22) Filed: **Dec. 8, 2017**

(30) **Foreign Application Priority Data**

Aug. 28, 2017 (KR) 30-2017-0040037

(51) **LOC (11) Cl.** **15-09**

(52) **U.S. Cl.**
USPC **D15/199**; D16/203

(58) **Field of Classification Search**
USPC D15/199; D16/203; D21/578-583, 621,
D21/622
CPC B25J 13/00; B25J 13/003; B25J 19/023;
G06T 1/0014; G10L 2021/02087
See application file for complete search history.

(56) **References Cited**

U.S. PATENT DOCUMENTS

D248,688 S *	7/1978	Vernon, Jr.	D21/578
D381,997 S *	8/1997	Morooka	D16/202
D387,789 S *	12/1997	Sumida	D16/202
D390,244 S *	2/1998	Yamakawa	D16/202
D392,299 S *	3/1998	Lin	D16/202
D394,274 S *	5/1998	Suzuki	D16/202
D399,860 S *	10/1998	Huang	D16/202
D410,479 S *	6/1999	Sawai	D16/202

D424,086 S *	5/2000	Choi	D16/202
D440,244 S *	4/2001	Prather	D16/202
D446,234 S *	8/2001	Shih	D16/202
D455,165 S *	4/2002	Tsang	D16/202
D467,952 S *	12/2002	Nakamura	D16/202
D468,759 S *	1/2003	Lin	D16/202
D478,108 S *	8/2003	Miyazaki	D16/202
D478,922 S *	8/2003	Han	D16/202

(Continued)

FOREIGN PATENT DOCUMENTS

JP	D1431473 S	1/2012
KR	30-0440614-1 S	2/2007
KR	30-0440614 S	2/2007

Primary Examiner — Patricia A Palasik

(74) *Attorney, Agent, or Firm* — Sughrue Mion, PLLC

(57) **CLAIM**

The ornamental design for a vision module for industrial robot, as shown and described.

DESCRIPTION

FIG. 1 is a front perspective view of the vision module for industrial robot showing our new design;
 FIG. 2 is a front elevational view of the vision module for industrial robot of;
 FIG. 3 is a rear elevational view of the vision module for industrial robot;
 FIG. 4 is a right side elevational view of the vision module for industrial robot;
 FIG. 5 is a left side elevational view of the vision module for industrial robot;
 FIG. 6 is a top plan view of the vision module for industrial robot; and,
 FIG. 7 is a bottom plan view of the vision module for industrial robot.

The broken line portions in the drawings are shown to illustrate environment only and form no part of the claimed design.

1 Claim, 6 Drawing Sheets

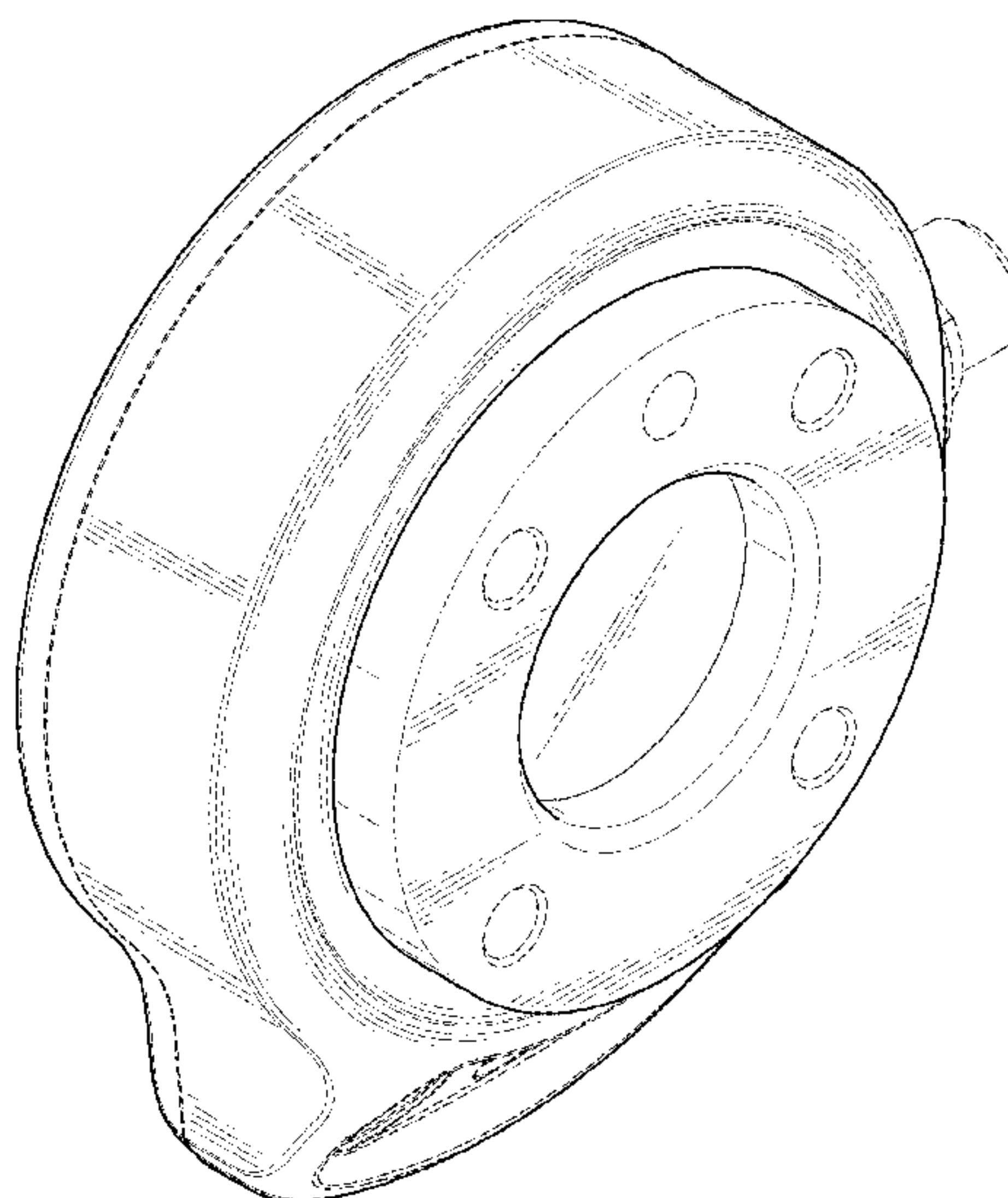

(56)

References Cited

U.S. PATENT DOCUMENTS

D486,509 S * 2/2004 Suzuki D16/202
 D502,196 S * 2/2005 Miyazaki D16/202
 D511,181 S * 11/2005 Huang D16/202
 D523,811 S 6/2006 Pinson
 D545,860 S * 7/2007 Miyazaki D16/202
 D552,650 S * 10/2007 Yamakawa D16/203
 D556,803 S * 12/2007 Ishida D16/202
 D561,798 S * 2/2008 Wen D16/202
 D565,070 S * 3/2008 Kim D16/202
 D574,870 S * 8/2008 Takahashi D16/202
 D579,474 S * 10/2008 Yoo D16/203
 D608,811 S * 1/2010 Frank D16/203
 D637,173 S * 5/2011 Elkerbout D14/159
 D650,410 S * 12/2011 Helaoui D16/203
 D694,305 S * 11/2013 Katori D16/203
 D702,576 S 4/2014 McKinney et al.
 D708,654 S * 7/2014 Tani D16/203
 D728,654 S * 5/2015 Lee D16/202
 D729,859 S * 5/2015 Shin D16/203

D730,966 S * 6/2015 Liu D16/202
 D741,389 S * 10/2015 Park D16/203
 D746,887 S * 1/2016 Deng D16/202
 D753,204 S * 4/2016 Luo D16/202
 D754,662 S * 4/2016 Volta D14/420
 D769,875 S * 10/2016 Volta D14/420
 D786,329 S * 5/2017 Kamei D16/202
 D790,620 S * 6/2017 Lee D16/202
 D798,931 S * 10/2017 Kim D16/203
 D805,570 S * 12/2017 Shi D16/202
 D808,099 S * 1/2018 Yoo D32/23
 D810,168 S * 2/2018 Shi D16/202
 D813,926 S * 3/2018 Shin D16/203
 D814,542 S * 4/2018 Iijima D15/199
 D817,374 S * 5/2018 Liu D15/199
 D819,106 S * 5/2018 Elmieh D16/202
 2010/0245569 A1 * 9/2010 Hakoishi G08B 13/19619
 348/143
 2015/0224640 A1 * 8/2015 Vu B25J 5/007
 700/259
 2017/0195533 A1 * 7/2017 Seo H04N 5/23238

* cited by examiner

FIG. 1

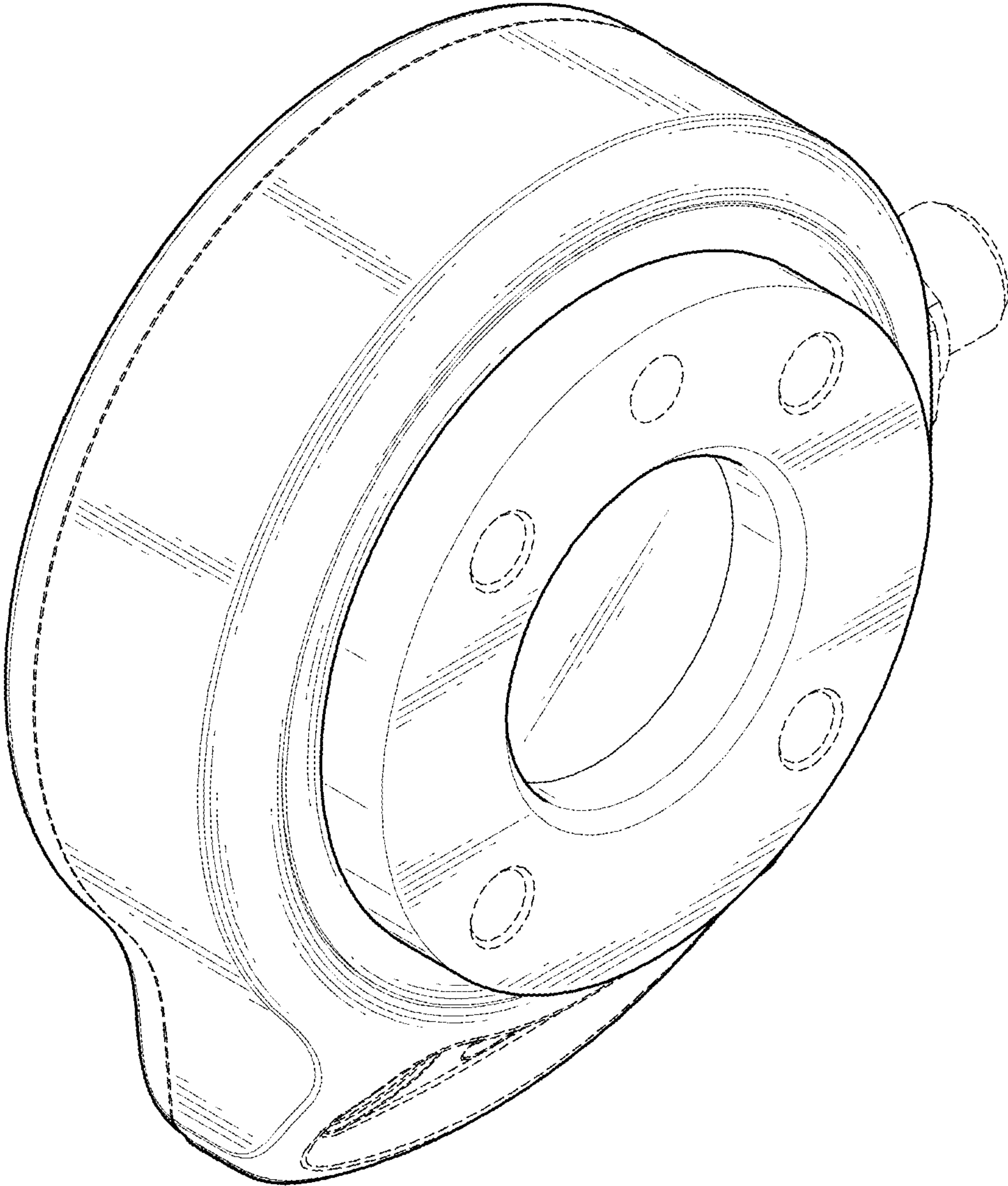

FIG. 2

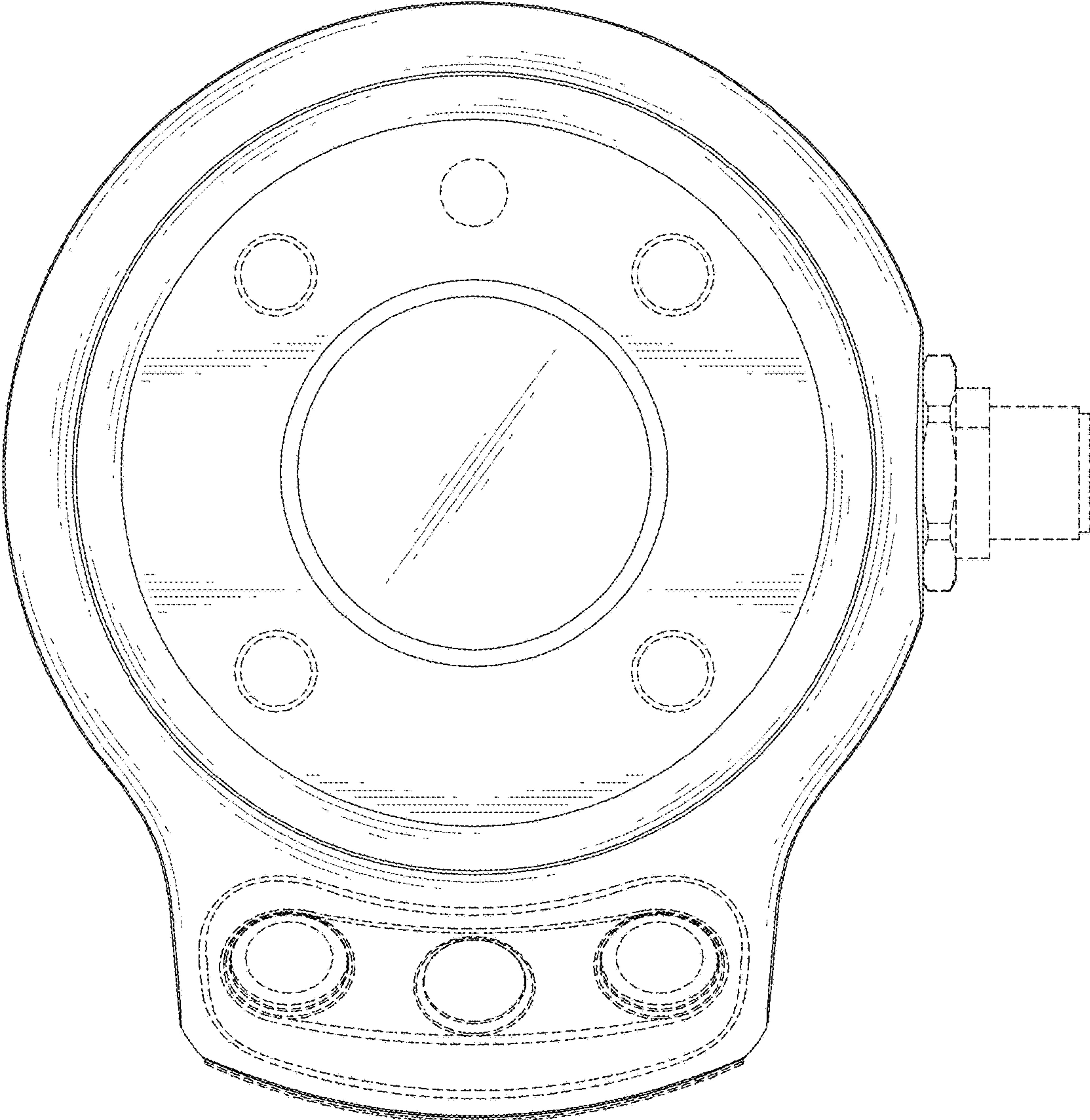

FIG. 3

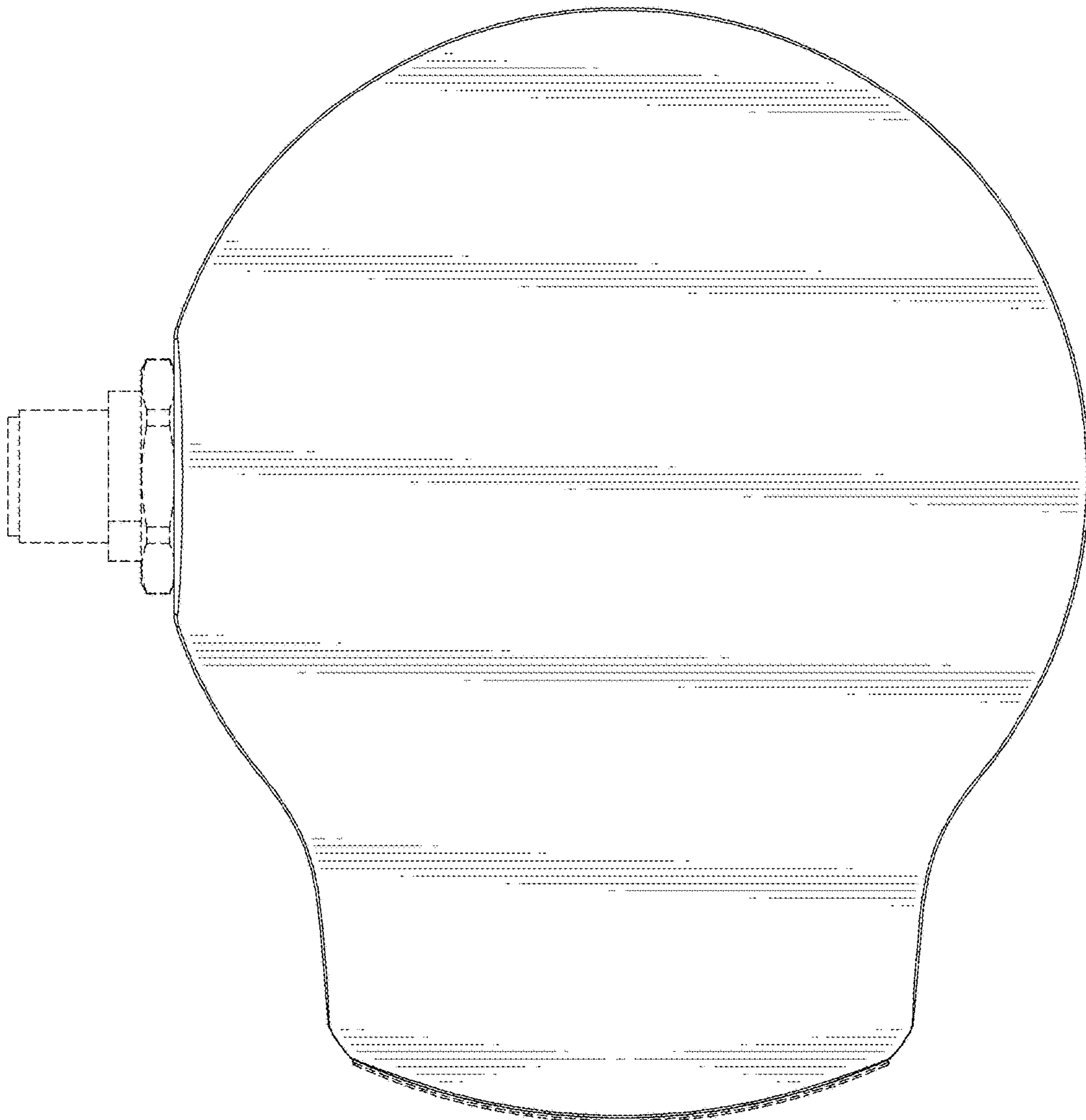

FIG. 4

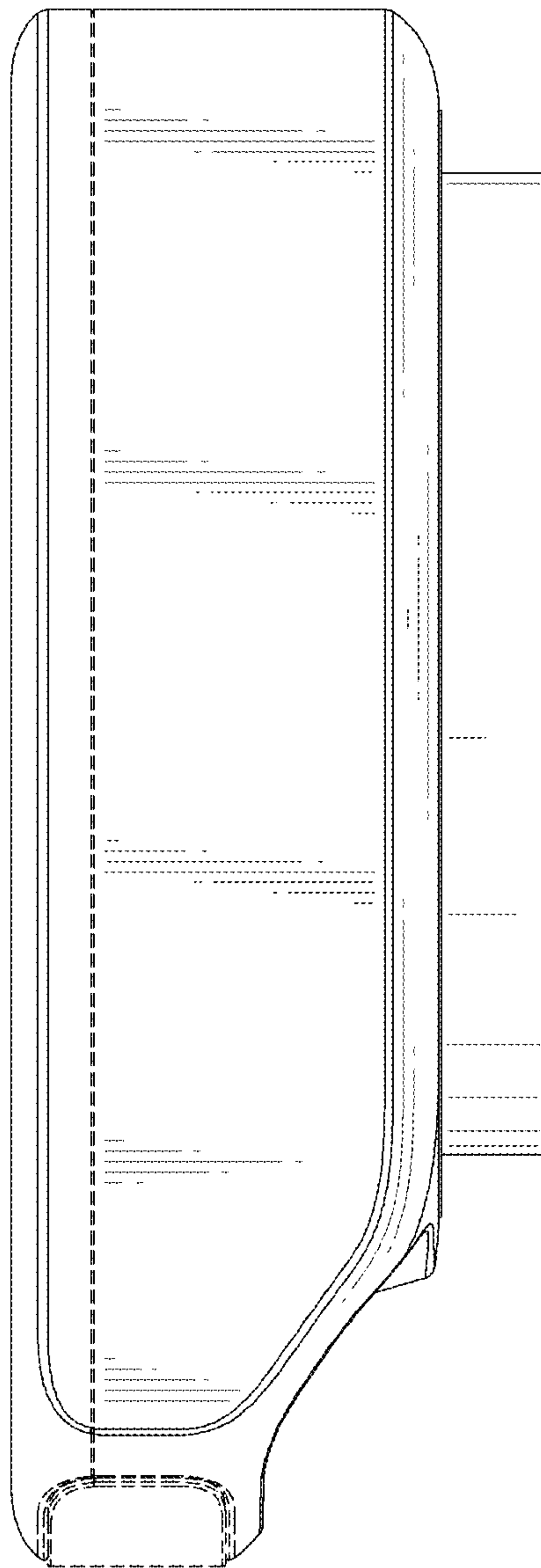

FIG. 5

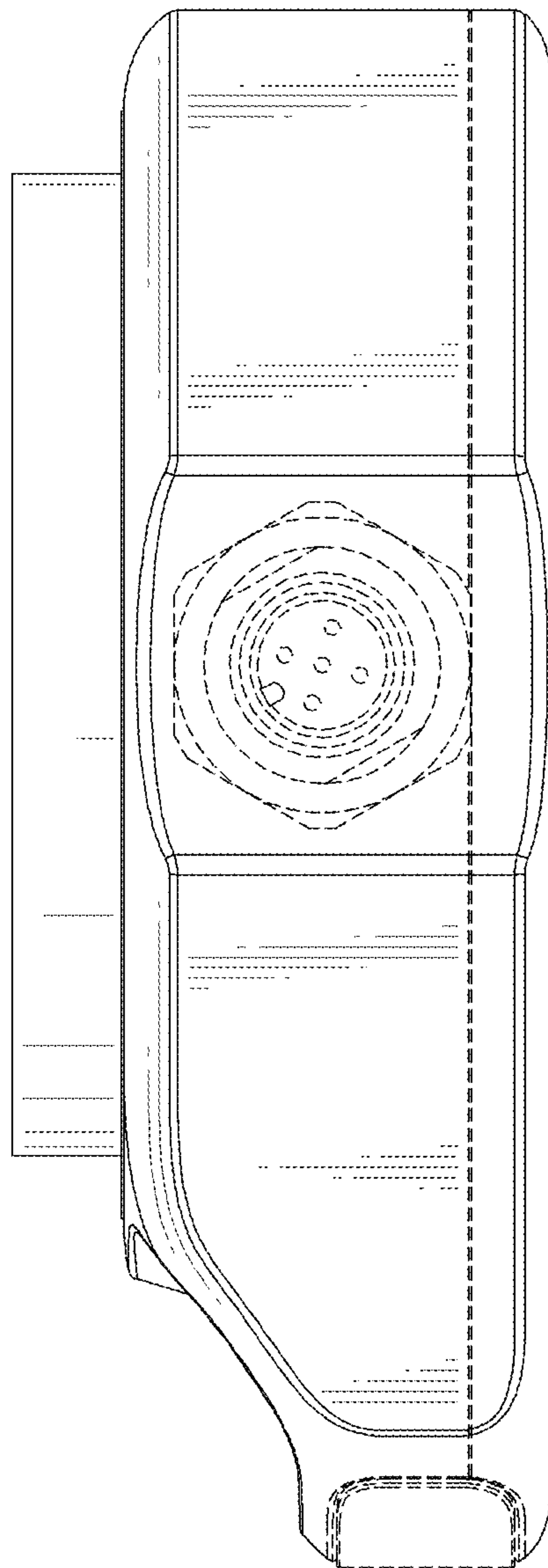

FIG. 6

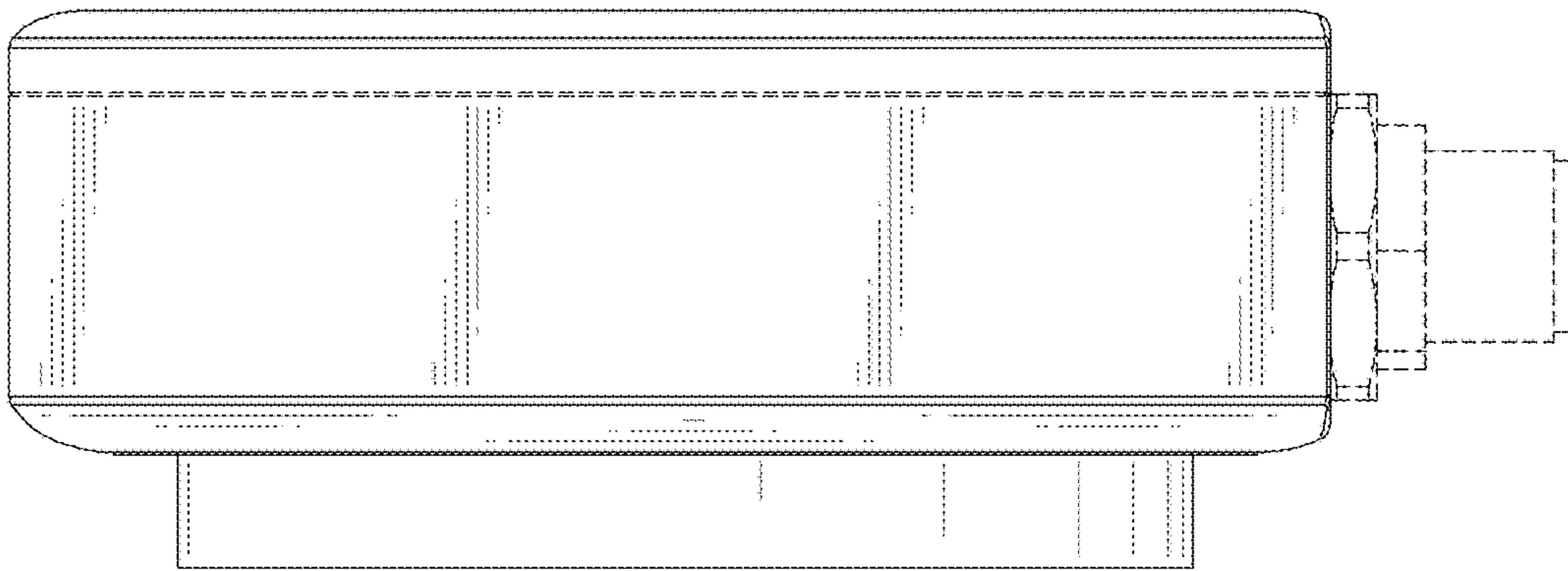

FIG. 7

