



US00D835979S

(12) **United States Design Patent** (10) **Patent No.:** **US D835,979 S**
Lin (45) **Date of Patent:** **** Dec. 18, 2018**

(54) **DECORATIVE WASHER**
(71) Applicant: **Simpson Strong-Tie Company, Inc.**,
Pleasanton, CA (US)
(72) Inventor: **Jin-Jie Lin**, Livermore, CA (US)
(73) Assignee: **Simpson Strong-Tie Company Inc.**,
Pleasanton, CA (US)
(**) Term: **15 Years**
(21) Appl. No.: **29/607,121**
(22) Filed: **Jun. 9, 2017**
(51) **LOC (11) Cl.** **08-08**
(52) **U.S. Cl.**
USPC **D8/399**
(58) **Field of Classification Search**
USPC D8/399, 382, 349, 397, 394
CPC F16B 39/24; F16B 31/028; F16B 39/28;
F16B 41/002; E04G 25/065; F01L 9/04
See application file for complete search history.

(56) **References Cited**
U.S. PATENT DOCUMENTS
1,342,001 A * 6/1920 Schulte H01M 2/30
429/121
1,635,313 A * 7/1927 Dieterich F16B 39/24
277/640
3,069,919 A * 12/1962 Schultz, Jr. F16H 55/44
474/169
4,122,915 A * 10/1978 Taguchi E04B 1/84
181/210
4,202,594 A * 5/1980 Coleman H01R 9/05
333/206
D269,852 S * 7/1983 Frieberg D8/399
D276,310 S * 11/1984 Frieberg D8/399
5,020,953 A * 6/1991 Wada F16B 39/34
411/247
D327,111 S * 6/1992 Hemming D22/134

5,205,760 A * 4/1993 Agut Sanz H01R 13/74
248/27.1
D335,441 S * 5/1993 Fraker D8/369
5,211,372 A * 5/1993 Smith, Jr. F01L 25/08
251/129.19
5,223,067 A * 6/1993 Hamamoto B29C 53/805
156/169
5,827,028 A * 10/1998 Swick H01R 4/44
411/160
6,056,519 A * 5/2000 Morita F04B 35/045
267/161
6,231,063 B1 * 5/2001 Chi B62K 21/06
280/276
D528,407 S * 9/2006 Schwab D8/399
D549,091 S * 8/2007 McIntyre D8/399
D554,491 S * 11/2007 Stenberg D8/349
7,367,786 B2 * 5/2008 Kang F04B 35/045
417/417

(Continued)

OTHER PUBLICATIONS

“OZCO 2015 New Product Launch”, catalog, 2015, cover and 4 pages, OZCO Building Products, Richardson, Texas.
(Continued)

Primary Examiner — Cynthia R Underwood
(74) *Attorney, Agent, or Firm* — James R. Cypher;
Charles R. Cypher

(57) **CLAIM**
The ornamental design for the decorative washer, as shown and described.

DESCRIPTION

FIG. 1 is a perspective view of a decorative washer showing my design;
FIG. 2 is a front view of the decorative washer of FIG. 1, the back view is identical; and,
FIG. 3 is a right side view of the decorative washer of FIG. 1, the top, bottom and left side views are identical.

1 Claim, 2 Drawing Sheets

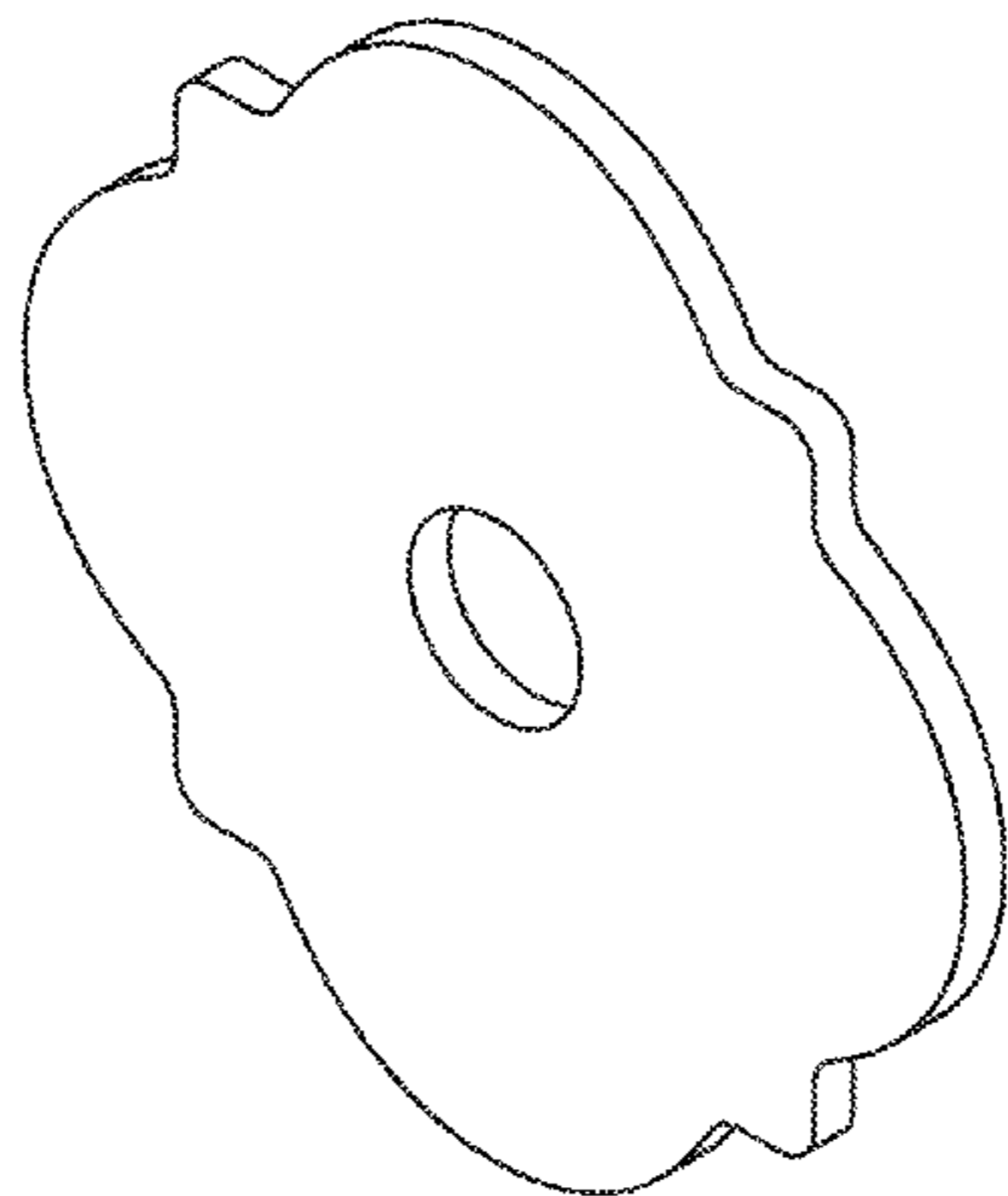

(56)

References Cited

U.S. PATENT DOCUMENTS

D609,552 S * 2/2010 Anderson D8/349
 D610,717 S * 2/2010 Lin
 D644,921 S * 9/2011 Hsu D8/399
 D645,337 S * 9/2011 Hsu D8/399
 D654,348 S * 2/2012 Musselman D8/349
 D654,937 S * 2/2012 Fader D15/138
 D664,170 S * 7/2012 Chung D15/144
 D692,747 S * 11/2013 Schwab D8/399
 D703,034 S * 4/2014 Stewart D8/399
 8,845,202 B2 * 9/2014 Teimel F16C 25/083
 384/517
 8,960,655 B2 * 2/2015 Wood F16F 1/027
 267/159
 9,027,897 B2 5/2015 Hill
 D733,546 S 7/2015 Balzhiser
 D744,799 S * 12/2015 Rodenhouse D8/70
 D748,973 S * 2/2016 Rodenhouse D8/399
 D776,519 S * 1/2017 Almaghlouth D8/399
 D783,393 S * 4/2017 Weifenbach D8/399
 D805,885 S * 12/2017 Karmarkar D8/382
 2002/0089106 A1 * 7/2002 Horng H02K 5/167
 267/161
 2006/0171794 A1 * 8/2006 Ordonio, Jr. F16B 37/14
 411/369

2008/0310932 A1 * 12/2008 McIntyre B29C 70/80
 411/150
 2013/0334392 A1 12/2013 Hill
 2013/0340375 A1 12/2013 Hill
 2014/0007541 A1 1/2014 Hill
 2014/0008557 A1 * 1/2014 Vandamme F16F 1/027
 251/129.15
 2016/0102724 A1 * 4/2016 Potter F16F 1/027
 267/161

OTHER PUBLICATIONS

“OZCO Decorative Structural Wood Connectors”, website page, Jan. 4, 2016, 1 page, OZCO Building Products, Richardson, Texas.
 “How to choose a wood connector face plate size for exposed beams”, website page, Jan. 5, 2016, 3 pages, Old West Iron, Felt, Idaho.
 Old West Iron Connectors, web pages, Feb. 15, 2017, 8 pages, Old West Iron, Felt, Idaho.
 “Wood to Wood Connector Gallery,” web page, Jun. 2012, 2 pages, Old West Iron dba Teton Iron, Teton, Idaho.
 U.S. Appl. No. 29/554,662 for a Decorative Connector invented by Jin-Jie Lin, filed Feb. 12, 2016, 52 pages, USA.

* cited by examiner

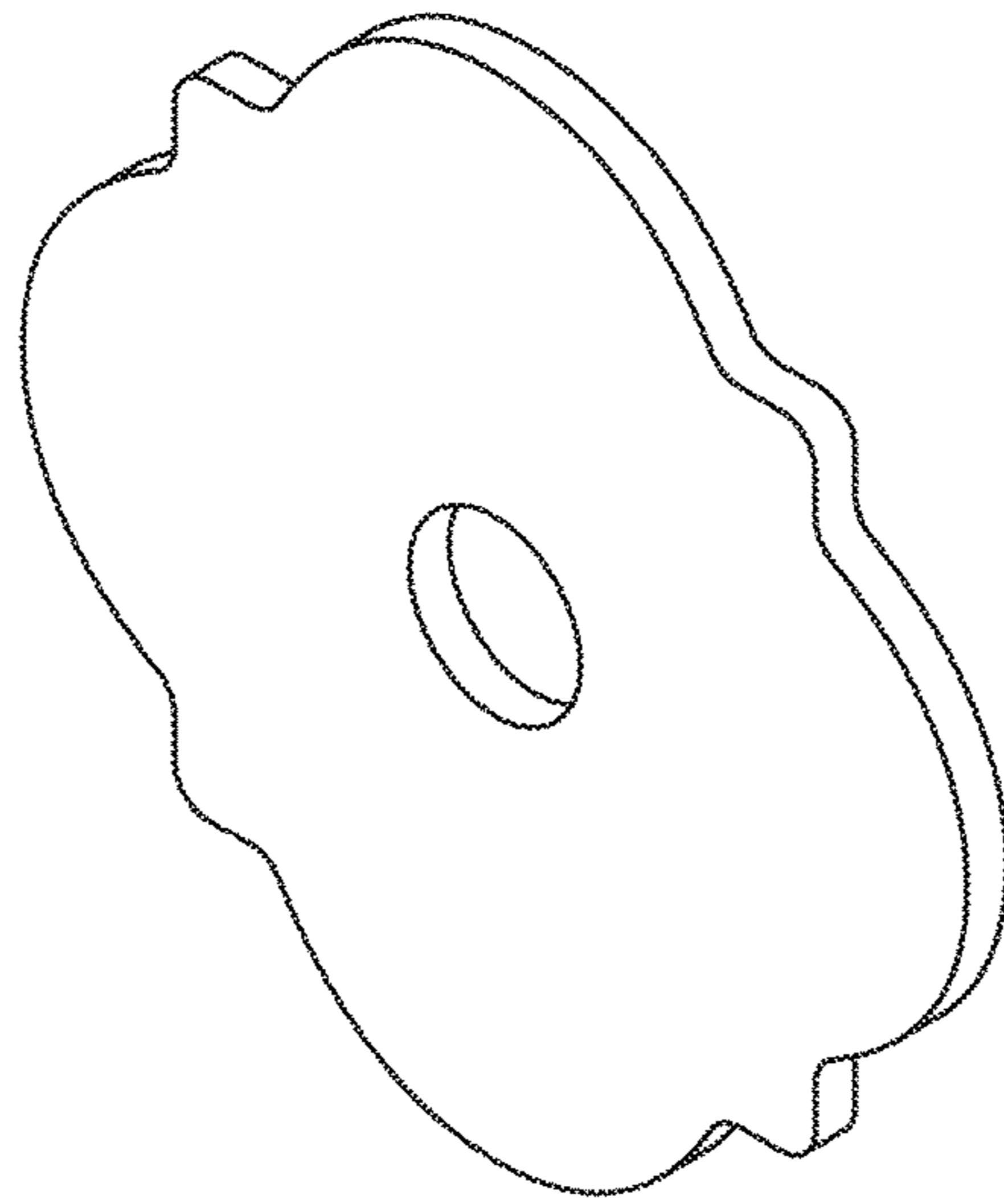

Fig. 1

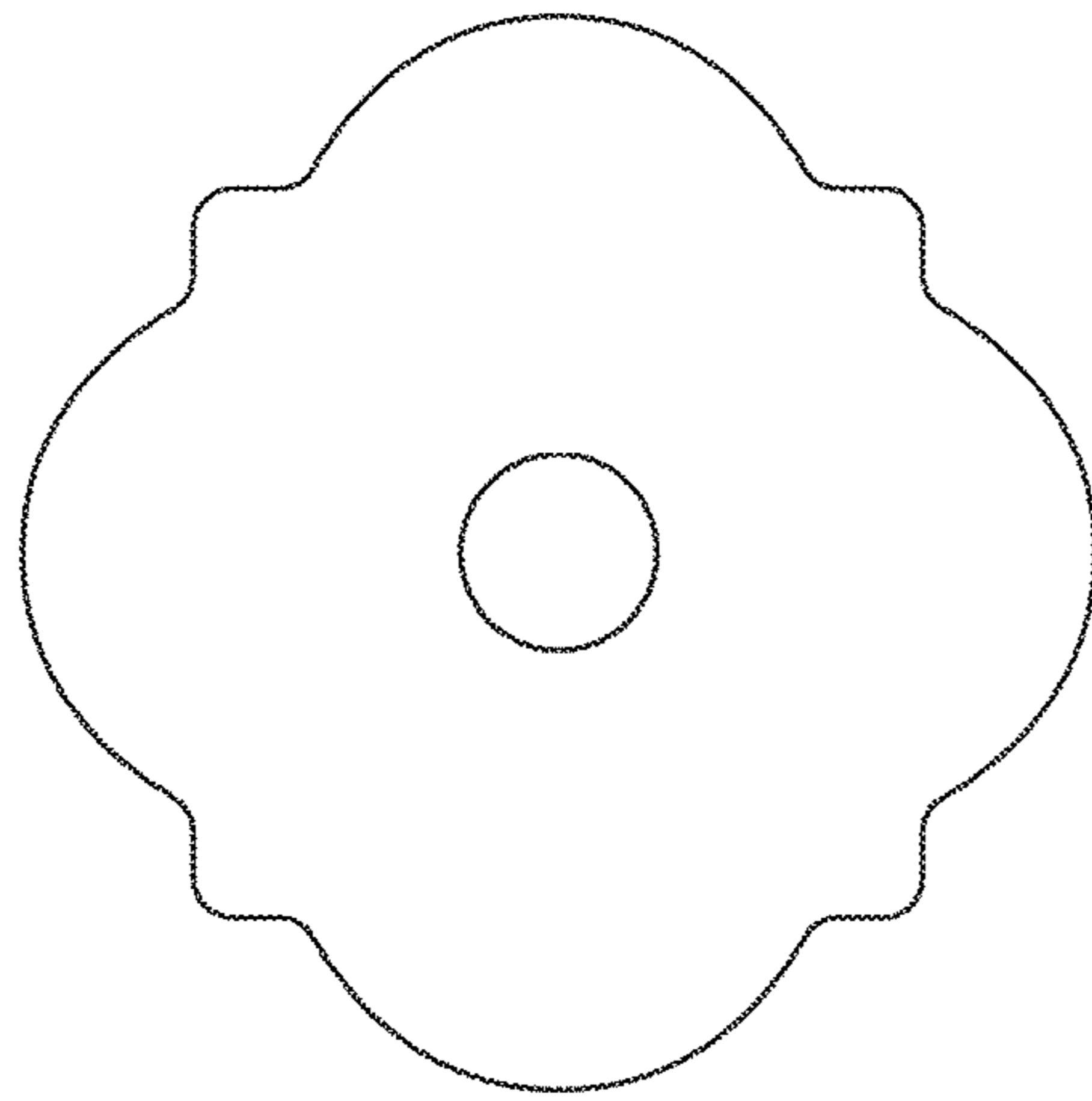

Fig. 2



Fig. 3