



US00D833978S

(12) **United States Design Patent** (10) **Patent No.:** **US D833,978 S**
Smajda (45) **Date of Patent:** **** Nov. 20, 2018**

(54) **RAIL CAR POWER CONNECTOR**
(71) Applicant: **Westinghouse Air Brake Technologies Corporation**, Wilmerding, PA (US)
(72) Inventor: **Kenneth J. Smajda**, Elkridge, MD (US)
(73) Assignee: **Westinghouse Air Brake Technologies Corporation**, Wilmerding, PA (US)

(**) Term: **15 Years**

(21) Appl. No.: **29/562,121**

(22) Filed: **Apr. 22, 2016**

(51) **LOC (11) Cl.** **13-03**

(52) **U.S. Cl.**
USPC **D13/154; D13/133**

(58) **Field of Classification Search**
USPC D13/123, 133, 146, 147, 154, 184, 199
CPC H01R 13/516; H01R 13/5219; H01R 13/623; H01R 13/625; H01R 13/6278; H01R 24/84; B61G 5/10
See application file for complete search history.

(56) **References Cited**

U.S. PATENT DOCUMENTS

| | | | |
|--------------|---------|------------------|---------|
| 2,933,711 A | 4/1960 | Eaton | |
| 3,271,726 A | 9/1966 | Pfendler | |
| 3,680,033 A | 7/1972 | Kawai | |
| 3,971,614 A | 7/1976 | Paoli et al. | |
| D243,407 S * | 2/1977 | Mooney | D13/149 |
| 4,457,572 A | 7/1984 | Frazier et al. | |
| 4,472,013 A | 9/1984 | Frear | |
| 4,497,530 A | 2/1985 | Shannon | |
| 4,595,251 A | 6/1986 | Moulin | |
| 4,629,272 A | 12/1986 | Mattingly et al. | |
| 4,639,064 A | 1/1987 | Knapp et al. | |
| 5,082,454 A | 1/1992 | Tonkiss et al. | |
| 5,131,862 A | 7/1992 | Gershfeld | |

| | | | |
|--------------|---------|-----------------|---------|
| 5,192,219 A | 3/1993 | Fowler et al. | |
| D336,070 S * | 6/1993 | Clark | D13/133 |
| 5,658,159 A | 8/1997 | Gardner et al. | |
| D406,816 S * | 3/1999 | Hopper | D13/146 |
| 6,173,849 B1 | 1/2001 | Stevens et al. | |
| 6,602,093 B1 | 8/2003 | Cannon | |
| 6,669,506 B2 | 12/2003 | Newton | |
| 6,808,407 B1 | 10/2004 | Cannon | |
| 6,848,931 B2 | 2/2005 | McMullen et al. | |
| 6,908,118 B2 | 6/2005 | Fumioka | |
| 7,097,490 B2 | 8/2006 | Eaton et al. | |
| D580,876 S * | 11/2008 | Farahani | D13/146 |
| 7,587,244 B2 | 9/2009 | Olbertz | |
| 7,748,986 B1 | 7/2010 | Pamapy et al. | |
| D633,872 S * | 3/2011 | Shen | D13/155 |

(Continued)

FOREIGN PATENT DOCUMENTS

| | | |
|----|-----------------|---------|
| EP | 1050931 A1 | 11/2000 |
| KR | 1020140062930 A | 5/2014 |

Primary Examiner — Daniel D Bui

(74) *Attorney, Agent, or Firm* — The Webb Law Firm

(57) **CLAIM**

The ornamental design for a rail car power connector, as shown and described.

DESCRIPTION

FIG. 1 is a rear perspective view of a rail car power connector showing my new design;
FIG. 2 is a front perspective view thereof;
FIG. 3 is a front view thereof;
FIG. 4 is a rear view thereof;
FIG. 5 is a top view thereof;
FIG. 6 is a bottom view thereof;
FIG. 7 is a right view thereof; and,
FIG. 8 is a left view thereof.
In the drawing views, the broken line represents unclaimed environment only and forms no part of the claimed design.

1 Claim, 5 Drawing Sheets

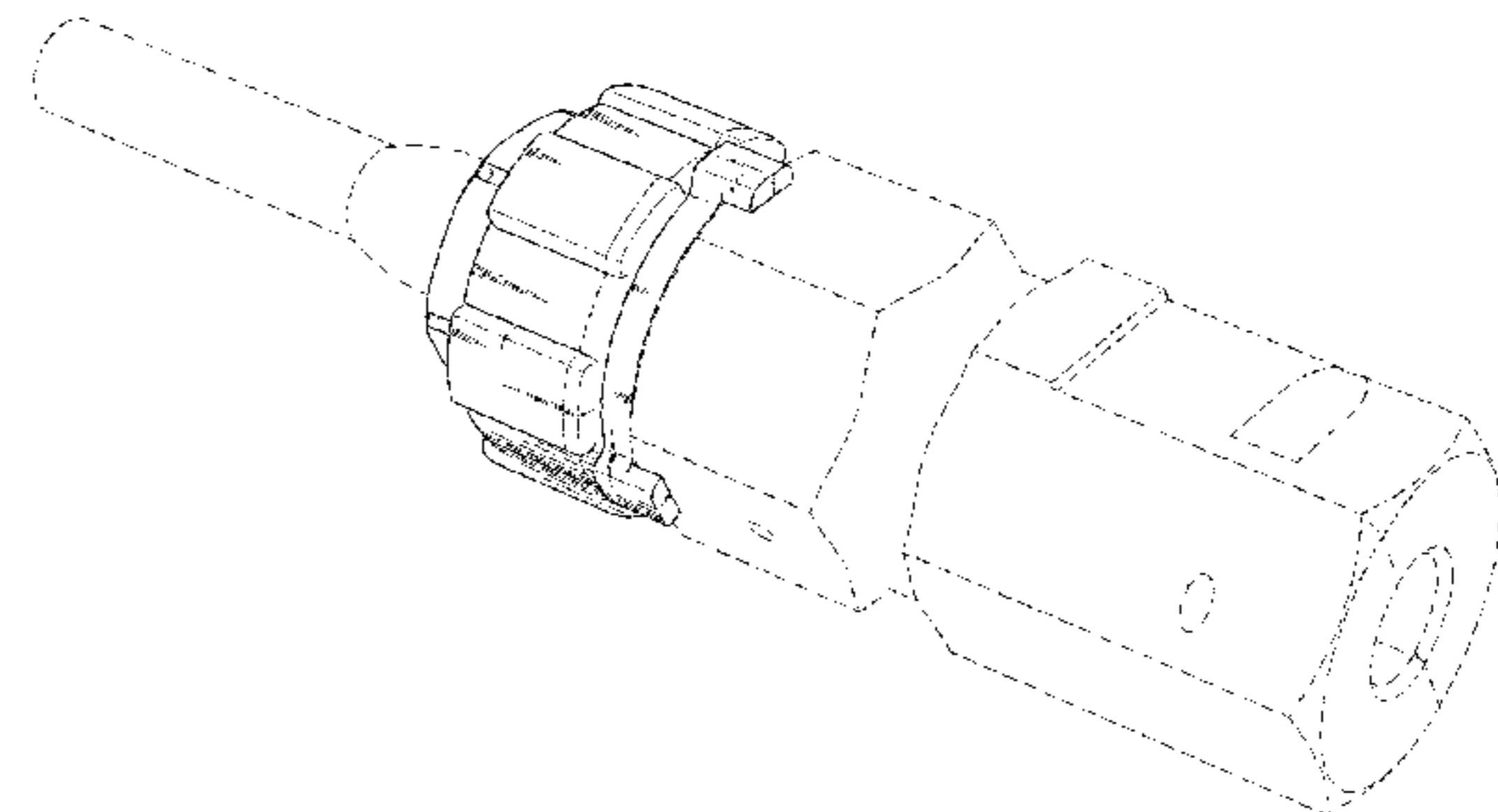
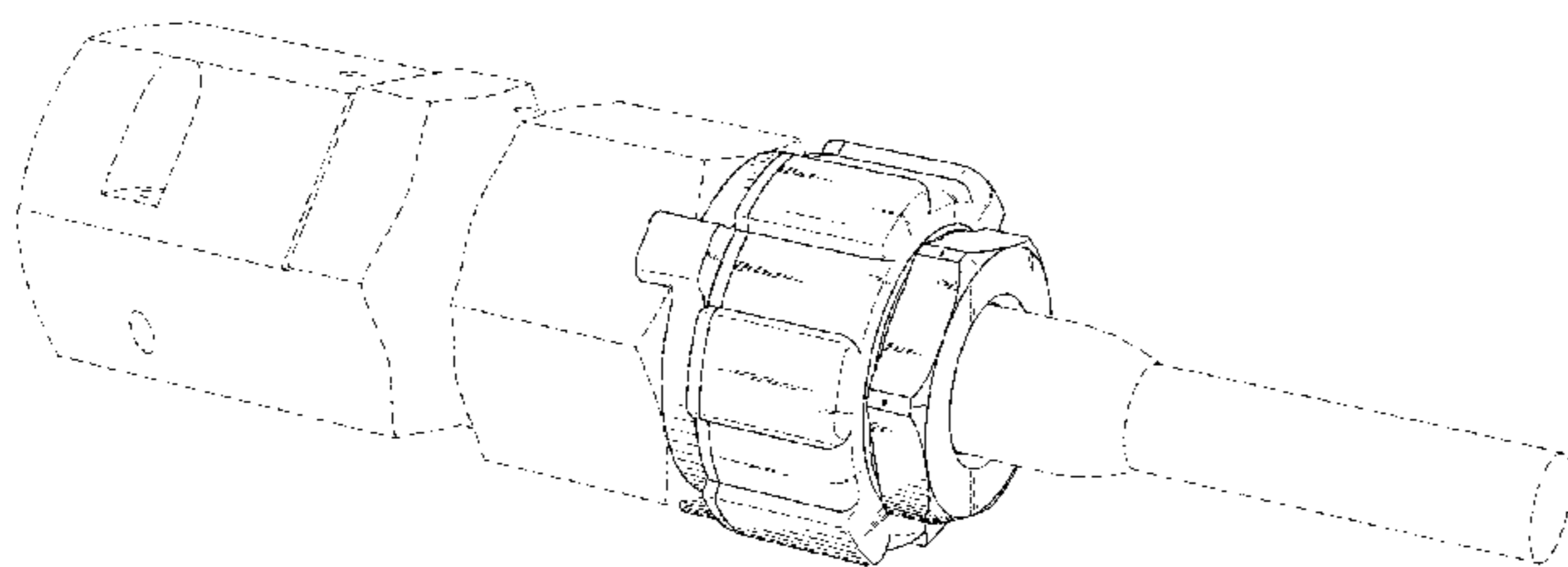

(56)

References Cited

U.S. PATENT DOCUMENTS

| | | | | |
|--------------|------|---------|------------------|--------------|
| 9,093,783 | B2 | 7/2015 | Grimm | |
| 9,099,807 | B2 | 8/2015 | Opgenorth | |
| 9,136,658 | B2 | 9/2015 | Chang et al. | |
| D749,047 | S * | 2/2016 | Smith | D13/149 |
| D754,073 | S * | 4/2016 | Katagiyama | D13/133 |
| 9,412,530 | B2 | 8/2016 | Kirita | |
| 9,437,961 | B1 | 9/2016 | Smajda | |
| 9,437,965 | B2 | 9/2016 | Zitsch et al. | |
| D769,822 | S * | 10/2016 | Reynolds | D13/146 |
| D781,787 | S * | 3/2017 | Spiel | D13/149 |
| D782,982 | S * | 4/2017 | Katagiyama | D13/156 |
| D794,573 | S * | 8/2017 | Tateishi | D13/147 |
| 2004/0014350 | A1 | 1/2004 | McMullen et al. | |
| 2006/0063396 | A1 | 3/2006 | Bankstahl | |
| 2009/0269958 | A1 | 10/2009 | Fujiwara et al. | |
| 2010/0173504 | A1 | 7/2010 | Pamapy et al. | |
| 2010/0297875 | A1 | 11/2010 | Purdy et al. | |
| 2011/0294329 | A1 | 12/2011 | Sasaki | |
| 2012/0252256 | A1 | 10/2012 | Zhu et al. | |
| 2013/0221166 | A1 | 8/2013 | Henniges et al. | |
| 2014/0050443 | A1 | 2/2014 | Lee | |
| 2014/0302724 | A1 | 10/2014 | Ono | |
| 2015/0050827 | A1 | 2/2015 | Chang et al. | |
| 2015/0110447 | A1 | 4/2015 | Elenbaas et al. | |
| 2017/0310044 | A1 * | 10/2017 | Smajda | H01R 13/6278 |

* cited by examiner

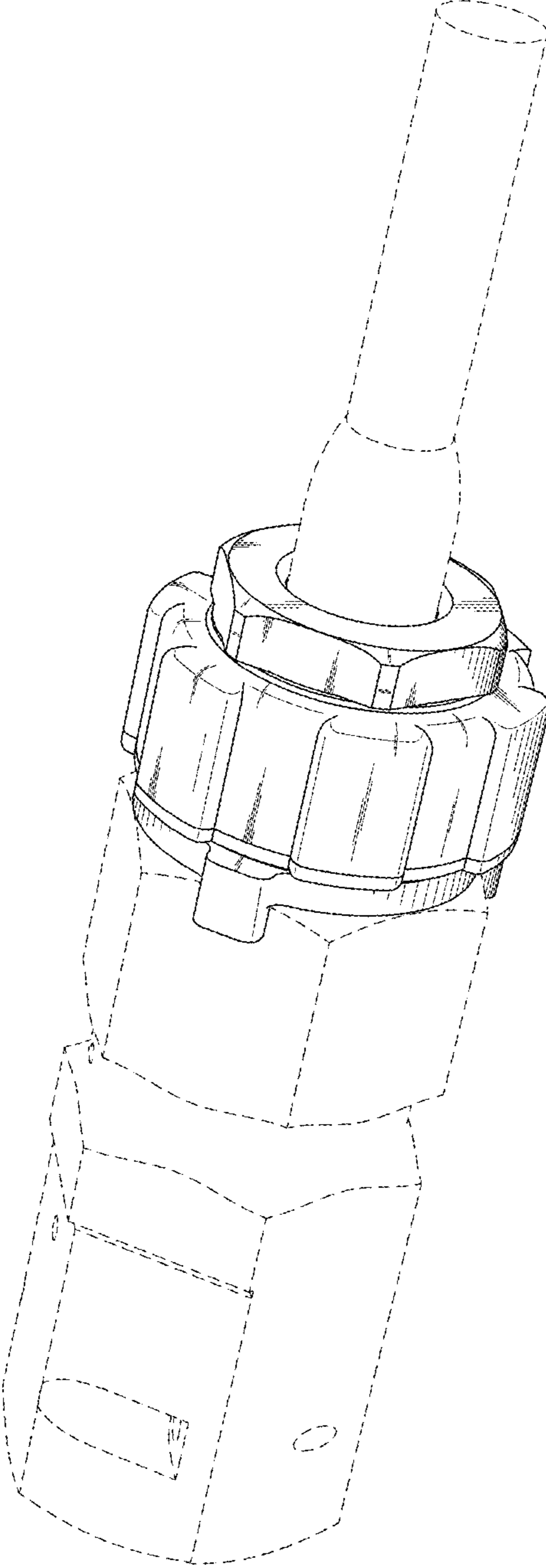

FIG. 1

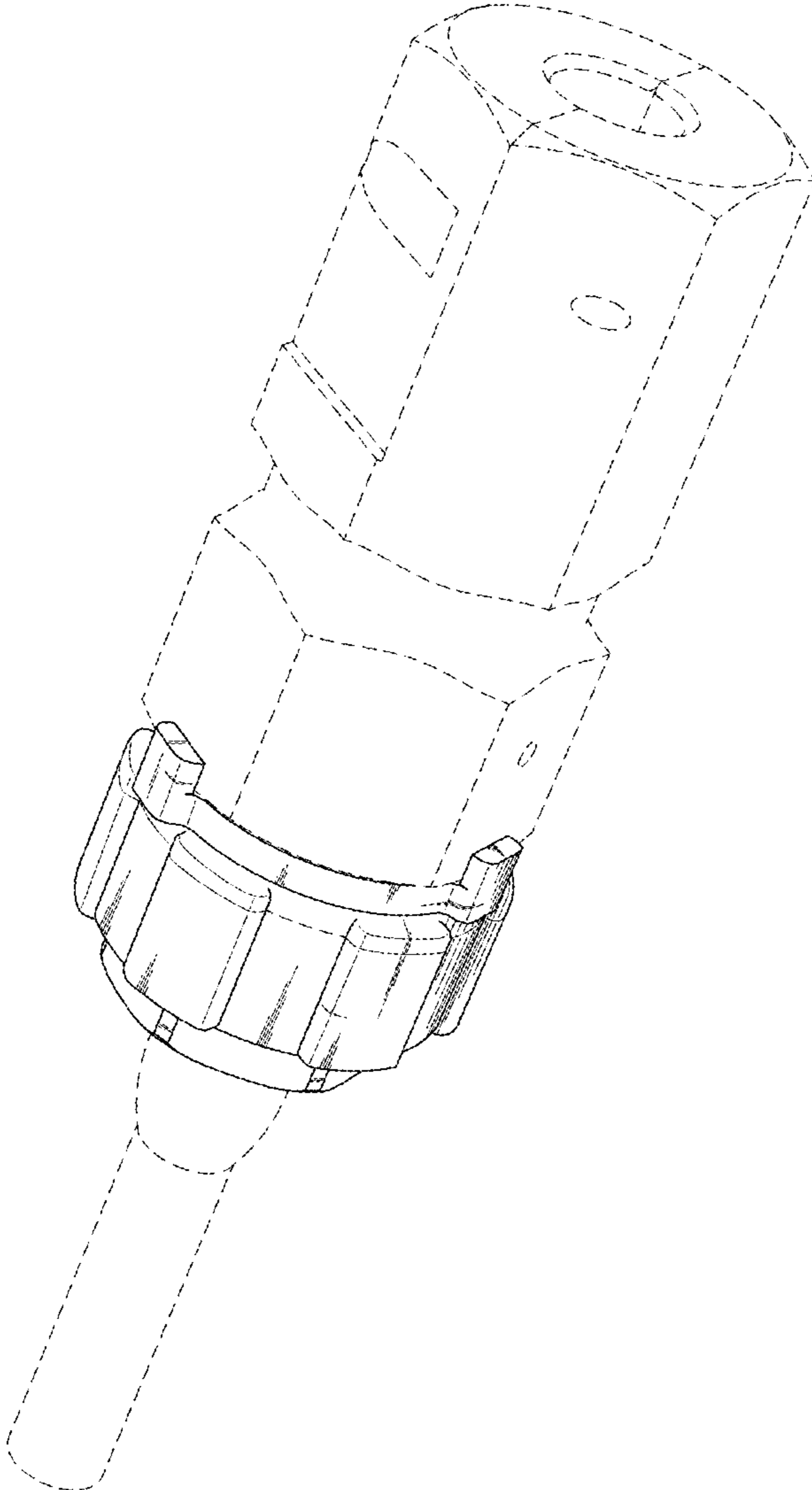

FIG. 2

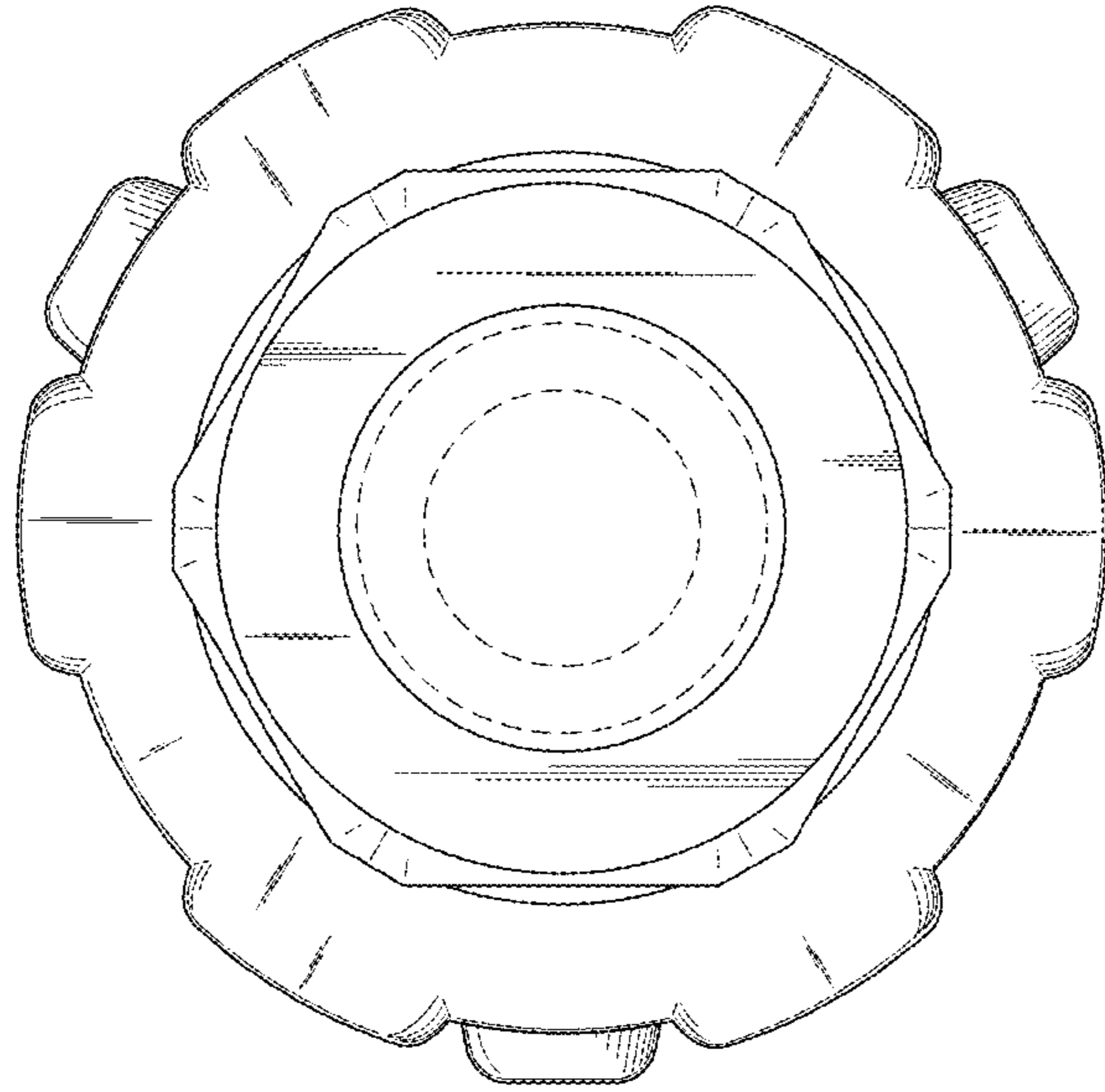

FIG. 4

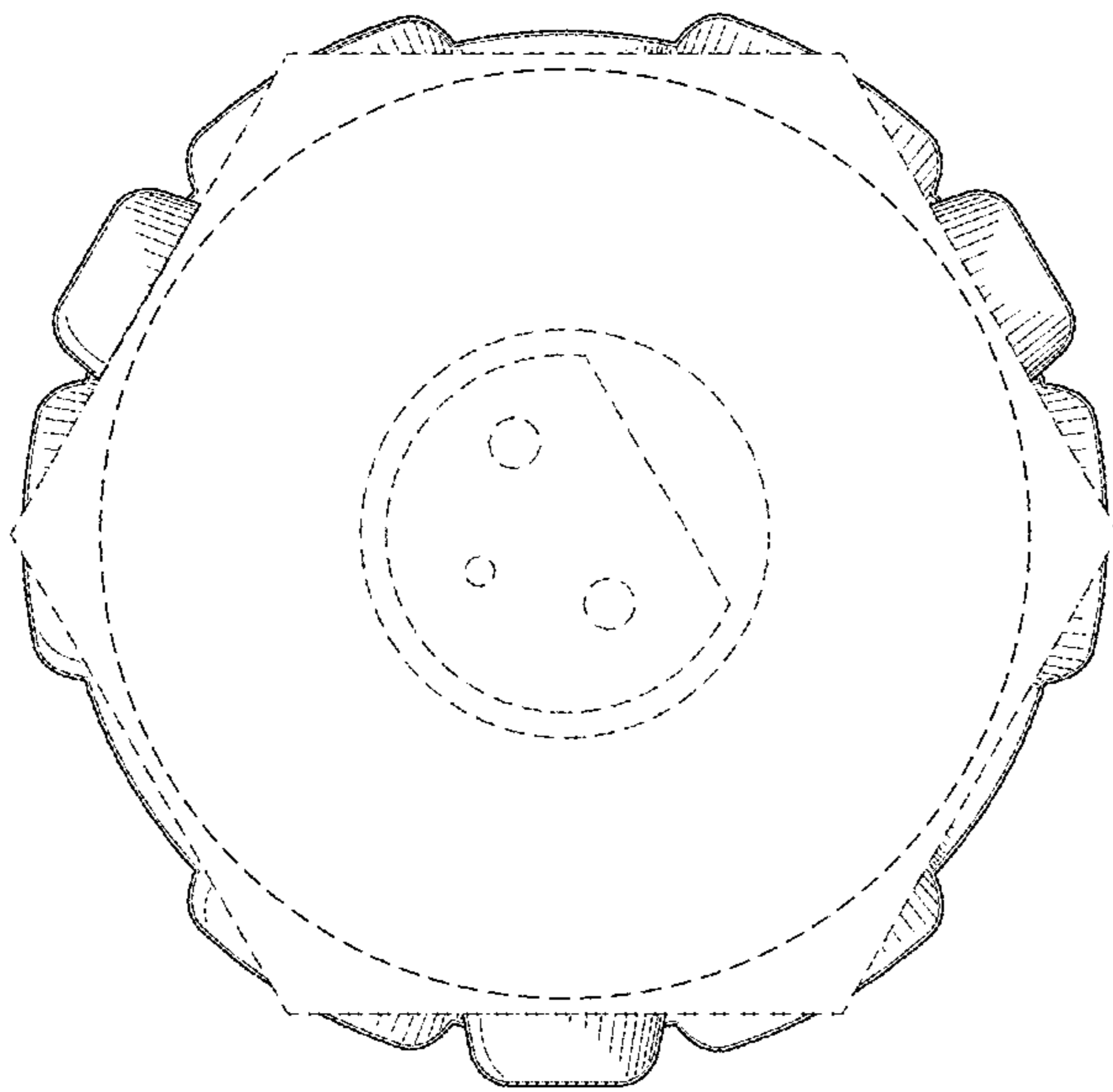

FIG. 3

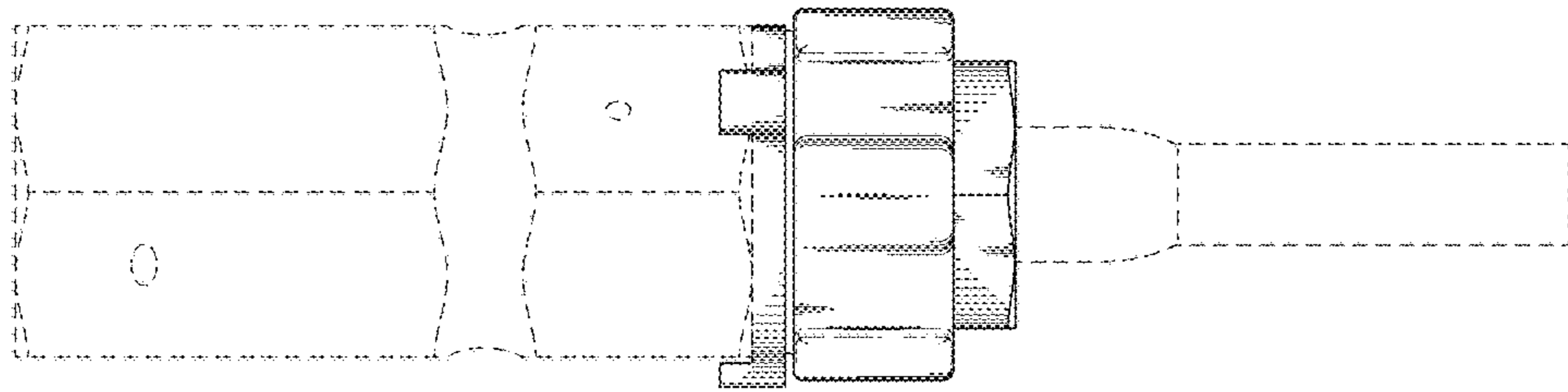

FIG. 6

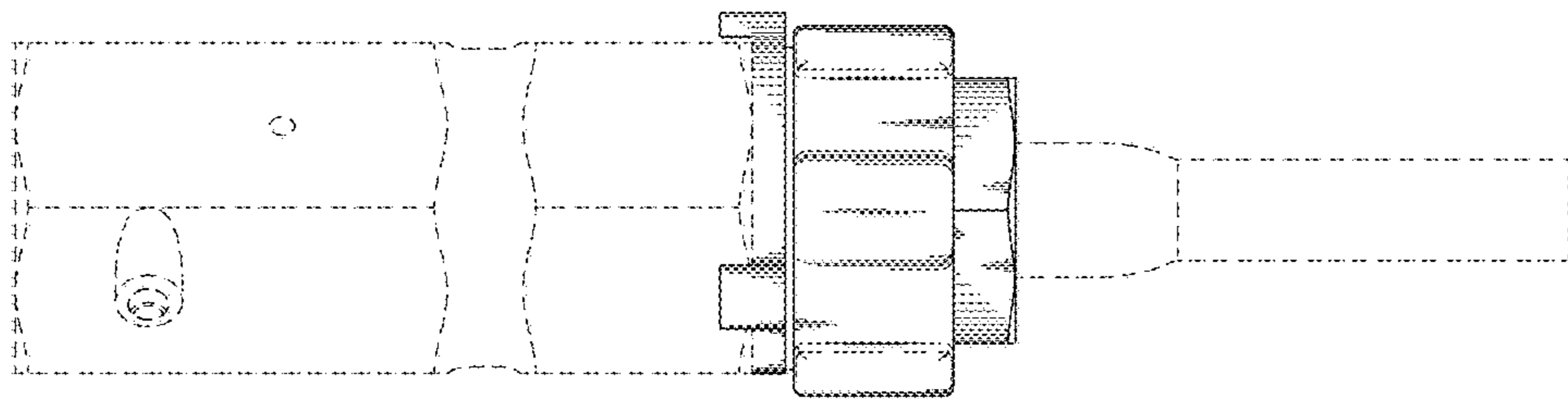

FIG. 5

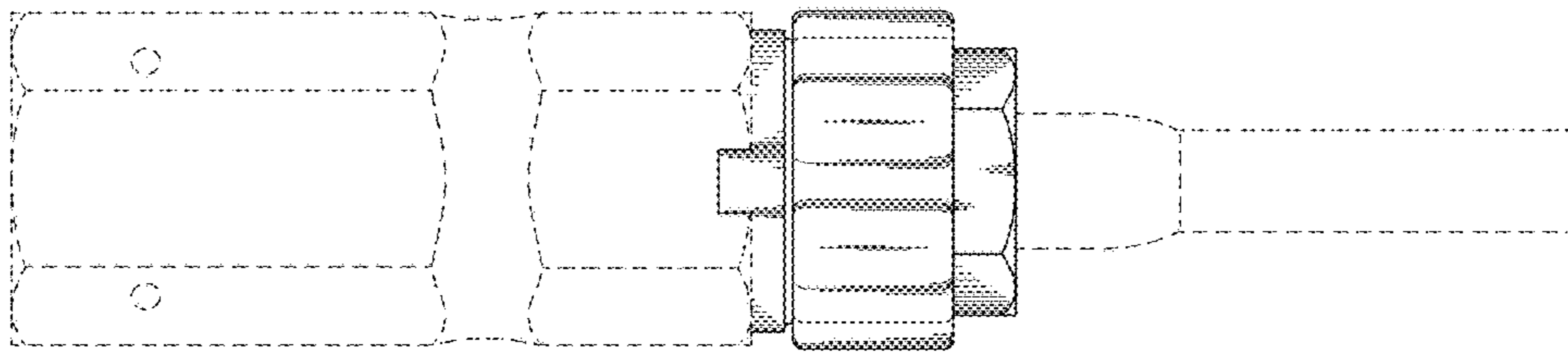

FIG. 8

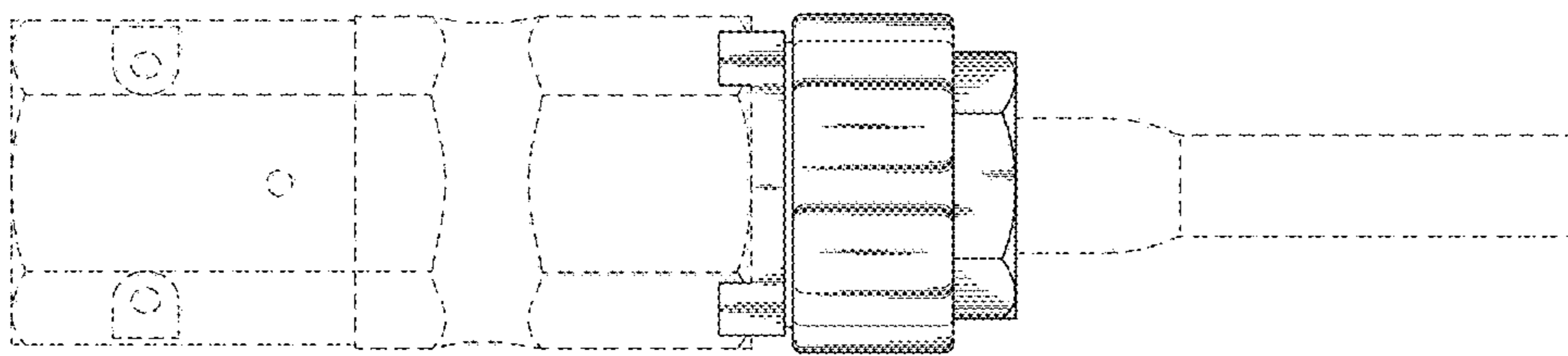

FIG. 7