



US00D833422S

(12) **United States Design Patent** (10) **Patent No.:** **US D833,422 S**
He (45) **Date of Patent:** **** Nov. 13, 2018**

(54) **ANTENNA**
(71) Applicant: **Airgain Incorporated**, San Diego, CA (US)
(72) Inventor: **Ziming He**, Irvine, CA (US)
(73) Assignee: **Airgain Incorporated**, San Diego, CA (US)
(**) Term: **15 Years**
(21) Appl. No.: **29/615,183**
(22) Filed: **Aug. 26, 2017**

Related U.S. Application Data

(62) Division of application No. 29/557,307, filed on Mar. 8, 2016, now Pat. No. Des. 795,847.
(51) **LOC (11) Cl.** **14-03**
(52) **U.S. Cl.**
USPC **D14/230**
(58) **Field of Classification Search**
USPC D14/138, 230, 231, 232, 233, 234, 235, D14/236, 237, 238, 238.1, 299, 358; D13/175, 182
CPC G01R 29/10; G01S 2013/0245; G01S 2013/0254; G01S 2013/0263; G01S 7/4026; G05B 2219/45001; G06K 19/07773; G06K 19/07775; G06K 19/07777; G08B 13/2468; G08B 13/2477; H01Q 1/088
See application file for complete search history.

(56) **References Cited**

U.S. PATENT DOCUMENTS

7,123,207 B2 * 10/2006 Yazdandoost H01Q 9/285 343/795
7,193,576 B2 * 3/2007 Yazdandoost H01Q 9/285 343/700 MS
D604,275 S * 11/2009 Norris D14/230

7,612,720 B2 * 11/2009 Kerselaers H01O 9/285 343/700 MS
D695,279 S * 12/2013 Yang D14/230
D695,280 S * 12/2013 Yang D14/230
D708,602 S * 7/2014 Gosalia D14/230
D766,221 S * 9/2016 Zheng D14/230
D766,884 S * 9/2016 Zheng D14/240
D782,448 S * 3/2017 Gosalia D14/230
D784,965 S * 4/2017 Chang D14/230
D788,082 S * 5/2017 Zheng D14/230
D795,228 S * 8/2017 He D14/230
D801,318 S * 10/2017 Manivannan D14/230

(Continued)

OTHER PUBLICATIONS

<http://airgain.com/our-services/embedded-antennas/>—Retrieved on Jul. 18, 2017.*

Primary Examiner — Manpreet S Matharu
Assistant Examiner — Mojtaba Tehrani
(74) *Attorney, Agent, or Firm* — Clause Eight IPS; Michael Catania

(57) **CLAIM**

The ornamental design for an antenna, as shown and described.

DESCRIPTION

FIG. 1 is a top plan view of a first embodiment of an antenna, showing my new design;
FIG. 2 is a front elevation view thereof;
FIG. 3 is a bottom plan view thereof;
FIG. 4 is a side elevation view thereof;
FIG. 5 is a top perspective view thereof;
FIG. 6 is a top plan view thereof, with unclaimed environment not shown; and,
FIG. 7 is a front elevation view thereof, with unclaimed environment not shown.
The broken line in the figure drawings represents unclaimed environment only and forms no part of the claimed design.

1 Claim, 3 Drawing Sheets

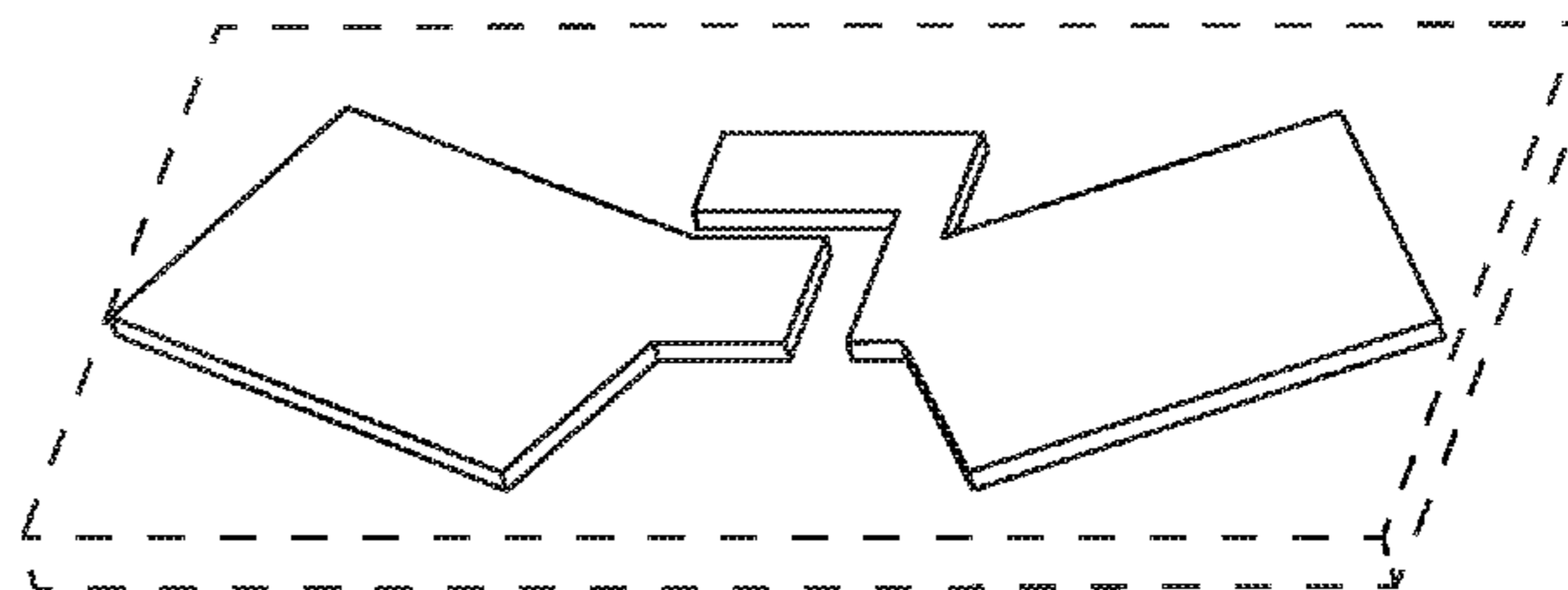
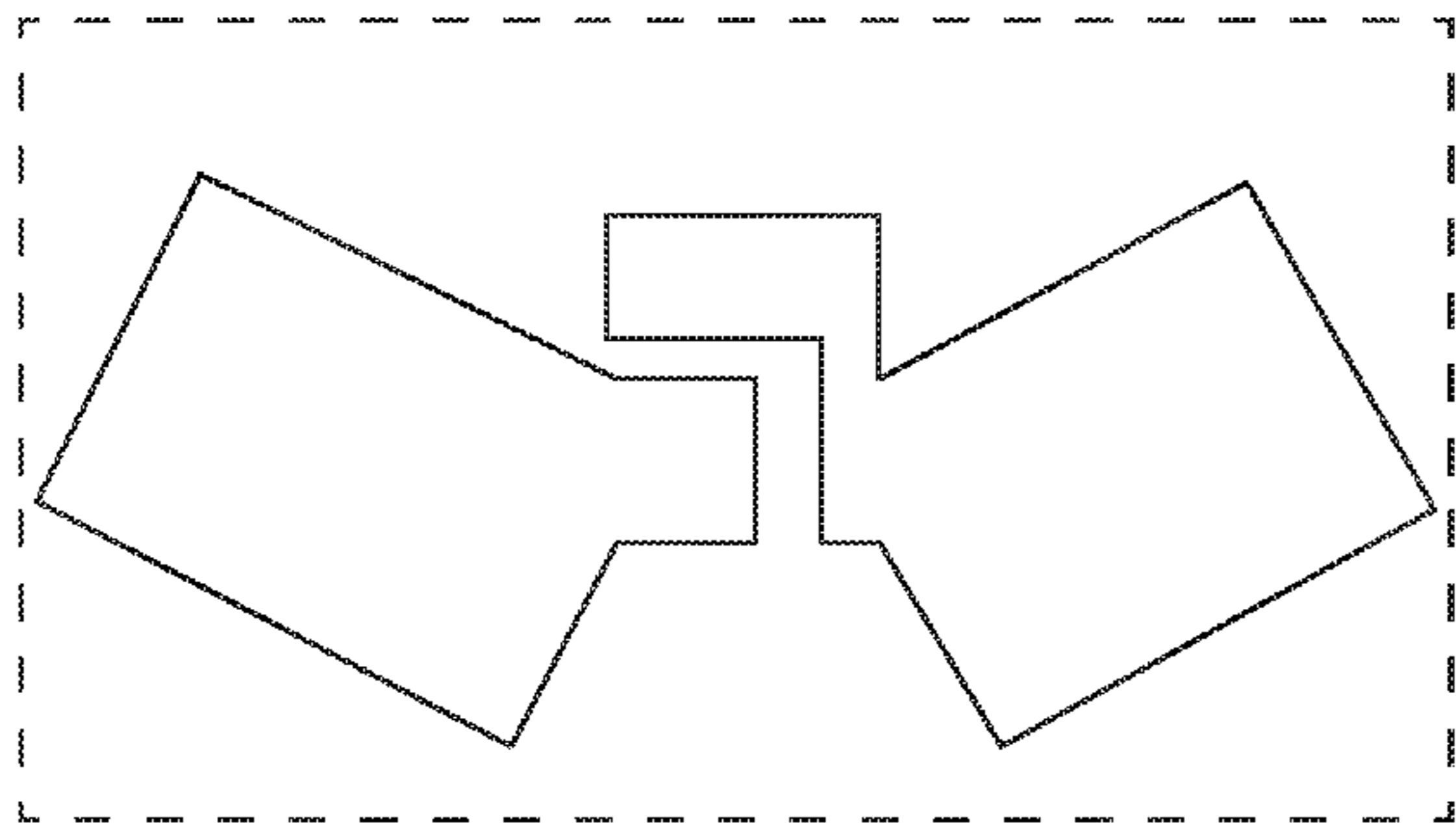

(56)

References Cited

U.S. PATENT DOCUMENTS

D814,448 S * 4/2018 Montgomery D14/230
2007/0194999 A1* 8/2007 Morton H01Q 1/48
343/767
2015/0294215 A1* 10/2015 Manzi G06K 7/0008
235/439

* cited by examiner

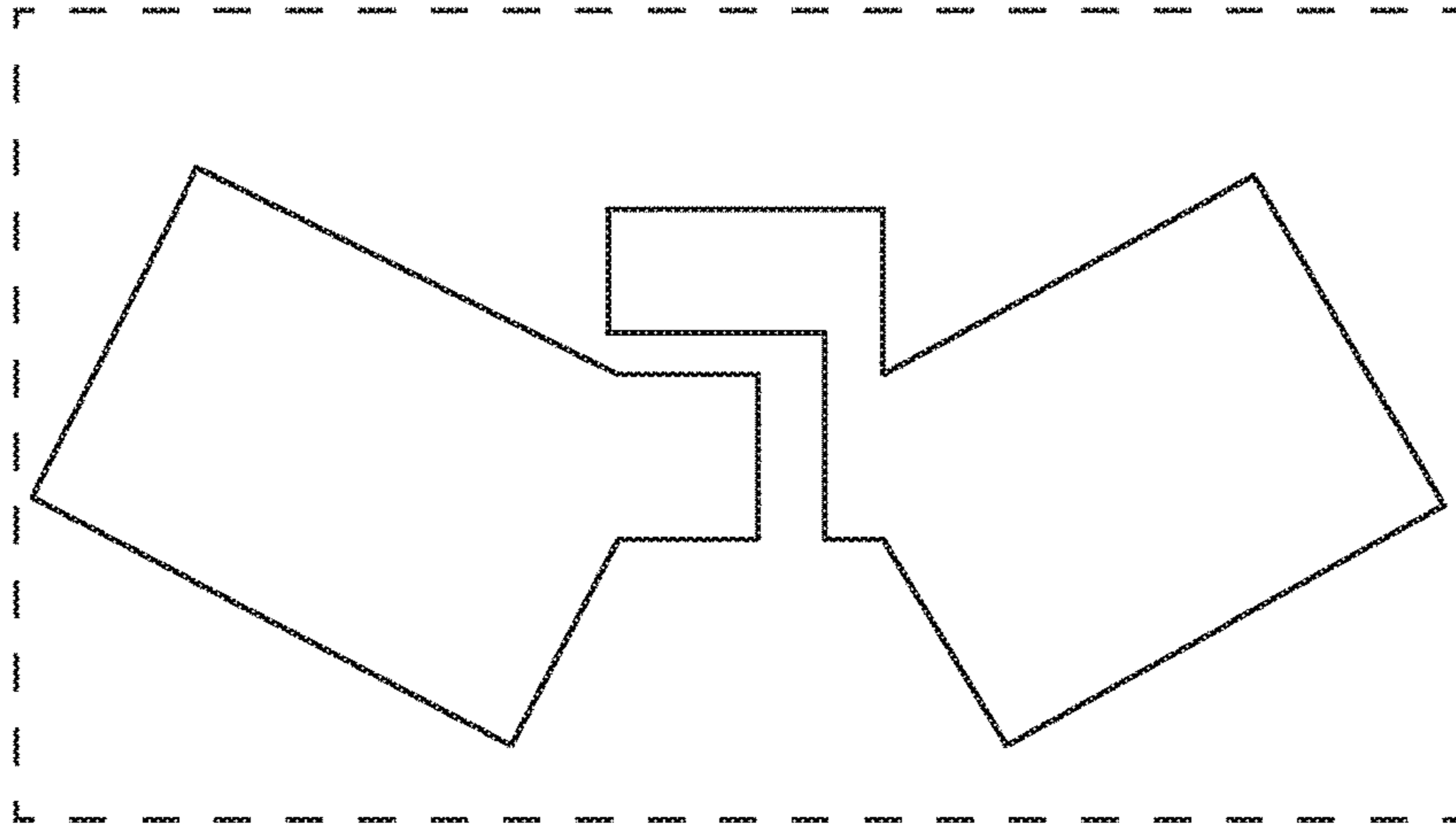

FIG. 1

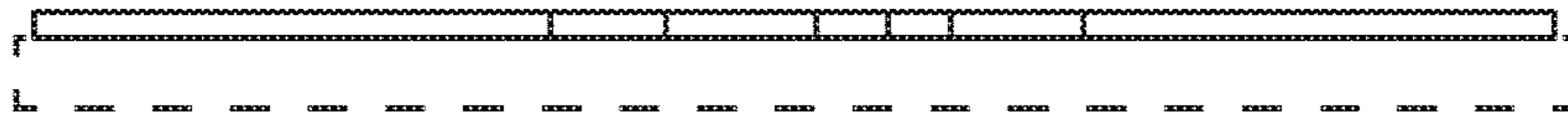

FIG. 2

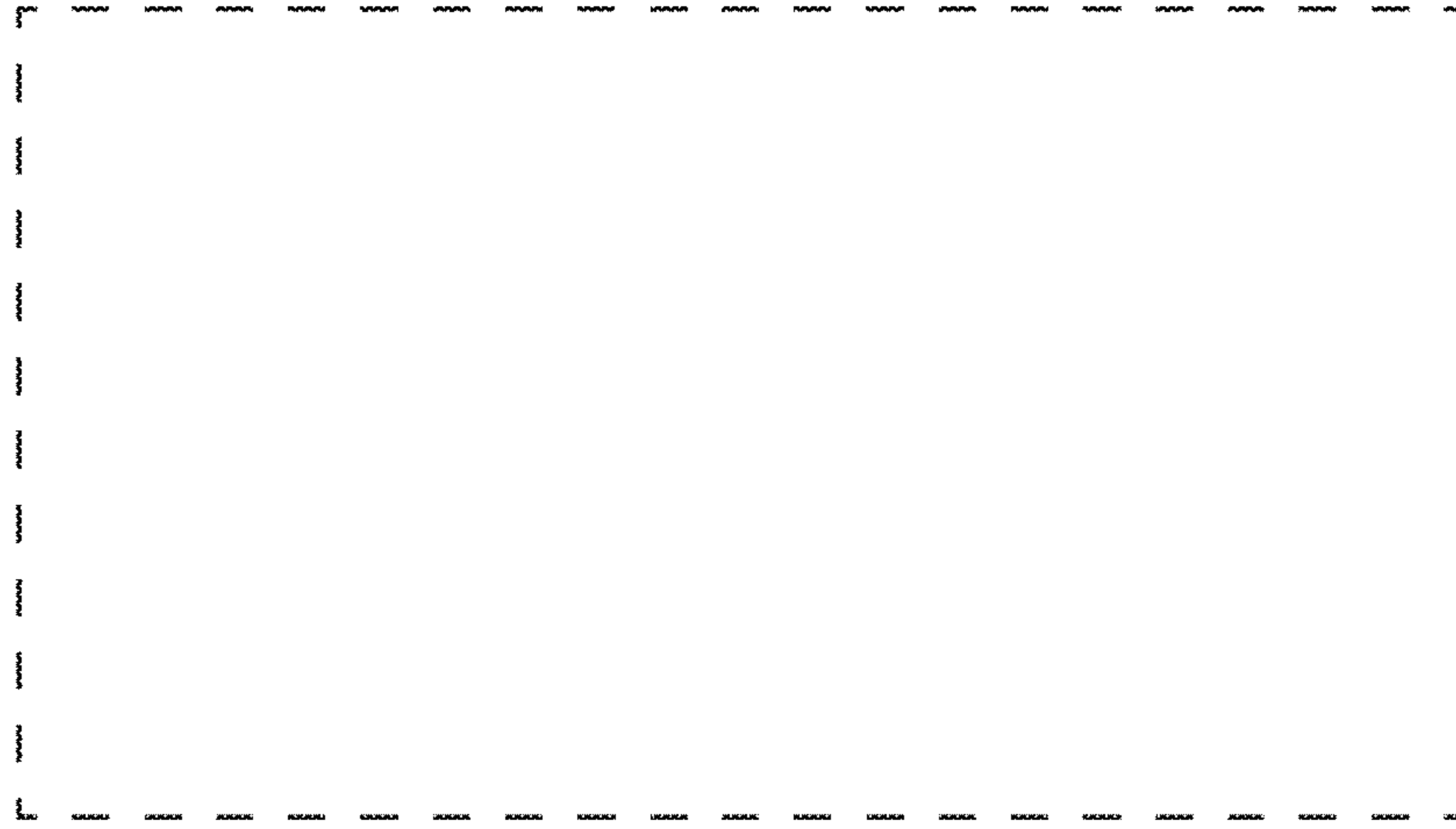

FIG. 3



FIG. 4

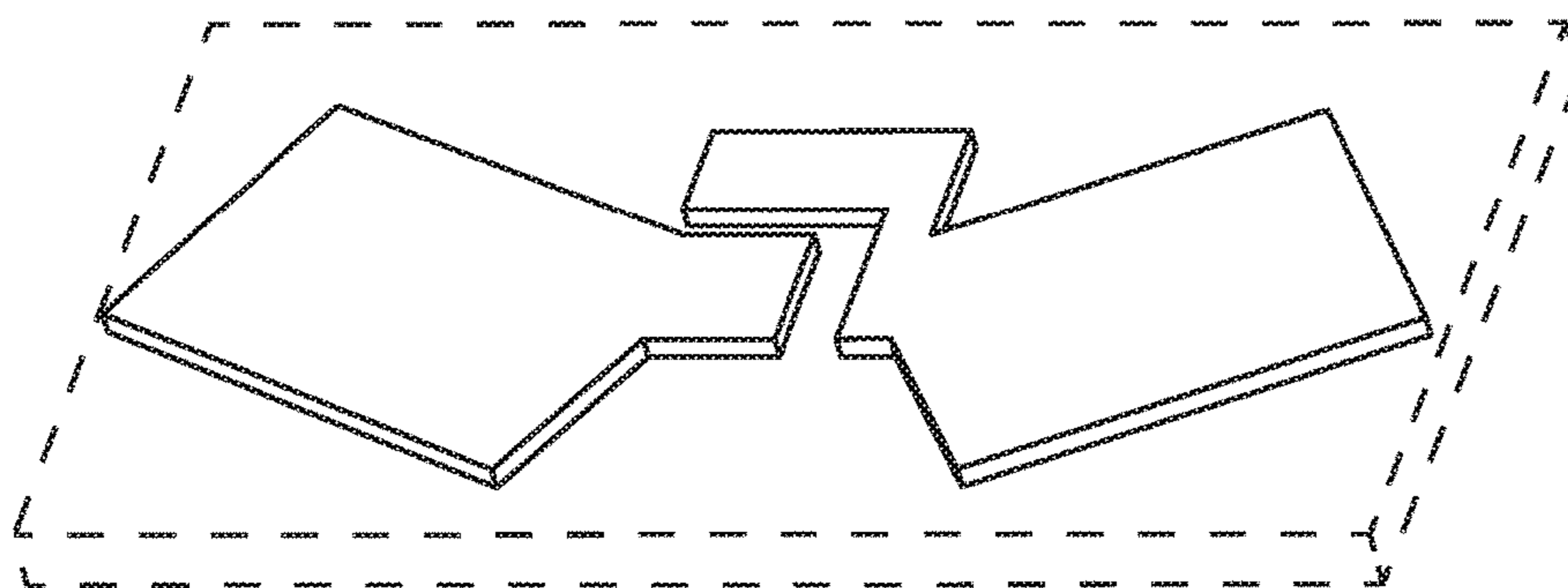

FIG. 5

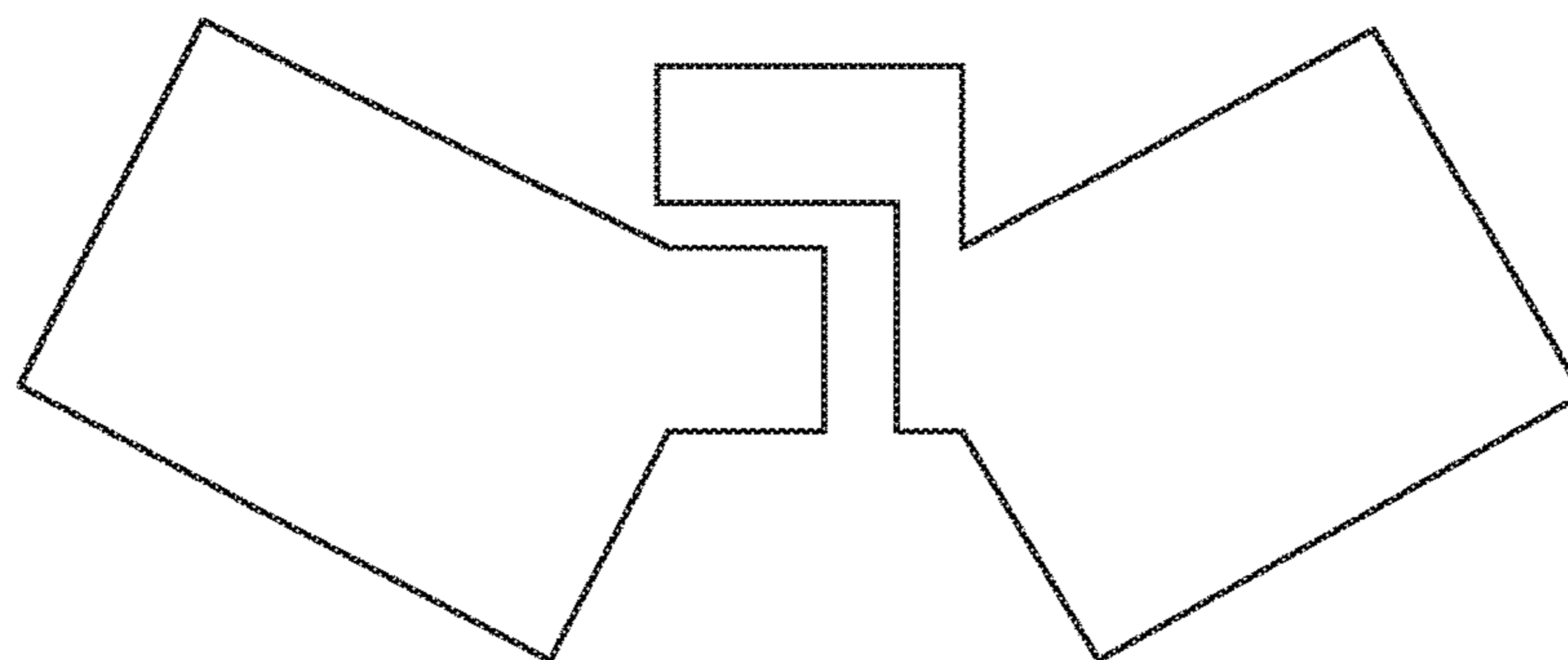

FIG. 6



FIG. 7