

US00D833347S

(12) **United States Design Patent** (10) **Patent No.:** **US D833,347 S**
Lewis (45) **Date of Patent:** **** Nov. 13, 2018**

(54) **REAR AXLE BRAKE BACKING PLATE ADAPTER**

(71) Applicant: **George Robert Lewis**, Hammond, LA (US)

(72) Inventor: **George Robert Lewis**, Hammond, LA (US)

(**) Term: **15 Years**

(21) Appl. No.: **29/574,086**

(22) Filed: **Aug. 11, 2016**

(51) **LOC (11) Cl.** **12-16**

(52) **U.S. Cl.**
USPC **D12/180**

(58) **Field of Classification Search**
USPC D12/160
See application file for complete search history.

(56) **References Cited**

PUBLICATIONS

Rear Axle Wheel Bearing Kit Toyota Pickup 4Runner Tacoma T100, www.jtoutfitters.com, dated Oct. 13, 2009, 4 pages. (last page is enlargement of the illustration on p. 2). Found online Apr. 16,

2018 at <http://www.jtoutfitters.com/rear-axle-wheel-bearing-toyota-pickup-4runner-tacoma-t100-p-24531.html> (Year: 2009).*

Rear hub bearing retaining plate, www.riminilambrettacentre.com, 5 pages, undated. Found online Apr. 16, 2018 at <https://www.riminilambrettacentre.com/en/casa-lambretta/elaborazioni/casa-performance/piastra-per-cuscinetto-ruota-posteriore-anodizzato-argento-per-blocco-motore-casacase.html> (Year: 2018).*

* cited by examiner

Primary Examiner — Robert M. Spear

(74) *Attorney, Agent, or Firm* — Steven H. Greenfield;
Greenfield Invention and Patent Consulting, Inc.

(57) **CLAIM**

The ornamental design for a rear axle brake backing plate adapter, as shown and described.

DESCRIPTION

FIG. 1 is a front isometric view of a rear axle brake backing plate adapter showing my new design;
FIG. 2 is a rear isometric view thereof;
FIG. 3 is a front view thereof;
FIG. 4 is a rear view thereof;
FIG. 5 is a top view thereof;
FIG. 6 is a bottom view thereof;
FIG. 7 is a first side view thereof; and,
FIG. 8 is a second side view thereof.

1 Claim, 8 Drawing Sheets

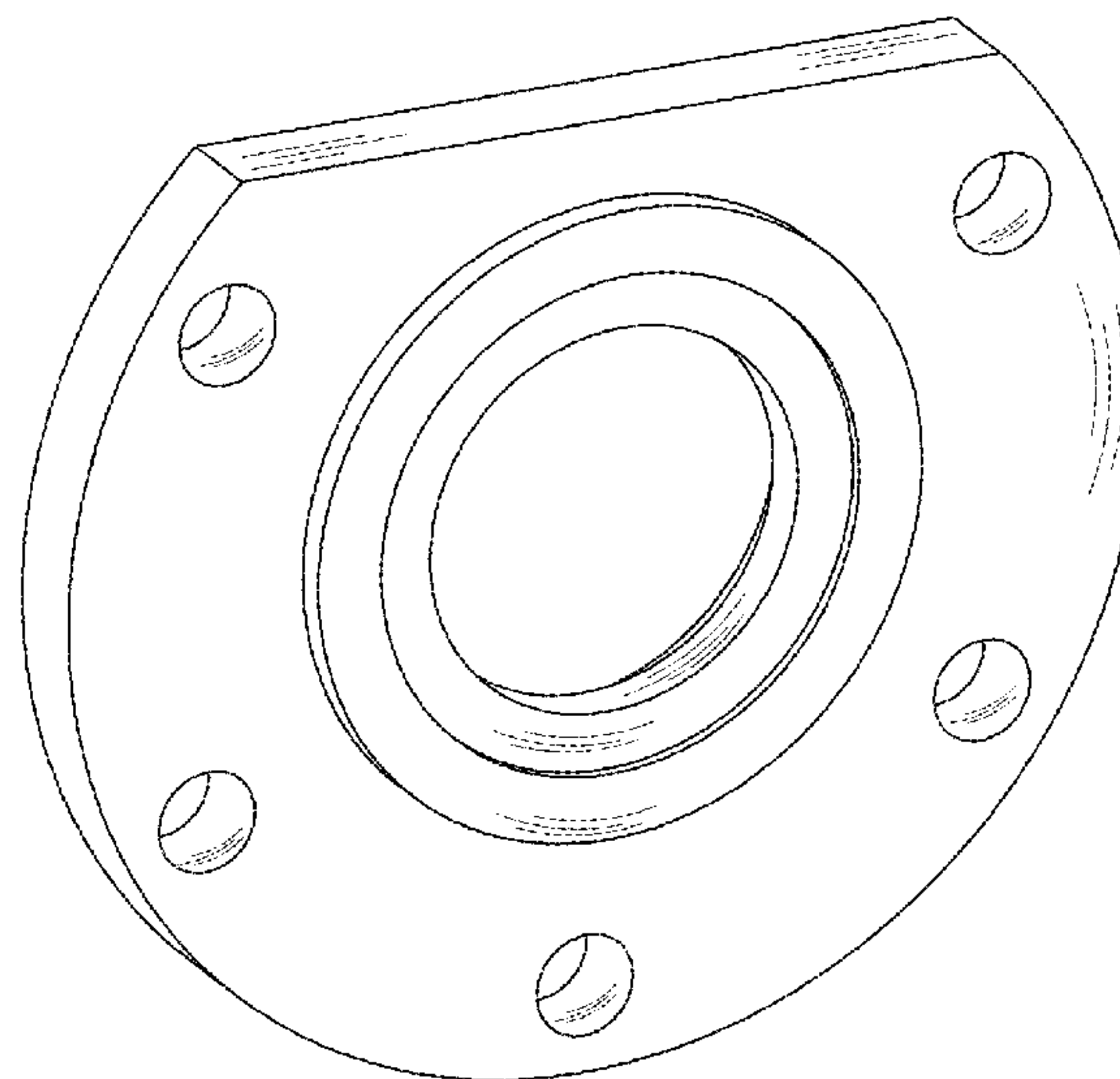
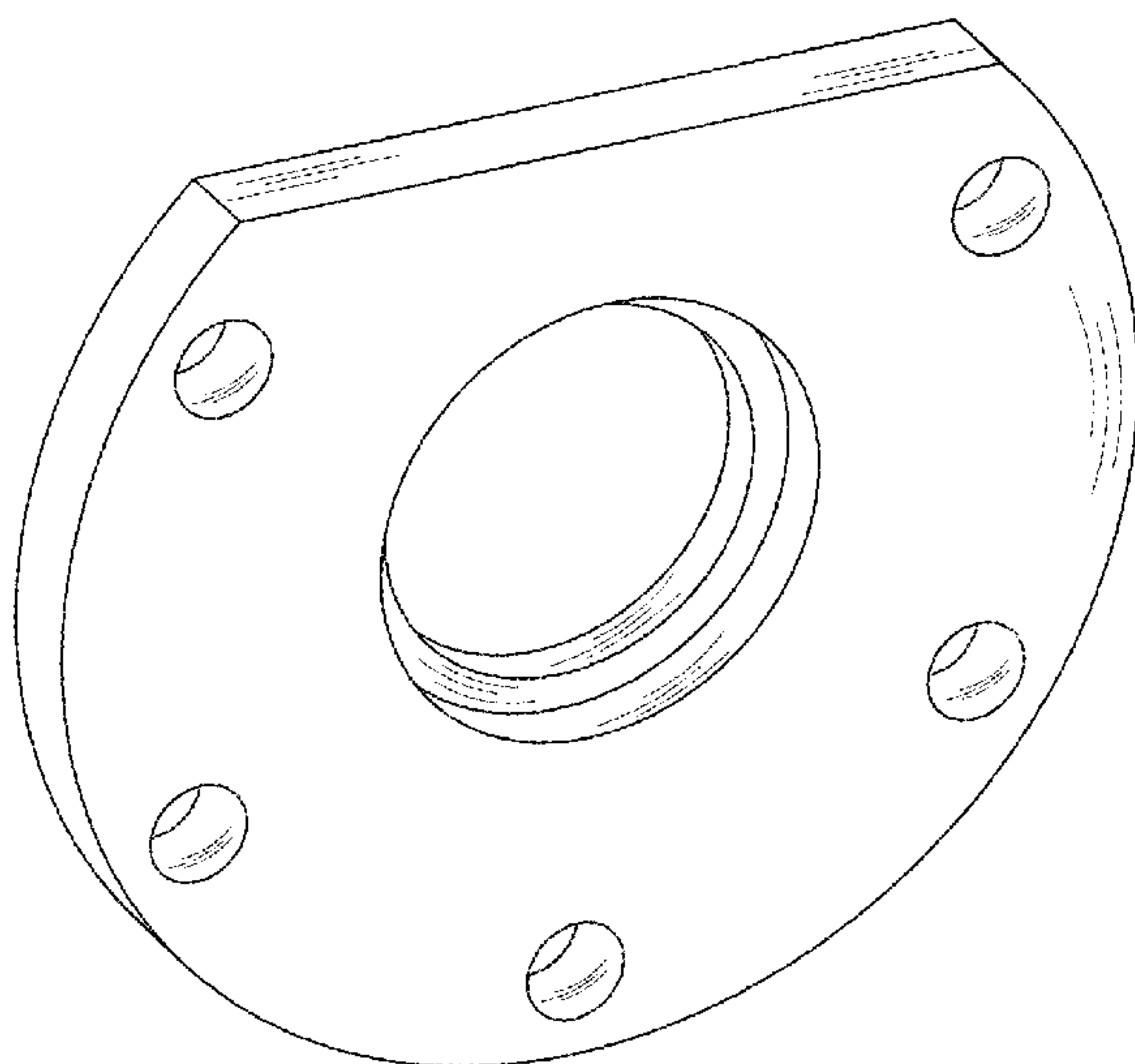

FIG. 1

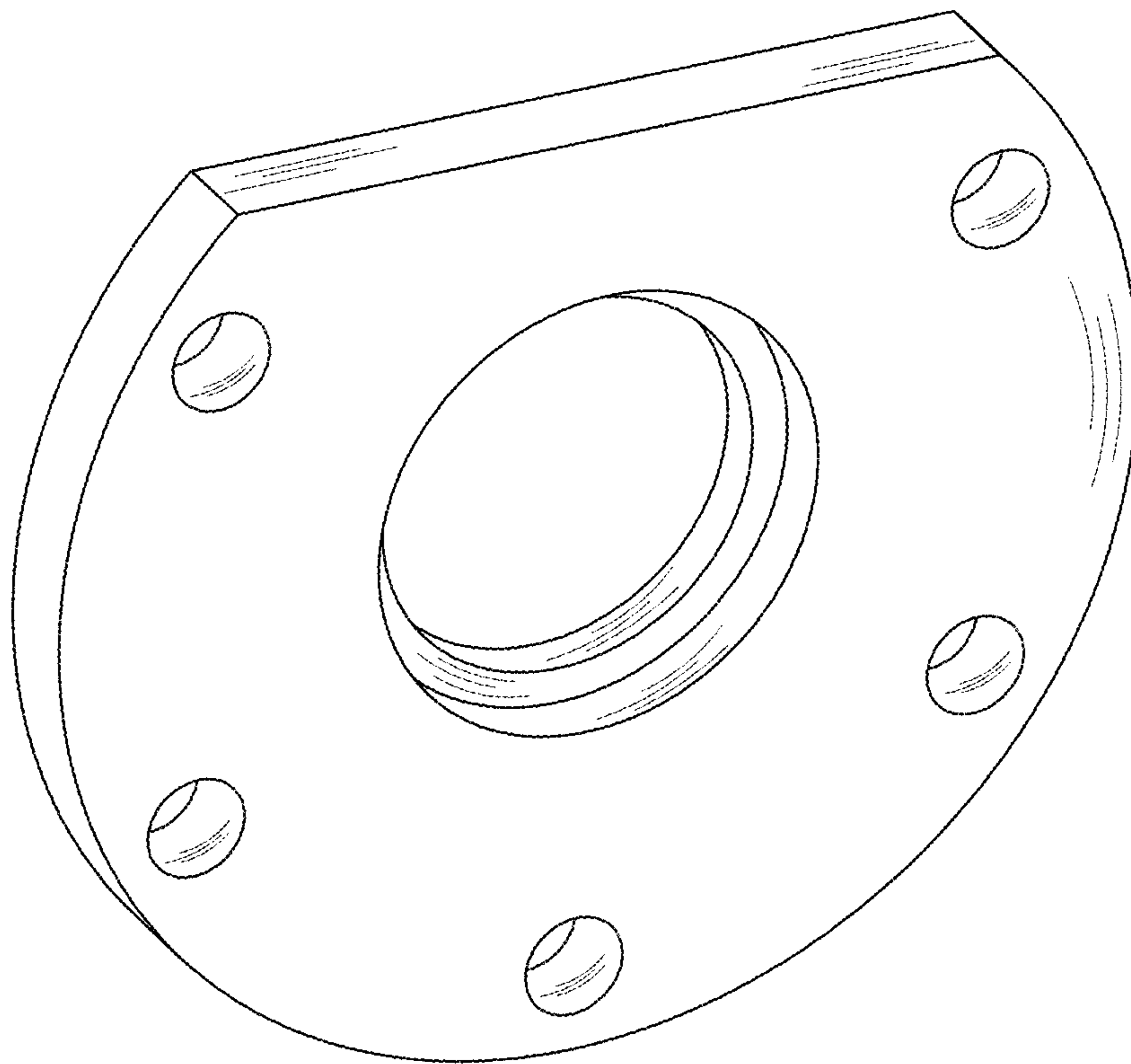

FIG. 2

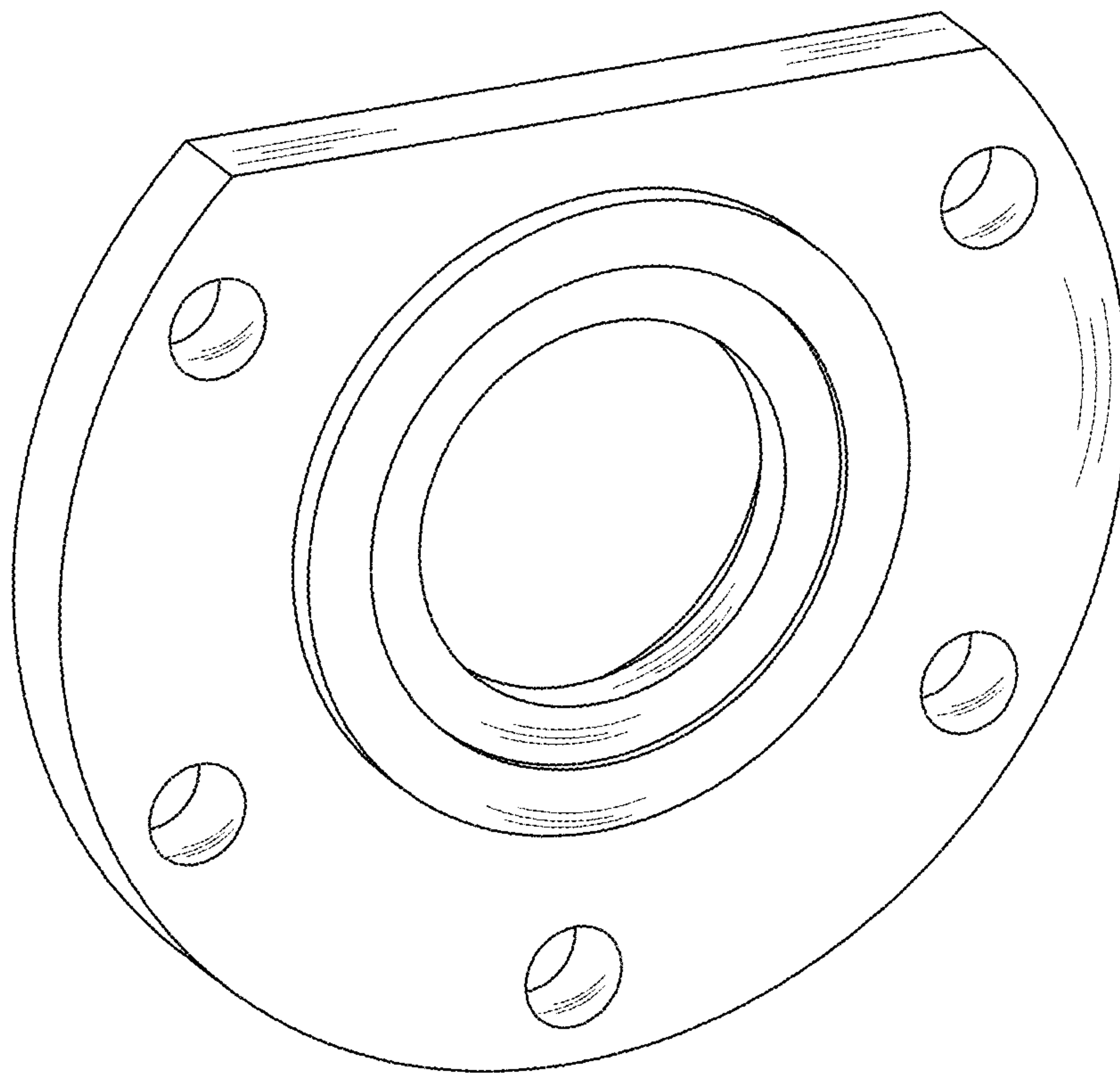

FIG. 3

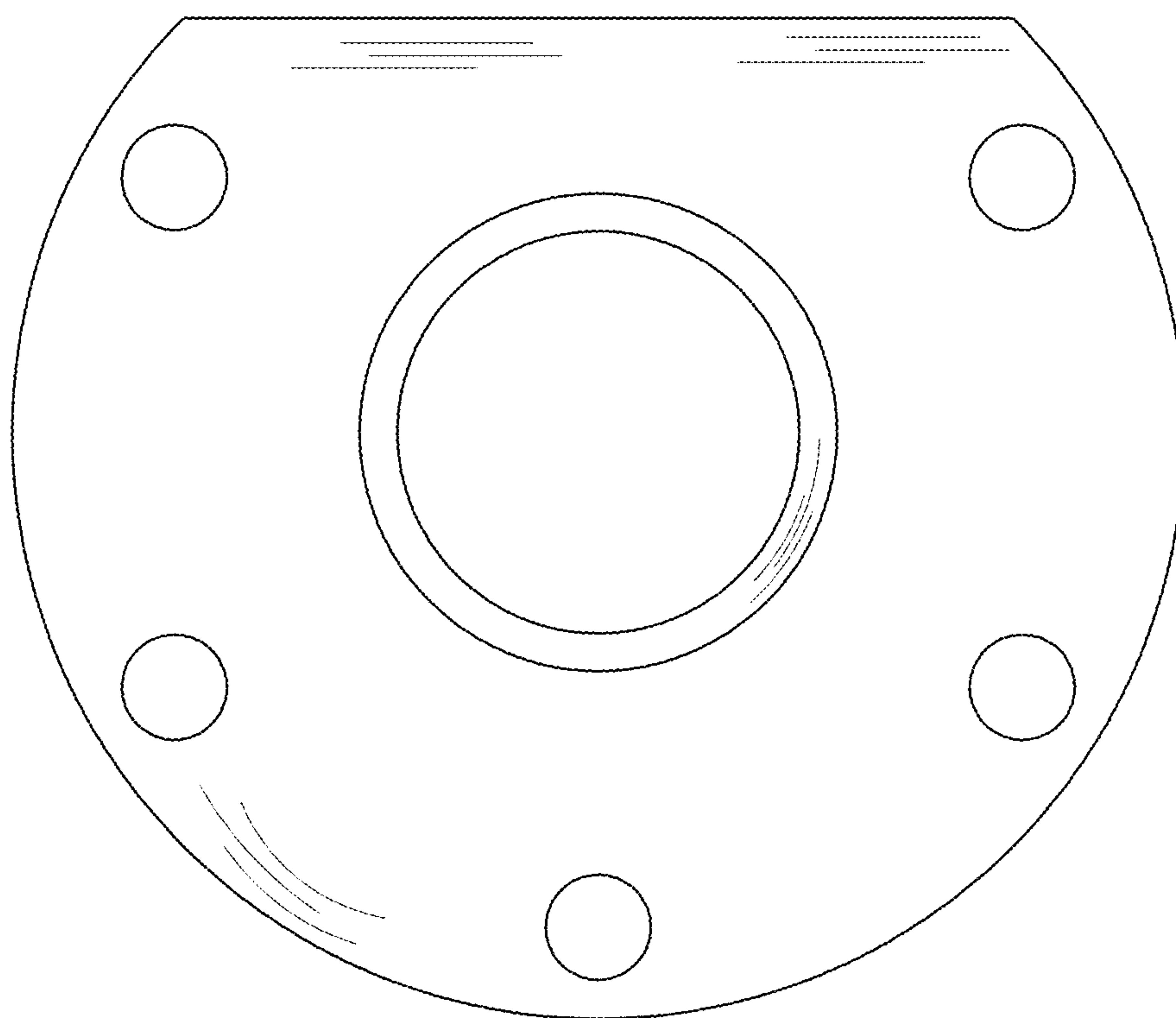

FIG. 4

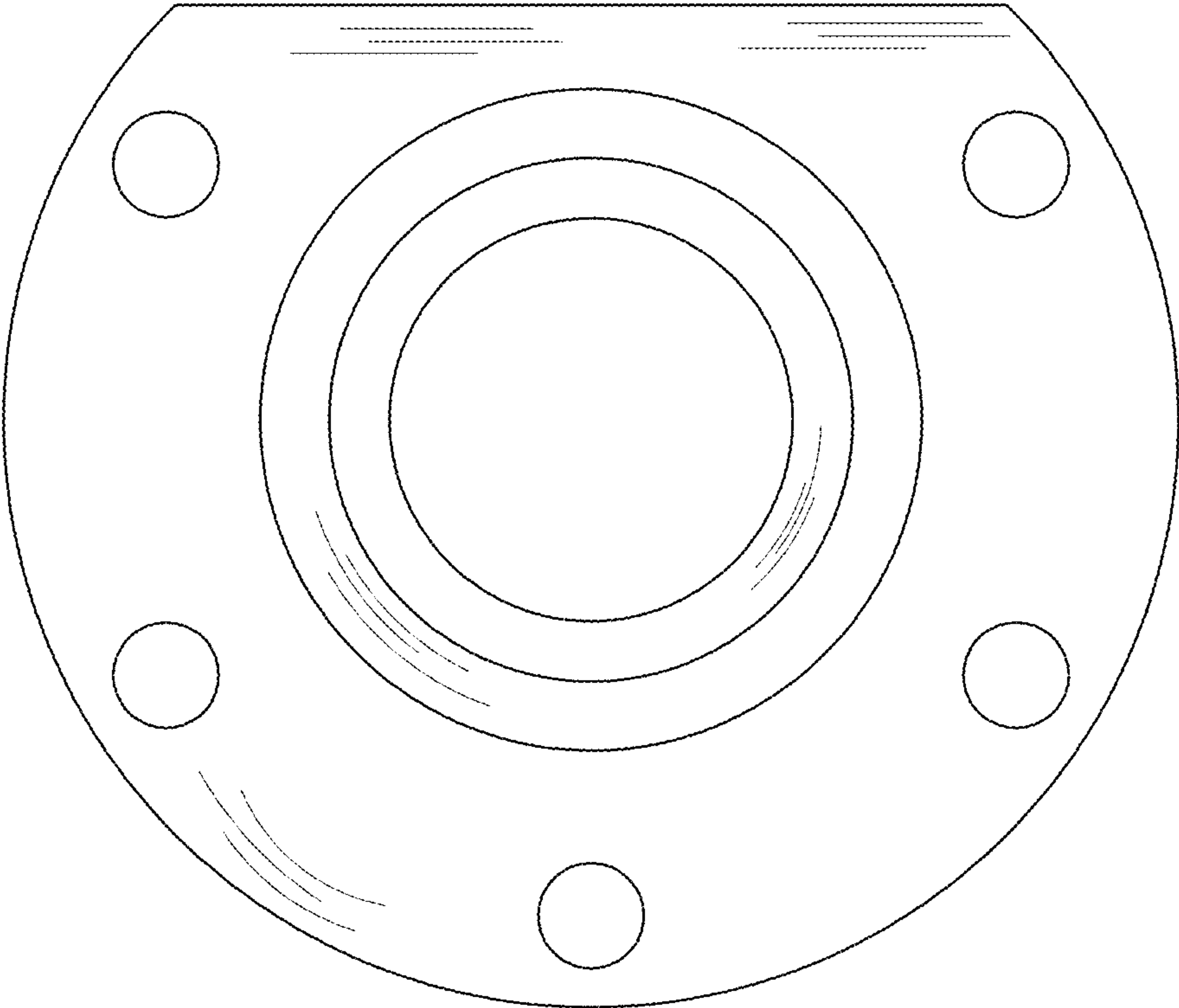

FIG. 5

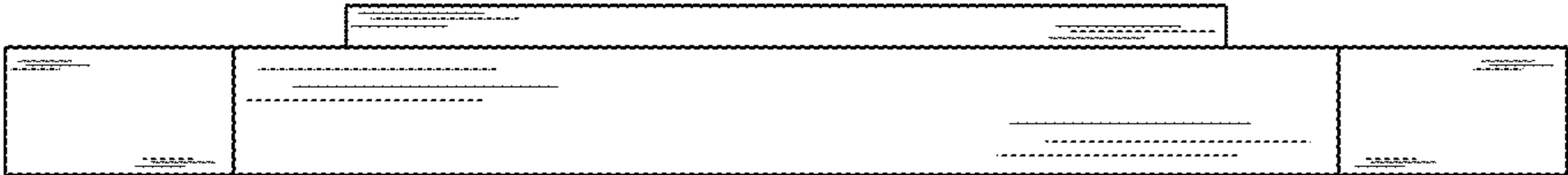

FIG. 6



FIG. 7

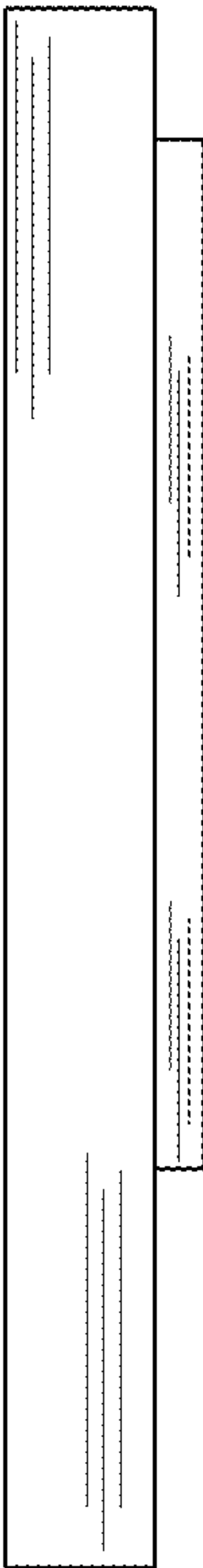

FIG. 8

