

US00D833194S

(12) **United States Design Patent** (10) **Patent No.:** **US D833,194 S**  
**Ladjavardi et al.** (45) **Date of Patent:** **\*\* Nov. 13, 2018**

(54) **MUDDLER ATTACHMENT FOR STRAW**  
(71) Applicants: **Farzad Ladjavardi**, Irvine, CA (US);  
**Bitra Mehrabani**, Irvine, CA (US);  
**Mohsen Motamedian**, Irvine, CA (US)  
(72) Inventors: **Farzad Ladjavardi**, Irvine, CA (US);  
**Bitra Mehrabani**, Irvine, CA (US);  
**Mohsen Motamedian**, Irvine, CA (US)

(\*\*) Term: **15 Years**  
(21) Appl. No.: **29/528,787**

(22) Filed: **Jun. 1, 2015**  
(51) **LOC (11) Cl.** ..... **07-06**  
(52) **U.S. Cl.**  
USPC ..... **D7/300.2; D7/682**  
(58) **Field of Classification Search**  
USPC ..... D7/300.2, 301, 305, 376, 682, 692;  
D9/436, 716, 717; D24/108, 110, 112,  
D24/116; 30/141; 215/229, 388, 389;  
239/16, 17, 24, 33; 604/35; 433/91, 96  
CPC .... A47G 21/18; A47G 21/182; A47G 21/186;  
A47J 19/04  
See application file for complete search history.

(56) **References Cited**

**U.S. PATENT DOCUMENTS**

2,613,107 A \* 10/1952 Hartnett ..... A47G 21/181  
239/33  
2,637,537 A \* 5/1953 Arthur ..... A47J 43/0711  
366/317  
2,979,267 A \* 4/1961 Miller ..... A47G 21/181  
215/388  
D211,046 S \* 5/1968 Saffran ..... D7/300.2  
D402,847 S \* 12/1998 Kinder ..... D7/300.2  
6,223,651 B1 \* 5/2001 Campbell ..... A23L 13/72  
452/146  
D488,339 S \* 4/2004 Lee ..... D7/300.2

D600,510 S \* 9/2009 Courington ..... D7/688  
D649,389 S \* 11/2011 Bickert ..... D7/300.2  
D720,967 S \* 1/2015 Melzer ..... D7/669  
2006/0291191 A1 \* 12/2006 Vanderschuit ..... A47G 21/182  
362/101

(Continued)

**OTHER PUBLICATIONS**

“Stainless Steel Muddler”. Found online Mar. 9, 2016 at worldmarket.com. Page dated Apr. 12, 2014. Retrieved from <http://www.worldmarket.com/product/stainless-steel-muddler.do>.\*

(Continued)

*Primary Examiner* — George D. Kirschbaum  
*Assistant Examiner* — Kendra Leslie Hamilton  
(74) *Attorney, Agent, or Firm* — Kafantaris Law Offices;  
Theo Kafantaris

(57) **CLAIM**

The ornamental design for a muddler attachment for straw, as shown and described.

**DESCRIPTION**

FIG. 1 is a front isometric view of the muddler attachment for straw showing my new design;  
FIG. 2 is a front dimetric view thereof;  
FIG. 3 is a front trimetric view thereof;  
FIG. 4 is a front isometric view thereof, in condition of use;  
FIG. 5 is a front isometric cross-sectional view of FIG. 1, taken along line 5-5 of FIG. 9;  
FIG. 6 is a front isometric cross-sectional view thereof, taken along line 5-5 of FIG. 9, in condition of use;  
FIG. 7 is a front elevation view of FIG. 1;  
FIG. 8 is a rear elevation view thereof;  
FIG. 9 is a top plan view thereof; and,  
FIG. 10 is a bottom plan view thereof.  
The broken line showing of a straw in FIGS. 4 & 6 represent unclaimed environmental subject matter and forms no part of the claim.

**1 Claim, 10 Drawing Sheets**

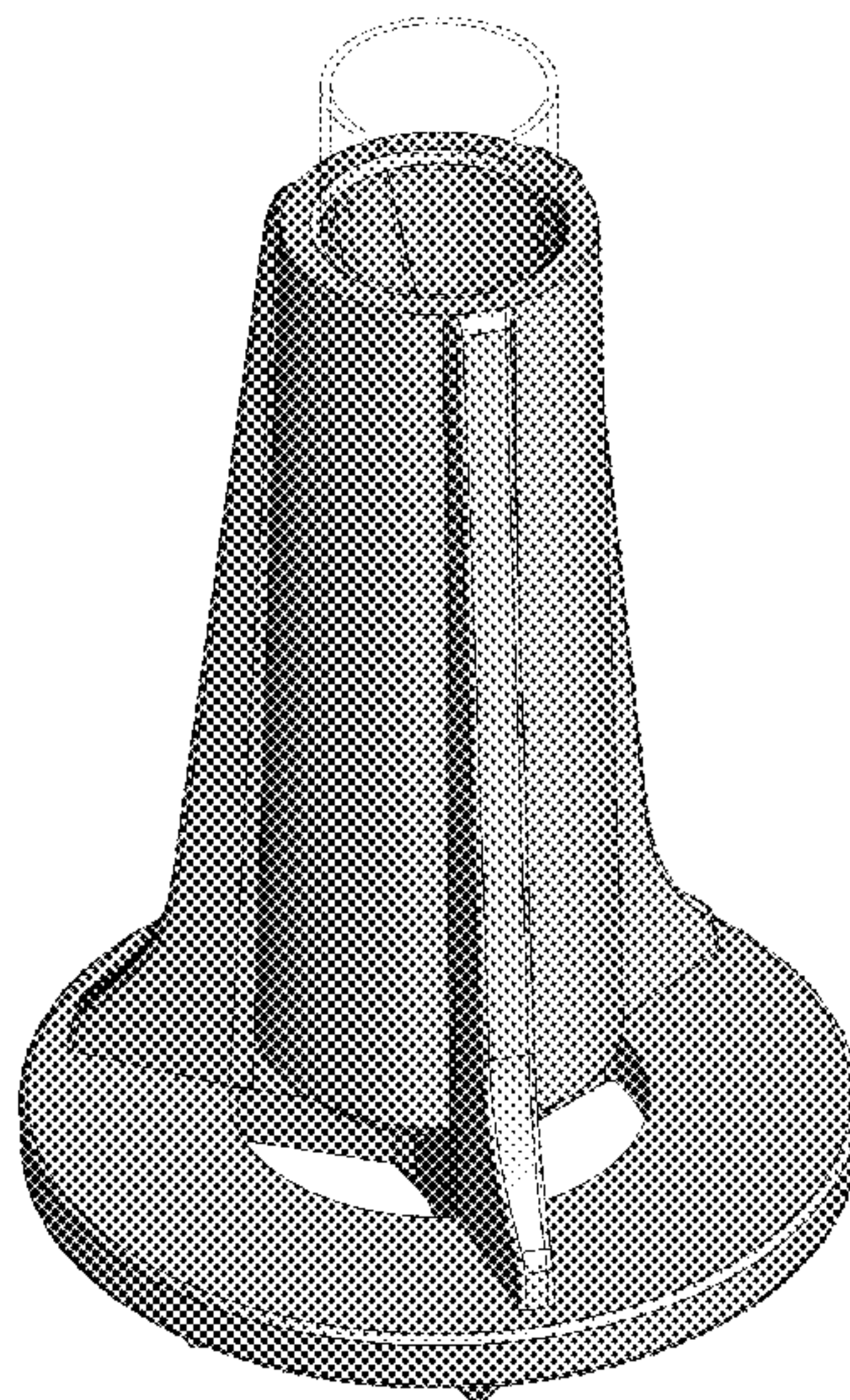

(56)

**References Cited**

U.S. PATENT DOCUMENTS

2007/0211562 A1\* 9/2007 Pitsis ..... A47G 21/181  
366/129  
2011/0041348 A1\* 2/2011 Silvers ..... A47J 43/28  
30/276

OTHER PUBLICATIONS

“Mastrad Cocktail Muddler Straws”. Found online Mar. 8, 2016 at amazon.com. Page dated Apr. 14, 2014. Retrieved from <http://www.amazon.com/Mastrad-A01156-Cocktail-Muddler-Straws/dp/B00JH03MIG>.\*

“Wooden Muddler—Stock Image”. Found online Jan. 23, 2015 at depositphotos.com. Page dated Feb. 25, 2010. Retrieved from <http://depositphotos.com/2331163/stock-photo-wooden-muddler.html?sqc=0&sqm=89&sq=424s6d>.\*

“Halloween Head Gear: Shrek Costume”. Found online Mar. 9, 2016 at foundation08.blogspot.com. Page dated Oct. 21, 2010. Retrieved from <http://foundation08.blogspot.com/2010/10/halloween-head-gear-shrek-costume.html>.\*

\* cited by examiner



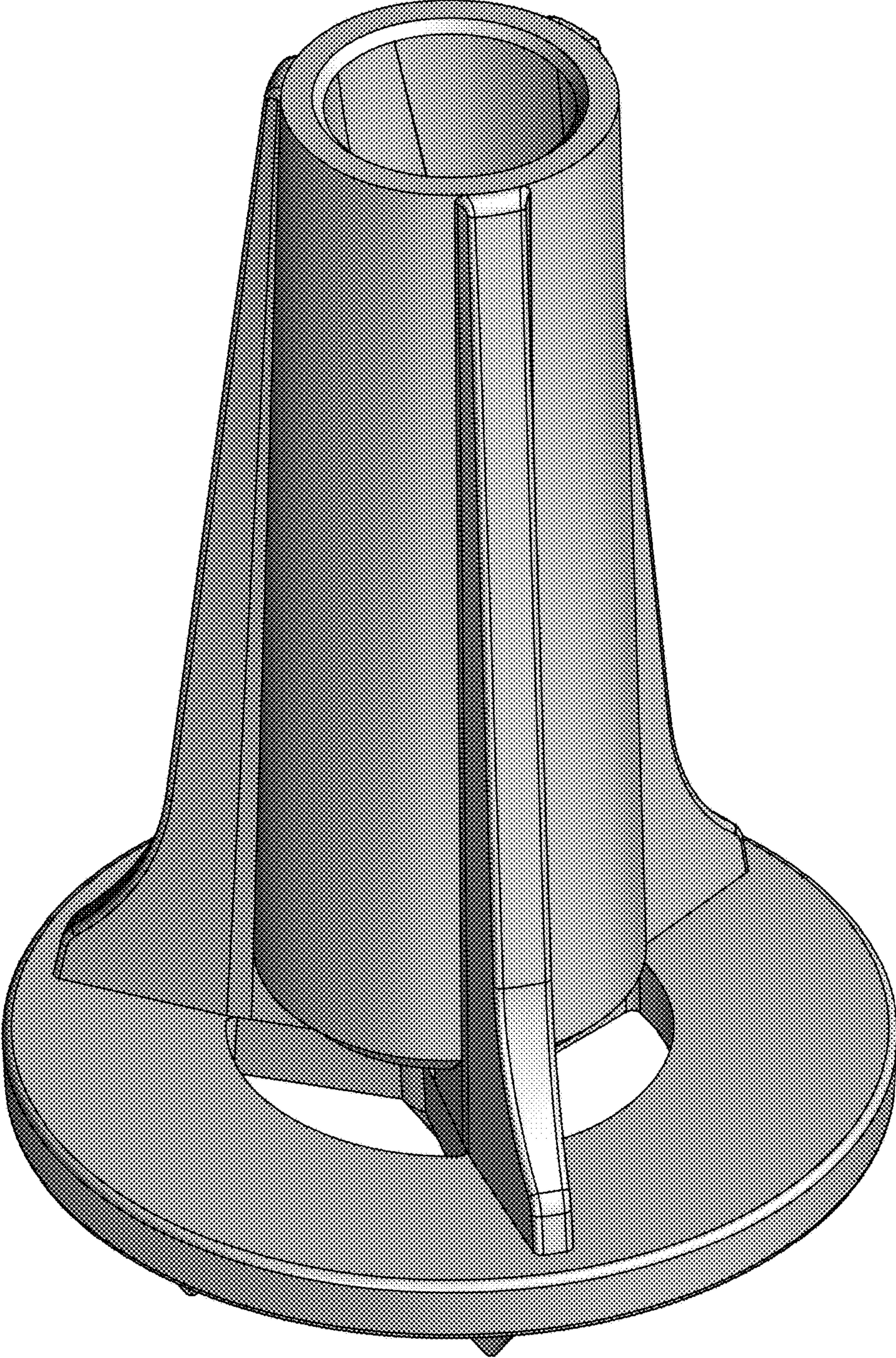

FIG. 1



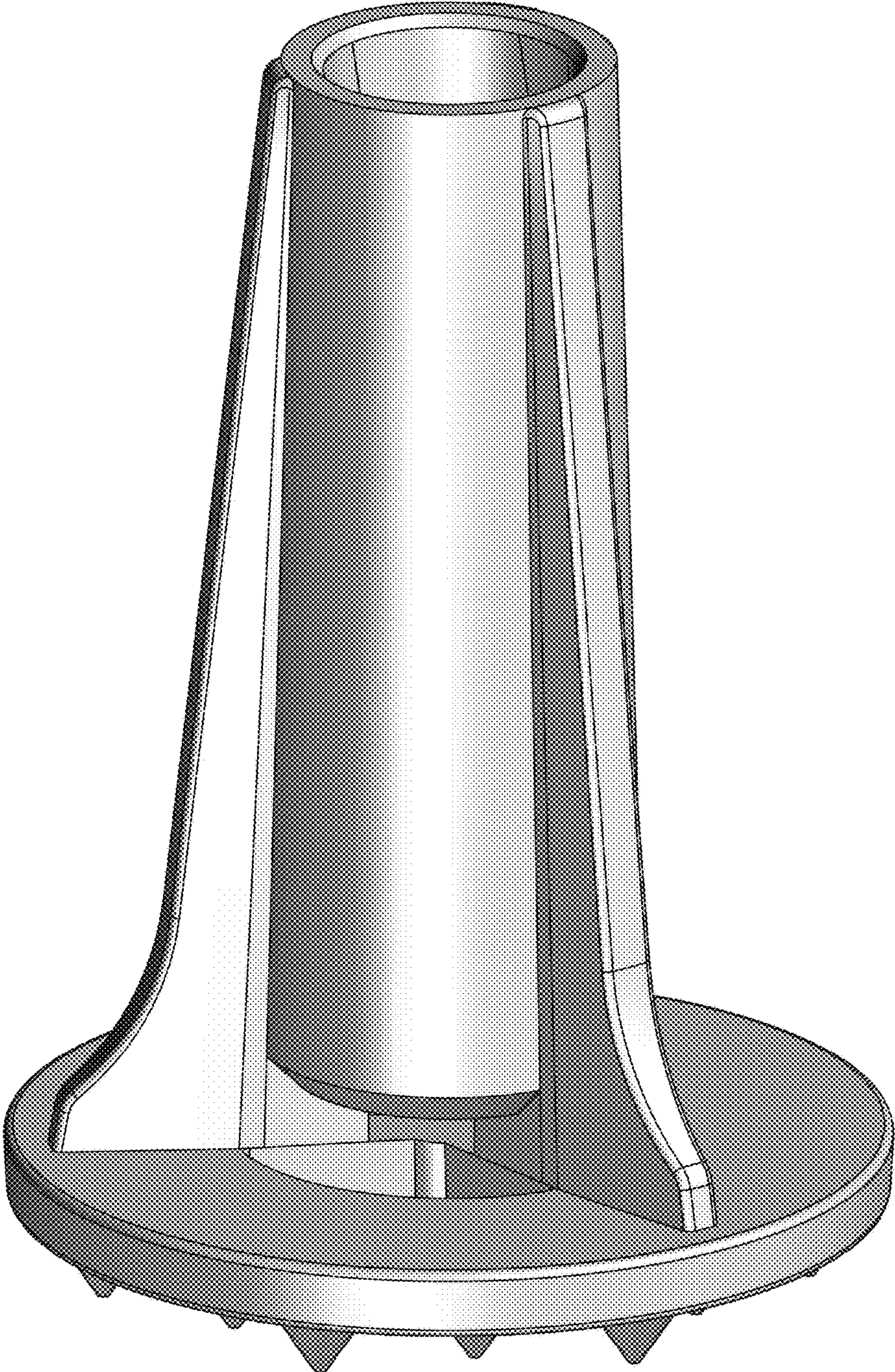

FIG. 2



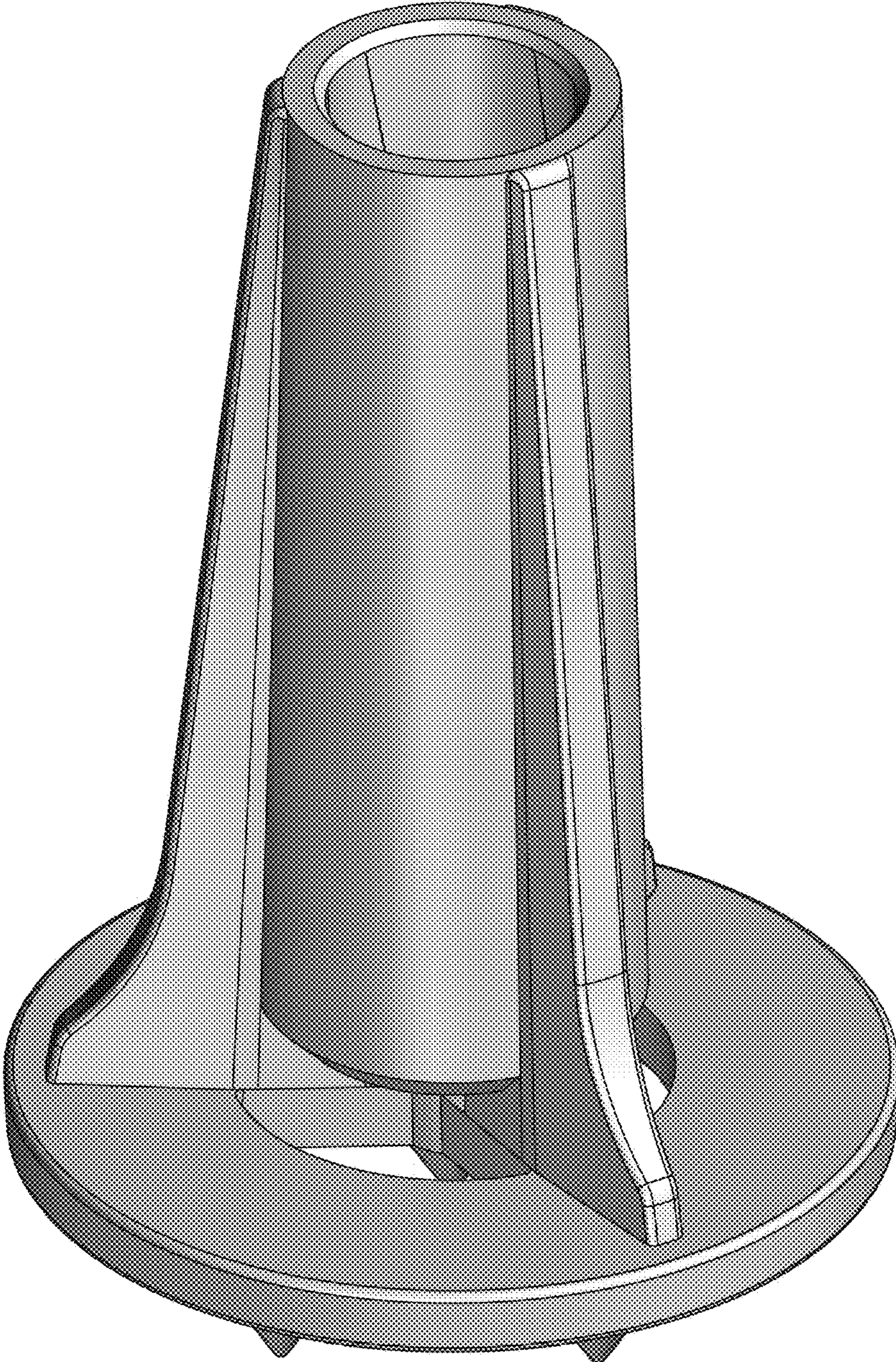

FIG. 3



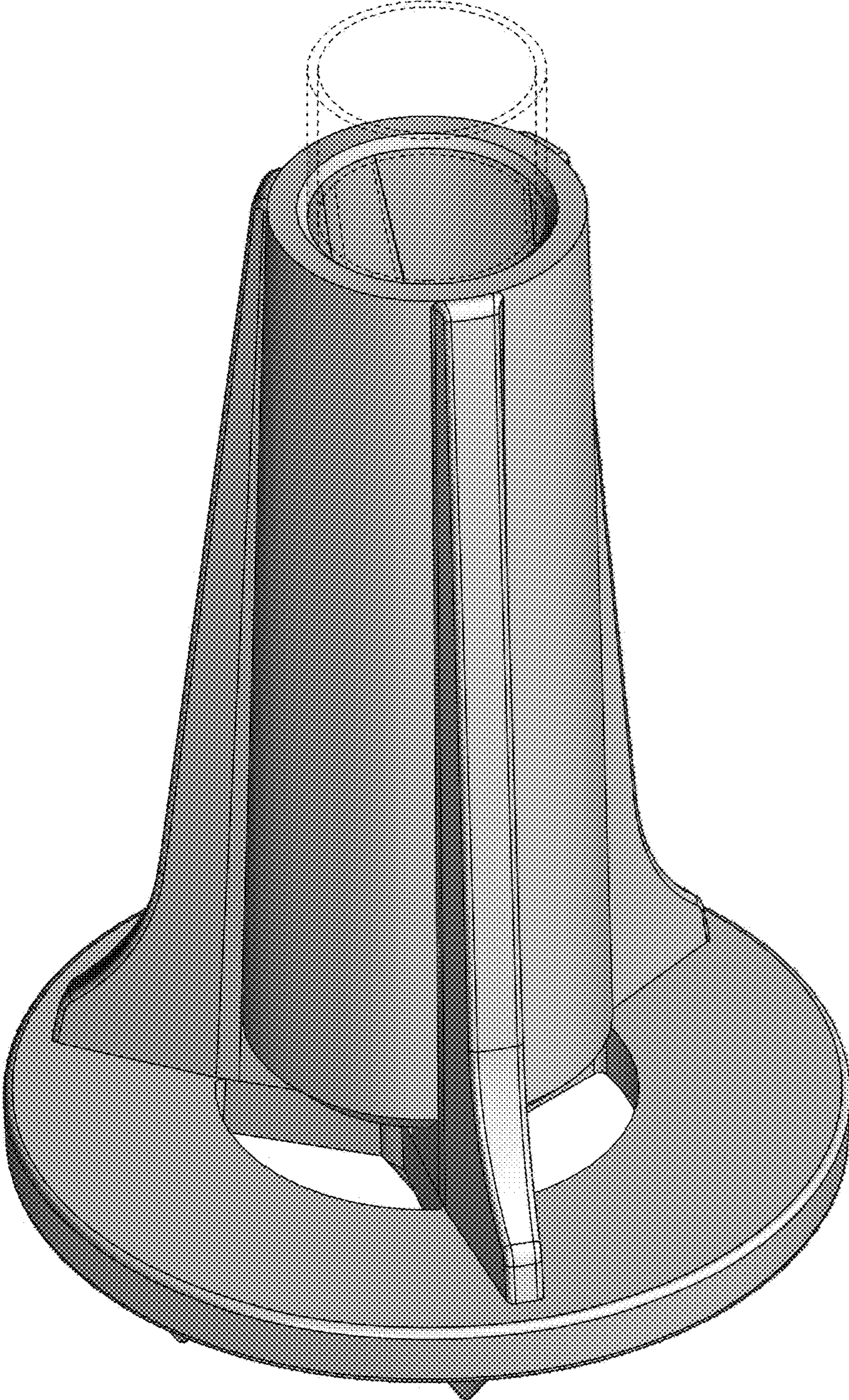

FIG. 4



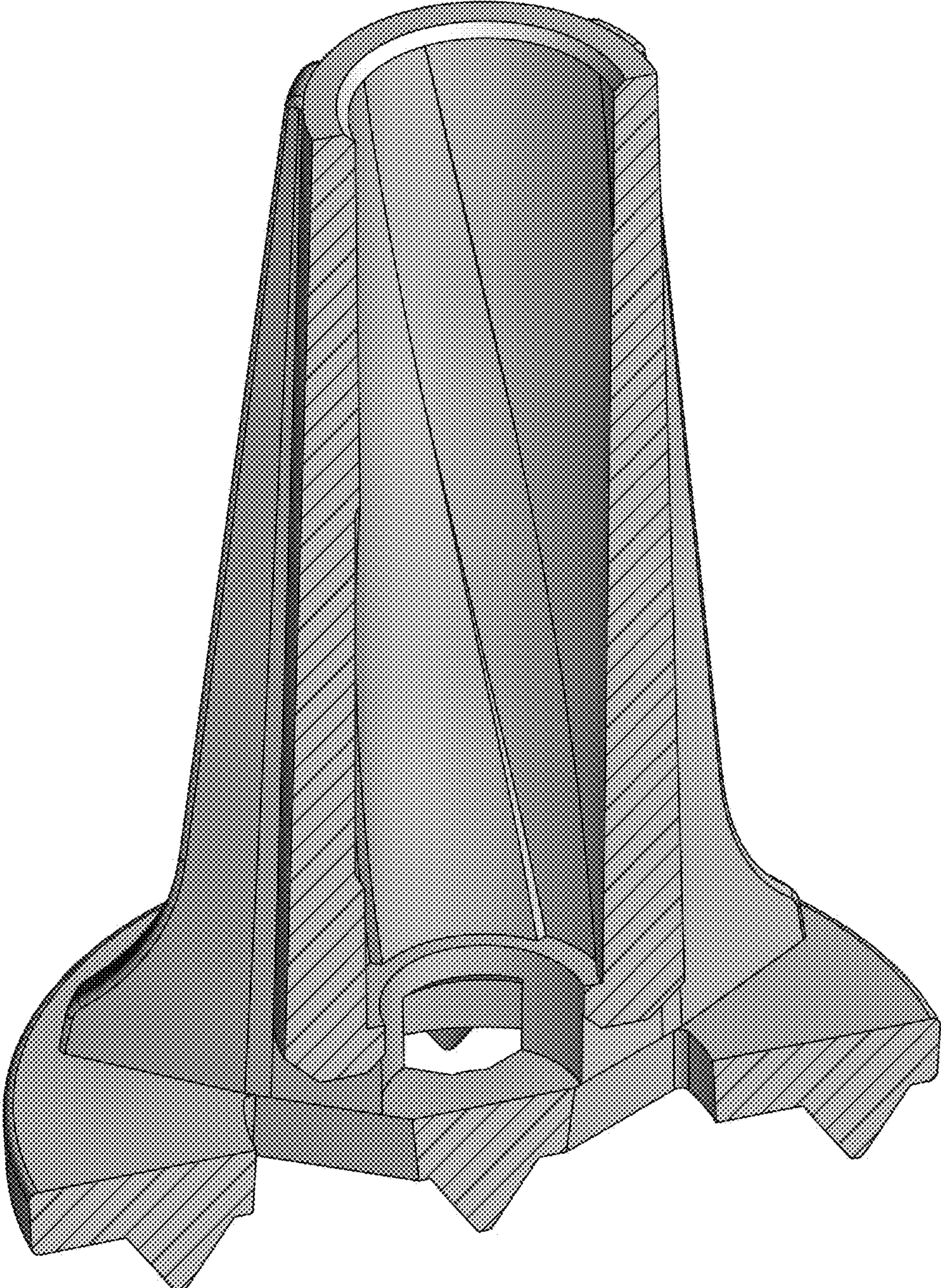

FIG. 5



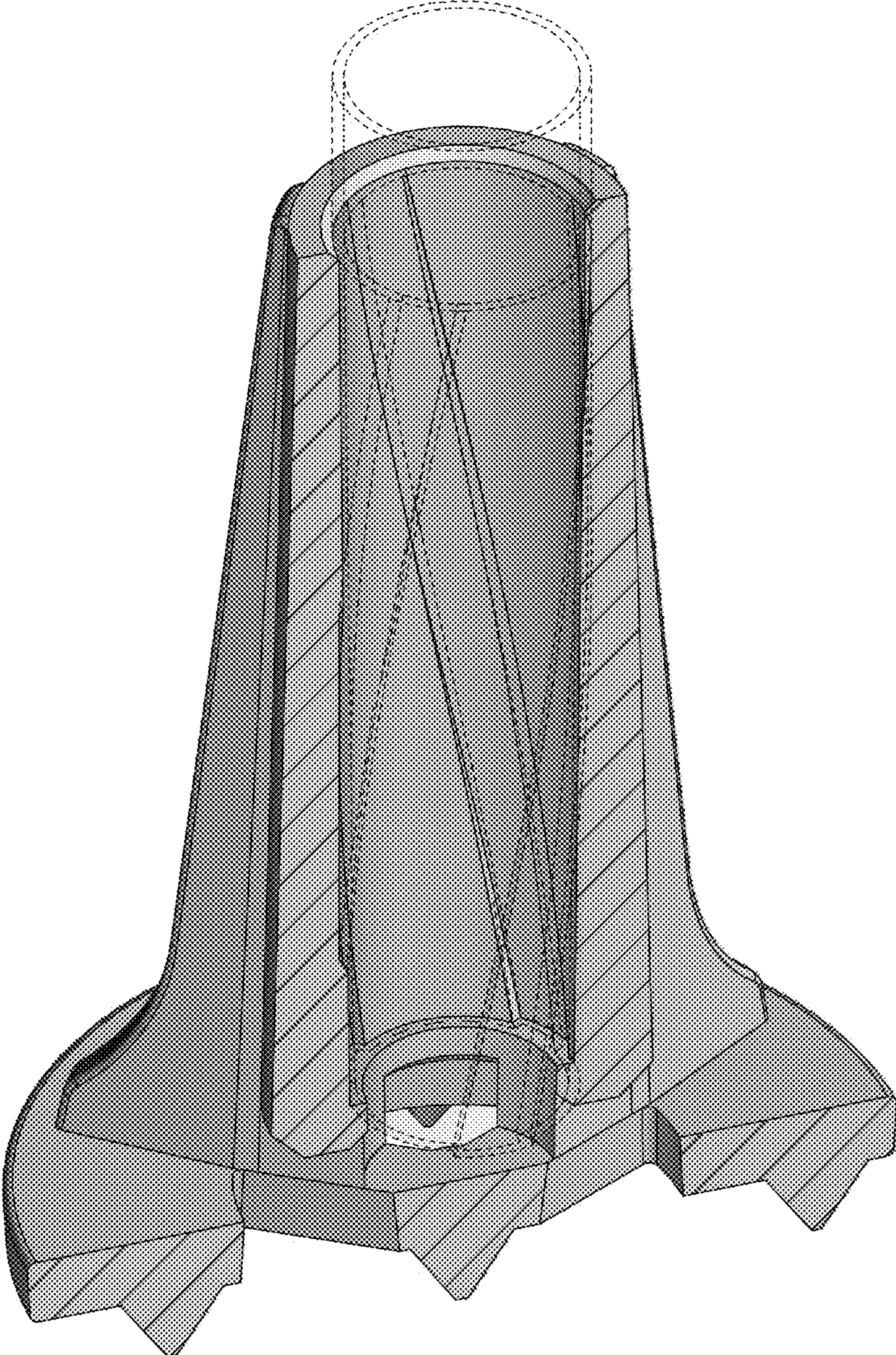

FIG. 6



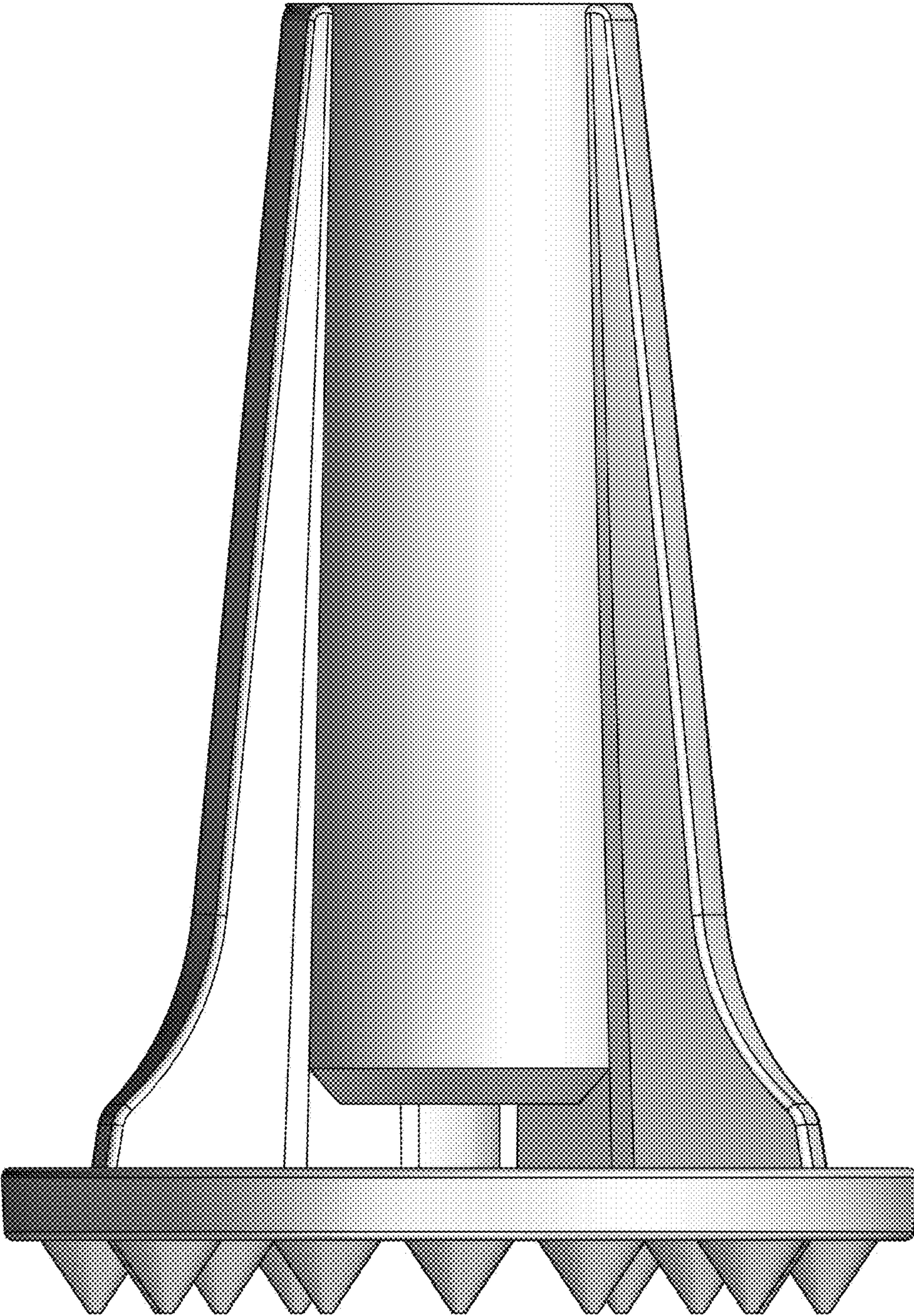

FIG. 7



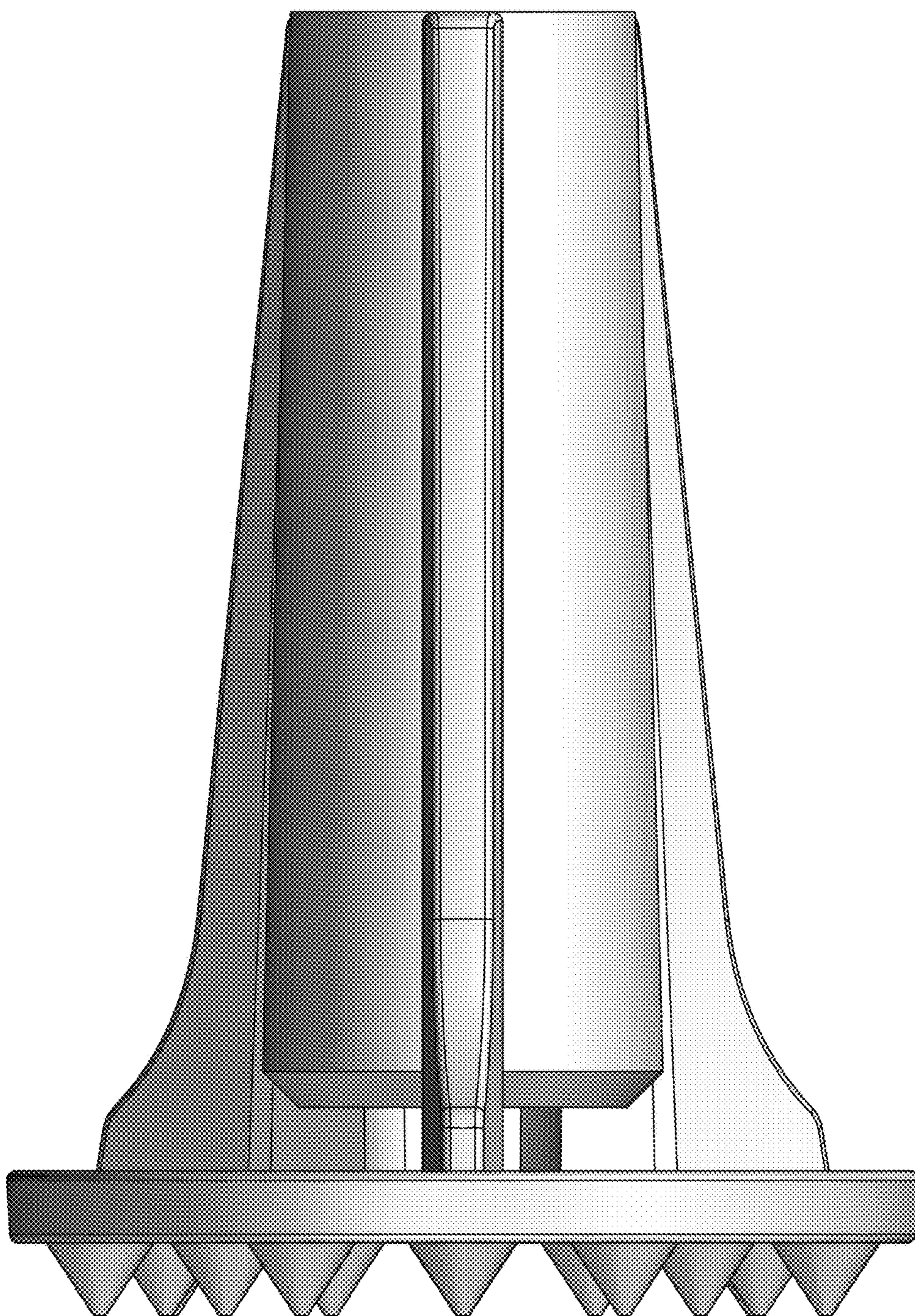

FIG. 8



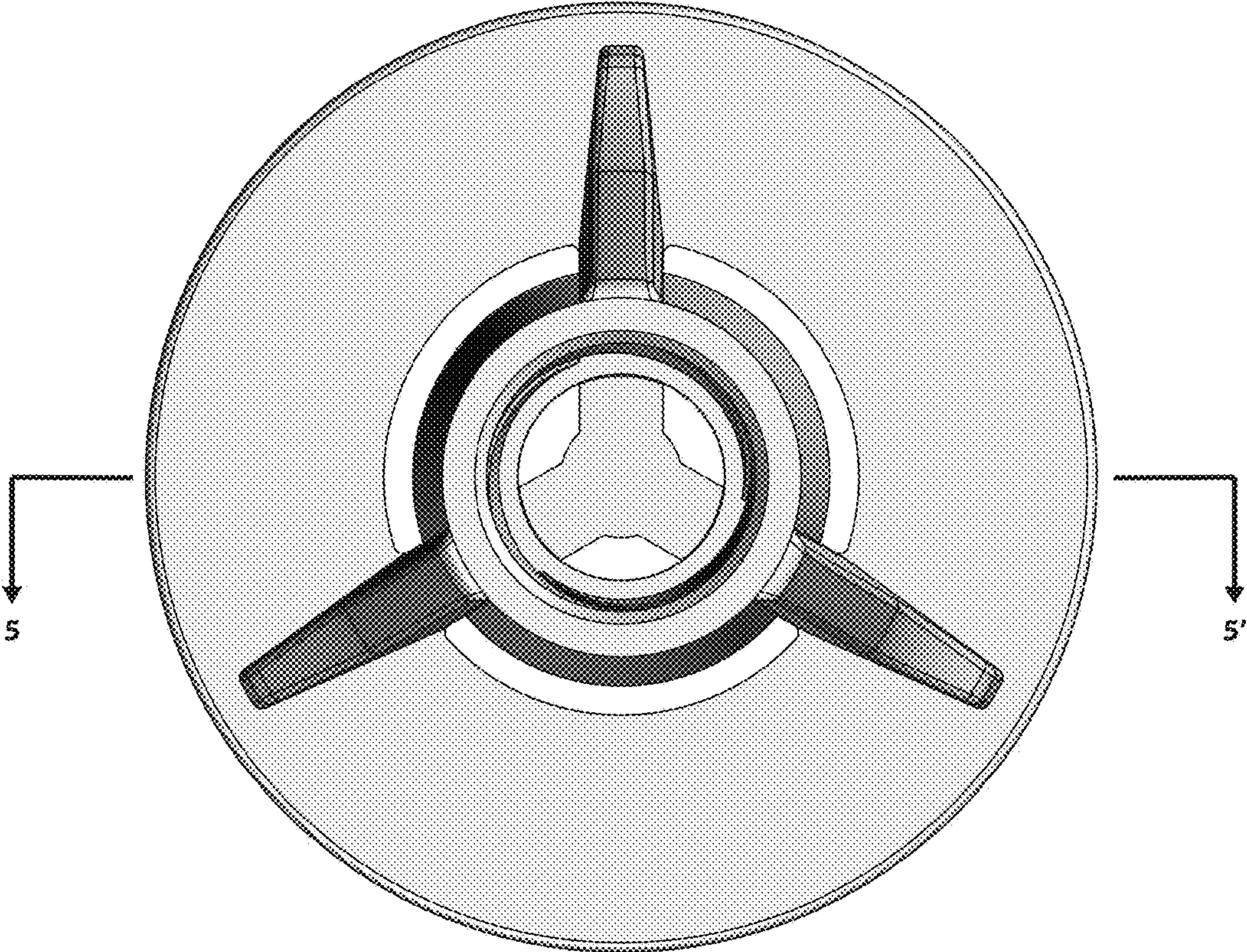

FIG. 9



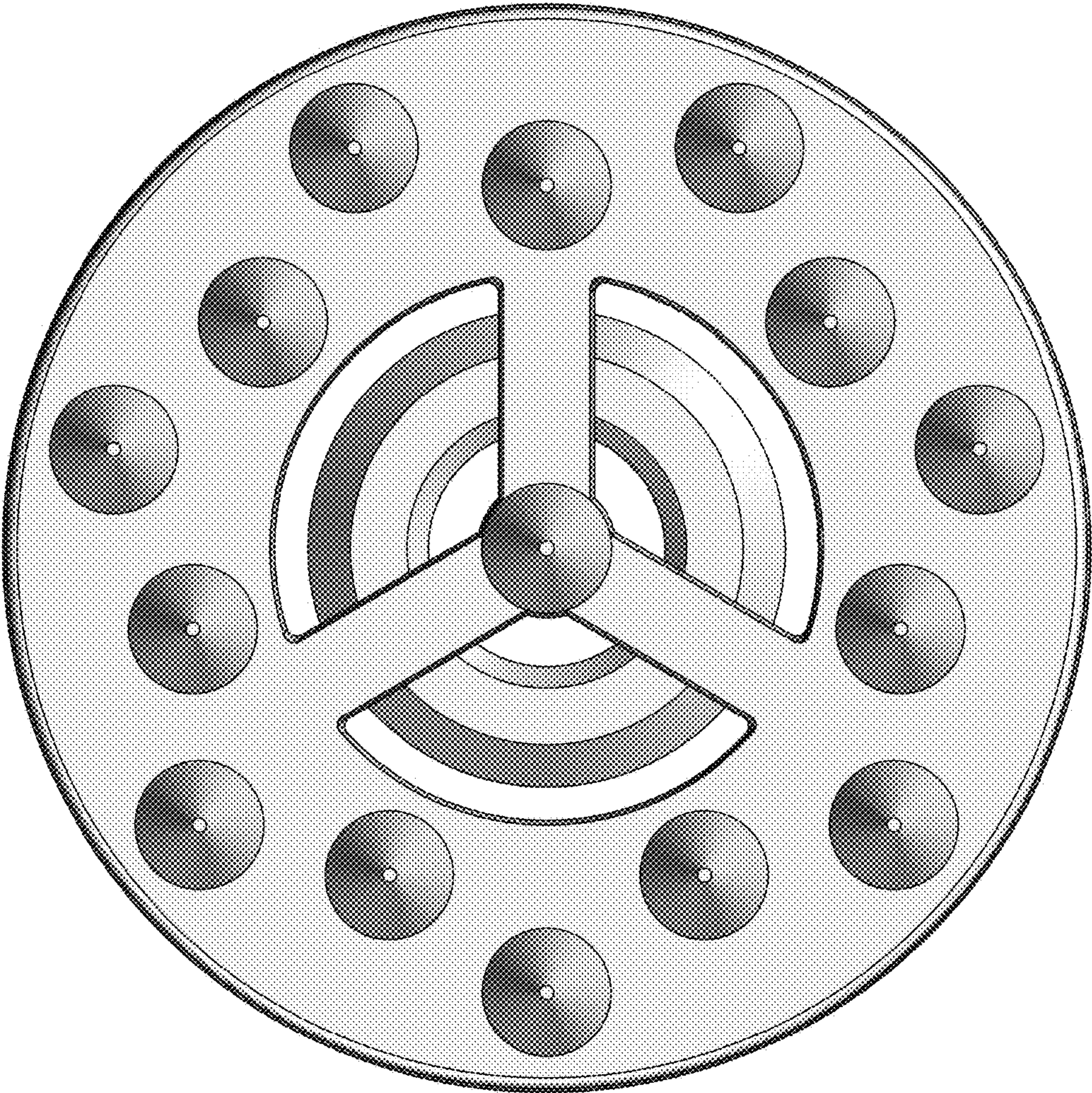

FIG. 10