



US00D832979S

(12) **United States Design Patent**
Scaramucci et al.

(10) **Patent No.:** **US D832,979 S**
(45) **Date of Patent:** **** Nov. 6, 2018**

(54) VALVE BODY	3,516,638 A	6/1970	Piggott	
	3,620,243 A *	11/1971	Zatopek	F16K 5/205 137/246.22
(71) Applicant: Valve Innovations, LLC , Oklahoma City, OK (US)	4,188,015 A *	2/1980	Halpine	F16K 5/0684 251/172
(72) Inventors: John P. Scaramucci , Oklahoma City, OK (US); Danny R. Lowe , Oklahoma City, OK (US)	4,548,067 A	10/1985	Cox	
	4,840,057 A	6/1989	Bingham	
	4,852,387 A	8/1989	Bingham	
	4,887,644 A	12/1989	Jeromson et al.	
	5,000,223 A *	3/1991	Scaramucci	F16K 15/03 137/515.7
(73) Assignee: Valve Innovations, LLC , Oklahoma City, OK (US)	5,152,503 A	10/1992	Conway	
	5,293,903 A	3/1994	Appelwick	
	5,735,307 A	4/1998	Charron	
(**) Term: 15 Years				(Continued)

(21) Appl. No.: **29/637,307**

(22) Filed: **Feb. 15, 2018**

Related U.S. Application Data

(62) Division of application No. 29/570,195, filed on Jul. 6, 2016, now Pat. No. Des. 822,796.

(51) **LOC (11) Cl.** **23-01**

(52) **U.S. Cl.**
USPC **D23/233**

(58) **Field of Classification Search**
USPC D23/233–250; 137/118.04, 498, 516.11, 137/597, 602, 533.11, 625.46, 270, 887, 137/876, 599.11, 10, 12, 15.18, 515.7, 137/385, 246.22, 329.06; 73/1.72; 251/315.01, 213, 292, 301, 180, 315.14, 251/175, 172

CPC F16K 27/067; F16K 31/52425
See application file for complete search history.

(56) **References Cited**

U.S. PATENT DOCUMENTS

2,853,267 A *	9/1958	Herren	F16K 1/2285 251/175
3,290,001 A *	12/1966	Taylor	F16K 1/226 137/329.06
3,345,032 A	10/1967	Rawstron	

OTHER PUBLICATIONS

“Evans Ball Valves—Process Cooling Water System” Product Brochure, Evans Components, Inc. Retrieved from the Internet: <http://evanscomponents.com/PCWSFP.html>.

Primary Examiner — Cynthia Ramirez

Assistant Examiner — Gino Colan

(57) **CLAIM**

The ornamental design for a valve body, as shown and described.

DESCRIPTION

FIG. 1 is a perspective view of a valve body showing our new design.

FIG. 2 is a front elevational view thereof.

FIG. 3 is a rear elevational view thereof.

FIG. 4 is a side elevational view thereof.

FIG. 5 is a side elevational view of a side opposite that shown in FIG. 4.

FIG. 6 is a top plan view thereof; and,

FIG. 7 is a bottom plan view thereof.

The broken lines represent environment that forms no part of the claim.

1 Claim, 4 Drawing Sheets

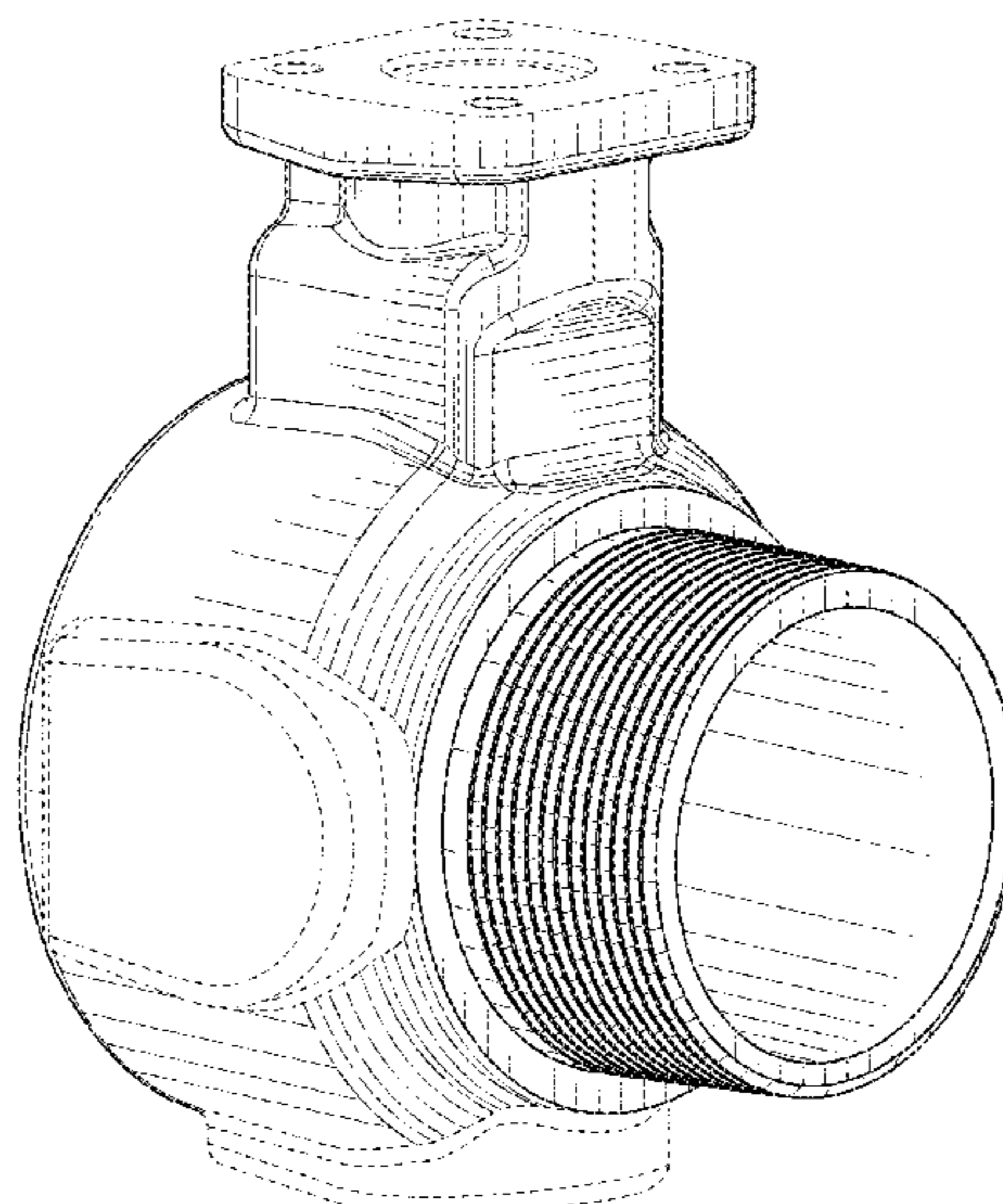

(56)

References Cited

U.S. PATENT DOCUMENTS

8,113,230	B2 *	2/2012	Vuojamo	F16K 5/0642 137/385
D678,471	S	3/2013	Sisk	
D692,099	S	10/2013	Freeth	
D746,948	S	1/2016	Hemman et al.	
9,964,226	B2 *	5/2018	Scaramucci	F16K 5/0647
D822,796	S *	7/2018	Scaramucci	D23/233
2007/0256746	A1	11/2007	Chang	
2008/0179558	A1	7/2008	Lloyd	
2009/0146093	A1	6/2009	Hartman et al.	
2013/0062546	A1	3/2013	Saldivar et al.	
2014/0116540	A1	5/2014	Waldor	
2015/0097132	A1	4/2015	Fan	
2015/0137020	A1	5/2015	Fan	
2017/0343118	A1	11/2017	Balan	

* cited by examiner

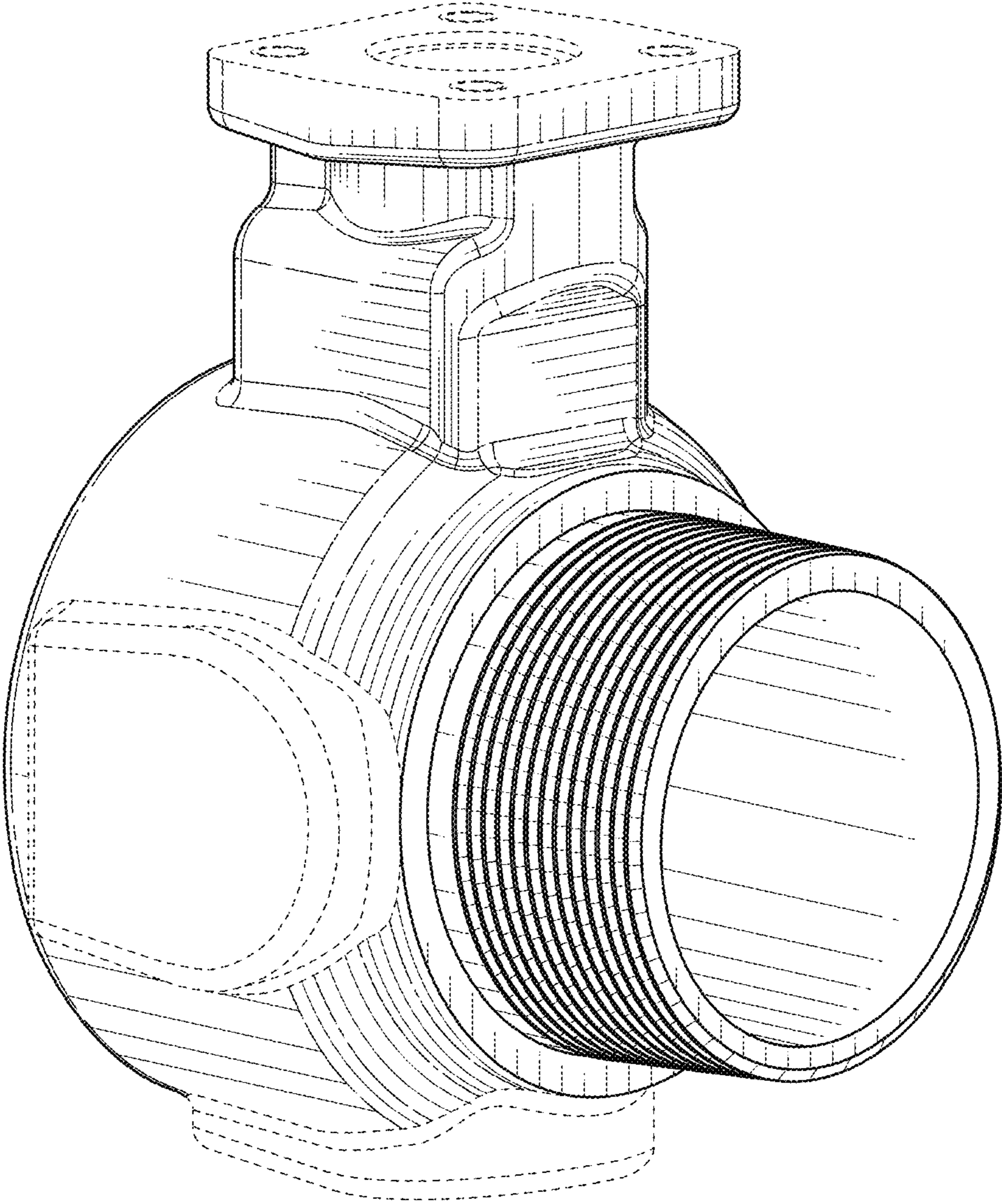

FIG. 1

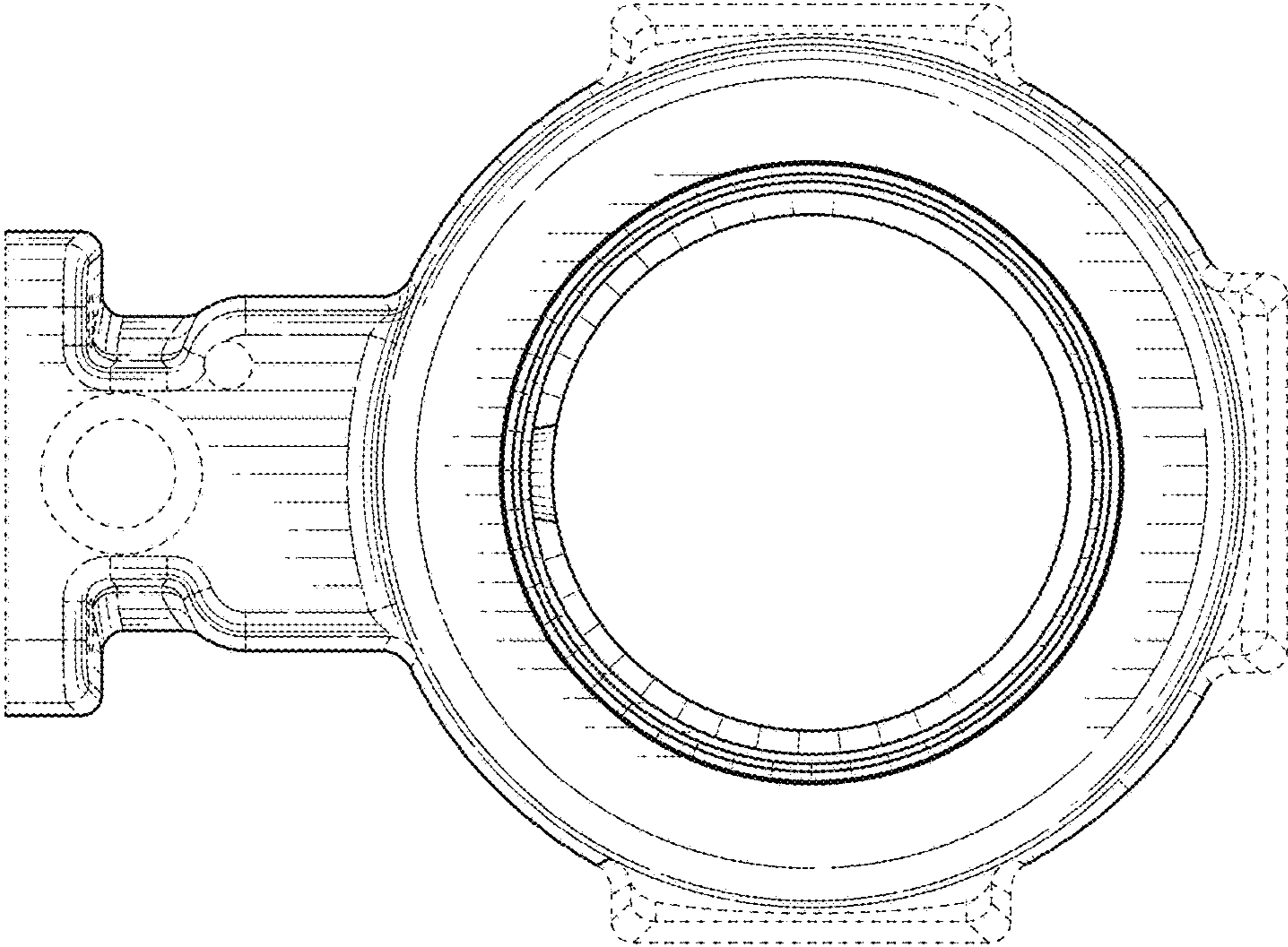

FIG. 3

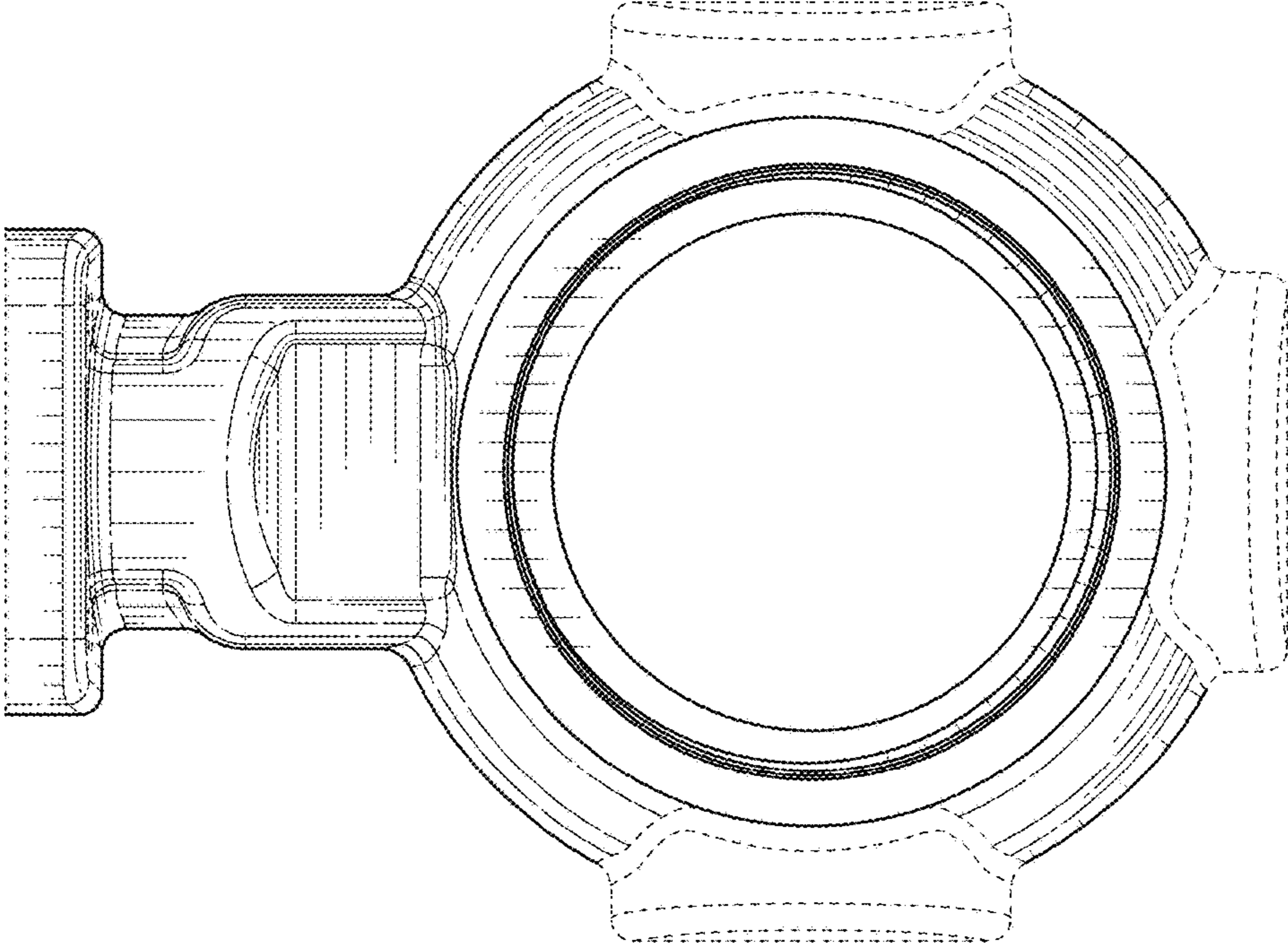

FIG. 2

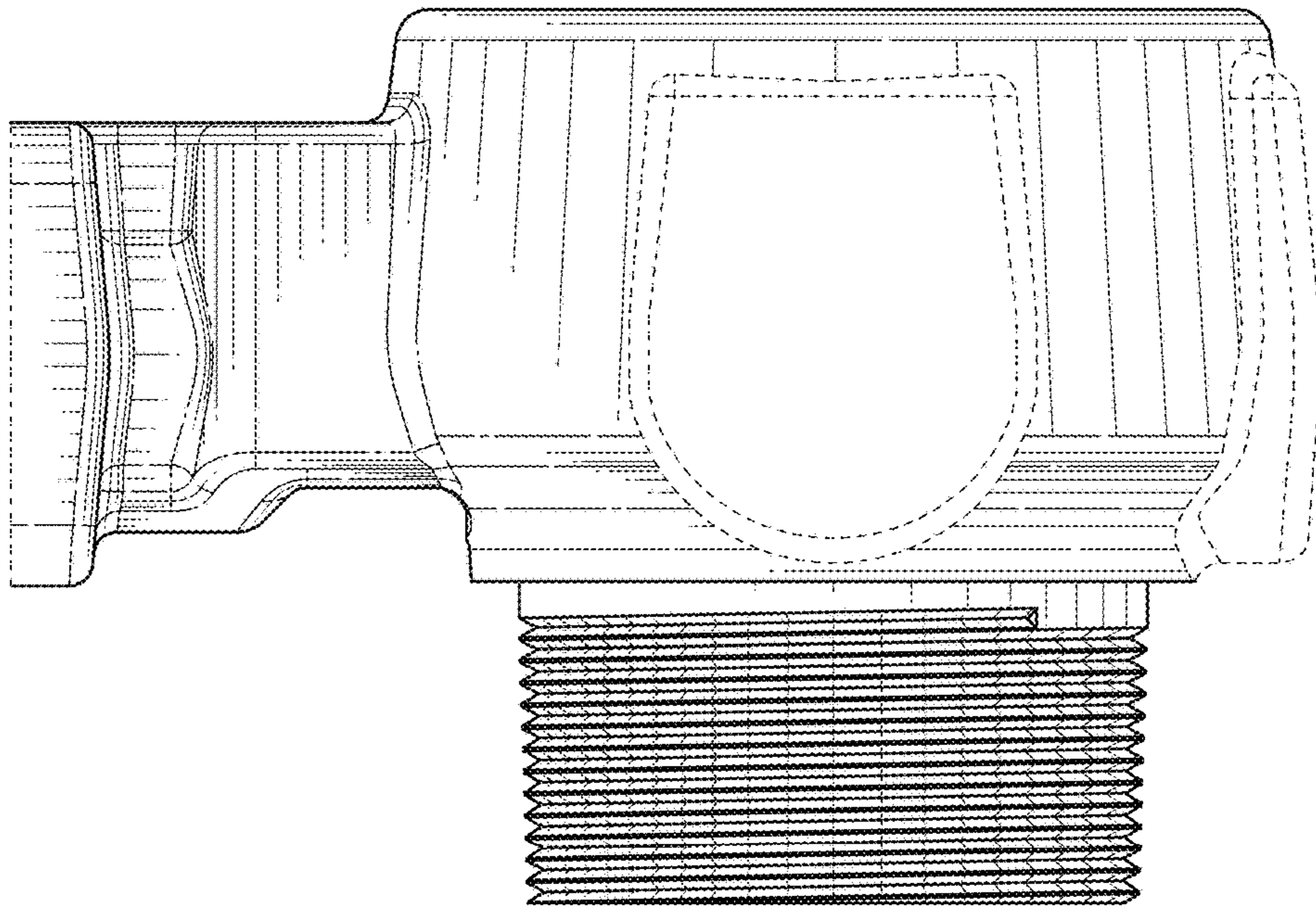

FIG. 5

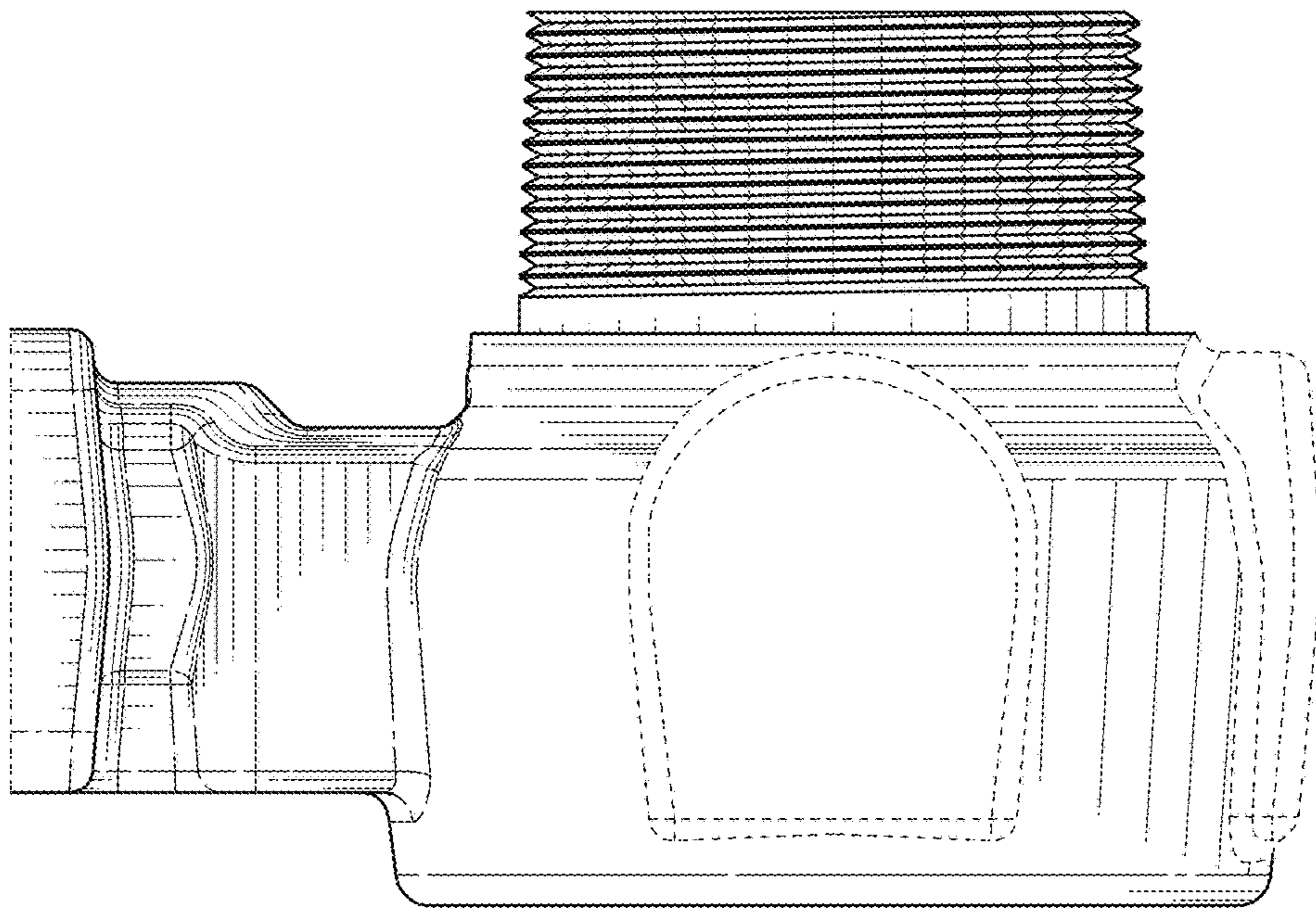

FIG. 4

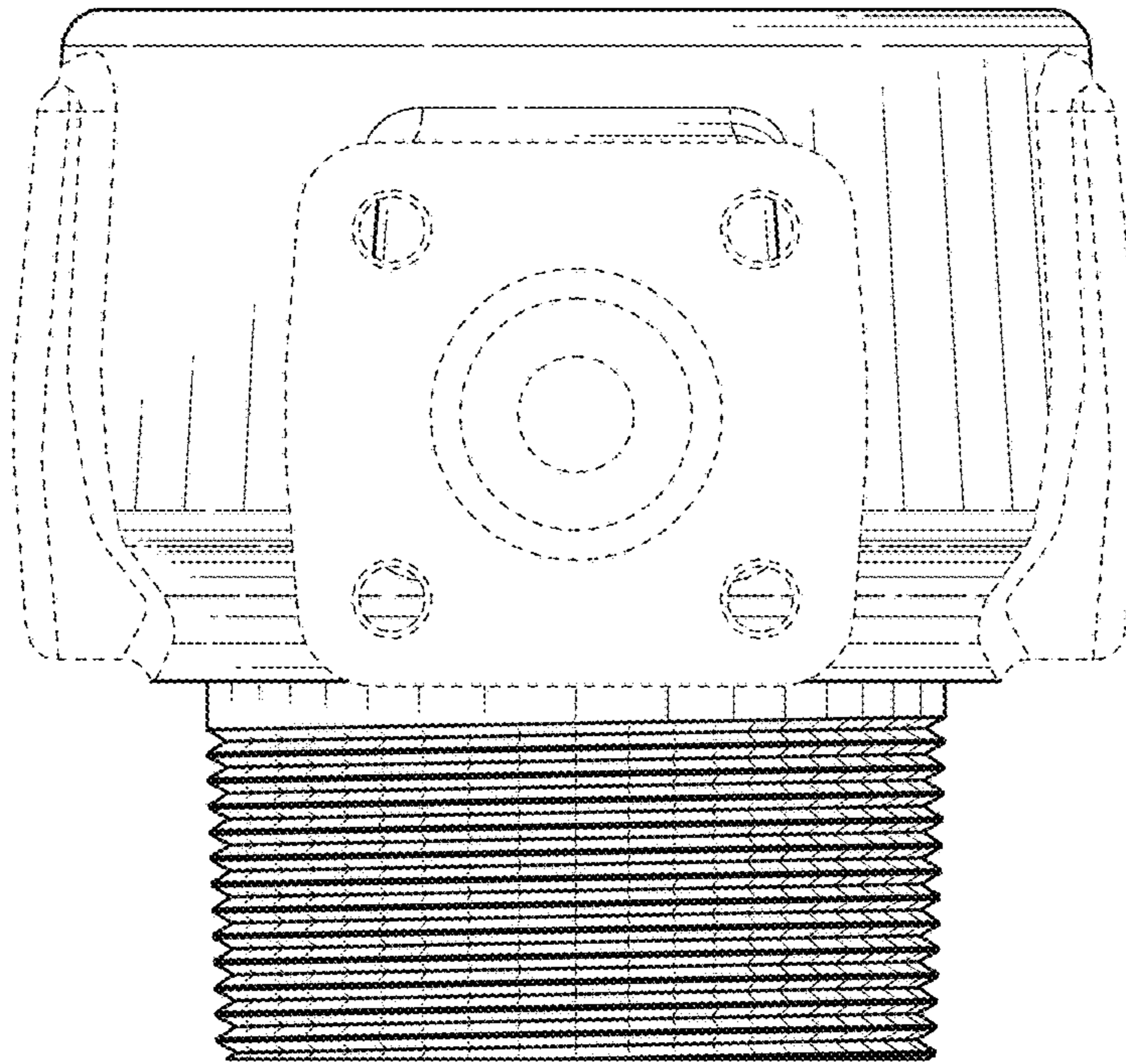

FIG. 6

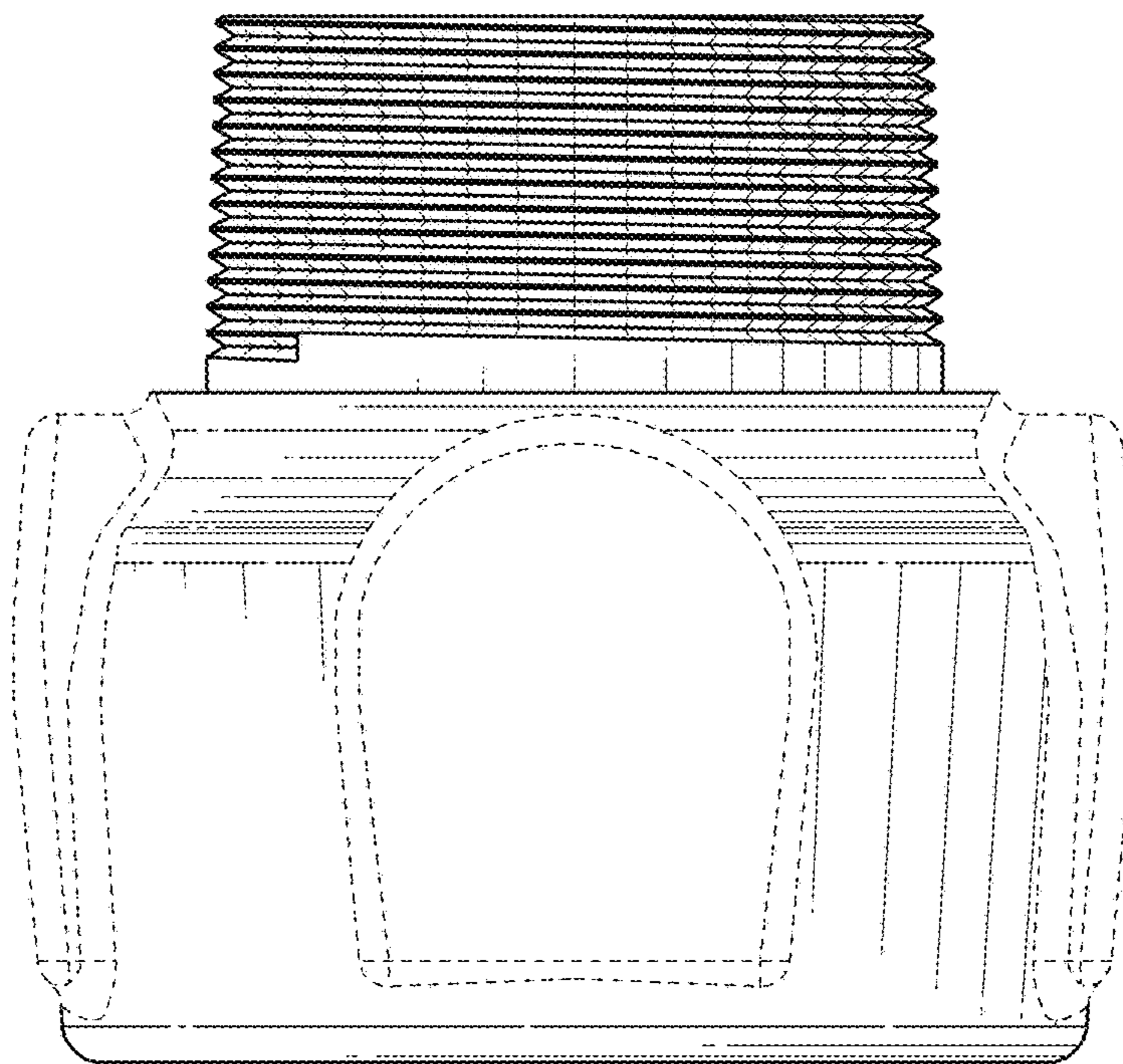

FIG. 7