



US00D832778S

(12) **United States Design Patent** (10) **Patent No.:** **US D832,778 S**
Yasunaga (45) **Date of Patent:** **** Nov. 6, 2018**

(54) **STUD PIN FOR TIRE** D814,398 S * 4/2018 Yasunaga B60C 11/1643
D12/608
(71) Applicant: **Toyo Tire & Rubber Co., Ltd.,** D815,025 S * 4/2018 Yasunaga B29D 30/0606
Osaka-shi, Okasa (JP) D12/608
2012/0227880 A1* 9/2012 Pons B60C 11/1643
(72) Inventor: **Toshikazu Yasunaga, Osaka (JP)** 2016/0159164 A1* 6/2016 Matsumoto B60C 11/1643
152/208
(73) Assignee: **TOYO TIRE & RUBBER CO., LTD.,** 2016/0311267 A1* 10/2016 Matsumoto B60C 11/1643
Osaka (JP) 2018/0022047 A1* 1/2018 Matsumoto B29D 30/0606
2018/0154704 A1* 6/2018 Matsumoto B60C 11/16

(**) Term: **15 Years**

(21) Appl. No.: **29/599,459**

(22) Filed: **Apr. 4, 2017**

(30) **Foreign Application Priority Data**

Oct. 5, 2016 (JP) 2016-021762

(51) **LOC (11) Cl.** **12-15**

(52) **U.S. Cl.**
USPC **D12/608**

(58) **Field of Classification Search**
USPC D12/604-608, 501, 544, 579
CPC ... B60C 27/08; B60C 27/086; B60C 27/0223;
B60C 11/1675; B60C 11/14
See application file for complete search history.

(56) **References Cited**

U.S. PATENT DOCUMENTS

3,476,166 A * 11/1969 Simon B60C 11/16
152/210
D431,215 S * 9/2000 Nyblom D12/608
D550,611 S * 9/2007 Liukkula D12/608
D706,709 S * 6/2014 Matsumoto D12/608
D814,396 S * 4/2018 Yasunaga B60C 11/16
D12/608
D814,397 S * 4/2018 Yasunaga B60C 11/1643
D12/608

FOREIGN PATENT DOCUMENTS

EM 000472071-0011 2/2006
EM 000900139-0003 1/2009

* cited by examiner

Primary Examiner — Robin V Webster
Assistant Examiner — Rachel A Voorhies
(74) *Attorney, Agent, or Firm* — Sterne, Kessler,
Goldstein & Fox P.L.L.C.

(57) **CLAIM**

The ornamental design for a stud pin for tire, as shown and described.

DESCRIPTION

FIG. 1 is a perspective view of a stud pin for tire showing the claimed design;
FIG. 2 is a front view thereof;
FIG. 3 is a rear view thereof;
FIG. 4 is a top plan view thereof;
FIG. 5 is a bottom plan view thereof; and,
FIG. 6 is a right side view thereof, the left side view being a mirror image thereof.

1 Claim, 6 Drawing Sheets

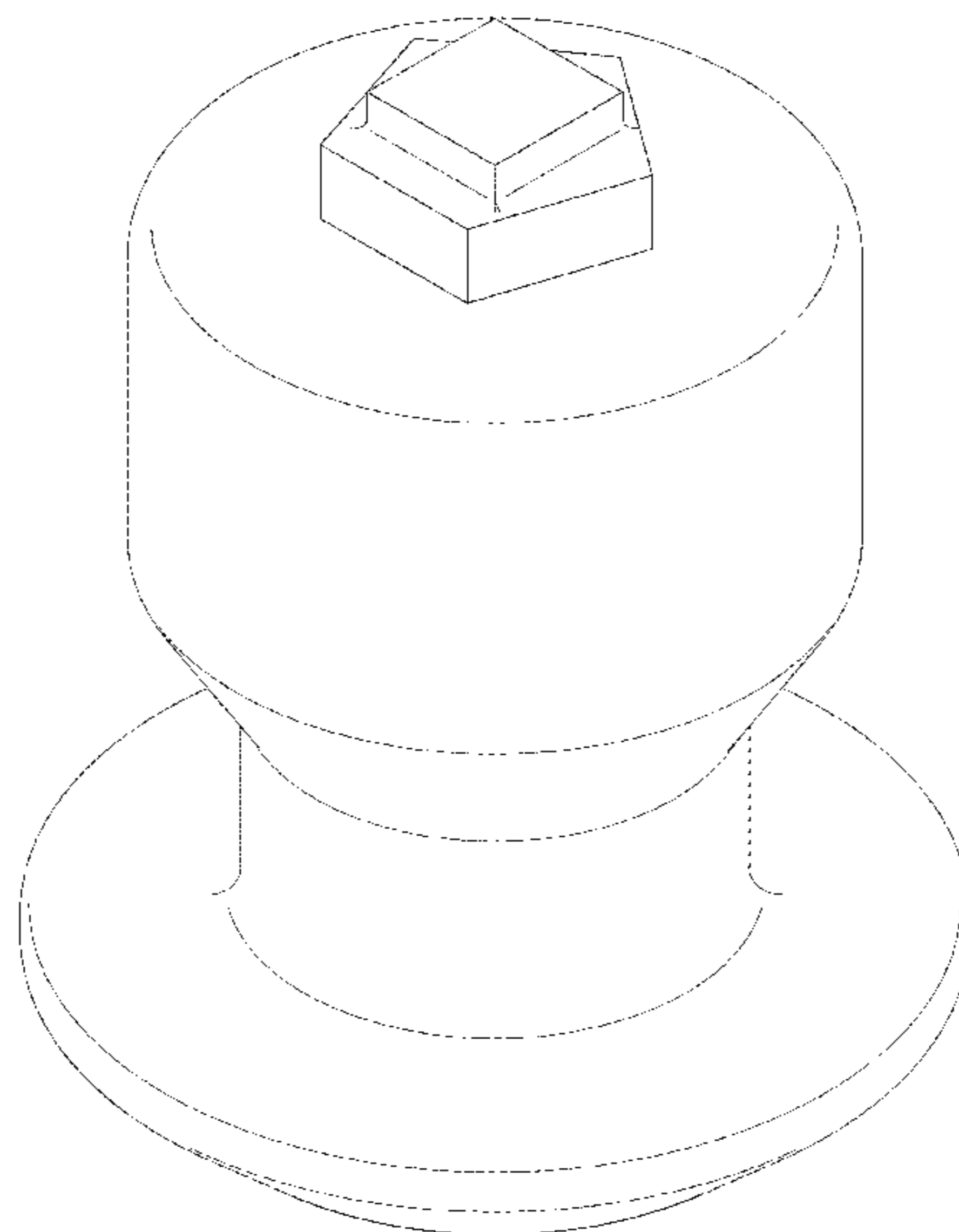

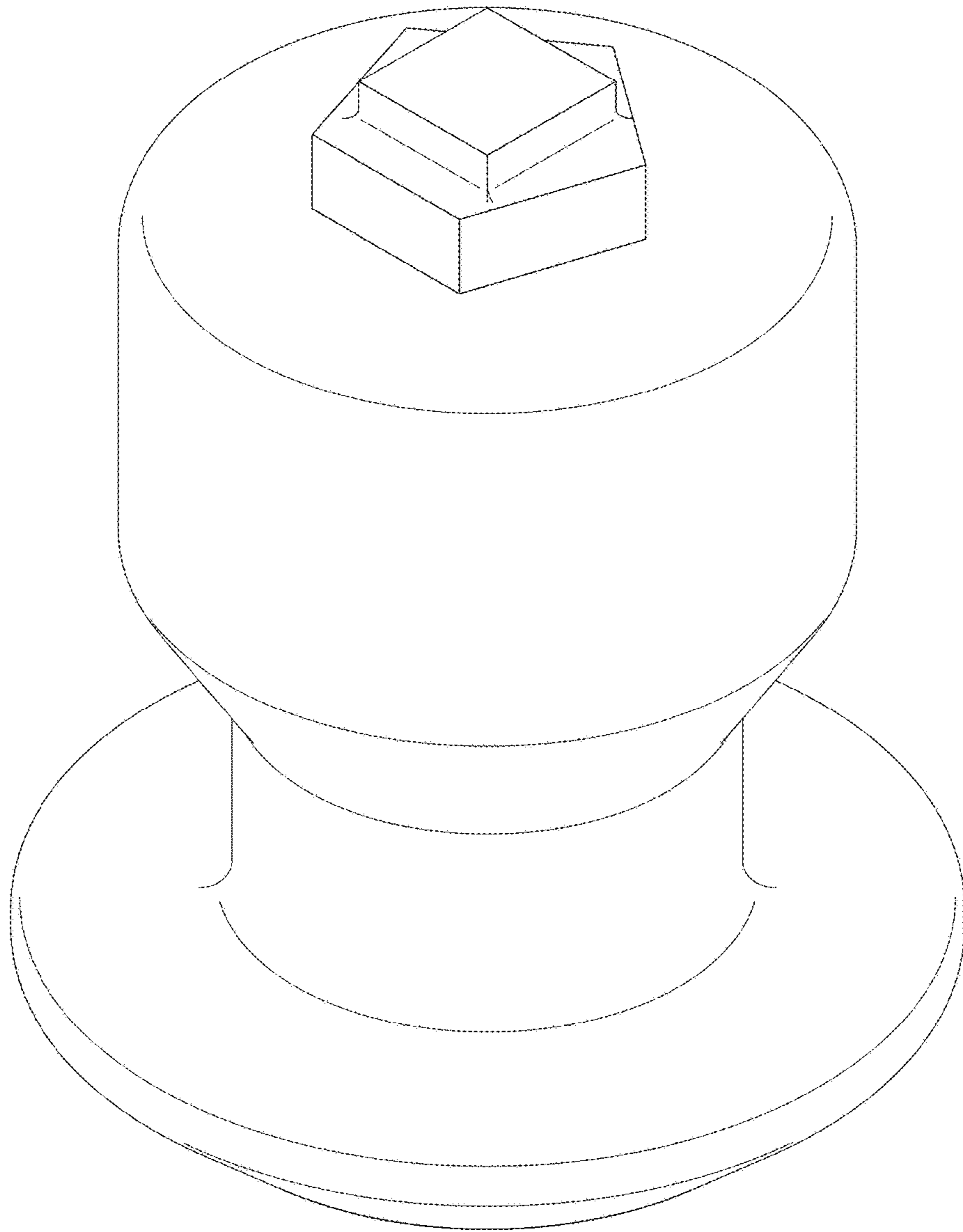

FIG. 1

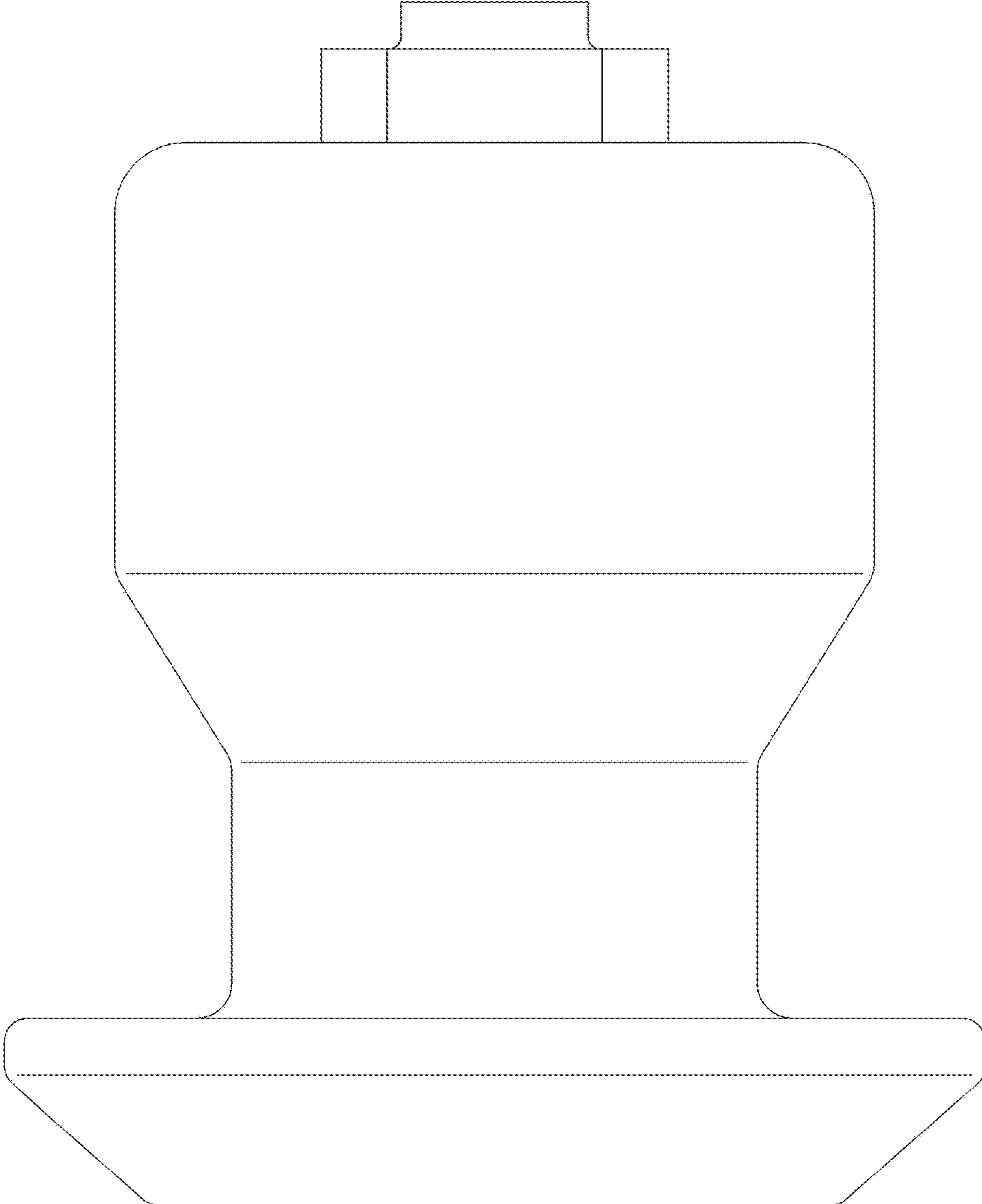

FIG. 2

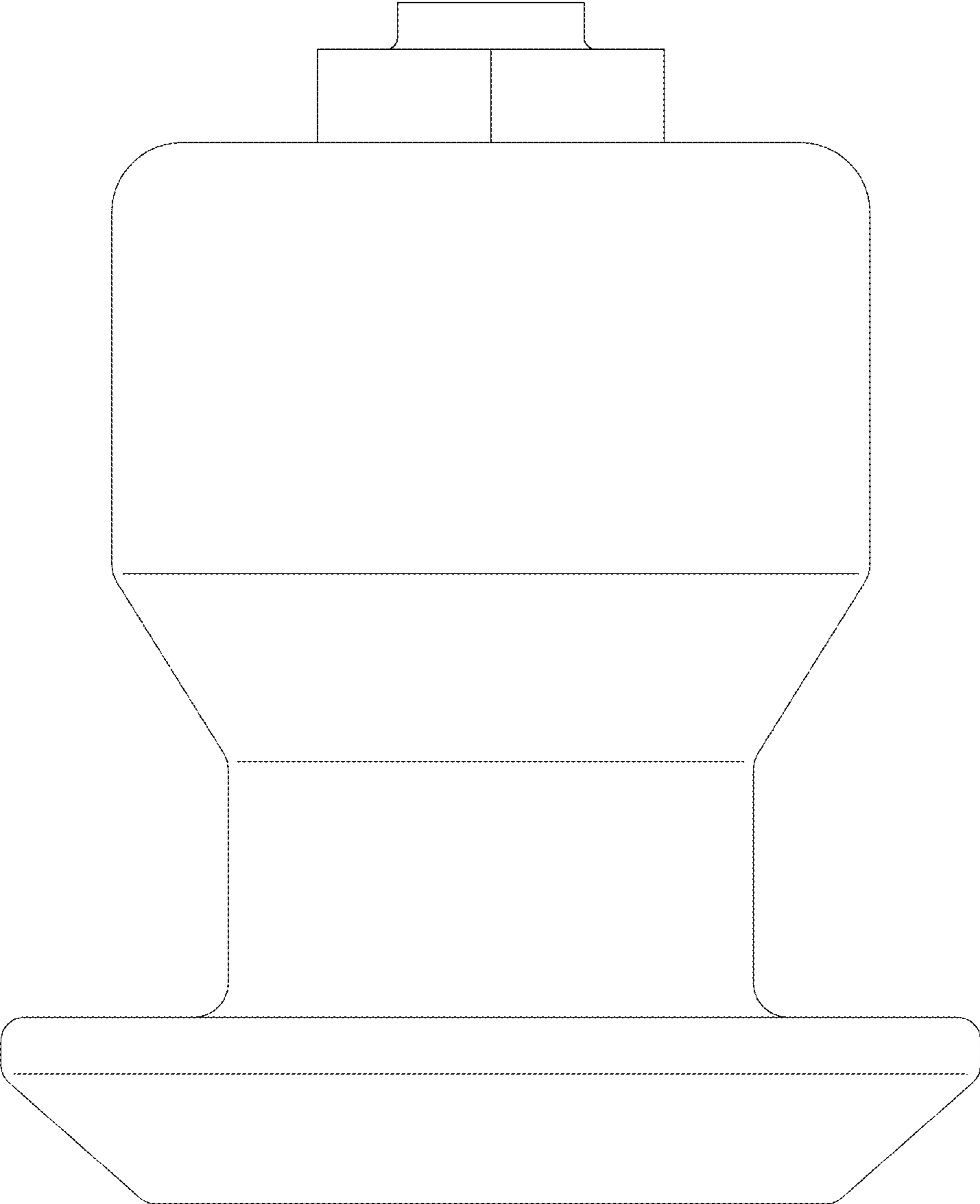

FIG. 3

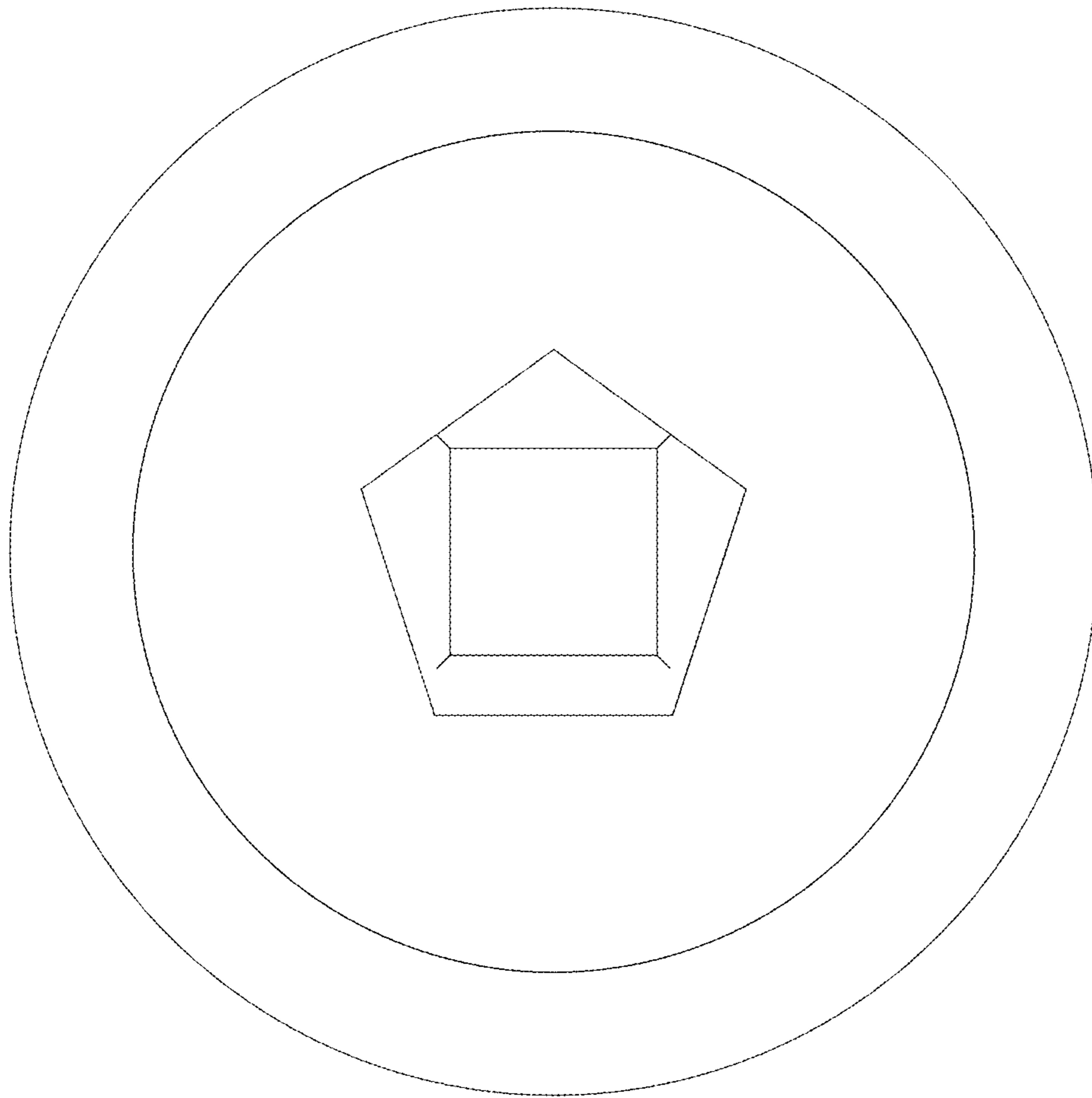

FIG. 4

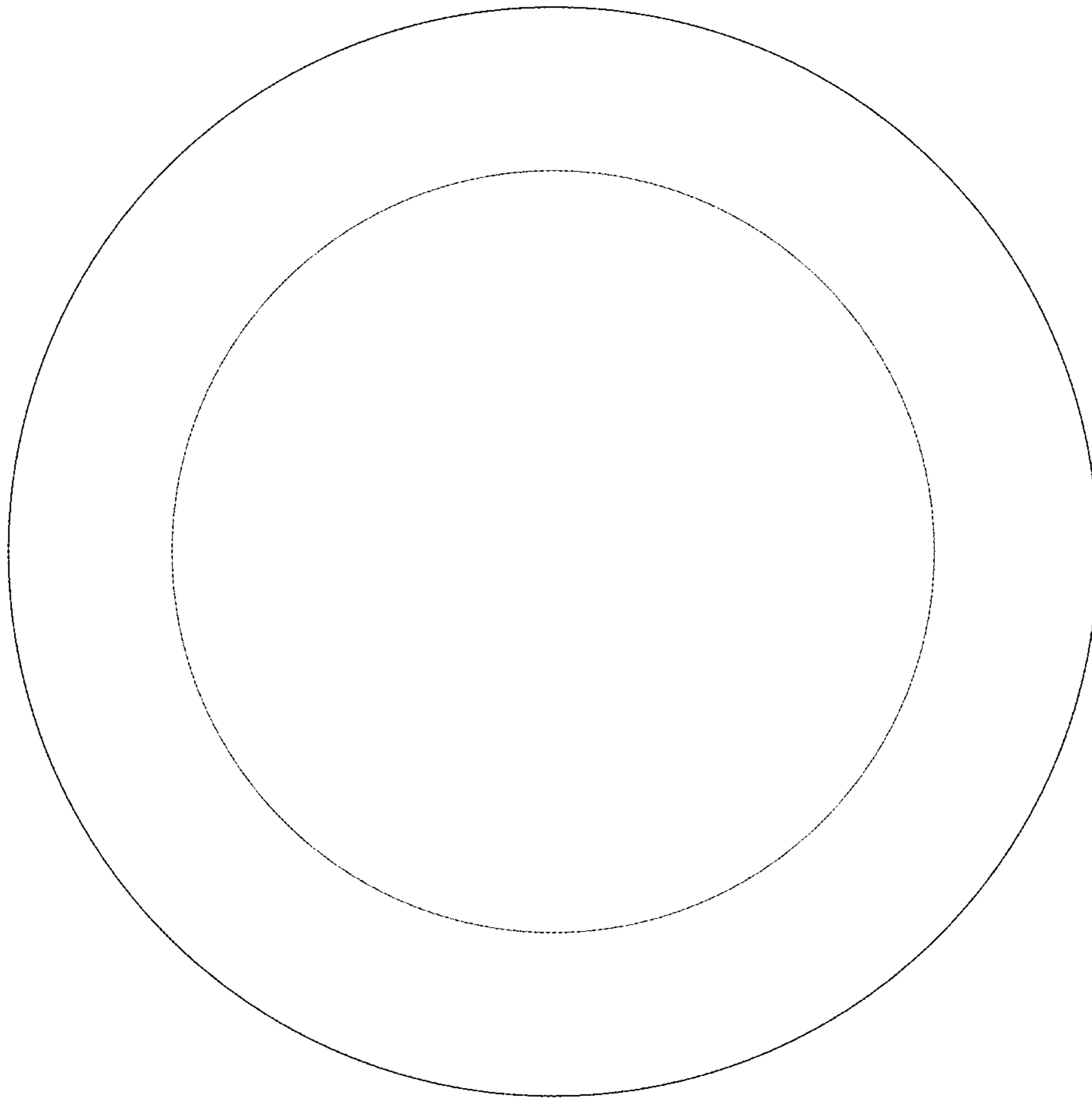

FIG. 5

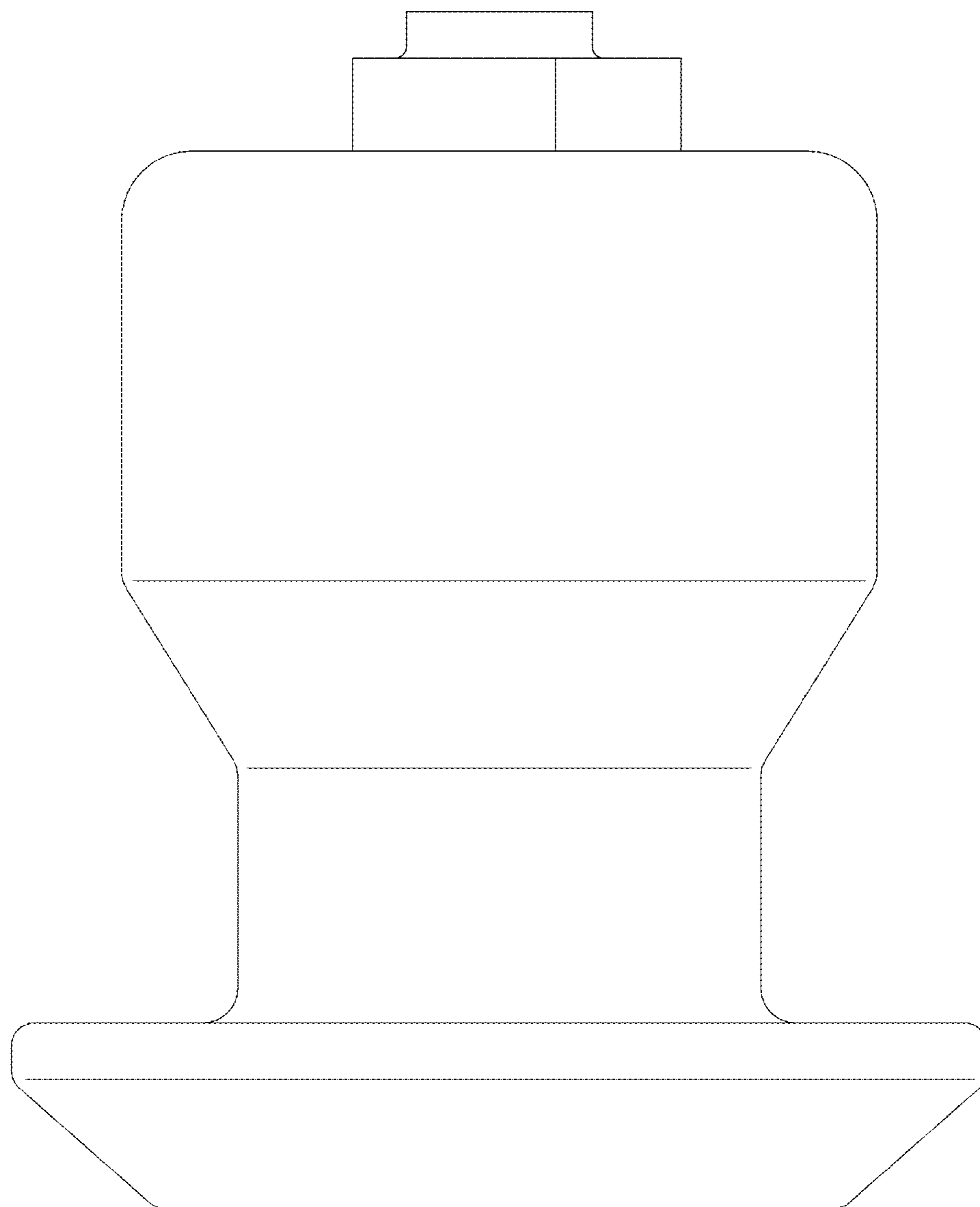

FIG. 6