



US00D832627S

(12) **United States Design Patent** (10) **Patent No.:** **US D832,627 S**  
**Blatstein et al.** (45) **Date of Patent:** **\*\* Nov. 6, 2018**

(54) **DISPLAY STRUCTURE**  
(71) Applicant: **OTG Experience, LLC**, New York, NY (US)  
(72) Inventors: **Eric J. Blatstein**, New York, NY (US); **Justin S. Blatstein**, New York, NY (US); **James Darcy**, Union, NJ (US); **Carmen C. Aguilar**, Rye, NY (US); **Erica G. Armstrong**, Cherry Hill, NJ (US); **Dean Mercado**, Milltown, NJ (US); **Alberto Penna**, Milltown, NJ (US)

D468,936 S \* 1/2003 Miranda ..... D6/675.4  
D604,062 S \* 11/2009 Wade ..... D6/675.2  
D612,171 S \* 3/2010 Wade ..... D6/629  
D622,977 S \* 9/2010 Wade ..... D6/675.4  
D647,996 S \* 11/2011 Griffin ..... D23/200  
D730,663 S \* 6/2015 Logan ..... G09F 7/10  
D6/675  
D741,626 S \* 10/2015 Tapias ..... D6/672  
D777,478 S \* 1/2017 Krauss ..... D6/675  
D785,379 S \* 5/2017 Maffett ..... D6/675.4  
D790,457 S \* 6/2017 Vargas ..... D13/108

\* cited by examiner

*Primary Examiner* — Kelley Donnelly  
(74) *Attorney, Agent, or Firm* — Kaplan Breyer Schwarz, LLP

(73) Assignee: **OTG Experience, LLC**, New York, NY (US)

(\*\*) Term: **15 Years**

(21) Appl. No.: **29/606,503**

(22) Filed: **Jun. 5, 2017**

(51) **LOC (11) Cl.** ..... **06-06**

(52) **U.S. Cl.**  
USPC ..... **D6/675.4**

(58) **Field of Classification Search**  
USPC ..... D6/663, 664, 669–670, 671.1, 672, 673, D6/683, 683.1; D3/273, 304–314; D9/424, 435, 449  
CPC ..... B65D 25/00; B65D 43/00; B65D 43/02  
See application file for complete search history.

(56) **References Cited**

**U.S. PATENT DOCUMENTS**

D307,838 S \* 5/1990 Johnston ..... D6/675.4  
D332,018 S \* 12/1992 De Pas ..... D6/682.6

(57) **CLAIM**  
The ornamental design for a display structure, substantially as shown and described.

**DESCRIPTION**

FIG. 1 is a perspective view of a display structure shown with environment;  
FIG. 2 is a perspective view of our design;  
FIG. 3 is a front elevation view of our design;  
FIG. 4 is a rear elevation view of our design;  
FIG. 5 is an elevation view of the right side of our design;  
FIG. 6 is an elevation view of the left side of our design;  
FIG. 7 is a top plan view of our design; and,  
FIG. 8 is a bottom plan view of our design.  
The broken lines showing in FIG. 1 are for the purposes of illustrating the environment of the article only and form no part of the claimed design.  
The portions shown in the drawings in dot and dashed lines do not constitute part of the claimed design.

**1 Claim, 7 Drawing Sheets**

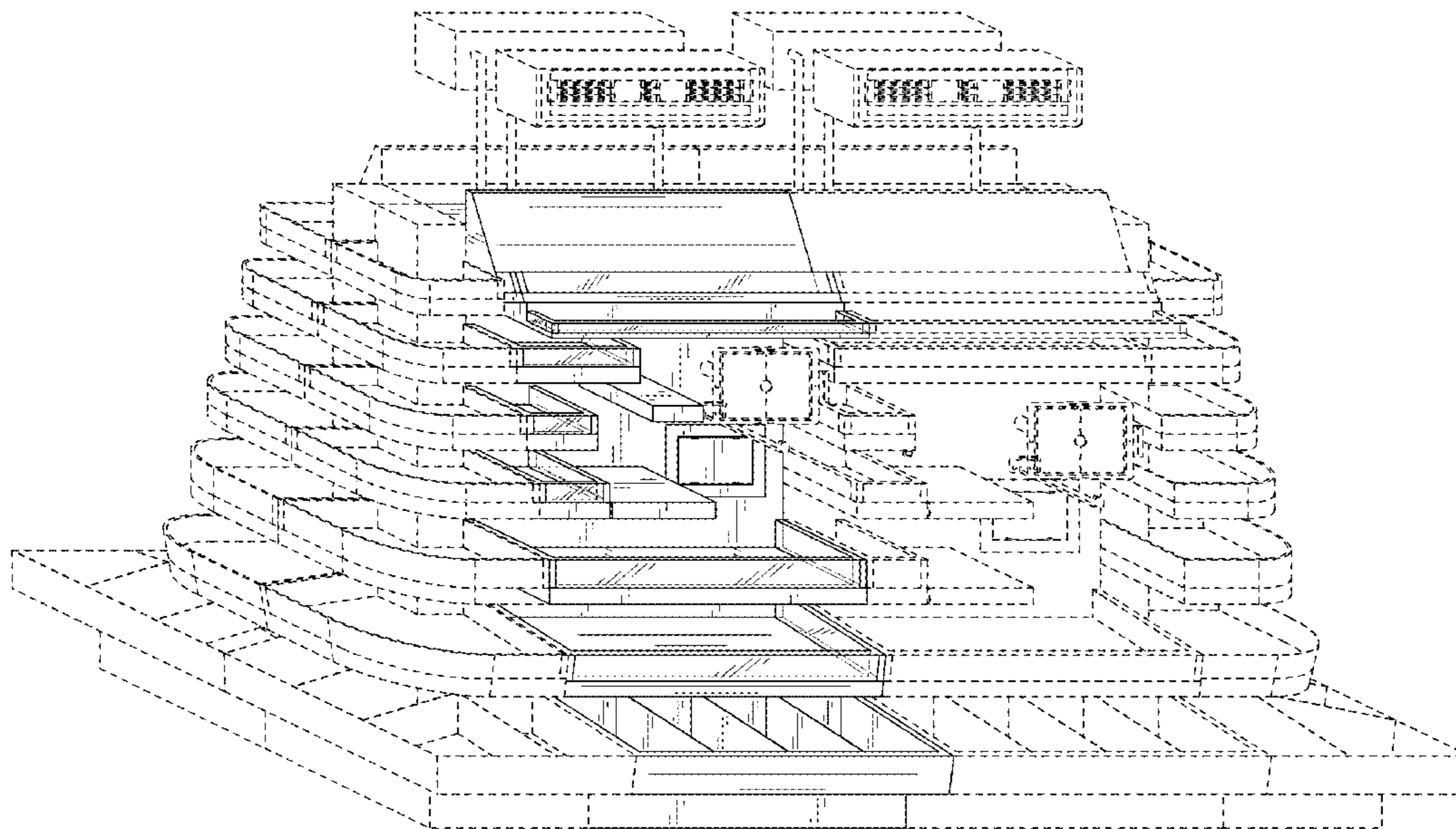

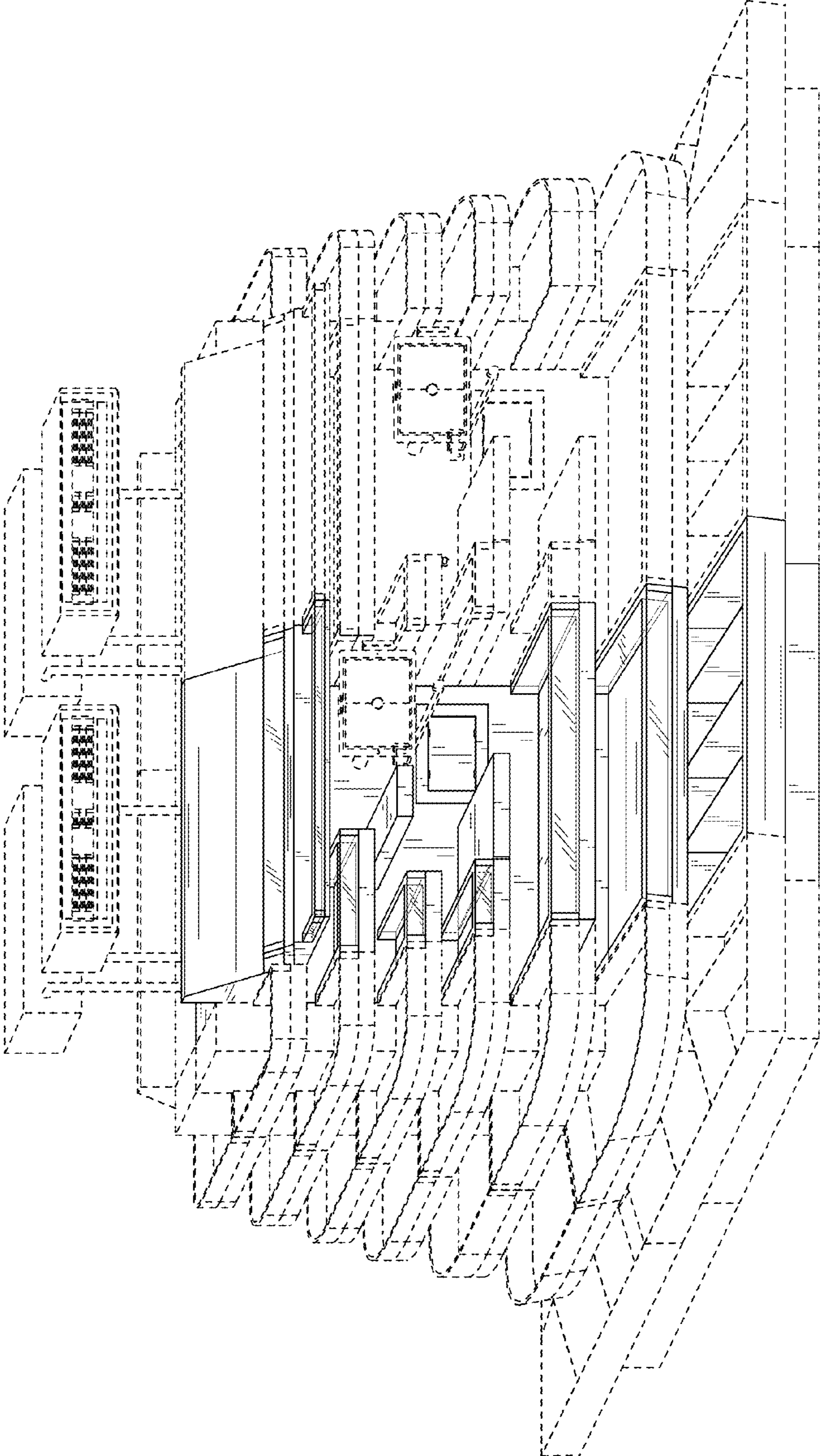

FIG. 1

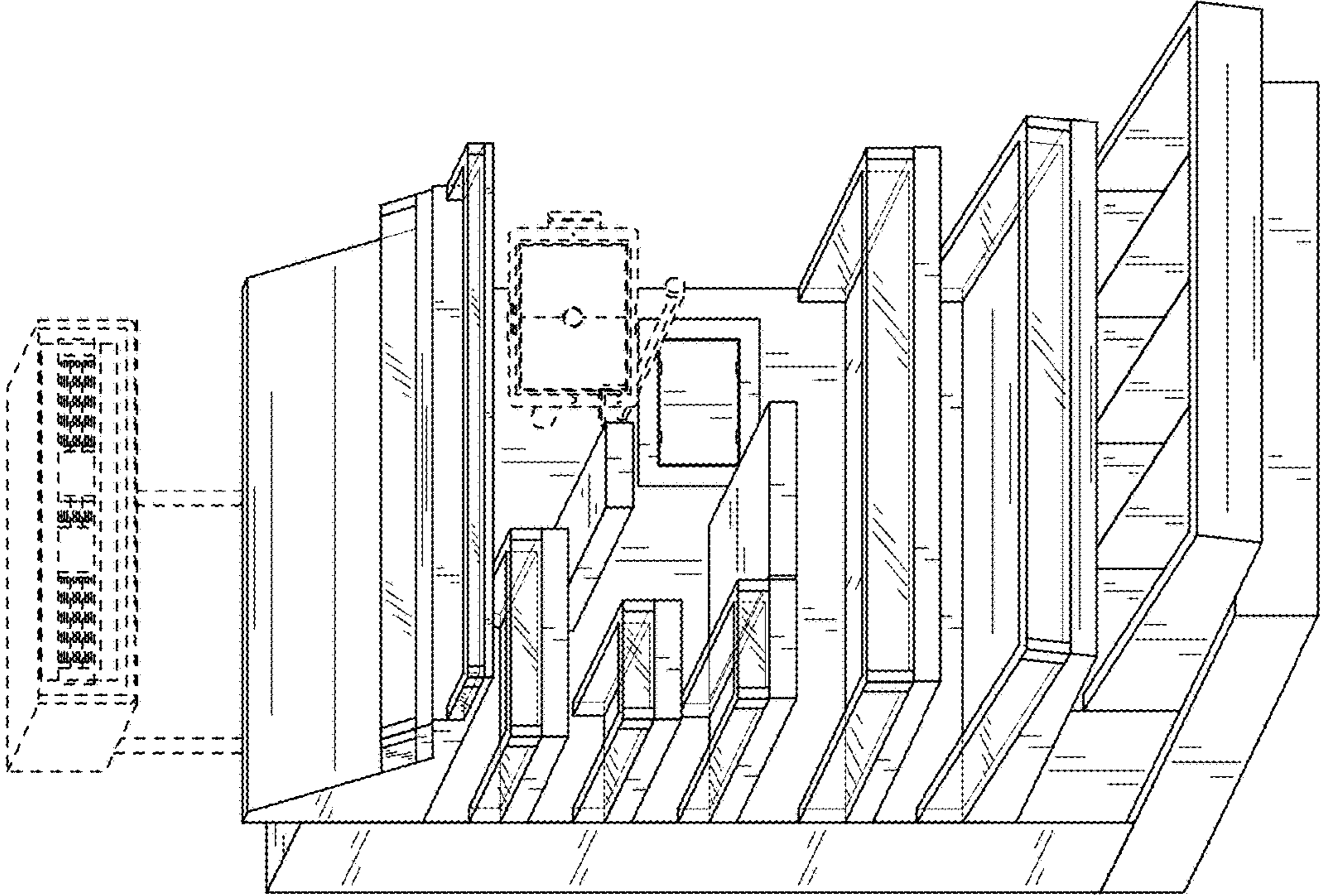

FIG. 2

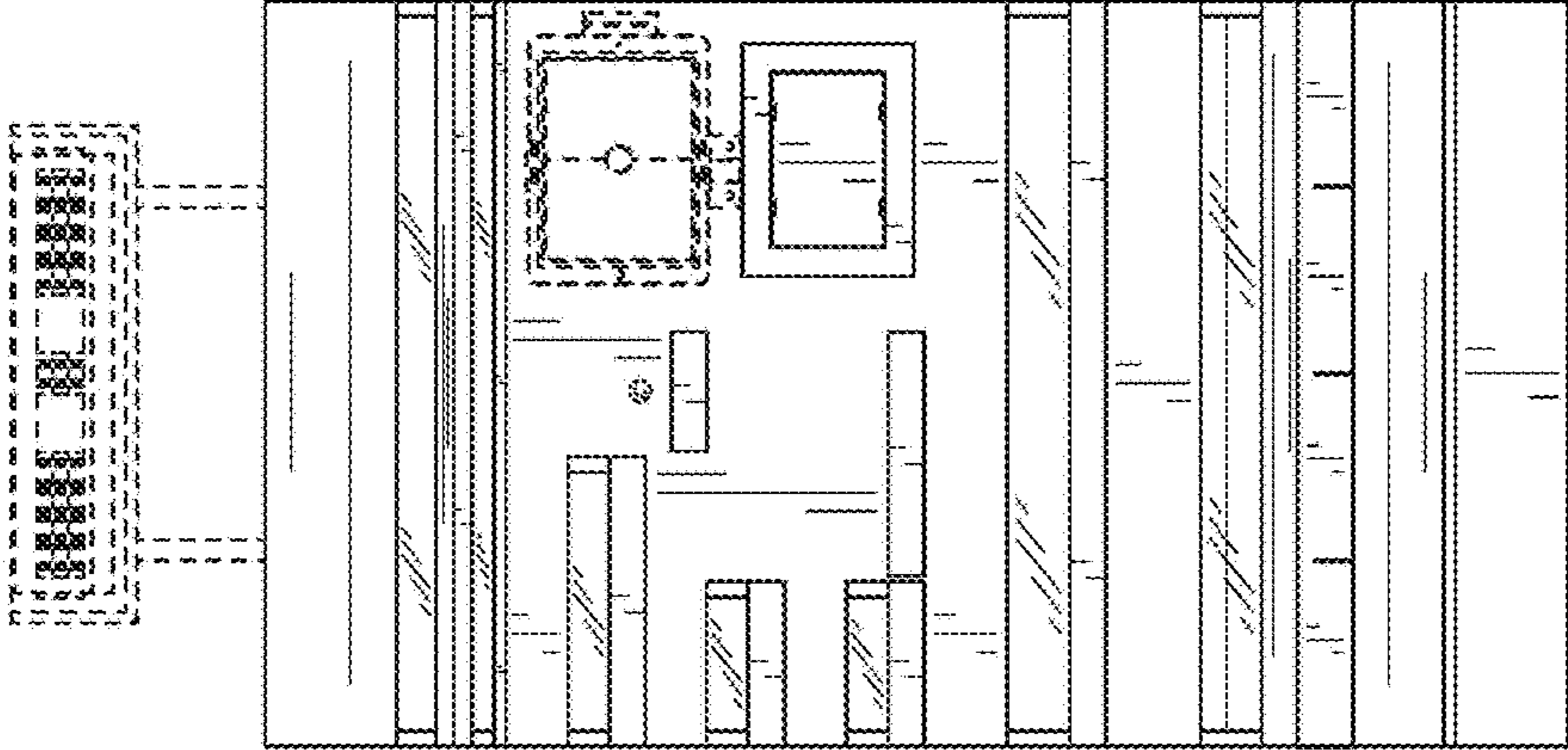

FIG. 3

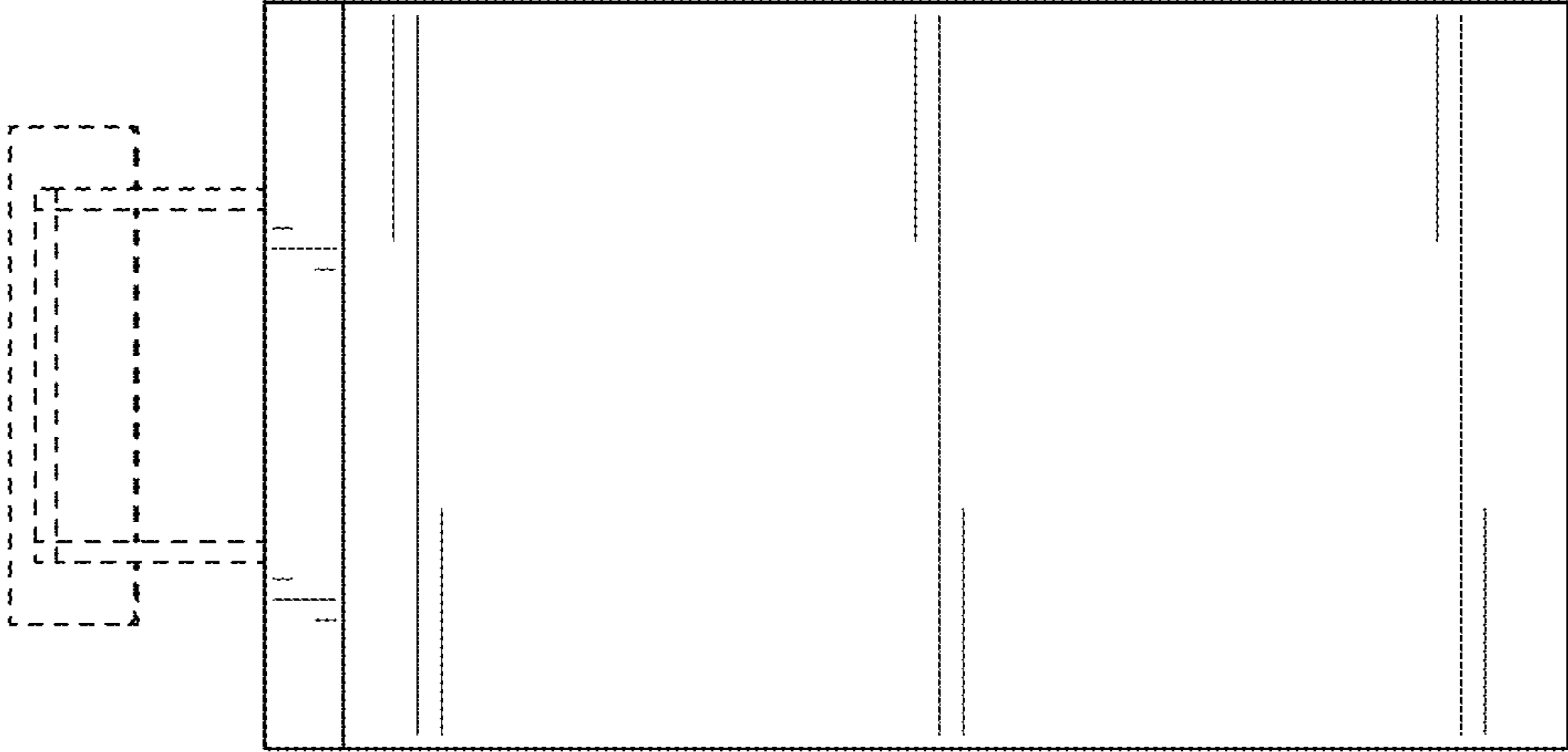

FIG. 4

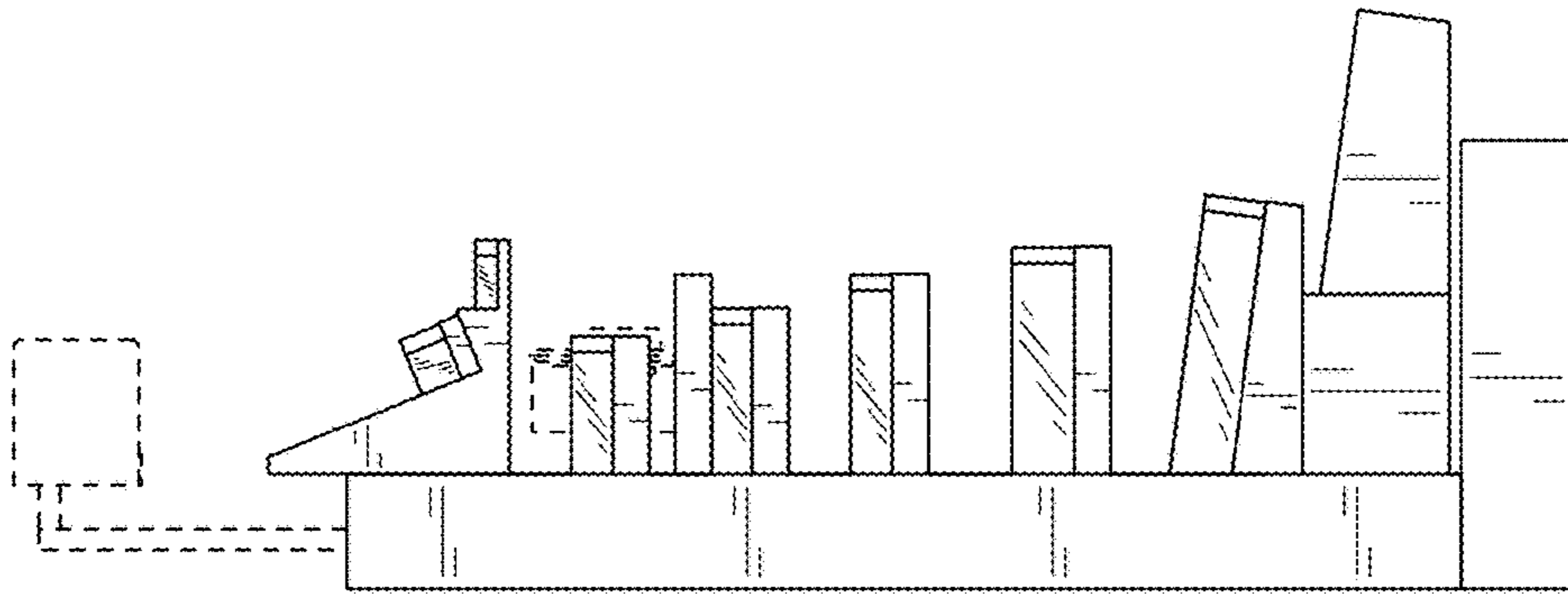

FIG. 6

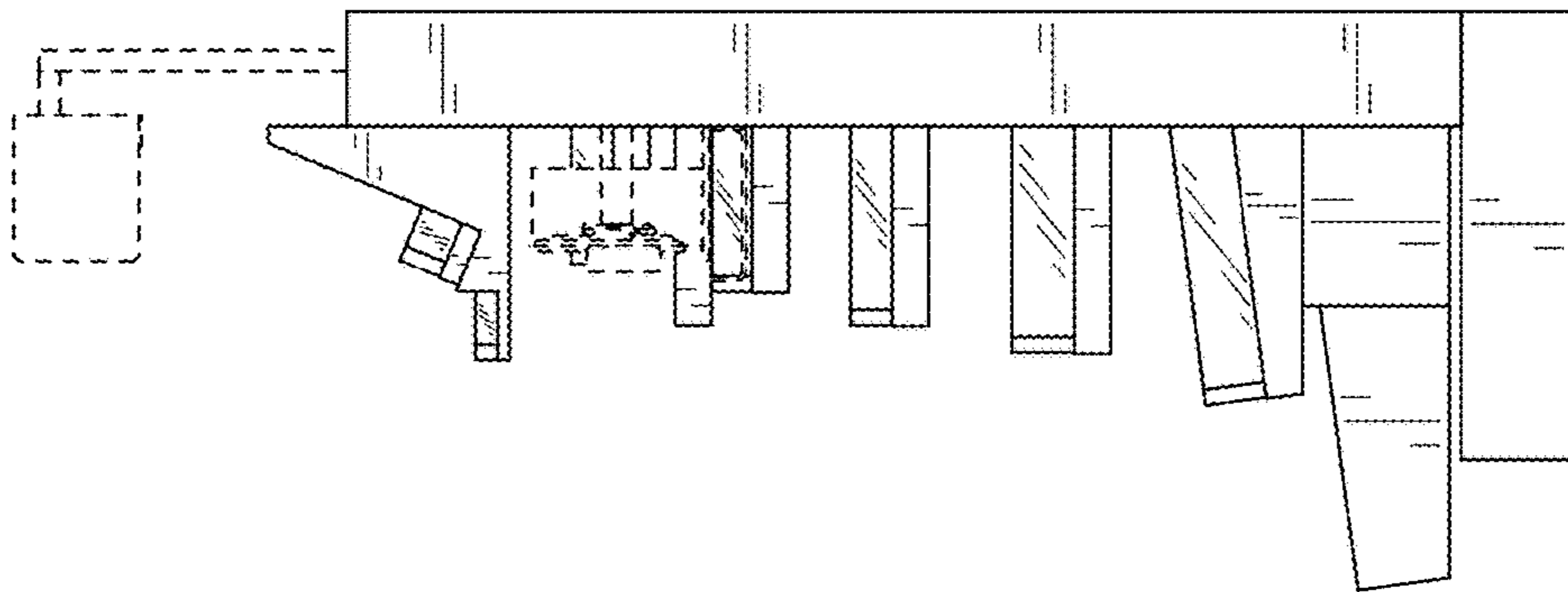

FIG. 5

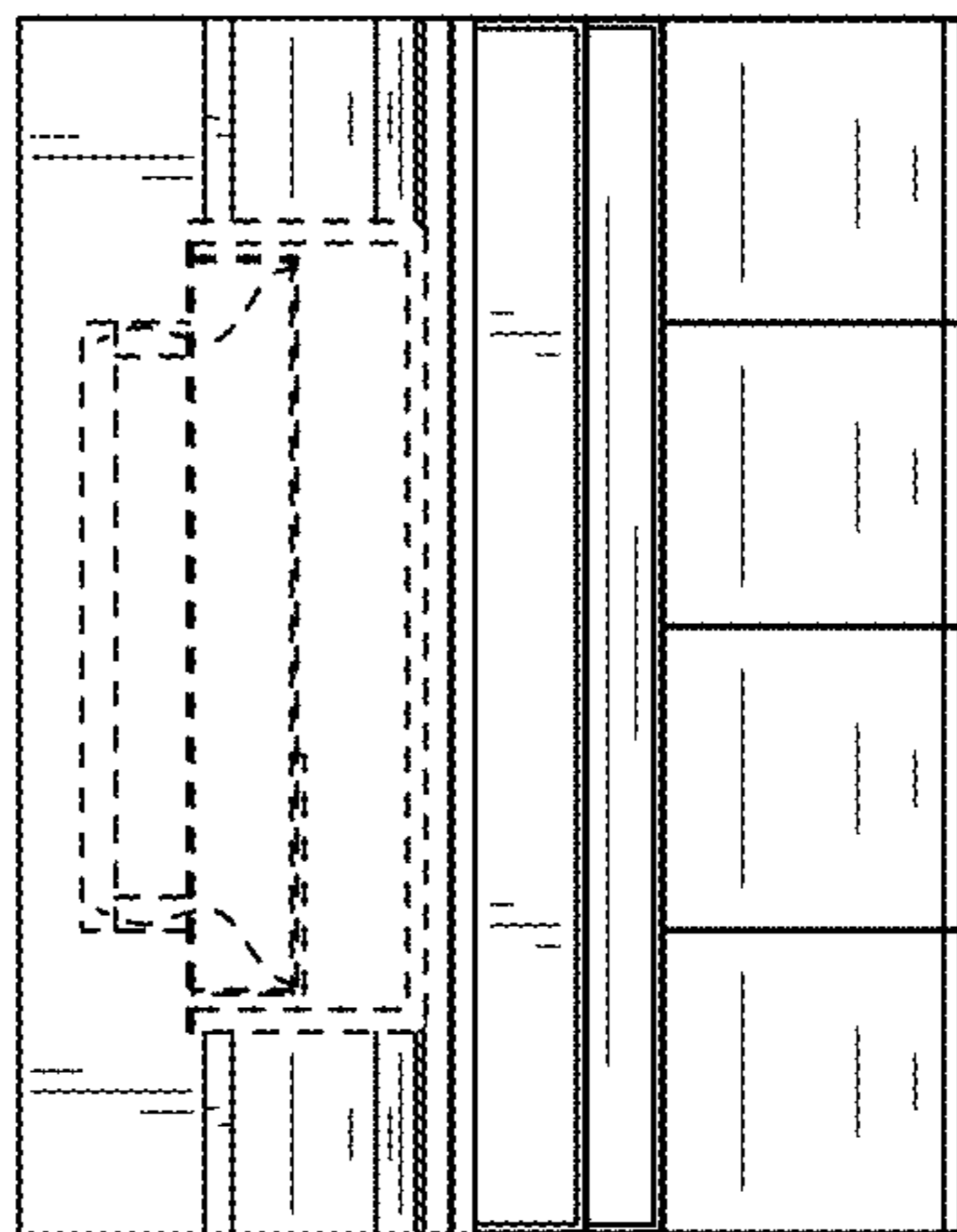

FIG. 7

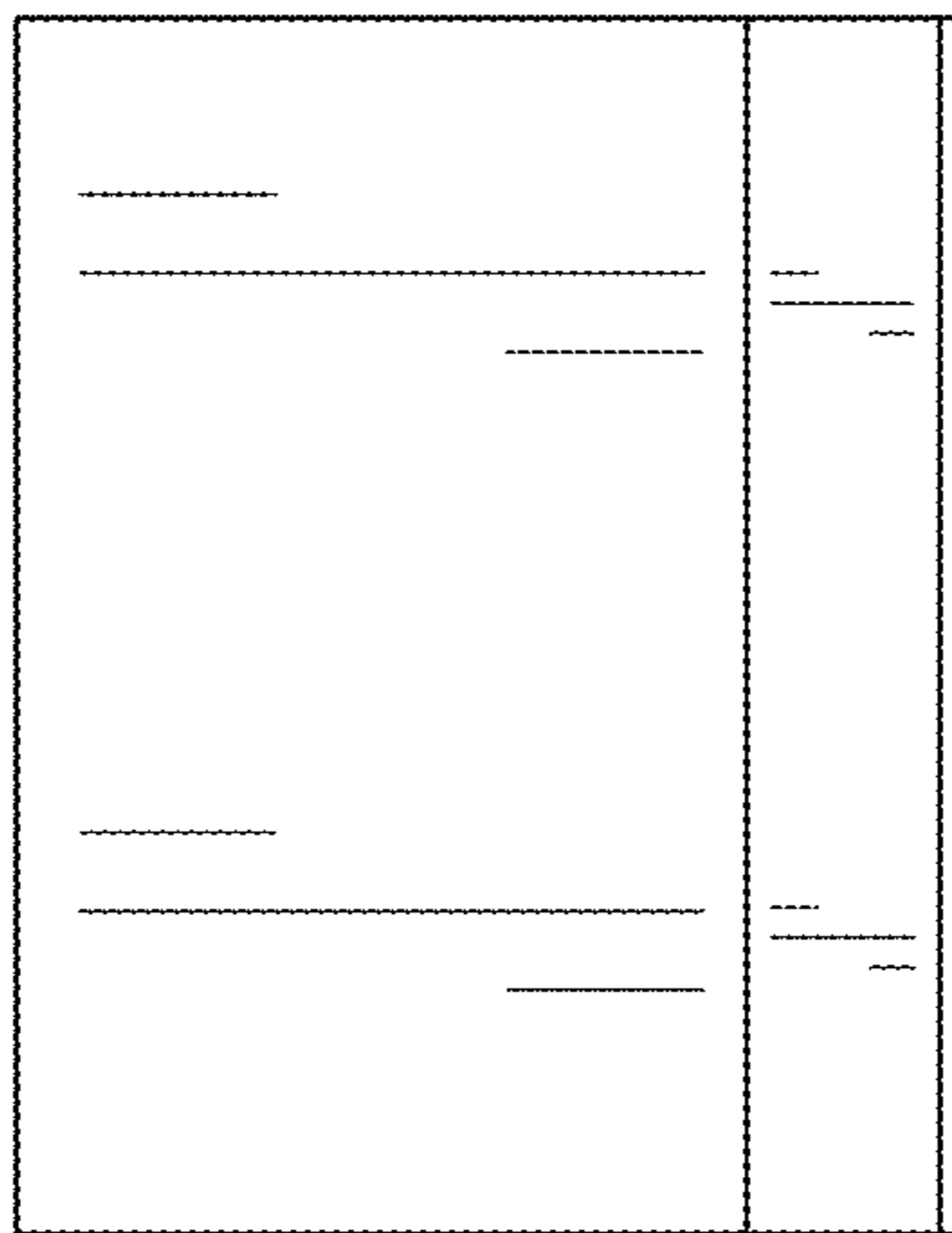

FIG. 8