



US00D830451S

(12) **United States Design Patent**  
**Makino et al.**

(10) **Patent No.:** **US D830,451 S**

(45) **Date of Patent:** **\*\* Oct. 9, 2018**

(54) **PRINTER**

(71) Applicant: **SEIKO EPSON CORPORATION,**  
Tokyo (JP)

(72) Inventors: **Takashi Makino,** Matsumoto (JP); **Seiji Kimura,** Shiojiri (JP); **Yusuke Yamashita,** Matsumoto (JP); **Genta Kawabe,** Matsumoto (JP); **Shinichiro Yoshikawa,** Matsumoto (JP); **Etsuo Tsuji,** Matsumoto (JP); **Soichiro Kii,** Shiojiri (JP)

(73) Assignee: **SEIKO EPSON CORPORATION,**  
Tokyo (JP)

(\*\*) Term: **15 Years**

(21) Appl. No.: **29/585,751**

(22) Filed: **Nov. 29, 2016**

(30) **Foreign Application Priority Data**

May 31, 2016 (JP) ..... 2016-011501

(51) **LOC (11) Cl.** ..... **18-02**

(52) **U.S. Cl.**  
USPC ..... **D18/53**

(58) **Field of Classification Search**

USPC ..... D18/53, 50, 54, 56, 59, 36, 38, 39, 40,  
D18/41, 45; D14/301, 307

CPC .... G06K 15/12; G06K 15/14; H04N 1/00204;  
H04N 1/00249; H04N 1/00278; B41J  
3/00; B41J 3/28; B41J 3/445; B41J 3/46

See application file for complete search history.

(56) **References Cited**

**U.S. PATENT DOCUMENTS**

D384,370 S \* 9/1997 Kobayashi ..... D18/55  
D425,551 S \* 5/2000 Shiozaki ..... D18/53  
D557,738 S \* 12/2007 Falk ..... D18/53  
D650,834 S \* 12/2011 Brown ..... D18/39

D665,012 S \* 8/2012 Saito ..... D18/39  
D738,956 S \* 9/2015 Larson ..... D18/49  
D742,450 S \* 11/2015 Larson ..... D18/50  
D742,960 S \* 11/2015 Lee ..... D18/50  
D755,889 S \* 5/2016 Wynn ..... D18/53  
D778,983 S \* 2/2017 Kim ..... D18/53  
D792,924 S \* 7/2017 Dwyer ..... D18/56  
2004/0081495 A1 \* 4/2004 Nakamura ..... G03G 15/602  
399/367  
2008/0003010 A1 \* 1/2008 Isogai ..... H04N 1/0035  
399/81

**FOREIGN PATENT DOCUMENTS**

JP D1264906 \* 3/2006

**OTHER PUBLICATIONS**

YouTube. <URL: <https://www.youtube.com/watch?v=zo5UZ5PBlvM>>  
Oct. 4, 2011. Kyocera taskalfa 500ci series.\*

\* cited by examiner

*Primary Examiner* — Thomas Johannes

*Assistant Examiner* — Lauren McVey

(57) **CLAIM**

The ornamental design for a printer, as shown and described.

**DESCRIPTION**

FIG. 1 is a front, top and right side perspective view of a printer showing our new design;

FIG. 2 is a front view thereof;

FIG. 3 is a rear view thereof;

FIG. 4 is a top plan view thereof;

FIG. 5 is a bottom plan view thereof;

FIG. 6 is a right side view thereof; and,

FIG. 7 is a left side view thereof.

The broken lines immediately adjacent to the claim represent the bounds of the claim, while all other broken lines are directed to environment; the broken lines form no part of the claimed design.

**1 Claim, 7 Drawing Sheets**

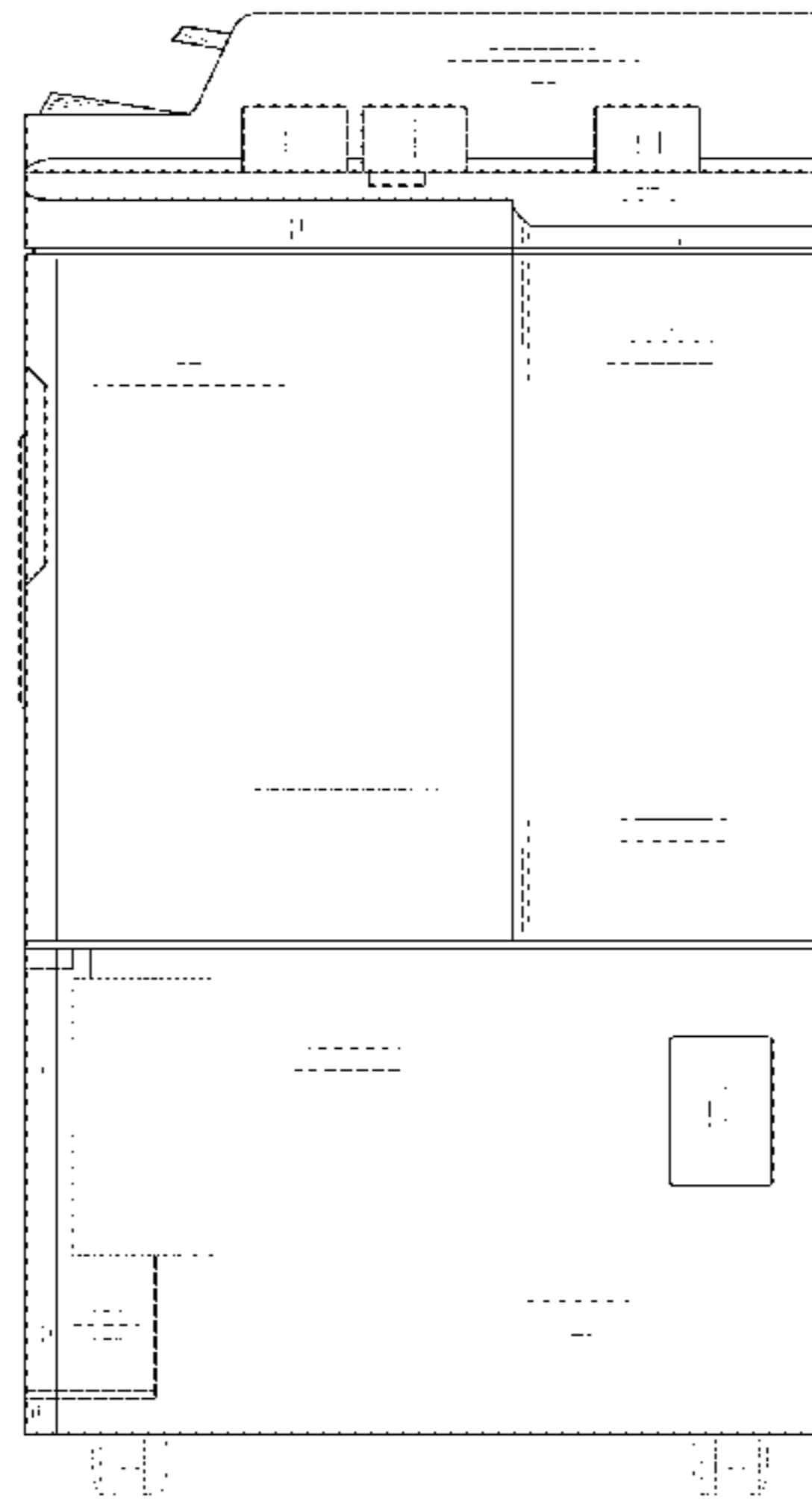
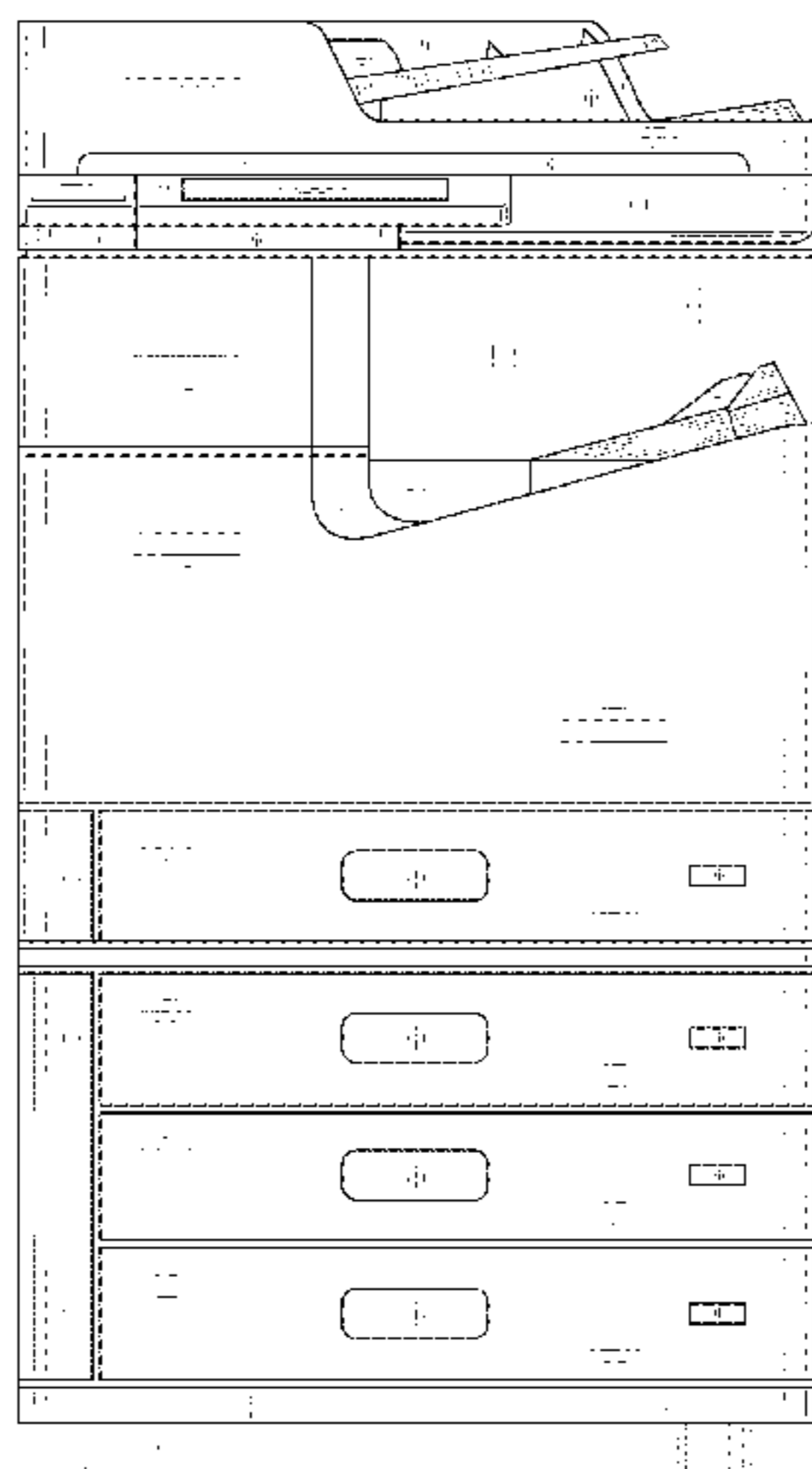

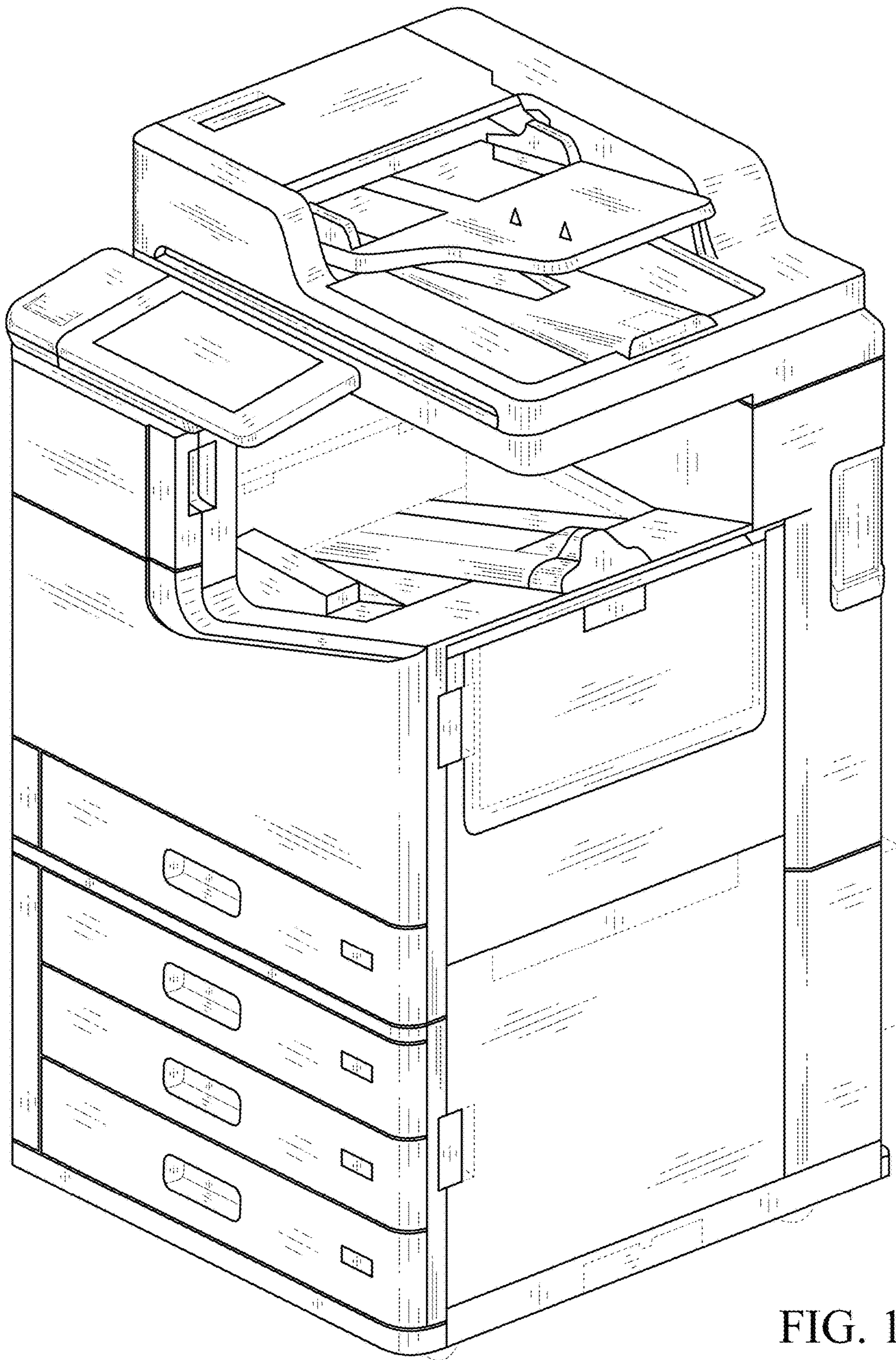

FIG. 1

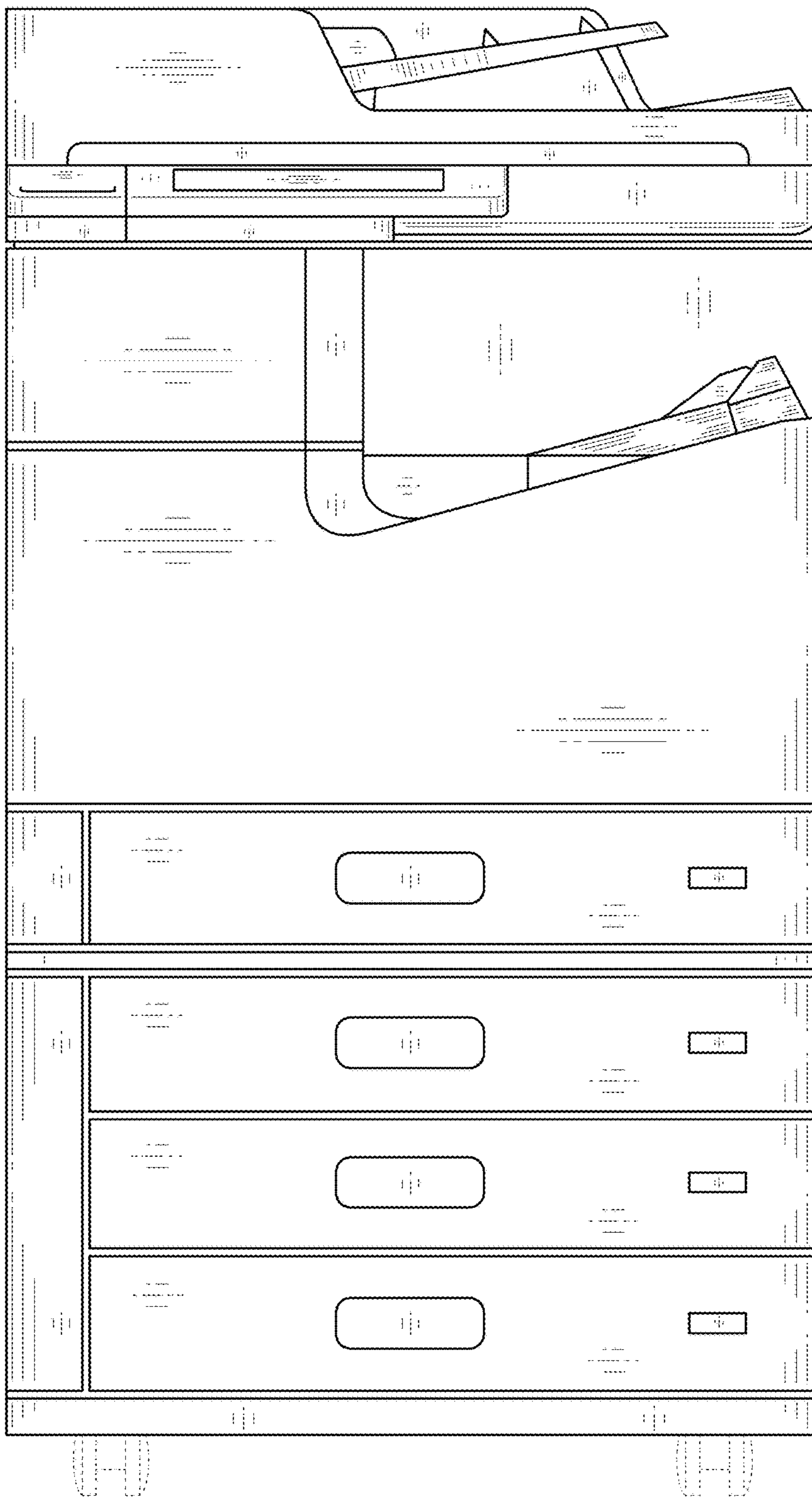

FIG. 2



FIG. 3

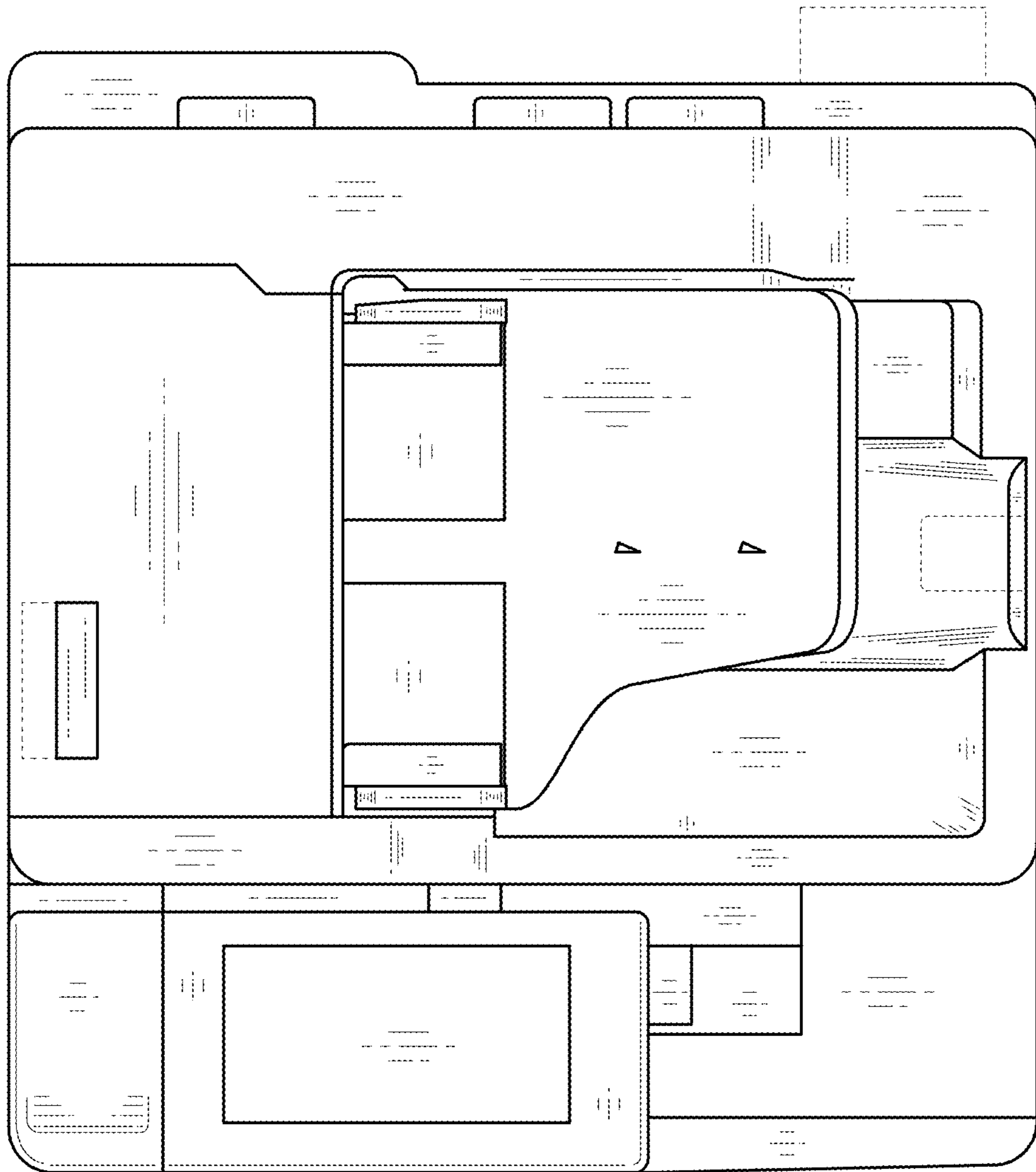

FIG. 4

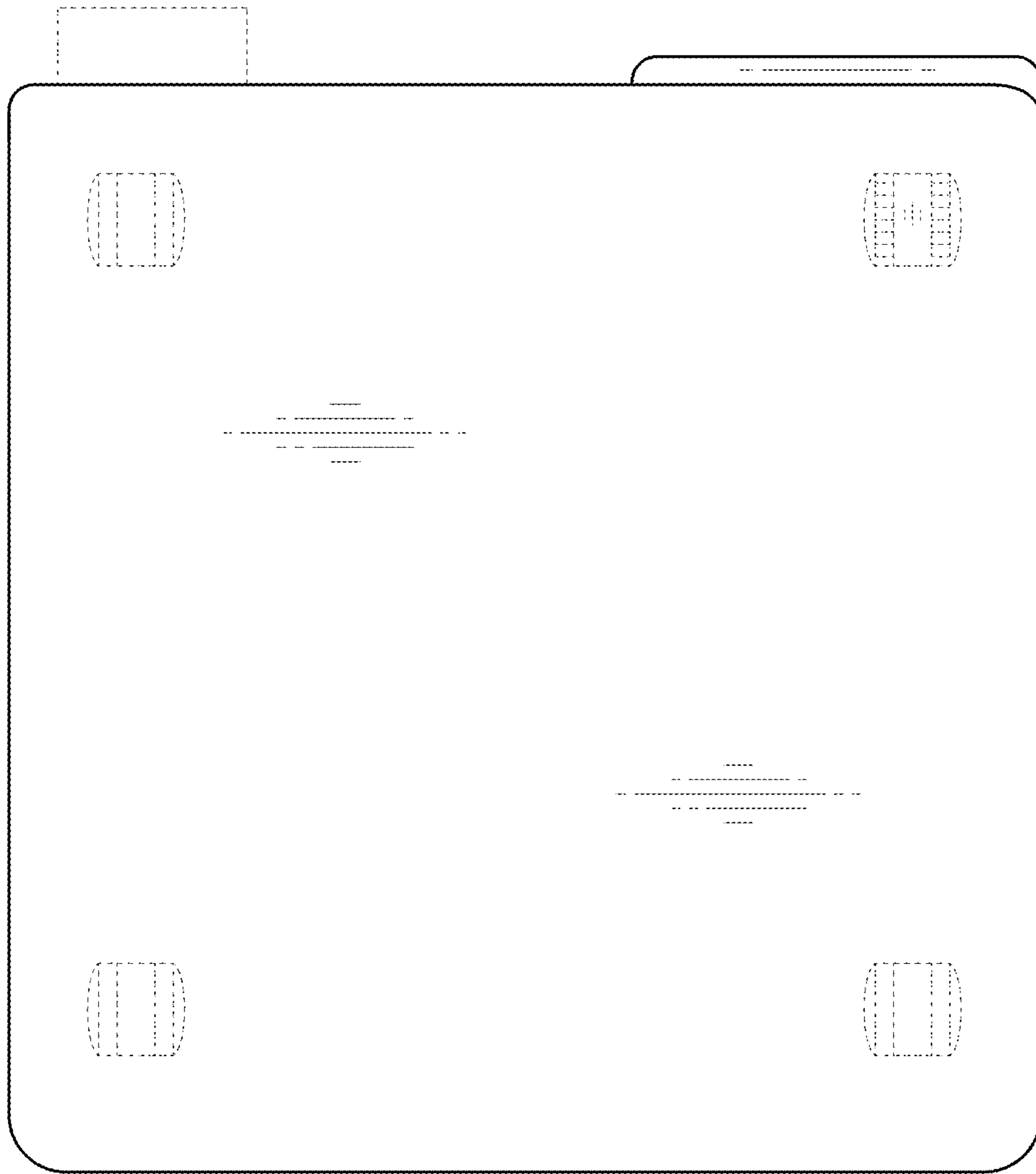

FIG. 5

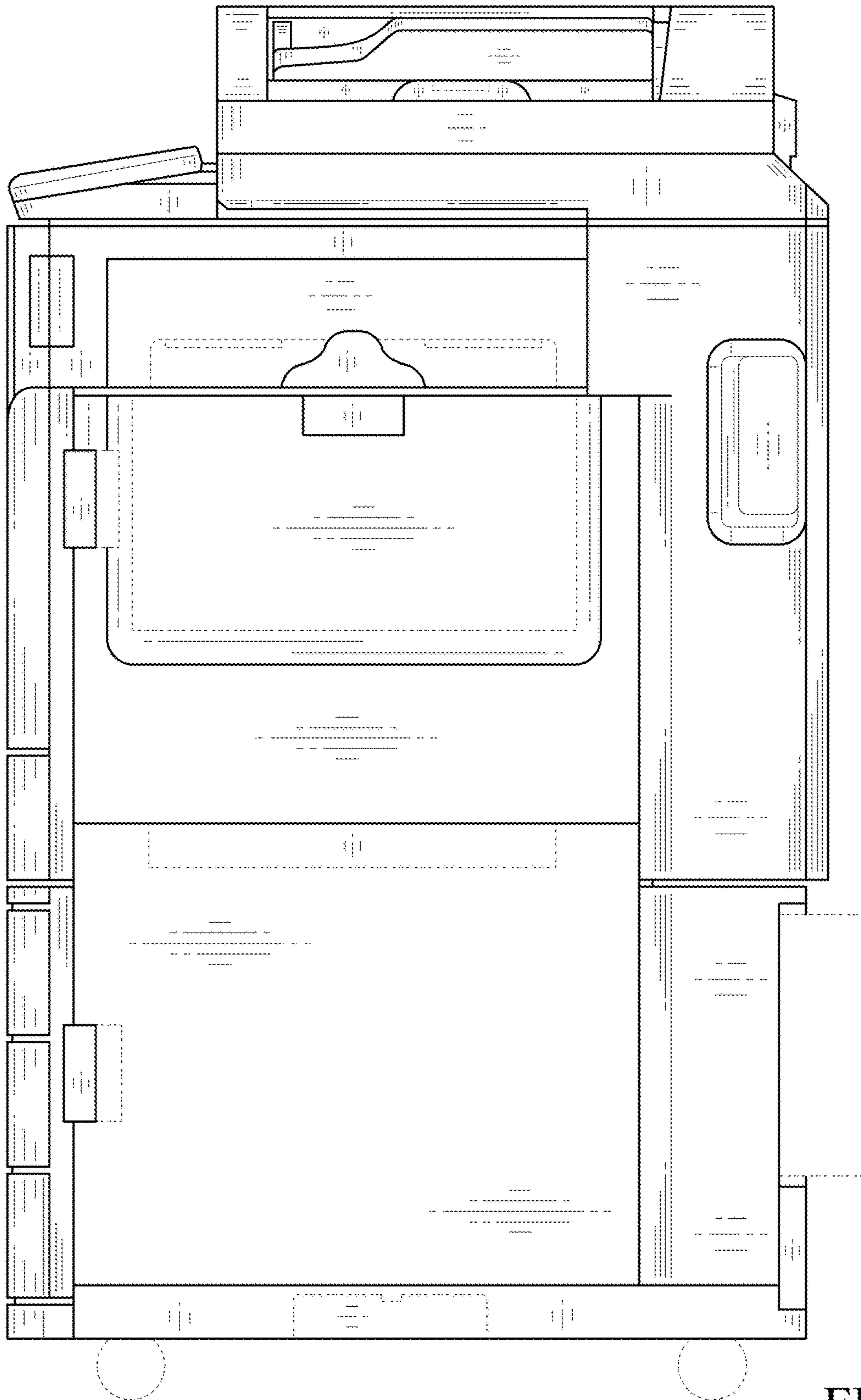

FIG. 6

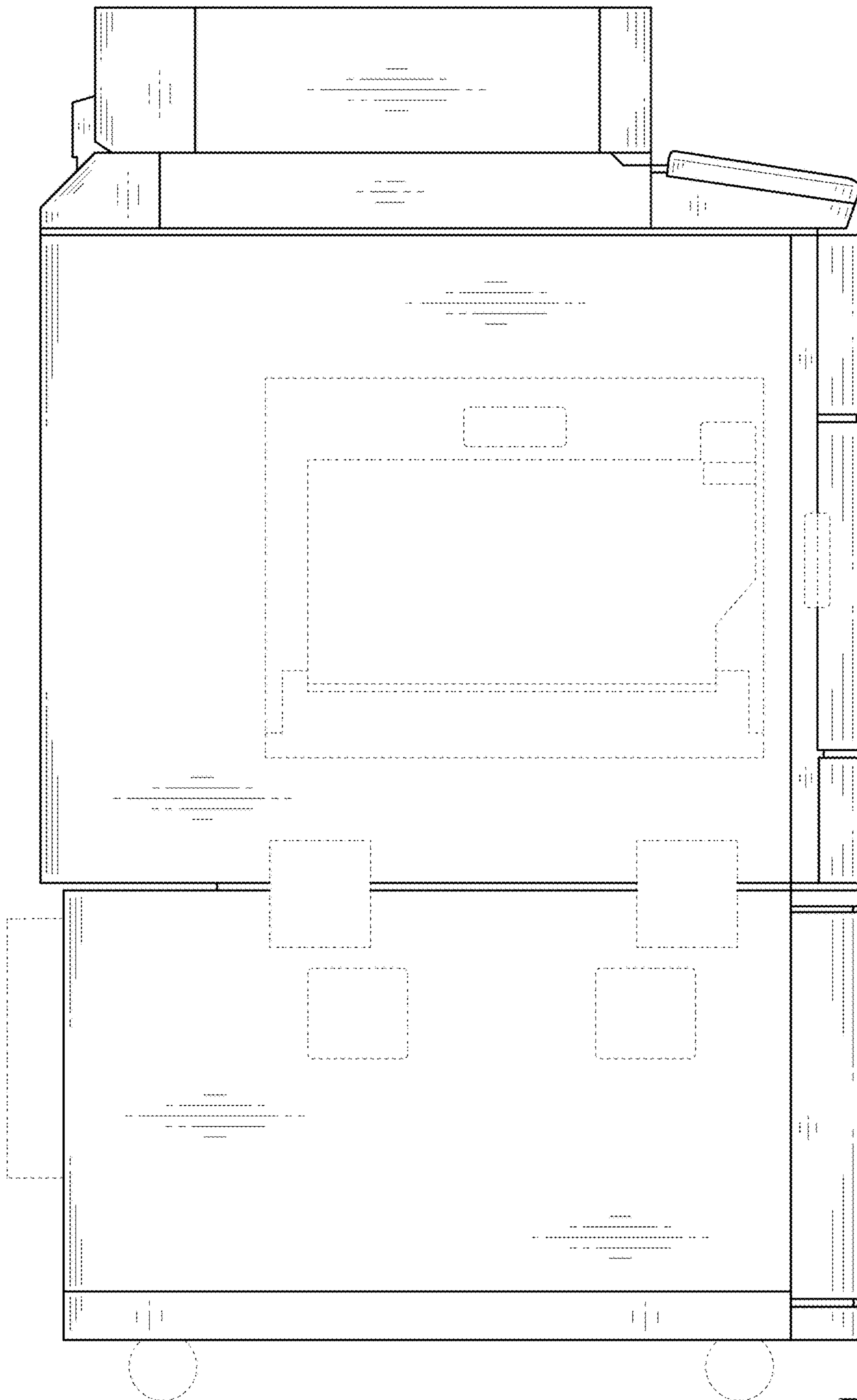

FIG. 7