



US00D830085S

(12) **United States Design Patent** (10) **Patent No.:** **US D830,085 S**
Curthelet et al. (45) **Date of Patent:** **** Oct. 9, 2018**

(54) **AIRCRAFT CREDENZA**
(71) Applicant: **BOMBARDIER INC.**, Dorval (CA)
(72) Inventors: **Alexandre Curthelet**, Montréal (CA);
Adrian Goring, Ville St Laurent (CA);
Louis-Xavier Lavallee, Dorval (CA);
Louis Gagnon-Seguin, Dorval (CA);
Timothy Michael Fagan, Dorval (CA)
(73) Assignee: **BOMBARDIER INC.**, Dorval (CA)
(**) Term: **15 Years**
(21) Appl. No.: **29/593,184**
(22) Filed: **Feb. 7, 2017**

D312,738 S 12/1990 Newhouse
D336,392 S 6/1993 Whalen
D477,474 S * 7/2003 Milligan D6/671.1
D553,385 S * 10/2007 Soressi D6/657
D553,386 S 10/2007 Soressi
D553,387 S * 10/2007 Soressi D6/662
D553,879 S 10/2007 Juneau
D560,930 S 2/2008 Woodward
D605,424 S 12/2009 Lovegrove
D615,776 S 5/2010 Bauchet
D634,562 S 3/2011 Bauchet
D663,136 S * 7/2012 Thompson D6/671
D681,301 S * 4/2013 Bennie D34/1
D686,015 S * 7/2013 Arko D6/703
D688,493 S * 8/2013 Woods D6/661
D690,142 S * 9/2013 Arko D6/681
D724,356 S * 3/2015 Weatherly D6/661
D728,975 S 5/2015 Park
D781,620 S * 3/2017 Curthelet D6/671
D815,464 S * 4/2018 Caillouet D6/657

Related U.S. Application Data

(62) Division of application No. 29/515,797, filed on Jan. 27, 2015, now Pat. No. Des. 781,620.
(51) **LOC (11) Cl.** **06-04**
(52) **U.S. Cl.**
USPC **D6/671**
(58) **Field of Classification Search**
USPC ... D6/657, 660-662, 662.1, 671, 671.1, 681, D6/691.8, 703; D34/6
CPC A47B 17/04; A47B 47/03; A47B 81/06; A47B 83/00; A47F 3/00; A47F 3/005; A47F 5/0807
See application file for complete search history.

* cited by examiner

Primary Examiner — Ricky Pham
(74) *Attorney, Agent, or Firm* — Norton Rose Fulbright Canada LLP

(57) **CLAIM**

We claim the ornamental design for an aircraft credenza, as shown and described.

DESCRIPTION

FIG. 1 is front tridimensional view of an aircraft credenza showing our new design;
FIG. 2 is a top plan view thereof;
FIG. 3 is a front elevational view thereof;
FIG. 4 is a left side elevational view thereof;
FIG. 5 is a rear elevational view thereof;
FIG. 6 is a right side elevational view thereof; and,
FIG. 7 is a bottom plan view of thereof.
Any parts shown in broken lines form no part of the claimed design.

(56) **References Cited**
U.S. PATENT DOCUMENTS

2,489,493 A 11/1949 Kuenzie
D226,832 S * 5/1973 Allen D6/671.1
D256,307 S 8/1980 Frank
D267,532 S 1/1983 Platner
D290,665 S 7/1987 Snodgrass
D300,487 S * 4/1989 Dyer D34/19

1 Claim, 3 Drawing Sheets

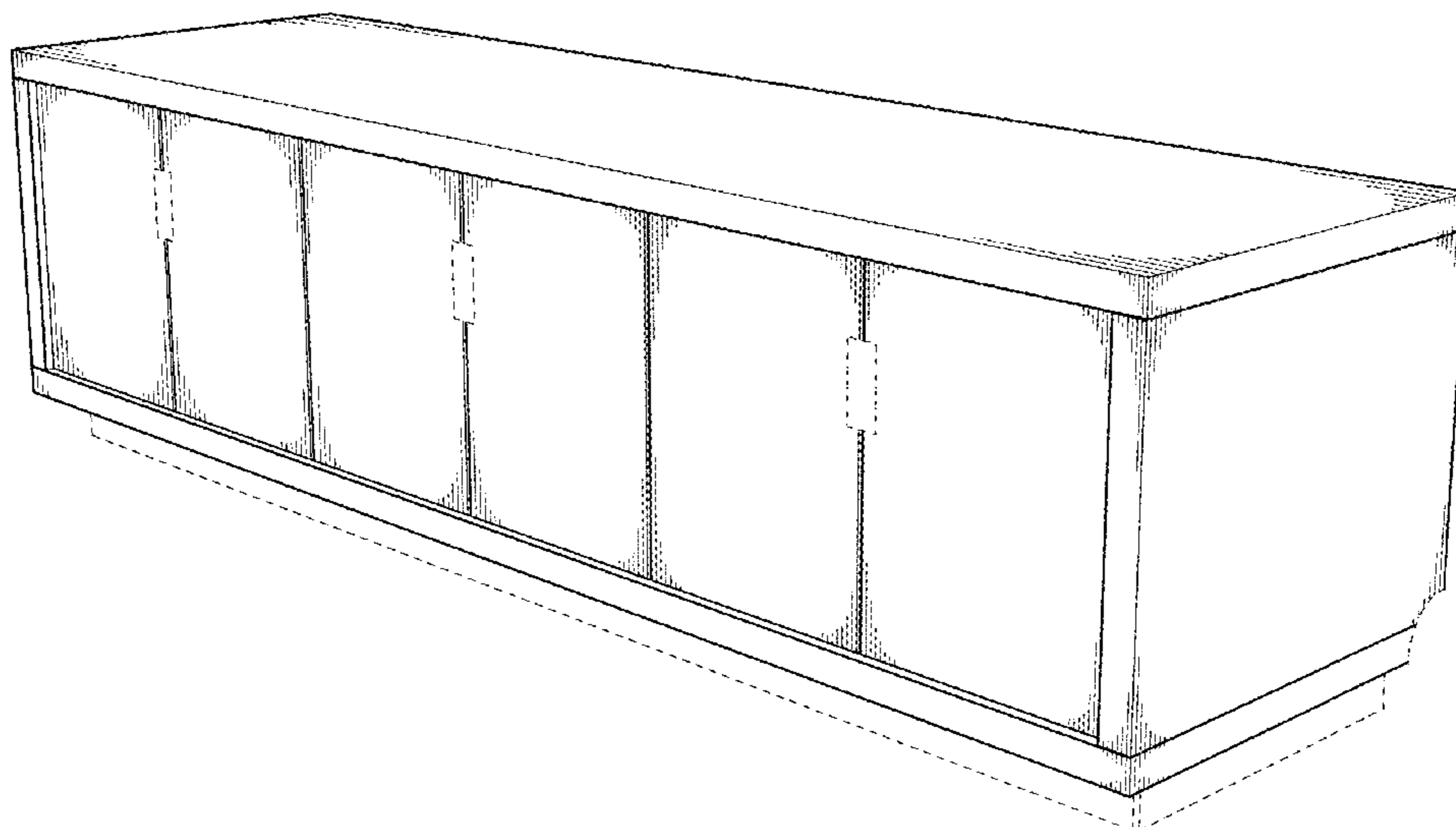

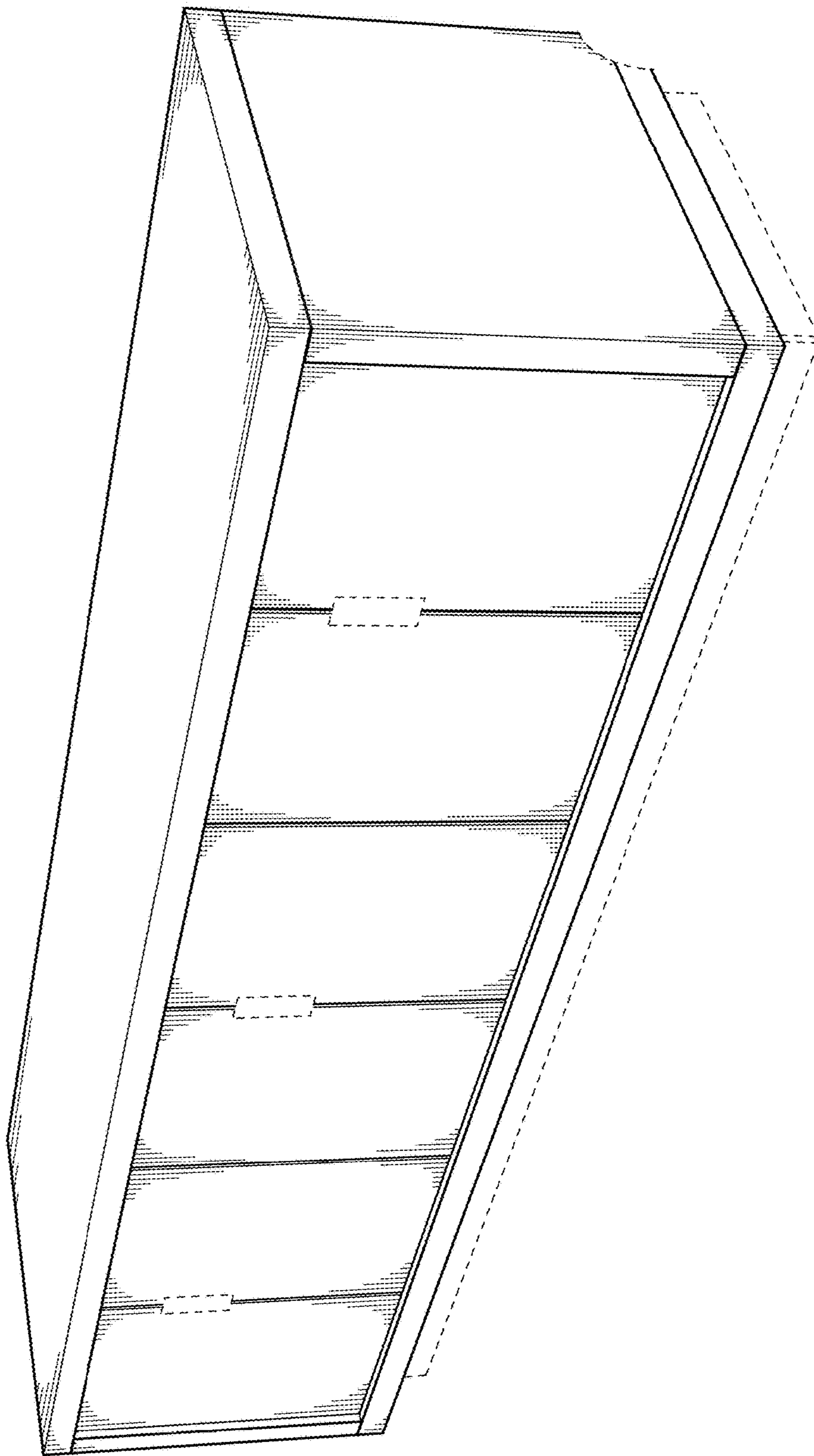

FIG. 1

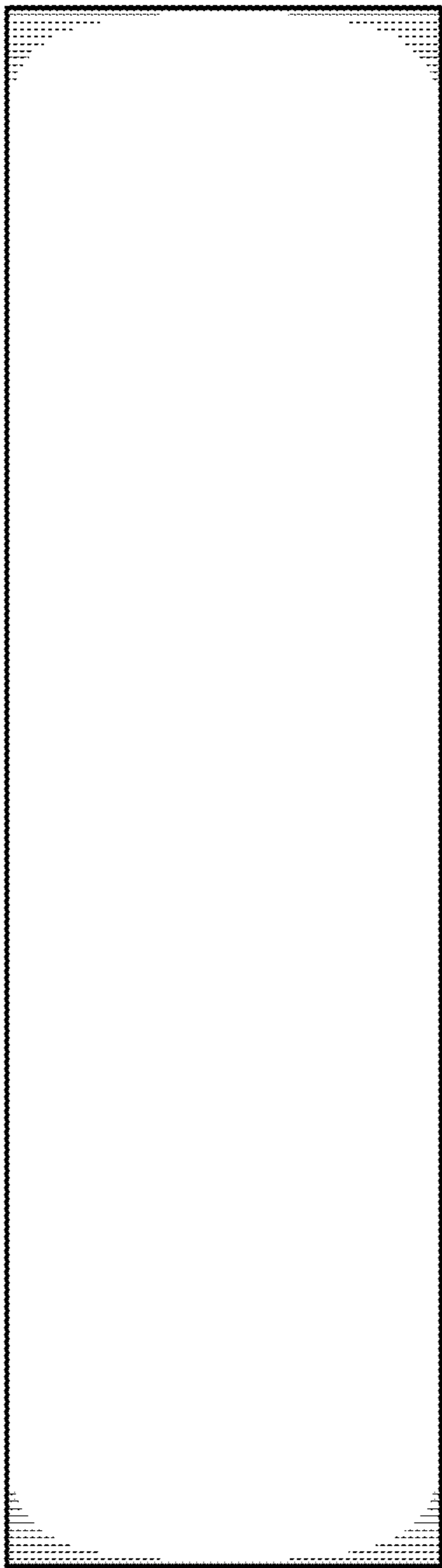

FIG. 2

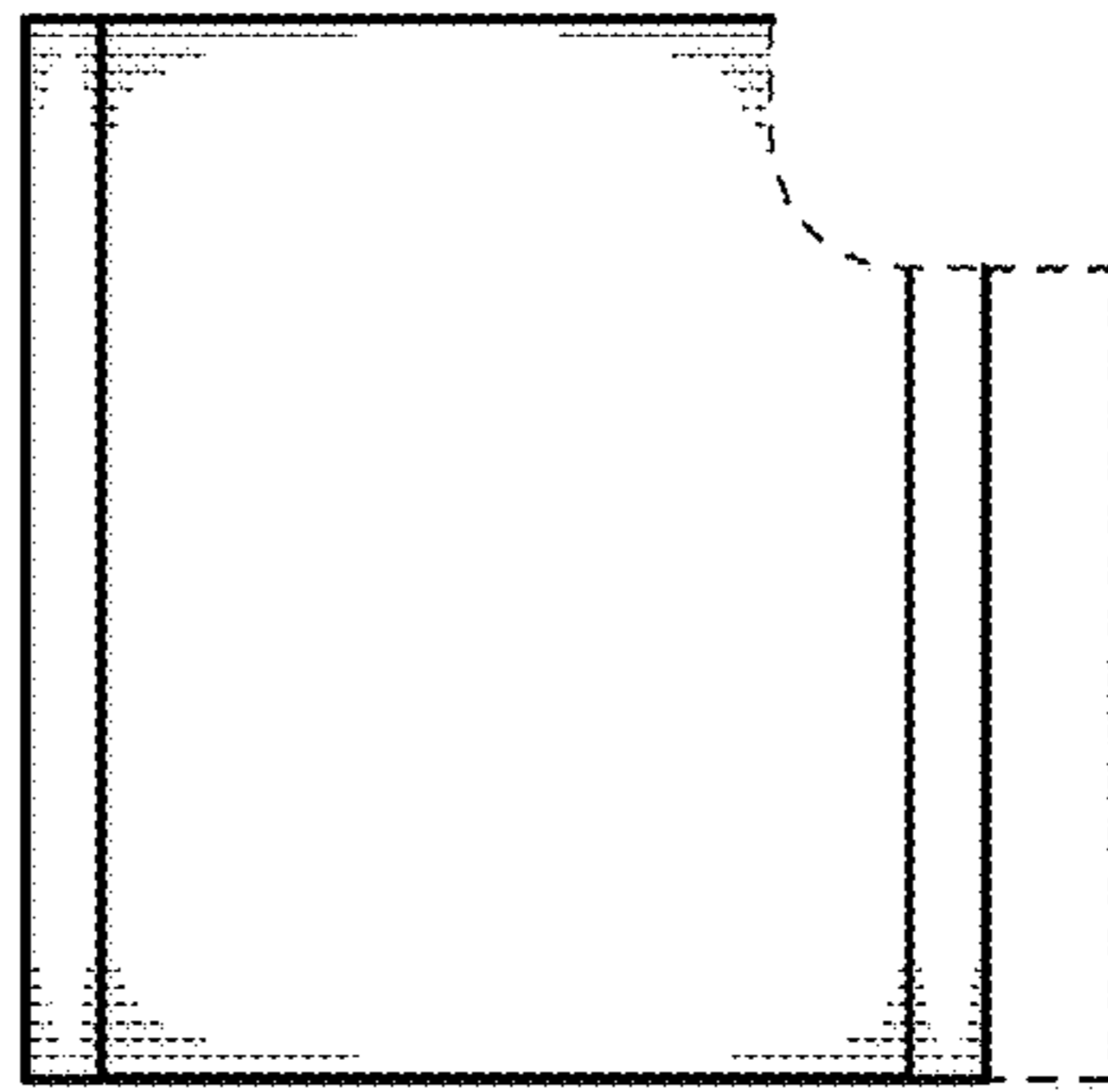

FIG. 4

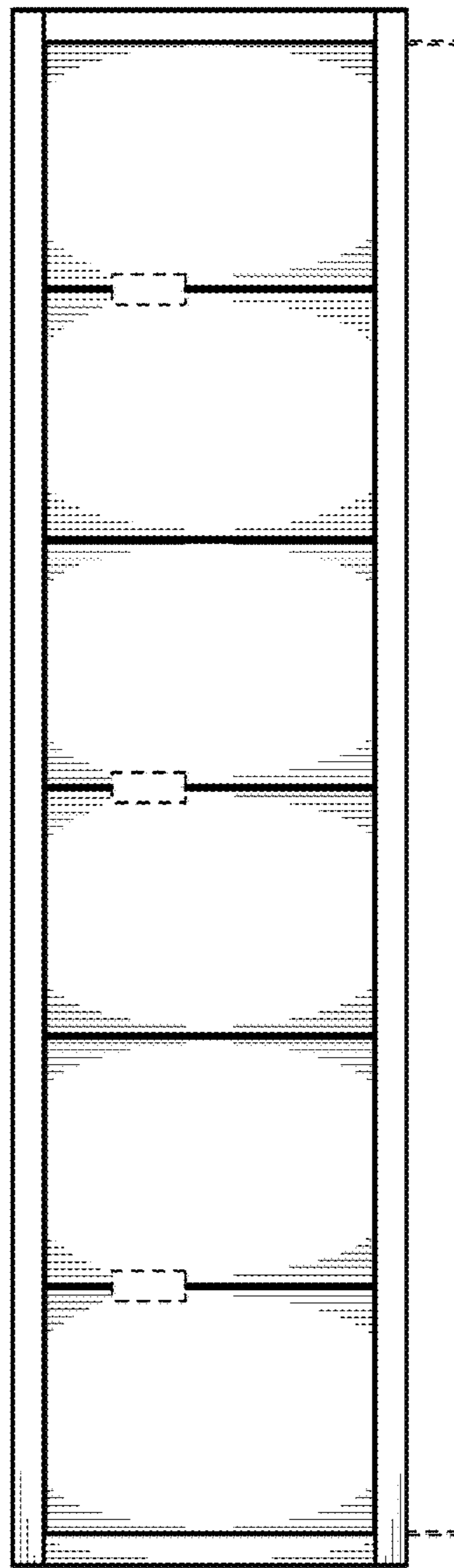

FIG. 3

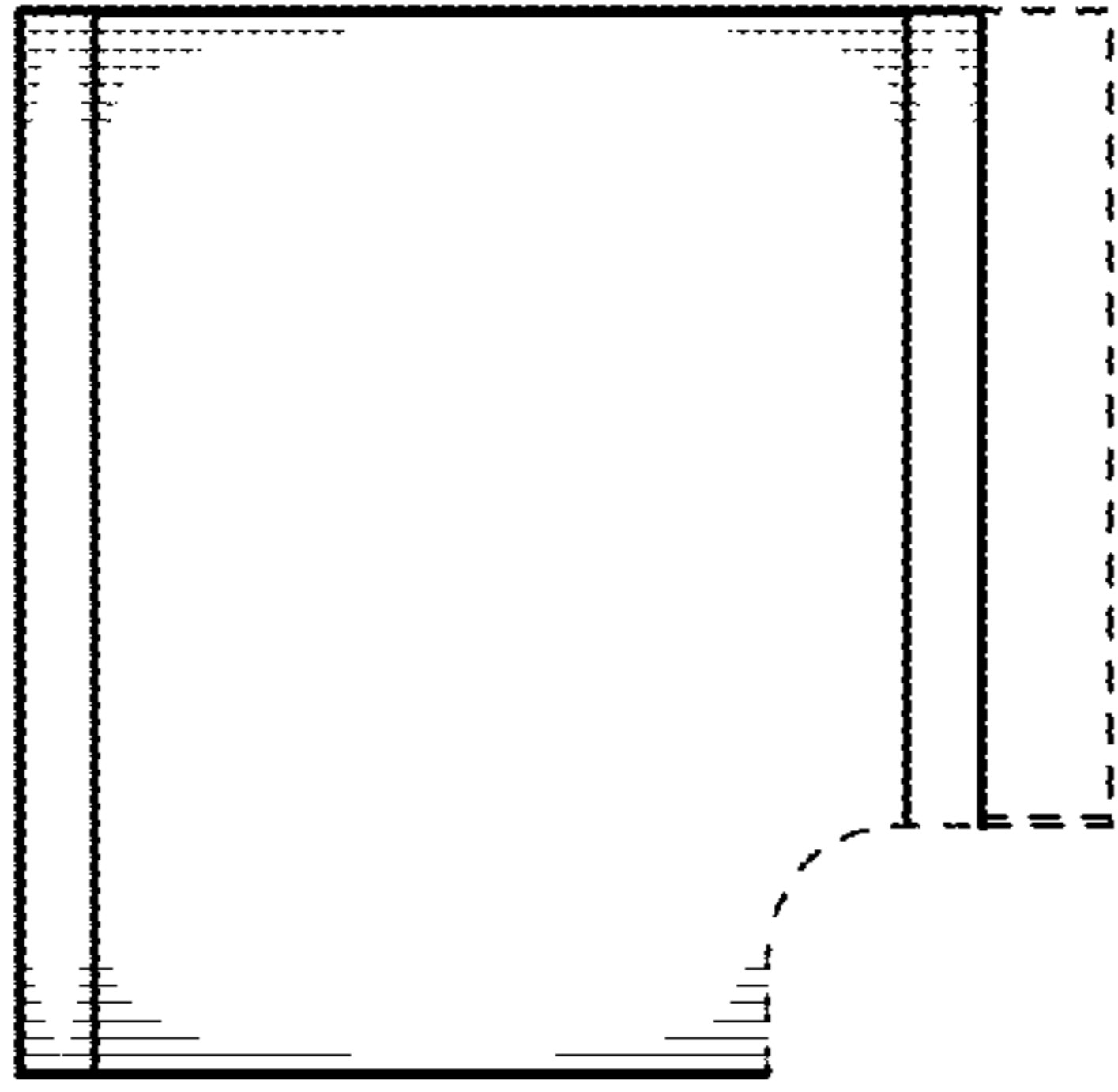

FIG. 5

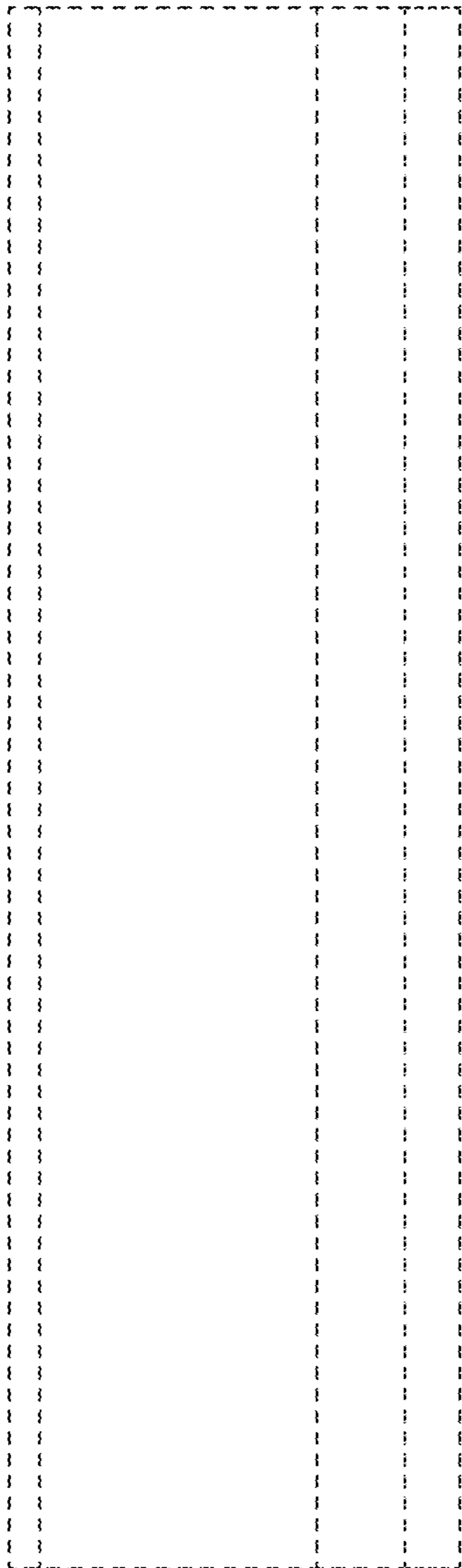

FIG. 6

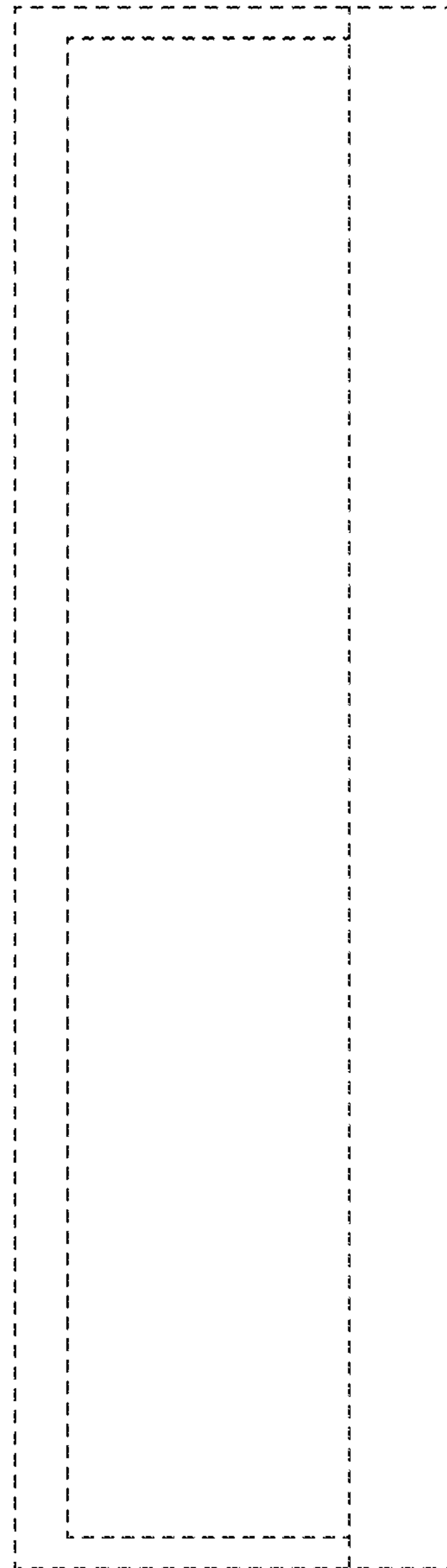

FIG. 7