



US00D829786S

(12) **United States Design Patent** (10) **Patent No.:** **US D829,786 S**  
**Furusawa** (45) **Date of Patent:** **\*\* Oct. 2, 2018**

(54) **CUTTING INSERT**  
(71) Applicant: **KYOCERA Corporation**, Kyoto-shi,  
Kyoto (JP)  
(72) Inventor: **Toru Furusawa**, Yotsukaido (JP)  
(73) Assignee: **KYOCERA Corporation**, Kyoto-shi,  
Kyoto (JP)

D414,194 S \* 9/1999 Patterson ..... D15/139  
D425,085 S \* 5/2000 Bernadic ..... D15/139  
D477,003 S \* 7/2003 Muren ..... D15/139  
D481,047 S \* 10/2003 Brockett ..... D15/139  
D487,756 S \* 3/2004 Kasperik ..... D15/139  
D491,588 S \* 6/2004 Kasperik ..... D15/139  
2014/0010607 A1\* 1/2014 Wandeback ..... B23F 21/128  
407/113

(\*\*) Term: **15 Years**

\* cited by examiner

*Primary Examiner* — Patricia A Palasik  
(74) *Attorney, Agent, or Firm* — Kenja IP Law PC

(21) Appl. No.: **29/587,524**

(22) Filed: **Dec. 14, 2016**

(57) **CLAIM**

The ornamental design for a cutting insert, as shown and described.

(30) **Foreign Application Priority Data**

Jul. 8, 2016 (JP) ..... 2016-014616

**DESCRIPTION**

(51) **LOC (11) Cl.** ..... **15-09**

(52) **U.S. Cl.**  
USPC ..... **D15/139**

(58) **Field of Classification Search**  
USPC ..... D8/20, 70; D15/126, 131, 138, 139, 140  
CPC ..... B23C 5/109; B23C 5/207  
See application file for complete search history.

FIG. 1 is a front perspective view of a cutting insert showing my new design;  
FIG. 2 is a front view thereof;  
FIG. 3 is a top view thereof;  
FIG. 4 is a right side view thereof;  
FIG. 5 is a left side view thereof;  
FIG. 6 is a rear view thereof;  
FIG. 7 is a bottom view thereof;  
FIG. 8 is a sectional view thereof taken along line 8-8 in FIG. 3; and,  
FIG. 9 is an enlarged partial top view thereof.

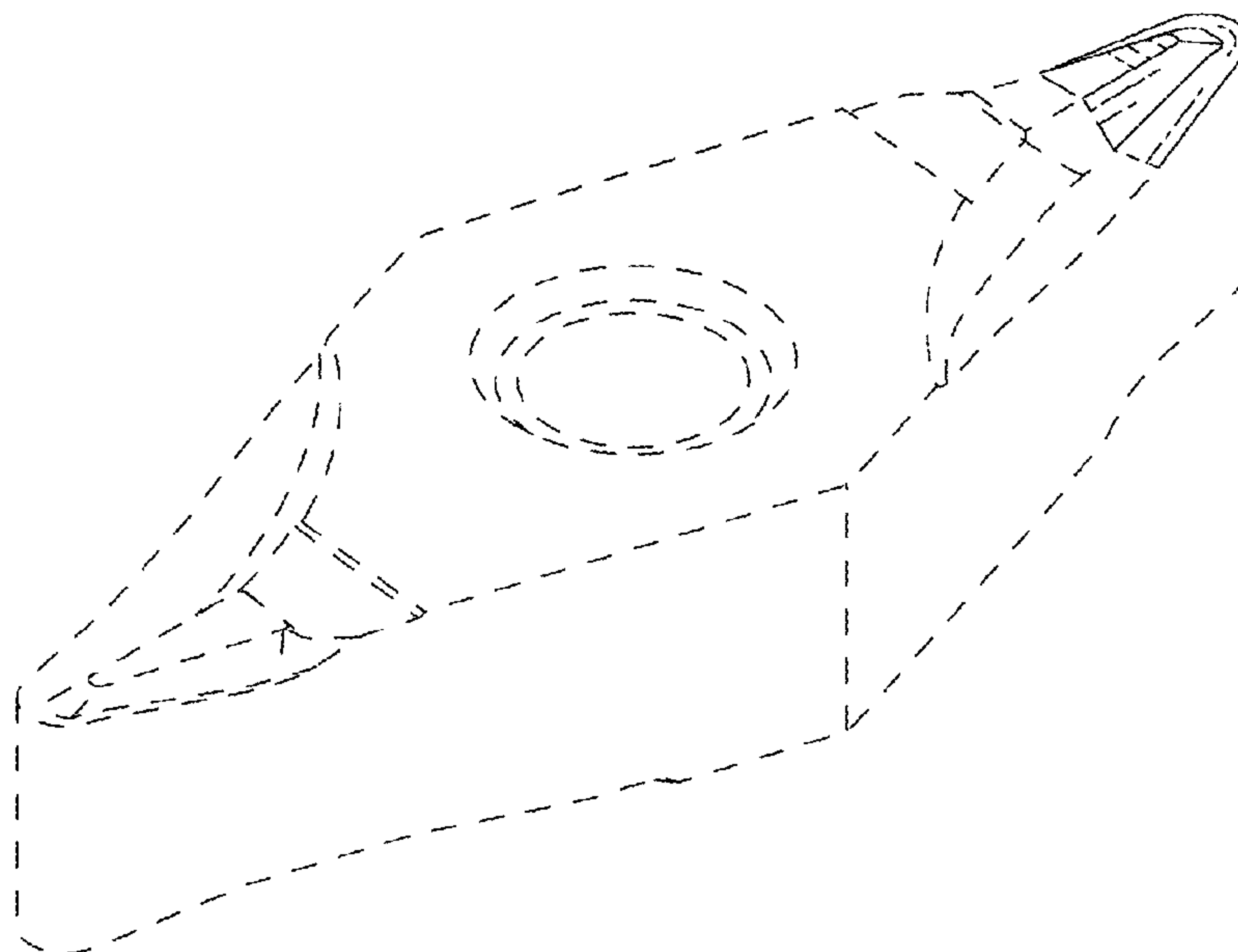
(56) **References Cited**

**U.S. PATENT DOCUMENTS**

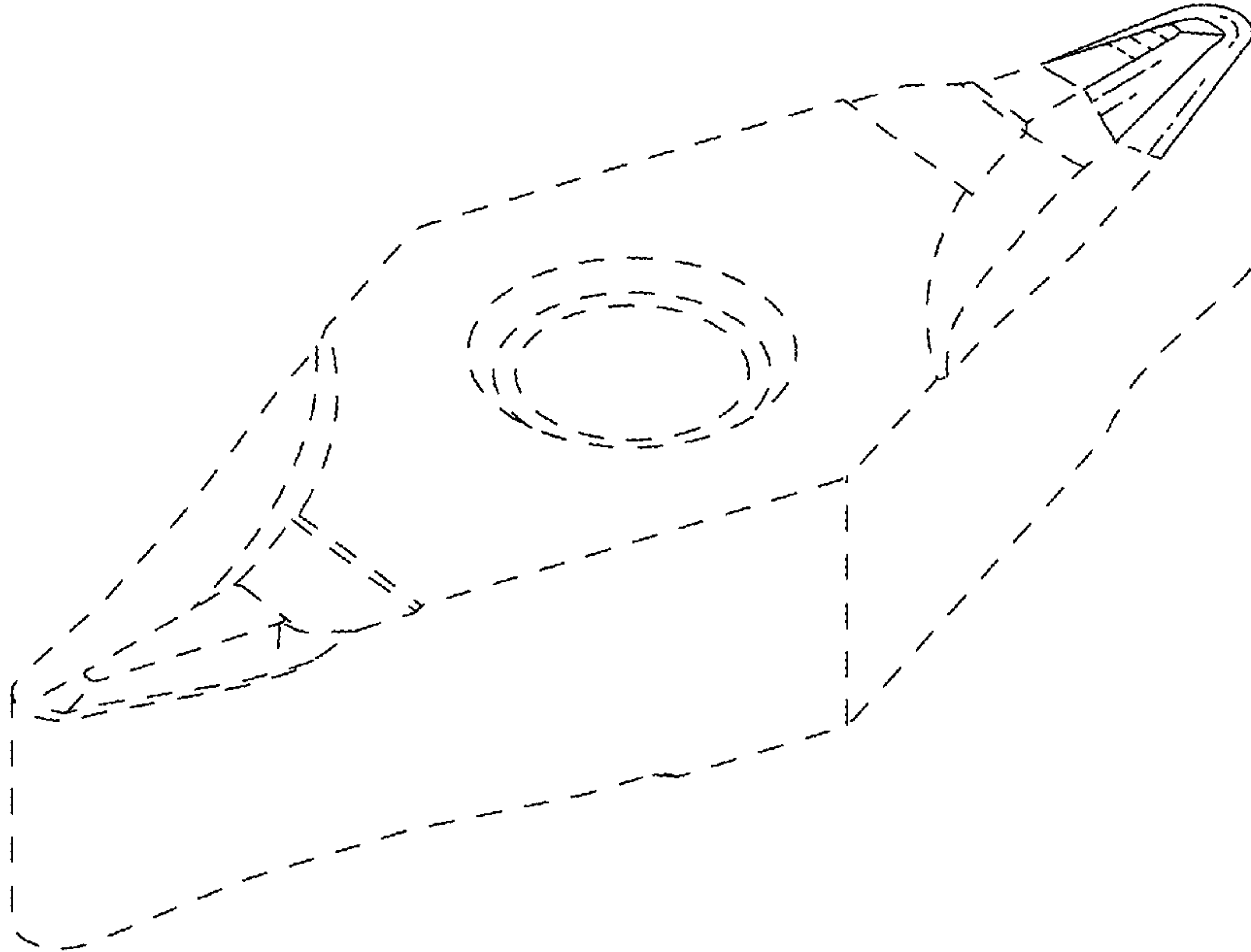
4,335,984 A \* 6/1982 Zweekly ..... B23B 27/143  
407/114  
D275,396 S \* 9/1984 Porat ..... D15/139  
D330,381 S \* 10/1992 Gustafsson ..... D15/139  
D362,859 S \* 10/1995 Wiman ..... D15/139  
D365,112 S \* 12/1995 Wiman ..... D15/139  
D404,744 S \* 1/1999 Bernadic ..... D15/139  
D404,745 S \* 1/1999 Bernadic ..... D15/139  
D410,475 S \* 6/1999 Bernadic ..... D15/139

The broken lines in the drawings depict unclaimed environmental subject matter. The dash-dot-dash lines directly adjacent to the claimed areas are included to represent the boundaries of the claimed design and form no part of the claimed design.

**1 Claim, 9 Drawing Sheets**



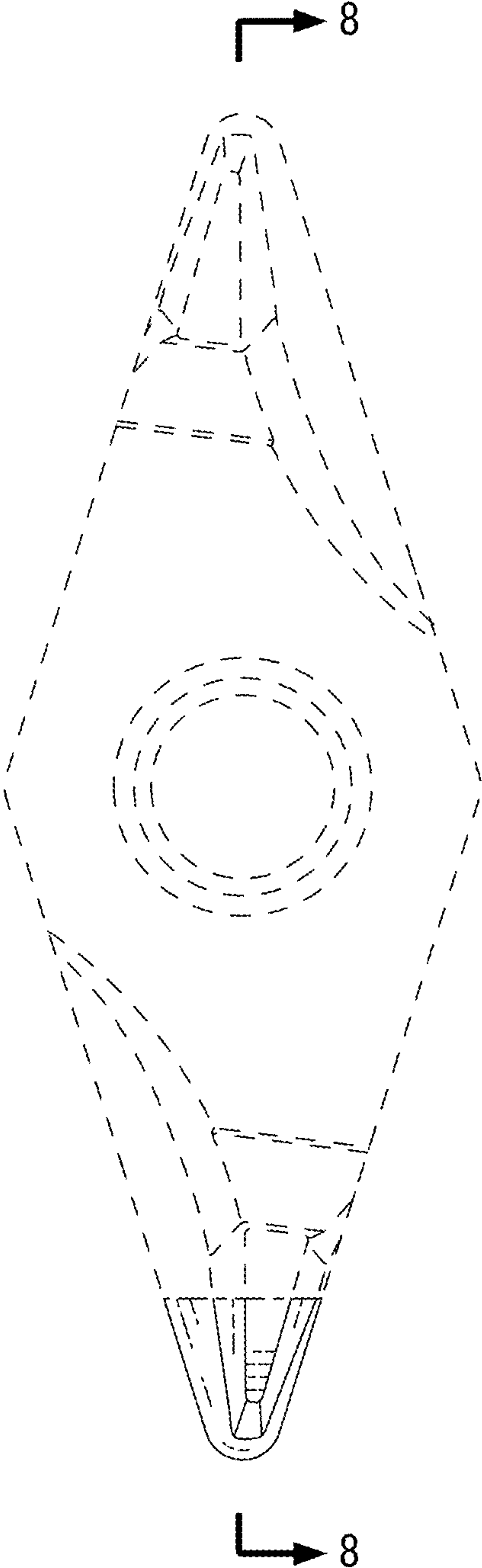
*FIG. 1*



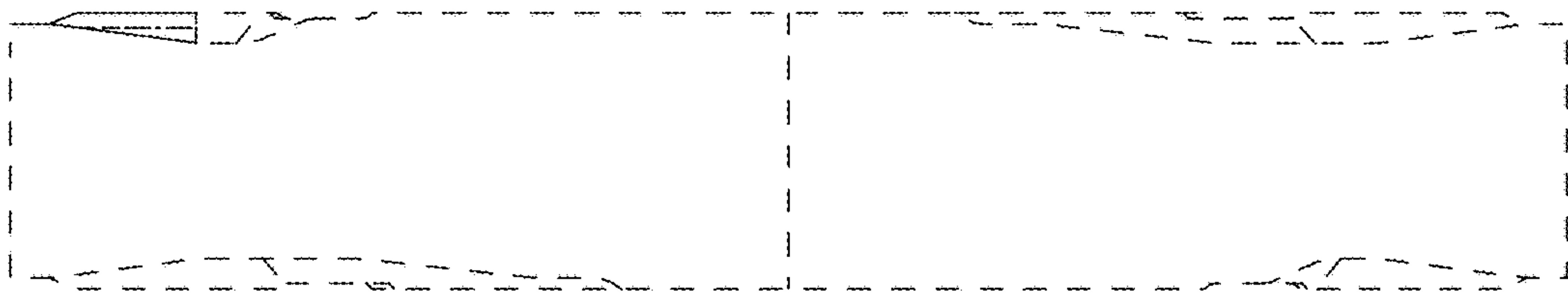
*FIG. 2*



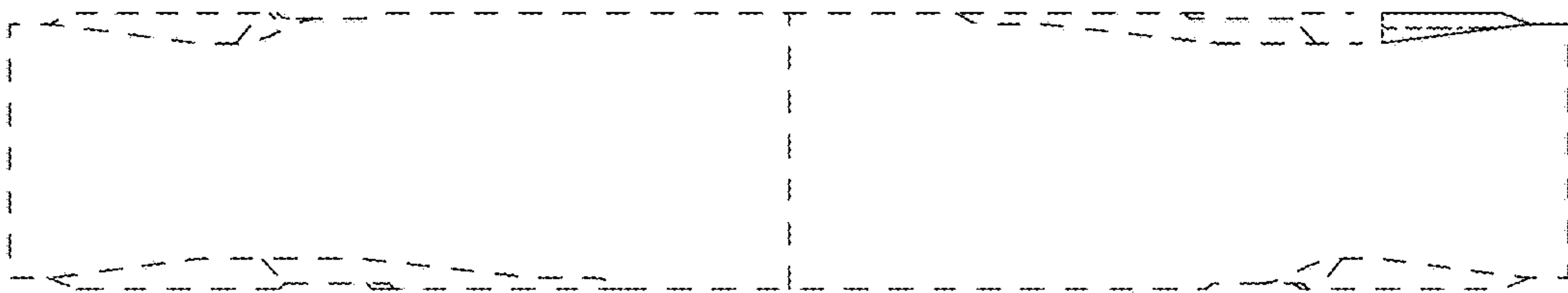
*FIG. 3*



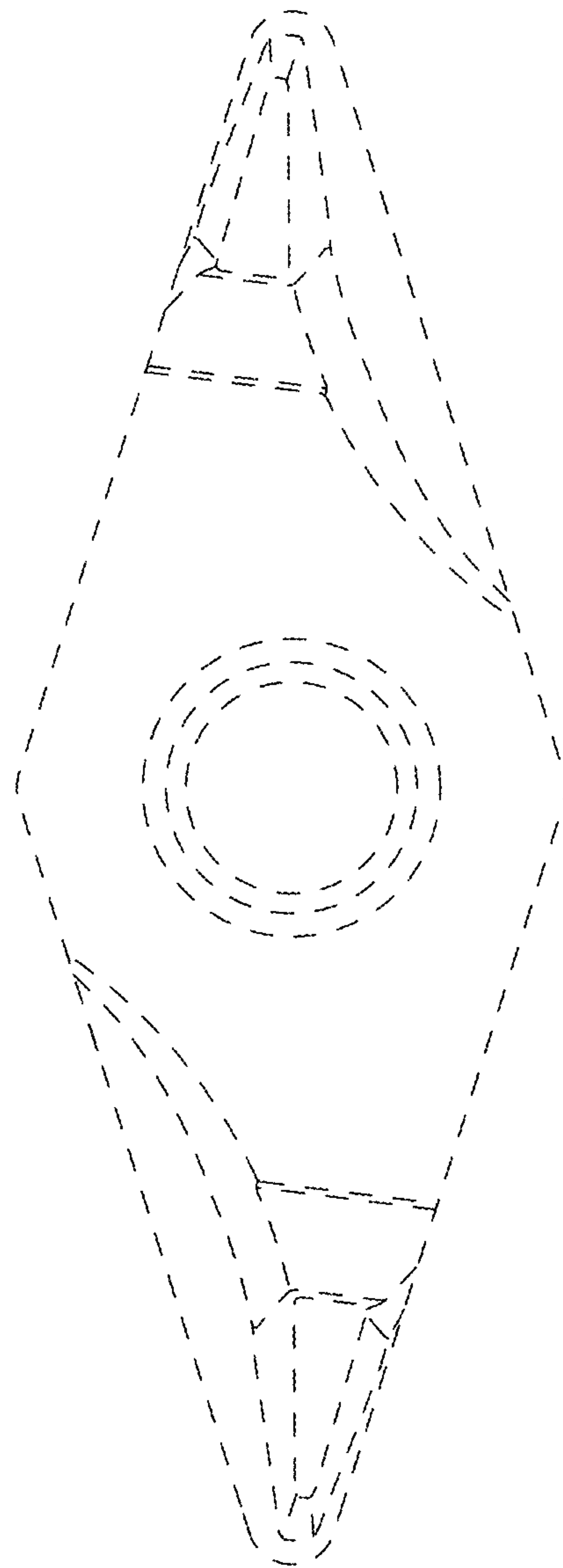
*FIG. 4*



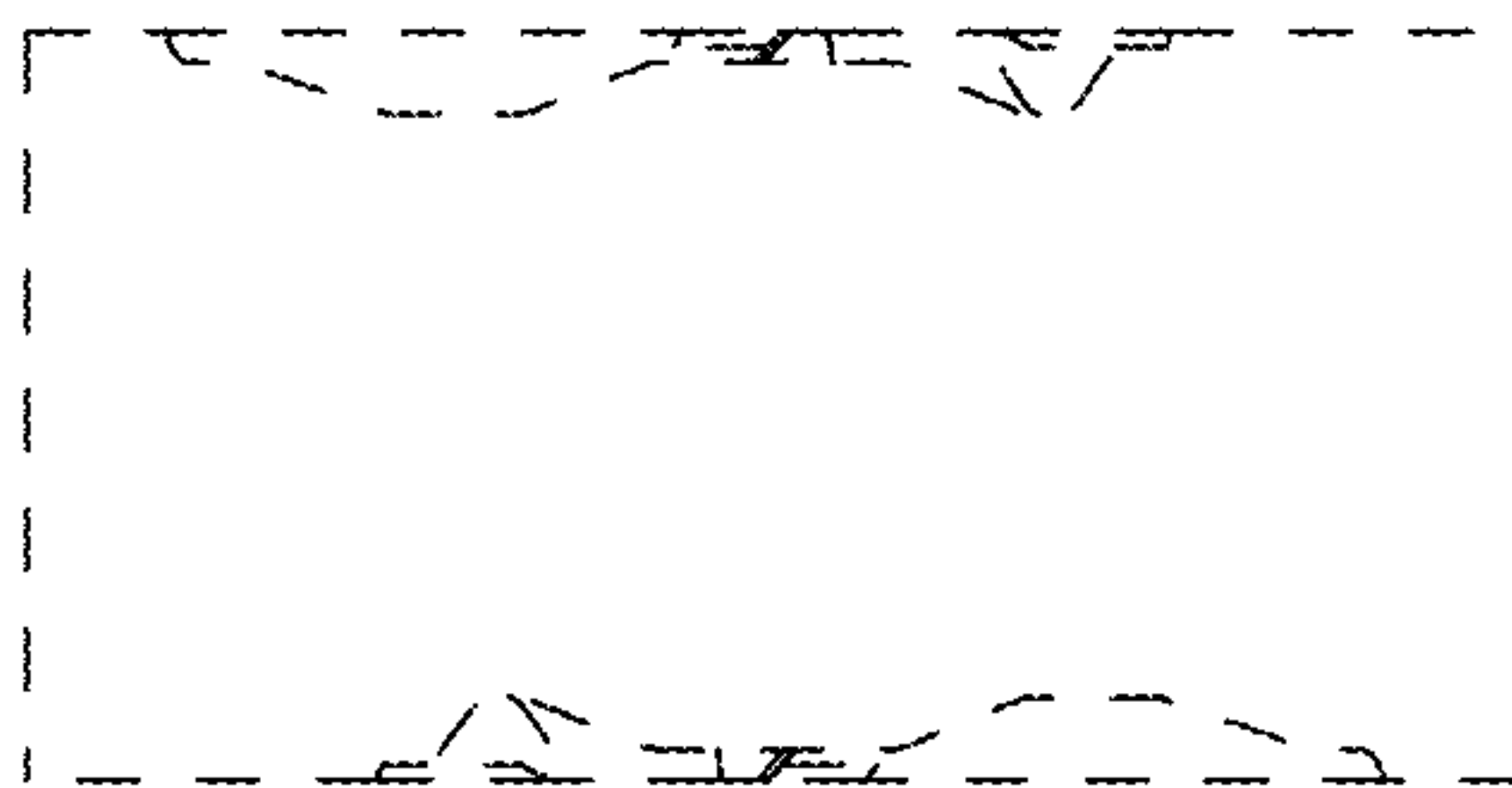
*FIG. 5*



*FIG. 6*

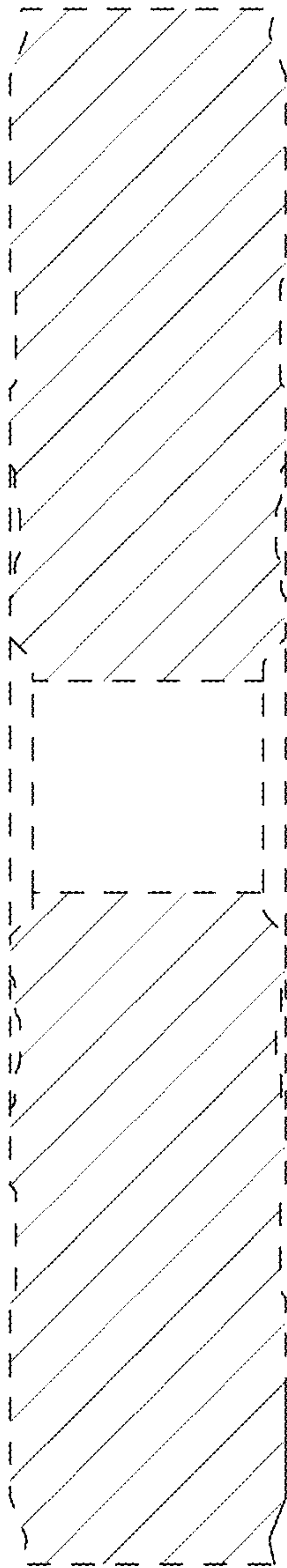


*FIG. 7*





*FIG. 8*



*FIG. 9*

