



US00D829027S

(12) **United States Design Patent** (10) **Patent No.:** **US D829,027 S**  
**Hales et al.** (45) **Date of Patent:** **\*\* Sep. 25, 2018**

(54) **COLOR CENTER DISPLAY**  
(71) Applicant: **Behr Process Corporation**, Santa Ana, CA (US)  
(72) Inventors: **Marianne Hales**, Irvine, CA (US); **Peter Schumerth**, Fountain Valley, CA (US); **Cody Berry**, Fountain Valley, CA (US); **Erika Woelfel**, Irvine, CA (US); **Diana Olvera**, Santa Ana, CA (US); **Doug Dow**, Fullerton, CA (US); **Lindsey Burr**, Irvine, CA (US)  
(73) Assignee: **Behr Process Corporation**, Santa Ana, CA (US)  
(\*\*) Term: **15 Years**  
(21) Appl. No.: **29/624,758**  
(22) Filed: **Nov. 3, 2017**  
(51) **LOC (11) Cl.** ..... **06-06**  
(52) **U.S. Cl.** ..... **D6/675**  
USPC ..... **D6/675**  
(58) **Field of Classification Search**  
USPC ..... D6/663, 664, 669-670, 671.1, 672, 673, D6/675, 683, 683.1; D3/273, 304-314; D9/424, 435, 449  
CPC ..... B65D 25/00; B65D 43/00; B65D 43/02; A47G 5/00; A47G 29/00; A47F 7/14; A47F 7/16; A47F 7/285  
See application file for complete search history.

D488,633 S 4/2004 Richardson et al.  
D493,045 S 7/2004 Richardson et al.  
D497,269 S 10/2004 Richardson et al.  
D497,495 S 10/2004 Richardson et al.  
D502,222 S 2/2005 Richardson et al.  
D519,115 S 4/2006 Lee et al.  
D526,819 S 8/2006 Lee et al.  
D527,207 S 8/2006 Lee et al.  
D527,934 S 9/2006 Lee et al.  
D528,835 S 9/2006 Lee et al.  
D532,416 S 11/2006 Lee et al.  
D557,041 S 12/2007 Lee et al.  
D631,679 S 2/2011 Woelfel  
D641,986 S 7/2011 Giroux et al.  
D641,987 S 7/2011 Giroux  
D641,988 S 7/2011 Giroux  
D641,989 S 7/2011 Giroux et al.  
D641,990 S 7/2011 Giroux  
D641,991 S 7/2011 Giroux  
D641,992 S 7/2011 Giroux et al.  
D642,399 S 8/2011 Giroux et al.  
D698,189 S 1/2014 Woelfel et al.  
D699,056 S 2/2014 Woelfel et al.  
D707,991 S 7/2014 Woelfel et al.  
D708,872 S 7/2014 Woelfel et al.  
D715,079 S 10/2014 Woelfel et al.  
D754,993 S \* 5/2016 Nathan ..... D6/675.3

(Continued)

*Primary Examiner* — Kelley A Donnelly  
(74) *Attorney, Agent, or Firm* — Lora J. Graentzdoerffer

(57) **CLAIM**

The ornamental design for color center display, as shown and described.

**DESCRIPTION**

FIG. 1 is a perspective view; and, FIG. 2 is an elevation view. The broken-line disclosure in the views represents portions of the color center display in which the claimed design is embodied, but which forms no part of the claimed design.

**1 Claim, 2 Drawing Sheets**

(56) **References Cited**  
U.S. PATENT DOCUMENTS  
D248,808 S \* 8/1978 Offredi ..... D6/662.1  
D249,215 S \* 9/1978 Offredi ..... D6/662.1  
D320,130 S \* 9/1991 Sutherland ..... D6/675.1  
D488,001 S 4/2004 Richardson et al.  
D488,318 S 4/2004 Richardson et al.

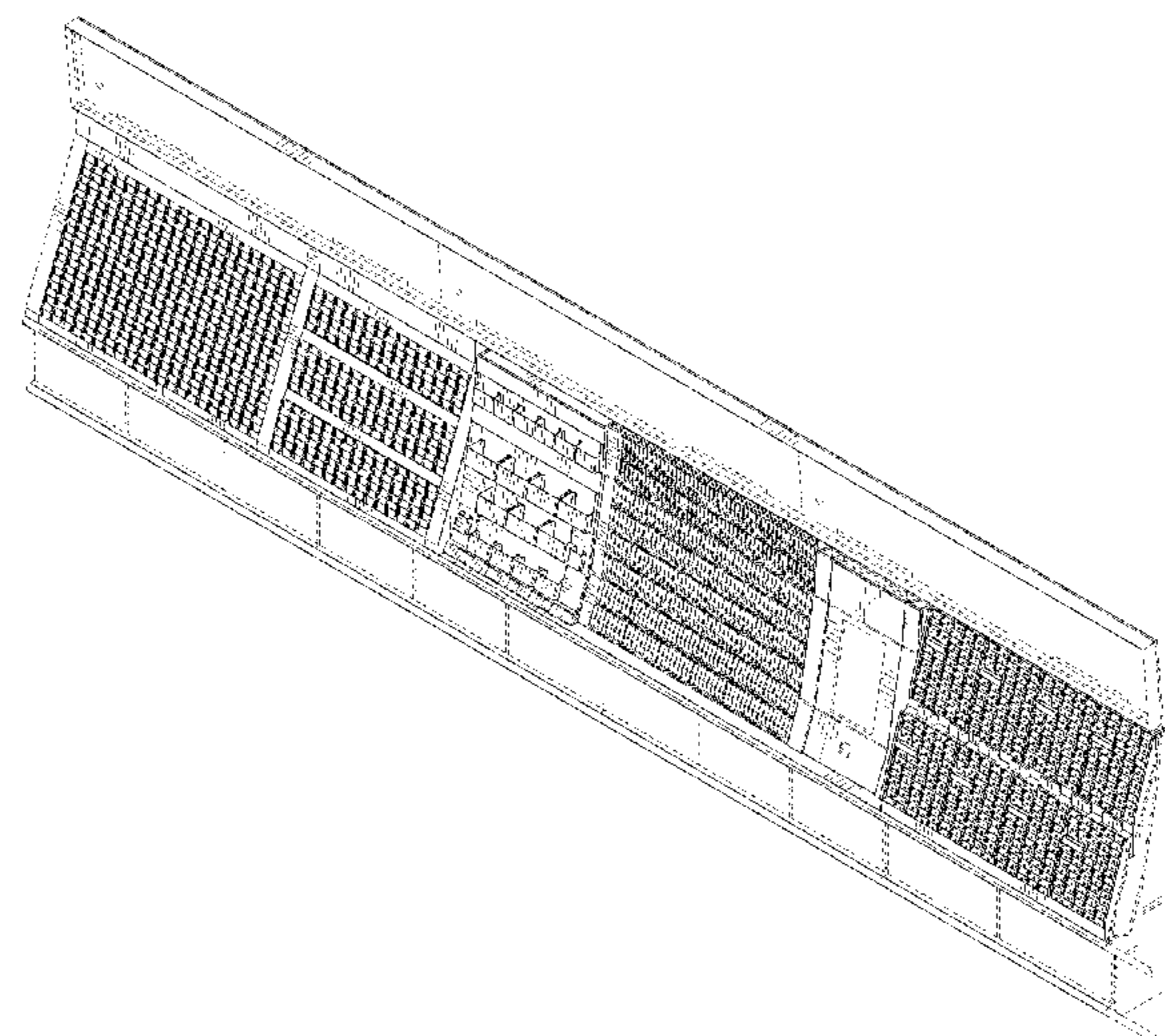

(56)

**References Cited**

U.S. PATENT DOCUMENTS

D757,465 S	5/2016	Woelfel et al.	
D761,599 S *	7/2016	Mason .....	D6/675.1
D776,463 S *	1/2017	Boaz .....	D6/672
D793,137 S	8/2017	Federwisch et al.	
D817,670 S *	5/2018	Germain .....	D6/675.4
D817,671 S *	5/2018	Germain .....	D6/675.4

\* cited by examiner

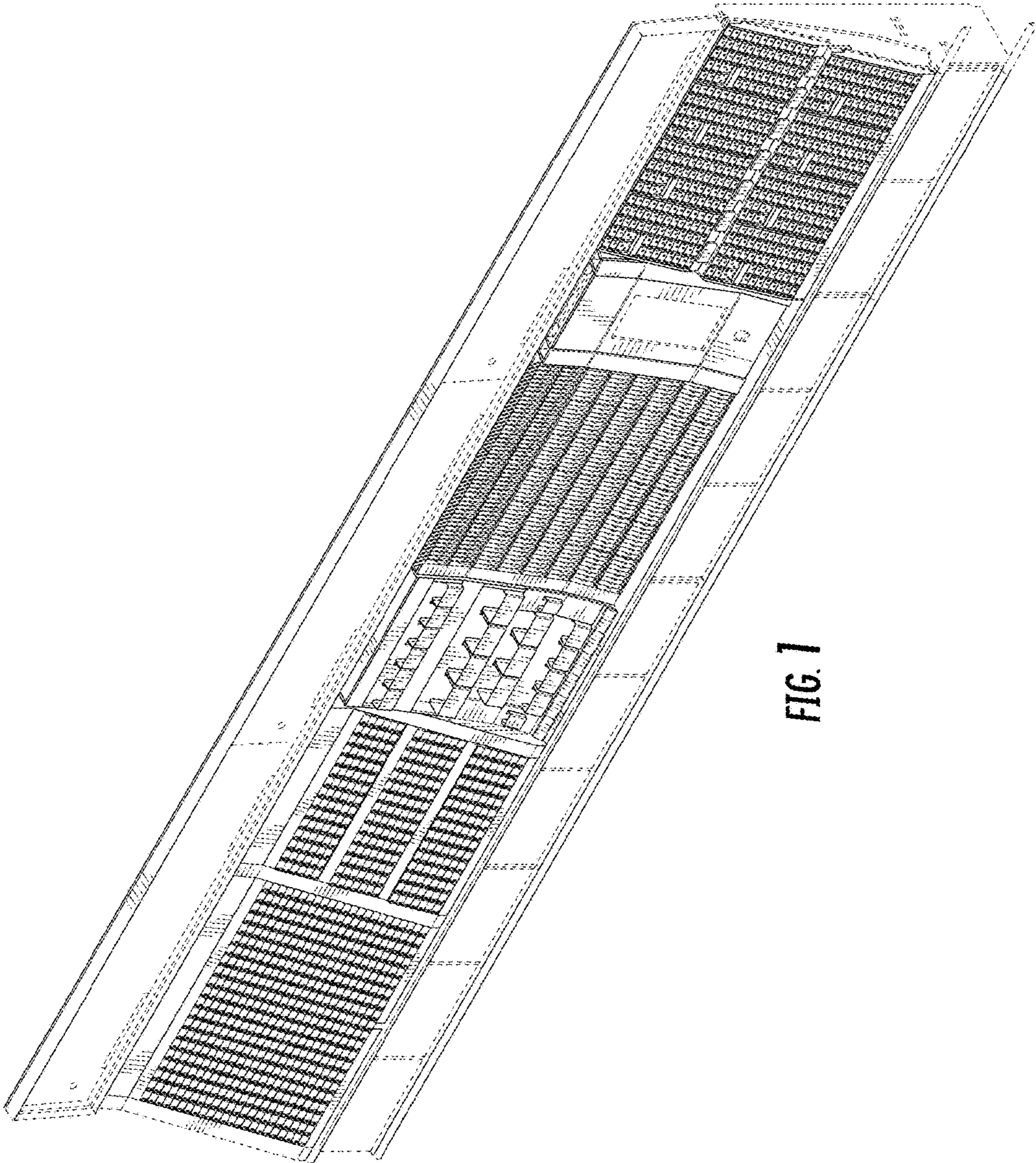

FIG. 1

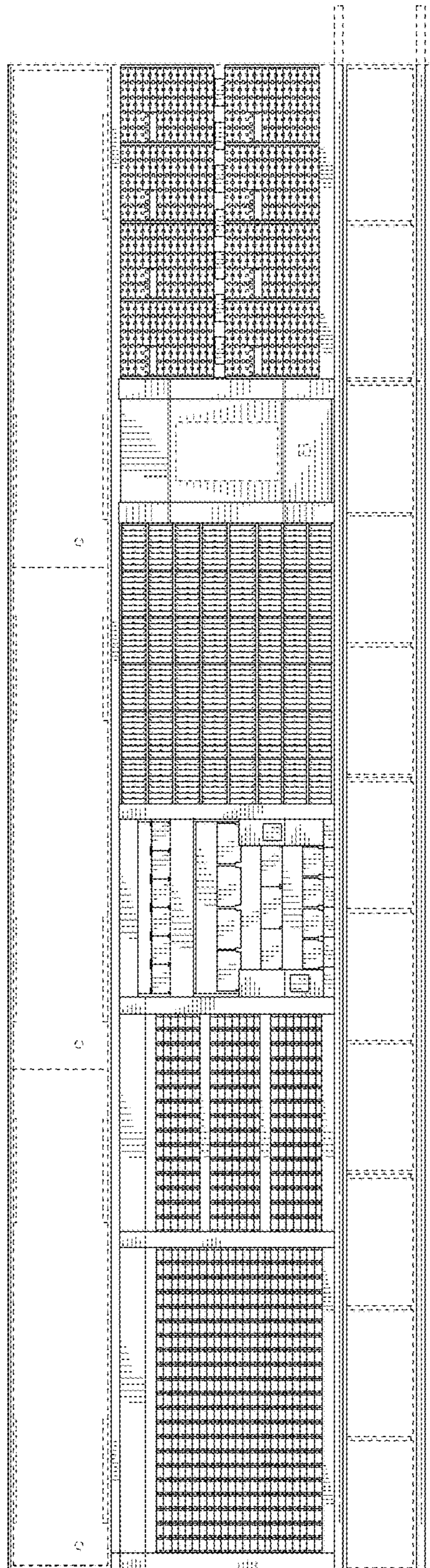

FIG. 2