



US00D827707S

(12) **United States Design Patent**  
**Campanini**

(10) **Patent No.:** **US D827,707 S**  
(45) **Date of Patent:** **\*\* Sep. 4, 2018**

- (54) **PRINTER**
- (71) Applicant: **Custom S.p.A.**, Fontevivo (IT)
- (72) Inventor: **Alberto Campanini**, Fidenza (IT)
- (73) Assignee: **Custom S.p.A.** (IT)
- (\*\*) Term: **15 Years**
- (21) Appl. No.: **29/532,421**
- (22) Filed: **Jul. 7, 2015**
- (51) **LOC (11) Cl.** ..... **18-02**
- (52) **U.S. Cl.**  
USPC ..... **D18/56**
- (58) **Field of Classification Search**  
USPC ..... D18/4.5, 12, 14, 18, 34.5, 40, 56, 34.9,  
D18/99, 36, 37, 38, 39, 41, 44, 45, 46,  
D18/47, 48, 49, 50, 51, 52, 53, 54, 55;  
D14/483, 432, 434, 345, 346, 425, 462,  
D14/463, 464, 465, 466, 467, 468, 469,  
D14/470, 471, 301, 307, 129, 130, 299;  
399/1-7, 16, 75, 81, 107, 130, 361, 355,  
399/381-383, 388; 101/113; 358/1.1;  
355/18, 23, 97; 400/613; 271/278, 226,  
271/8.1, 3.14; D15/138, 199; 347/16,  
347/17, 20, 85-87  
CPC .. B41J 2/17513; B41J 2/1752; B41J 2/17553;  
B41J 2/17559; B65B 3/027; B65B 3/045  
See application file for complete search history.

- D655,730 S \* 3/2012 Block ..... D15/123
- 8,926,202 B2 \* 1/2015 Nakada ..... B41J 11/009  
347/16
- D723,100 S \* 2/2015 Minagawa ..... D18/53
- D747,766 S \* 1/2016 Cesar ..... D18/53
- D751,637 S \* 3/2016 Cesar ..... D18/53
- D768,235 S \* 10/2016 Ozawa ..... D18/56
- 2015/0009266 A1 \* 1/2015 Noto ..... B41J 29/377  
347/86
- 2015/0062266 A1 \* 3/2015 Ono ..... B41J 2/175  
347/87
- 2015/0202878 A1 \* 7/2015 Mokhamad ..... B41J 2/17509  
347/85
- 2016/0039212 A1 \* 2/2016 Elferink ..... B41J 25/001  
347/20

\* cited by examiner

*Primary Examiner* — Cynthia Ramirez  
*Assistant Examiner* — Michael A Maharajh  
(74) *Attorney, Agent, or Firm* — Laubscher, Spendlove & Laubscher, P.C.

(57) **CLAIM**

The ornamental design for a printer, as shown and described.

**DESCRIPTION**

FIG. 1 is a front perspective view of a printer showing my new design;  
FIG. 2 is a front elevation view thereof, shown in larger scale;  
FIG. 3 is a rear elevation view thereof, shown in larger scale;  
FIG. 4 is a top plan view thereof;  
FIG. 5 is a bottom plan view thereof;  
FIG. 6 is a left side elevation view thereof; and,  
FIG. 7 is a right side elevation view thereof.  
The broken lines in the drawings are for the purpose of illustrating portions of the printer, which form no part of the claimed design.

**1 Claim, 7 Drawing Sheets**

(56) **References Cited**  
U.S. PATENT DOCUMENTS

- 4,135,808 A \* 1/1979 Morrison ..... G03B 27/625  
271/245
- D363,735 S \* 10/1995 Karafuji ..... D18/53
- D562,377 S \* 2/2008 Kuroda ..... D18/3.1
- D643,463 S \* 8/2011 Sakurai ..... D18/53

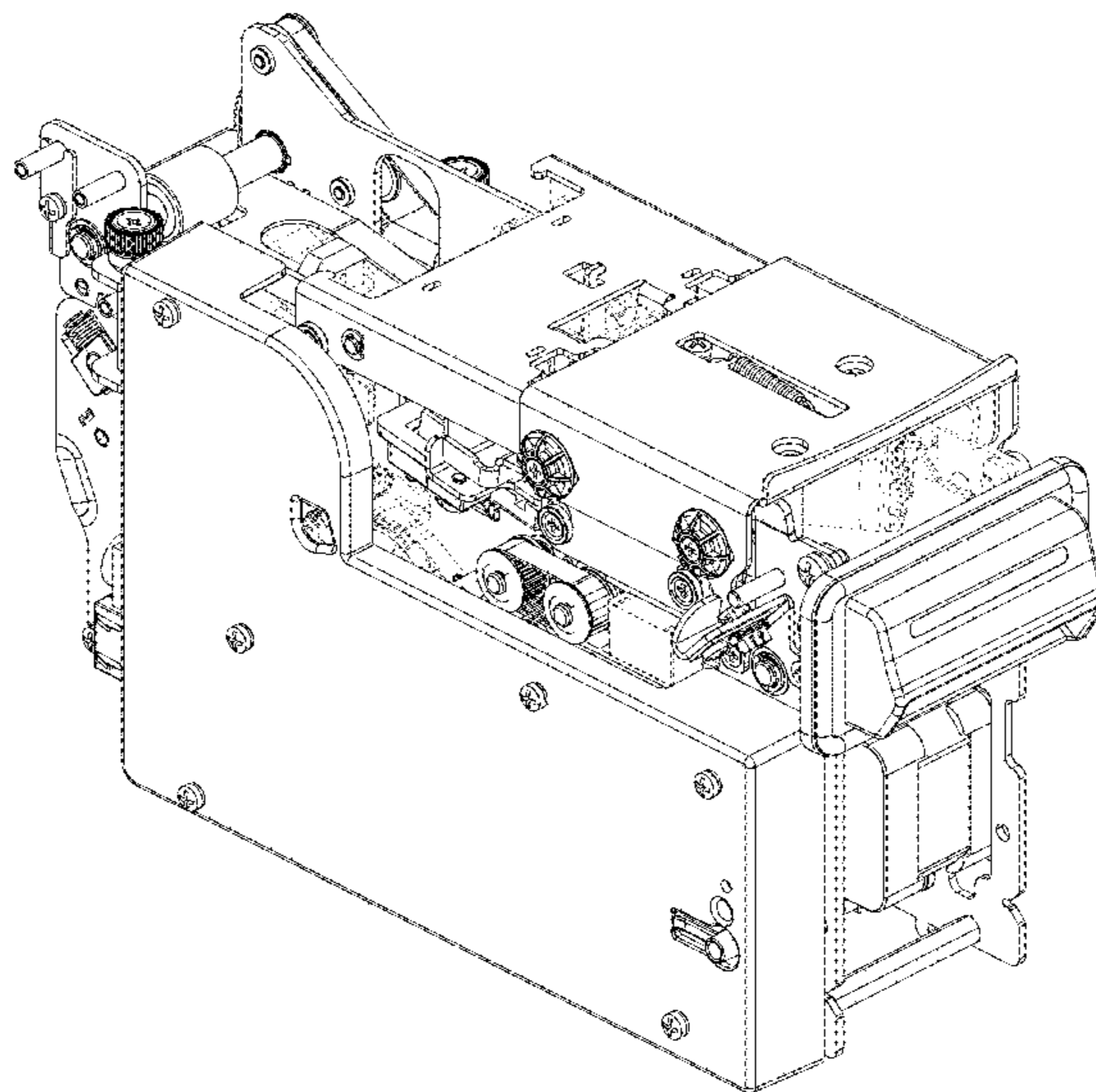

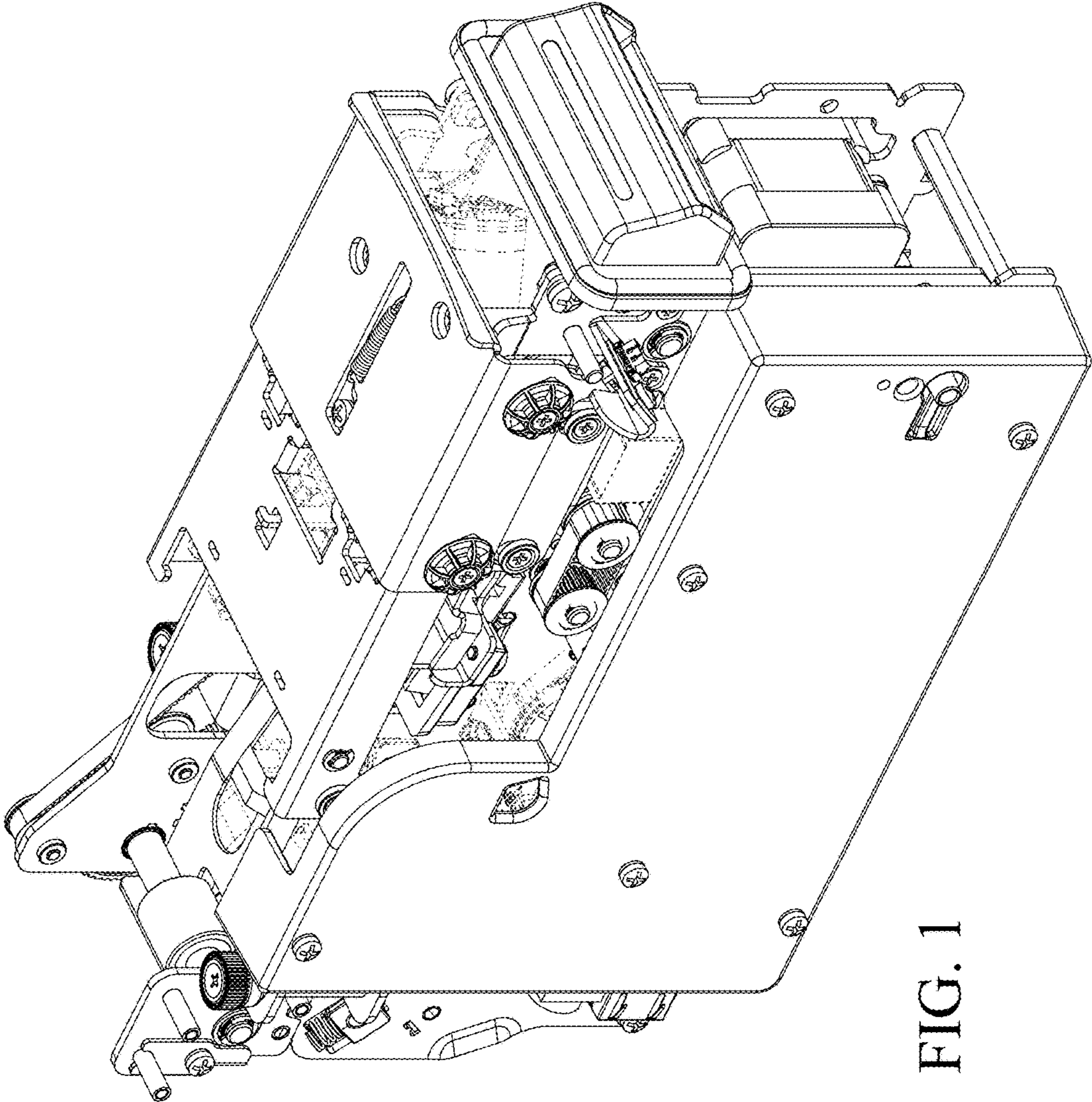

FIG. 1

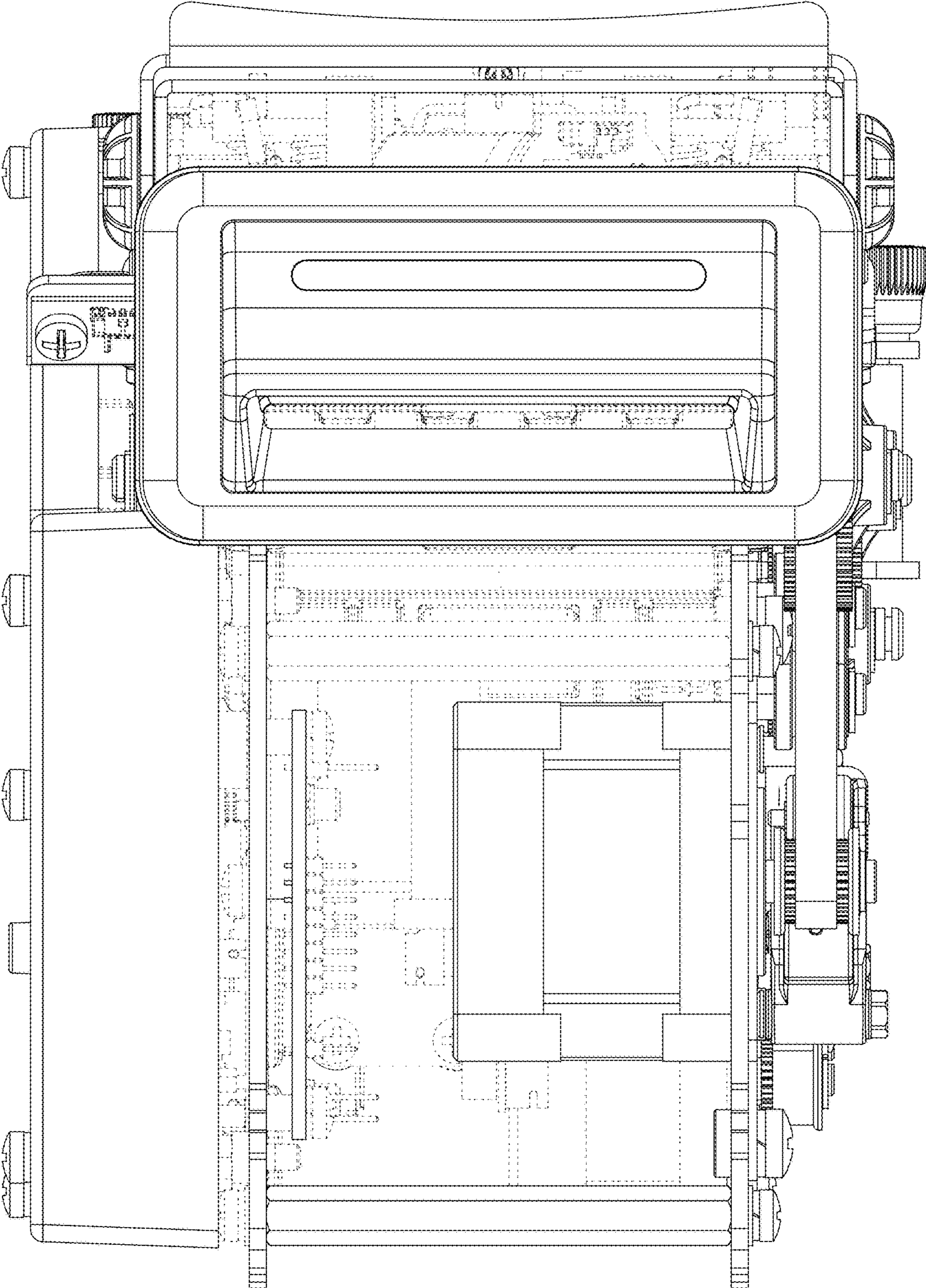

FIG. 2

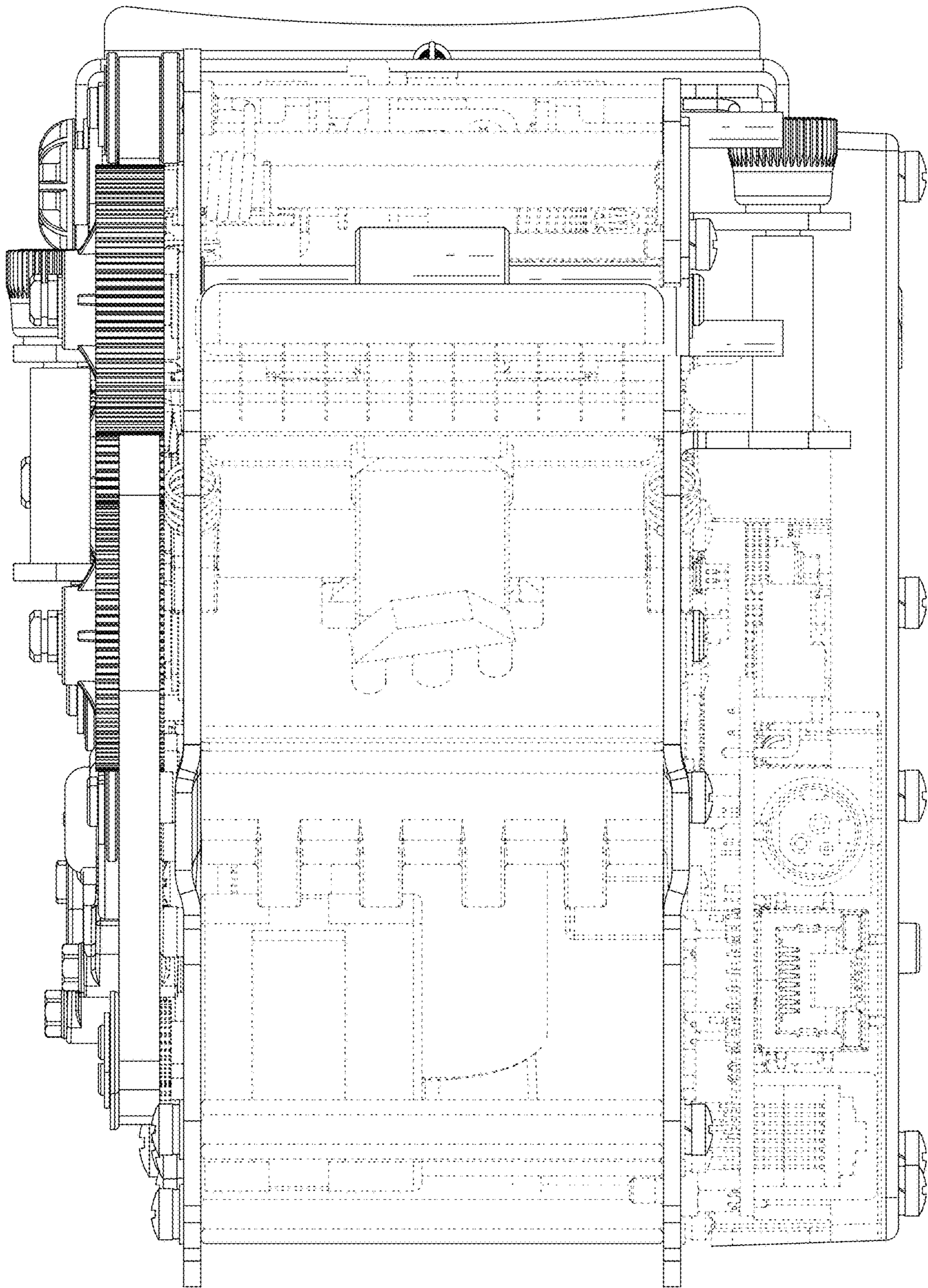

FIG. 3

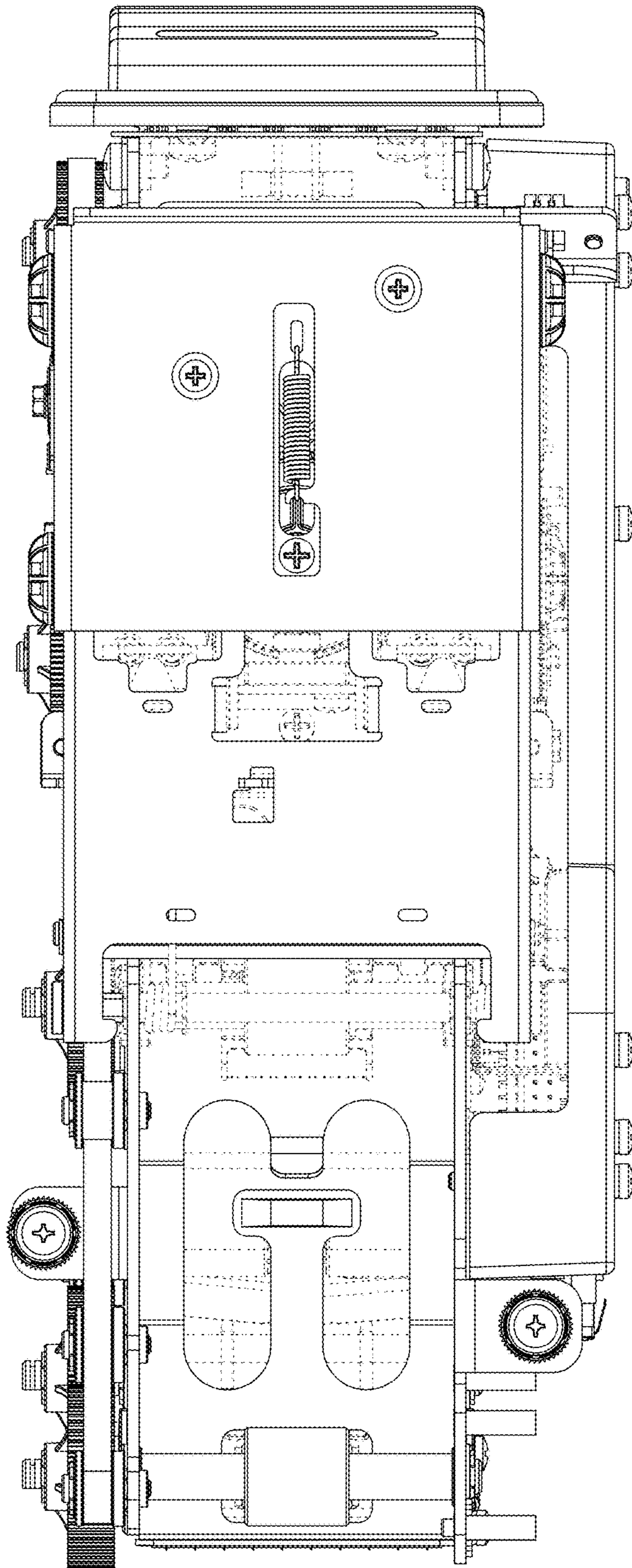

FIG. 4

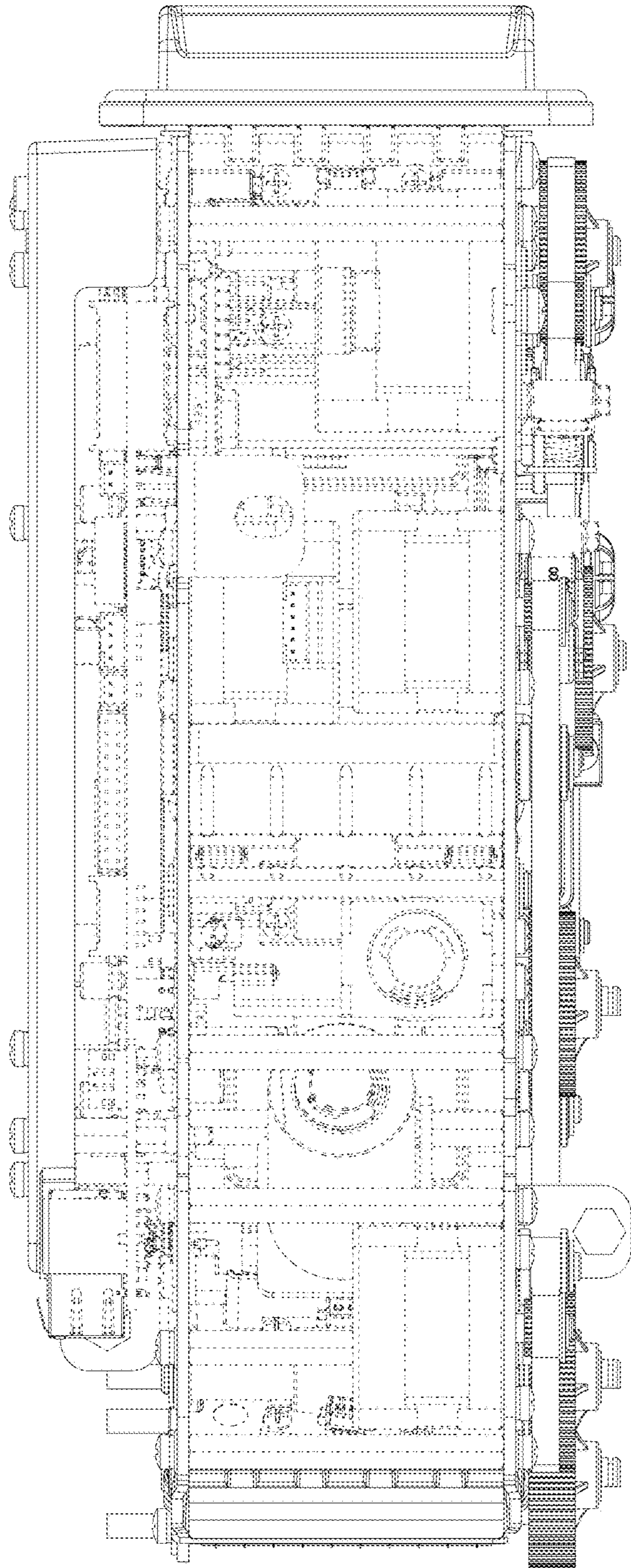

FIG. 5

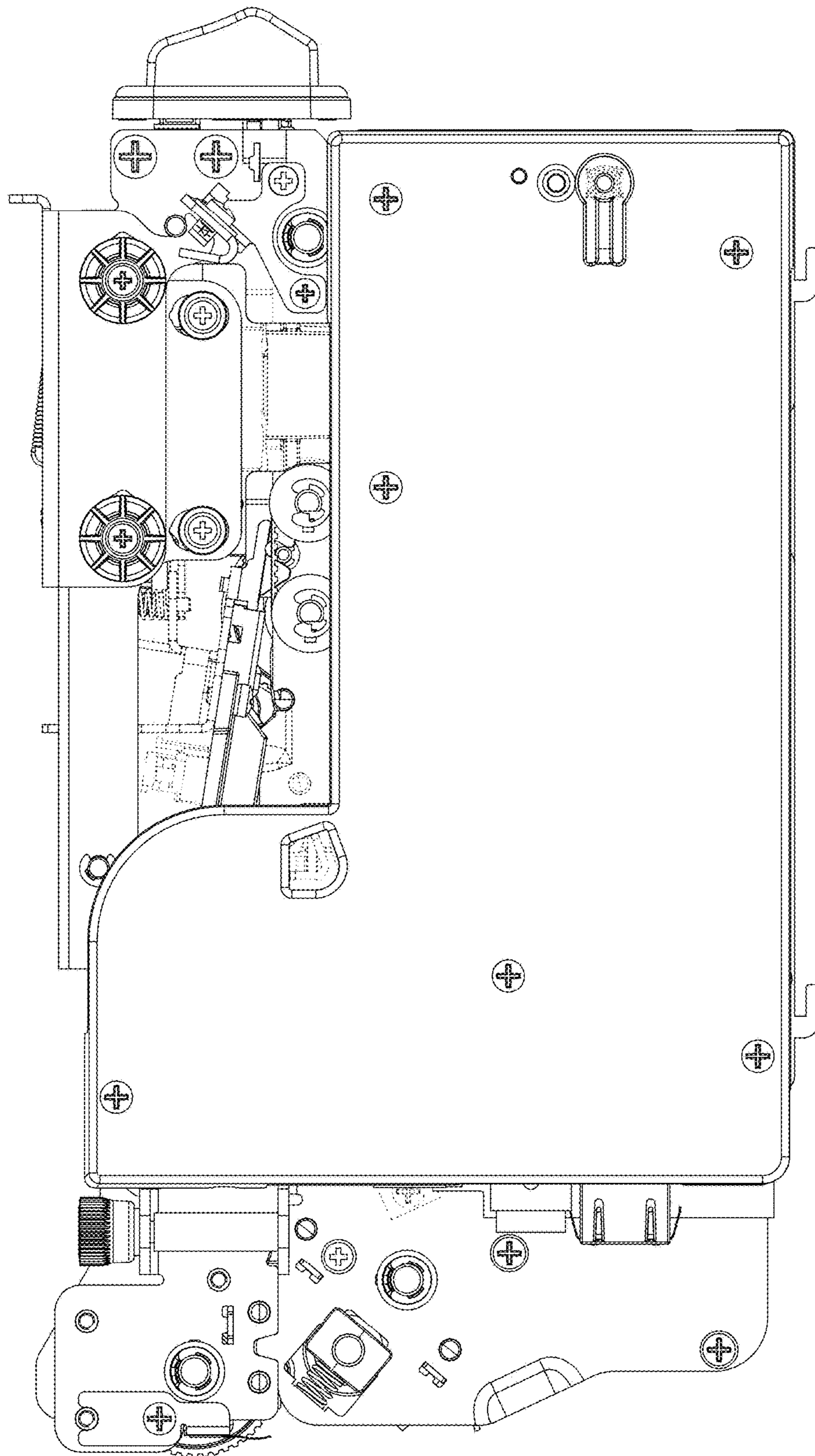

FIG. 6

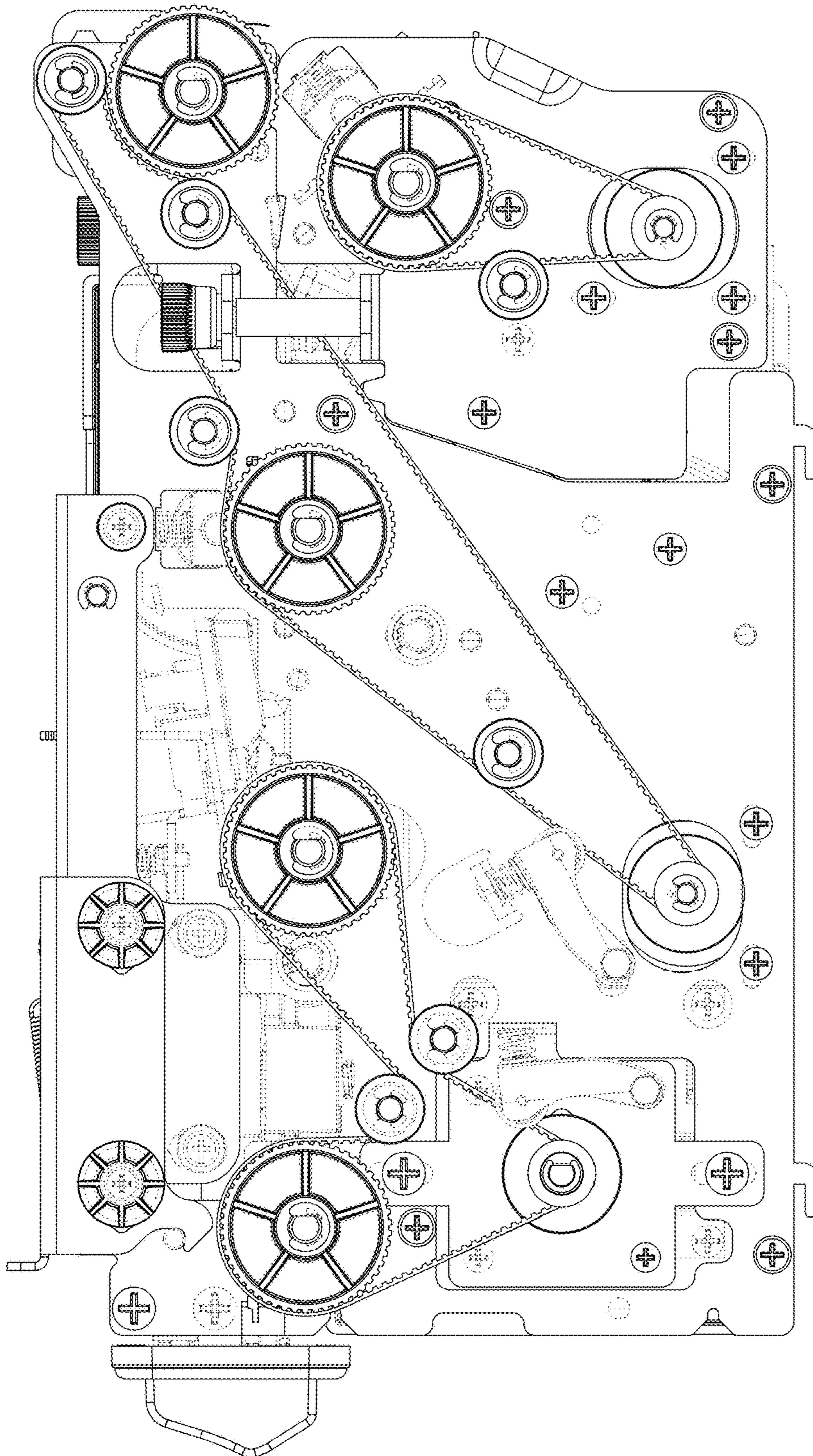

FIG. 7