



US00D826664S

(12) **United States Design Patent** (10) **Patent No.:** **US D826,664 S**  
**Matsubara et al.** (45) **Date of Patent:** **\*\* Aug. 28, 2018**

(54) **CUTTING TOOL**

(71) Applicant: **SUMITOMO ELECTRIC HARDMETAL CORP.**, Itami-shi (JP)

(72) Inventors: **Kouki Matsubara**, Itami (JP); **Junya Okida**, Itami (JP); **Naoki Matsuda**, Itami (JP)

(73) Assignee: **SUMITOMO ELECTRIC HARDMETAL CORP.**, Itami-shi (JP)

(\*\*) Term: **15 Years**

(21) Appl. No.: **29/614,435**

(22) Filed: **Aug. 18, 2017**

(30) **Foreign Application Priority Data**

Jul. 5, 2017 (JP) ..... 2017-014533

(51) **LOC (11) Cl.** ..... **08-03**

(52) **U.S. Cl.**  
USPC ..... **D8/20; D15/139**

(58) **Field of Classification Search**  
USPC ..... D8/5, 8, 9, 62, 64, 66, 70, 92, 98, 99;  
30/32, 48, 50, 81, 128, 159, 165, 166.3,  
30/169, 272, 277.4, 294, 346; 83/665,  
83/666, 667, 835, 886; 407/20, 30;  
D15/29, 138, 139  
CPC .. B24B 3/36; B24B 3/365; B24B 3/46; B27B  
5/00; Y10T 83/9319; Y10T 83/9321;  
Y10T 83/9346; Y10T 83/9348; B23D  
61/00; B23D 61/025; B23D 61/06; B23D  
61/04; B23D 61/026; B23D 65/00; B23D  
7/086; B23D 7/2614; B26B 1/00; B26B  
3/00; B26B 21/00; B26B 11/00; B26B  
9/00; B26B 5/00; B26D 7/18

See application file for complete search history.

(56) **References Cited**

U.S. PATENT DOCUMENTS

2,036,145 A \* 3/1936 Jewett ..... B27G 13/10  
144/219  
5,197,831 A \* 3/1993 Shiratori ..... B23C 5/1045  
407/114  
5,207,538 A \* 5/1993 Satran ..... B23C 5/2213  
407/113  
D342,269 S \* 12/1993 Arai ..... D15/139  
D367,866 S \* 3/1996 Pantzar ..... D15/139  
D410,475 S \* 6/1999 Bernadic ..... D15/139

(Continued)

*Primary Examiner* — Wan Laymon

*Assistant Examiner* — Clint A Samuel

(74) *Attorney, Agent, or Firm* — Venable LLP; Michael A. Sartori; Miguel A. Lopez

(57) **CLAIM**

The ornamental design for a cutting tool, as shown and described.

**DESCRIPTION**

FIG. 1 is a front view of a cutting tool showing our new design,  
FIG. 2 is a rear view thereof;  
FIG. 3 is a right side view thereof;  
FIG. 4 is a left side view thereof;  
FIG. 5 is a top view thereof;  
FIG. 6 is a bottom view thereof;  
FIG. 7 is a first perspective view thereof;  
FIG. 8 is a second perspective view thereof;  
FIG. 9 is a third perspective view thereof;  
FIG. 10 is a cross sectional view taken along line 10-10 of FIG. 1;  
FIG. 11 is a cross sectional view taken along line 11-11 of FIG. 1;  
FIG. 12 is a cross sectional view taken along line 12-12 of FIG. 1;

(Continued)

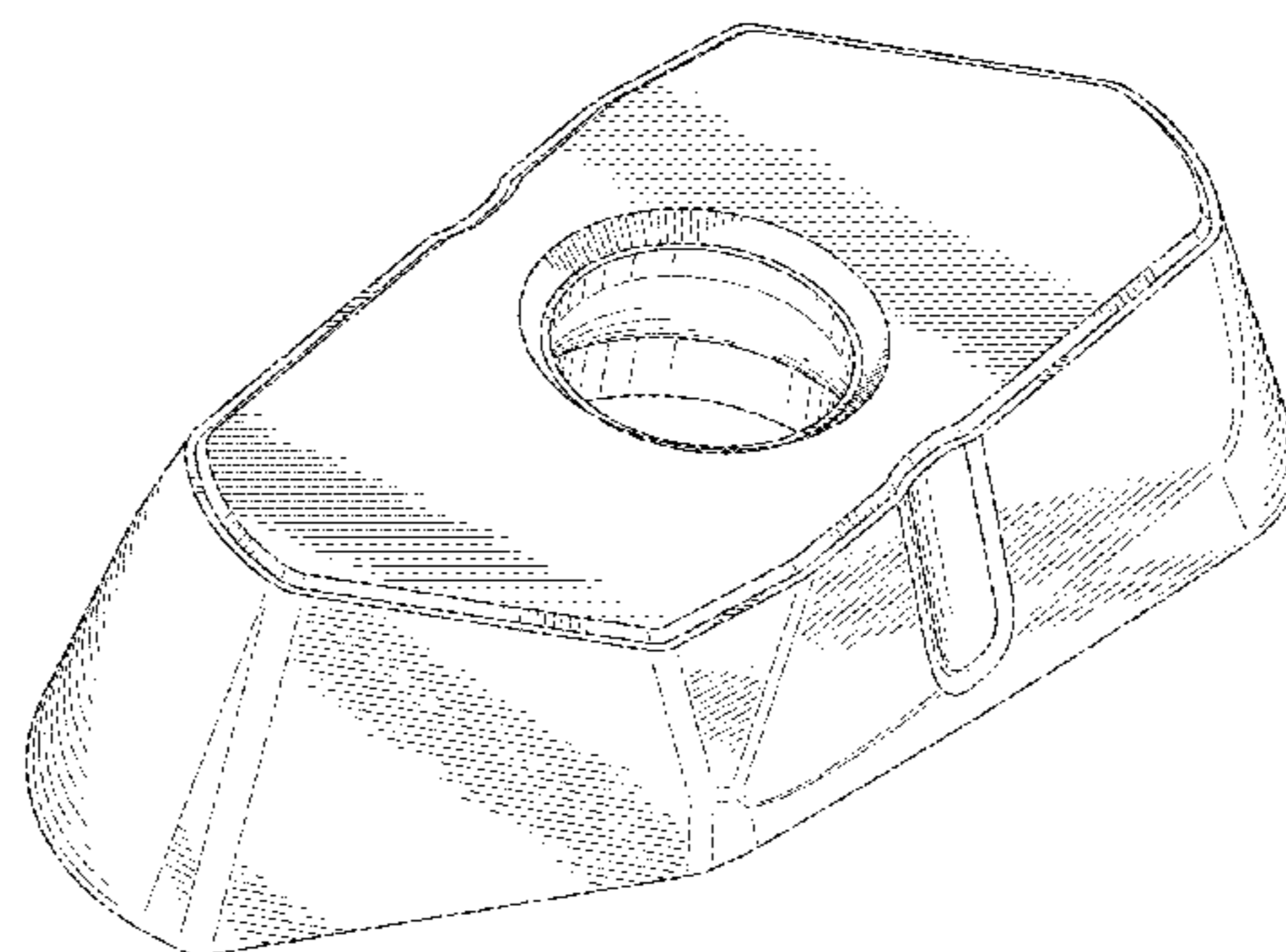
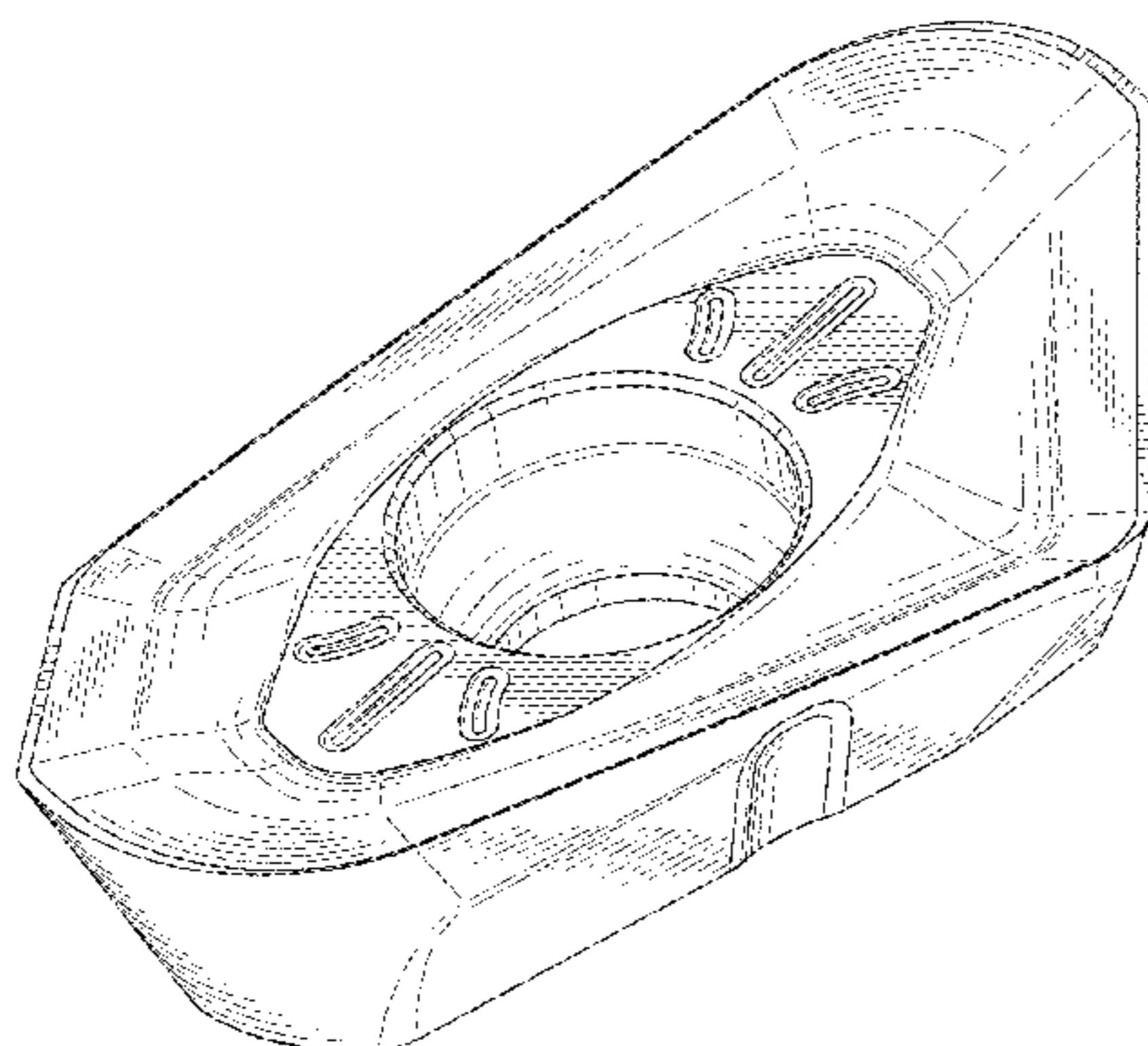

FIG. 13 is an enlarged view of portion 13-13 of FIG. 10; and,  
 FIG. 14 is an enlarged view of portion 14-14 of FIG. 11.

**1 Claim, 8 Drawing Sheets**

(56)

**References Cited**

U.S. PATENT DOCUMENTS

D454,142 S \* 3/2002 Vanberg ..... D15/139  
 D474,787 S \* 5/2003 Niebauer ..... D15/139  
 D487,281 S \* 3/2004 Roman ..... D15/139  
 D496,949 S \* 10/2004 Waggle ..... D15/139  
 D497,371 S \* 10/2004 Waggle ..... D15/139  
 D559,286 S \* 1/2008 Waggle ..... D15/139  
 D579,470 S \* 10/2008 Maeta ..... D15/139  
 D595,323 S \* 6/2009 Sakata ..... D15/139  
 D676,071 S \* 2/2013 Cox ..... D15/139

D676,072 S \* 2/2013 Cox ..... D15/139  
 D705,281 S \* 5/2014 Heinasenaho ..... D15/139  
 D715,840 S \* 10/2014 Park ..... D15/139  
 D748,703 S \* 2/2016 Nam ..... D15/139  
 D752,664 S \* 3/2016 Jung ..... D15/139  
 D786,952 S \* 5/2017 Jeong ..... D15/139  
 D795,318 S \* 8/2017 Yoshida ..... D15/139  
 D804,552 S \* 12/2017 Lee ..... D15/139  
 D805,564 S \* 12/2017 Lee ..... D15/139  
 D805,566 S \* 12/2017 Oh ..... D15/139  
 D806,150 S \* 12/2017 Komiyama ..... D15/139  
 D807,719 S \* 1/2018 Gopi ..... D8/20  
 D807,935 S \* 1/2018 Dudzinsky ..... D15/139  
 D812,443 S \* 3/2018 Gonzalez ..... D8/20  
 D815,164 S \* 4/2018 Schleicher ..... D15/139  
 D815,165 S \* 4/2018 Morisaki ..... D15/139  
 D816,133 S \* 4/2018 Mura ..... D15/139  
 D816,134 S \* 4/2018 Mura ..... D15/139  
 D816,744 S \* 5/2018 Lee ..... D15/139  
 D818,016 S \* 5/2018 Yoshida ..... D15/139

\* cited by examiner

FIG.1

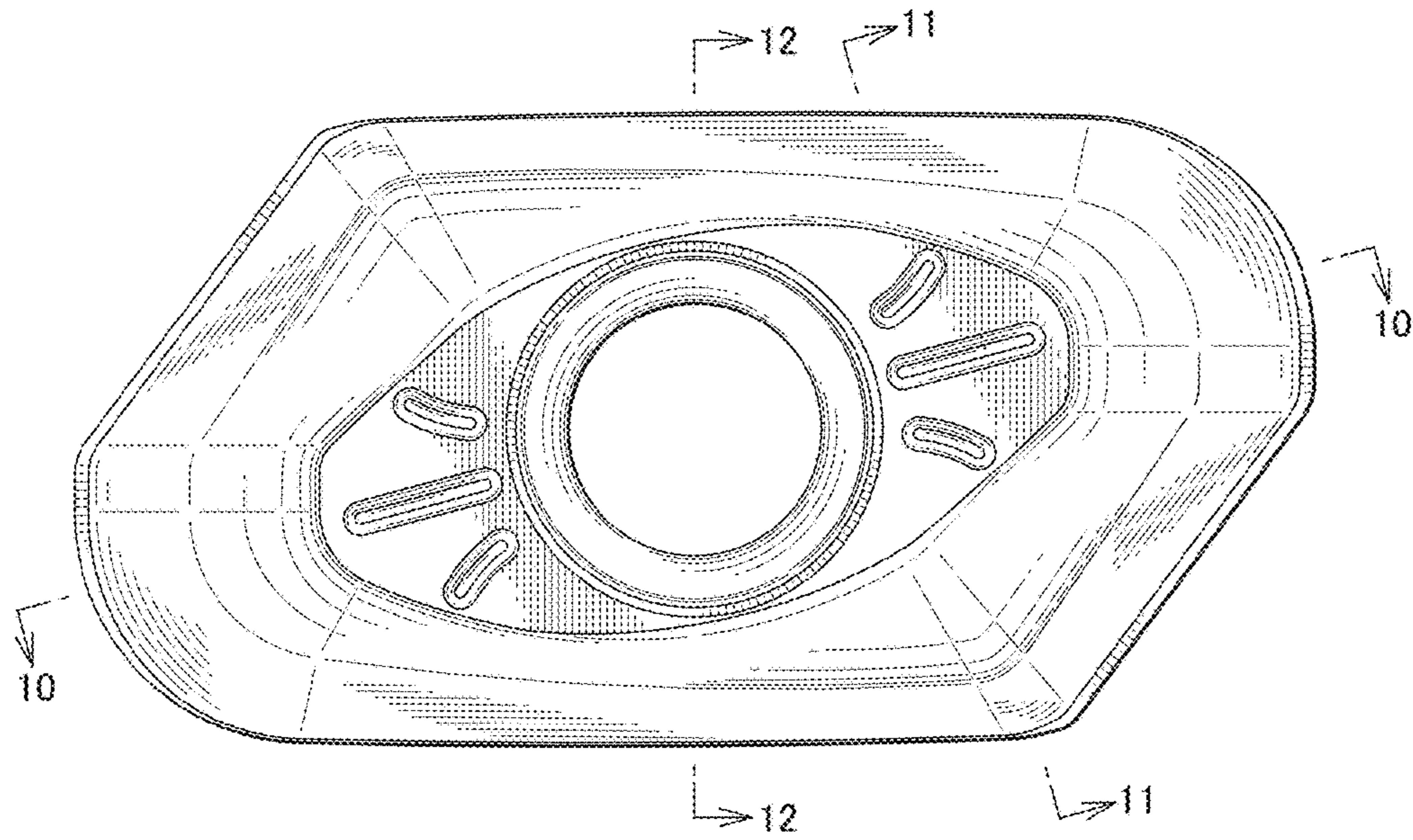

FIG.2

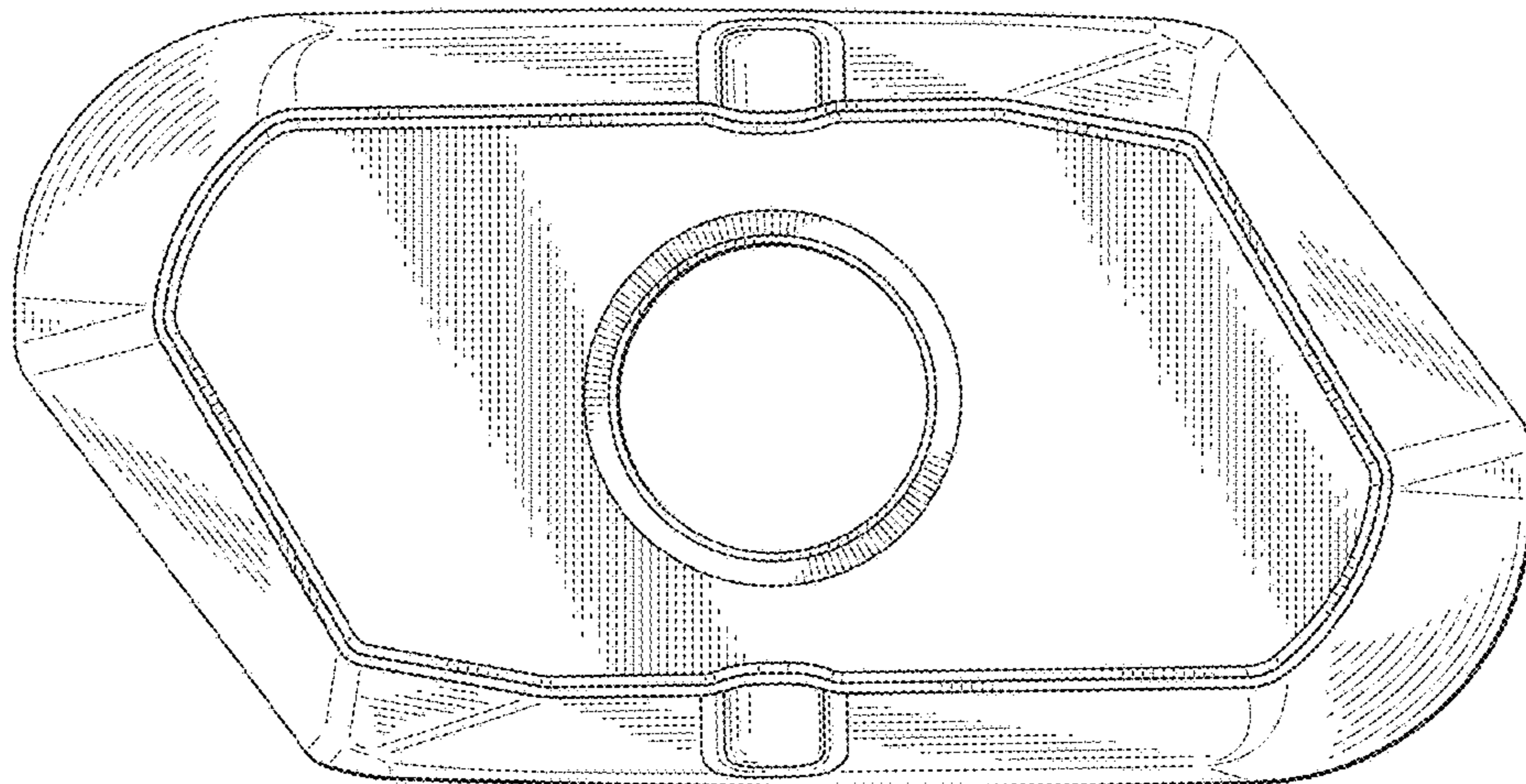

FIG.3

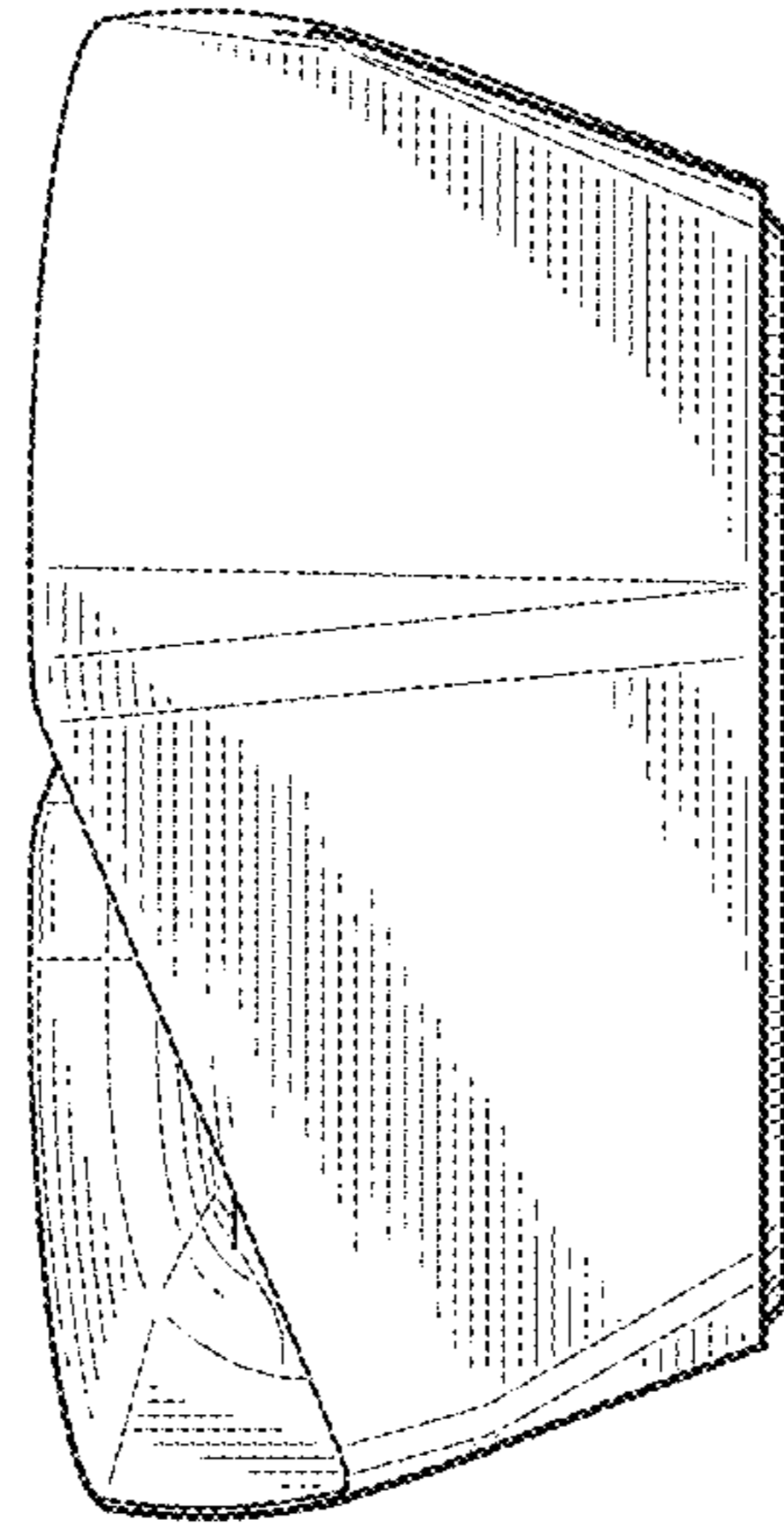

FIG.4

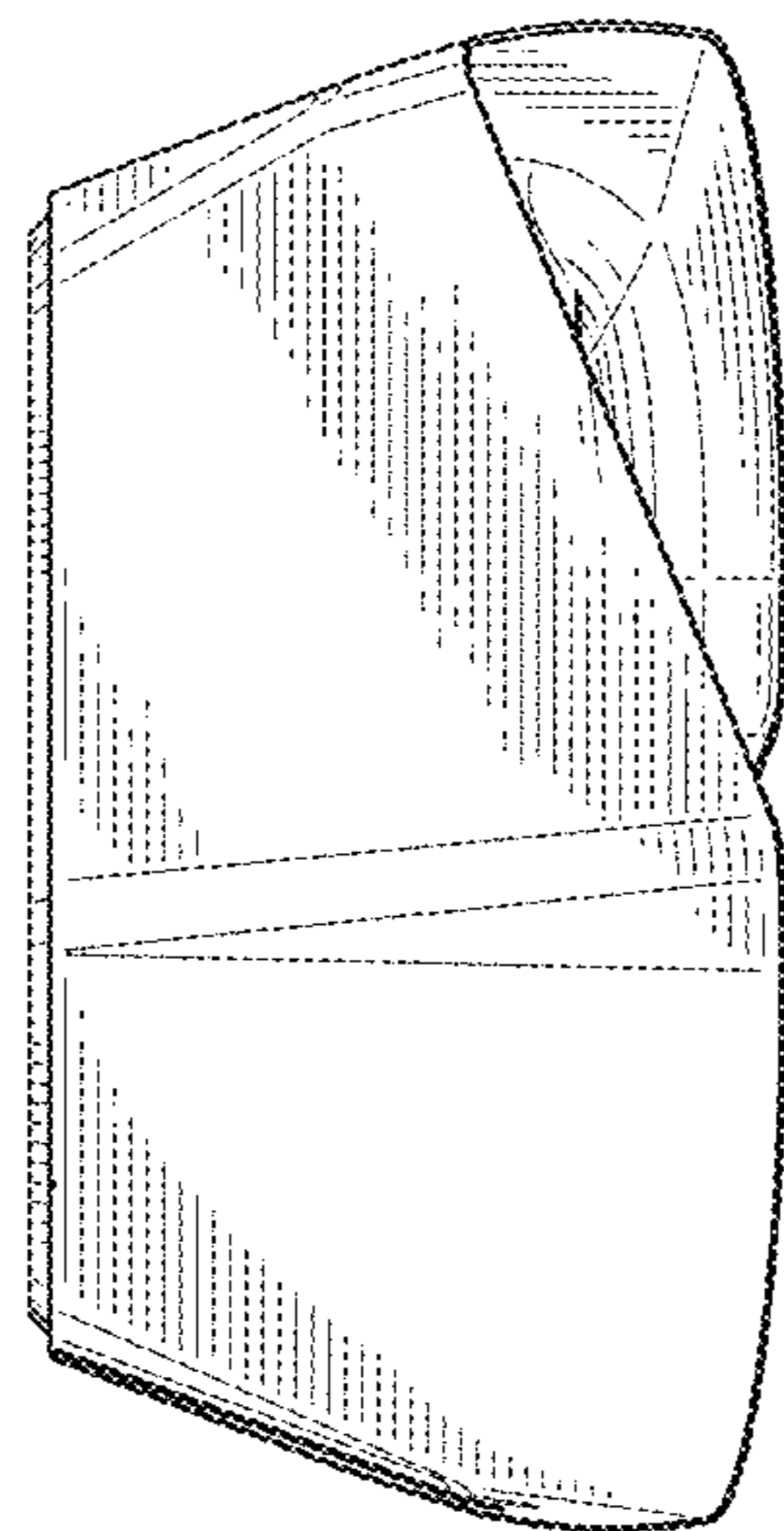

FIG.5

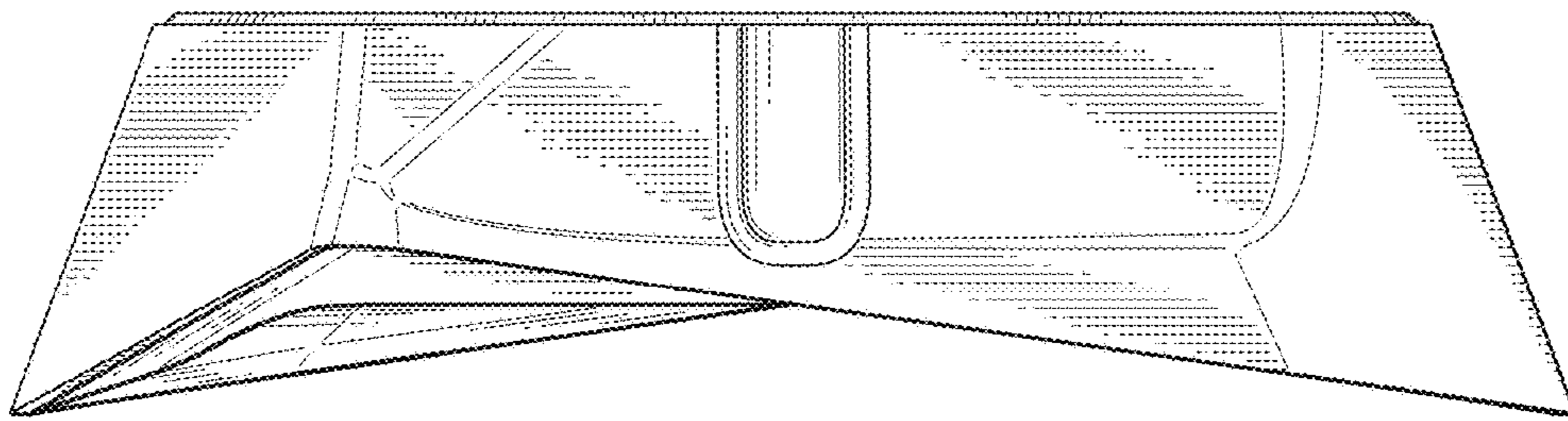

FIG.6

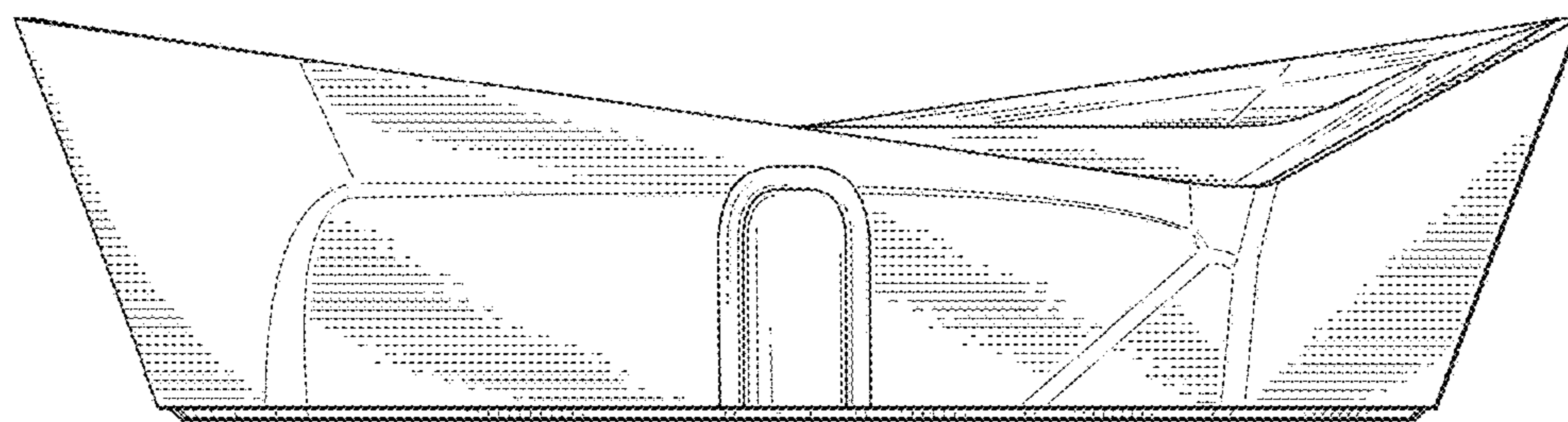

FIG. 7

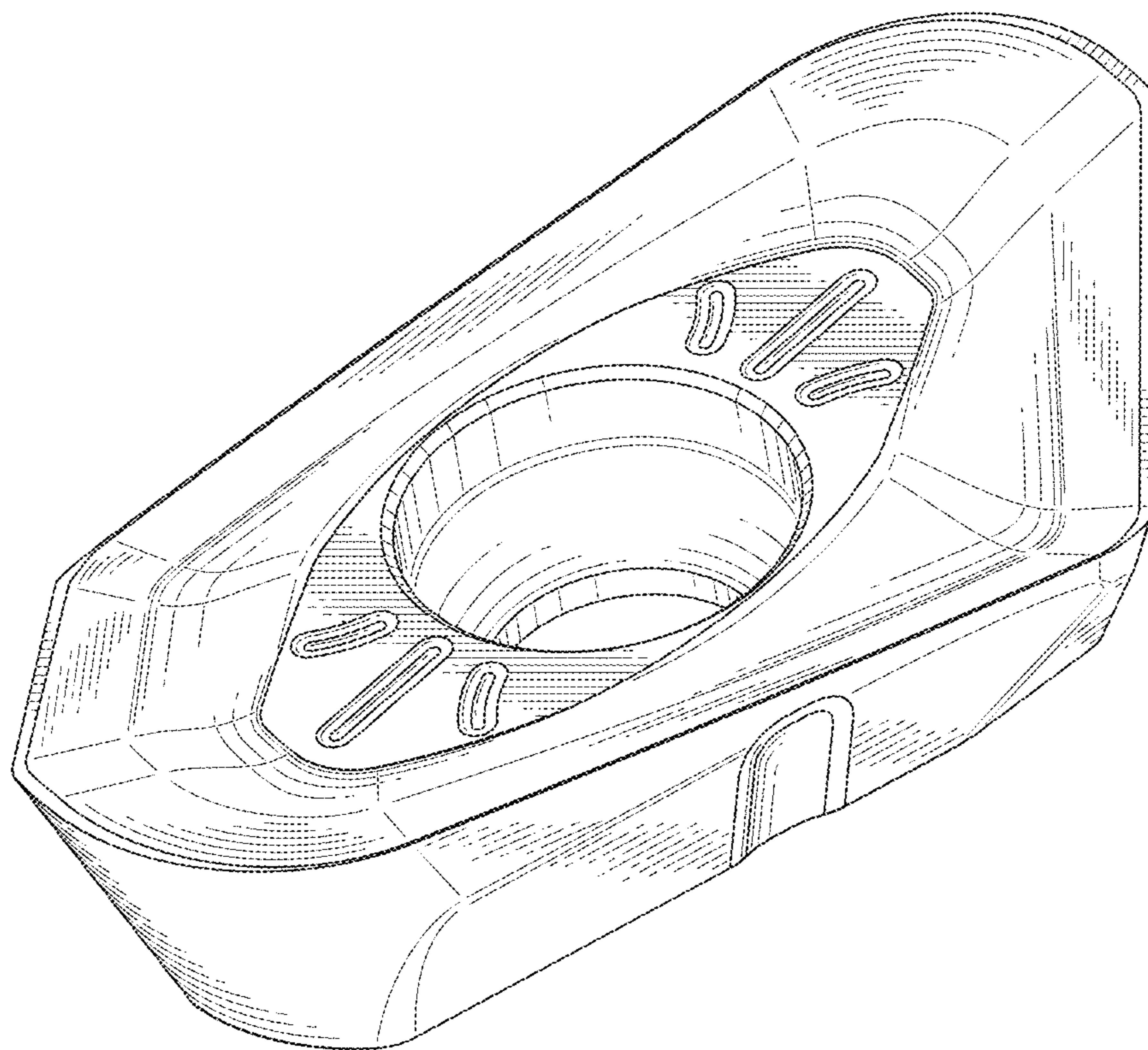

FIG.8

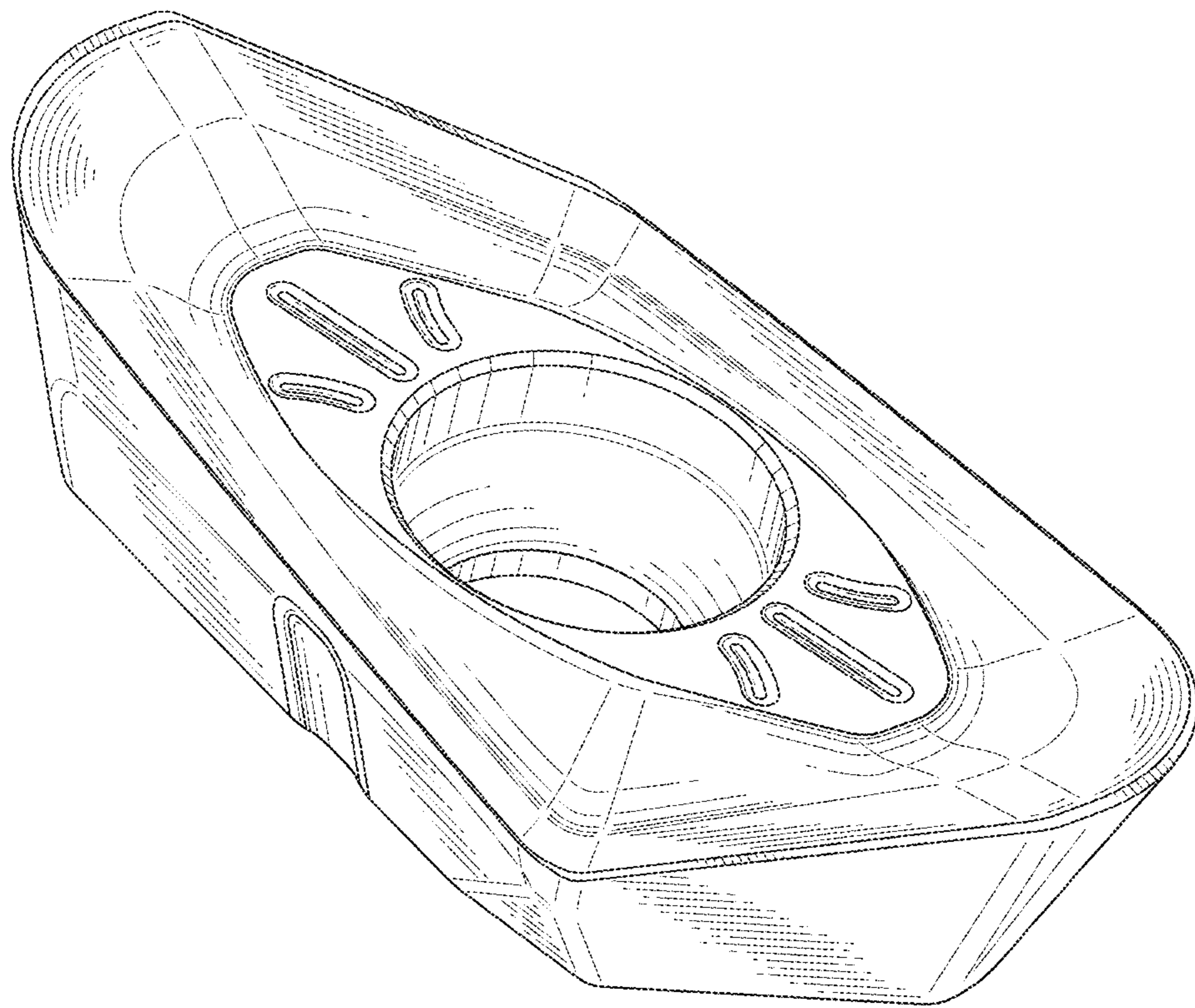

FIG.9

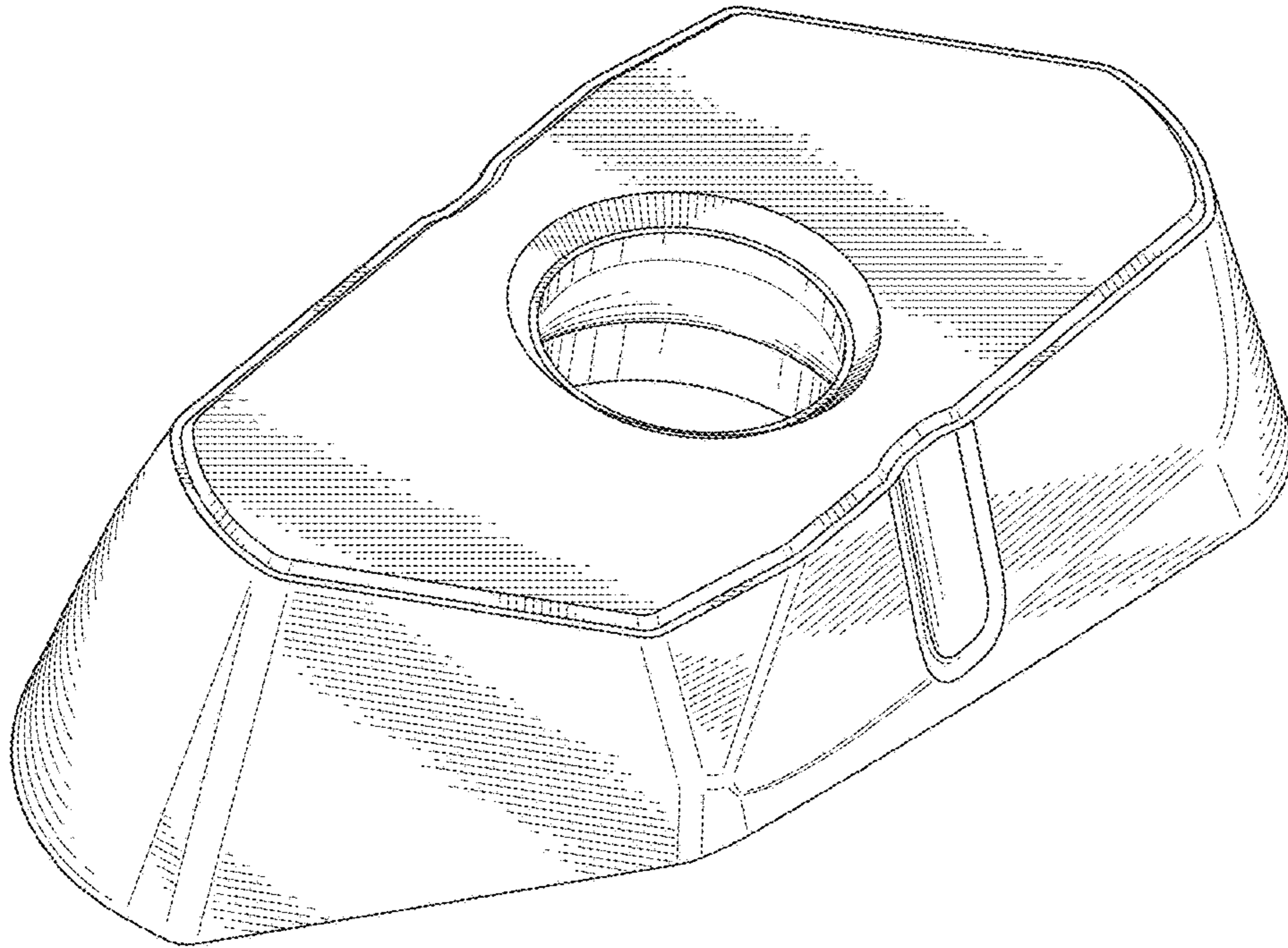

FIG.10

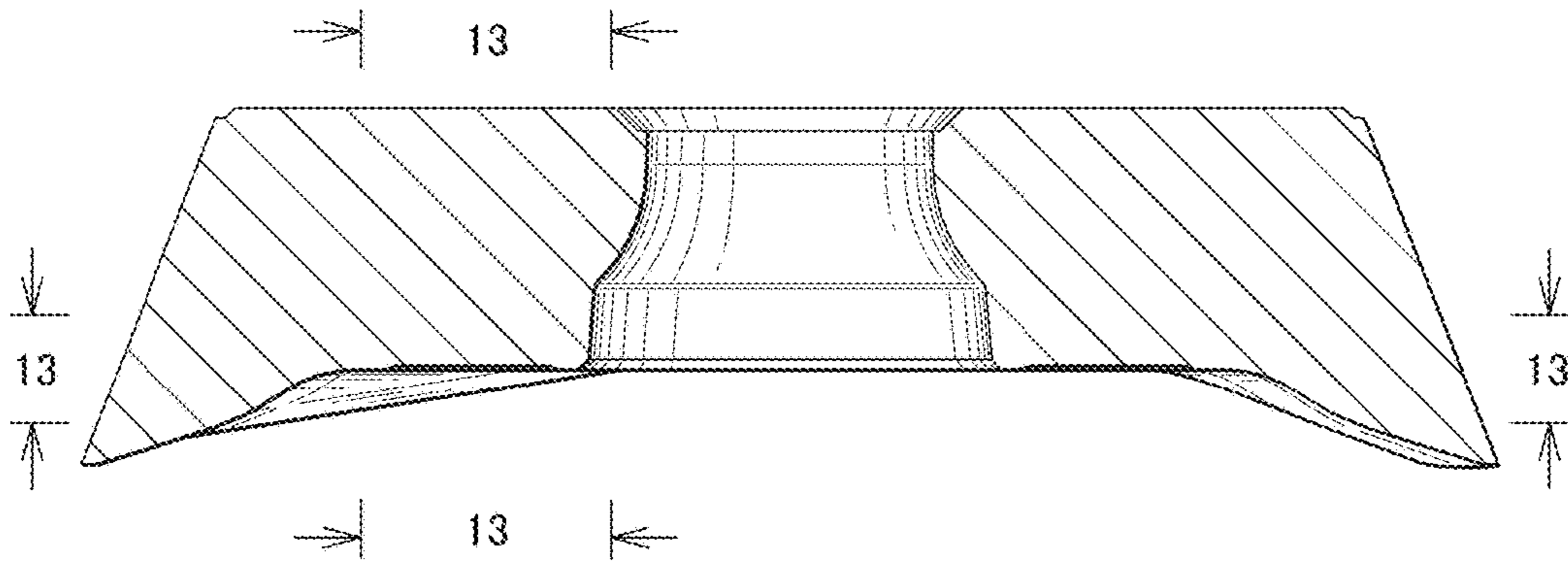



FIG.11

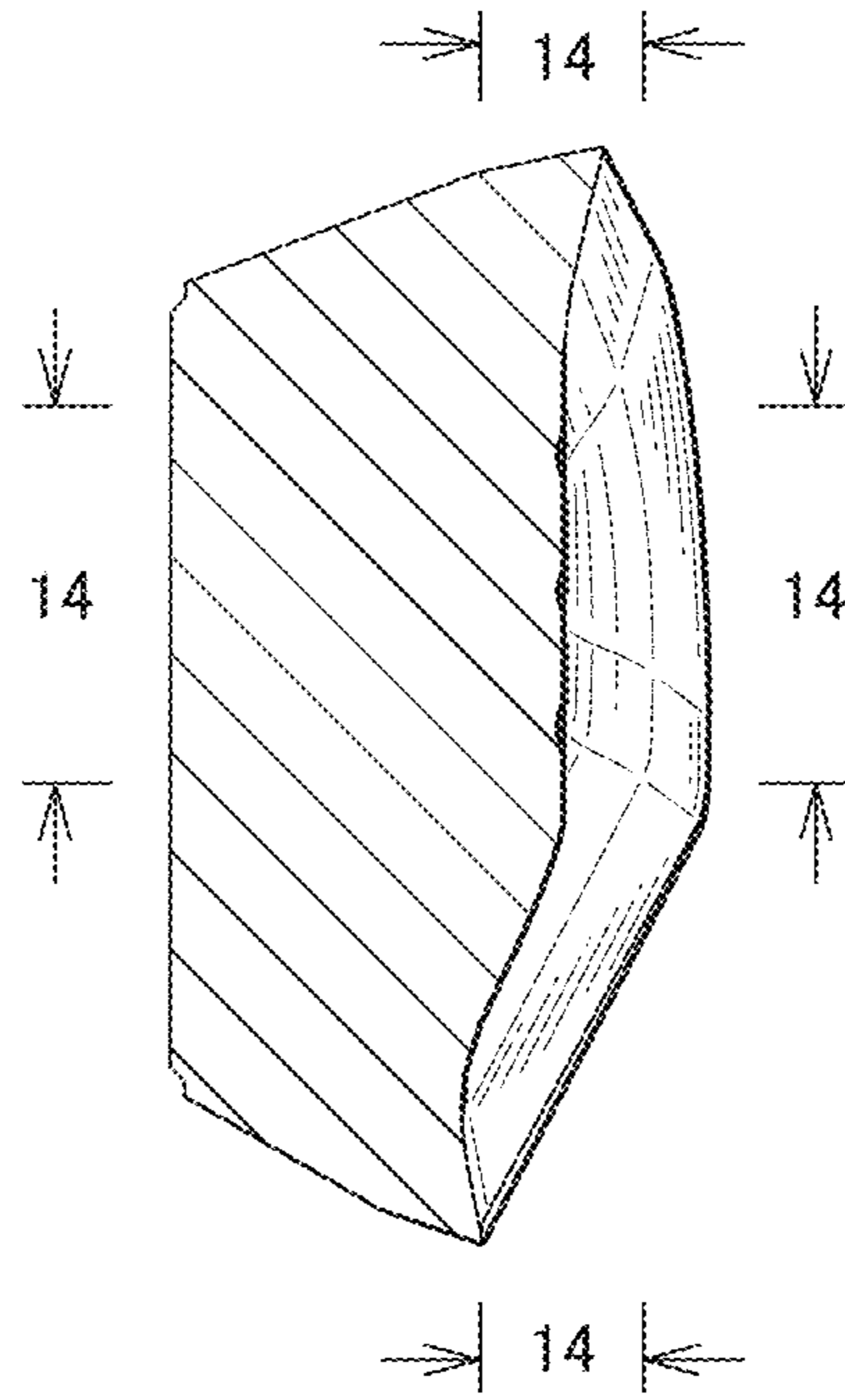

FIG.12

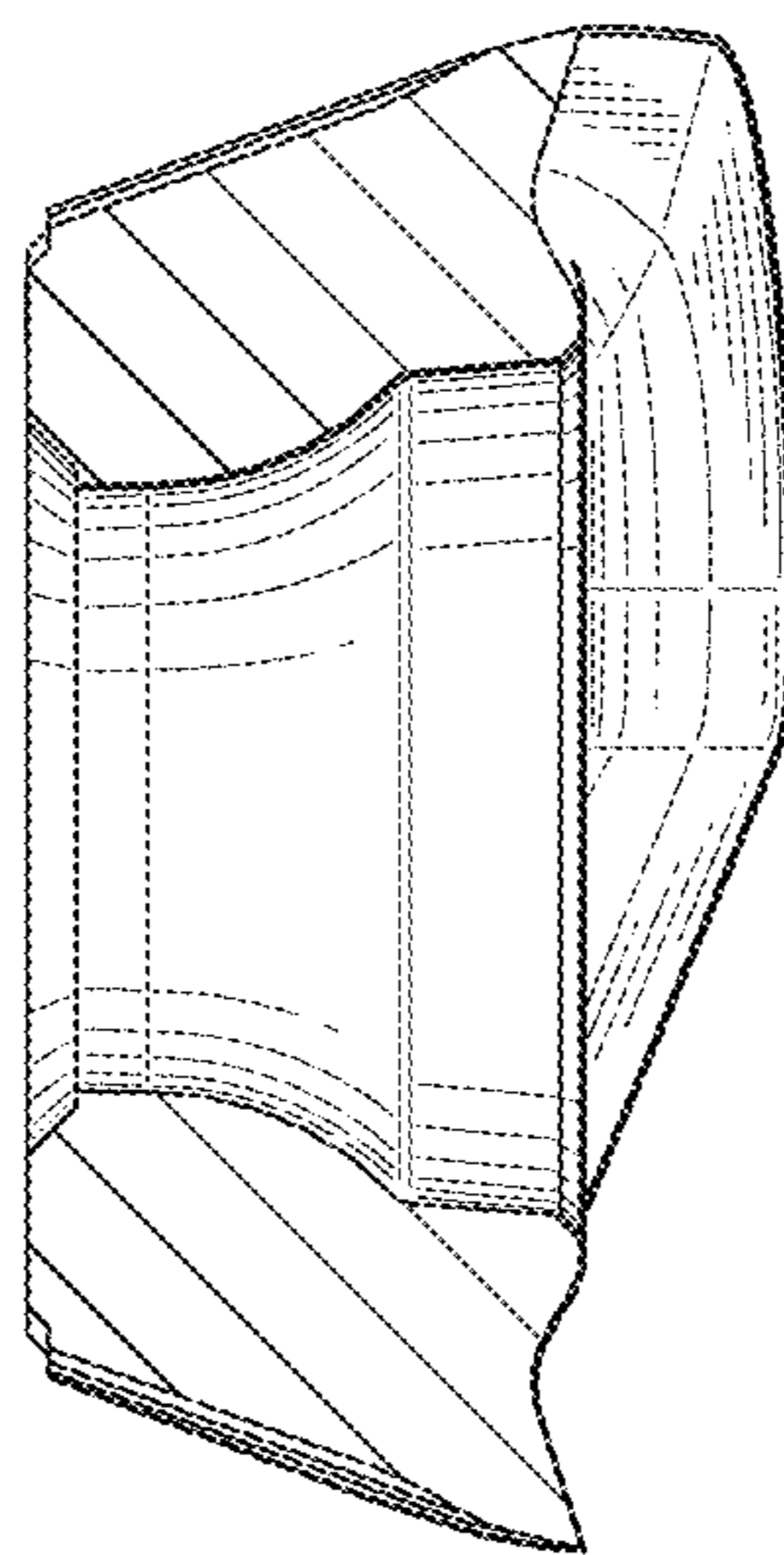

FIG.13

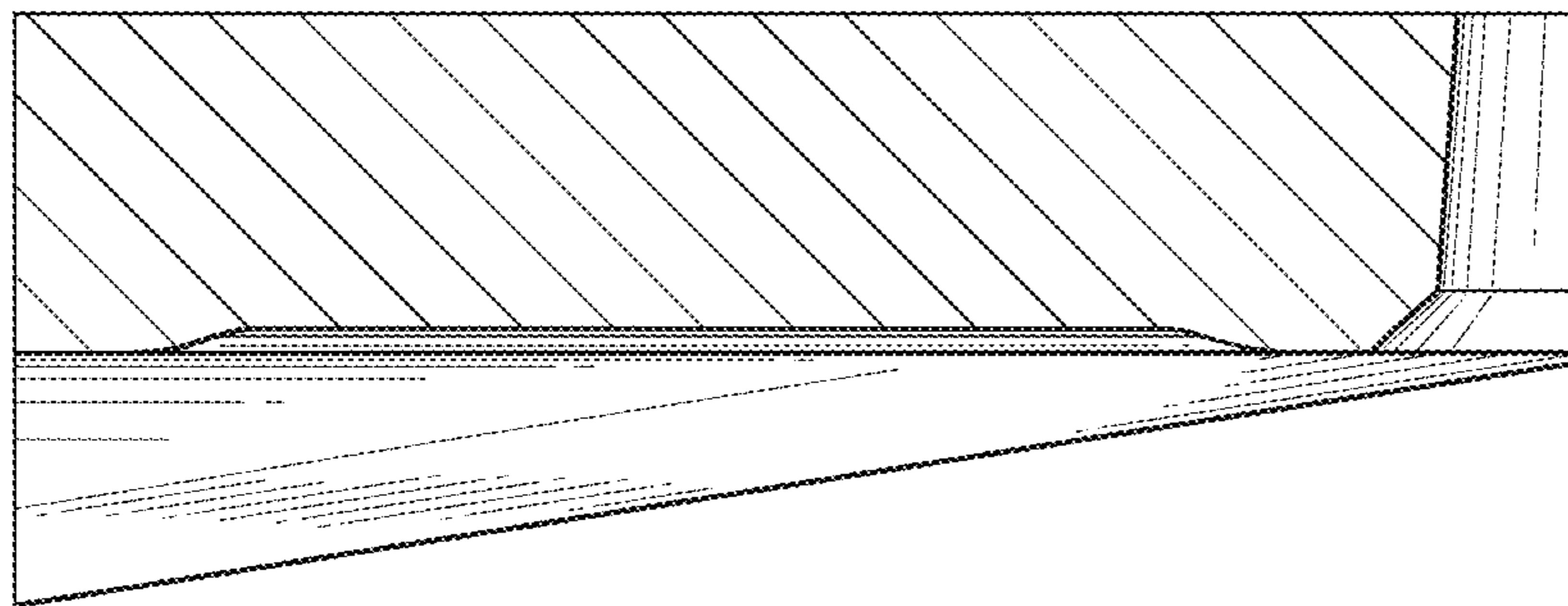

FIG.14

