



US00D825685S

(12) **United States Design Patent**
Tompkin

(10) **Patent No.:** **US D825,685 S**

(45) **Date of Patent:** **** Aug. 14, 2018**

- (54) **REMOTE CONTROL CAR**
- (71) Applicant: **MerchSource, LLC**, Irvine, CA (US)
- (72) Inventor: **Crispian Tompkin**, Los Angeles, CA (US)
- (73) Assignee: **MerchSource, LLC**, Irvine, CA (US)
- (**) Term: **15 Years**
- (21) Appl. No.: **29/607,697**
- (22) Filed: **Jun. 15, 2017**
- (51) **LOC (11) Cl.** **21-01**
- (52) **U.S. Cl.**
USPC **D21/550; D21/533; D21/548**
- (58) **Field of Classification Search**
USPC D12/85, 86, 88, 90-92, 107, 164, 173,
D12/184-186, 190, 196; D21/419, 421,
D21/423, 424-426, 433-434, 548-550,
D21/552, 559; 446/456; 280/124.103;
180/210, 312, 903
CPC A63H 17/26; A63H 17/262; A63H 17/264;
A63H 17/266; A63H 17/36; A63H 17/38;
A63H 29/00; A63H 29/22; A63H 29/24;
A63H 30/04
See application file for complete search history.

D457,926 S *	5/2002	Zweiback	D21/550
D465,814 S *	11/2002	Koveleski	D21/433
D506,415 S *	6/2005	Byrne	D12/88
D509,264 S *	9/2005	Wei	D21/550
D575,356 S *	8/2008	Martino	D21/550
D577,778 S *	9/2008	Fink	D21/550
D617,851 S *	6/2010	Stoddard	D21/549
D672,407 S *	12/2012	Nakayama	D21/550
D771,201 S *	11/2016	Tompkin	D21/550
D803,329 S *	11/2017	Tompkin	D21/550

* cited by examiner

Primary Examiner — Robin V Webster
Assistant Examiner — Keith J Wilson
(74) *Attorney, Agent, or Firm* — Avyno Law P.C.

(57) **CLAIM**

I claim the ornamental design for a remote control car, as shown and described.

DESCRIPTION

FIG. 1 is a top perspective view of a remote control car. FIG. 2 is a bottom perspective view of the remote control car of FIG. 1. FIG. 3 is a side view of the left side of the remote control car of FIG. 1. FIG. 4 is a side view of the right side of the remote control car of FIG. 1. FIG. 5 is a front view of the remote control car of FIG. 1. FIG. 6 is a rear view of the remote control car of FIG. 1. FIG. 7 is a top view of the remote control car of FIG. 1; and, FIG. 8 is a bottom view of the remote control car of FIG. 1. The dashed lines in various figures are for illustrative purposes only and form no part of the claimed design.

1 Claim, 7 Drawing Sheets

- (56) **References Cited**
U.S. PATENT DOCUMENTS
D246,613 S * 12/1977 Ogawa D21/550
D266,779 S * 11/1982 Appel D21/550
5,061,007 A * 10/1991 Simpson B60G 21/05
180/903
D359,082 S * 6/1995 Aker D21/550

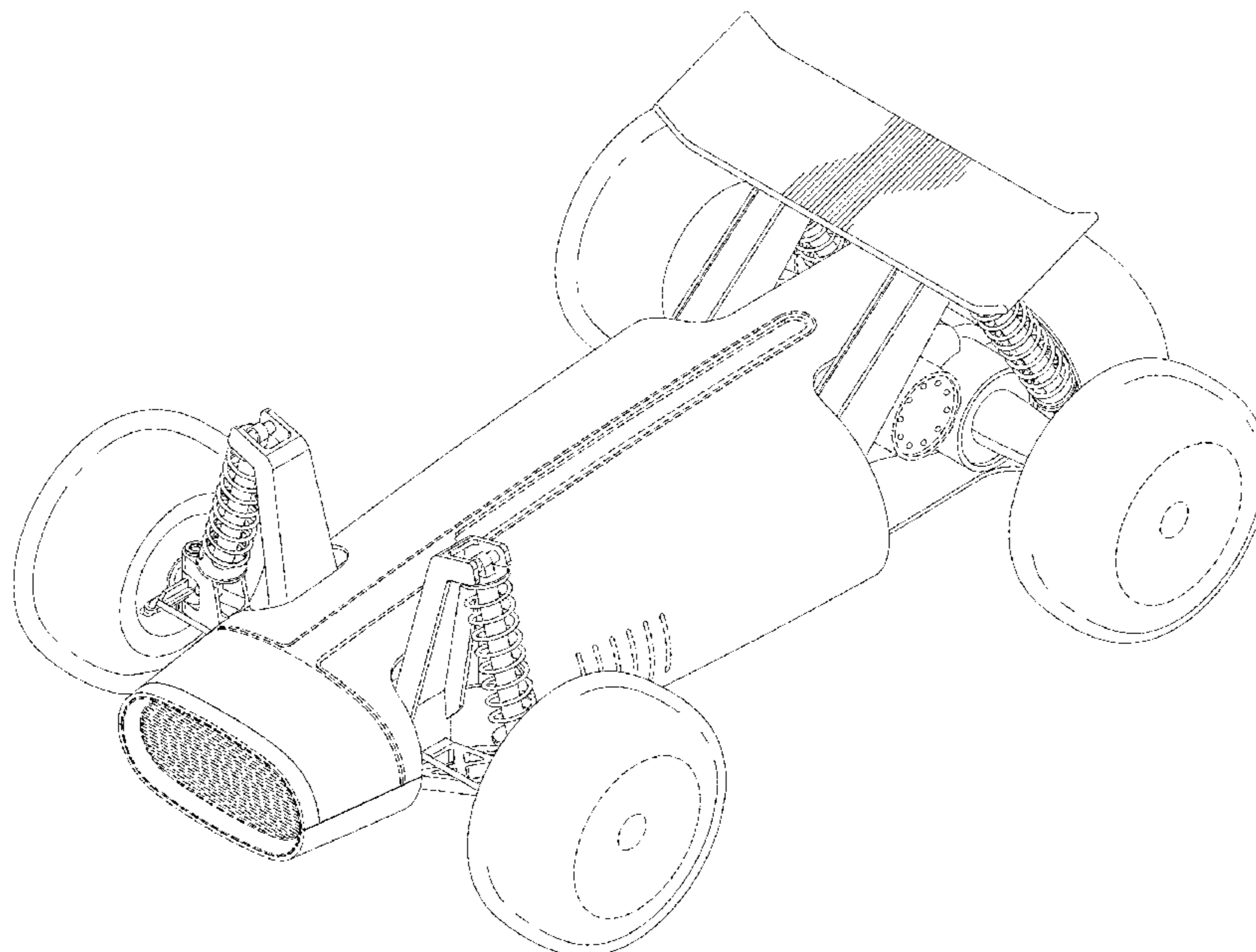

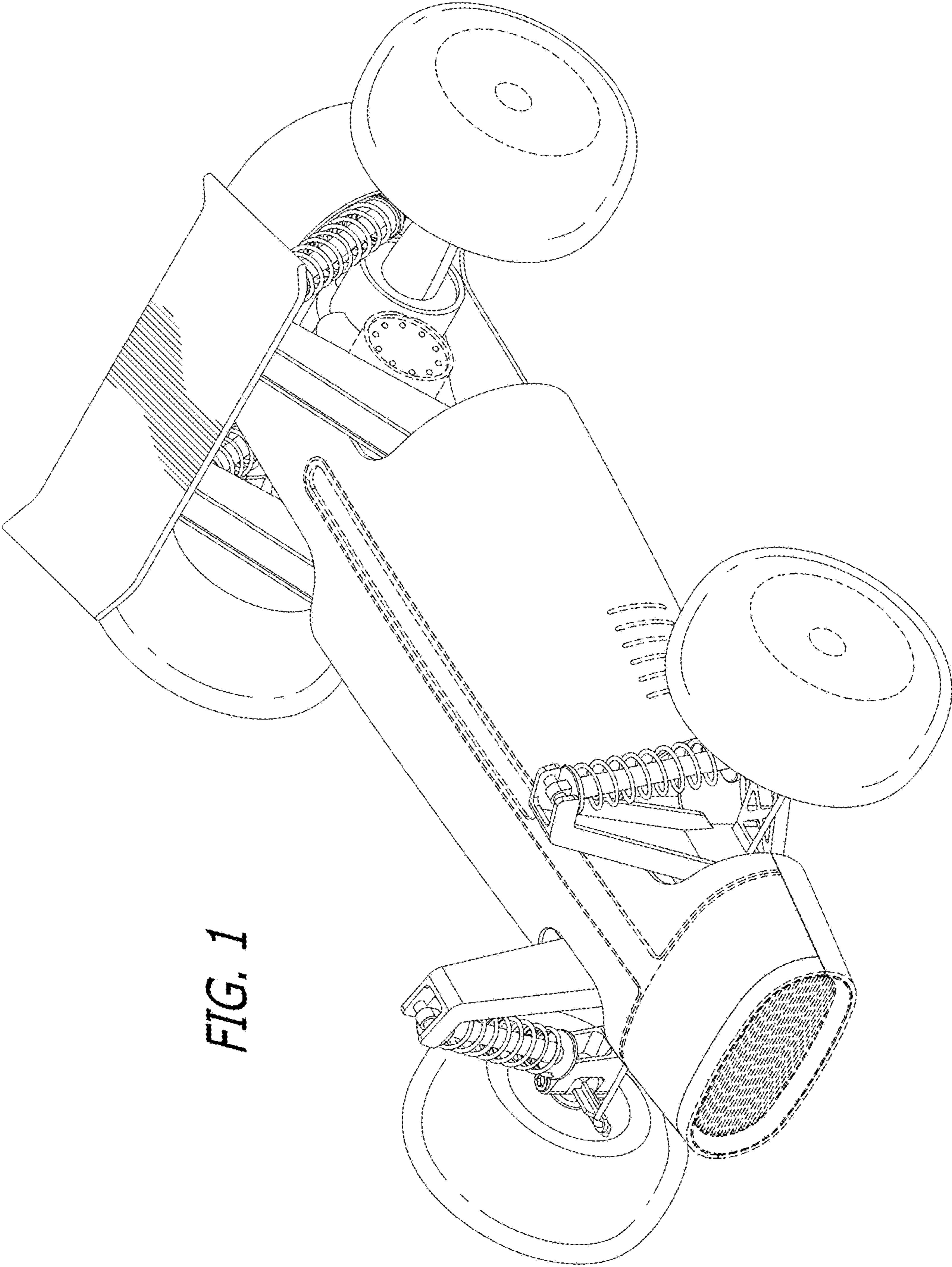
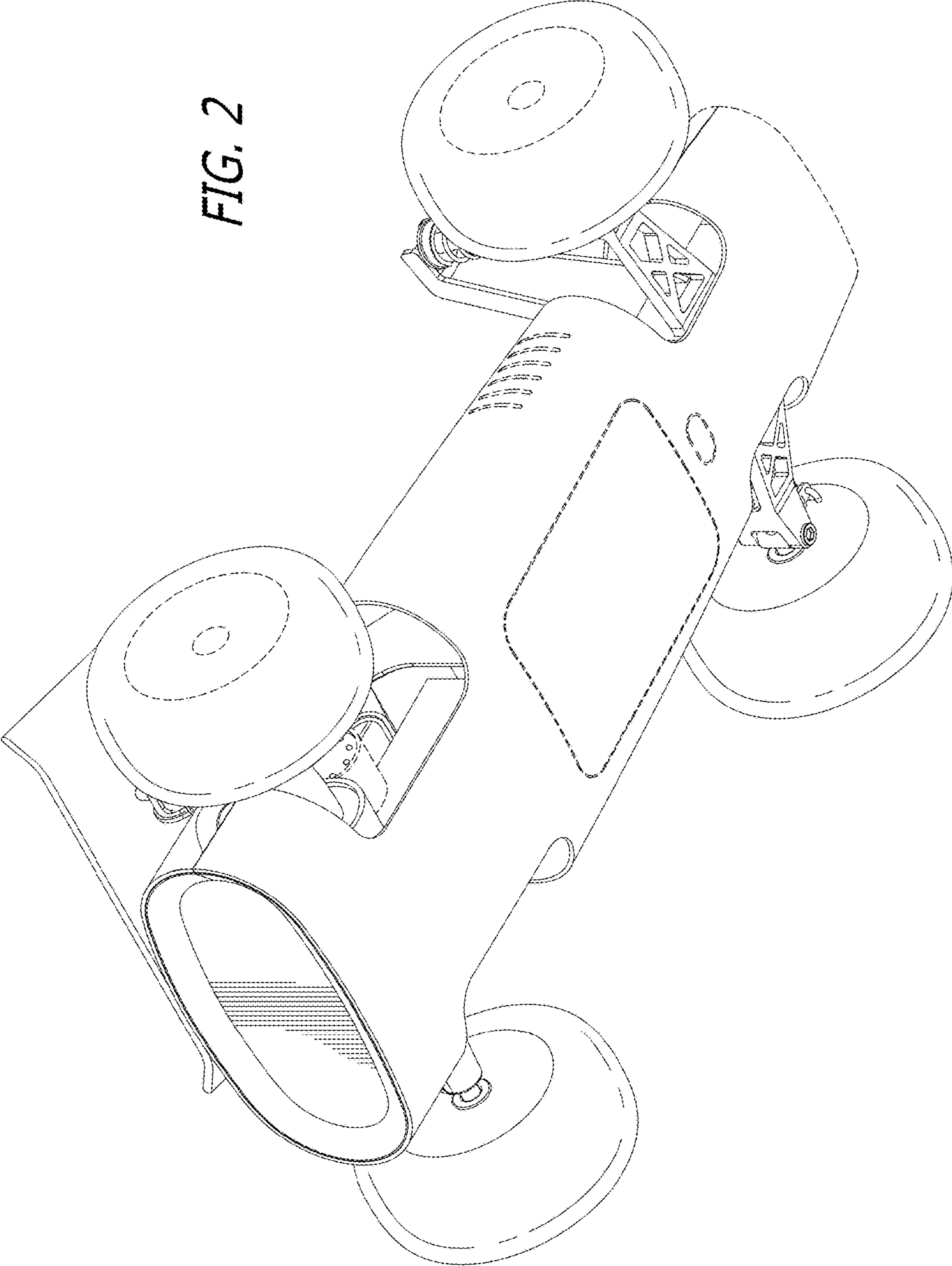

FIG. 1

FIG. 2



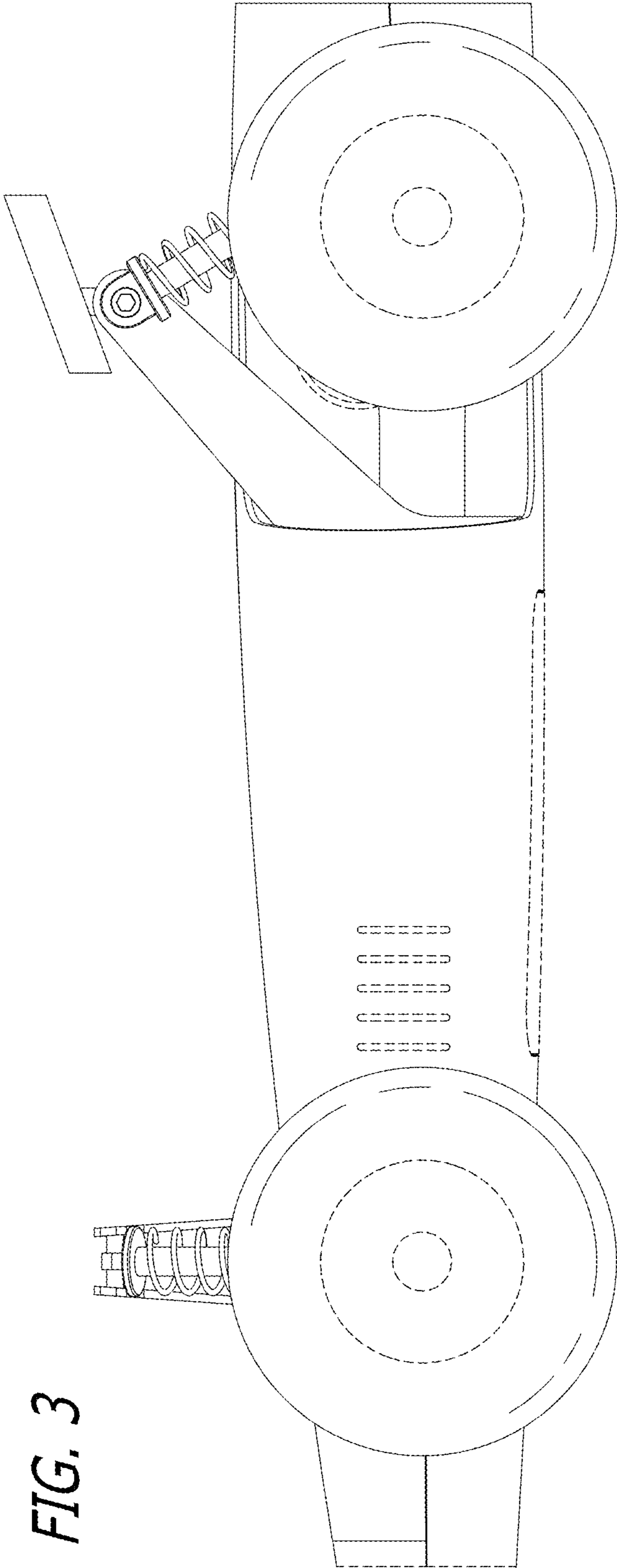

FIG. 3

FIG. 4

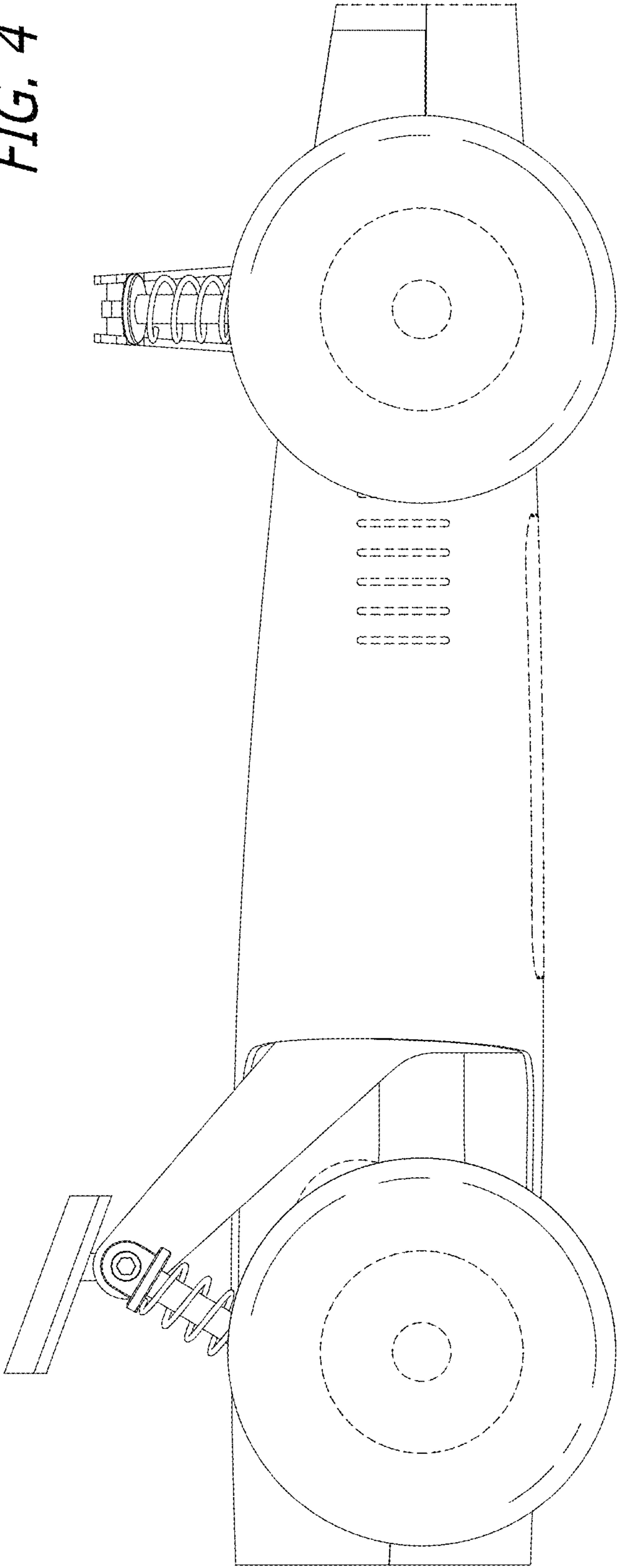

FIG. 5

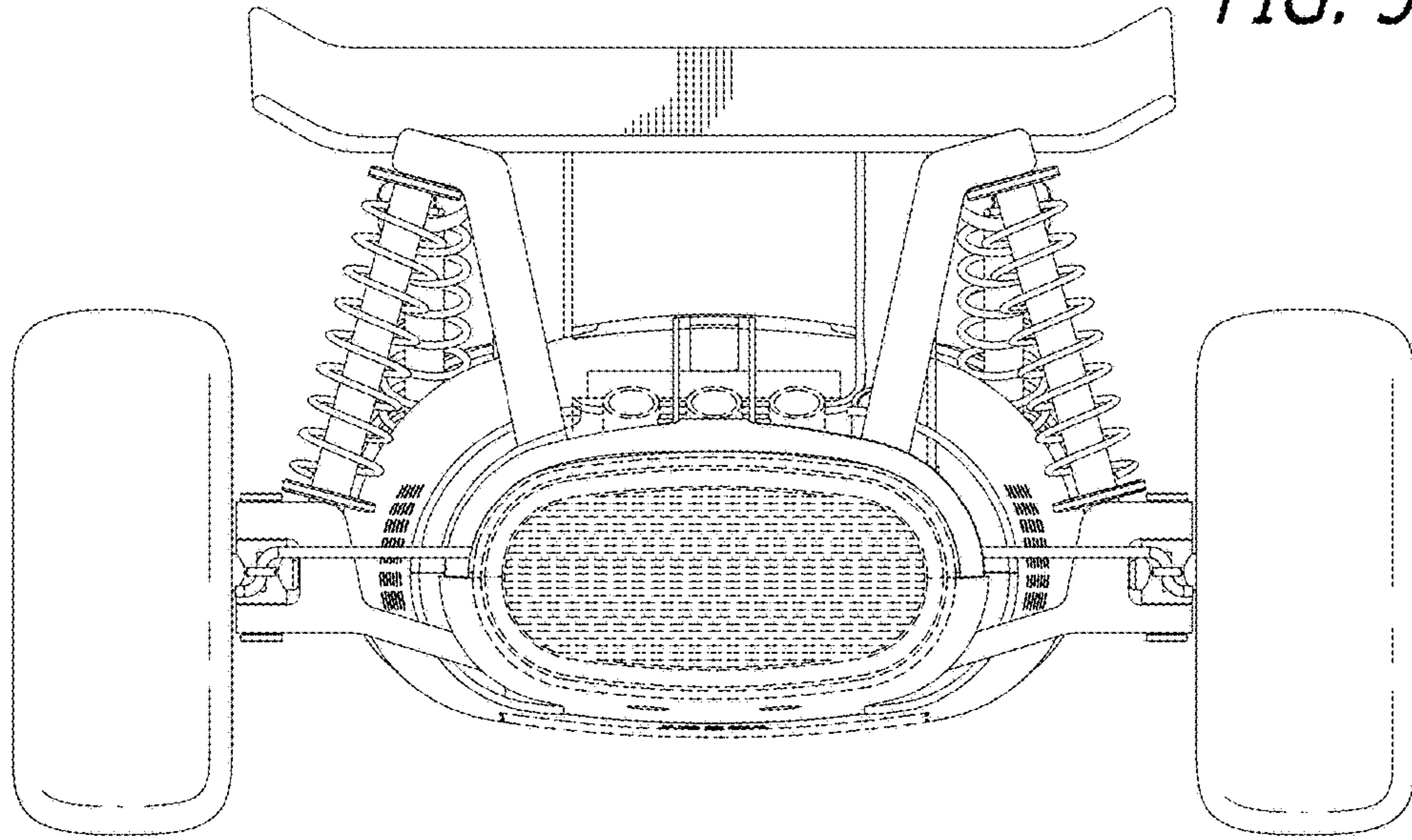
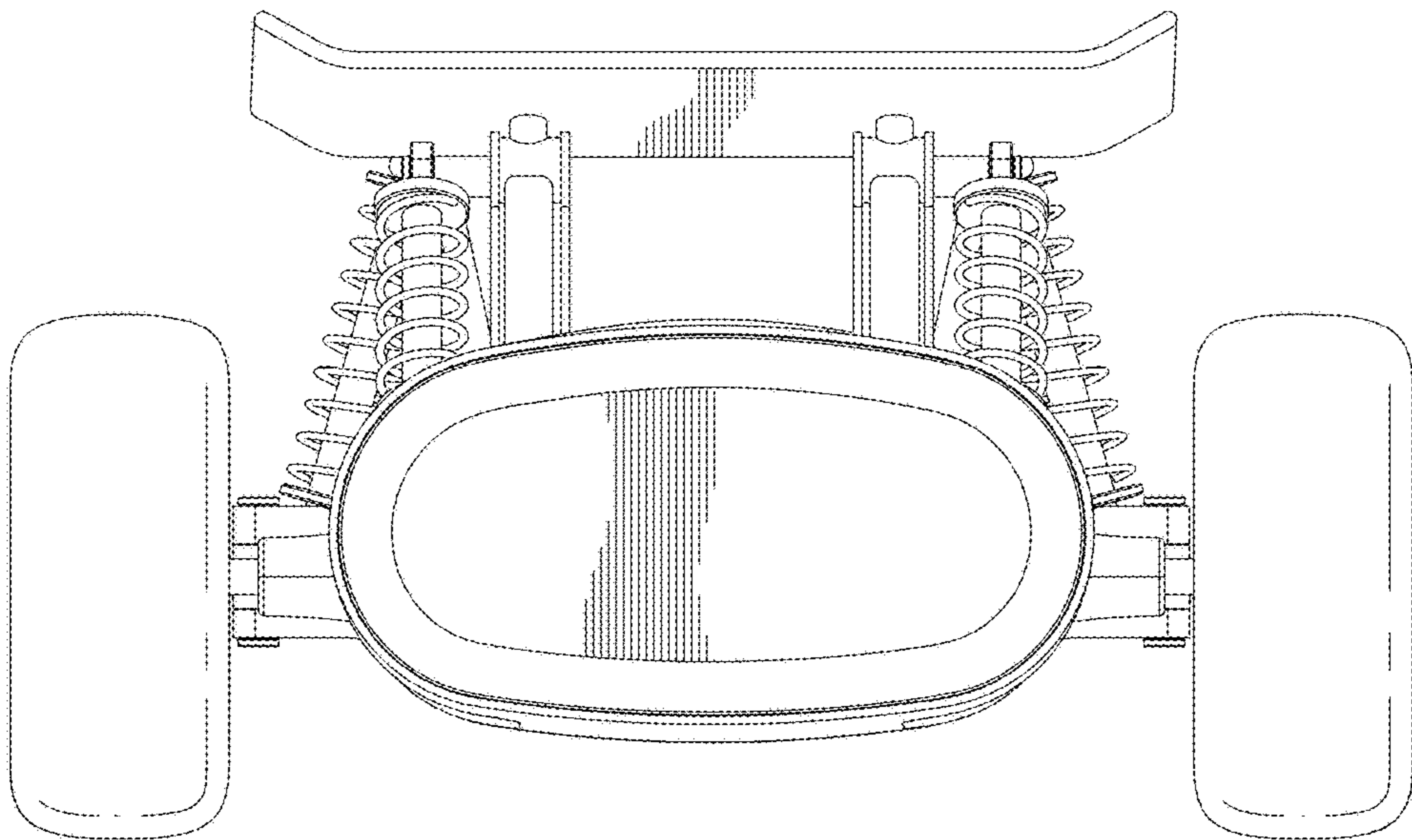

FIG. 6



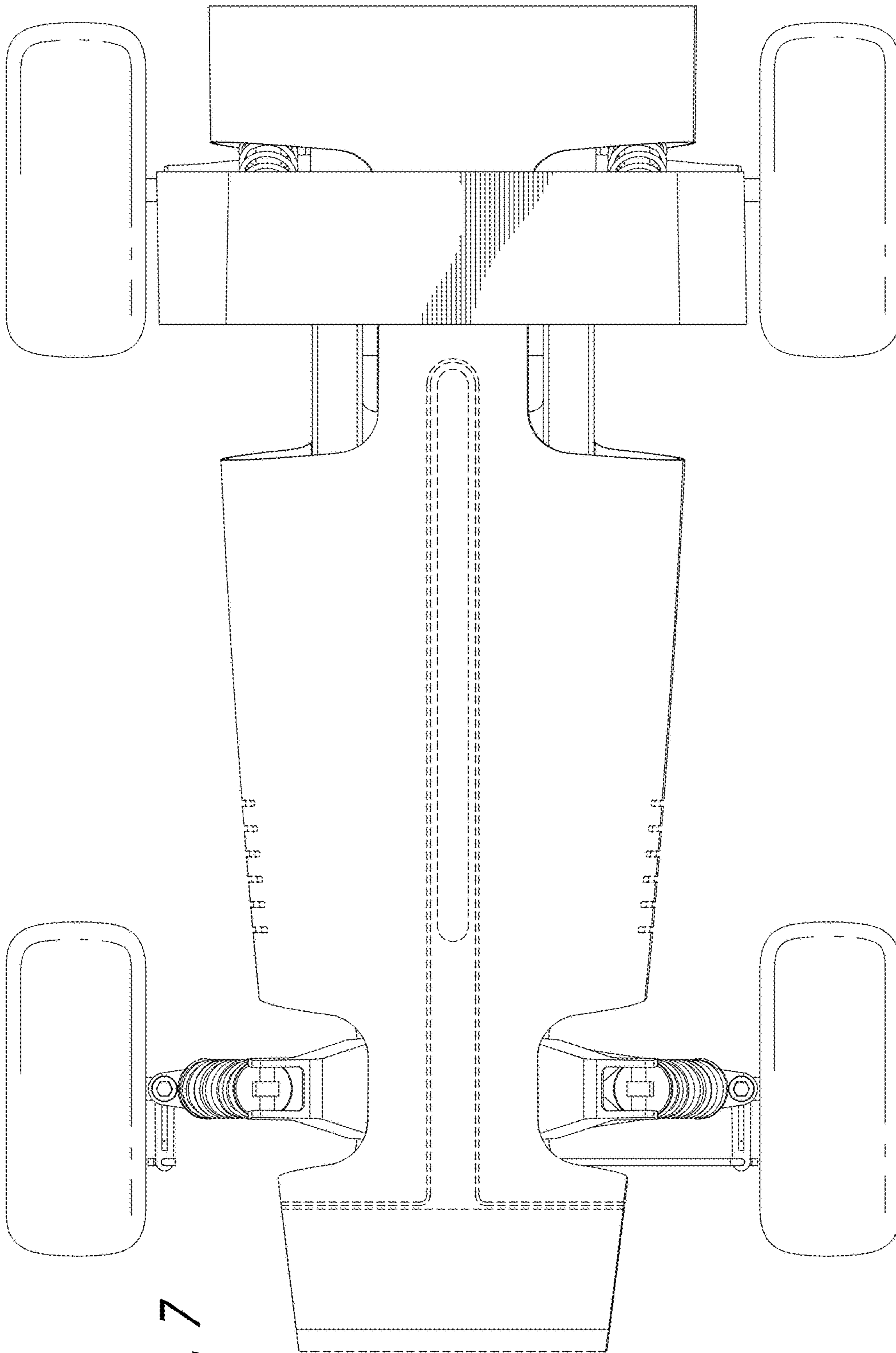

FIG. 7

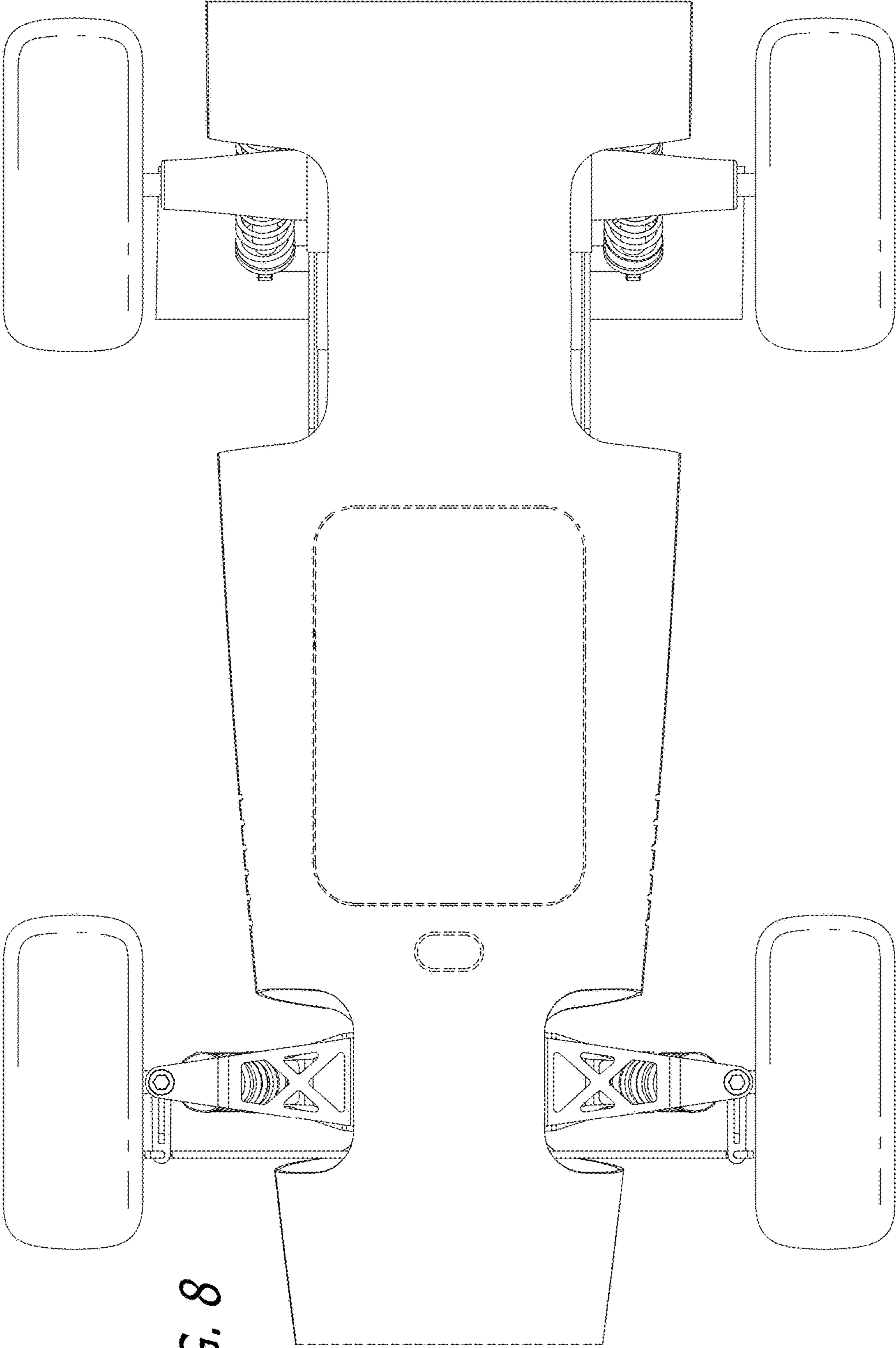

FIG. 8