



US00D825494S

(12) **United States Design Patent** (10) **Patent No.:** **US D825,494 S**
Ryan et al. (45) **Date of Patent:** **** Aug. 14, 2018**

(54) **REMOTE CONTROL HOUSING**

(71) Applicant: **Universal Electronics Inc.**, Santa Ana, CA (US)

(72) Inventors: **Brian Ryan**, Darlington (GB); **Richard Remmes**, Santa Ana, CA (US); **Alex Lai**, Lake Silver (HK)

(73) Assignee: **Universal Electronics Inc.**, Santa Ana, CA (US)

(**) Term: **15 Years**

(21) Appl. No.: **29/582,446**

(22) Filed: **Oct. 27, 2016**

(51) **LOC (11) Cl.** **14-03**

(52) **U.S. Cl.**
 USPC **D13/168**; D14/218

(58) **Field of Classification Search**
 USPC D13/168; D14/218
 CPC H05K 5/0217; H05K 5/0221; H05K 5/03; H01H 9/0235; H01H 9/0242; H04B 1/202; G08C 17/00; G08C 17/02; G08C 19/28; G08C 23/04; H04N 21/4221; H04N 21/42204; H04N 5/44582
 See application file for complete search history.

(56) **References Cited**

U.S. PATENT DOCUMENTS

D533,165 S * 12/2006 Knight D14/218
 D601,976 S * 10/2009 Petrillo D13/168
 9,155,210 B2 * 10/2015 Hwang H05K 5/0017
 D774,493 S * 12/2016 Wong D14/218
 D785,602 S * 5/2017 Park D14/218
 9,703,330 B2 * 7/2017 Johnson G06F 1/181
 2010/0062323 A1 * 3/2010 Dong H01M 2/1066
 429/96
 2010/0102576 A1 * 4/2010 Zhang A45F 5/00
 292/261

2013/0165190 A1 * 6/2013 Ko H05K 5/03
 455/575.8
 2013/0328461 A1 * 12/2013 Chung H05K 5/0221
 312/223.1
 2014/0016996 A1 * 1/2014 Chung H05K 5/0221
 403/321
 2015/0061475 A1 * 3/2015 Fairchild H05K 5/0013
 312/223.1
 2015/0156903 A1 * 6/2015 Heimerl H05K 5/0204
 174/520
 2015/0228420 A1 * 8/2015 McDaniel H01H 9/0242
 206/524.6
 2015/0277487 A1 * 10/2015 Gerst G06F 1/1626
 361/679.01
 2015/0289398 A1 * 10/2015 Takase G02F 1/133308
 428/138
 2016/0120047 A1 * 4/2016 Chang H05K 5/0221
 361/679.01
 2017/0170446 A1 * 6/2017 Tompkins H01M 2/34
 2017/0263114 A1 * 9/2017 Yoon G08C 17/02

* cited by examiner

Primary Examiner — Selina Sikder
 (74) *Attorney, Agent, or Firm* — Greenberg Traurig, LLP

(57) **CLAIM**

The ornamental design for a remote control housing, as shown and described.

DESCRIPTION

FIG. 1 is a top perspective view of a remote control housing showing my new design;
 FIG. 2 is a bottom perspective view thereof;
 FIG. 3 is a top plan view thereof;
 FIG. 4 is a bottom view thereof;
 FIG. 5 is a right side elevational view thereof;
 FIG. 6 is a left side elevational view thereof;
 FIG. 7 is front elevational view thereof; and,
 FIG. 8 is a rear elevational view thereof.
 The broken lines illustrate portions of the remote control housing that form no part of the claimed design.

1 Claim, 8 Drawing Sheets

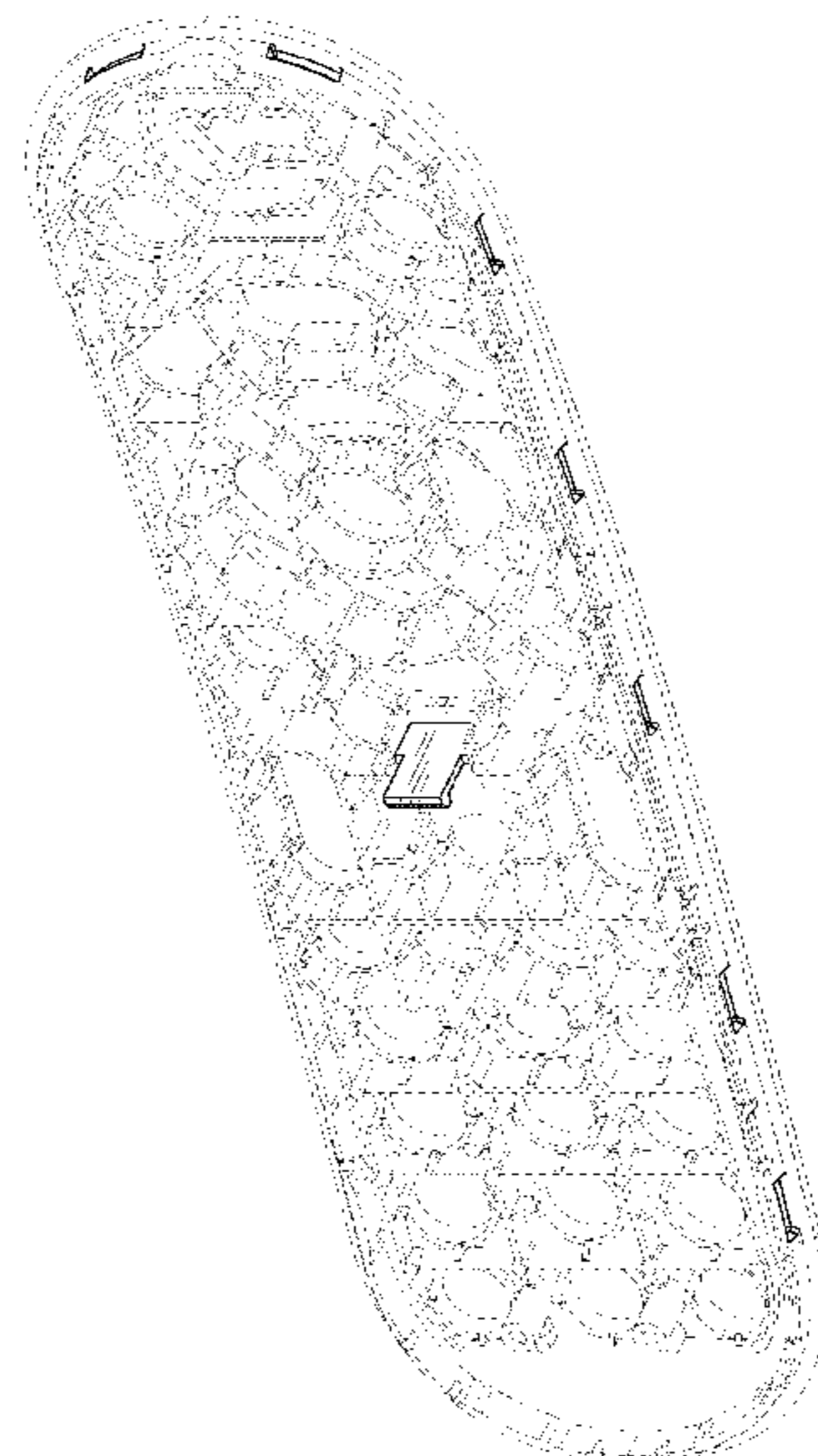

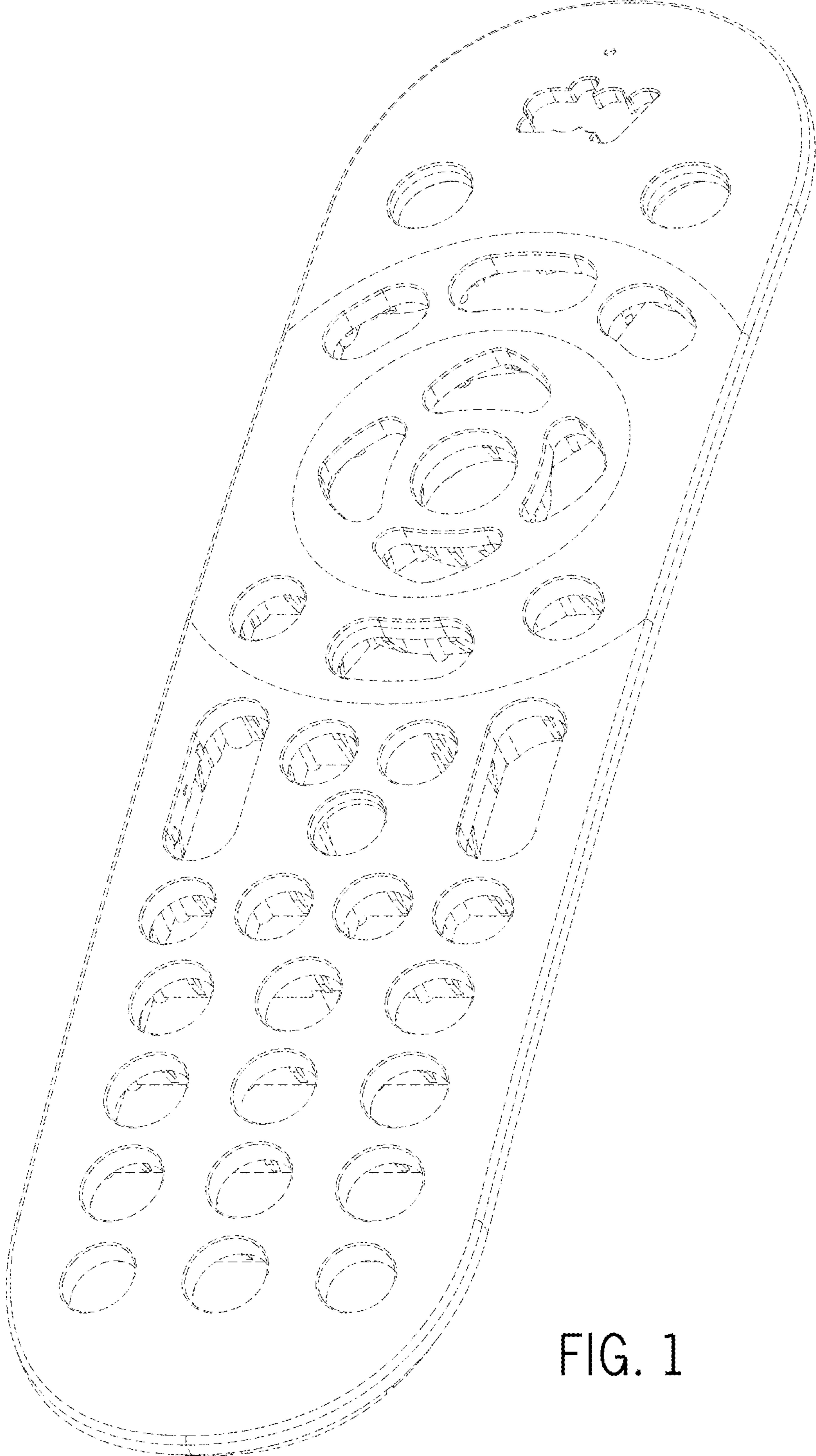

FIG. 1

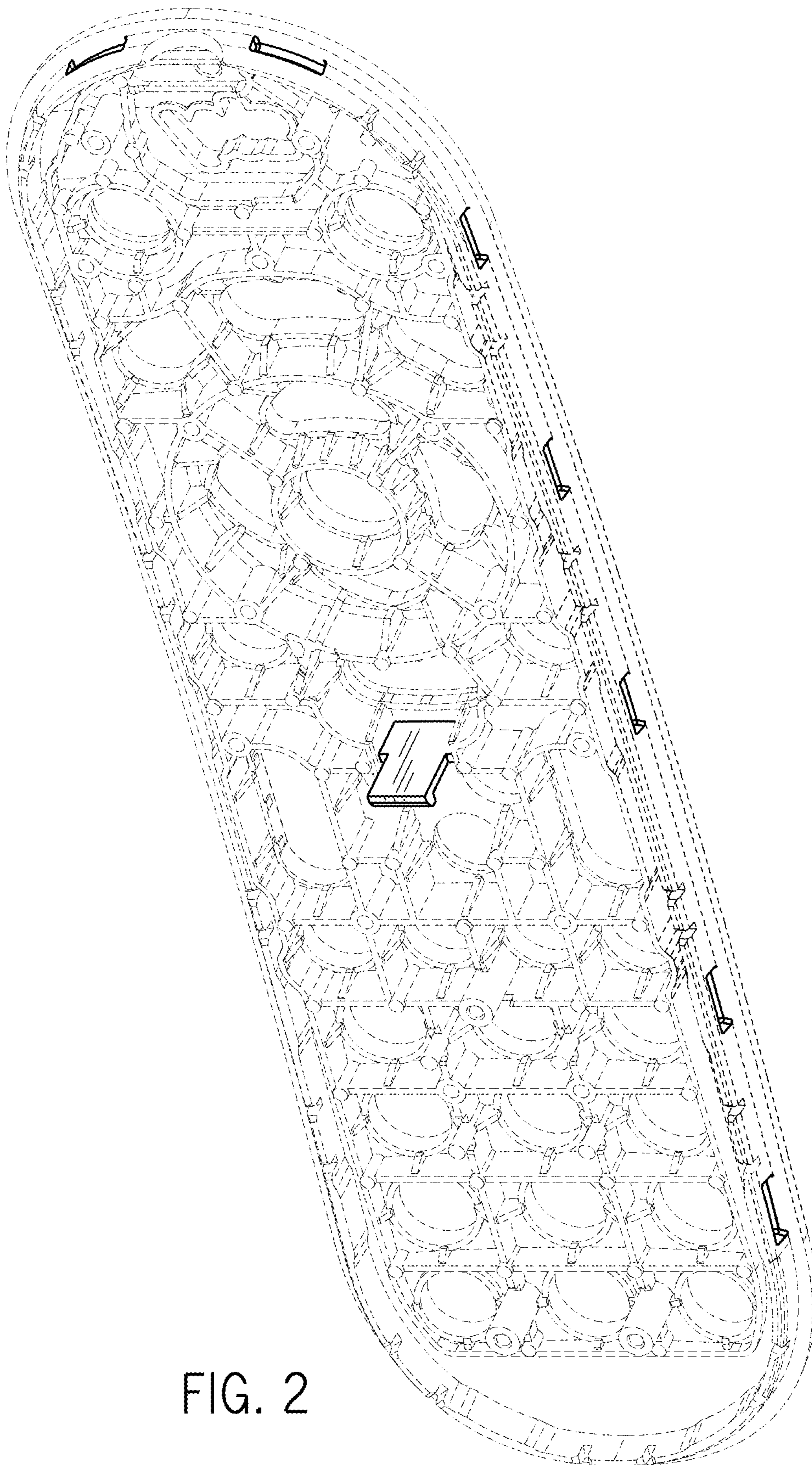

FIG. 2

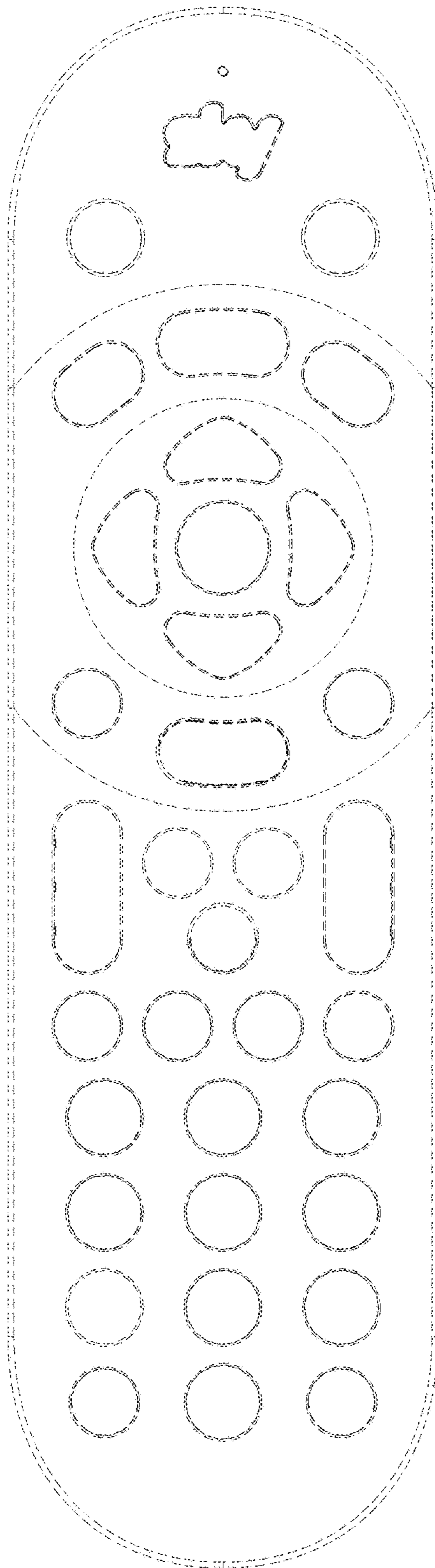

FIG. 3

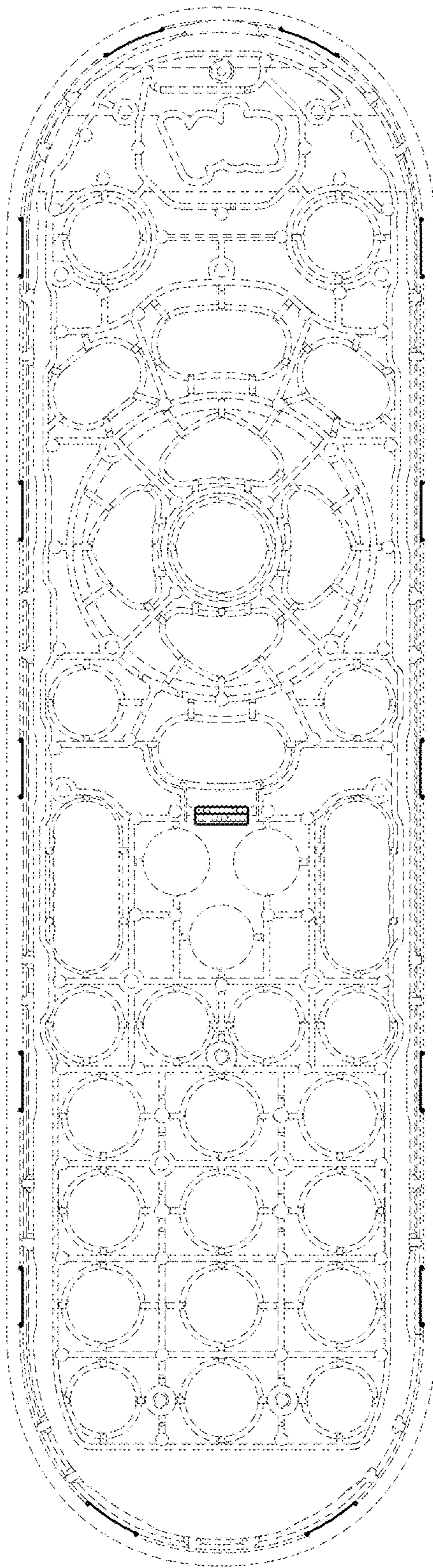

FIG. 4

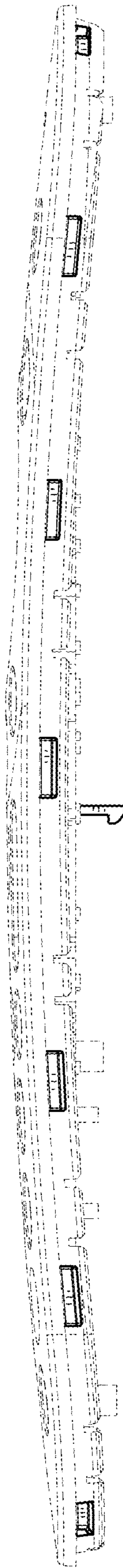

FIG. 5

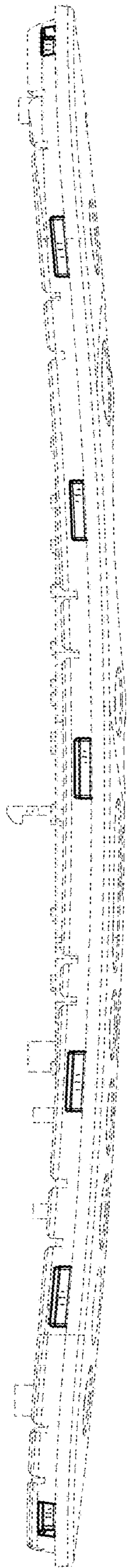

FIG. 6

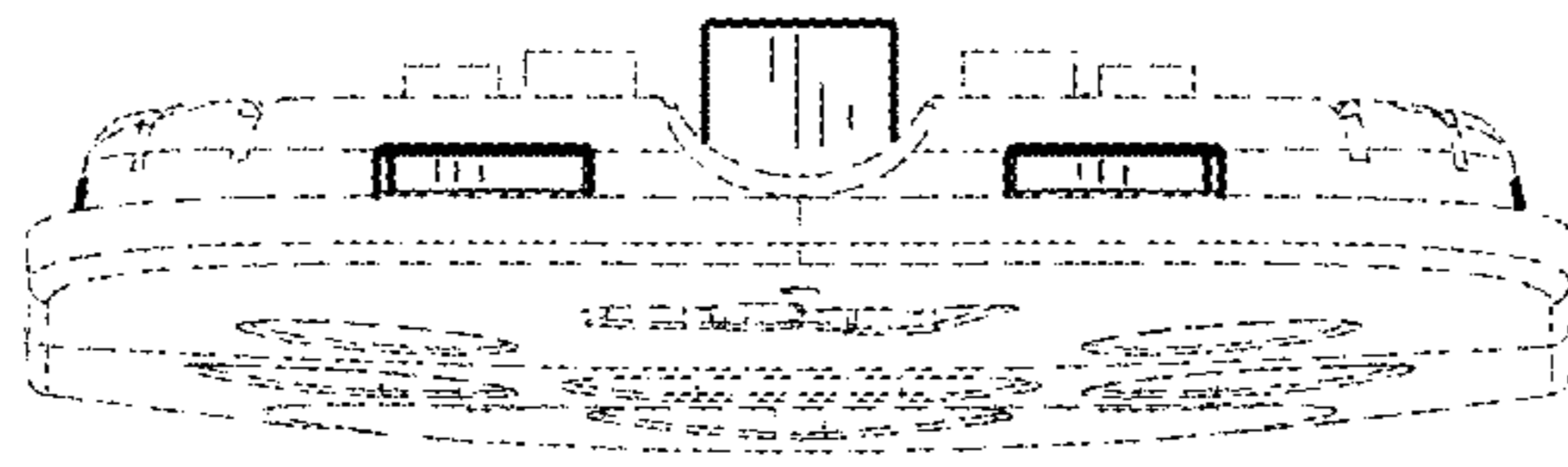

FIG. 7

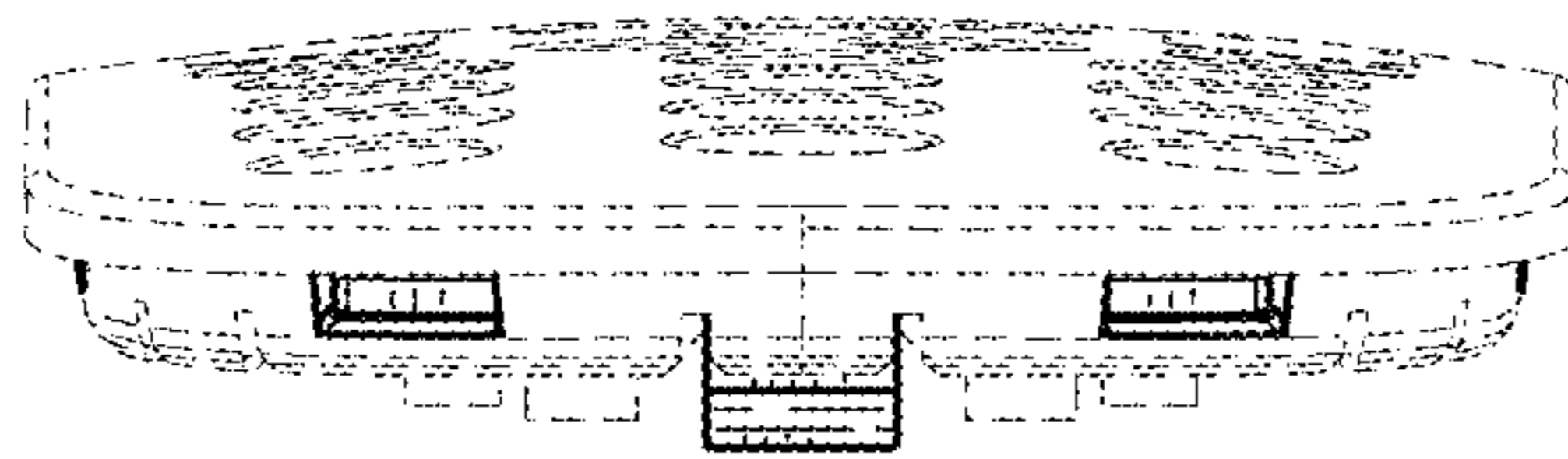

FIG. 8