



US00D825305S

(12) **United States Design Patent**
Tasic et al.

(10) **Patent No.:** **US D825,305 S**
(45) **Date of Patent:** **** Aug. 14, 2018**

(54) **POWER TOOL HANDLE PORTION**

(71) Applicant: **Robert Bosch GmbH**, Stuttgart (DE)

(72) Inventors: **Zoran Tasic**, Esslingen (DE); **Vincent Hasenmayer**, Stuttgart-Möhringen (DE)

(73) Assignee: **Robert Bosch GmbH**, Stuttgart (DE)

(**) Term: **15 Years**

(21) Appl. No.: **29/572,460**

(22) Filed: **Jul. 28, 2016**

(30) **Foreign Application Priority Data**

Feb. 15, 2016 (EM) 002986455

(51) **LOC (11) Cl.** **08-03**

(52) **U.S. Cl.**
USPC **D8/62**

(58) **Field of Classification Search**
USPC D8/69, 68, 67, 66, 64, 61, 70; 83/698.41,
83/747, 166.3, 374, 373, 375, 376, 391,
(Continued)

(56) **References Cited**

U.S. PATENT DOCUMENTS

D497,296 S * 10/2004 Krondorfer D8/62
D506,662 S * 6/2005 Watson D8/62
(Continued)

Primary Examiner — Austin Murphy

(74) *Attorney, Agent, or Firm* — Maginot, Moore & Beck
LLP

(57) **CLAIM**

The ornamental design for a power tool handle portion, as shown and described.

DESCRIPTION

Cross reference is made to copending U.S. design patent application Ser. No. 29/572,457 entitled "Power Tool Handle Portion" by Tasic et al. filed on Jul. 28, 2016.

FIG. 1 is a perspective view of a power tool including a first embodiment of a power tool handle portion showing our new design;

FIG. 2 is a front elevational view of the power tool handle portion of FIG. 1;

FIG. 3 is a top plan view of the power tool handle portion of FIG. 1; and

FIG. 4 is a bottom plan view of the power tool handle portion of FIG. 1.

FIG. 5 is a perspective view of a power tool including a second embodiment of a power tool handle portion showing our new design;

FIG. 6 is a front elevational view showing the power tool handle portion of FIG. 5;

FIG. 7 is a top plan view showing the power tool handle portion of FIG. 5;

FIG. 8 is a bottom plan view showing the power tool handle portion of FIG. 5;

FIG. 9 is an enlarged front elevational view of the power tool handle portion of FIG. 5; and

FIG. 10 is an enlarged bottom plan view of the power tool handle portion of FIG. 5.

FIG. 11 is a perspective view of a power tool including a third embodiment of a power tool handle portion showing our new design;

FIG. 12 is a front elevational view showing the design for the power tool handle portion of FIG. 11;

FIG. 13 is a rear elevational view of the power tool of FIG. 11;

FIG. 14 is a left side elevational view of the power tool of FIG. 11;

FIG. 15 is a right side elevational view of the power tool of FIG. 11;

FIG. 16 is a top plan view showing the power tool handle portion of FIG. 11; and,

FIG. 17 is a bottom plan view showing the power tool handle portion of FIG. 11.

The broken lines shown in the drawings form no part of the claimed design. The dash-dot-dash lines of FIGS. 1-10 identify boundaries of the claimed design and form no part of the claimed design. The rear side, left side, and right side

(Continued)

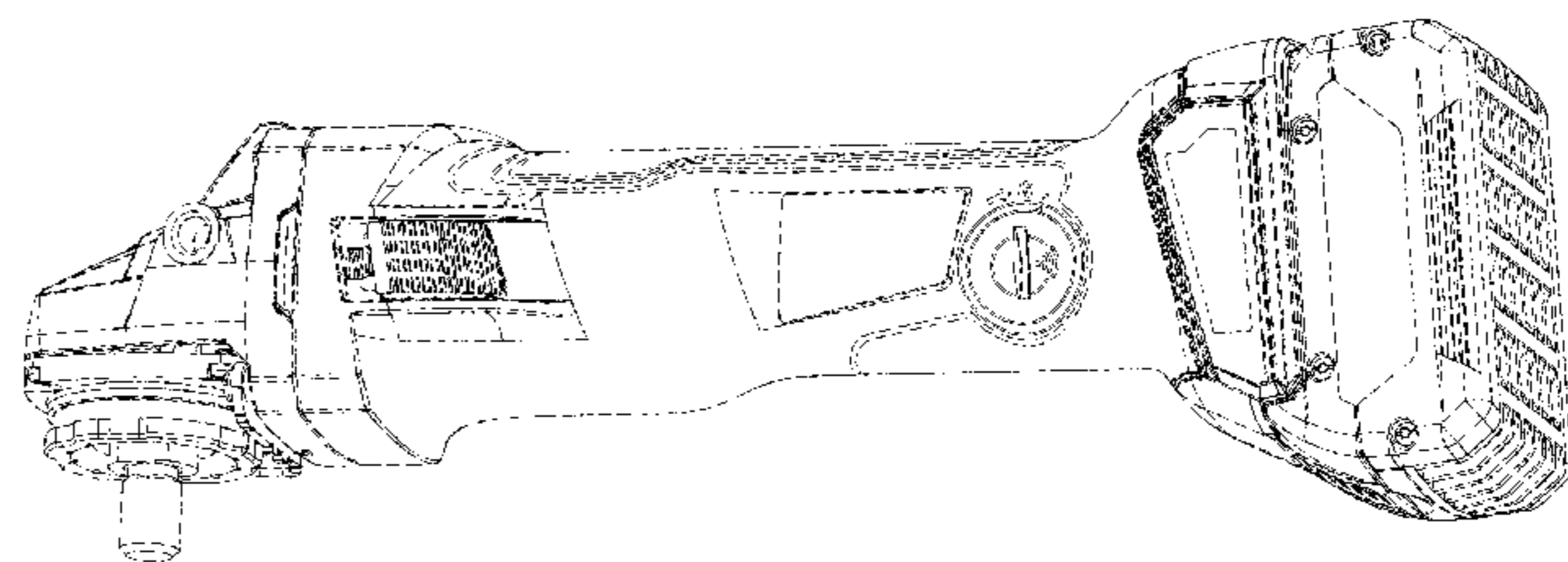
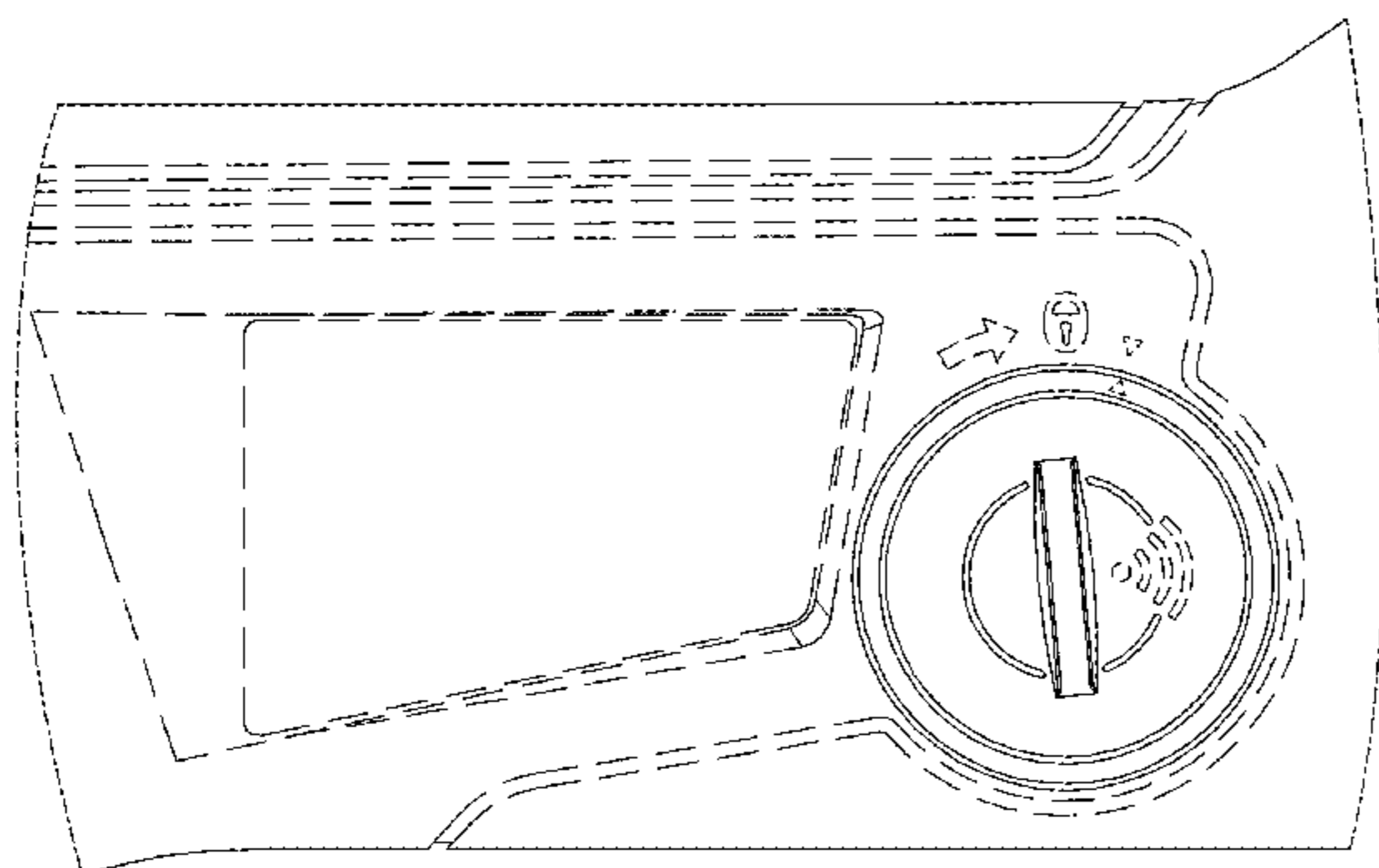

of the first and second embodiments of the power tool handle portion form no part of the claimed design.

1 Claim, 17 Drawing Sheets

(58) **Field of Classification Search**

USPC 83/377, 390, 388, 389; 125/13.01;
144/218; D21/532
CPC B24B 23/028; B24B 47/12; B24B 7/186;
B25F 5/001; B25F 5/02
See application file for complete search history.

(56) **References Cited**

U.S. PATENT DOCUMENTS

D540,638 S * 4/2007 Concari D8/62
D576,461 S * 9/2008 Bast D8/62
D580,723 S * 11/2008 Concari D8/62
D722,853 S * 2/2015 Takahashi D8/61

* cited by examiner

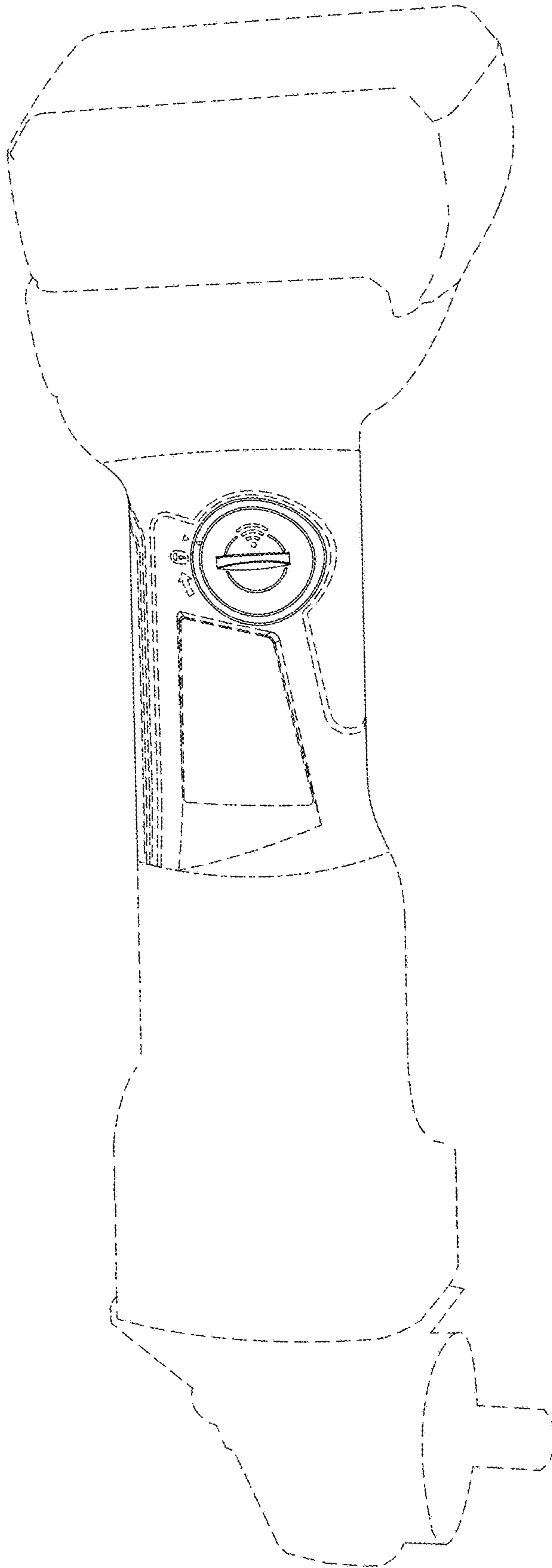

FIG. 1

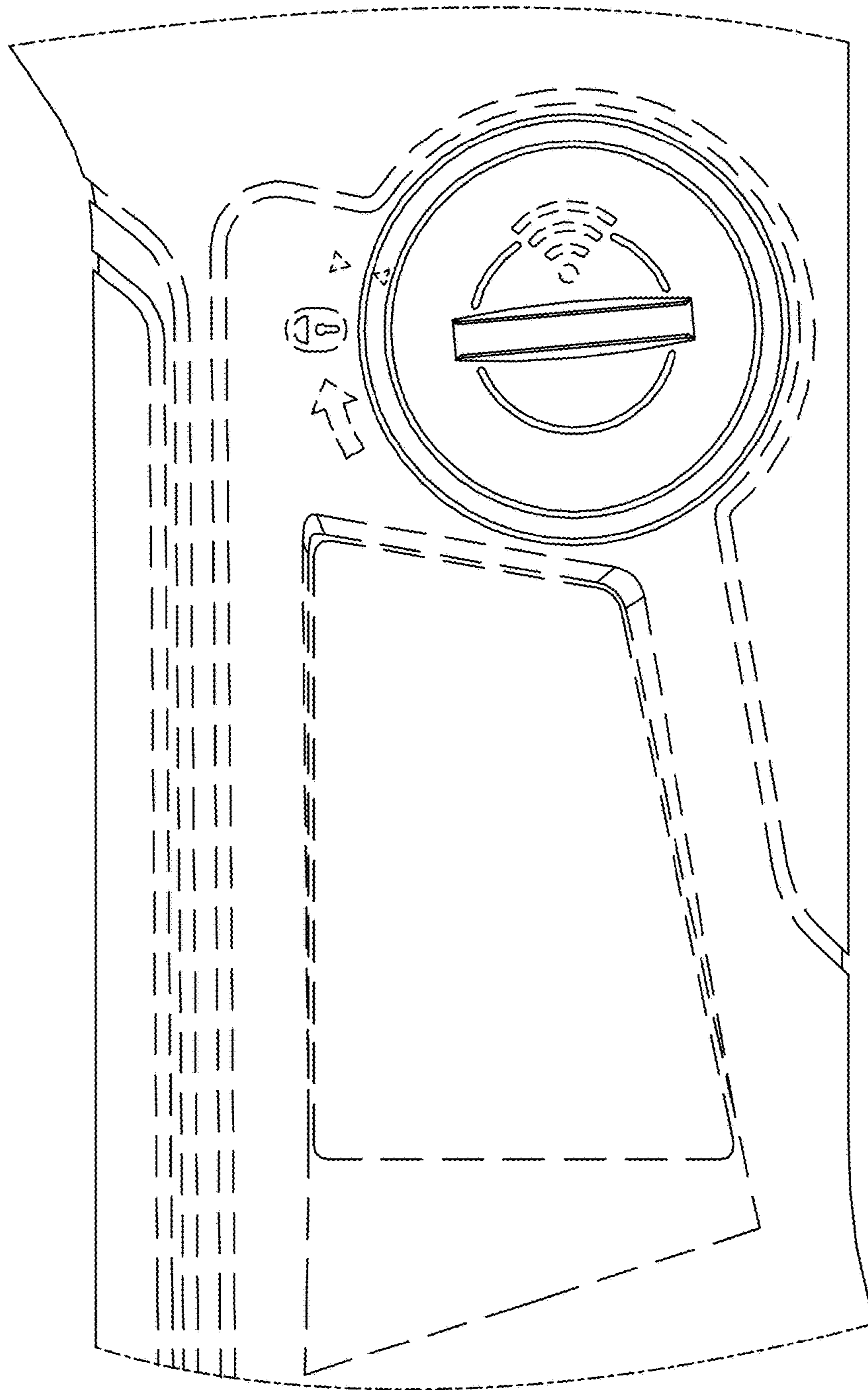

FIG. 2

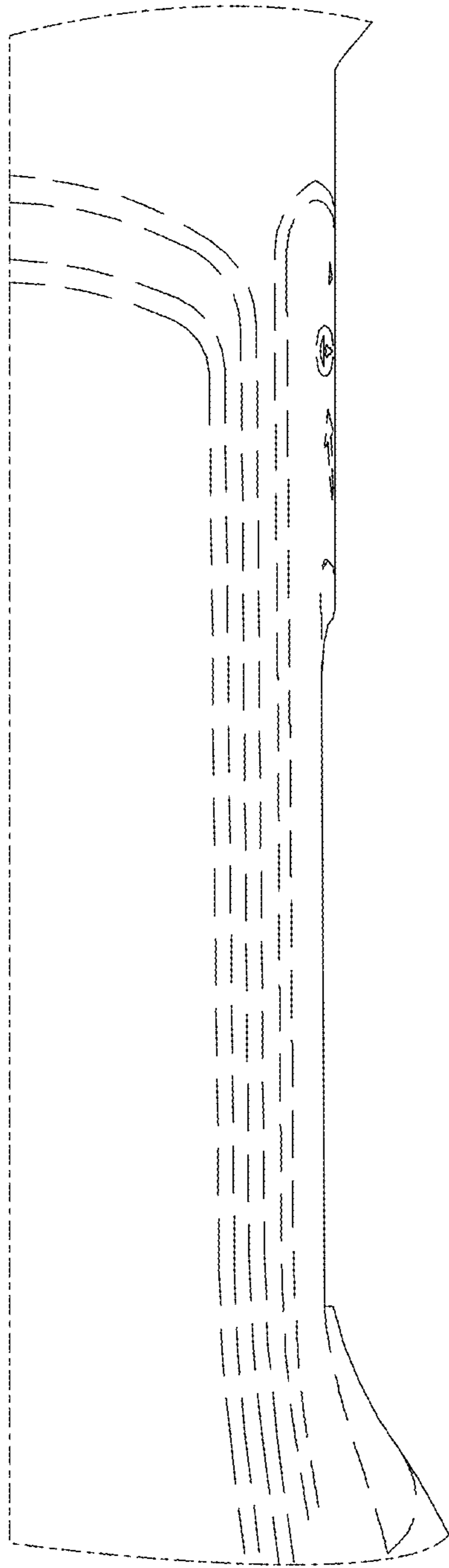

FIG. 3

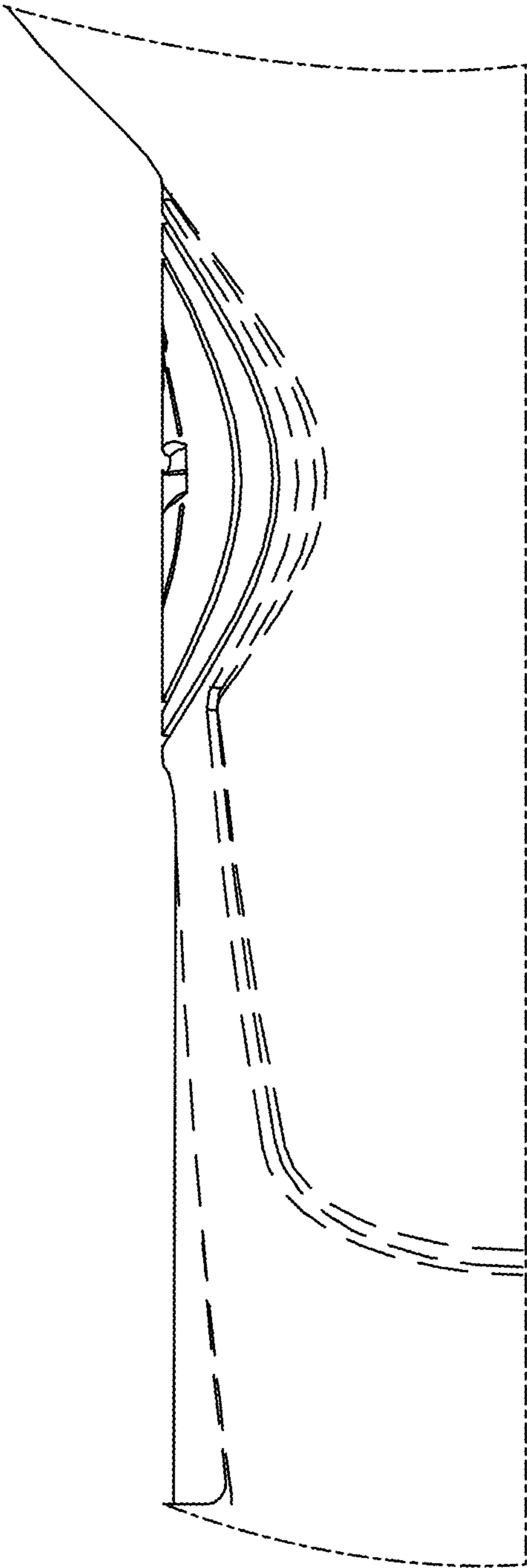

FIG. 4

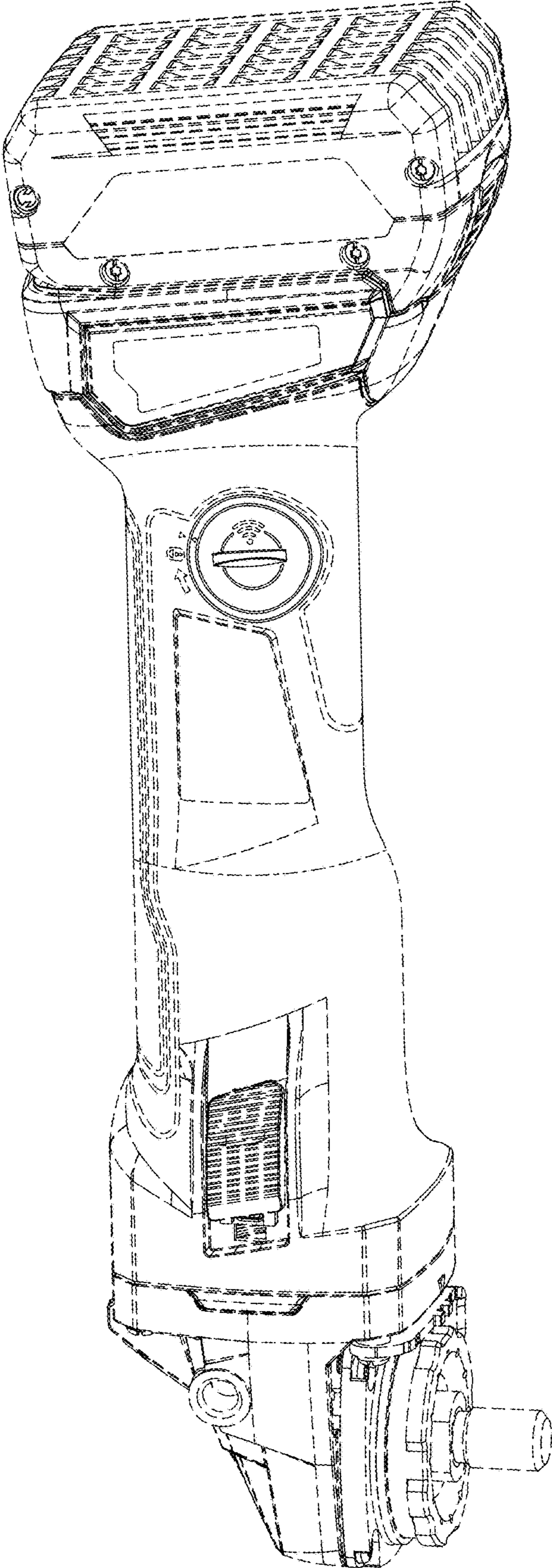

FIG. 5

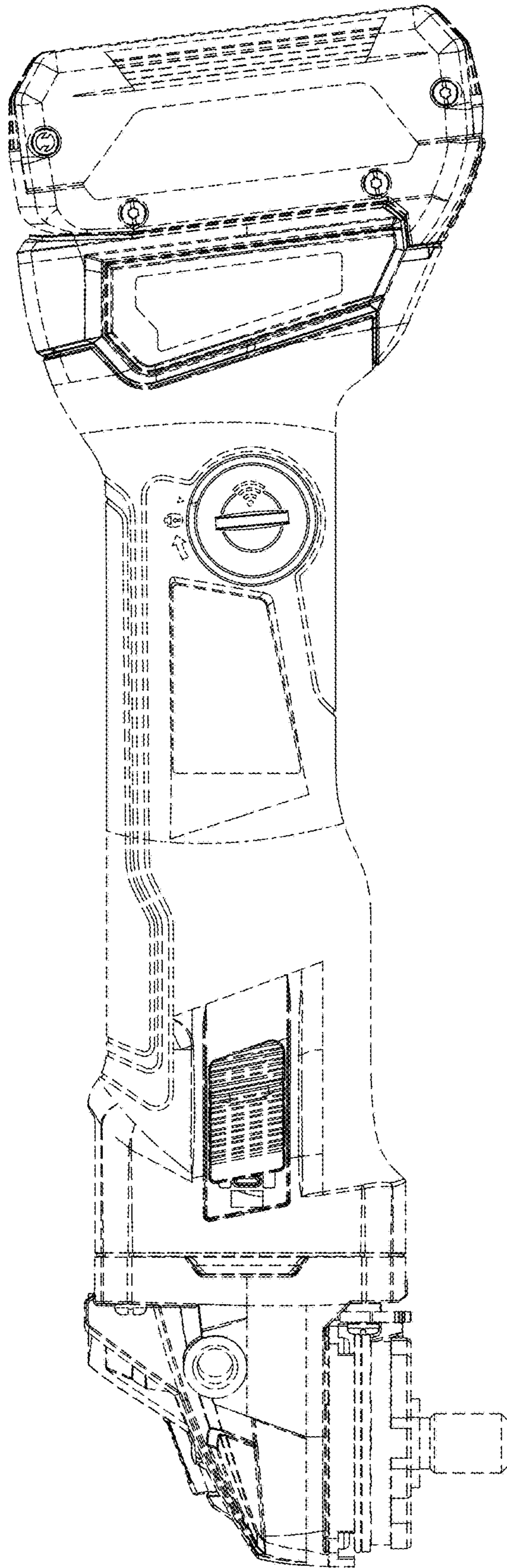

FIG. 6

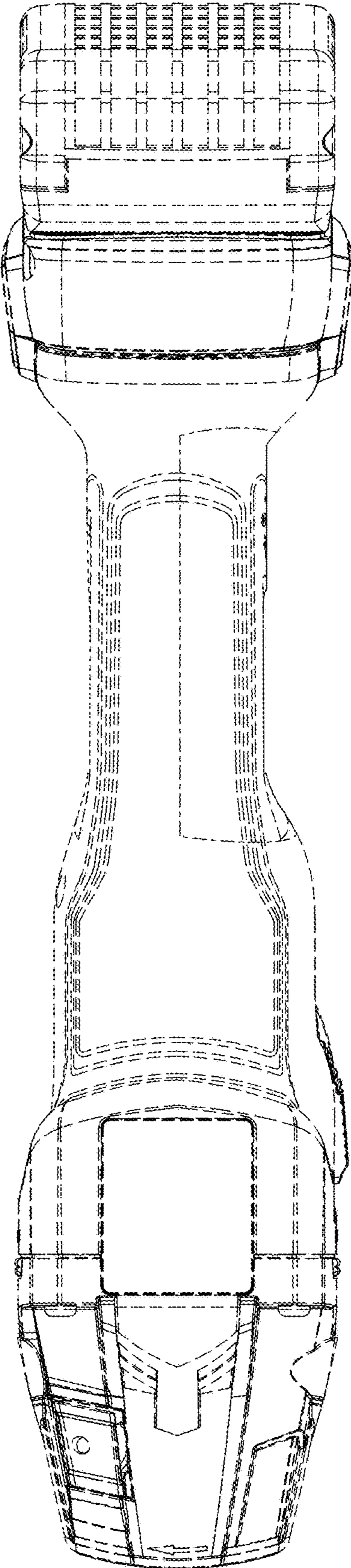

FIG. 7

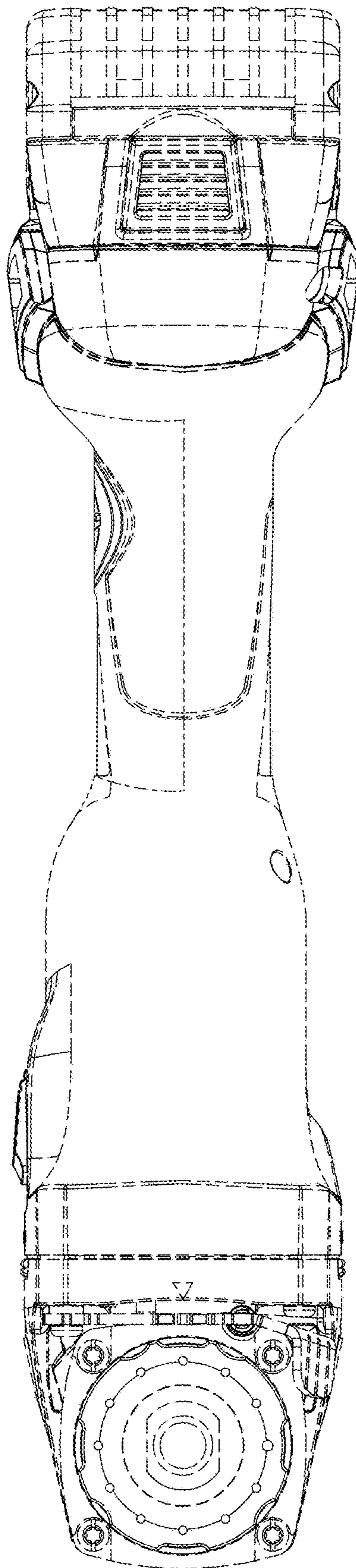

FIG. 8

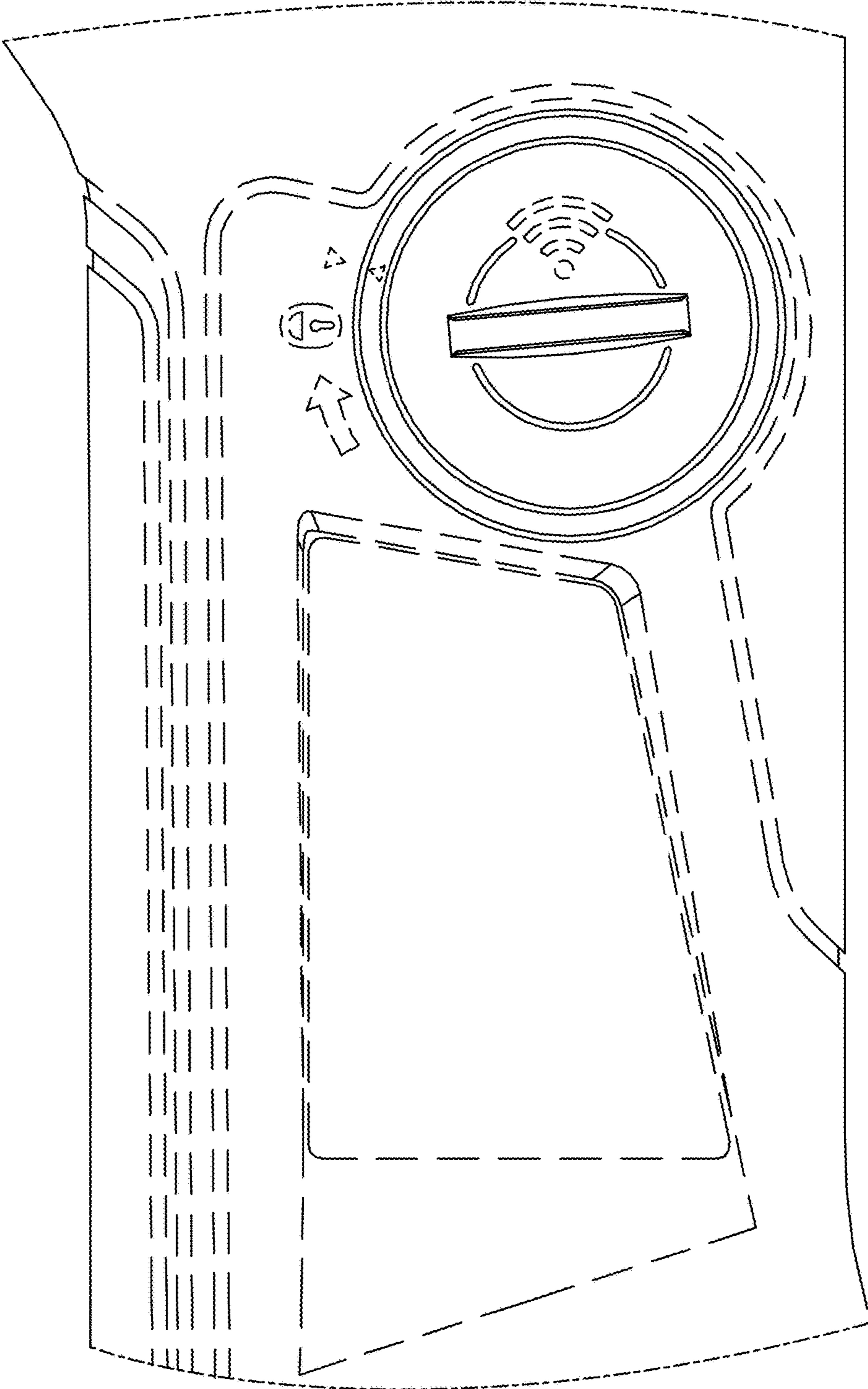

FIG. 9

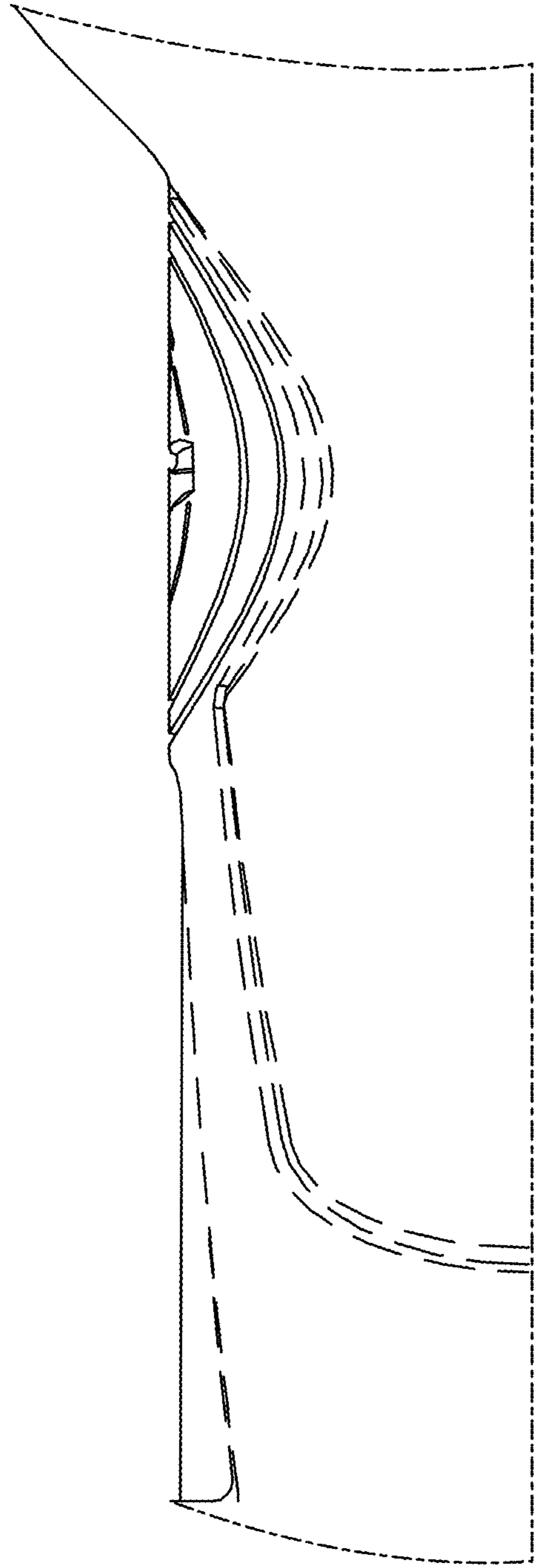

FIG. 10

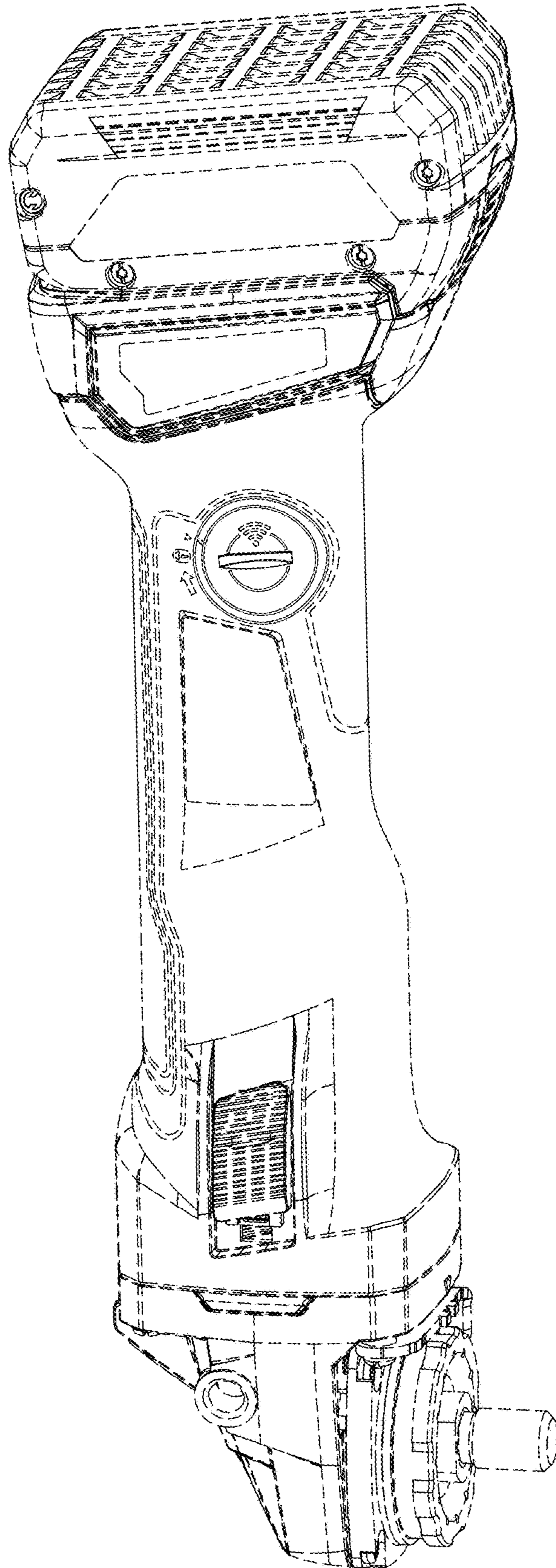

FIG. 11

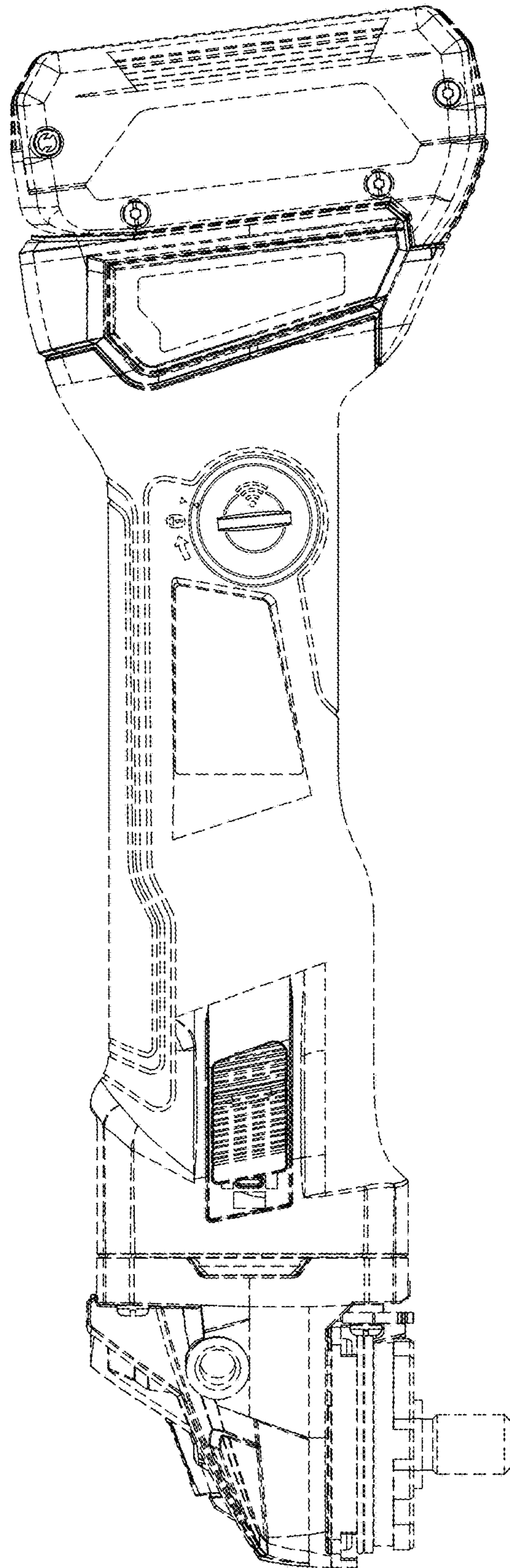

FIG. 12

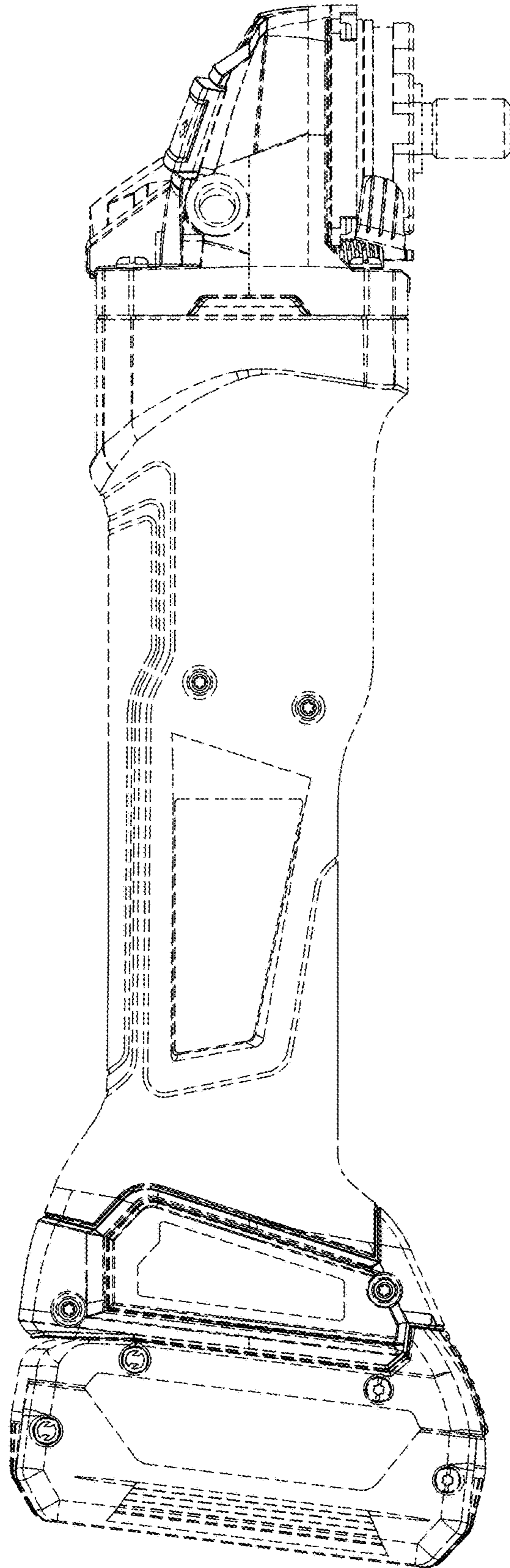

FIG. 13

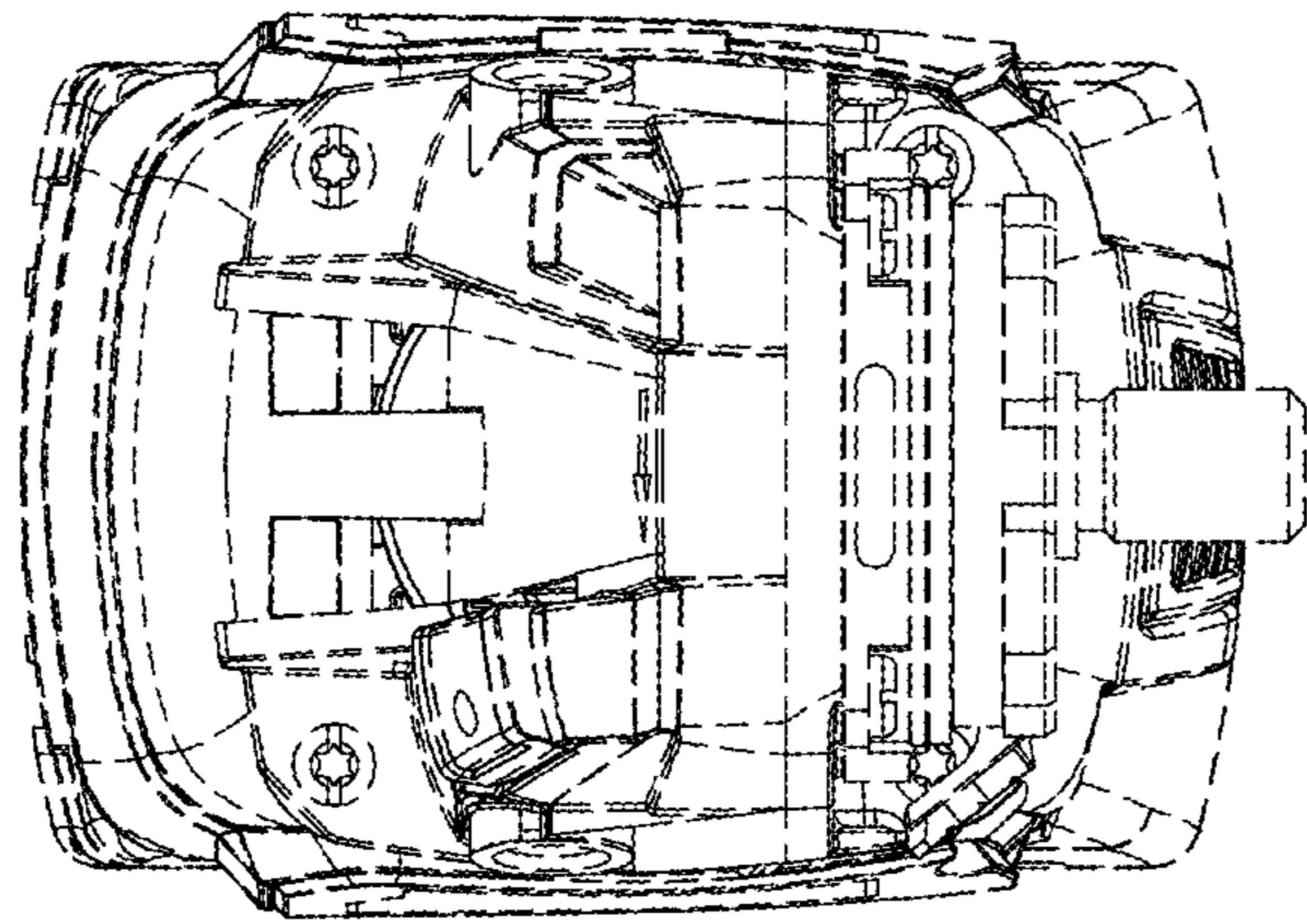

FIG. 14

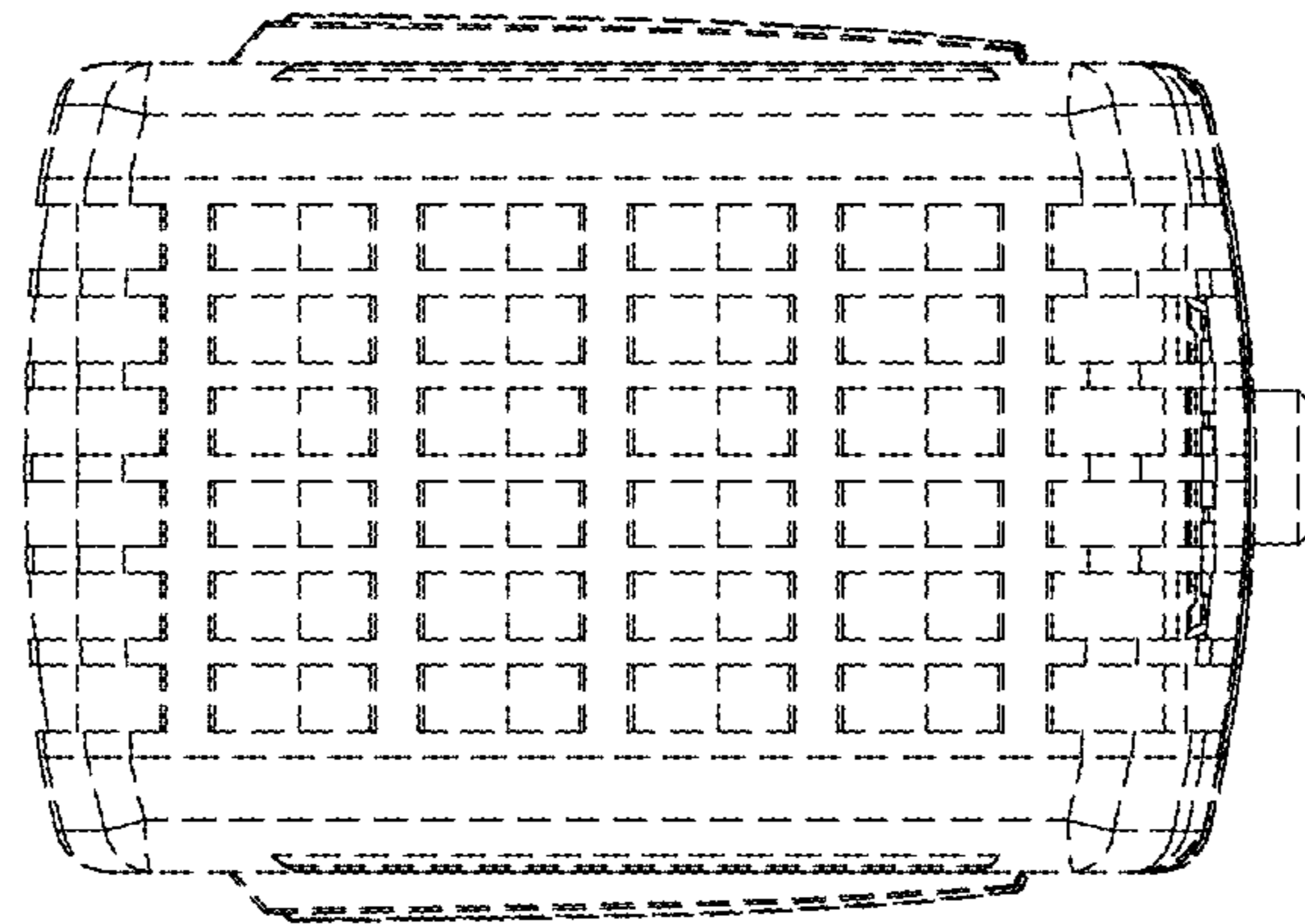

FIG. 15

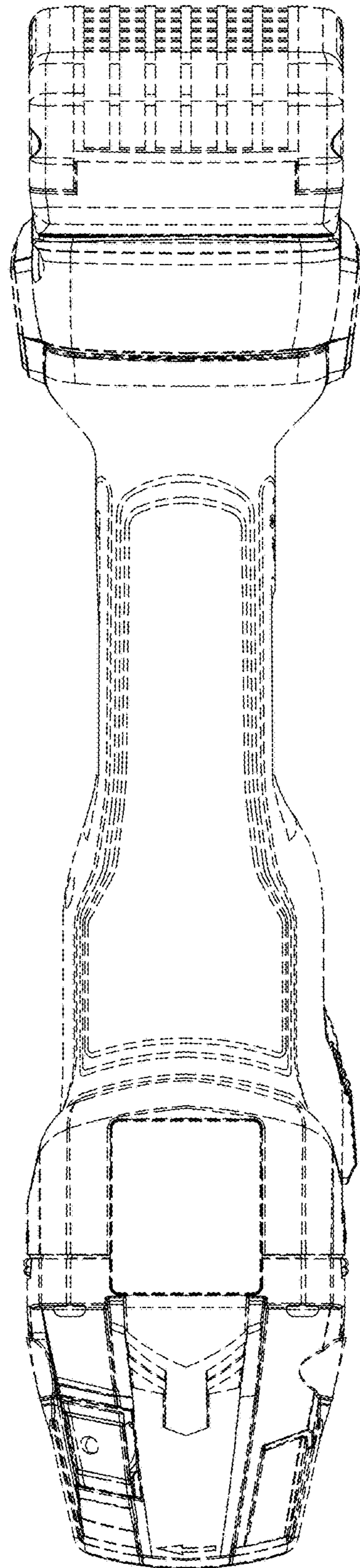

FIG. 16

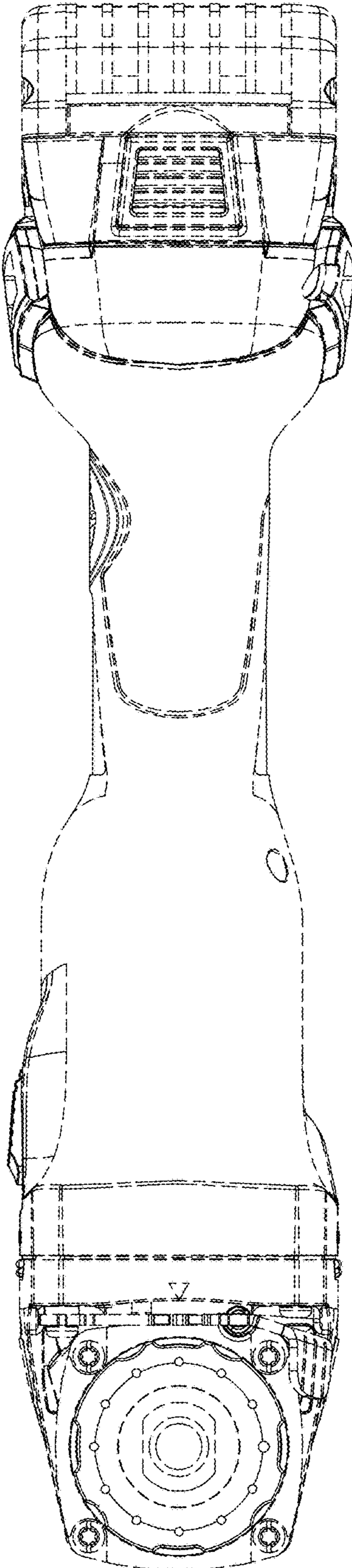

FIG. 17