



US00D824958S

(12) **United States Design Patent** (10) **Patent No.:** **US D824,958 S**
Akamine (45) **Date of Patent:** **** Aug. 7, 2018**

(54) **INTERNAL-COMBUSTION ENGINE**

(71) Applicant: **Honda Motor Co., Ltd.**, Tokyo (JP)

(72) Inventor: **Yuko Akamine**, Wako (JP)

(73) Assignee: **HONDA MOTOR CO., LTD.**, Tokyo (JP)

(**) Term: **15 Years**

(21) Appl. No.: **29/571,097**

(22) Filed: **Jul. 14, 2016**

(30) **Foreign Application Priority Data**

Jan. 15, 2016 (JP) 2016-000670

(51) **LOC (11) Cl.** **15-01**

(52) **U.S. Cl.**
USPC **D15/5**

(58) **Field of Classification Search**

USPC D15/1-6

CPC F01P 5/02; F01P 1/02; F02M 35/1017;

F02M 35/024; F02B 75/007

See application file for complete search history.

(56) **References Cited**

U.S. PATENT DOCUMENTS

D282,071 S * 1/1986 Nakamura D15/1
4,813,385 A * 3/1989 Yamaguchi B01D 46/0024

123/2

D515,589 S * 2/2006 Lin D15/1

D516,580 S * 3/2006 Li D15/1

D529,046 S * 9/2006 Maeda D15/1

D529,514 S * 10/2006 Maeda D15/5

D552,128 S * 10/2007 Li D15/1

D576,638 S * 9/2008 Busschaert D15/1

D579,026 S * 10/2008 Busschaert D15/1

D595,737 S * 7/2009 Neeley D15/1

(Continued)

Primary Examiner — T. Chase Nelson

Assistant Examiner — Ania Aman

(74) *Attorney, Agent, or Firm* — Westerman, Hattori,
Daniels & Adrian, LLP

(57) **CLAIM**

The ornamental design for an internal-combustion engine, as shown and described.

DESCRIPTION

FIG. 1 is a front-right perspective view of an internal-combustion engine with non-claimed environmental structure shown in dashed lines;

FIG. 2 is a back-left perspective view thereof;

FIG. 3 is a front-left perspective view thereof;

FIG. 4 is a back-right perspective view thereof;

FIG. 5 is a front elevation view thereof;

FIG. 6 is a top plan view thereof;

FIG. 7 is a bottom plan thereof;

FIG. 8 is a right side elevation view thereof;

FIG. 9 is a left side elevation view thereof;

FIG. 10 is a back-right auxiliary view, free of non-claimed environmental structure, of the internal-combustion engine;

FIG. 11 is a front elevation auxiliary view of the internal-combustion engine;

FIG. 12 is a rear elevation auxiliary view of the internal-combustion engine;

FIG. 13 is a top plan auxiliary view of the internal-combustion engine;

FIG. 14 is a bottom plan auxiliary view of the internal-combustion engine;

FIG. 15 is a right side auxiliary view of the internal-combustion engine; and,

FIG. 16 is a left side auxiliary view of the internal-combustion engine.

The broken lines in the drawings illustrate portions of the internal-combustion engine that forms no part of the claimed design.

1 Claim, 16 Drawing Sheets

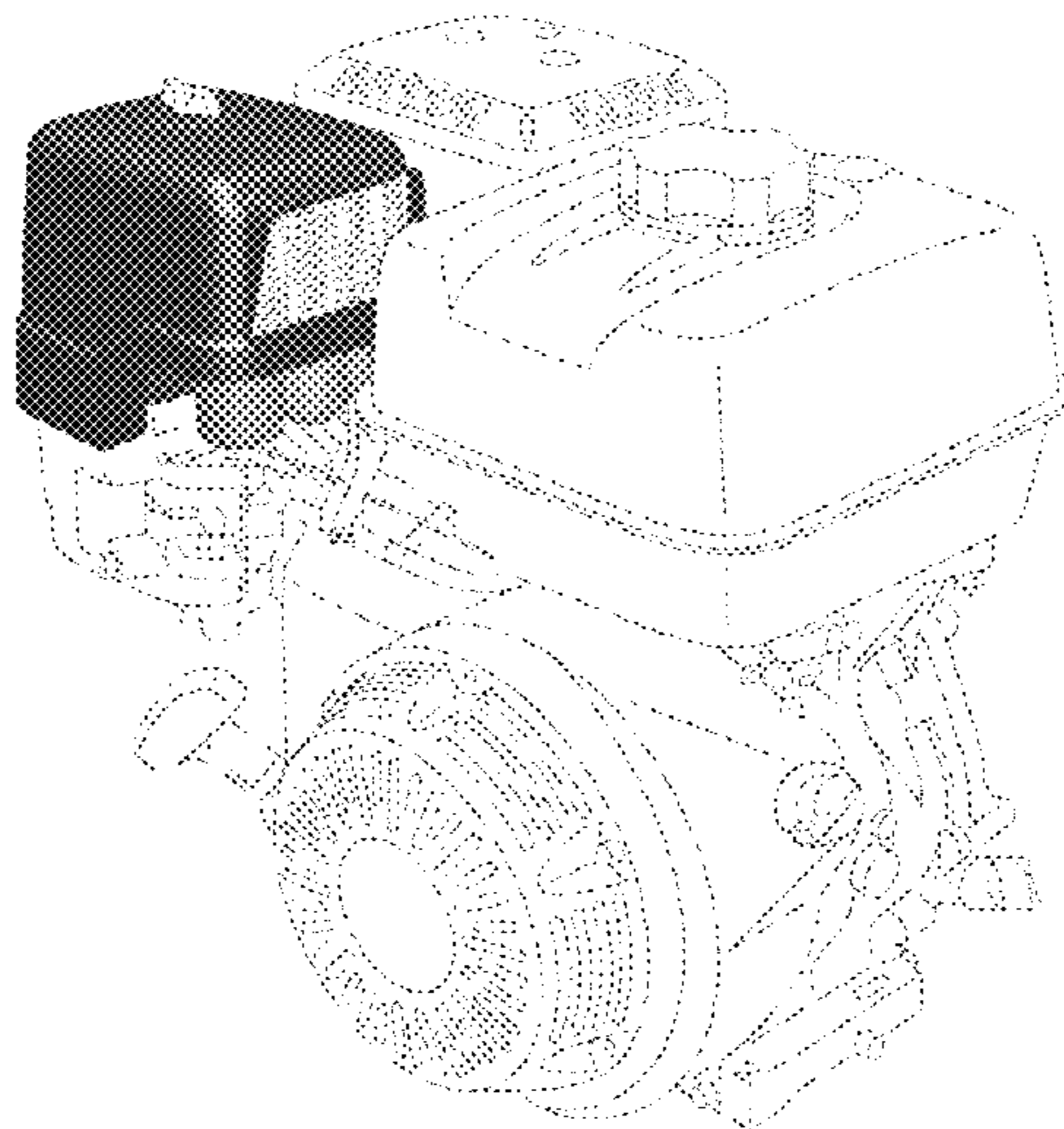

(56)

References Cited

U.S. PATENT DOCUMENTS

7,993,424 B2 * 8/2011 Takeuchi F02M 35/024
123/198 E
8,025,707 B2 * 9/2011 Furuya B01D 46/06
123/198 E
D689,522 S * 9/2013 Johnson D15/1
D751,118 S * 3/2016 Suzuki D15/1
D771,143 S * 11/2016 Yu D15/1
2003/0057016 A1 * 3/2003 Schlossarczyk F01N 1/089
181/283
2009/0126678 A1 * 5/2009 Takeuchi F02M 35/1017
123/198 E
2009/0183709 A1 * 7/2009 Kubo F02M 35/024
123/198 E

* cited by examiner

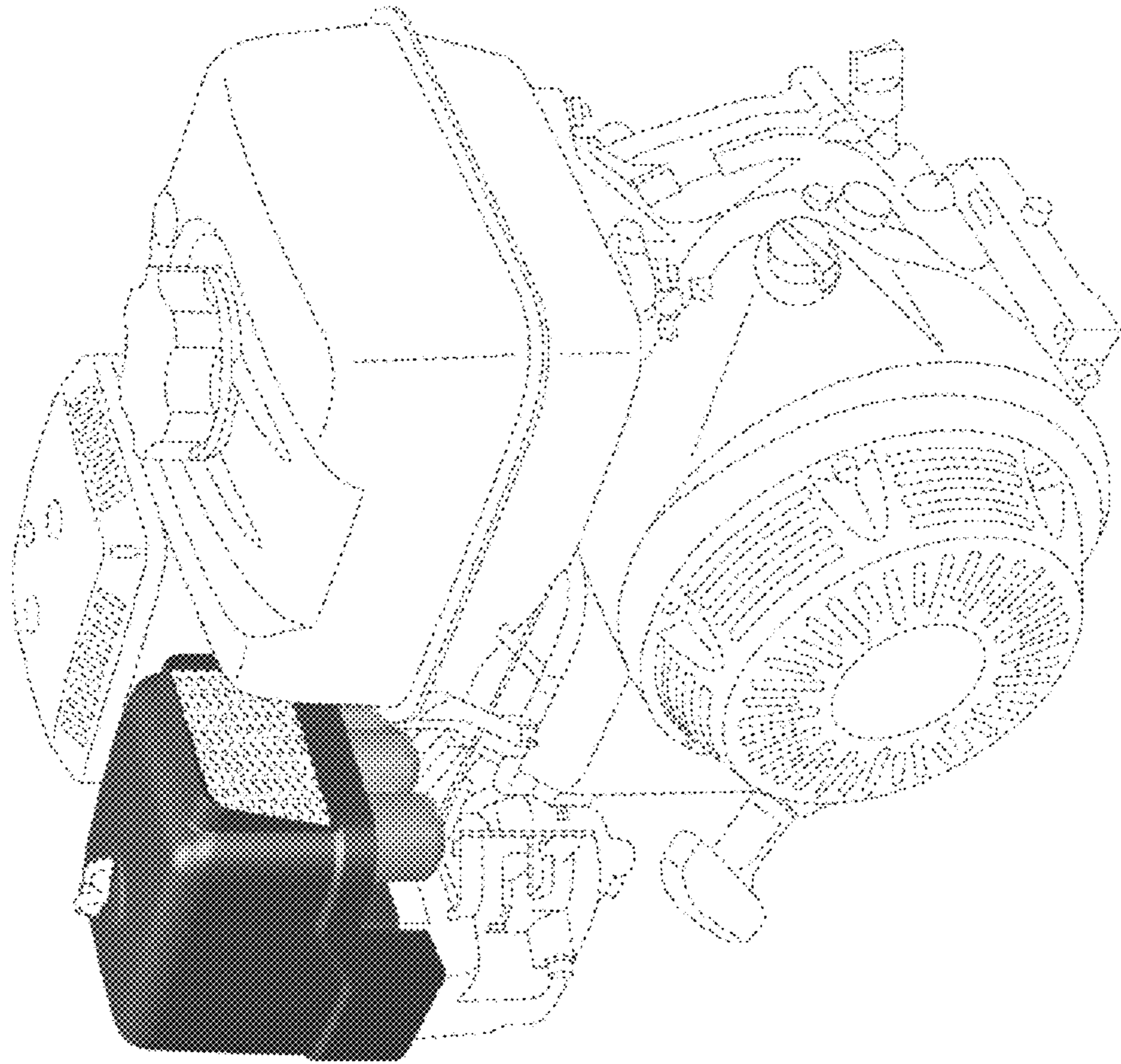

Fig. 1

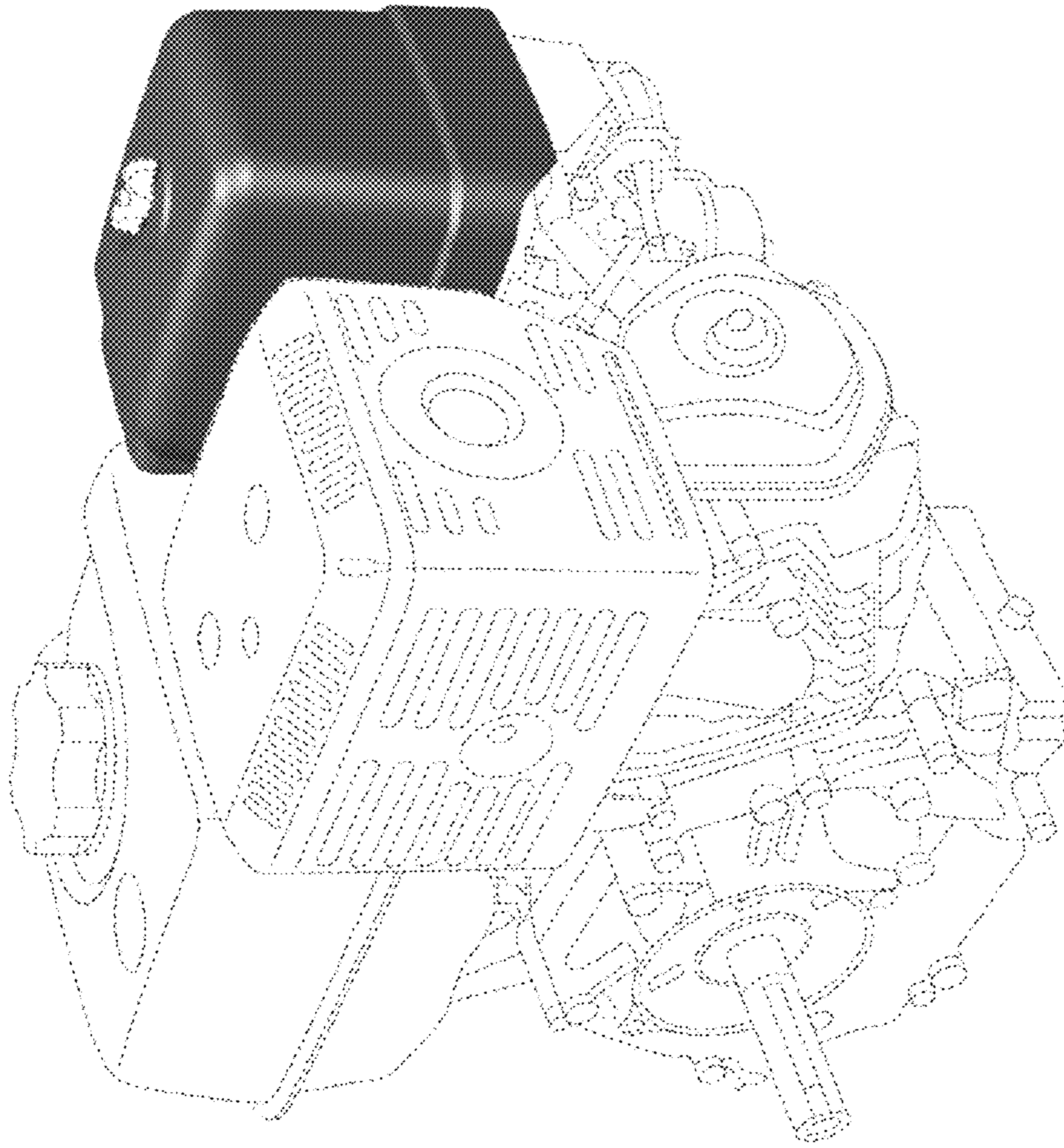

Fig. 2

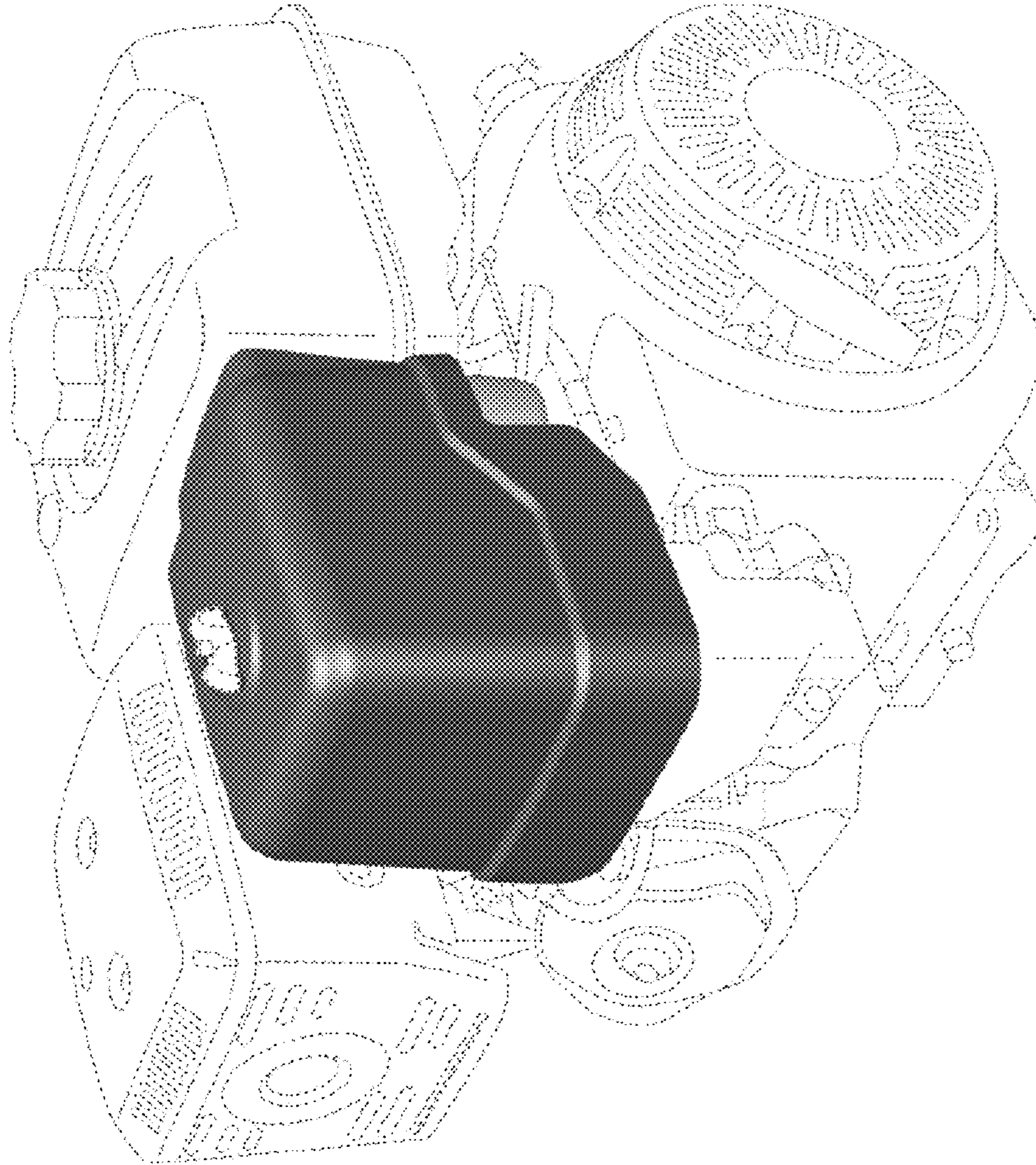

Fig. 3

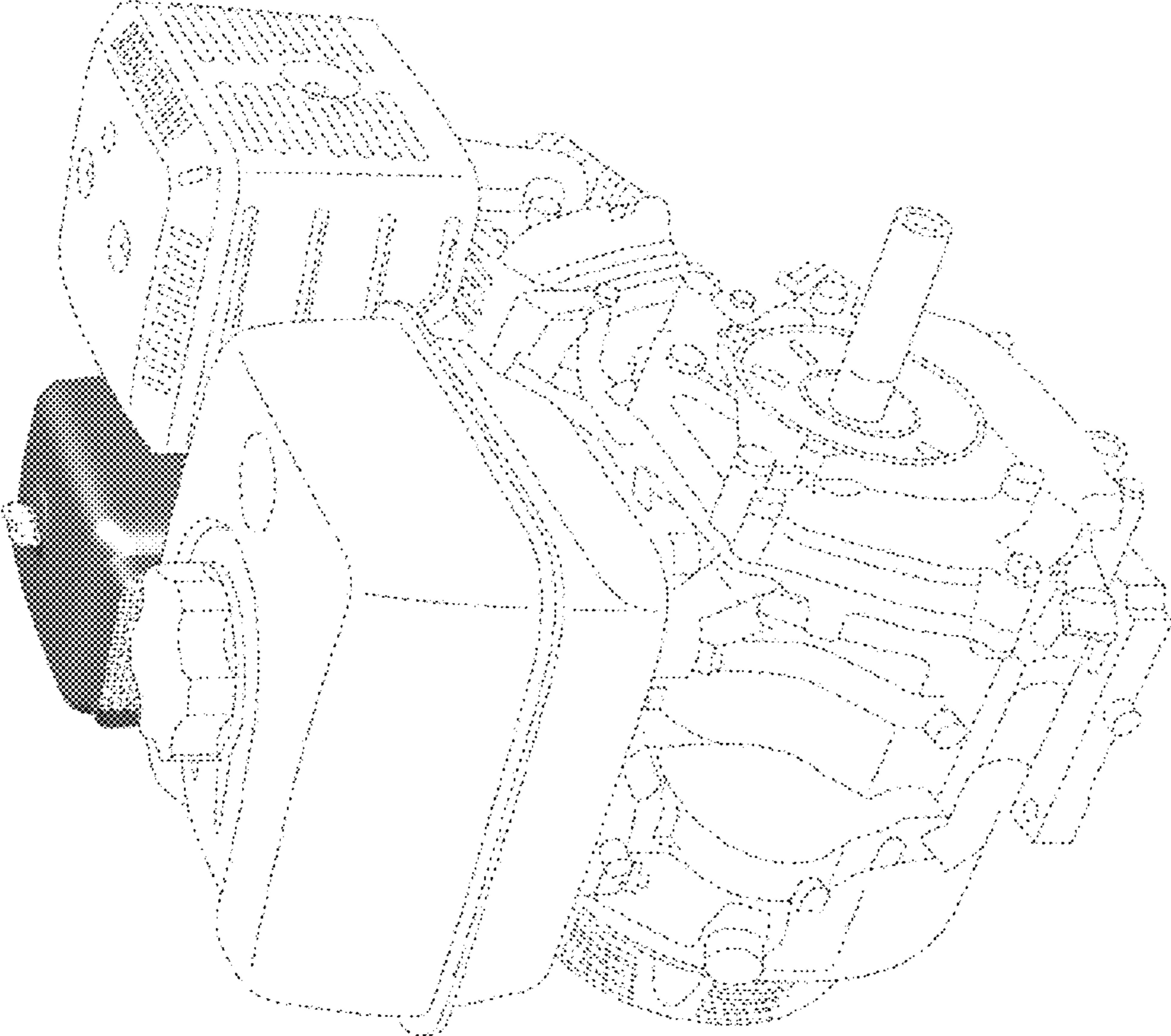

Fig. 4

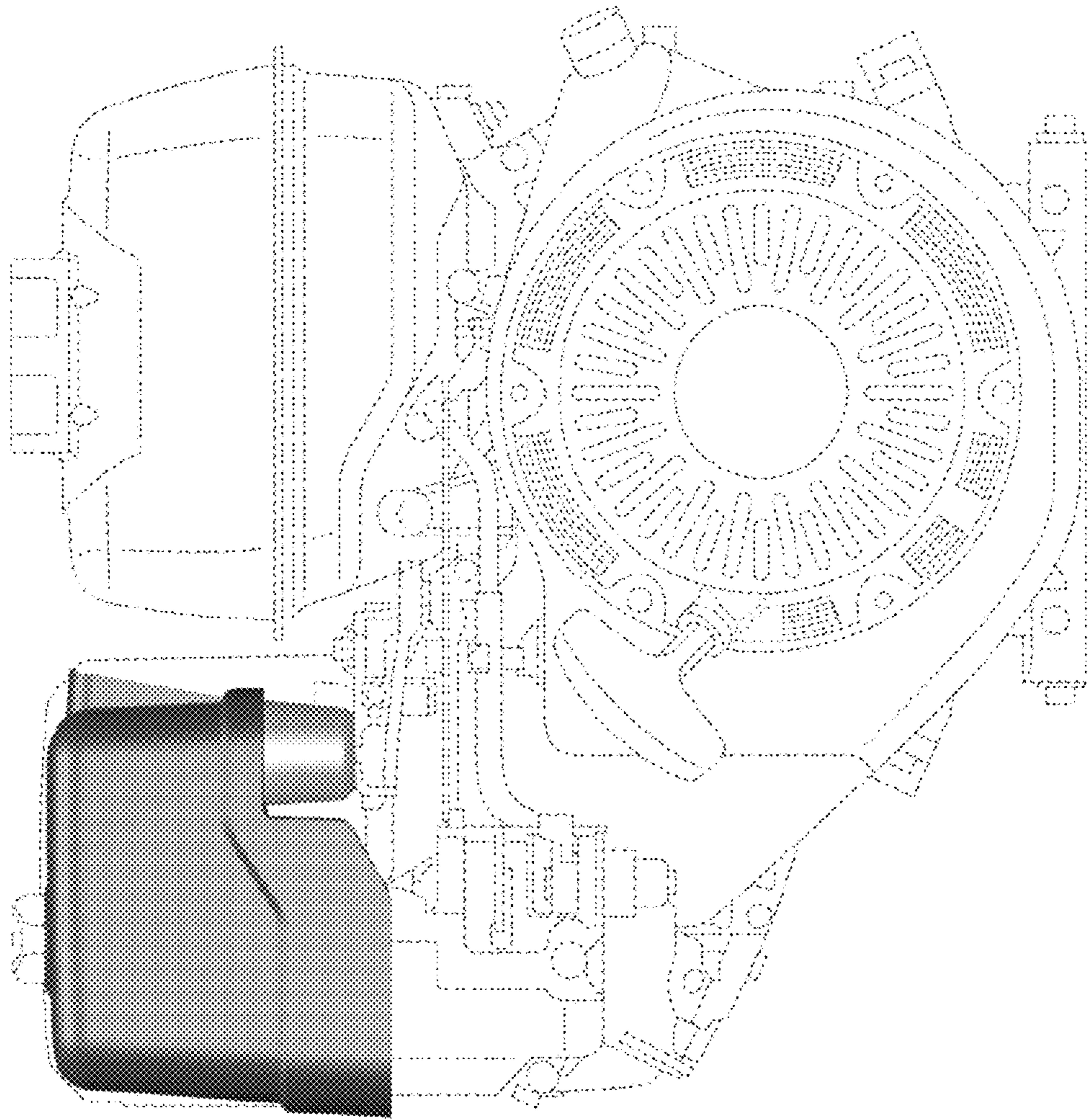

Fig. 5

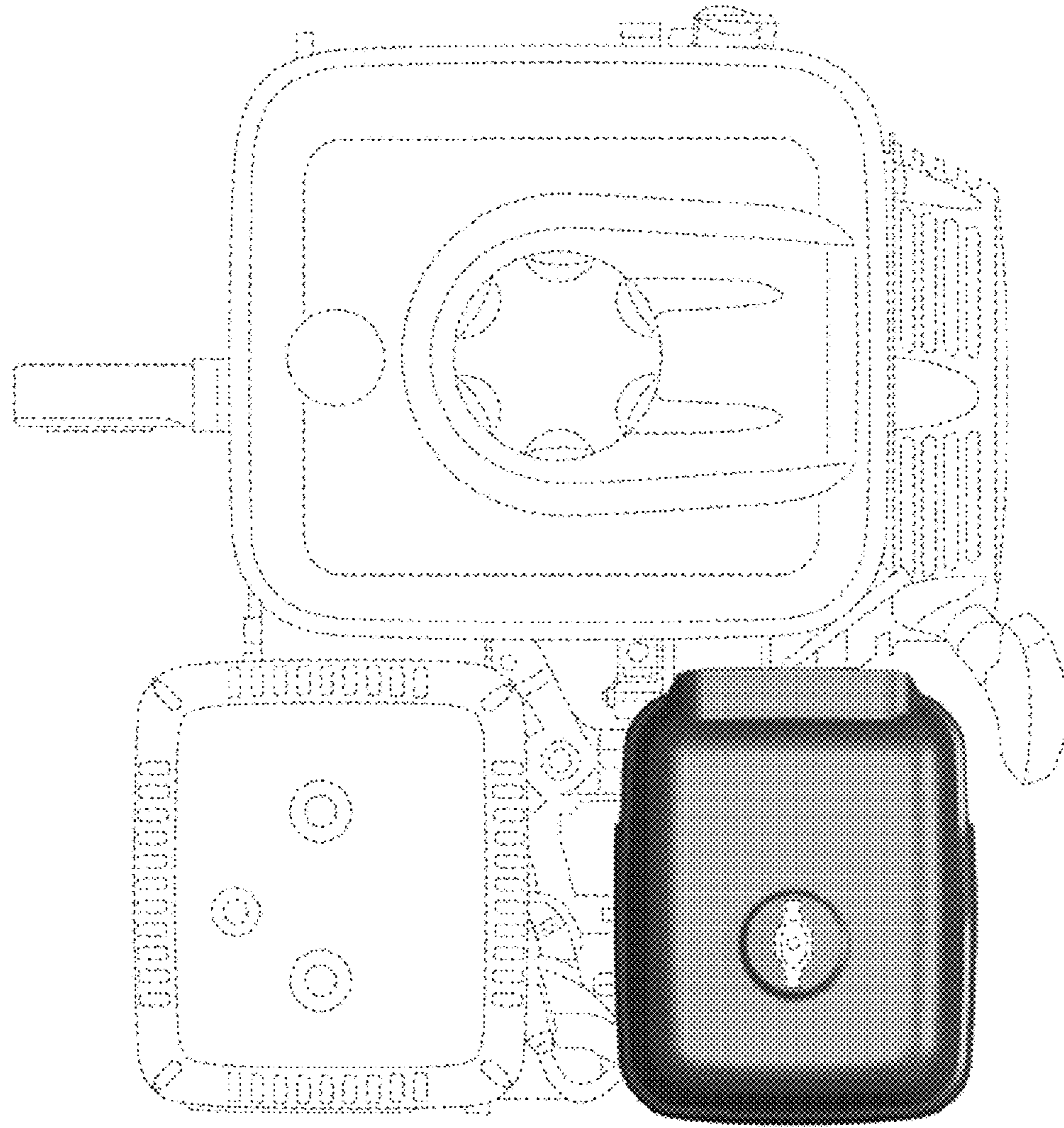

Fig. 6

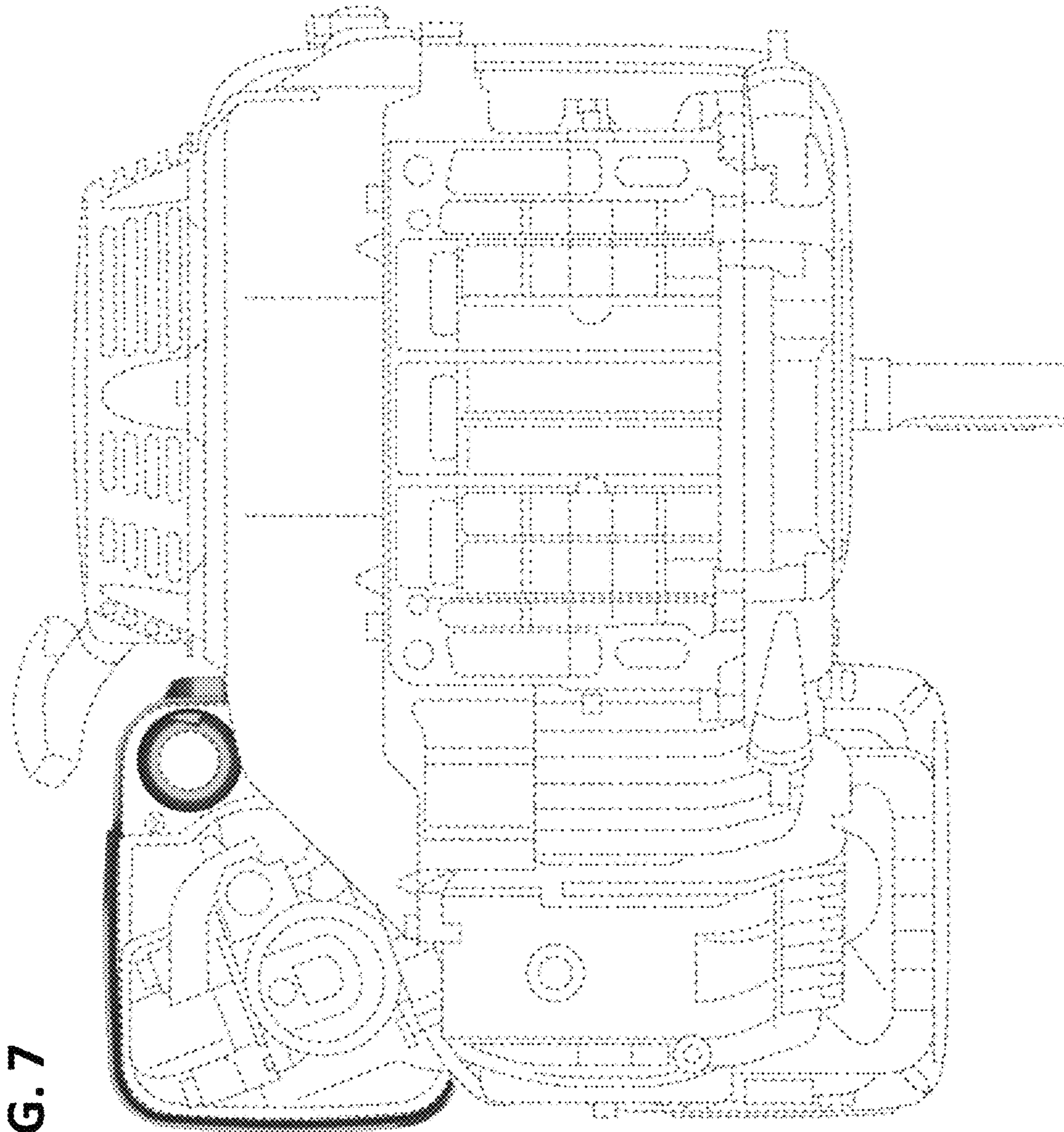

FIG. 7

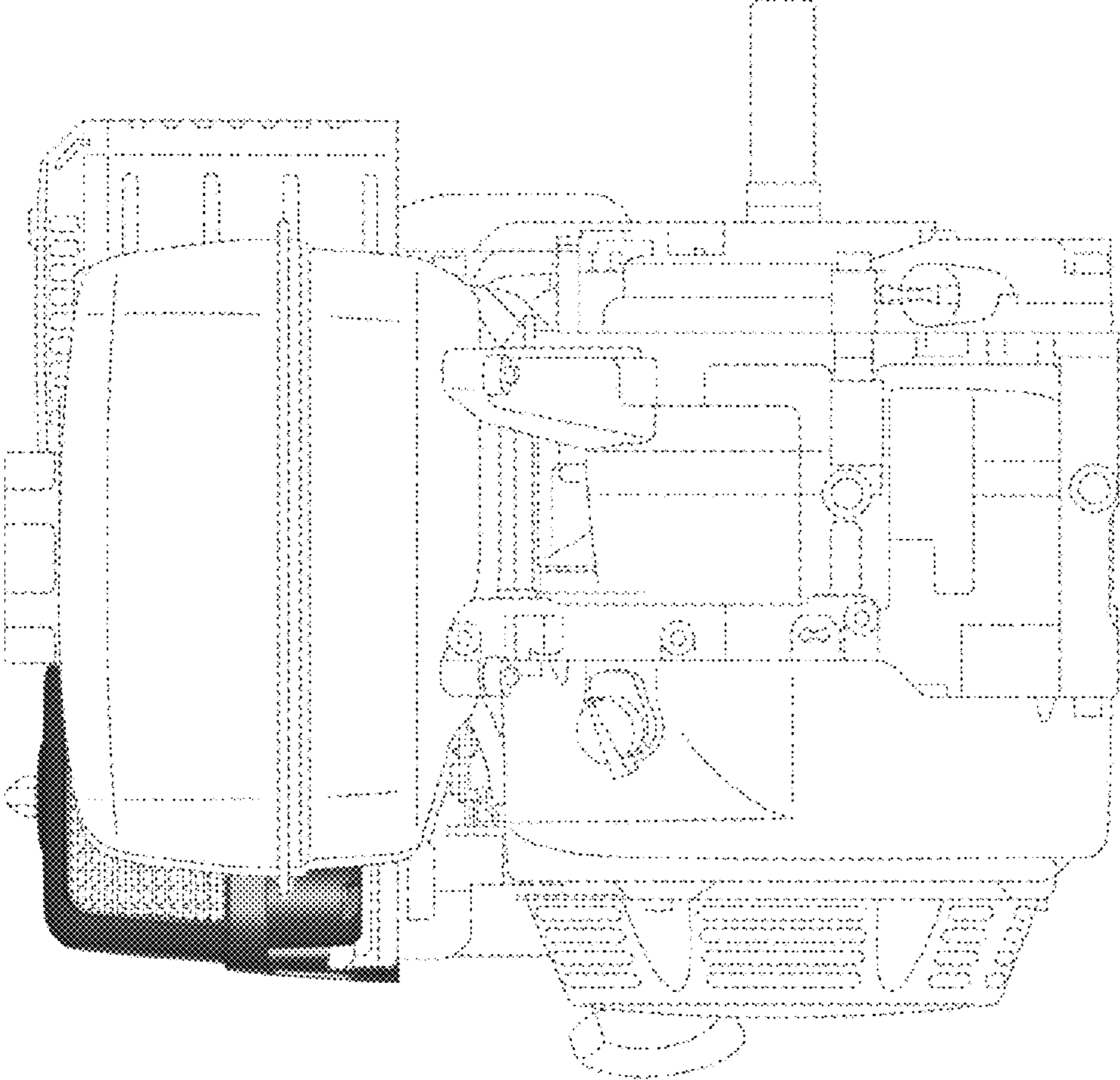

Fig. 8

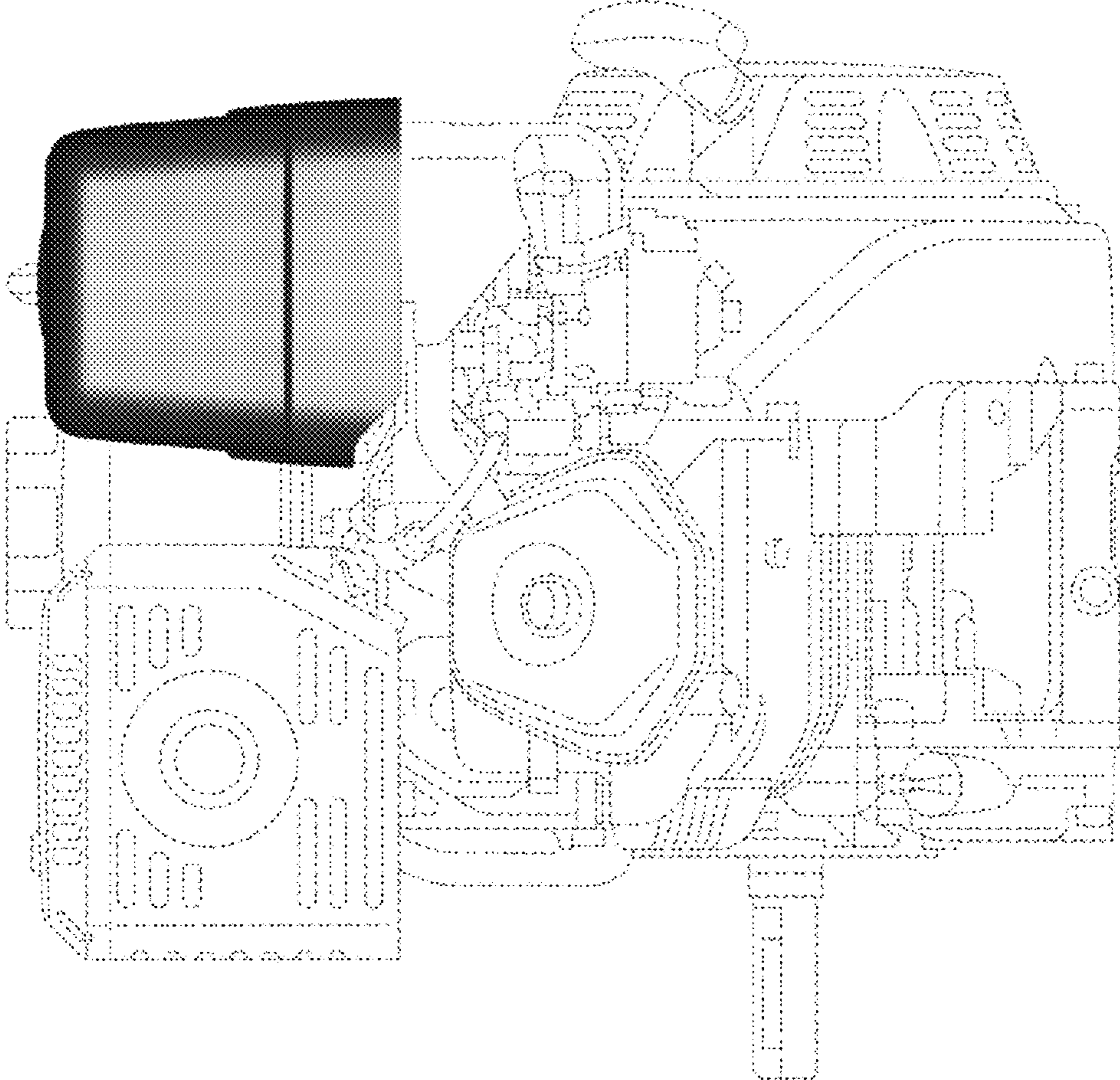

Fig. 9

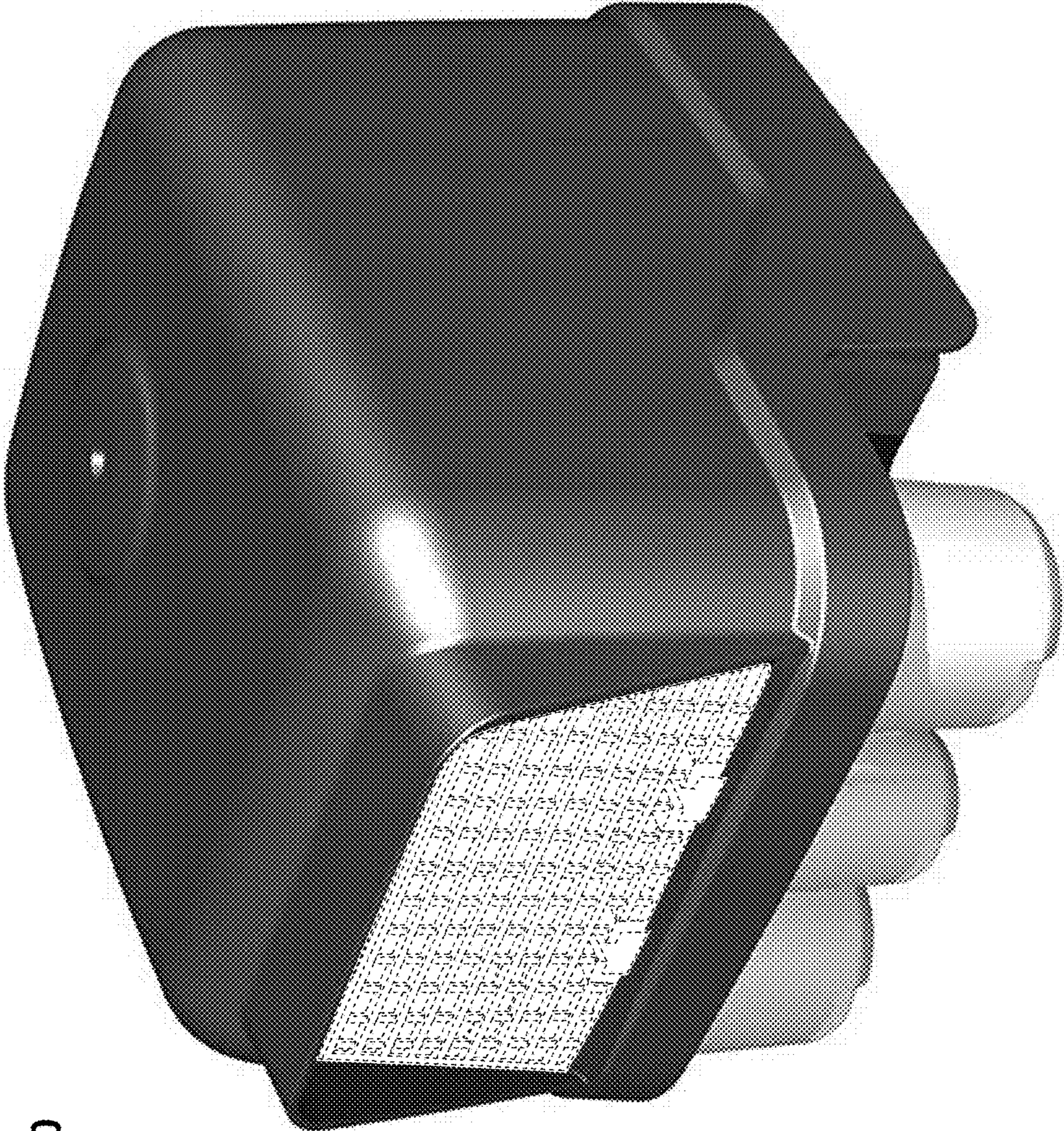

Fig. 10

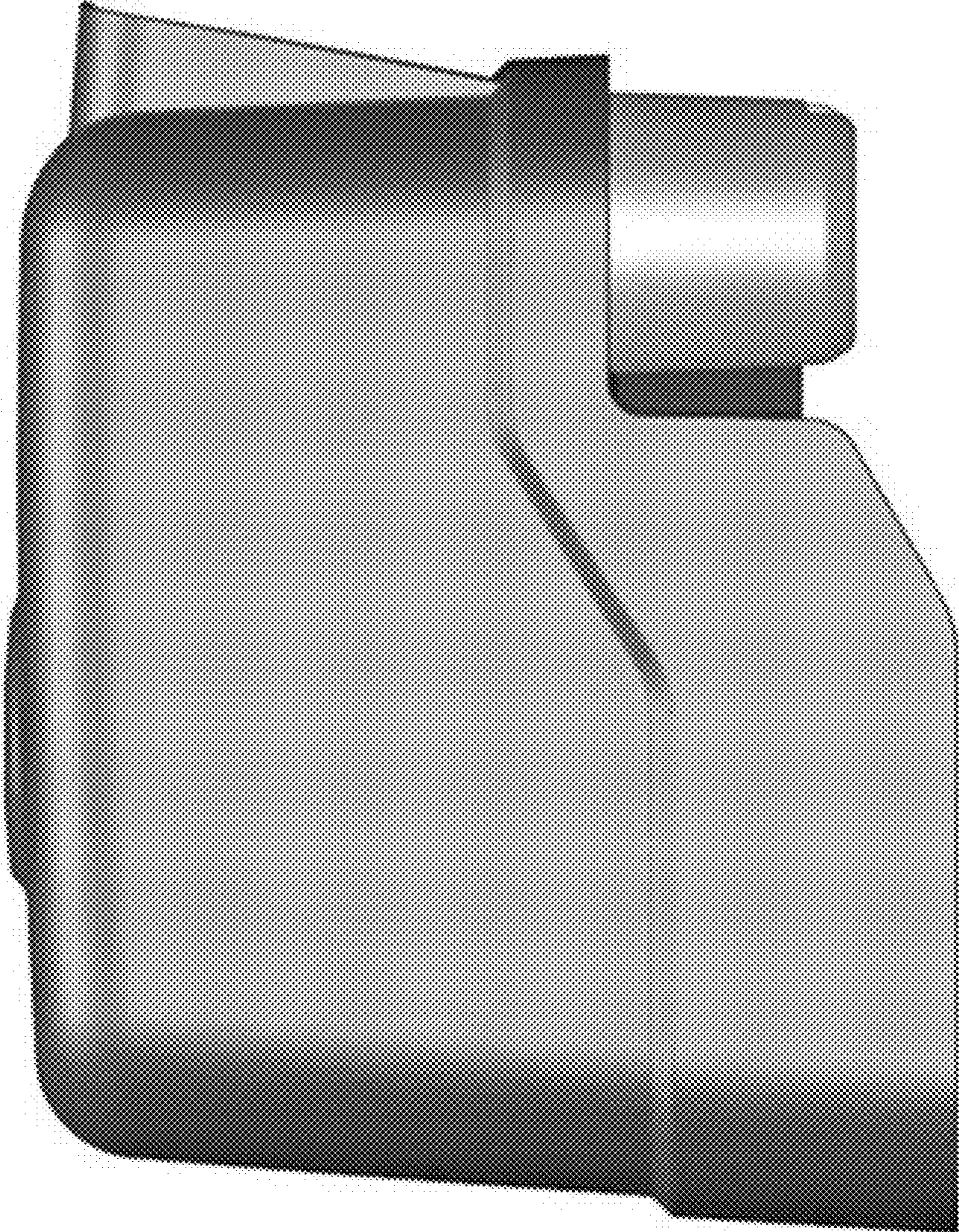

Fig. 11

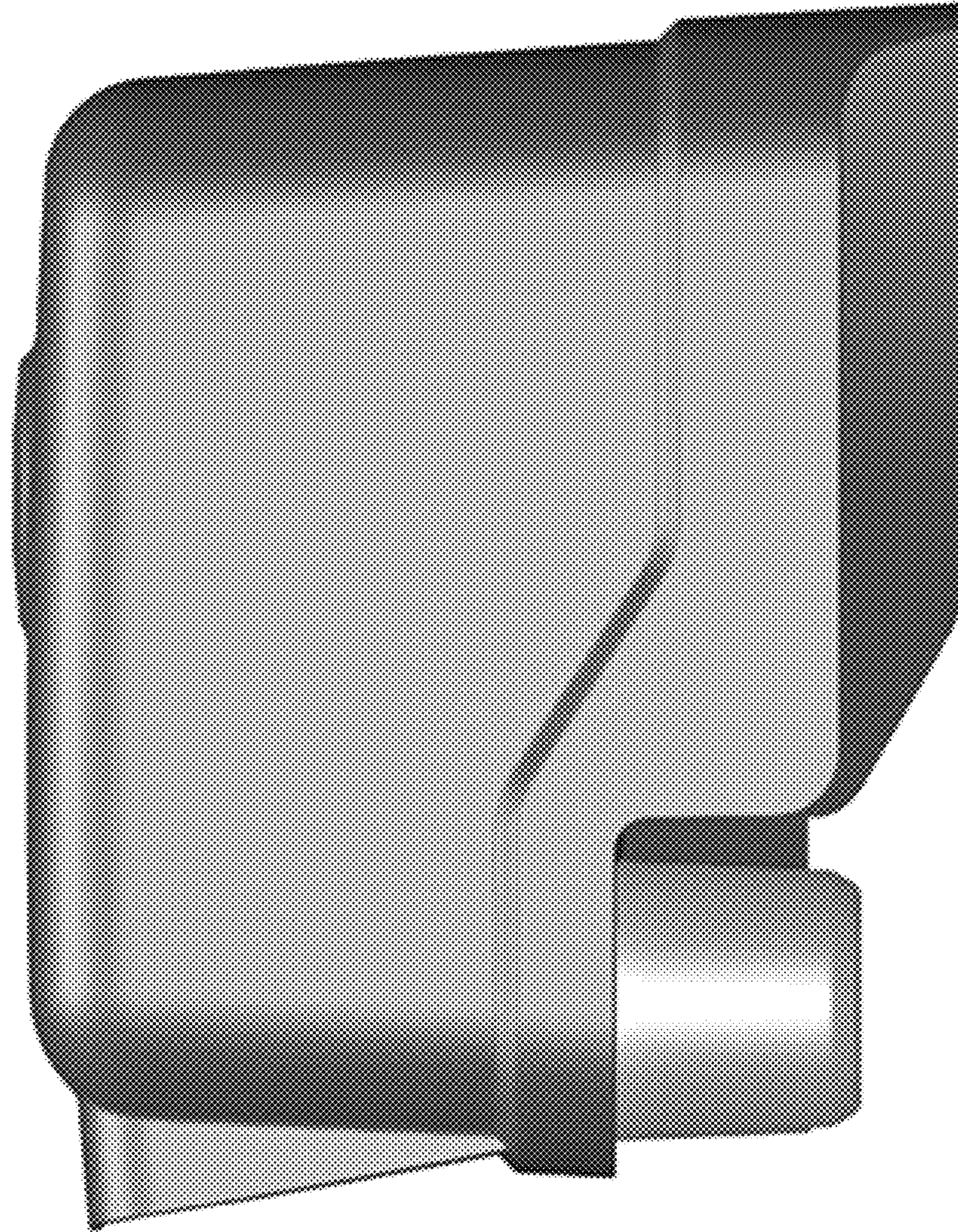

Fig. 12



Fig. 13

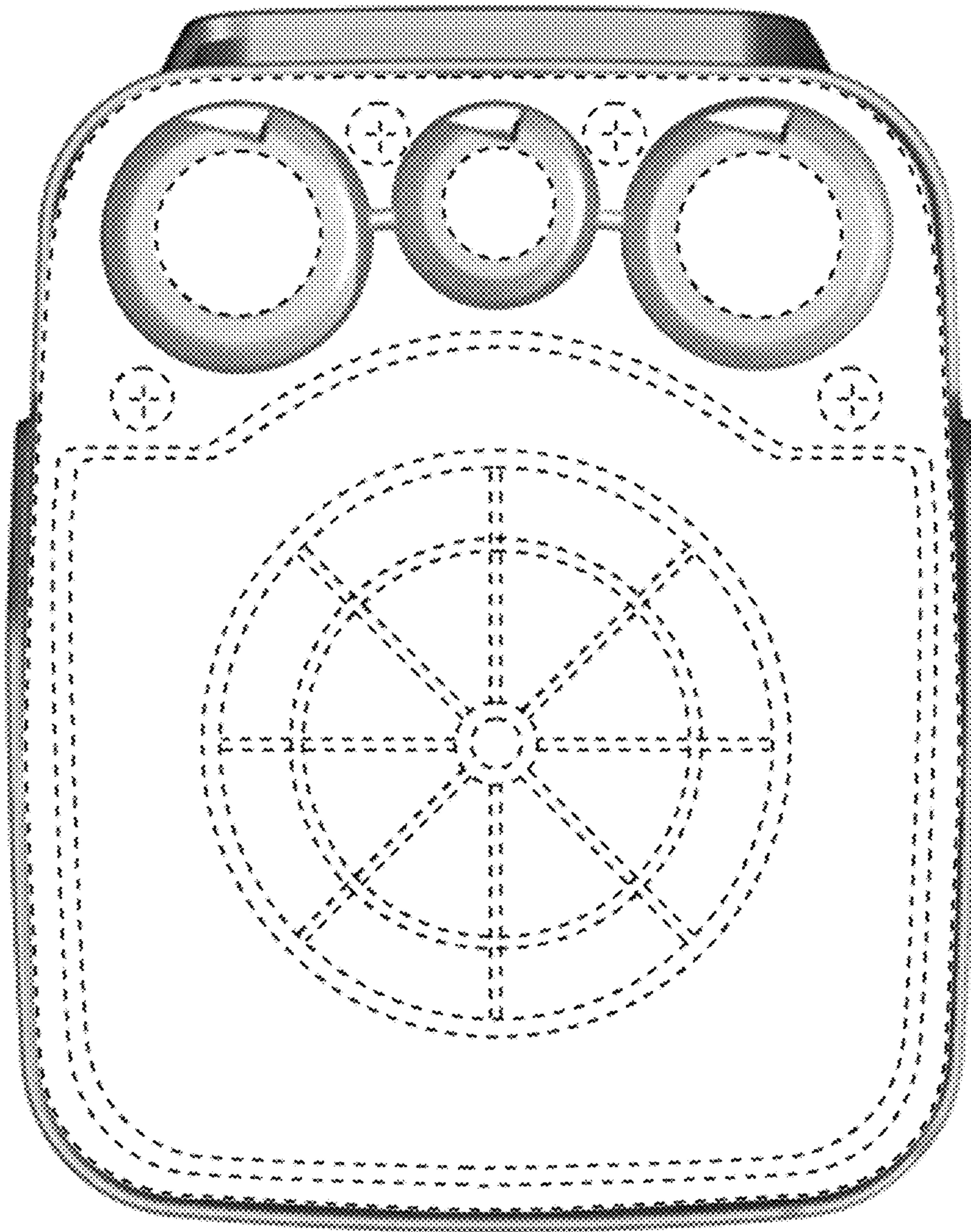

FIG. 14



Fig. 15

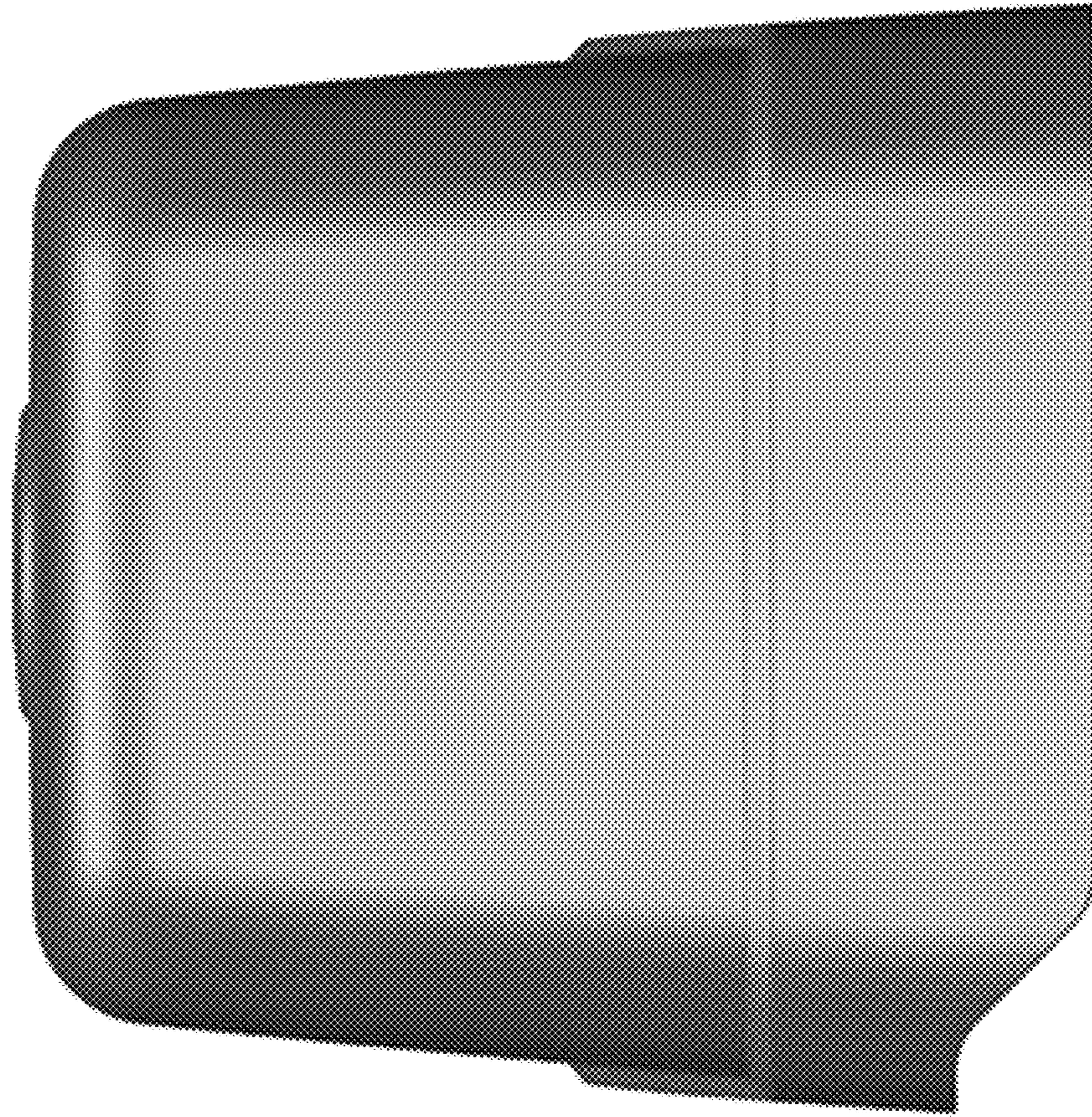

Fig. 16