



US00D824601S

(12) **United States Design Patent**  
**Fallgatter**

(10) **Patent No.:** **US D824,601 S**

(45) **Date of Patent:** **\*\* Jul. 31, 2018**

(54) **KINESIOLOGICAL MOBILITY ASSIST  
DEVICE**

(71) Applicant: **James Calvin Fallgatter**, Ridgecrest,  
CA (US)

(72) Inventor: **James Calvin Fallgatter**, Ridgecrest,  
CA (US)

(\*\*) Term: **15 Years**

(21) Appl. No.: **29/615,966**

(22) Filed: **Sep. 1, 2017**

(51) **LOC (11) Cl.** ..... **29-02**

(52) **U.S. Cl.**  
USPC ..... **D29/124**

(58) **Field of Classification Search**  
USPC ..... D29/124; D12/128-133; 5/625-629,  
5/636, 484, 499, 691, 891 T; 128/869,  
128/870, 845; D24/190, 191; 296/65.03,  
296/65.04; 280/15, 18, 19, 158; 441/80,  
441/82, 88  
CPC ..... A61G 1/00; A61G 1/01; B63C 9/04  
See application file for complete search history.

(56) **References Cited**

**U.S. PATENT DOCUMENTS**

5,709,649 A \* 1/1998 Chitwood ..... A61F 5/04  
128/845  
5,888,111 A \* 3/1999 Walker ..... B63C 9/04  
114/345

D419,495 S \* 1/2000 Muhanna ..... 5/706  
7,137,961 B2 \* 11/2006 Hurd ..... A61F 5/01  
602/32  
D592,812 S \* 5/2009 Hughes ..... D29/124  
7,607,185 B1 \* 10/2009 Minson ..... A47C 27/081  
5/655  
7,900,299 B2 \* 3/2011 Weedling ..... A61G 7/103  
5/625  
8,549,683 B2 \* 10/2013 Ratner ..... A61G 13/121  
128/845  
8,782,833 B2 \* 7/2014 Beurguet ..... A61G 1/01  
128/870  
8,850,642 B2 \* 10/2014 Rasmussen ..... A47G 9/1027  
297/398

\* cited by examiner

*Primary Examiner* — Randall H Gholson

(57) **CLAIM**

The ornamental design for an kinesiological mobility assist device, as shown.

**DESCRIPTION**

FIG. 1 is a perspective view of an kinesiological mobility assist device showing my new design;  
FIG. 2 is a side elevational view thereof; the opposite side being a mirror image thereof;  
FIG. 3 is a front elevational view thereof;  
FIG. 4 is a back elevational view thereof;  
FIG. 5 is a top elevational view thereof; and,  
FIG. 6 is a bottom elevational view thereof.

**1 Claim, 6 Drawing Sheets**

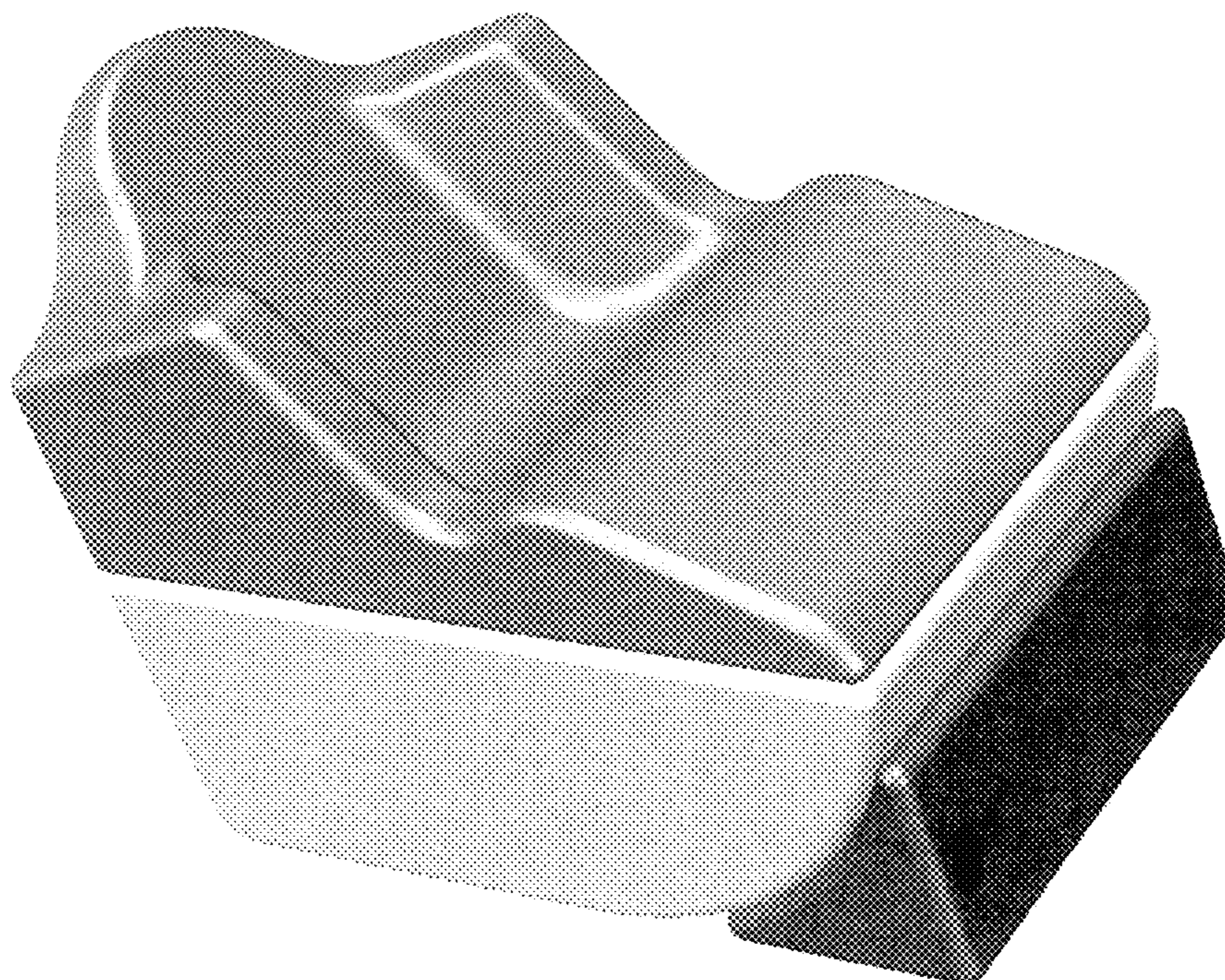

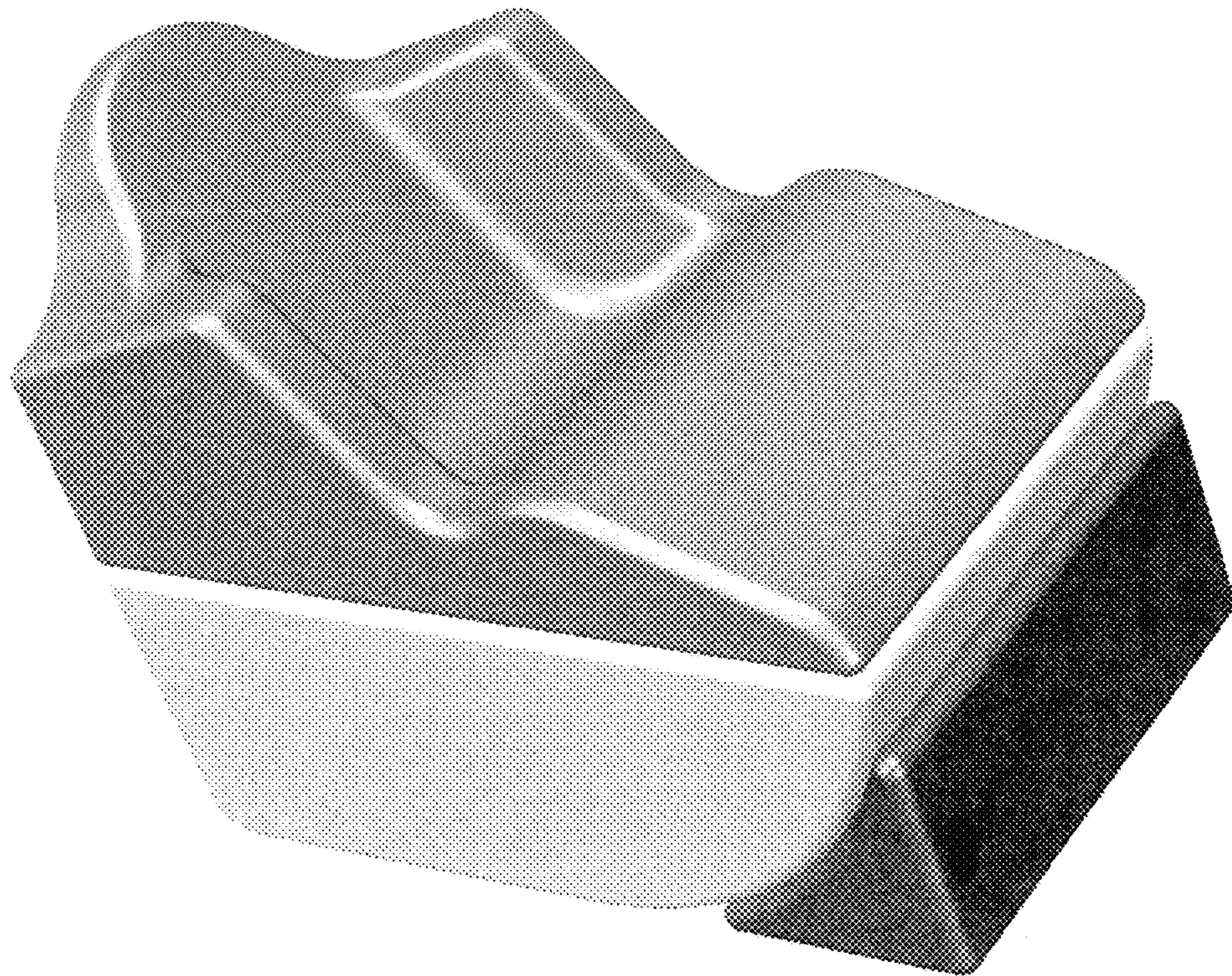

FIG. 1

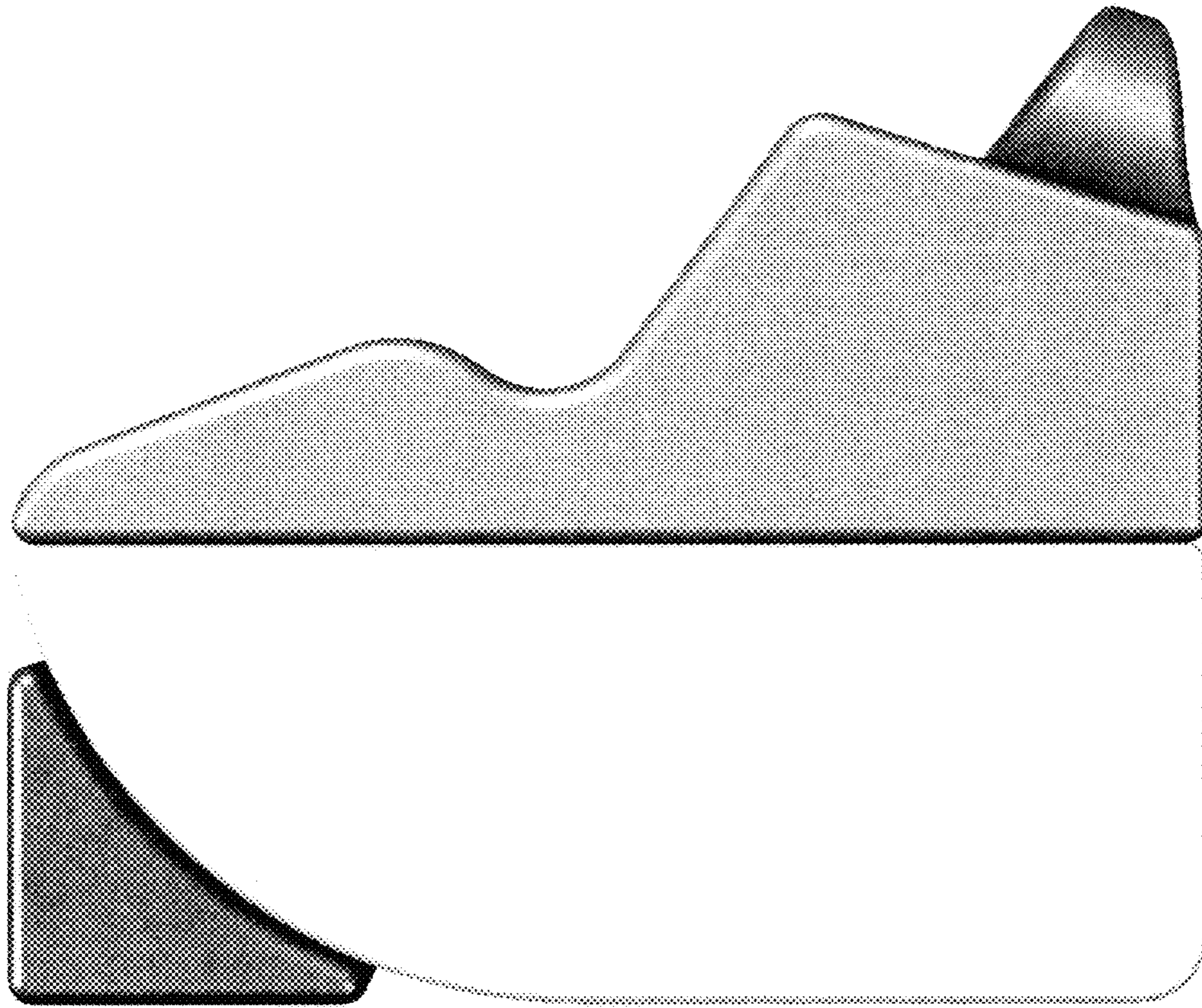

FIG. 2

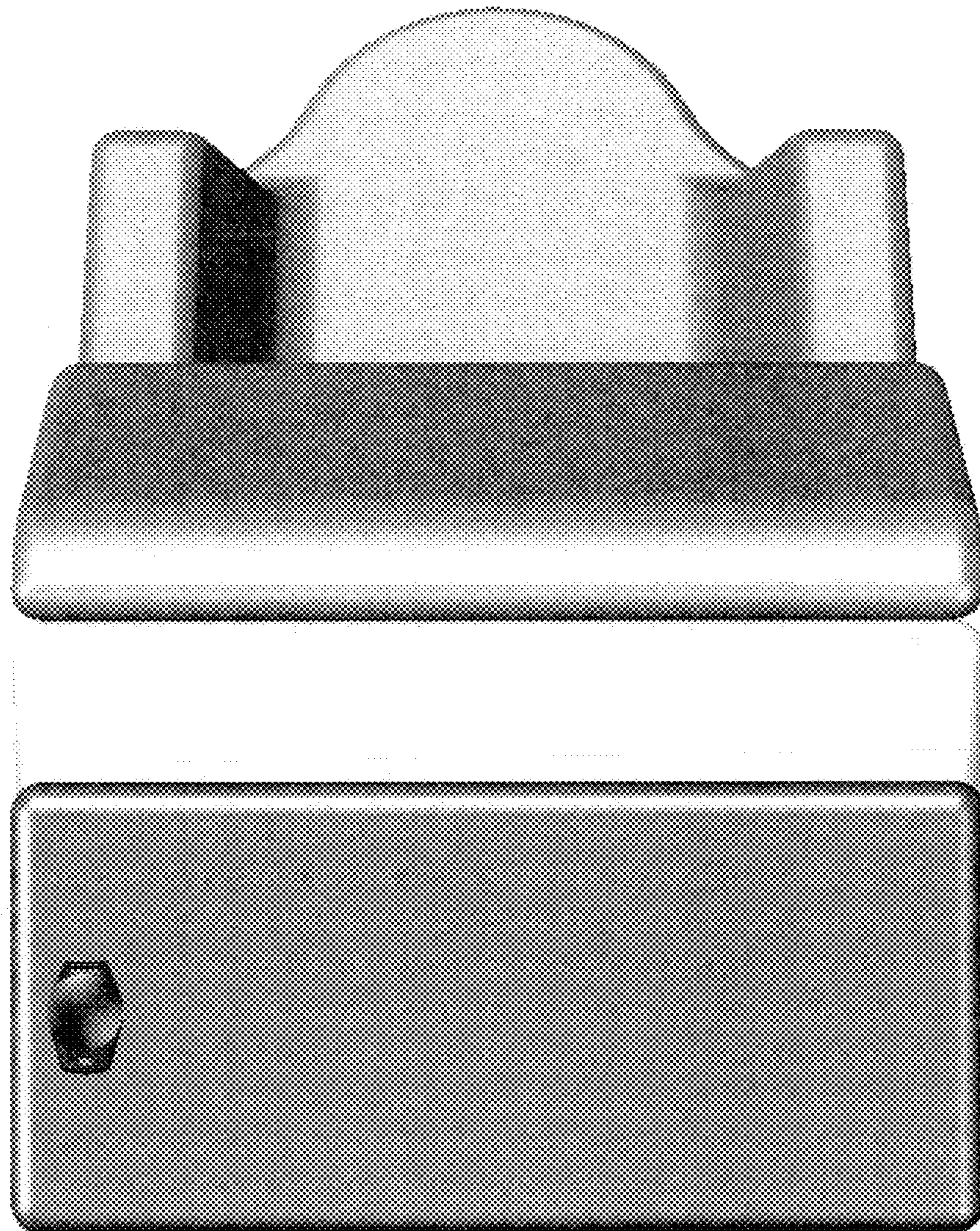

FIG. 3

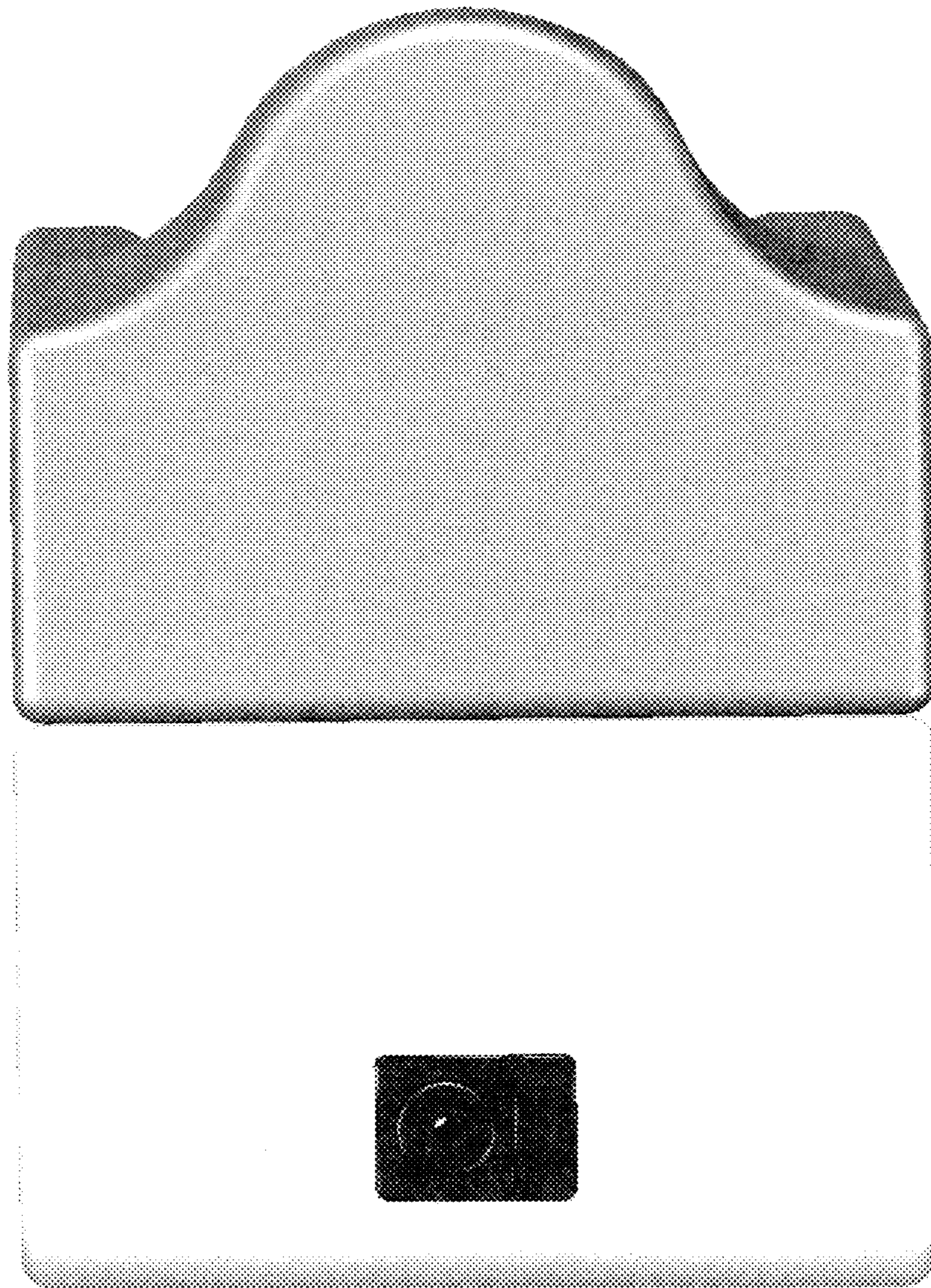

FIG. 4

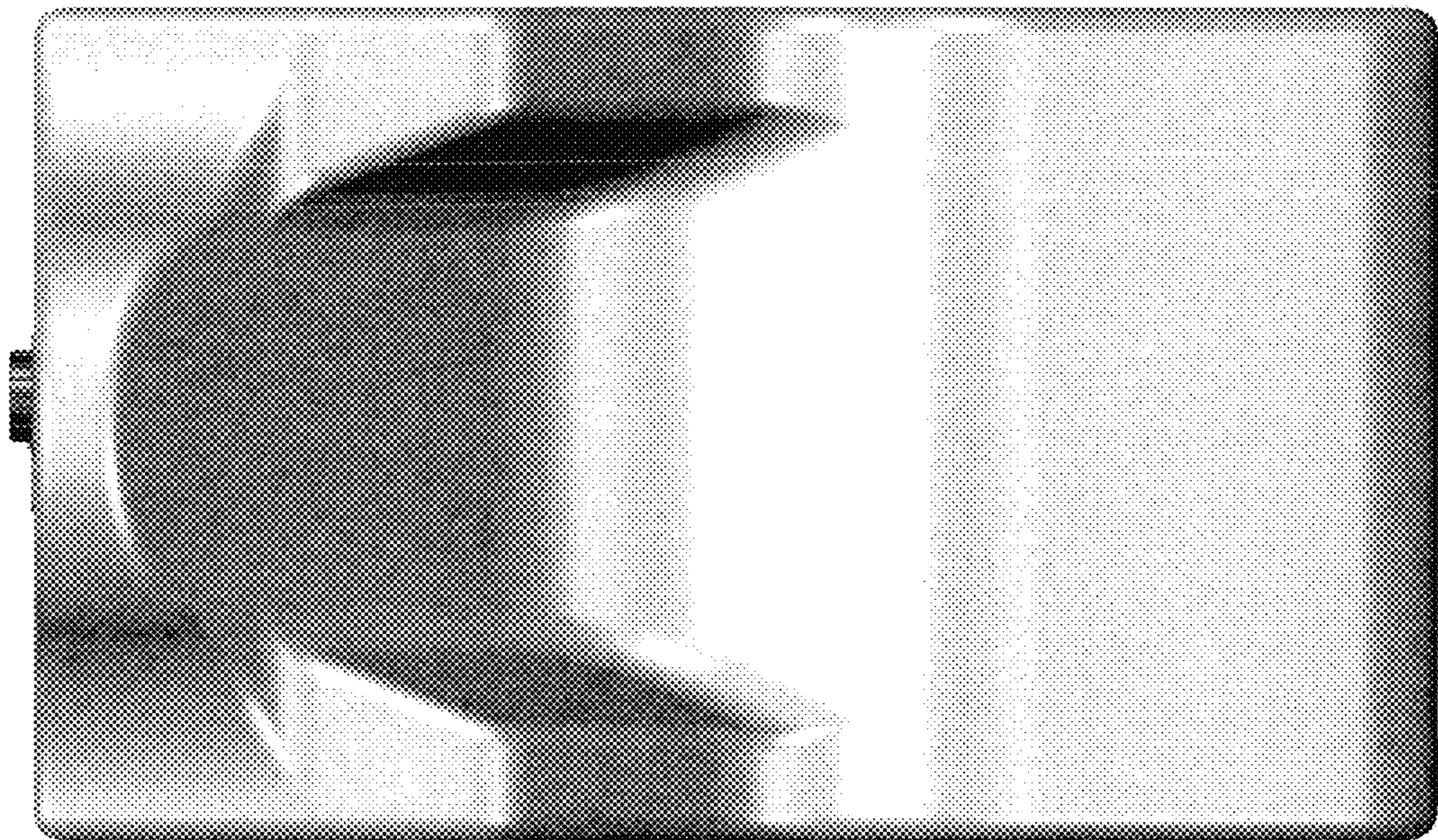

FIG. 5

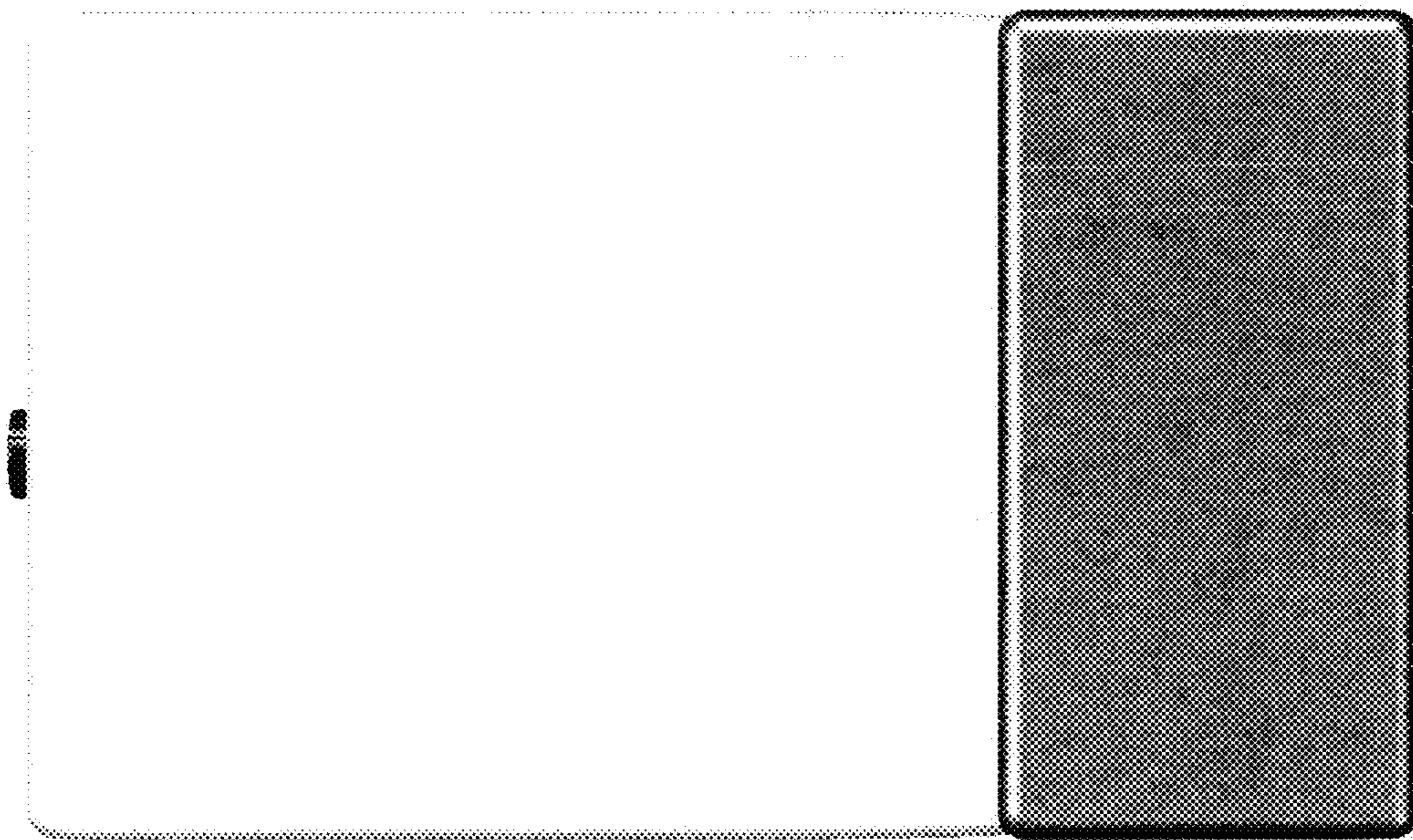

FIG. 6