



US00D823896S

(12) **United States Design Patent**
Yamamoto et al.

(10) **Patent No.:** **US D823,896 S**
(45) **Date of Patent:** **** Jul. 24, 2018**

- (54) **MULTIPURPOSE ENGINE**
- (71) Applicants: **Masanobu Yamamoto**, Shizuoka-ken (JP); **Kiyoshi Hashimoto**, Shizuoka-ken (JP)
- (72) Inventors: **Masanobu Yamamoto**, Shizuoka-ken (JP); **Kiyoshi Hashimoto**, Shizuoka-ken (JP)
- (73) Assignee: **YAMAHA MOTOR POWER PRODUCTS KABUSHIKI KAISHA** (JP)

D709,523	S	*	7/2014	Nonaka	D15/1
D751,118	S	*	3/2016	Suzuki	D15/1
2006/0266338	A1	*	11/2006	Kashima	B60K 15/03504
						123/519
2009/0199793	A1	*	8/2009	Sato	F01P 1/02
						123/41.62
2009/0230695	A1	*	9/2009	Yoshida	F02B 63/04
						290/1 A
2009/0302610	A1	*	12/2009	Kanai	F02B 63/04
						290/47
2012/0160194	A1	*	6/2012	Yano	F02F 1/34
						123/41.65
2012/0210704	A1	*	8/2012	Kawase	F01N 1/089
						60/320
2014/0338634	A1	*	11/2014	Mitchell	F02D 17/04
						123/332

(**) Term: **15 Years**

* cited by examiner

(21) Appl. No.: **29/589,188**

Primary Examiner — T. Chase Nelson

(22) Filed: **Dec. 29, 2016**

Assistant Examiner — Ania Aman

(30) **Foreign Application Priority Data**

(74) *Attorney, Agent, or Firm* — Ostrolenk Faber LLP

Jun. 29, 2016 (JP) 2016-013703

(51) **LOC (11) Cl.** **15-01**

(52) **U.S. Cl.**
USPC **D15/1**

(58) **Field of Classification Search**
USPC D15/1, 2, 3, 4, 5
CPC ... F01P 5/02; F01P 1/02; F02B 75/007; F02B 77/02; F02B 2700/03; F02B 75/16; F02B 63/00; F02B 63/02; F02F 1/34
See application file for complete search history.

(56) **References Cited**

U.S. PATENT DOCUMENTS

D634,333	S	*	3/2011	Johnson	D15/1
D689,522	S	*	9/2013	Johnson	D15/1
D695,317	S	*	12/2013	Yano	D15/1

(57) **CLAIM**

The ornamental design for a multipurpose engine, as shown and described.

DESCRIPTION

FIG. 1 is a top, front, perspective view of a multipurpose engine showing my new design;
FIG. 2 is a top rear perspective view thereof;
FIG. 3 is a front view thereof;
FIG. 4 is a rear view thereof;
FIG. 5 is a left side view thereof;
FIG. 6 is a right side view thereof;
FIG. 7 is a top view thereof; and,
FIG. 8 is a bottom view thereof.
The broken lines in the drawings illustrate environmental material that forms no part of the claimed design.

1 Claim, 8 Drawing Sheets

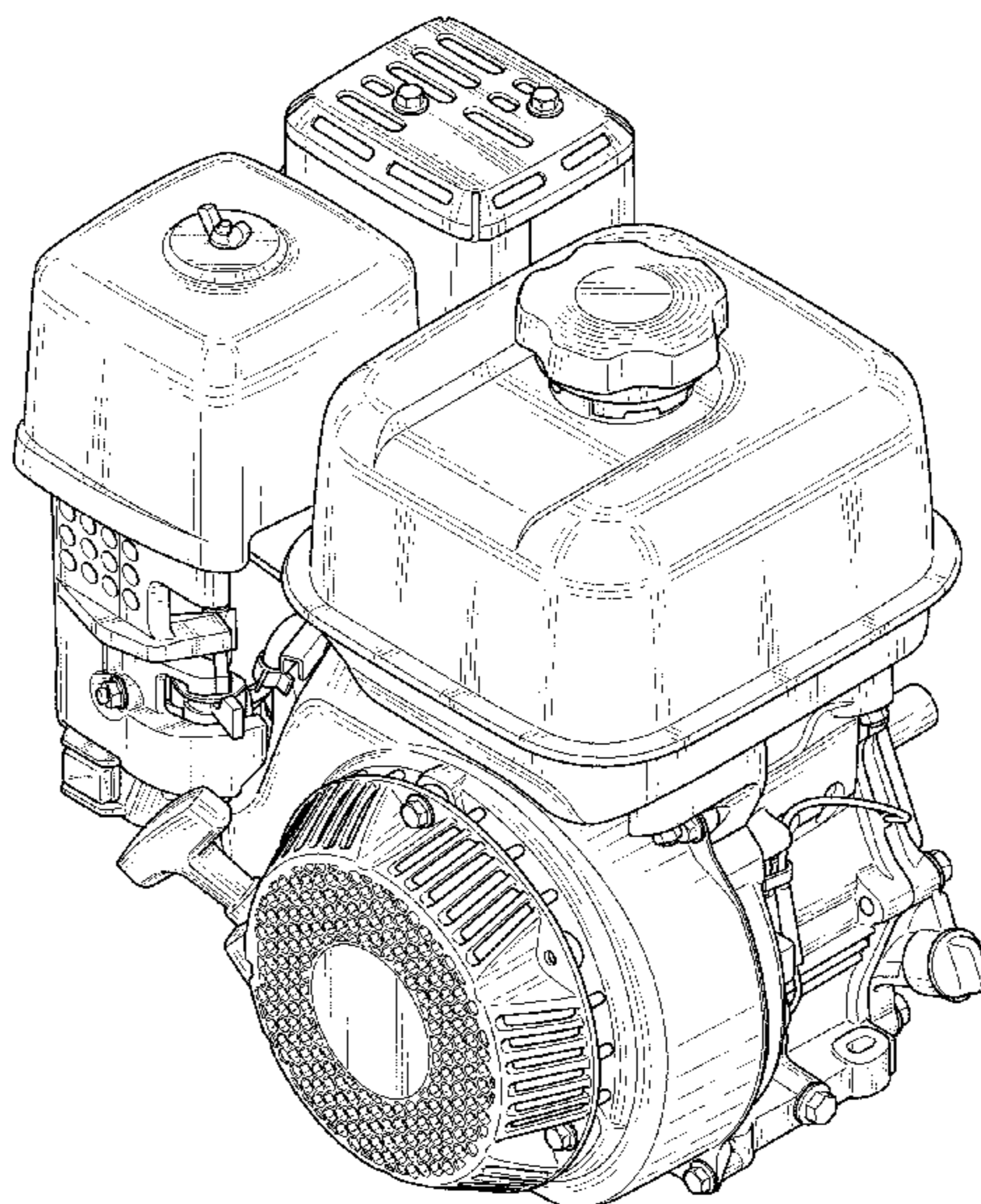

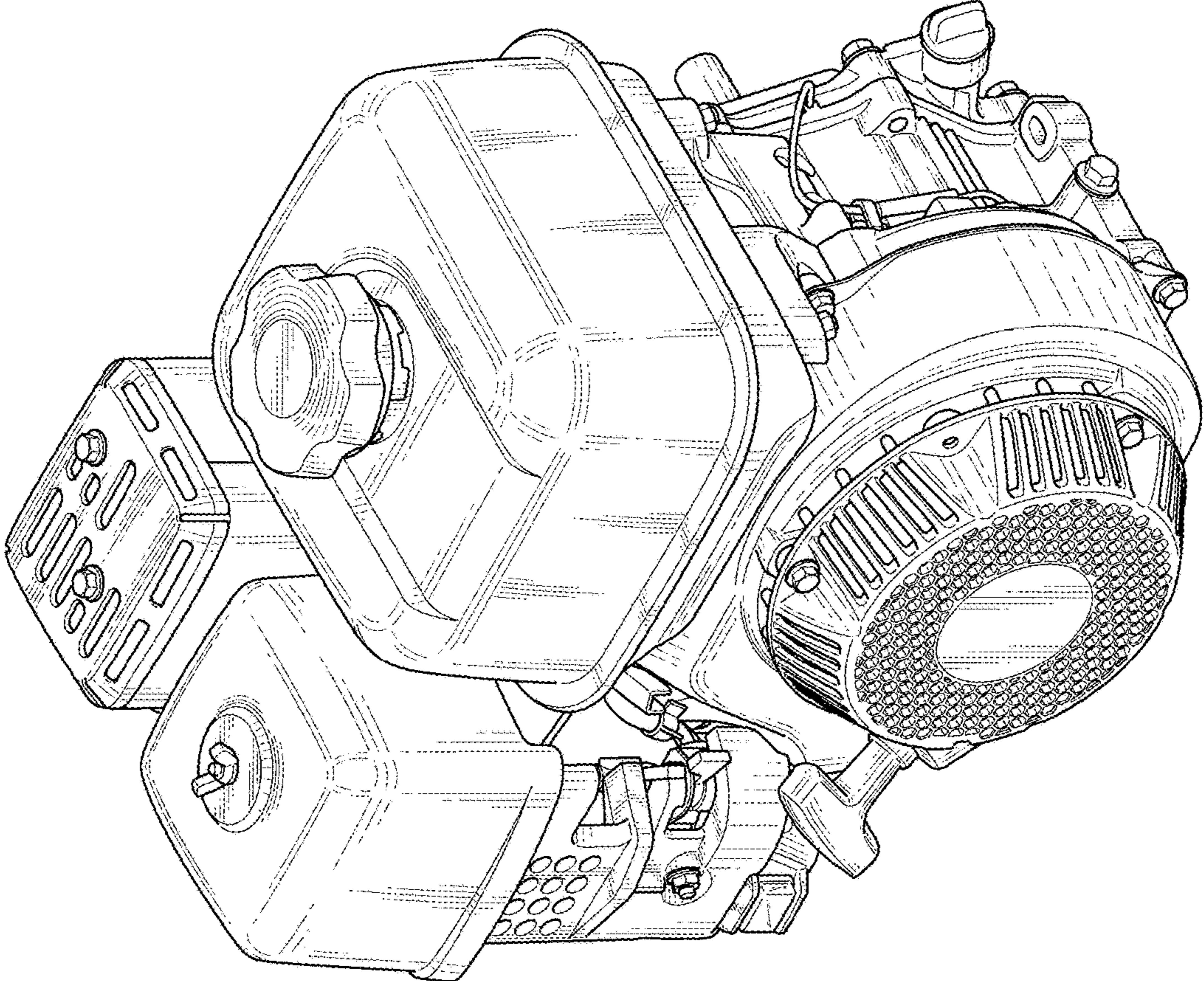

FIG. 1

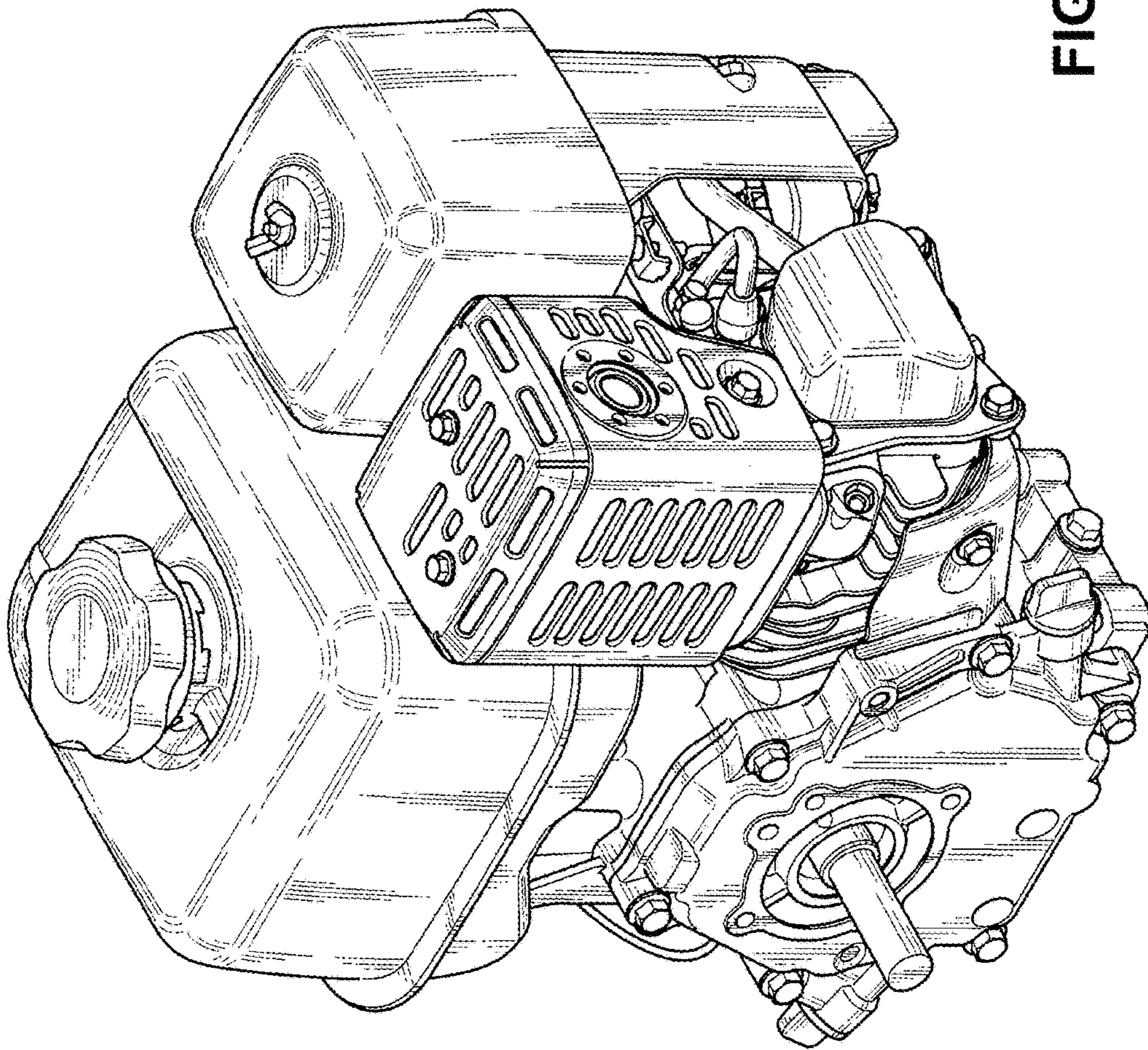

FIG. 2

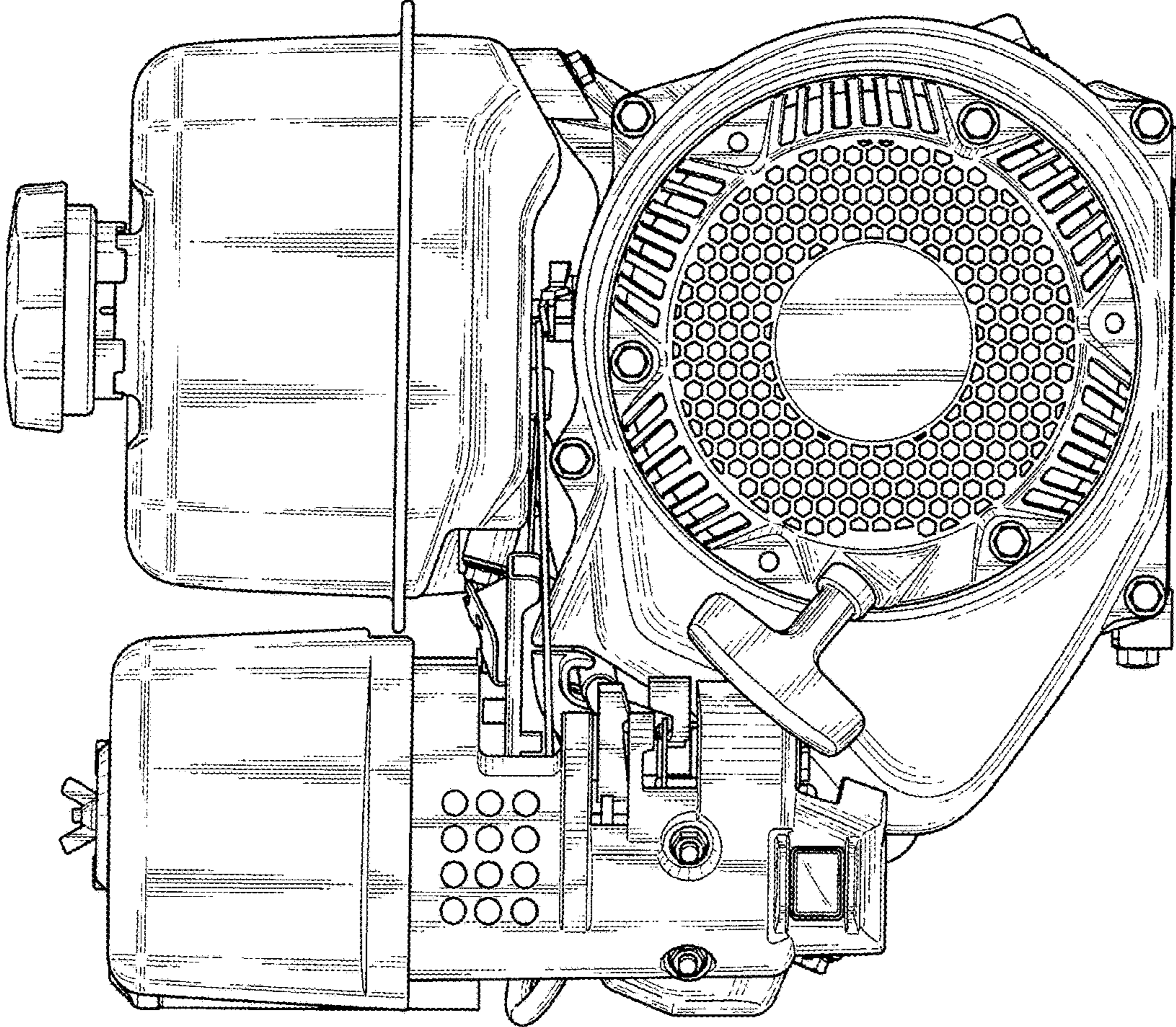

FIG. 3

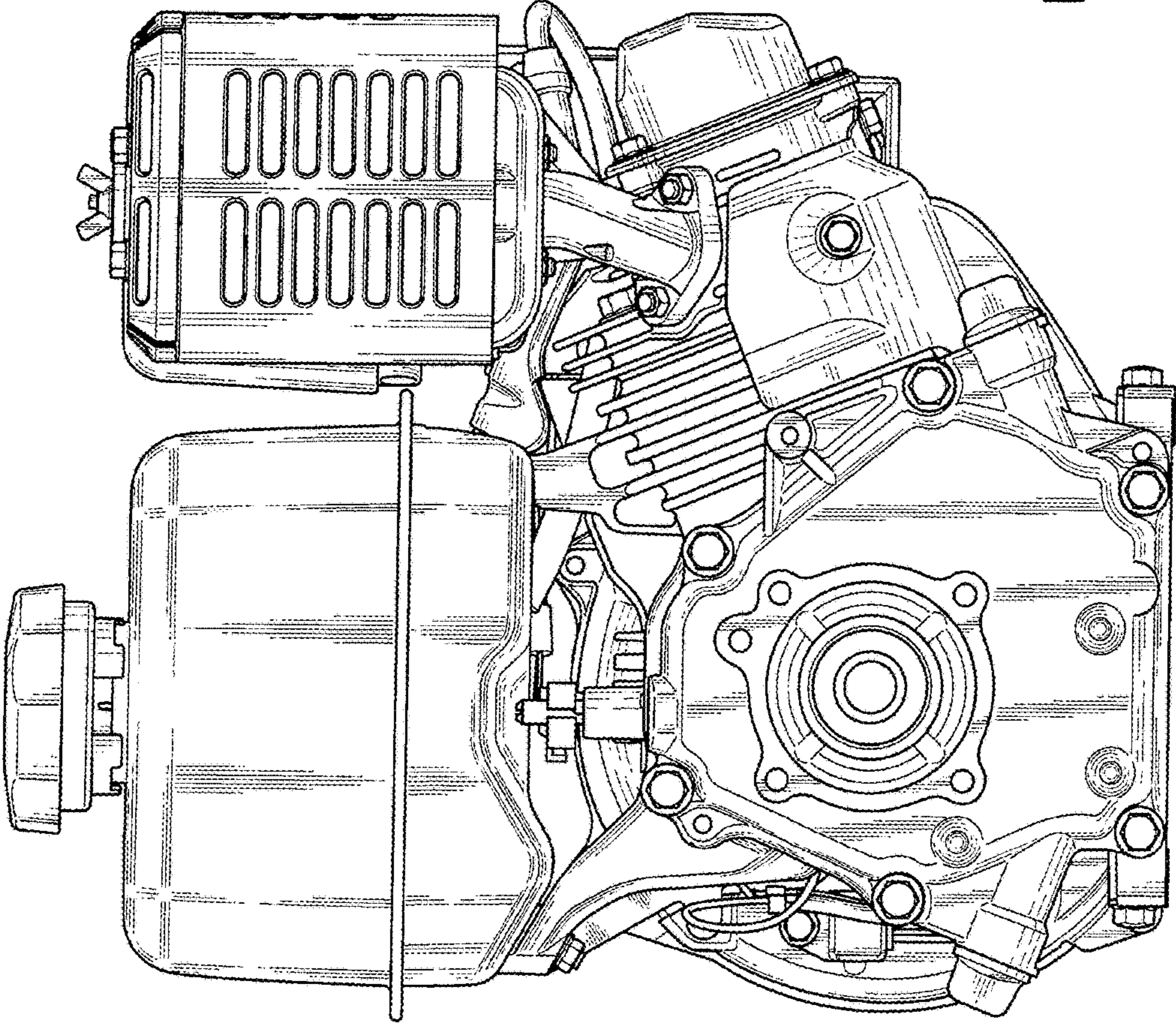

FIG. 4

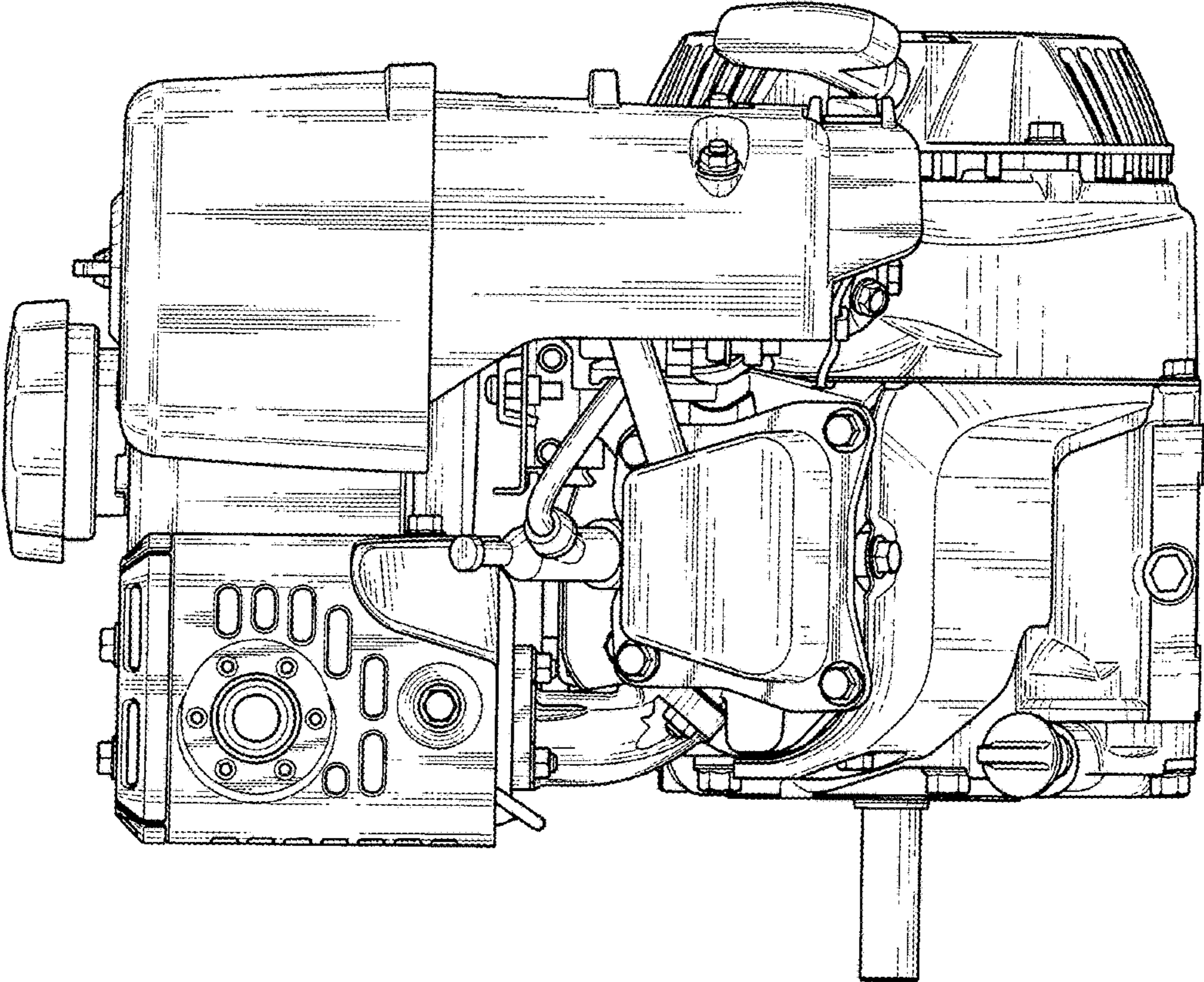

FIG. 5

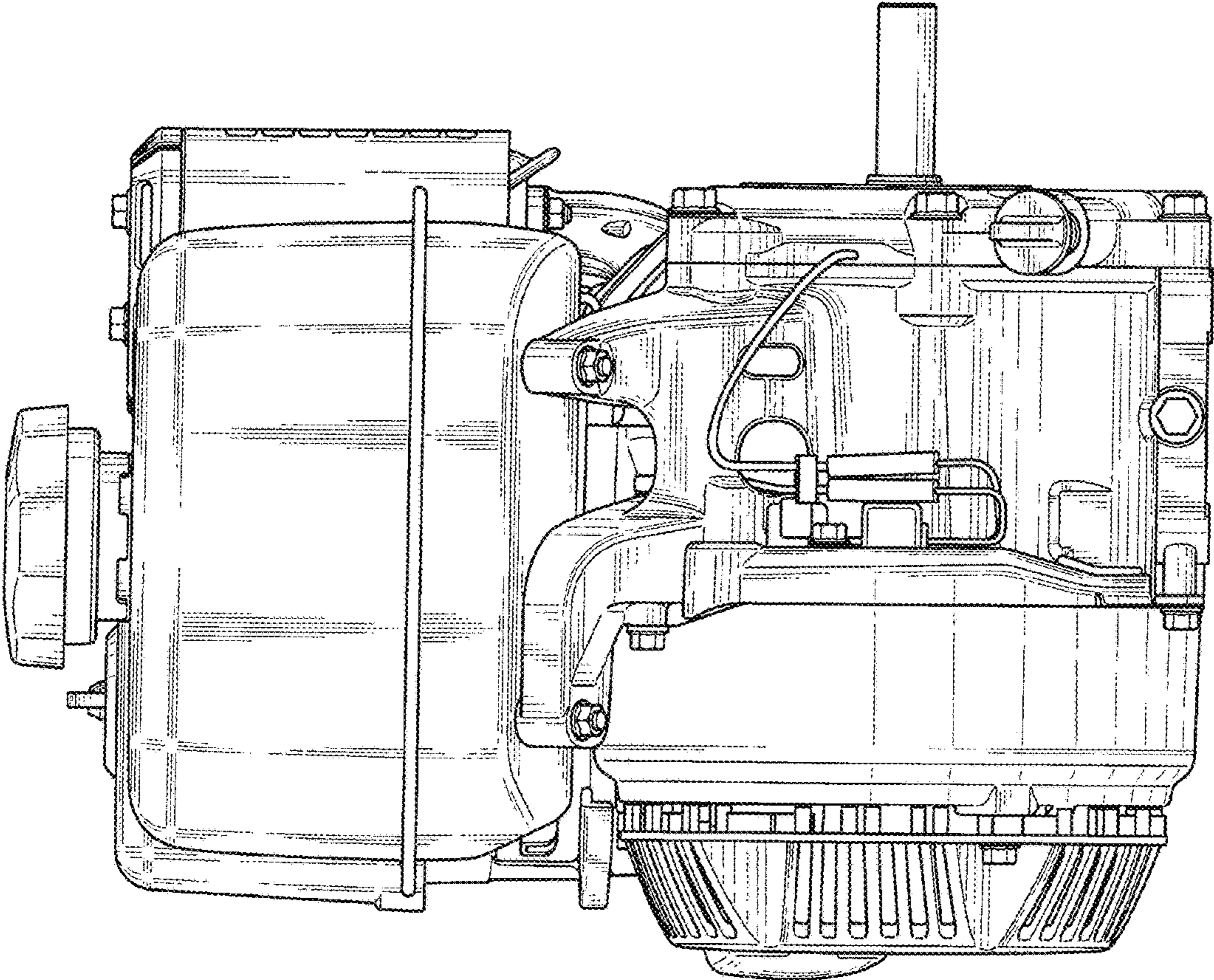

FIG. 6

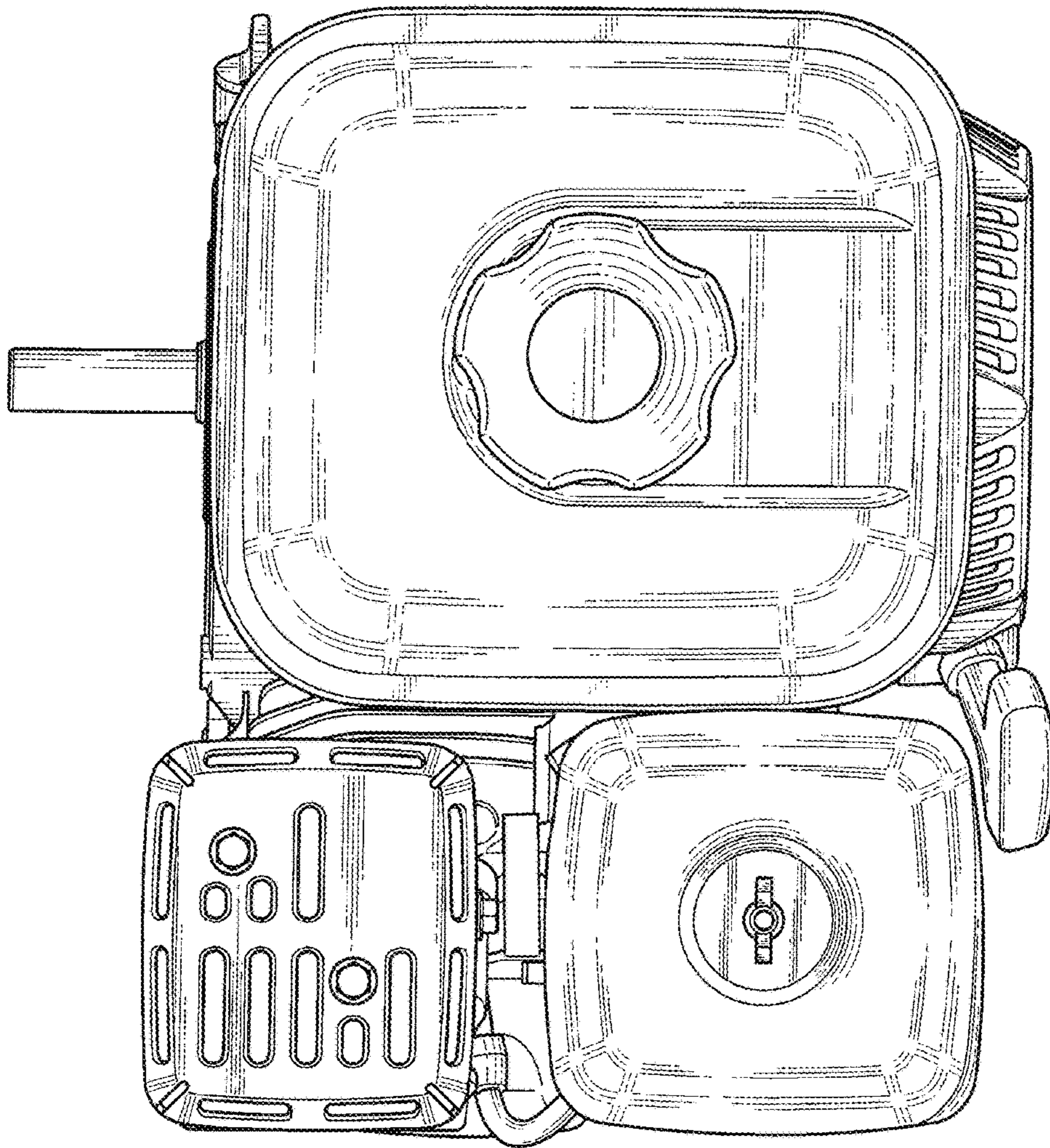

FIG. 7

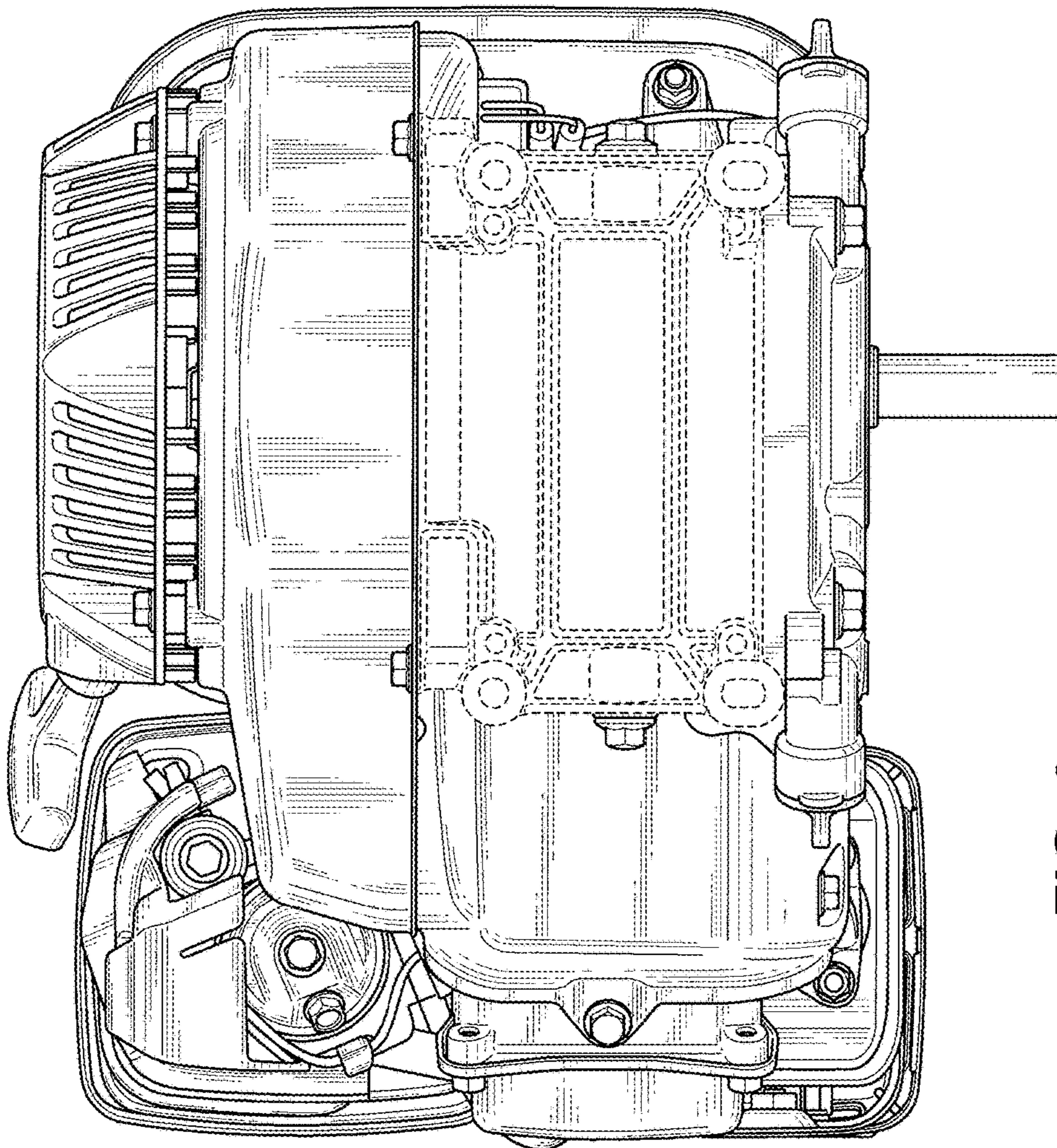

FIG. 8