



US00D823869S

(12) **United States Design Patent**
Zimmerman et al.

(10) **Patent No.:** **US D823,869 S**

(45) **Date of Patent:** **** Jul. 24, 2018**

(54) **BLOT AND GEL IMAGING INSTRUMENT
DISPLAY SCREEN WITH GRAPHICAL USER
INTERFACE**

(58) **Field of Classification Search**

USPC D14/485-495

CPC G06F 3/0482; G06F 3/04886

See application file for complete search history.

(71) Applicants: **LIFE TECHNOLOGIES
CORPORATION**, Carlsbad, CA (US);
PIERCE BIOTECHNOLOGY, INC.,
Carlsbad, CA (US); **LIFE
TECHNOLOGIES HOLDINGS PTE
LIMITED**, Carlsbad, CA (US)

(56) **References Cited**

U.S. PATENT DOCUMENTS

D591,762 S * 5/2009 Scalisi D14/485

D685,813 S * 7/2013 Bork D14/486

D735,231 S * 7/2015 Omiya D14/486

D785,016 S * 4/2017 Berwick D14/486

2013/0104079 A1* 4/2013 Yasui G06F 3/0482
715/834

2016/0019352 A1* 1/2016 Cohen G06Q 50/24
705/3

* cited by examiner

Primary Examiner — Richelle G Shelton

(72) Inventors: **Sean Zimmerman**, San Diego, CA
(US); **Chee Kiong Lim**, Singapore
(SG); **Scott Rickes**, San Diego, CA
(US); **Gregory Kilmer**, Winnebago, IL
(US); **John Langan**, Carlsbad, CA
(US); **Kok Siong Teo**, Singapore (SG)

(57) **CLAIM**

The ornamental design for a blot and gel imaging instrument display screen with graphical user interface, as shown and described.

(73) Assignees: **LIFE TECHNOLOGIES
CORPORATION**, Carlsbad, CA (US);
PIERCE BIOTECHNOLOGY, INC.,
Rockford, IL (US); **LIFE
TECHNOLOGIES HOLDINGS PTE
LIMITED**, Singapore (SG)

DESCRIPTION

FIG. 1 is a view of a first embodiment of a blot and gel imaging instrument display screen with graphical user interface of our new design; and,

FIG. 2 is a view of a second embodiment of a blot and gel imaging instrument display screen with graphical user interface of our new design.

The broken lines showing the display screen and elements of the graphical user interface form no part of the claimed design.

(**) Term: **15 Years**

(21) Appl. No.: **29/581,068**

(22) Filed: **Oct. 14, 2016**

(51) **LOC (11) Cl.** **14-04**

(52) **U.S. Cl.**
USPC **D14/486**

1 Claim, 2 Drawing Sheets

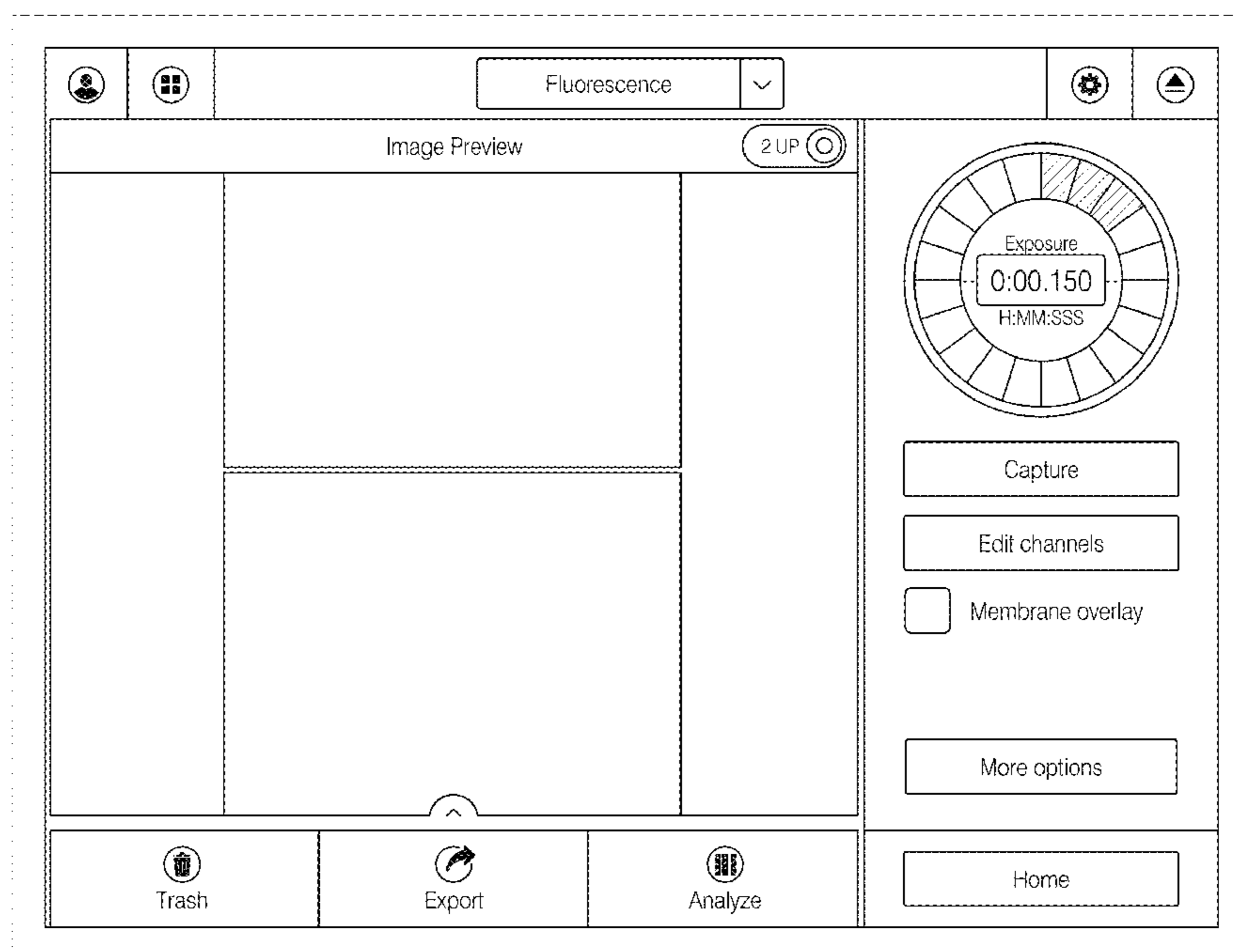

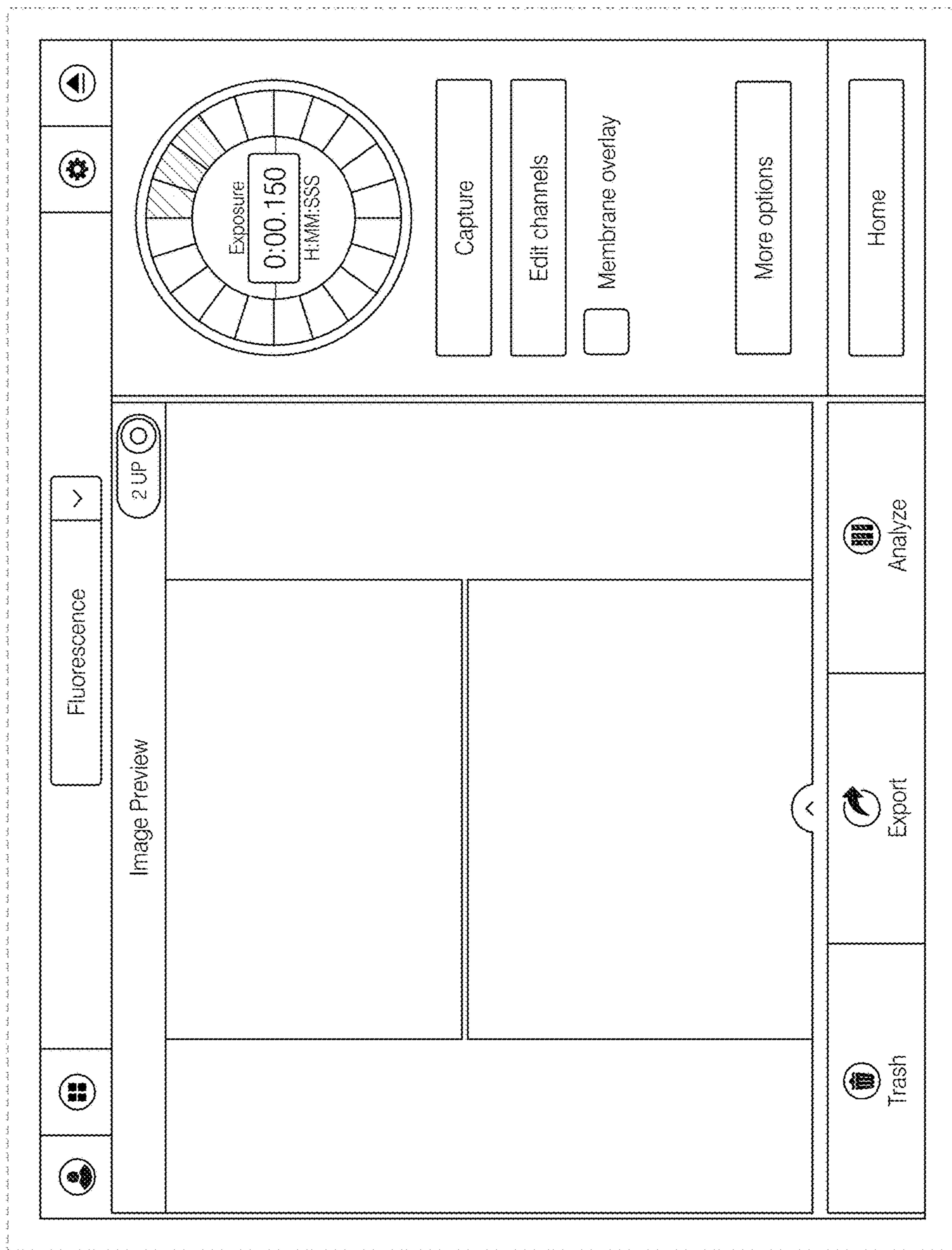

FIG. 1

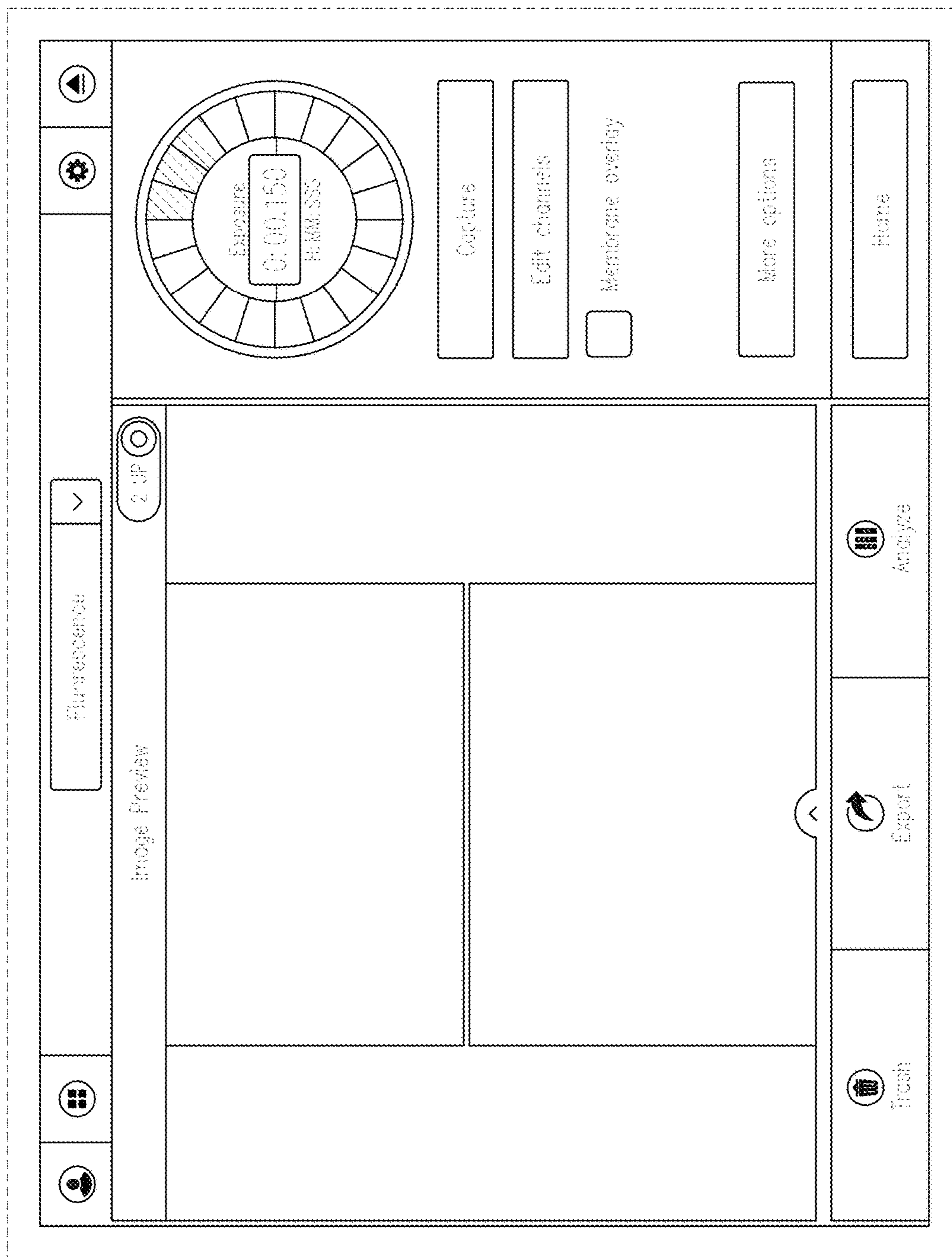

FIG. 2