



US00D823401S

(12) **United States Design Patent**
Kondo

(10) **Patent No.:** **US D823,401 S**

(45) **Date of Patent:** **** Jul. 17, 2018**

(54) **BLOCK ASSEMBLY TOY**
(71) Applicant: **BORNDEA CO., LTD.**, Tokyo (JP)
(72) Inventor: **Hiroyuki Kondo**, Tokyo (JP)
(73) Assignee: **BORNDEA CO., LTD.**, Tokyo (JP)

(**) Term: **15 Years**

(21) Appl. No.: **35/502,698**

(22) Filed: **Sep. 28, 2016**

(80) **Hague Agreement Data**

Int. Filing Date: **Sep. 28, 2016**

Int. Reg. No.: **DM/092813**

Int. Reg. Date: **Sep. 28, 2016**

Int. Reg. Pub. Date: **Mar. 31, 2017**

(51) **LOC (11) Cl.** **21-01**

(52) **U.S. Cl.**
USPC **D21/484**

(58) **Field of Classification Search**
USPC D21/484, 492, 493
See application file for complete search history.

(56) **References Cited**

U.S. PATENT DOCUMENTS

D258,743 S * 3/1981 Ruga D21/484

D398,338 S * 9/1998 Yoon D21/484
D798,391 S * 9/2017 Howard D21/484
D802,683 S * 11/2017 Howard D21/492

* cited by examiner

Primary Examiner — George D. Kirschbaum

(57) **CLAIM**

The ornamental design for a block assembly toy, as shown and described.

DESCRIPTION

The patent or application file contains at least one drawing executed in color. Copies of this patent or patent application publication with color drawing(s) will be provided by the Office upon request and payment of the necessary fee.

1. Block assembly toy

1.1 : Front

1.2 : Back

1.3 : Left

1.4 : Right

1.5 : Top

1.6 : Bottom

1.7 : Perspective

1 Claim, 7 Drawing Sheets
(7 of 7 Drawing Sheet(s) Filed in Color)

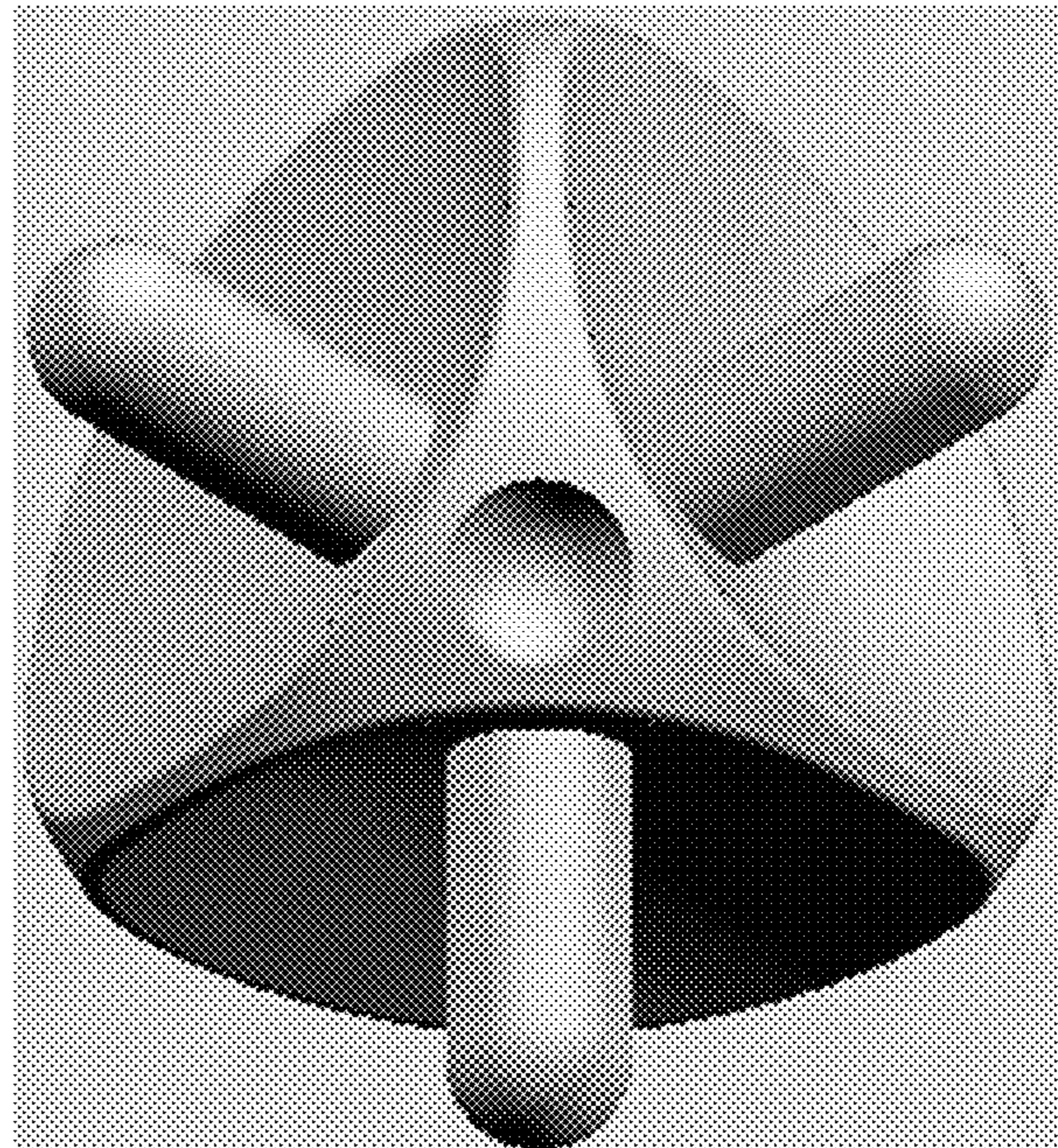
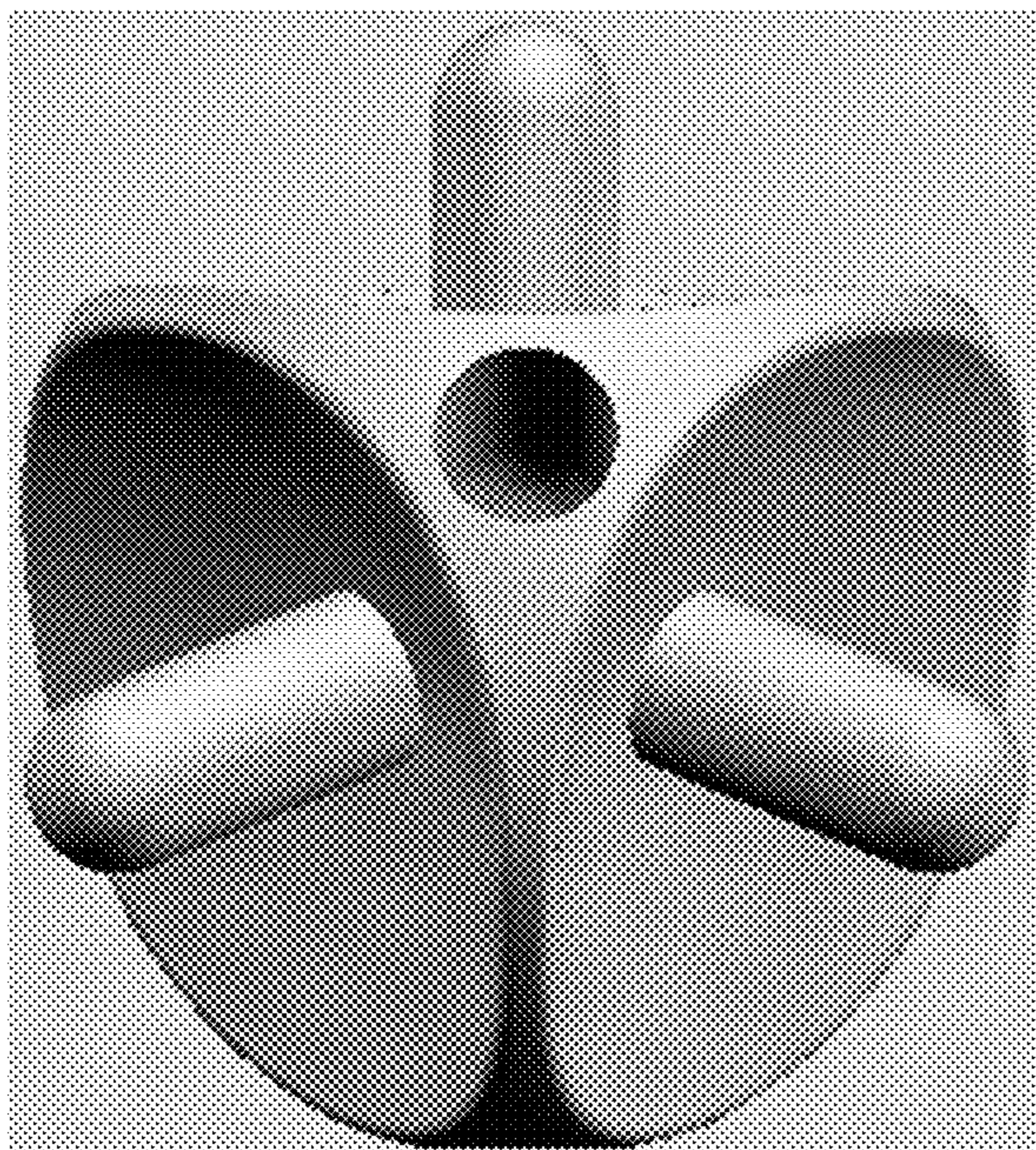

1.1

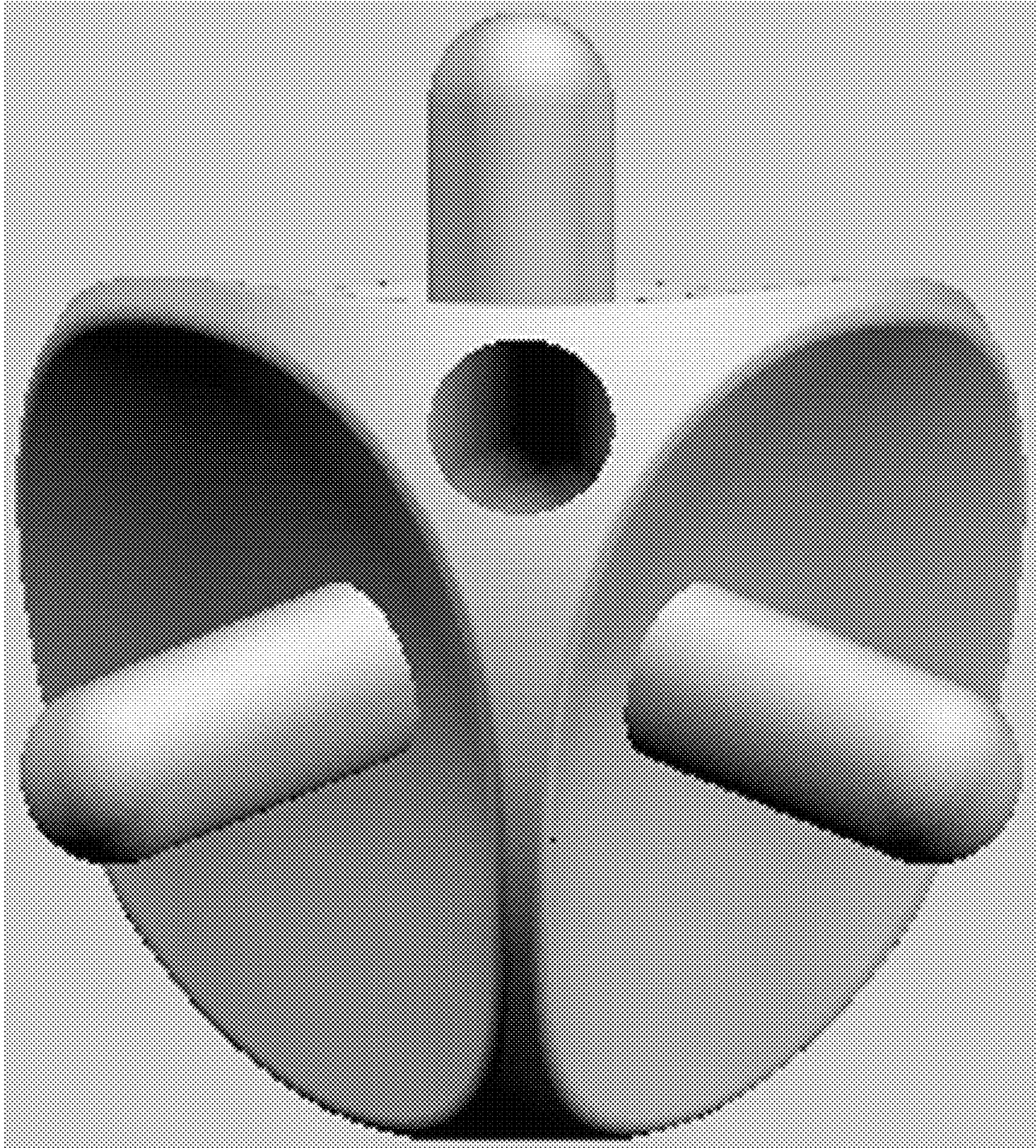

1.2

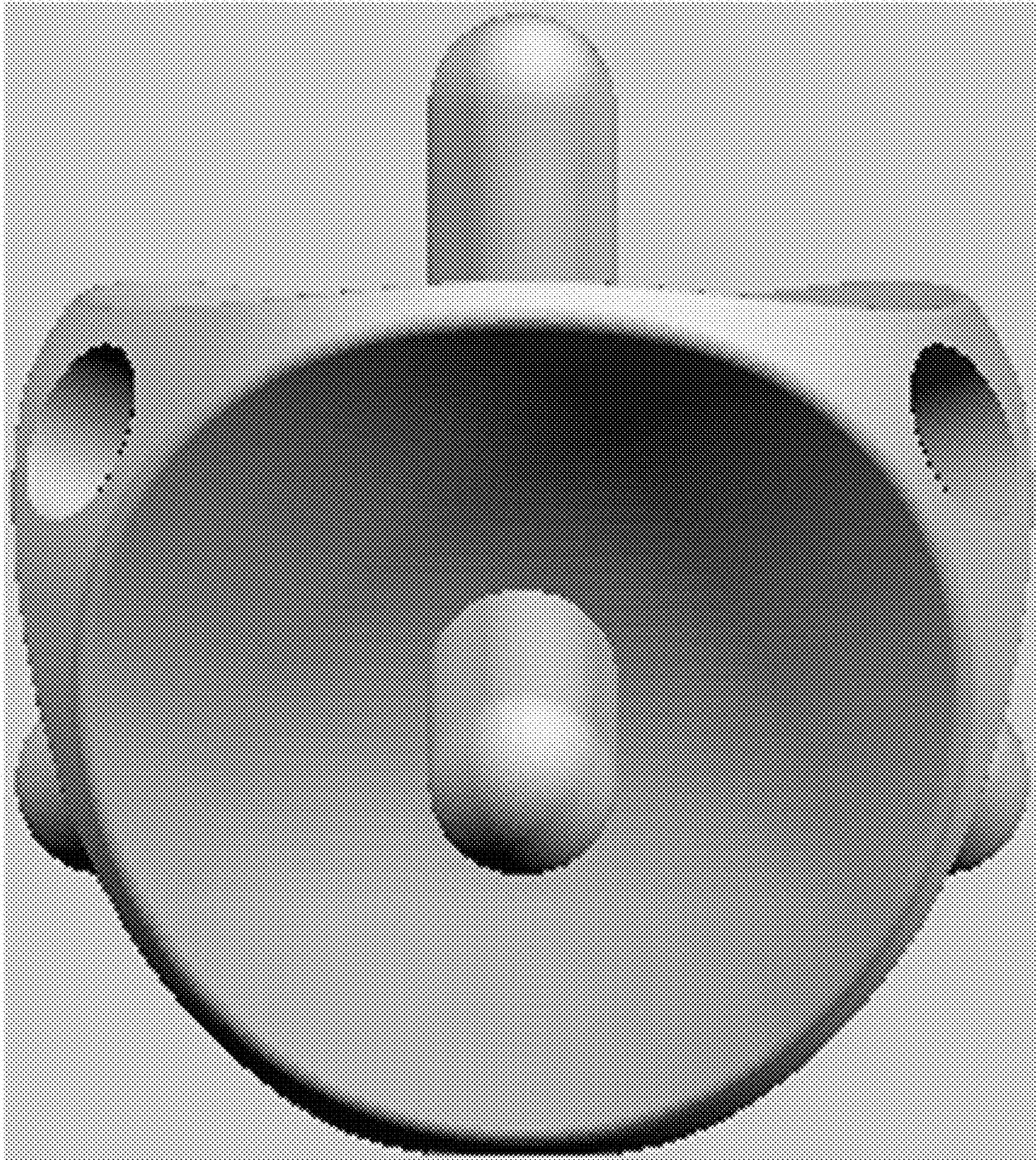

1.3

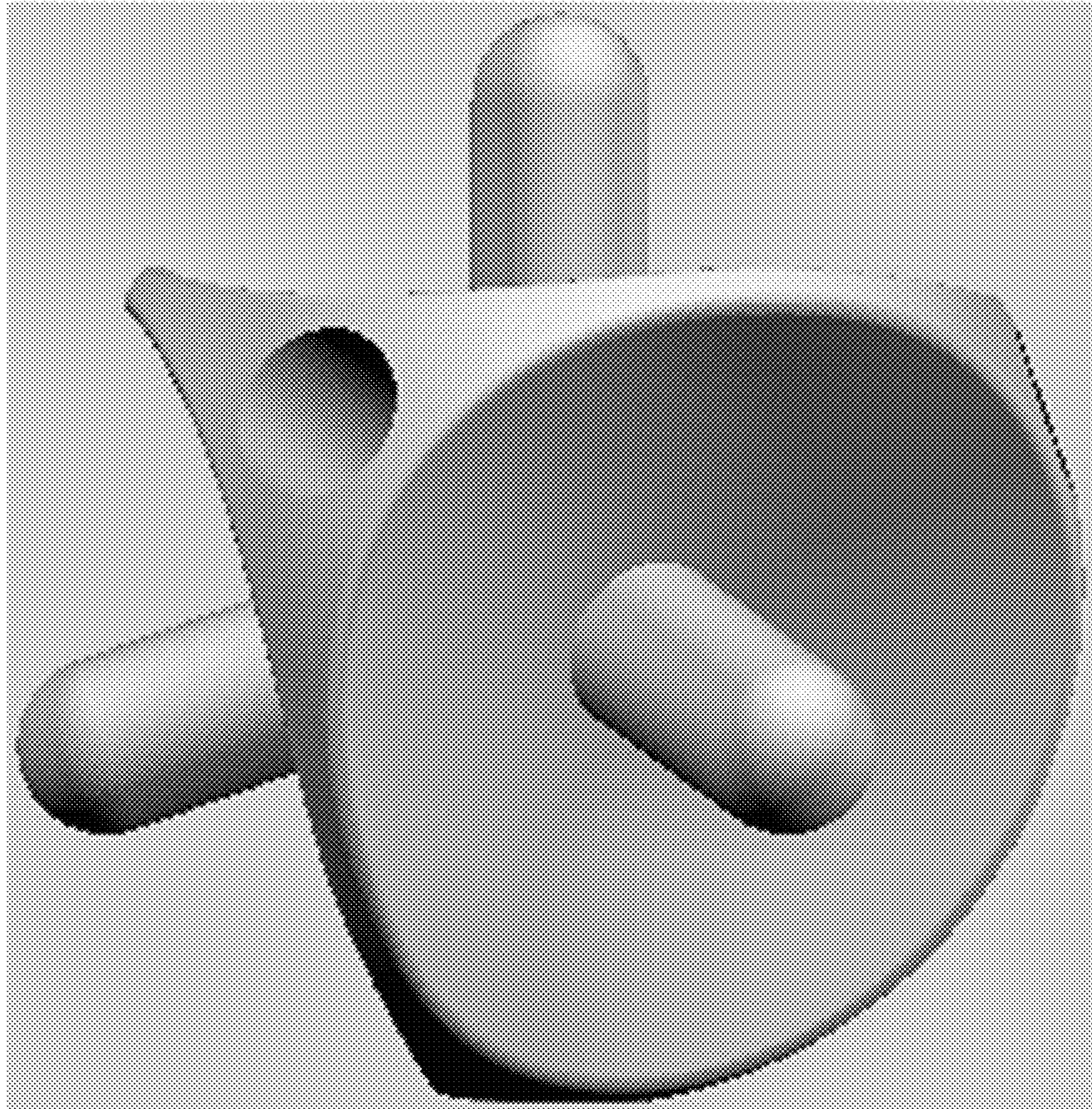

1.4

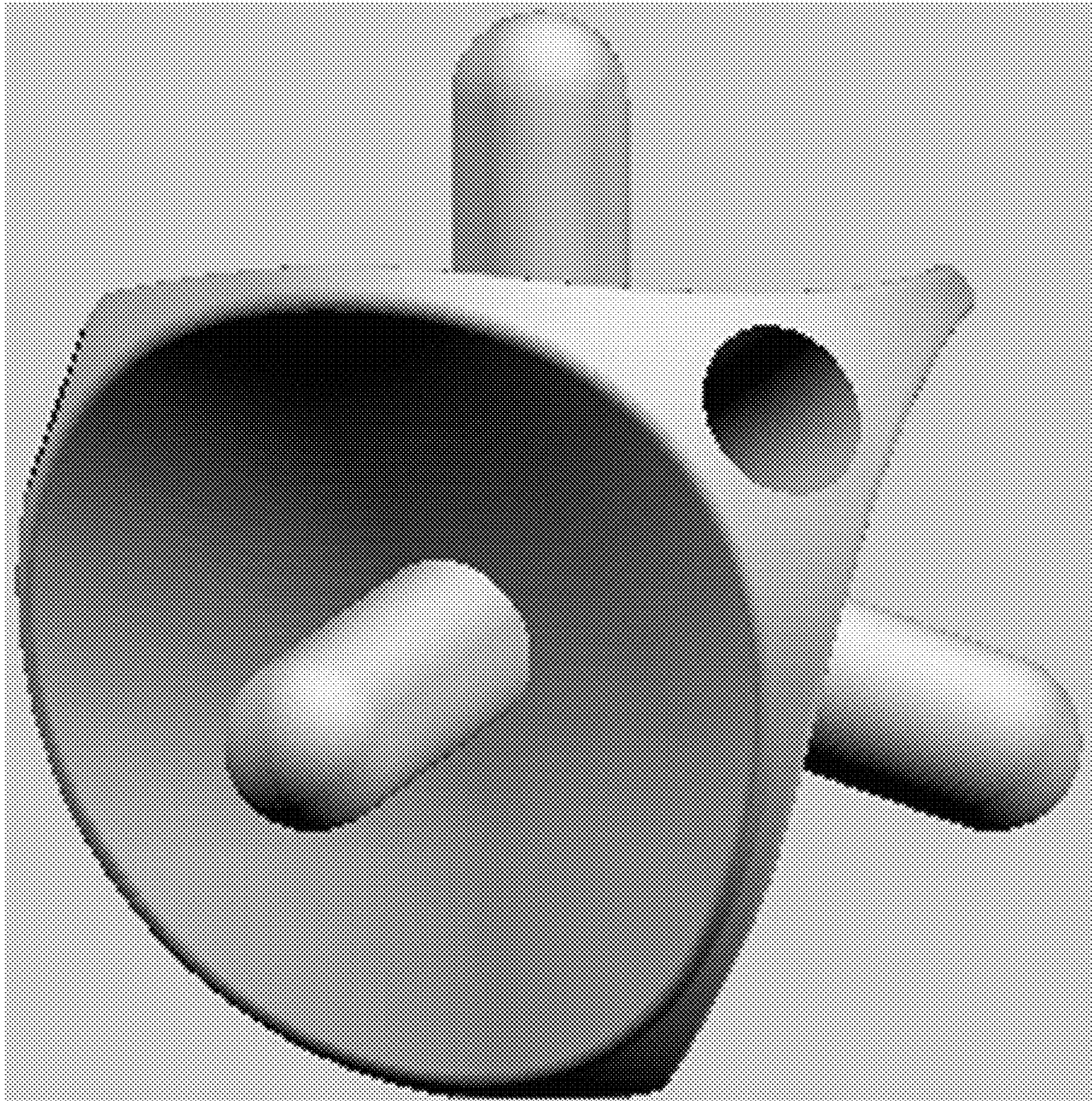

1.5

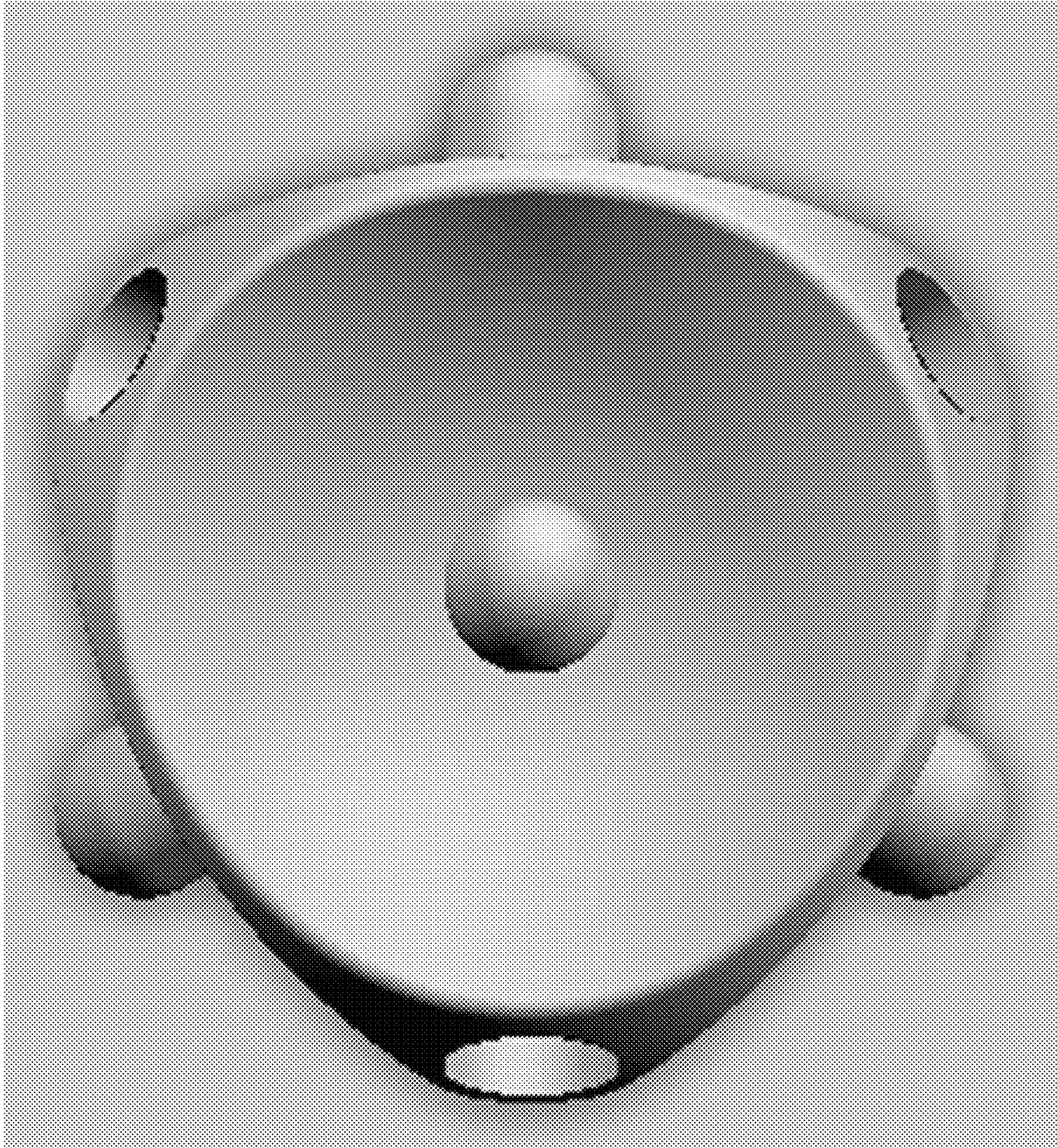

1.6

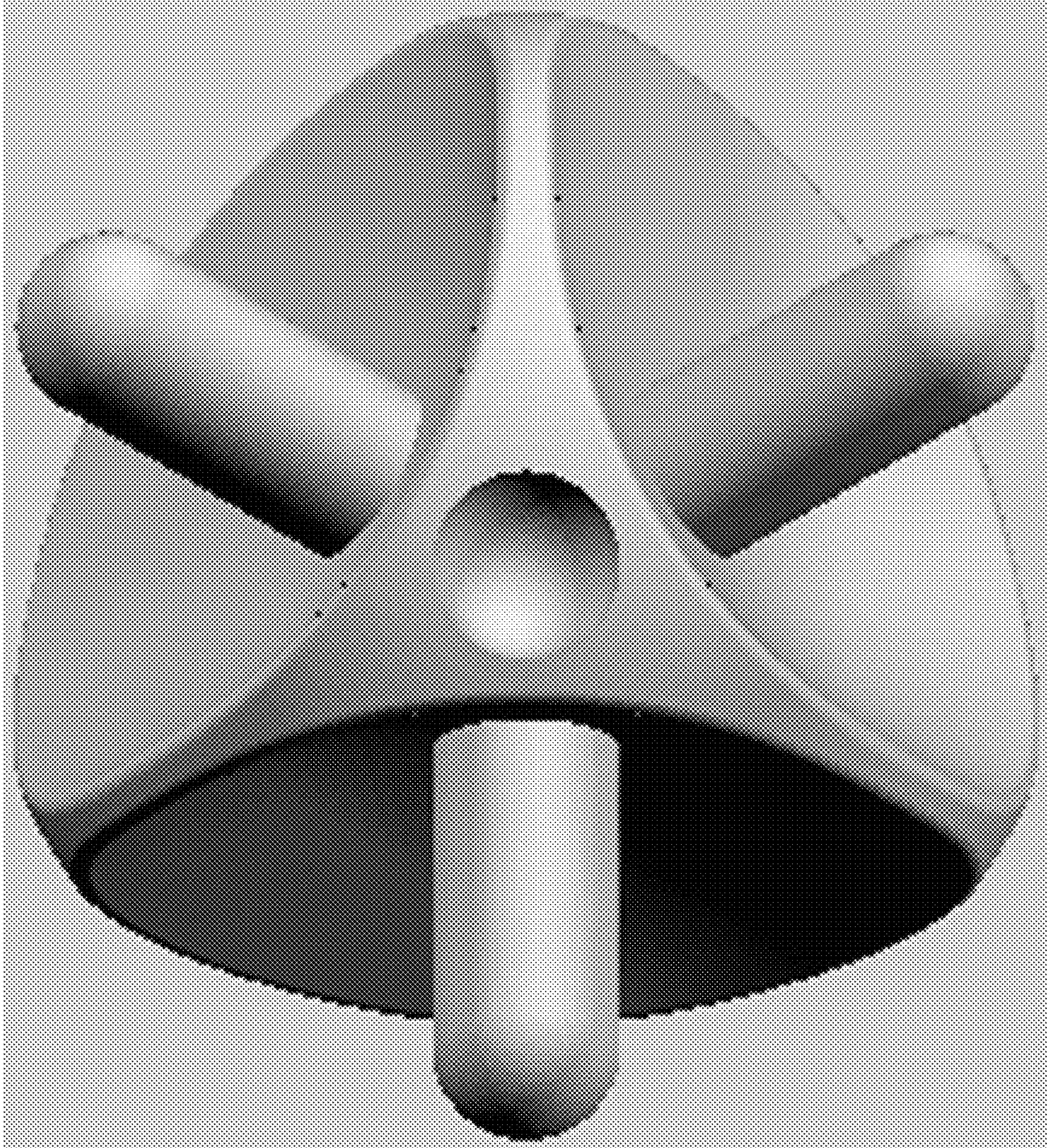

1.7

